

# MODEL 800 AUTOMATIC HUMIDIFIER

**INSTALLER: PLEASE FILL OUT AND MAIL GUARANTEE CARD AFTER INSTALLATION IS COMPLETE. LEAVE INSTALLATION INSTRUCTIONS WITH HOME OWNER**

**PRECAUTION:** The installer should be an experienced service technician. Disconnect electrical power before beginning installation. Do not install where temperatures fall below 32 degrees F or where plenum temperatures exceed 200 degrees F.

**INSTALLATION:** The humidifier may only be mounted on the warm air plenum or furnace bonnet. Humidifier extends into duct 7 1/2 inches. See Typical Installations.

**FOR INSTALLATION ON A  
VERTICAL SURFACE OF ANY  
WARM AIR PLENUM**

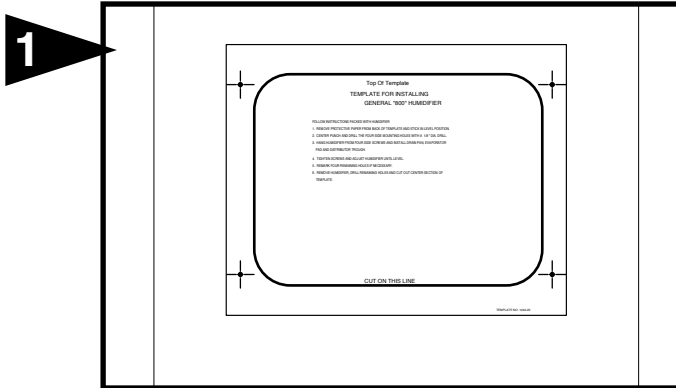
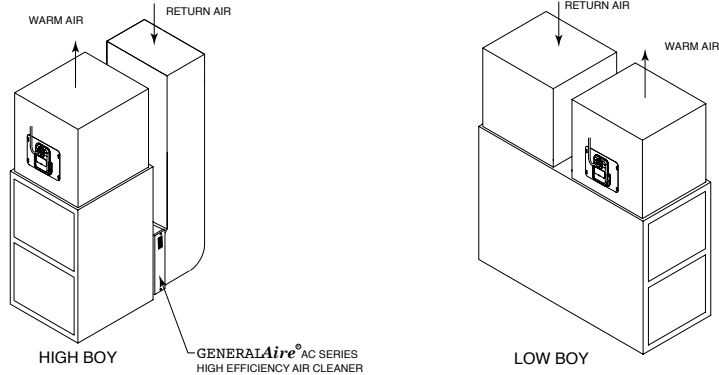

Select location on vertical surface of warm air plenum for mounting humidifier. Stick mounting template in place making sure the template is level. Do not install humidifier where the blanked off ends of a cooling coil will restrict air flow to the humidifier.

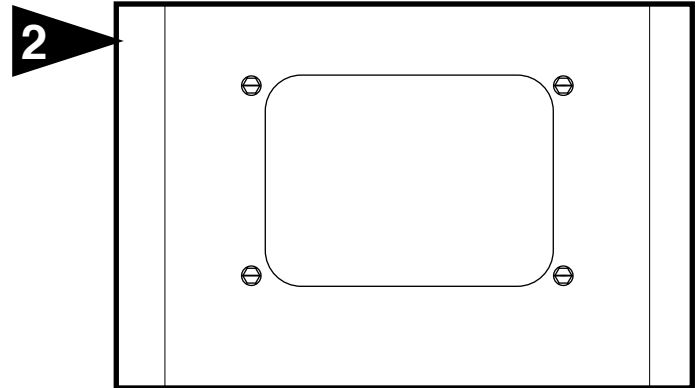

Center punch the four side mounting holes on the template and drill with an 1/8" drill bit. Cut out center section of template. Remove the template and insert the four sheet metal screws until the heads project about 1/8".

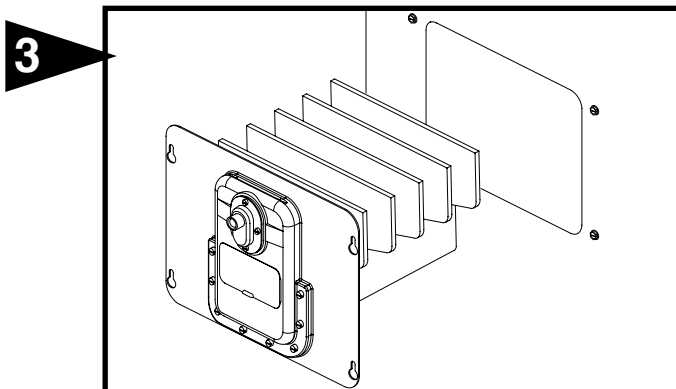

Install evaporator plates in pan. Insert the humidifier in the plenum such that the four screws project through the keyhole slots. Slide the humidifier down level and tighten four screws.

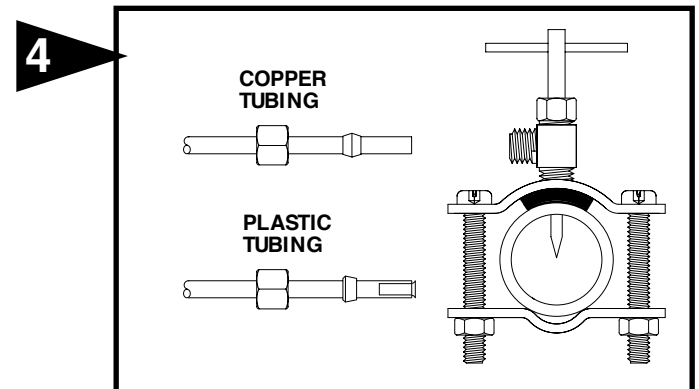

Mount the self tapping saddle valve on either a cold or a hot water pipe. A side or top mount is best to avoid clogging from pipe sediment. Connect 1/4" O.D. tubing to the saddle valve. Copper tubing requires a brass compression nut and brass sleeve. Plastic tubing requires a brass insert inside the tubing, a plastic sleeve on the outside with a brass compression nut.

**NOTE: DO NOT USE PLASTIC TUBING ON HOT WATER OR IN CONTACT WITH ANY HOT PLENUM SURFACE OR DUCT. INSTALLATION OF THIS SADDLE VALVE MUST MEET OR EXCEED LOCAL CODES AND ORDINANCES.**

## SADDLE VALVE INSTALLATION INSTRUCTIONS

### Copper Pipe

1. Retract piercing pin into valve body by turning handle counterclockwise.
2. Screw valve body into upper bracket and tighten.
3. Place rubber gasket over piercing pin.
4. Assemble saddle valve over copper pipe using enclosed screws, nuts and lower bracket.
5. Tighten screws evenly and firmly. Brackets should be parallel.
6. Complete compression connection to saddle valve outlet.
7. Turn handle clockwise to pierce tubing and close saddle valve.
8. Turn handle counterclockwise to open saddle valve, leave open for several seconds to flush dirt from pipe and tubing.

### Steel, Brass or Hard Plastic Pipe

1. Shut off water supply and drain pipe.
2. Turn handle clockwise to expose piercing pin and close saddle valve.
3. Place rubber gasket over piercing pin.
4. Drill 1/8" hole in pipe using a hand crank drill to avoid shock hazard.
5. Assemble saddle valve over steel, brass or hard plastic pipe using enclosed screws, nuts and lower bracket.
6. Tighten screws evenly and firmly. Brackets should be parallel.
7. Complete compression connection to saddle valve outlet.
8. Turn handle counterclockwise to open saddle valve, leave open for several seconds to flush dirt from pipe and tubing.

### Threaded Pipe Fittings

1. Turn handle clockwise to expose piercing pin and close saddle valve.
2. Seal valve body threads using pipe tape or sealant.
3. Install valve into 1/8" NPT fitting.
4. Complete compression connection to saddle valve outlet.
5. Turn handle counterclockwise to open saddle valve, leave open for several seconds to flush dirt from pipe and tubing.

5

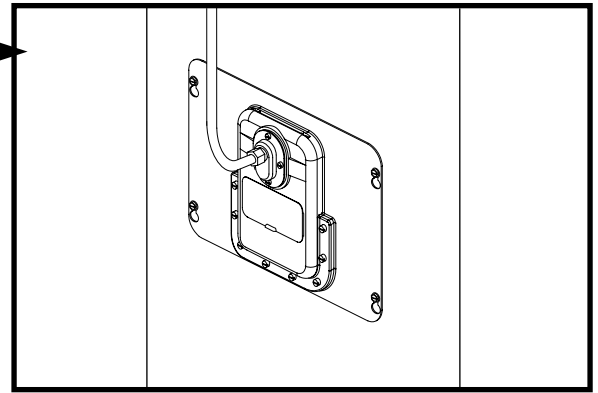

Connect 1/4" water supply tube to humidifier. Copper tubing requires a brass compression nut and brass sleeve. Plastic tubing requires a brass insert inside the tubing, a plastic sleeve on the outside with a brass compression nut. **DO NOT USE PLASTIC TUBING IN CONTACT WITH ANY HOT PLENUM SURFACE OR DUCT. IF USING PLASTIC TUBING, USE TUBE SUPPORT PROVIDED.**

6

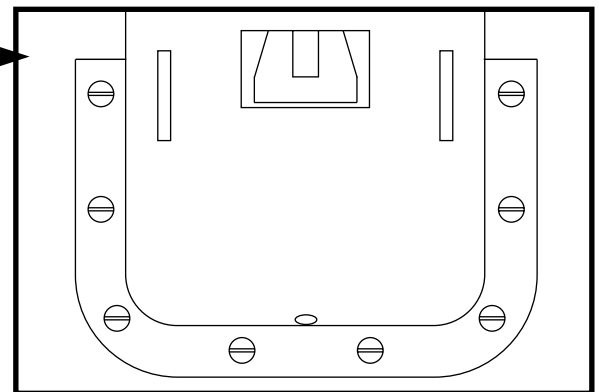

## PARTS LIST FOR HUMIDIFIER

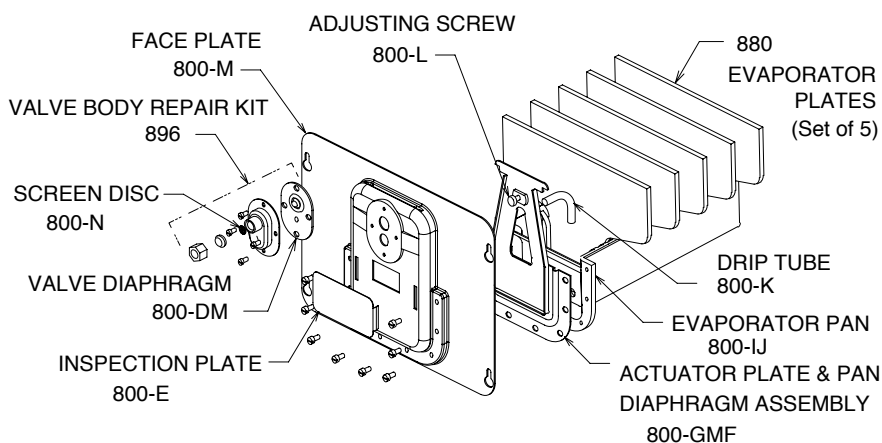

Turn on water supply and check operation of humidifier. Check flow of water by removing inspection plate and observe drip tube. Humidifier will gradually fill 3/4 inch to 1 inch deep and shut off. To accelerate filling, move valve actuator plate toward pan through inspection opening. **NOTE: THIS HUMIDIFIER HAS BEEN FACTORY ADJUSTED TO OPERATE ON WATER PRESSURES FROM 20 TO 150 P.S.I. NO ADJUSTMENT SHOULD BE NECESSARY.**

**NOTE:** 800-IJ phenolic evaporator pan with cast in plate rack and pan baffle is interchangeable with 800-I pan.

## CARE AND MAINTENANCE

Your Humidifier is engineered to give helpful and trouble-free humidification. For maximum efficiency the following cleaning procedures should be carried out at the end of each heating season:

### REPLACING EVAPORATOR PLATES AND CLEANING HUMIDIFIER

1. Turn off water supply to humidifier.
2. Disconnect the 1/4" water supply line from the humidifier.
3. Loosen the four screws holding the humidifier in place.
4. Lift humidifier up and slide out.
5. Remove old evaporator plates.
6. Clean pan with scouring pad and rinse thoroughly.
7. Replace evaporator plates with Generalaire 880 evaporator plates.
8. Carefully slide humidifier into opening to prevent breaking evaporator plates.
9. Tighten the four screws and reconnect the 1/4" water line to the humidifier. Turn on the water supply and check all points for leakage. The humidifier is now ready for operation.
10. During the summer, turn off water supply to humidifier.

DO NOT DISTURB VALVE ASSEMBLY UNLESS IT SHOULD FAIL TO FUNCTION PROPERLY.

### SERVICING THE VALVE

If the valve should malfunction look for dirt in the orifice and neoprene valve seat.

- A. Turn off water supply to humidifier. Disconnect the 1/4" water supply line from the humidifier. Loosen the four screws holding the humidifier in place. Lift humidifier up and slide out.
- B. Remove the four screws from the valve body and pull from neoprene valve diaphragm.
- C. Remove screen disc from orifice fitting with wire paper clip. Clean orifice and screen.
- D. Clean all dirt and scale from neoprene valve seat and examine seat for wear.
- E. Replace valve body with orifice fitting on top. Do not over tighten screws.
- F. Reconnect the 1/4" water line to the humidifier. Turn on water supply and adjust valve to shut off when water level is approximately 1/4 inch above holes in pan baffle. When the water reaches this level turn valve adjusting screw in slowly until water stops dripping from drip tube. To test this setting dip water from the pan. Water should start dripping from the drip tube. The humidifier is now properly adjusted to automatically maintain this water level in the pan.

## HOW THE HUMIDIFIER WORKS

The water supply to the humidifier is automatically controlled by the water pressure against the neoprene pan diaphragm.

When the water level is approximately 1 inch deep in the pan, the pressure on the pan diaphragm causes the actuator plate to pivot pushing the screw and valve seat against the orifice, shutting off the flow of water.

As the water is drawn from the pan and evaporated through the evaporator plates, the pressure on the pan diaphragm is reduced, allowing the actuator plate to pivot away from the valve, opening the water inlet orifice. This allows water to flow from the orifice through the valve chamber and drip tube to refill the pan.

### FILL OUT AND MAIL THIS WARRANTY CARD AND LITERATURE REQUEST FORM

- AIR CLEANERS AND AIR PURIFIERS
- HUMIDIFIERS
- DIGITAL HUMIDITY GAGE
- AIR FILTER GAGE
- FUEL OIL FILTERS AND ACCESSORIES

# LIMITED WARRANTY

This humidifier, if properly registered by the return of the warranty registration card to the manufacturer, is warranted to the consumer against defects in materials and workmanship for a period of one year from the date of installation. Evaporator pads, sleeves or plates are not covered by this limited warranty or any other warranties. Any other defective parts will be repaired without charge except for removal, reinstallation and transportation costs. To obtain repair service under this limited warranty, the consumer must send the defective part or the complete humidifier to the manufacturer.

THERE ARE NO EXPRESS WARRANTIES COVERING THIS HUMIDIFIER OTHER THAN AS SET FORTH ABOVE, THE IMPLIED WARRANTIES OF MERCHANTABILITY AND FITNESS FOR A PARTICULAR PURPOSE ARE LIMITED IN DURATION TO ONE YEAR. THE MANUFACTURER ASSUMES NO LIABILITY IN CONNECTION WITH THE INSTALLATION OR USE OF THIS PRODUCT, EXCEPT AS STATED IN THIS LIMITED WARRANTY. THE MANUFACTURER WILL IN NO EVENT BE LIABLE FOR INCIDENTAL OR CONSEQUENTIAL DAMAGES.

This limited warranty gives you specific legal rights, and you may also have other rights which vary from state to state. Some states do not allow either limitations on implied warranties, or exclusions from incidental or consequential damages, so the above exclusion and limitation may not apply to you.

Any questions pertaining to this limited warranty should be addressed to the manufacturer. (U.S.A.: The manufacturer has elected not to make available the informal dispute settlement mechanism which is specified in the Magnuson-Moss Warranty Act.).

**GENERAL FILTERS, INC. 43800 GRAND RIVER AVE. NOVI, MICHIGAN 48375-1115 WWW.GENERALAIR.COM**  
**CANADIAN GENERAL FILTERS, LTD. 39 CROCKFORD BLVD. SCARBOROUGH, ONTARIO M1R3B7 WWW.CGFPRODUCTS.COM**

**LE PROPRIÉTAIRE DOIT REMPLIR LA CARTE  
D'ENREGISTREMENT  
ET LA POSTER AU :**  
**OWNER FILL IN  
REGISTRATION  
AND MAIL TO :**  
GENERAL FILTERS, INC.  
43800 GRAND RIVER AVE.  
NOVI, MI 48375-1115

## **WARRANTY REGISTRATION Enregistrement de la garantie**

MODEL 800 AUTOMATIC HUMIDIFIER  
AUTOMATIQUE HUMIDIFICATEUR MODÈLE 800

OWNER'S NAME

Nom du propriétaire: \_\_\_\_\_

STREET ADDRESS

Adresse: \_\_\_\_\_

CITY

Ville: \_\_\_\_\_

DEALERS NAME

Nom du marchand: \_\_\_\_\_

STREET ADDRESS

Adresse: \_\_\_\_\_

CITY

Ville: \_\_\_\_\_

DATE OF INSTALLATION

DATE DE INSTALLATION

STATE

Province: \_\_\_\_\_

STREET ADDRESS

Adresse: \_\_\_\_\_

CITY

Ville: \_\_\_\_\_

STATE

Province: \_\_\_\_\_

DATE OF INSTALLATION

DATE DE INSTALLATION

POSTAL CODE

Code postal: \_\_\_\_\_

STREET ADDRESS

Adresse: \_\_\_\_\_

CITY

Ville: \_\_\_\_\_

STATE

Province: \_\_\_\_\_

DATE OF INSTALLATION

DATE DE INSTALLATION

SERIAL NUMBER

Numéro de Série \_\_\_\_\_