

# **Duracraft®**

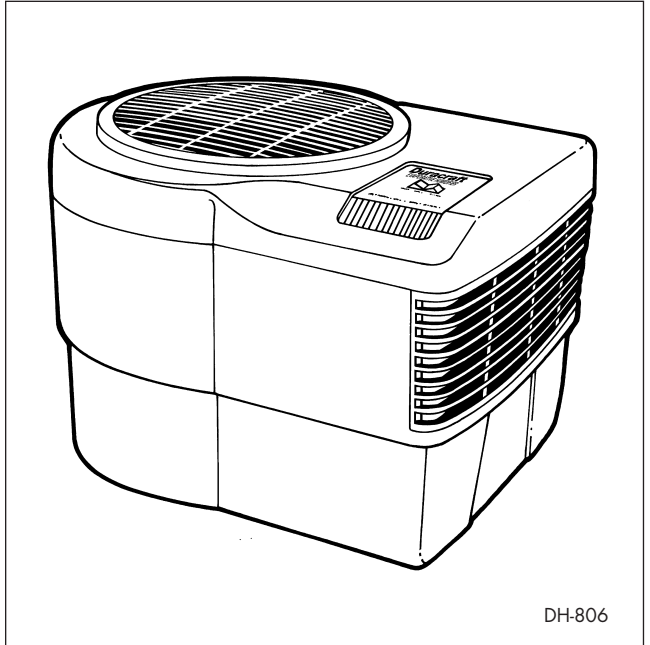

DH-806

## **OWNER'S MANUAL**

**NATURAL COOL  
MOISTURE™ HUMIDIFIER**  
With Humidistat

Models DH-803/DH-804/DH-805/DH-806

## IMPORTANT SAFETY INSTRUCTIONS

**READ ALL INSTRUCTIONS BEFORE USING THIS HUMIDIFIER AND SAVE THESE IMPORTANT INSTRUCTIONS FOR EASY REFERENCE.**

**WHEN USING ANY ELECTRICAL APPLIANCE, BASIC SAFETY PRECAUTIONS SHOULD BE FOLLOWED INCLUDING:**

1. Always place this humidifier on a firm, flat, and level surface. It may not work properly on an uneven surface.
2. Place this humidifier in an area where it is not accessible to children.
3. Do not place the humidifier near any heat sources such as stoves, radiators and heaters.
4. Before using the humidifier, check the power cord for any signs of damage. If the cord is found to be damaged, **DO NOT USE** and return the humidifier to Duracraft under the warranty agreement for repair.
5. This product is equipped with a polarized AC-line plug (a plug having one blade wider than the other). This plug will fit into the power outlet only one way. **This is a safety feature. NEVER** connect the humidifier to any power source other

than a 120V AC polarized outlet. If you are unable to insert the plug fully into the outlet, try reversing the plug. If the plug should still fail to fit, contact an electrician to replace the obsolete outlet.

**DO NOT defeat the safety purpose of the polarized plug.**

6. The humidifier should always be unplugged and emptied when not in operation or while being serviced or cleaned.
7. Never tilt or attempt to move the humidifier while it is operating or filled with water. **UNPLUG** the humidifier before moving.
8. This humidifier requires regular cleaning. Refer to the **CLEANING** instructions provided. Never clean the humidifier in any manner other than as instructed in this manual.
9. Turn the humidifier **OFF** if the relative humidity exceeds 60%, or if you notice moisture on the inside of your windows. For proper humidity readings use a hygrometer which is available in many hardware and department stores, or by ordering one from Duracraft (see Replacement Parts and Care Products).

# INTRODUCTION

Thank you for purchasing a DURACRAFT® NATURAL COOL MOISTURE™ HUMIDIFIER .

Before using your humidifier, we would like to explain the benefits of maintaining your home or office at the proper humidity level.

## HEALTH

Your body needs moisture to stay healthy and comfortable. Dry air can be damaging and irritating. The Duracraft® Natural Cool Moisture™ Humidifier can help relieve:

- Dry, itchy skin and chapped lips.
- Cold symptoms and congestion.
- Dry, scratchy throat and coughs.

For serious medical conditions, always consult your physician prior to use.

## ENVIRONMENT

Maintaining the proper moisture level in your home or office with your Duracraft® Natural Moisture™ Humidifier will also:

- Replace needed moisture in furniture.
- Keep indoor plants moist and healthy.
- Eliminate cracking and dryness in wood furniture and fixtures.
- Minimize static electricity.

## HOW DOES IT WORK?

Dry air is pulled through the Natural Cool Moisture™ system and a quiet fan disperses invisible moisture-balanced air. Unwanted minerals and bacteria from the water are trapped inside the Natural Cool Moisture™ filter. There is no “mist” or excessive condensation emitted.

The Duracraft® exclusive Automatic Moisture Balance System™ increases moisture output when the air is dry and lowers the moisture output when the humidity level is high. This automatically adjusts the output for maximum comfort and helps prevent condensation.

## SET UP

- Select a firm, level, flat location—at least six inches (15 cm) from any wall for proper air flow and convenient to an electrical outlet.
- Place the humidifier on a water-resistant surface, as water can damage furniture and some flooring. **Duracraft will not accept responsibility for property damage caused by water spillage.**

## FILLING

- We recommend that the humidifier be disinfected prior to first use. Please see **CLEANING** instructions.
- Remove the upper motor housing from the reservoir base, being careful not to let the power cord drop into the base. Set aside. (Figure 1).

Fig. 1

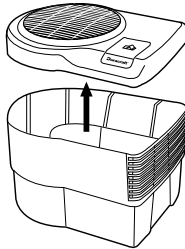

- Remove the Natural Cool Moisture™ filter from its frame in the reservoir base. (Figure 2). Run it under cold water; this will help reduce residue buildup. Turn the filter upside down before repositioning it in its frame. Replace in the humidifier.

Fig. 2

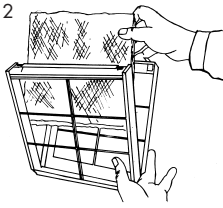

To help extend the life of your filter, repeat this step every time you fill your humidifier.

- Fill the reservoir base with COOL tap water up to the FULL WATER LEVEL (center hub).

**DO NOT OVERFILL.**

Distilled water is not necessary as the water is filtered by the Natural Cool Moisture™ filter. **DO NOT USE HOT WATER.**

- Place the upper motor housing back into position on the water-filled, reservoir base.

- **DO NOT** attempt to move the humidifier. If it has to be moved, unplug the humidifier first.

**NOTE: DO NOT POUR WATER INTO THE GRILL ON THE TOP OF THE UPPER MOTOR HOUSING. DOING SO MAY DAMAGE THE HUMIDIFIER OR CAUSE PERSONAL INJURY.**

## OPERATION

• With the moisture output power switch in the OFF position, plug the filled humidifier into a polarized 120V outlet.

**DO NOT FORCE THE POLARIZED PLUG INTO THE OUTLET;** it will only fit one way.

**CAUTION: DO NOT PLUG IN THE HUMIDIFIER WITH WET HANDS AS AN ELECTRIC SHOCK COULD OCCUR.**

### MODEL DH-805

- Slide the Humidity Level knob to HIGH.
- Set the moisture output control to the desired position:– HIGH for fast humidifying or NORMAL for quieter operation.

**NOTE: IF THE HUMIDIFIER FAN WILL NOT START OR RESTART WHEN YOU SELECT A FAN SPEED, THE HUMIDISTAT MAY BE SET TOO LOW. MOVING THE HUMIDITY LEVEL KNOB TO A HIGHER SETTING SHOULD START THE FAN.**

• The length of time your humidifier runs will vary depending on the quality of construction and insulation of your room or house, as well as the fan speed.

• Adjust the round air outlet grill on the top of the upper motor housing (above the fan) to direct moisture in the desired direction. **DO NOT** aim the moisture flow toward furniture or walls that could be damaged by excessive moisture.

• When a comfortable humidity level is reached, lower the Humidity Level (Humidistat) setting slowly until the fan stops. The Humidistat will automatically restart the fan each time the humidity level falls below this setting. This "ON/OFF" cycle will continue periodically while the humidifier is in use.

• Lower the Humidity Level setting if condensation forms on walls or windows.

Turn the Humidifier OFF or lower the Moisture Output

Setting if condensation forms on walls or windows.

• **ALWAYS** be sure to discard any unused water in the base each time you refill the water tank or finish using the humidifier.

### MODELS: DH-803, 804, 806

• Set the moisture output control to the desired position:– HIGH for fast humidifying or NORMAL for quieter operation.

**For Model DH-806 simply turn on the humidifier.**

• The length of time your humidifier runs will vary depending on the quality of construction and insulation of your room or house, as well as the fan speed.

• Adjust the round air outlet grill on the top of the upper motor housing (above the fan) to direct moisture in the desired direction. **DO NOT** aim the moisture flow toward furniture or walls that could be damaged by excessive moisture.

- Turn the Humidifier OFF or lower the Moisture Output Setting if condensation forms on walls or windows.

## HUMIDISET® REMOTE HUMIDISTAT

**NOTE: You may upgrade your humidifier with the HumidiSet® remote humidistat from Duracraft®. HumidiSet® will automatically maintain your desired humidity level by turning the humidifier on and off as needed. See Replacement Parts and Care Products.**

## FOR MODEL DH-803 ONLY

Use the water level indicator window on the front of the humidifier to determine when to refill your humidifier.

## FOR MODELS DH-804 AND DH-805

The humidifier will automatically shut off when it is empty. Refill when the REFILL light glows.

- ALWAYS be sure to discard any unused water in the base each time you refill the water tank or finish using the humidifier.

## CLEANING

We recommend that you clean the humidifier once a week, or more often if you:

- have hard water,
- notice a build-up of impurities, or
- detect unpleasant odors.

Using DuraSept™ Humidifier Bacteriostatic Treatment (#AC-802) will help control the growth of bacteria, algae, and odors and help extend the life of the Natural Cool Moisture™ filter.

**NOTE: THE USE OF OTHER WATER TREATMENT PRODUCTS MAY CAUSE DETERIORATION OF THE FILTER OR DAMAGE THE HUMIDIFIER, THEREBY, HINDERING THE HUMIDIFIER'S EFFECTIVENESS.**

**DO NOT USE SOAP, DETERGENTS, OR ABRASIVE CLEANSERS.**

Cleaning involves two steps: **SCALE REMOVAL** and **DISINFECTING**. Be sure to perform these in the proper order to avoid harmful chemical interactions.

- First, turn off and unplug the humidifier.
- Lift the upper motor housing off the reservoir base; remove the Natural Cool Moisture™ filter from its frame. Set aside. (Figure 3).
- Discard any residual water from the base.

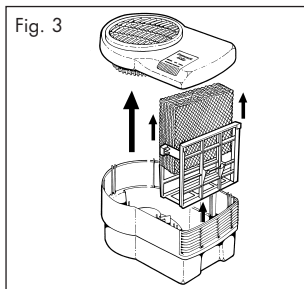

## **Step One: WEEKLY SCALE REMOVAL**

### **(Reservoir Base)**

- Fill the reservoir base with DuraRinse™ Humidifier Cleaner (#AC-816), following bottle instructions, or one 8-oz. (250 ml.) cup of undiluted white vinegar. Let solution stay for 20 minutes.

- With DuraRinse™ or vinegar still in the unit, clean all interior surfaces of the base with a soft brush or cloth to remove scale.

- Rinse reservoir base thoroughly with clean, warm water to remove scale and cleaning solution.

## **Step Two: WEEKLY DISINFECTING (Reservoir Base)**

- Be sure the reservoir base is empty. Fill with 1 teaspoon chlorine bleach in 1 gallon (4 litres) water. Let solution stay 20 minutes, swishing every few minutes to wet all surfaces.

- Empty reservoir base after 20 minutes. Rinse with water until bleach smell is gone.

## **AFTER DISINFECTING...**

- Clean all surfaces of the upper motor housing with a dry, soft cloth. **DO NOT USE WATER TO CLEAN THE UPPER MOTOR HOUSING. THIS MAY DAMAGE THE HUMIDIFIER OR CAUSE ELECTRIC SHOCK.**

- If you have hard water you may need to clean or change the filter more often. If the filter is dirty, rinse it under cold tap water and turn the filter upside down before repositioning in the frame. Do not squeeze or wring out pad. Do not soak pad in bleach or vinegar.

When the filter turns dark brown, replace it. Using DuraSept™ Humidifier Bacteriostatic Treatment will help extend the life of the filter. For best and proven results, always use Duracraft® Natural Cool Moisture™ filters available from your local store or from Duracraft.

- Reposition the filter and frame in the reservoir base.

- Reposition the upper motor housing on the reservoir base.

**NOTE: THE FAN MOTOR OF THIS HUMIDIFIER AND THE NATURAL COOL MOISTURE™ FILTER ARE DESIGNED TO FUNCTION EFFICIENTLY AS A SET. USING ANY OTHER FILTER COULD DAMAGE THE HUMIDIFIER'S MOTOR OR IMPAIR ITS PERFORMANCE.**

## **END-OF-SEASON CARE AND STORAGE**

- Follow weekly CLEANING instructions at end of humidification season or when humidifier will not be used for at least one week or more.

- Remove and throw away filter; do not store with a used filter.

### **SAVE THE FILTER FRAME FOR USE WITH YOUR REPLACEMENT FILTER PAD.**

- Let the humidifier dry completely before storing. Do not store with water inside the reservoir base.

- Pack the unit in its original carton and store in a cool, dry location.

- Remember to install a new filter and clean the humidifier at the start of the next humidification season.

## ELECTRICAL RATINGS

DH-803, DH-806 are rated 0.20 amps at 120V, 60 Hz.

DH-804, DH-805, are rated 0.45 amps at 120V, 60 Hz.

**NOTE: IF YOU EXPERIENCE A PROBLEM WITH YOUR HUMIDIFIER'S UPPER MOTOR HOUSING, PLEASE SEE THE WARRANTY FOR INSTRUCTIONS. PLEASE DO NOT ATTEMPT TO OPEN OR REPAIR THE HUMIDIFIER**

**YOURSELF. DOING SO WILL VOID THE WARRANTY AND COULD CAUSE DAMAGE OR PERSONAL INJURY. IF THE PROBLEM STILL PERSISTS, PLEASE CALL:**

DURACRAFT CORP.  
CUSTOMER SERVICE  
DEPARTMENT

TOLL FREE: 1-800-554-4558

Business Hours:  
Monday – Friday  
8:00 AM – 10:00 PM (EST)

Saturday, Sunday  
8:30 AM – 5:00 PM (EST)

Mail questions or comments to:

DURACRAFT CORP.  
Customer Service Dept.  
250 Turnpike Road  
Southborough, MA  
01772  
U.S.A.

**Please be sure to specify model number.**

## CARE PRODUCTS

**Model AC-802 — DuraSept™ Humidifier Bacteriostatic Treatment** helps control the growth of bacteria and algae in your humidifier and helps prevent unpleasant mildew odors. It can also help extend the life of the Natural Cool Moisture™ Filter. **For best results, DuraSept™ should be added every time you fill your humidifier.**

**Model AC-816 — DuraRinse™ Humidifier Cleaner** helps soften lime scale and mineral deposits when cleaning the Natural Cool Moisture™ Humidifier. DuraRinse™ should be used whenever you begin to notice discoloration in the humidifier's reservoir or water tank.

**Model AC-817 — DuraFree™ Humidifier Water Softener** softens hard water impurity

deposits in the reservoir and on the Natural Cool Moisture™ Filter so they can be easily rinsed away.

**Model AC-850 — Humidifier Complete Care Kit** A complete care kit for your Natural Cool Moisture™ Humidifier, including one 32-oz. (946 ml) bottle of each of the above products: DuraSept™, DuraRinse™ and DuraFree™.



## LIMITED WARRANTY

### 3 Year Limited Warranty

#### DURACRAFT® NATURAL COOL MOISTURE™ HUMIDIFIER

This product has been engineered and crafted with great care for your satisfaction.

Please read all instructions before attempting to use this product. **Be sure to fill out and return the enclosed card within 7 days of purchase.**

A. This warranty applies to repair or replacement of product found to be defective in material or workmanship. This warranty does not apply to damage resulting from commercial, abusive, unreasonable use or supplemental damage. Defects that are the result of normal wear and tear will not be considered manufacturing defects under this warranty. Duracraft is not liable for incidental or consequential damages of any nature. Any implied warranty of merchantability or fitness for a particular purpose on this product is limited in duration to the duration of this warranty. Some regions do not allow the exclusion or limitation of incidental or consequential damages, or limitations on how long an implied warranty lasts, so the above limitations or exclusions may not apply to you. This warranty gives you specific legal rights, and you also may have other rights which vary from region to region. This warranty applies only to the original purchaser of this product.

B. At its option Duracraft will repair or replace this product if it is found defective in material or workmanship. Defective product should be returned directly to Duracraft.

C. This warranty does not cover damage resulting from any unauthorized attempts to repair or from any use not in accordance with this manual.

D. Return defective product to the following address with a brief description of the problem. Include proof of purchase and a U.S. \$10.00/Can. \$13.50 check or money order for handling (Models DH-803, DH-804, DH-805), or U.S. \$8.00/Can. \$11.00 (Model DH-806), return packing and shipping charges. Please include your name, address and a daytime phone number. You must prepay shipping charges. Mark carton **"Attention Repair Department."** Ship to

Duracraft Corp.  
Southpoint Distribution Center  
4755 Southpoint Drive  
Memphis, TN 38118  
U.S.A.

**NOTE: THIS WARRANTY DOES NOT COVER THE NATURAL COOL MOISTURE™ FILTER, WHOSE PERFORMANCE WILL DEPEND UPON THE CONDITION OF THE WATER USED IN THE HUMIDIFIER.**

**Duracraft®**

250 Turnpike Road, Southborough, MA 01772