

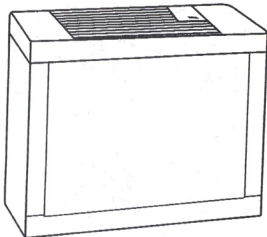

Evaporative Humidifier Information



MODELS

497 300*	Light Oak Variable-Speed with Air Care® Filter	427 300*	Light Oak Two-Speed with Air Care® Filter
496 800*	Vanilla Variable-Speed	426 700	Taupe Two-Speed
496 600	Dark Gray Variable-Speed	426 300	Light Oak Two-Speed
436 300*	Light Oak Three-Speed		



* Model numbers changed as of May 1996. Formerly 4973, 4968, 4363 and 4273 respectively.

Bemis Manufacturing Company, 300 Mill Street, Sheboygan Falls, WI 53083, 920-447-4621, Fax 920-447-8573



ITEM	DESCRIPTION	QTY	MODEL 496 800	MODEL 497 200	MODEL 498 200	MODEL 417 300	MODEL 499 400	MODEL 426 200	MODEL 426 300
1	Door Spring	1	None	546090*	546090*	546090*	None	None	None
2	Control Panel Door	1	34830200AN	34830200BN	34830200BN	34830200BN	34830200GR	34830200AU	34830200BN
3	Humidistat Knob	1	5060430	5060620*	5060620*	5060615*	5060630	5060630	5060630
4	Speed Switch Knob	1	5060430	5060620*	5060620*	5060630	5060630	5060630	5060630
5	Control Panel Decal	1	5461290	5461290*	5461290*	5461290*	5461290*	5461290*	5461290*
6	Right Lamp	1	5560260	5560423*	5560423*	5560320	5560320	5560310	5560310
7	Left Lamp	1	5560540	5560710*	5560710*	5560520	5560520	5560520	5560560
8	Shield	1	3488001BLK	3488001BLK	3488001BLK	3488001BLK	3488001BLK	3488001BLK	3488001BLK
9	Humidistat	1	5560660	5560910*	5560910*	5560910*	3488001BLK	3488001BLK	3488001BLK
10	Humidistat Screw	2	5461810	5461810*	5461810*	5461810*	5461810	5461810	5461810
11	Speed Switch Screw	2	None	5461780*	5461780*	5461780*	None	None	None
12	Speed Switch	1	5560080***	5560080***	5560130**	5560130**	5560080***	5560110	5560110
13	Chassis	4	5462000	5462000	5462000	5462000	5462000	5462000	5462000
14	Chassis	1	34860020RLK	3486001BLK*	3486001BLK*	3486001BLK*	3486001BLK*	3486001BLK*	34860020RLK
15	Right Angle Lead	1	None	5560910*	5560910*	5560910*	None	None	None
16	Straight Lead	1	5561080	5560940*	5560940*	5560940*	5561080	5561080	5561080
17	Shunt Lead	1	None	None	5561100	5561100	None	5561000	5561000
18	Fan Blade	1	5060250	5060250*	5060250*	5060250*	5060250	5060250	5060250
19	Wicking Filter	1	1041	1041	1041	1041	1041	1041	1041
20	Cabinet	1	3487001VAN	3487001LBR	3487001LBR	3487001LBR	3487001DGR	3487001AU	3487001LBR
21	Filter Hose	1	5560140	5560140	5560140	5560140	5560140	5560140	5560140
22	Center XR (4-Pcs.)	1	5461000	5460960*	5460960*	5460960**	5461000	5461000	5461000
23	Center Screw	16	None	5461000*	5461000*	5461000*	None	None	None
24	Air Filter	1	None	1051	None	1051	None	None	None
25	Roller Springs	2	5460980	5460980	5460980	5460980	5460980	5460980	5460980
26	Bottle Cap	2	5060300	5060300	5060300	5060300	5060300	5060300	5060300
27	Bottle	2	5060110	5060110	5060110	5060110	5060110	5060110	5060110
28	Motor Wad	4	5461380	5461380	5461380	5461380	5461380	5461380	5461380
29	Motor Washer	4	None	5460750*	5460750*	5460750*	None	None	None
30	Switch Knob	2	WHM15	WHM16	WHM16	WHM16	WHM15	WHM15	WHM15
31	Microswitch	2	5560250	5560250	5560250	5560250	5560250	5560250	5560250
32	End Cover	2	3481001VAN	3481001DGR	3481001DGR	3481001DGR	3481001DGR	3481001AU	3481001DGR
33	Plug Receptacle	1	5560210	5560250*	5560250*	5560250*	5560210	5560210	5560210
34	Plug Receptacle Screw	2	5461810	5461810*	5461810*	5461810*	5461810	5461810	5461810
35	Motor	1	5560410	5560413*	5560412**	5560413***	5560410	5560410	5560410
36	Cord	1	5560380	5560380	5560380	5560380	5560380	5560380	5560380
37	Grille	1	34830200VAN	34830200BN	34830200BN	34830200BN	34830200GR	34830200AU	34830200BN
38	Neutral Lead	1	5561100	5561100	5561100	5561100	5561100	5561100	5561100
39	Connector	1	5561050	5561050	5561050	5561050	5561050	5561050	5561050
40	Retainer Clip	1	5460620	5460620	5460620	5460620	5460620	5460620	5460620
41	Common Jumper Lead	1	None	None	None	None	None	None	None
42	Power Jumper Lead	1	None	None	None	None	None	None	None

- 1* Door Spring not required after 6/01/96 production
2* Humidistat Knob - Units made after 6/01/94 use 5060250
3* Right lamp - Units made after 7/01/95 use 5560540
4* Left lamp - Units made after 7/01/95 use 5560548
5* Humidistat - Units made after 6/01/94 use 5560660
9* Humidistat screw - Units made after 6/01/94 use 5461810, also required with all 5560660 humidistats
11* Speed switch screw not required on units made after 7/01/95
12* Speed switch - units made after 6/01/94 use 5560110
12*** Speed switch - Units made after 6/01/91 use 5560143
12**** Speed switch - Units made after 10/01/97 use 5560620 Variable Speed Control
14* Chassis - Units made after 7/01/95 use 34860020RLK
15* and 15** Lamps - Units made after 7/01/95 use 5561050 Combined lead assembly
18* Fan Blade - Units made after 7/01/95 use 5060250 in place of 5060250 and 5060250 in place of 5060280
22* Center - Units made after 6/01/94 use 5461000
23* Center screw not required with 5461000 center
29* Motor Washer not required after 6/01/94
33* Receptacle - Units made after 7/01/95 use 5560210 with 5561100 lead
34* Receptacle screw - Units made after 7/01/95 use 5461810
35** Motor - Units made after 7/01/95 use 5560410 motor with 5060350 fan blade
35*** Motor - Units made after 7/01/95 use 5560640 motor with 5060350 fan blade
38 Lead and 39 Connector are required after 7/01/95
40 Retainer clip is required with each replacement fan blade (F18)
41 and 42 Model 496 800 only - 1996 Production only (not shown)

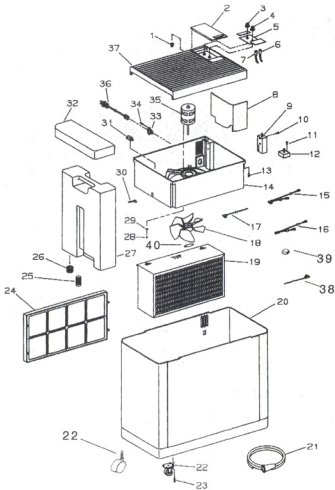

Wiring Schematic

MODEL SERIES 49XX
VARIABLE SPEED

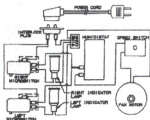

MODEL SERIES 41XX
ONE SPEED

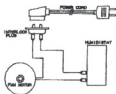

MODEL SERIES 42XX
TWO SPEED

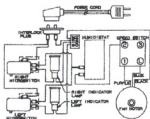

MODEL SERIES 43XX
THREE SPEED

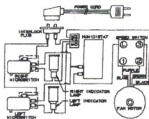

Bemis Manufacturing Company
300 Mill Street
Shoboygan Falls, WI 53085