

This Owner's Manual is provided and hosted by [Appliance Factory Parts](#).

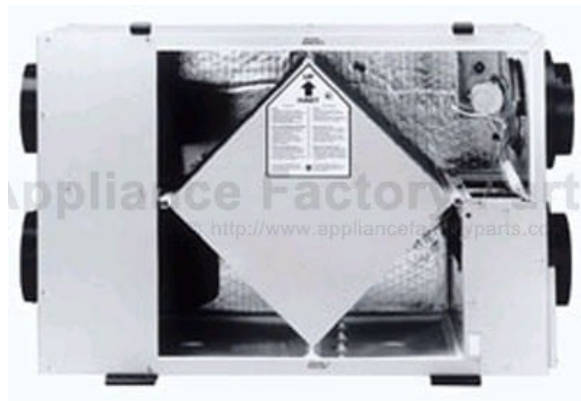

BROAN ERV100HC Owner's Manual

[Shop genuine replacement parts for BROAN
ERV100HC](#)



[Find Your BROAN Air Cleaner Parts - Select From 37 Models](#)

----- Manual continues below -----

ERV100HC FRESH AIR SYSTEM

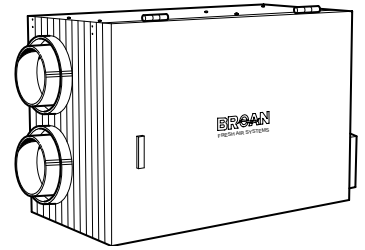

Your Fresh Air Solution for Mild, Humid Climates

FEATURES

- Best airflow, sensible energy recovery, and latent energy recovery of its class / The enthalpic core will slow the moisture transfer between the outdoor and indoor environments, tempering the air*. This innovative technology reduces moisture that enters the house during the summer. Enjoy the benefits of fresh air to dilute contaminants without an energy penalty.
- Durability, reliability and performance are the features that you will find with the Broan Energy Recovery Ventilators (ERV) / For contractors who want added value, quality, and best performance.
- Smart Defrost system / Failure protection system to prevent cold air from entering the house.
- Easy to service / All parts removable in 5 minutes, with electrical access on side panel.

GENERAL SPECIFICATIONS

- For houses from 4,501 to 7,500 sq. ft.
- 64 to 152 cfm (0.3 in. w.g.)
- 60 to 142 cfm (0.4 in. w.g.)
- Voltage: 120 VAC
- Frequency: 60 Hz
- Dimensions: 21.1" x 34.6" x 13.25"
- Weight: 65 lbs
- Shipping Weight: 75 lbs
- Warranty: 2 years on parts - 5 years on core
- HVI Rated of air flow: 169 cfm
- Power Consumed (max): 150 Watts
- Supply air duct connections: 6" diameter
- Exhaust air duct connections: 6" diameter
- Filter: 30 ppi washable reticulated foam
- Cabinet: 20 ga. Pre-painted steel
- Mounting: Suspension by chains and springs
- Wall control modes: N/A
- Power: 147 Watts
- Current: 1.4 Amps
- Continuous duty, permanently lubricated motors
- 36" power cord

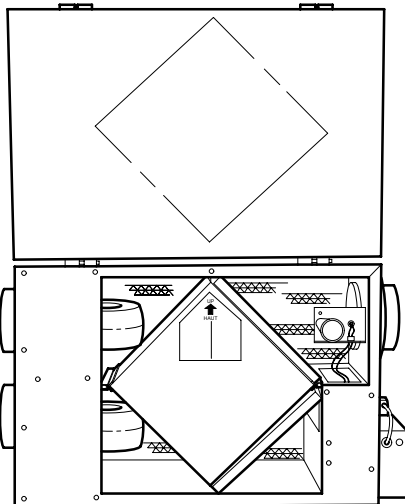

*The ability to slow the moisture transfer depends on the outdoor humidity condition

Broan-NuTone LLC Hartford, Wisconsin www.broan.com 800-558-1711

REFERENCE	QTY.	REMARKS	Project
			Location
			Architect
			Engineer
			Contractor
			Submitted by Date

MODEL ERV100HC

PERFORMANCE SPECIFICATIONS

Ventilation Performance							
External Static Pressure		Net Supply Airflow		Gross Airflow			
				Supply		Exhaust	
Pa	In. W.g.	L/s	cfm	L/s	cfm	L/s	cfm
25	0.1	81	173	87	184	93	197
50	0.2	78	165	83	175	86	182
75	0.3	72	152	76	162	80	169
100	0.4	62	142	71	151	77	103
125	0.5	55	117	59	124	67	143
150	0.6	46	98	49	104	56	118
175	0.7	36	77	39	82	41	87
200	0.8	30	63	32	67	24	51

Note: Unit operating at maximum speed.



Energy Performance								
	Supply Temperature		Net Airflow		Average Power	Sensible Recovery Efficiency	Apparent Sensible Effectiveness	Latent Recovery Moisture Transfer
	C	F	L/s	cfm	Watts	%	%	
Heating	0	32	29	60	56	71	79	0.52
	0	32	47	100	80	64	73	0.41
	0	32	65	137	126	60	68	0.36
	-15	5	31	65	64	56	81	0.41
						Total Recovery Efficiency		
Cooling	35	95	28	59	52	45		

INSTALLATION OPTIONS

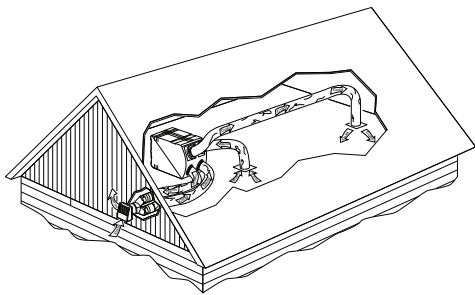

Attic*

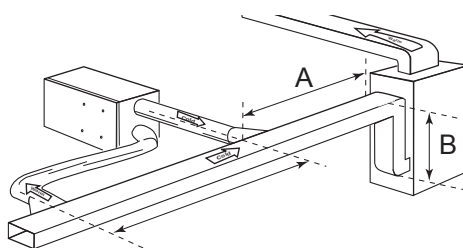

Return-Return Connection

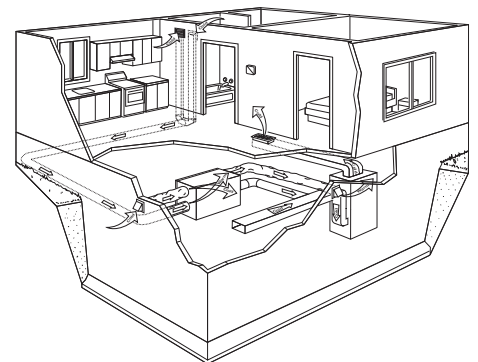

Return Connection - Extended Exhaust

*Contact your broan sales representative for information on attic installation requirements.



Broan-NuTone LLC Hartford, Wisconsin www.broan.com 800-558-1711