

This Owner's Manual is provided and hosted by Appliance Factory Parts.

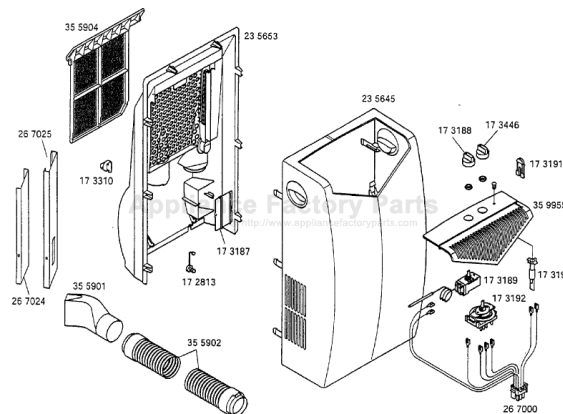

COMFORT-AIRE PAC71 Owner's Manual

[Shop genuine replacement parts for COMFORT-AIRE
PAC71](#)



[Find Your COMFORT-AIRE Air Conditioner Parts - Select From 599 Models](#)

----- Manual continues below -----

PAC 71

INSTALLATION & OPERATIONS MANUAL

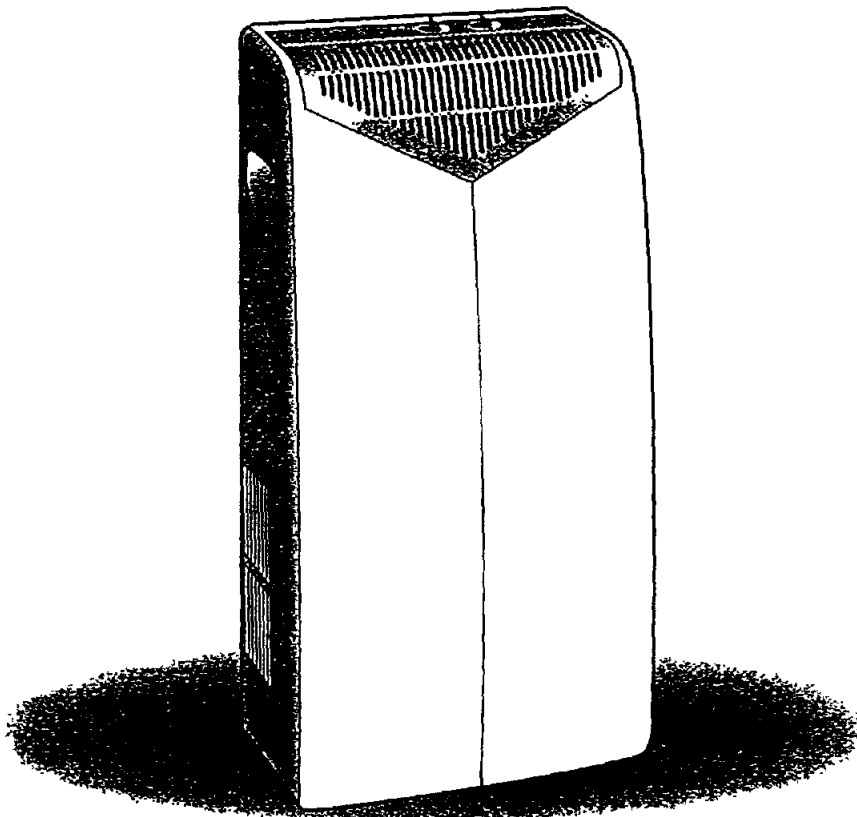

PORTABLE AIR CONDITIONER

*Room Air Conditioner
Acondicionador de Aire
Climatiseur*

*Dehumidifier
Deshumecedor
Déshumidificateur*

*Air Purifier
Purificación de Aire
Epurateur d'air*

*Including Service
Incluido mantenimiento
Avec service*

2000

23-23-0330N-001

INSTALLATION

⚠ WARNING

Electrical Shock Hazard

1. Plug unit only into grounded electrical outlet.
2. Do not use an extension cord or plug adapter with this unit.
3. Do not operate unit with front removed.

Failure to follow the above precautions could result in electrical shock, fire or personal injury.

If the unit has a serial plate rating of 115 volts and up to and including 7.5 amps, the unit may be on a fuse or circuit breaker with other devices. However, the maximum amps of all devices on that fuse or circuit breaker cannot exceed the amps of the fuse or circuit breaker.

The location of the serial plate that applies to this model can be found on the back page of this manual.

Notice

Do not operate this unit without proper time delay circuit protection. Refer to serial plate for proper power supply requirements.

RECOMMENDED CIRCUIT WIRE SIZES (As installed per building code)

PROTECTOR SIZE	WIRE GAUGE
15 AMP	#14 MINIMUM
20 AMP	#12 MINIMUM
30 AMP	#10 MINIMUM

VOLTAGE	AMPERAGE
115V	15A
230V	15A
230V	20A
230V	30A

⚠ WARNING

For Your Safety:

- Do not store or use gasoline or other flammable vapors and liquids in the vicinity of this or any other appliance. The fumes can create a fire hazard or explosion.

Power Supply: 115V, 60 Hz
AC Only, 15A

Outlet Requirement: 3-Prong Grounding Type
125 V, 15 Amp

Minimum Wire Size: #14 (A.W.G.) Wire
Use Copper Wire Only

Circuit Protector: 15 Amp Time Delay Fuse
or Circuit Breaker

1. ELECTRICAL REQUIREMENTS

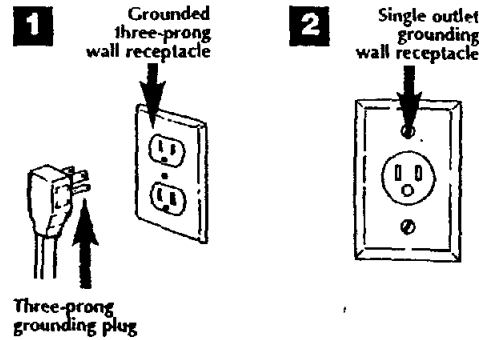

Important Grounding Requirements

Your unit will operate on any 115 volt, 3-pronged (grounded), 60 Hz circuit. A separate line is not required, but it is advisable not to overload the circuit with heavy duty appliances such as washing machines, etc. For your safety, this unit is equipped with a 3-pronged, grounding plug and must be plugged into a properly grounded outlet (Figs. 1 & 2). If your outlet is not of the proper type, it is your responsibility to have the outlet and wiring changed to the correct type. **DO NOT** cut off the third (grounding) prong. **DO NOT USE AN ADAPTER.**

2. BEFORE STARTING YOUR UNIT

Important information

- Read the instruction manual before operating the unit for the first time. It contains important information on operation, safety, maintenance, service and warranty.
- Keep this instruction manual for future reference.
- Do not start a damaged unit.
- The assembly and connection of the unit must be carried out according to the instructions. If they are not followed you run the risk of voiding the warranty.

1. The power cord is located in the rear of the unit.
2. Do not allow contact between the unit and water.
3. Do not cover the air discharge and air intake louvers of the unit.
4. Proper venting of the air to the exterior is required at all times.

After turning off the system wait at least 3 minutes before restarting it.

The unit has casters to ease movement. If it is necessary to tilt the unit, it must first be emptied of water in the internal tank using the drain valve at the bottom of the unit. See the section When transporting the unit or Storing the unit for the season.

3. LIST OF FIGURES

3 Description of Parts on the Portable Cooling Unit

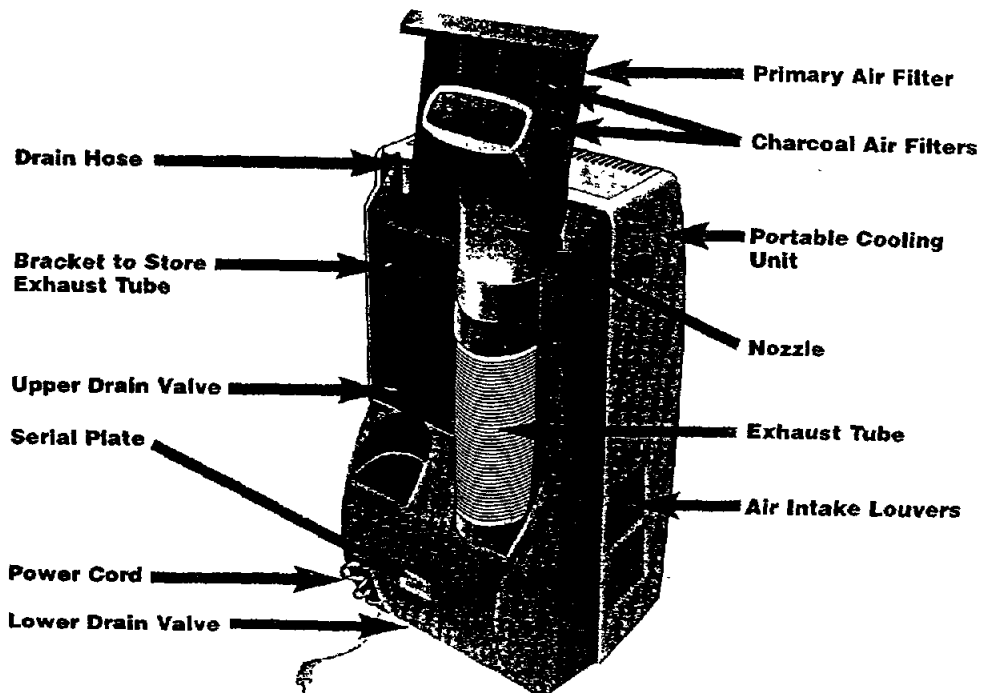

INSTALLATION

4. WINDOW & MOBILE INSTALLATION

4 Window Adapter Application

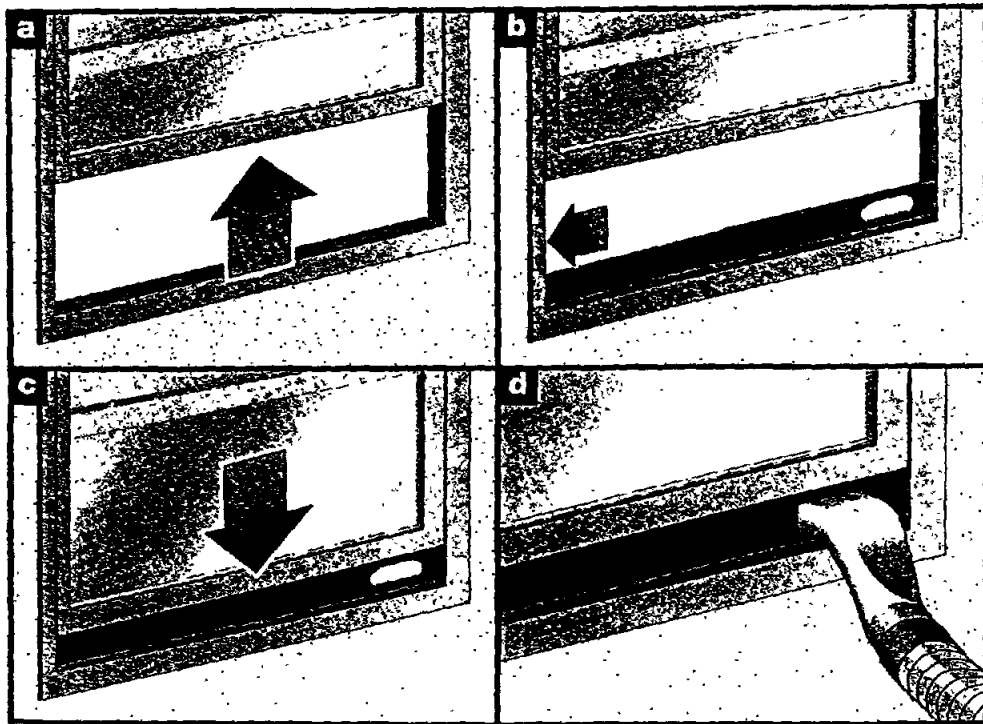

Window Installation

1. Place the nozzle in the exhaust tube.
2. Open the window and place the window adapter in the window, extending it to fit the width of the window, close the window (*Fig. 4*).
3. Secure the window adapter to the window sill.
4. Insert the nozzle into the slot in the window adapter.
5. Select a cooling mode; normal cool or high cool (*Fig. 6*).
6. Adjust the thermostat to the desired temperature setting (*Fig. 6*).
7. Air direction can be adjusted using the handle found on the top of the control panel (*Fig. 6*).

5

Mobile Installation

1. Place the nozzle in the exhaust tube.
2. Open the door slightly and position the nozzle between the door and the door jamb (*Fig. 5*).
3. Select a cooling mode; normal cool or high cool (*Fig. 6*).
4. Adjust the thermostat to the desired temperature setting (*Fig. 6*).
5. Air direction can be adjusted using the handle found on the top of the control panel (*Fig. 6*).

Important: Do not over-stretch the exhaust tube or make any unnecessary bends in it.

5 Cooling Through a Door Application

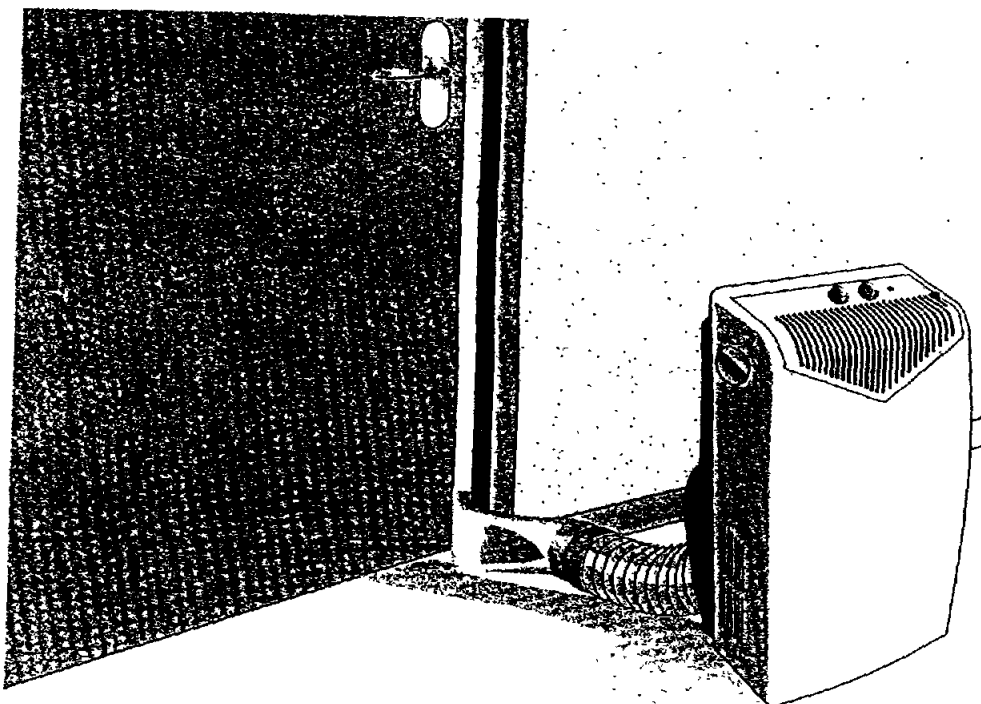

OPERATION

5. CONTROL PANEL

6 Control Panel Display

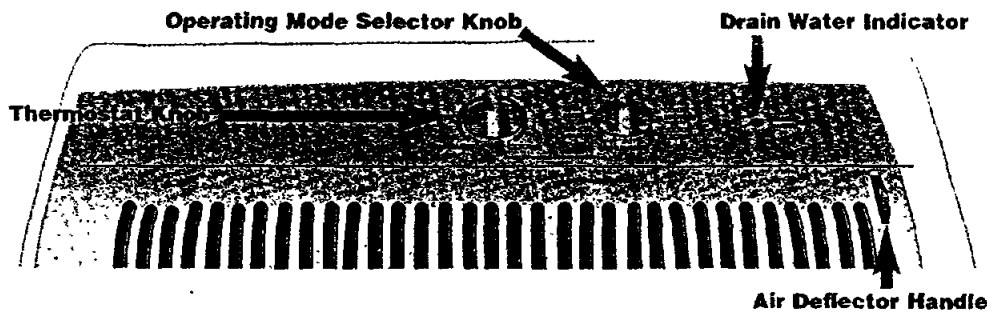

Cooling Mode

- The unit cools and dehumidifies at the same time for more comfort. During the cooling mode condensed water is released to the outside air through the nozzle.
- In conditions of extreme humidity the unit will accumulate condensed water in an internal tank. At that time the red light will turn on indicating that the tank must be emptied. See the section on *Draining the Water*.
- Adjust cooling speed and thermostat setting to suit your comfort requirements.

Dehumidification Mode

In this mode the unit reduces the ambient humidity in the room.

1. Place the nozzle in the exhaust tube.
2. Open the window and place the window adapter in the window, extending it to fit the width of the window. Close the window (Fig. 4).
3. Secure the window adapter to the window sill.
4. Insert the nozzle into the slot in the window adapter.
5. Ensure that the upper drain valve is in the closed position and that the rubber plug is in place (Fig. 7 d).
6. Select the Dehumidifying mode (Fig. 6).
7. If the red light is lit, indicating that the internal bucket is full, follow the recommended water draining procedure.

7

6. DRAINING THE WATER

Draining the water

If the red light is lit, indicating that the internal bucket is full, follow the recommended water draining procedure:

1. The unit must be switched to the off position.
2. Place a container under the upper drain valve and remove the rubber plug from the upper drain valve (Fig. 7 a, b, c).
3. Insert the drain hose on the upper drain valve pointing it into the container.
4. Turn the upper drain valve from the closed position to the open position (Fig. 7 b).
5. Turn the unit on, turn the thermostat to the warmest setting and the switch to a cooling position. The unit will turn on, allowing the pump to run and drain the water from the unit (Fig. 6).
6. When the water stops draining from the unit, turn off the unit.
7. Close the upper drain valve, remove the drain hose, remove the container of water, put the rubber plug back in the upper drain valve (Fig. 7 d).
8. The unit can be turned to any operating mode.

Important: When changing the operating mode back to cooling do not forget to put the rubber plug back in and turn the upper drain valve 90° to the right or to the closed position. If this is not done the water will come out of the unit when it is switched on.

7 Upper Drain Valve

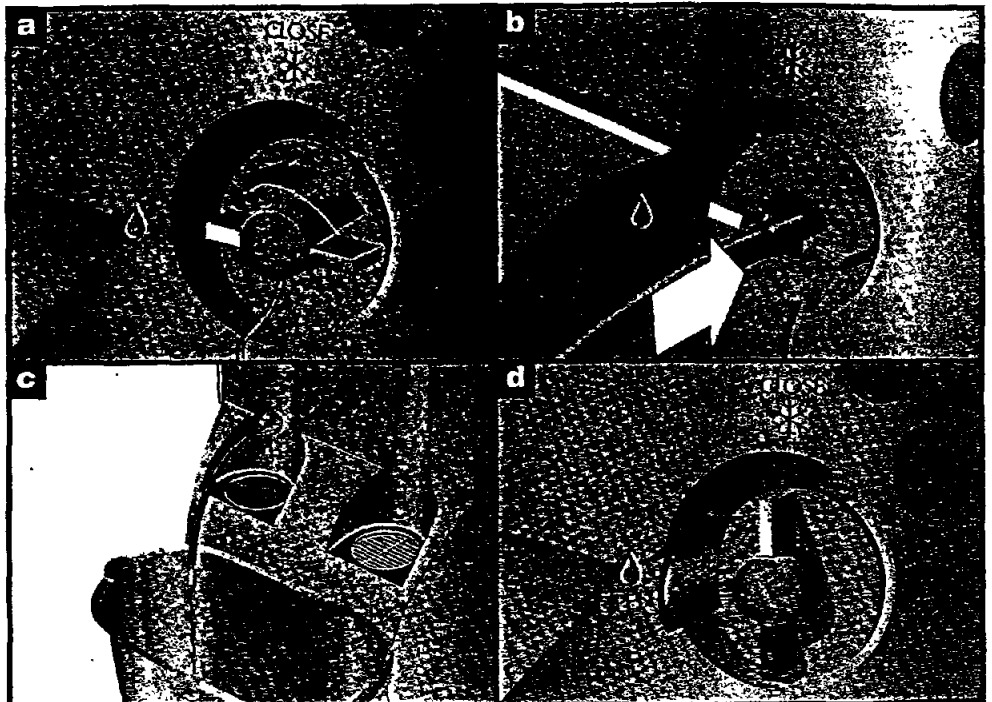

OPERATION

7. VENTILATION

8 Inserting Charcoal Filters

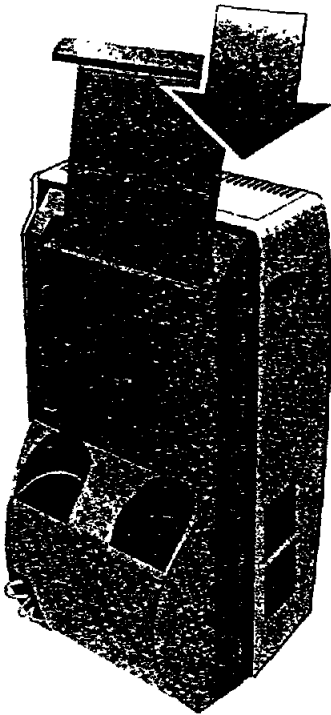

Ventilation mode

In this mode the air is recycled to the interior of the room after passing through the primary air filter or the charcoal filters. The charcoal filters act against odors, bacteria, and dust.

1. To insert the charcoal filters see (Fig. 8).
2. Place the exhaust tube in the same position as the cooling mode for either window or mobile installation.
3. Select the ventilation speed desired; normal or maximum (Fig. 6).

8. CLEANING & MAINTENANCE

9 Cleaning the Filter

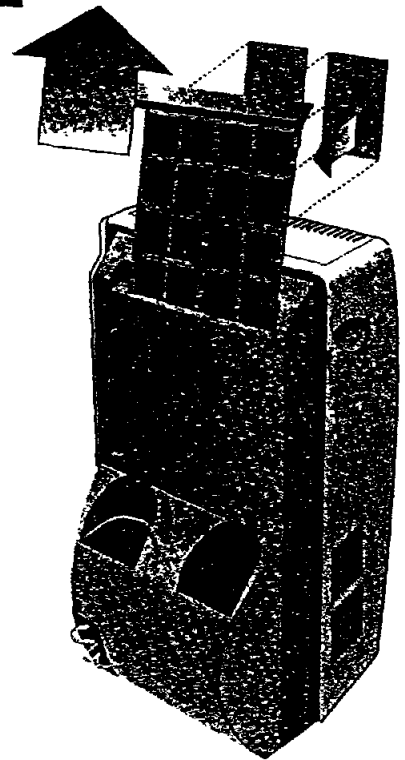

10 Bottom Drain Valve

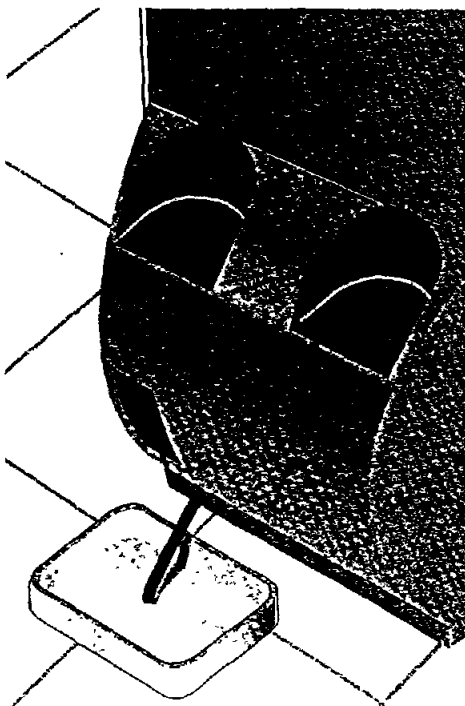

Cleaning and Maintenance

- The unit has a primary air filter that must be cleaned with water every two weeks and put back in the unit after it is completely dry (Fig. 9).
- The charcoal purification filters should be replaced with new every year so that the unit performs well.
- The fitting of the filters should be done as in (Fig. 8).
- Only one set of filters is required on the frame to maintain cooling efficiency.
- The air discharge grille can be cleaned with a rag or sponge, warm water and mild detergent.
- NEVER use hot water, bleach, gasoline, acids, cleaning fluid or a brush to clean the unit. This will damage the cabinet and the air discharge area.
- DO NOT wash the unit with a hose.
- Remove charcoal insert before cleaning primary filter.

Before using at the start of a season

- Turn the unit on for four to five hours to dry it out.
- Clean the air filter.
- Clean the cabinet and air discharge areas if necessary.

When transporting the unit or storing the unit after the season

Drain excess water from the bottom tank by placing a pan under the lower drain, remove the rubber plug, and let the water drain into the pan. When the water stops draining out, replace the lower drain plug and remove the pan of water (Fig. 10). To drain water using the upper drain valve refer to the section entitled "Draining the Water".

SERVICE

Service Instructions

Read carefully before calling for service

If the unit fails to start

- Make sure the unit is plugged into an outlet.
- Make sure the unit is not in the off position.
- Make sure the circuit breaker has not been tripped.

If the unit does not function and the red light is on

- Make sure the unit is standing level, if the light is still on, empty the internal water tank.
(See the section on *Draining Water*).

If the unit does not cool sufficiently

- Make sure the exhaust tube and nozzle fit correctly to each other and to the window adapter.
- Make sure the exhaust tube is not bent.
- Make sure the upper drain valve is in the closed position.
- Adjust the thermostat to a lower temperature.
- Make sure the exhaust tube and nozzle have nothing inside them.

If the unit is too loud

- Make sure the exhaust tube and nozzle fit correctly to each other and to the window mount.
- Make sure the exhaust tube and nozzle have nothing inside.

PAC - 71

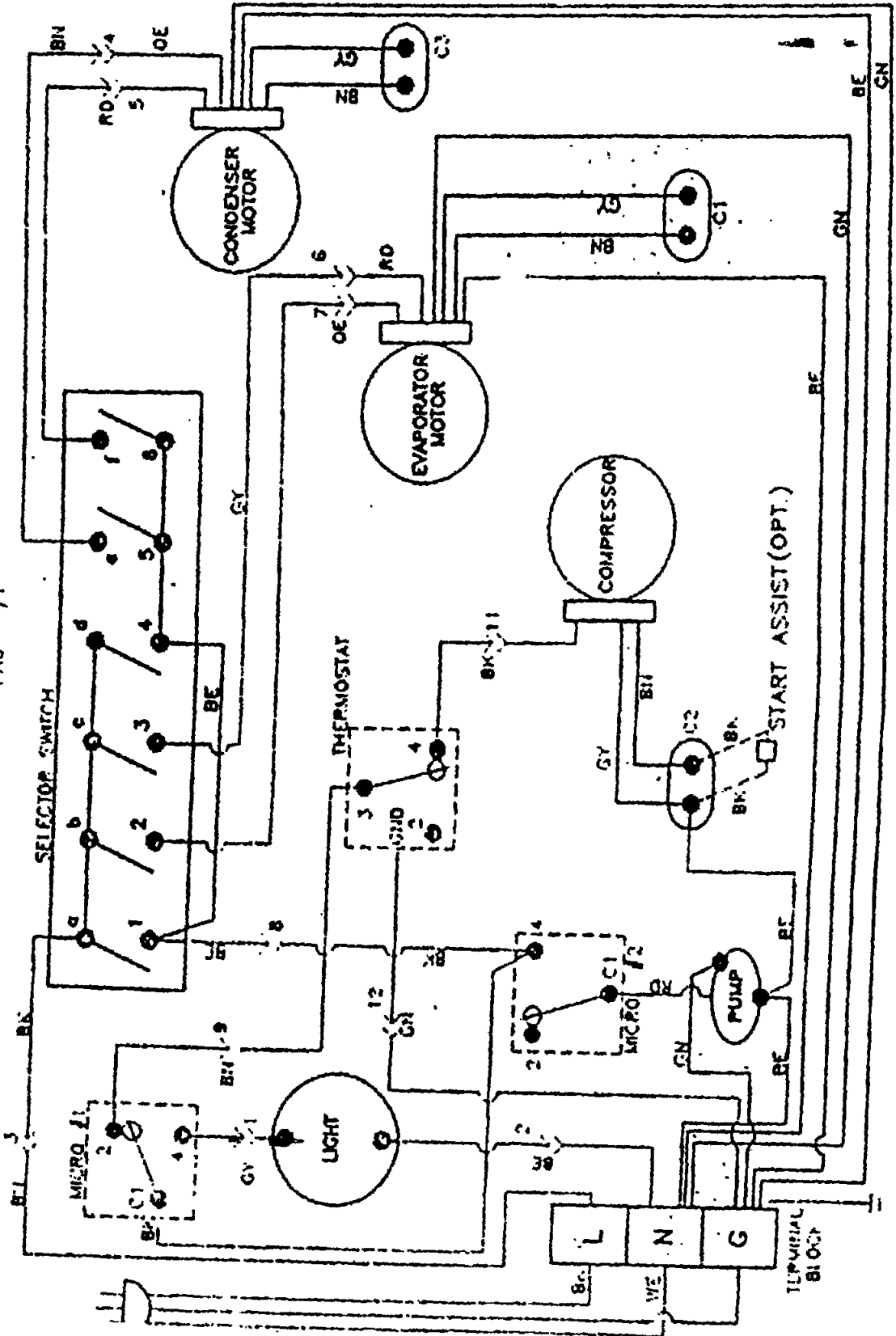

88-03-08088-069