

HEAT CONTROLLER, INC.

Comfort-Care®

Room Air Conditioner

**MODELS: RAD-101A
RAD-81A**



Replacement Parts List

Exploded View

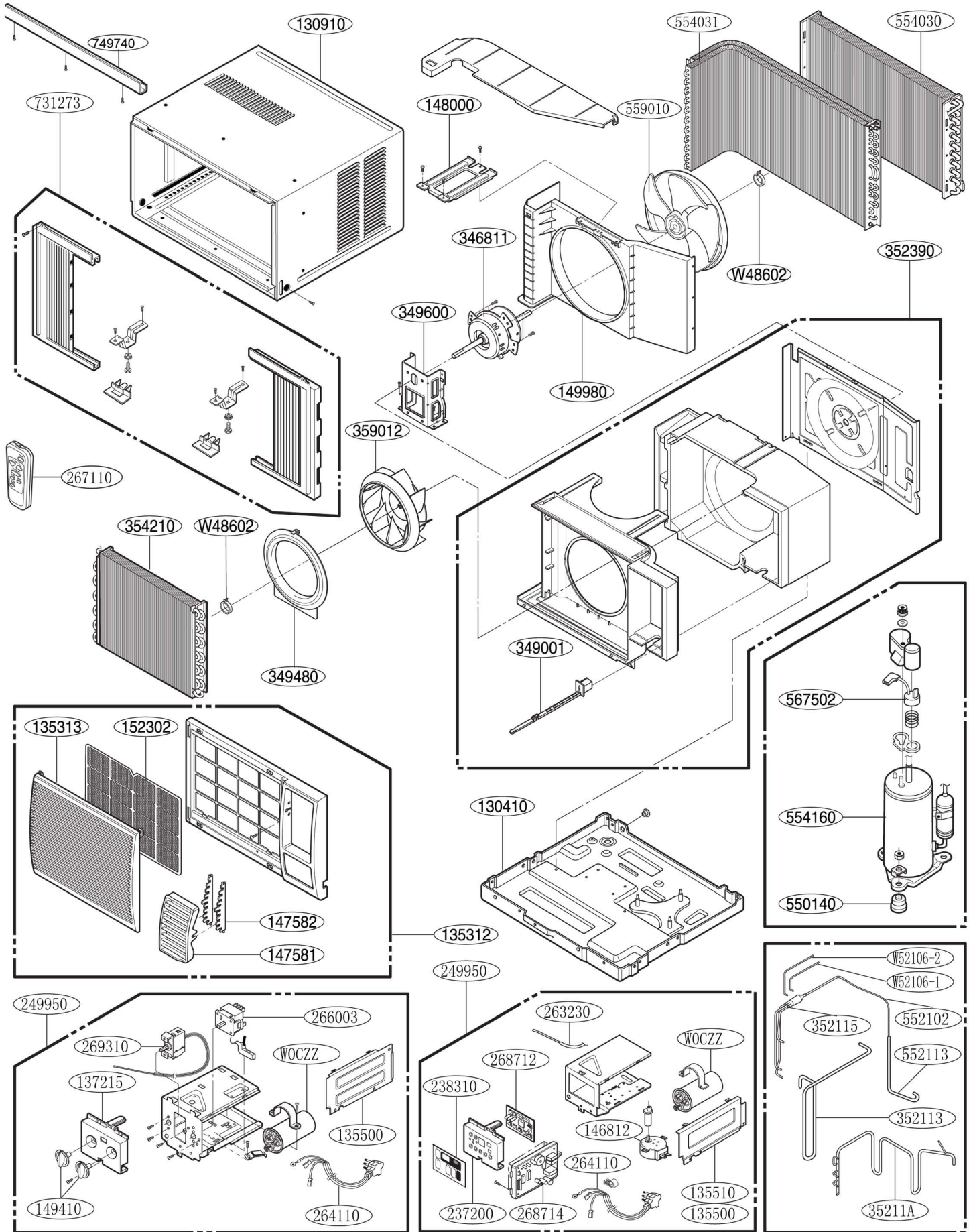

Replacement Parts List

LOCATION NO	DESCRIPTION	PART NO	
		RAD-81A	RAD-101A
130410	BASE ASSEMBLY, SINGLE	3041A30011D	3041A30005P
130910	CABINET ASSY, SINGLE	3091A30005R	
135312	GRILLE ASSY, FRONT (SINGLE)	3531A29018B	
135313	GRILLE ASSY, INLET	3530A10027A	
135500	COVER, CONTROL (INDOOR)	3550A30036B	
749740	UPPER GUIDE CABINET	5210AR3196F	
147581	LOUVER, HORIZONTAL	4758A20002A	
147582	LOUVER, VERTICAL	4758A30008A	
149980	SHROUD	4998A10019A	4998A10010A
152302	FILTER (MECH), A/C	5231A20004A	
237200	PANEL, CONTROL	3720A20053A	
238310	ESCUTCHEON	3831A20015R	
249950	CONTROL BOX ASSEMBLY, SINGLE	4995A20806C	4995A20806D
264110	POWER CORD ASSEMBLY	6411A20056A	6411A20056E
263230	THERMISTOR ASSEMBLY	6323A20003S	
267110	REMOTE CONTROLLER	6711A20066C	
268712	PWB (PCB) ASSEMBLY, DISPLAY	6871A20443B	
268714	PWB (PCB) ASSEMBLY, MAIN	EBR39266506	
346811	MOTOR ASSEMBLY, SINGLE	4681A20073Z	4681A20027J
349001	DAMPER, VENTILAYION	4901A30001A	
349480	ORIFICE	4948A30007B	
349600	MOUNT, MOTOR	4960A20014A	
352113	TUBE ASSEMBLY, DISCHARGE SINGLE	5211A20708D	5211AR2930Z
352115	TUBE ASSEMBLY, EVAPORATOR IN	5211A20130H	5211A20130R
352390	AIR GUIDE ASSEMBLY	5239A30002S	
354210	EVAPORATOR ASSEMBLY, FIRST	5421A20061M	5421A20061K
359012	FAN, TURBO	5900A10008A	
550140	ISOLATOR, COMP	5040AR4195A	4830AR4335A
552102	TUBE, CAPILLARY BEND	5211A30260B	5211A20598B
552113	TUBE ASSEMBLY, CONDENSER OUT	5211A10067G	5211A10067P
554030	CONDENSER ASSEMBLY, FIRST	5403A20092H	5403A20043S
554160	COMPRESSOR	2520UCBA002	2520UCDK004
559010	FAN ASSEMBLY, AXIAL	5900A20015A	
567502	O. L. P	6750UL048A	6750U-L031A
731273	INSTALL PARTS ASSEMBLY, SINGLE	3127A20074D	
35211A	TUBE ASSEMBLY, SUCTION SINGLE	AJR31679501	5211A20130M
W0CZZ	CAPACITOR	0CZZA20005B	0CZZA20001N

Specifications and performance data subject to change without notice.

HEAT CONTROLLER, INC.

1900 WELLWORTH AVENUE • JACKSON, MICHIGAN 49203

THE QUALITY LEADER IN CONDITIONING AIR