

This Owner's Manual is provided and hosted by [Appliance Factory Parts](#).

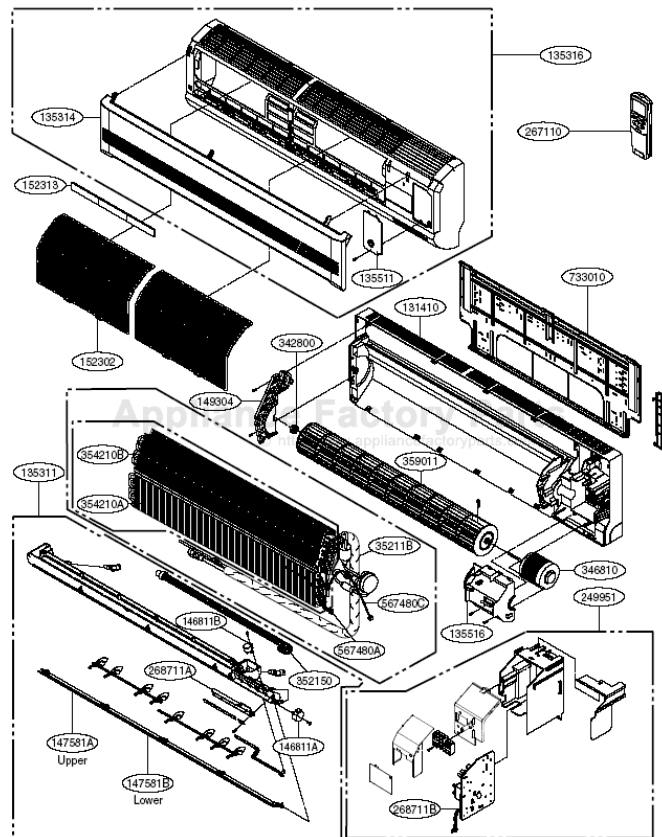

HEAT CONTROLLER AS-Q303DPZ0 Owner's Manual

[Shop genuine replacement parts for HEAT CONTROLLER AS-Q303DPZ0](#)



[Find Your HEAT CONTROLLER Air Conditioner Parts - Select From 32 Models](#)

----- Manual continues below -----

HEAT CONTROLLER, INC.

**Wall Mounted
Mini-Split System
Inverter Single-Zone
Air Conditioning**

Service Manual

**Model: AS-W303DPZ0[VMH30SB-1]
AS-Q303DPZ0[VMC30SB-1]**

CAUTION

Before servicing the unit, read the
“safety precautions” in this manual.

Only for authorized service personnel.

1. Specification

Models		AS-W303DPZ0[VMH30SB-1]	AS-Q303DPZ0[VMC30SB-1]
Cooling Capacity (Min~Rating~Max)		kW 3.5~7.9~7.9	3.5~7.9~7.9
		Btu/h 12000~27000~27000	-
Heating Capacity (Min~Rating~Max)		kW 3.5~8.5~8.5	-
		Btu/h 12000~29000~29000	12000~29000~29000
Power Input	Cooling/Heating	W 3100/3200	3100/3200
Running Current	Cooling/Heating	A 13.6/14.0	13.6/14.0
Starting Current	Cooling/Heating	A 13.1/14.0	13.1/14.0
EER		W/W 2.55	2.55
		Btu/h.W 8.71	8.71
COP		W/W 2.66	-
Power Supply		Ø / V / Hz 1/208~230/60	1/208~230/60
Power Factor		% 97	97
Air Flow Rate	Indoor,Max	m³/min(cfm) 21(742)	21(742)
	Outdoor,Max	m³/min(cfm) 58(2048)	58(2048)
Moisture Removal		l/h 2.8	2.8
Sound Level	Indoor,H/M/L	dB(A)+3 47/43/41	47/43/41
	Outdoor,Max	dB(A)+3 58	58
Refrigerant & Charge(at 7.5m)		g(oz) R410A 1830(64.6)	R410A 1830(64.6)
Additional Refrigerant Charge		g/m(oz/ft) 20(0.22)	20(0.22)
Compressor	Type	SCROLL + ROTARY	SCROLL + ROTARY
	Model	5CS130XCC03 + GK141KAA	5CS130XCC03 + GK141KAA
	Motor Type	BLDC + AC	BLDC + AC
	Oil Type	POE	POE
	Oil Charge	cc 480 + 350	480 + 350
	O.L.P Name	-	-
Fan(Indoor)	Type	Cross Flow Fan	Cross Flow Fan
	Motor Output	W 91	91
Fan(outdoor)	Type	Propeller	Propeller
	Motor Type	AC	AC
	Motor Output	W 140	140
Circuit Breaker*		A 30	30
Power Supply Cable		No.*mm² 3*2.08	3*2.08
Power and Transmission Cable		No.*mm²+No.*mm² 4*0.82	4*0.82
Piping Connections	Liquid Side	mm(in) 6.35(1/4)	6.35(1/4)
	Gas Side	mm(in) 15.88(5/8)	15.88(5/8)
Drain Hose	O.D , I.D	mm(in) 21.5,16(0.85,0.63)	21.5,16(0.85,0.63)
Dimension	Indoor(W*H*D)	mm 1209*346*205	1209*346*205
		inch 47.6*13.6*8.1	47.6*13.6*8.1
	Outdoor(W*H*D)	mm 800*870*320	800*870*320
		inch 31.5*34.3*12.6	31.5*34.3*12.6
Net Weight	Indoor	kg(lbs) 17(37.5)	17(37.5)
	Outdoor	kg(lbs) 67(147.7)	67(147.7)
Operation Range	Cooling(Outdoor)	°C(°F) -5°C~43°C (23~109.4)	-5°C~43°C (23~109.4)
	Heating(Outdoor)	°C(°F) -5°C~27°C(23~80.6)	-
Max. Piping Length		m(ft) 30(98.4)	30(98.4)
Max. Elevation Difference		m(ft) 15(49)	15(49)
Tool Code(Chassis)	Indoor + Outdoor	SD+UE1	SD+UE1
Functions	Temperature Control	Thermistor	Thermistor
	Plasma Filter	-	-
	Prefilter(washable/anti-fungus)	○	○
	Auto Clean	○	○
	CHAOS Wind(Auto Wind)	○(-)	○(-)
	Steps, Fan/Cool/Heat	3/4/4	3/4/4
	Airflow Direction Control(up&down)	Auto	Auto
	Airflow Direction Control(left&right)	Auto	Auto
	Remocon Type	Wireless LCD	Wireless LCD
	Setting Temperature	Cooling 18 ~ 30(64~86)	18 ~ 30(64~86)
	Range	Heating 16 ~ 30	-
	Auto Operation (Micom Control)	-	-
	Auto Changeover (Micom Control)	○	○
	Self Diagnosis	○	○
	Timer	24h, On/Off	24h, On/Off
	Sleep Operation	○	○
	Soft Dry Operation	○	○
	Restart Delay(minute)	2	2
	Deice Control(Defrost)	○	-
	Hot Start	○	-
	Jet Cool	○	○
	Low Ambient Operation	○	○
	Special Function	-	-
Network Functions	Dry Contact	-	-
	Network Solution(LGAP)	-	-
	PI485	-	-

Note:

○ : Applied, - : No relation

* For circuit breaker rating, please conform to local standards wherever necessary.

* Some of functions are slightly different depending upon models.

* The specification may be subject to change without prior notice for purpose of improvement.

* Capacity : based on 230V.

2. Piping Diagrams

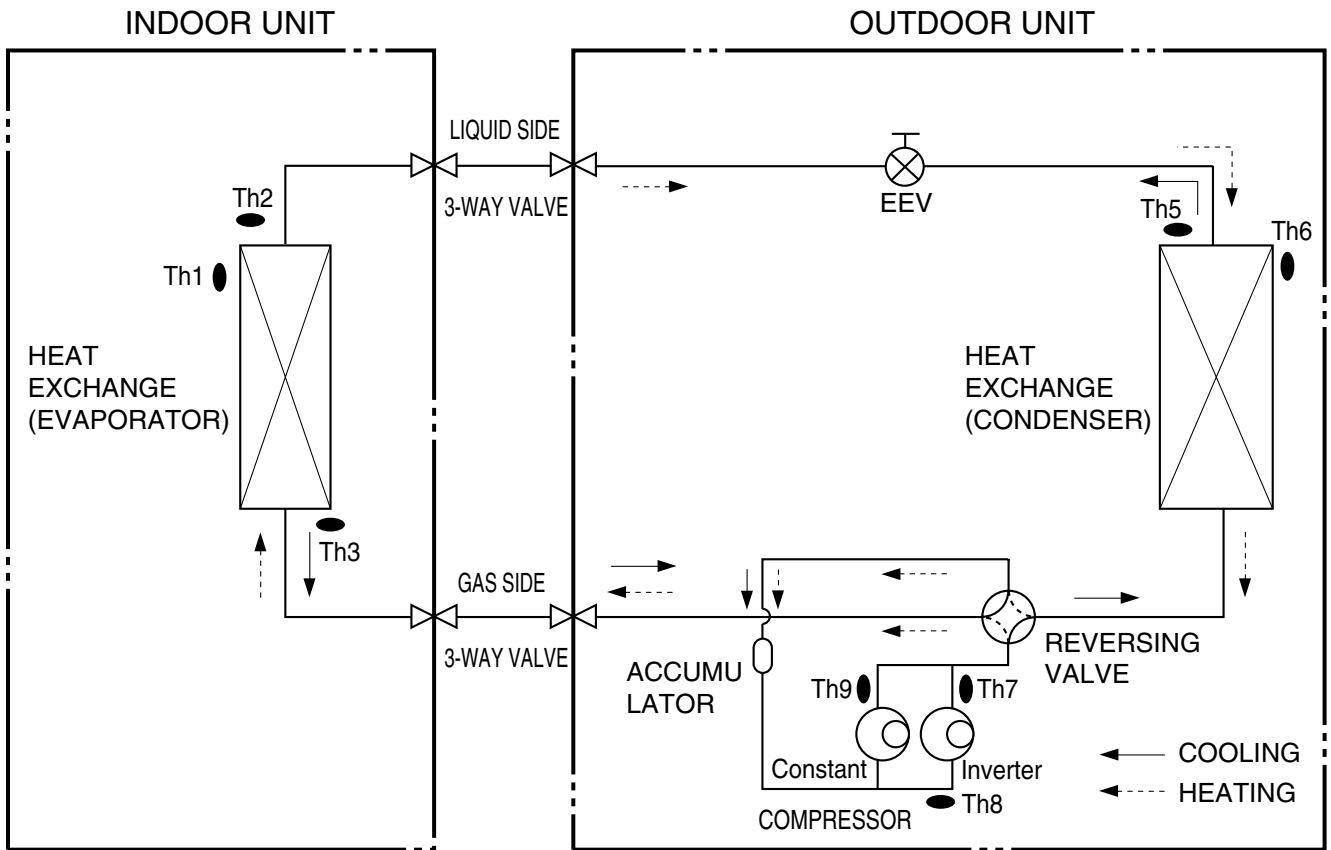

LOC.	Description	PCB Connector
Th1	Thermister for indoor air temperature	CN-TH1(Indoor)
Th2	Thermister for indoor pipe(in) temperature	
Th3	Thermister for Indoor pipe(out) temperature	CN-TH2(Indoor)
Th4	Thermister for outdoor heat sink temperature	CN-TH1(Outdoor)
Th5	Thermister for outdoor pipe temperature	CN-TH2(Outdoor)
Th6	Thermister for outdoor air temperature	
Th7	Thermister for outdoor discharge pipe temperature(Inverter)	CN-TH3(Outdoor)
Th8	Thermister for outdoor suction pipe temperature (Inverter)	
Th9	Thermister for outdoor discharge pipe temperature(Constant)	CN-TH4 (Outdoor)

* EEV : Electronic Expansion Valve

3. Wiring Diagrams

Indoor Unit

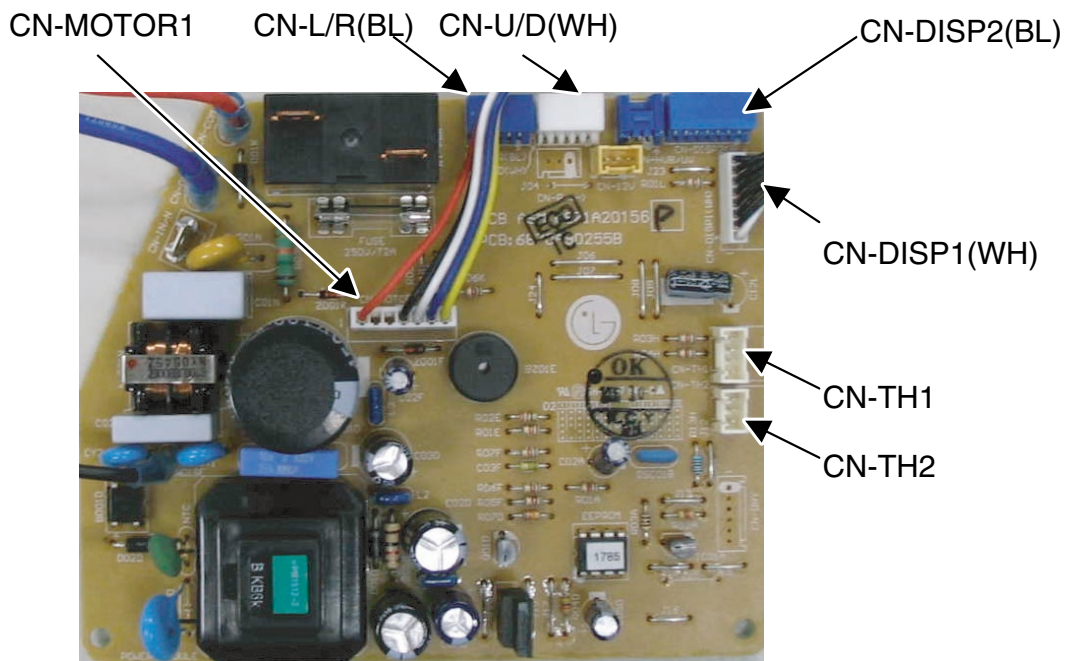
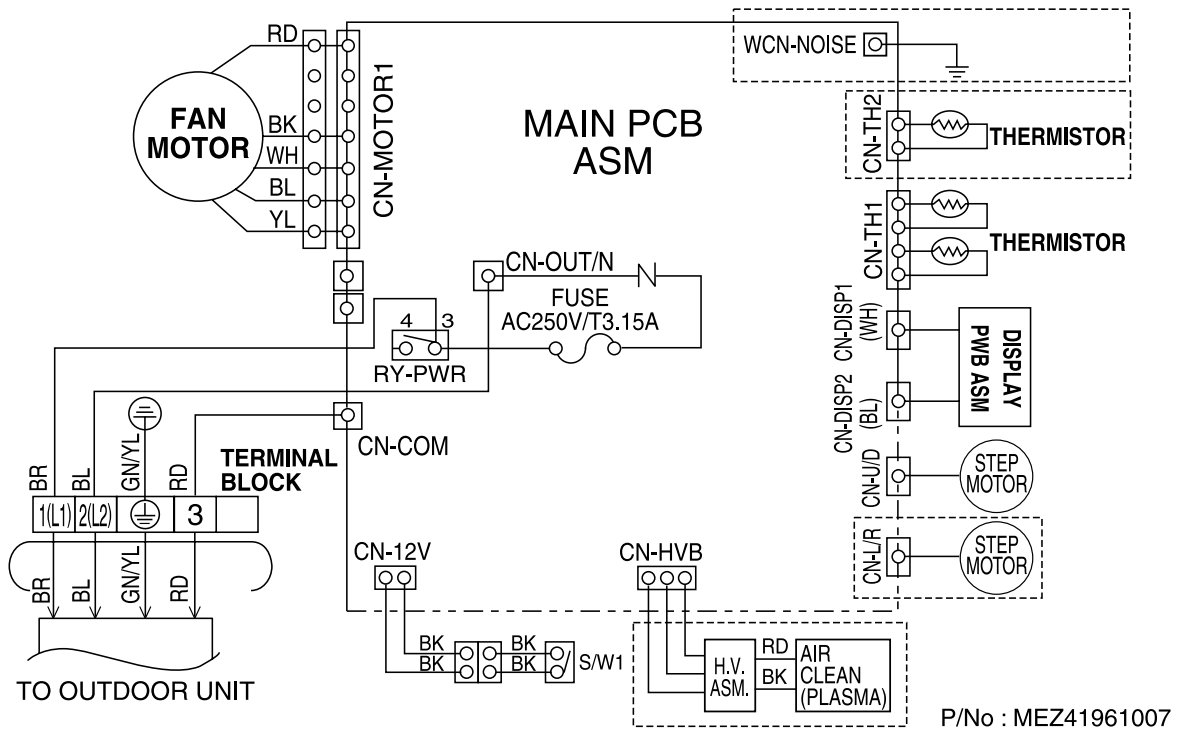

Outdoor Unit

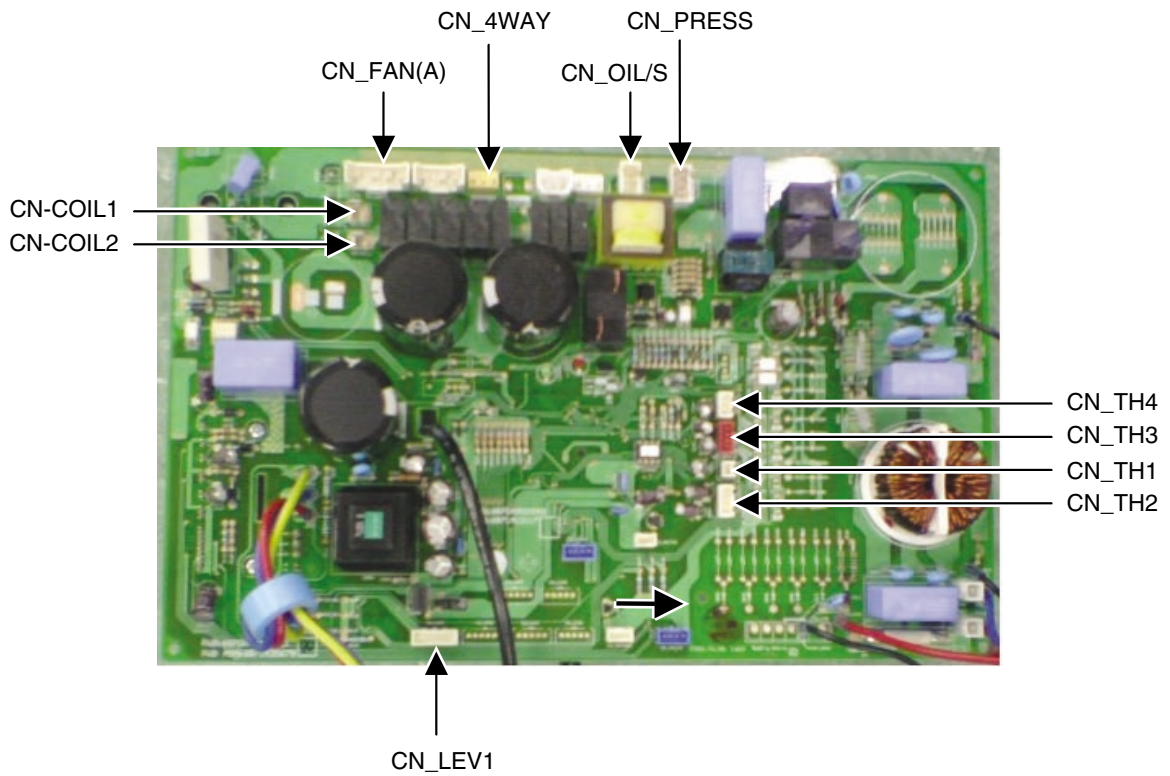
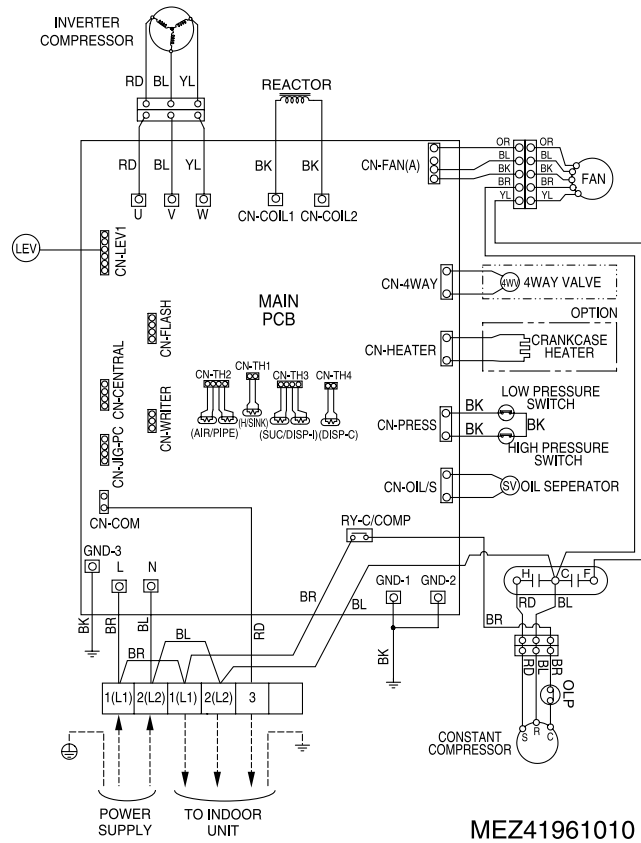

4. Exploded View

Indoor Unit

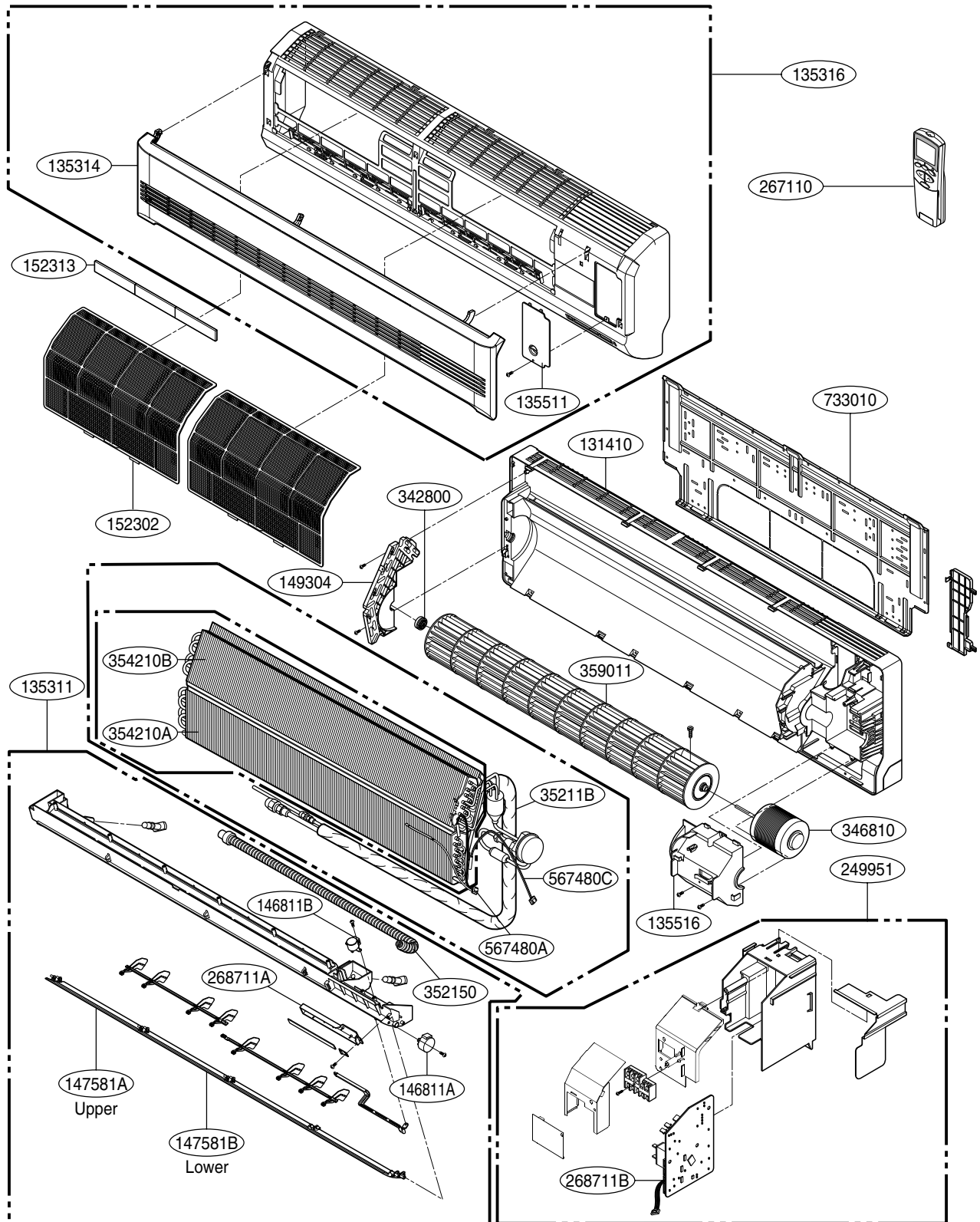

Note) * Please ensure GCSC since the replacement parts may be changed depending upon the buyer's request.
Please check the correct parts in View RPL(Replacement Part List) on GCSC.
(GCSC Website <http://biz.Lgservice.com>.)

Specifications and performance data subject to change without notice.

HEAT CONTROLLER, INC.

1900 WELLWORTH AVENUE • JACKSON, MICHIGAN 49203

THE QUALITY LEADER IN CONDITIONING AIR

P/No.:MFL42286416