

This Owner's Manual is provided and hosted by Appliance Factory Parts.

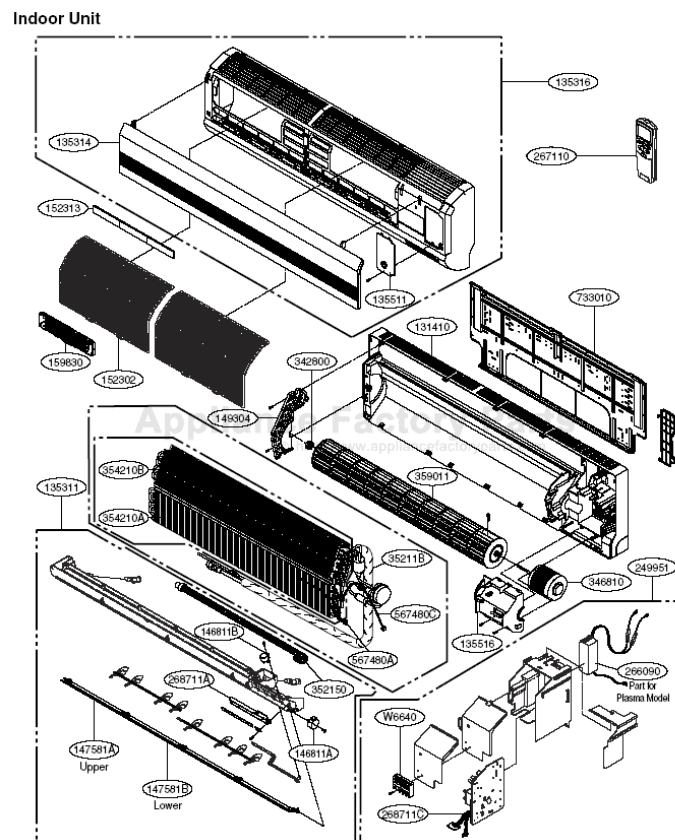

LG LSU305HV Owner's Manual

[Shop genuine replacement parts for LG LSU305HV](#)



[Find Your LG Air Conditioner Parts - Select From 2328 Models](#)

----- Manual continues below -----



Internal Use Only

<http://biz.lgservice.com>

Room Air Conditioner **SVC MANUAL(Exploded View)**

MODEL : AS-W303DGH0(LS305HV)

CAUTION

Before Servicing the unit, read the safety precautions in General SVC manual.
Only for authorized service personnel.

1. Specification

Models		AS-W303DGH0		
Cooling Capacity (Min~Rating~Max)		kW	3.5~7.9~7.9	
		Btu/h	12000~27000~27000	
Heating Capacity (Min~Rating~Max)		kW	3.5~8.5~8.5	
		Btu/h	12000~29000~29000	
Power Input	Cooling/Heating	W	3100/3200	
Running Current	Cooling/Heating	A	13.6/14.0	
Starting Current	Cooling/Heating	A	13.1/14.0	
EER		W/W	2.55	
		Btu/h.W	8.71	
COP		W/W	2.66	
Power Supply		Ø / V / Hz	1/208~230/60	
Power Factor		%	97	
Air Flow Rate	Indoor,Max	m³/min(cfm)	21(742)	
	Outdoor,Max	m³/min(cfm)	58(2048)	
Moisture Removal		l/h	2.8	
Sound Level	Indoor,H/M/L	dB(A)+3	47/43/41	
	Outdoor,Max	dB(A)+3	58	
Refrigerant & Charge(at 7.5m)		g(oz)	R410A 1830(64.6)	
Additional Refrigerant Charge		g/m(oz/ft)	20(0.22)	
Compressor	Type		SCROLL + ROTARY	
	Model		5CS130XCC03 + GK141KAA	
	Motor Type		BLDC + AC	
	Oil Type		POE	
	Oil Charge	cc	480 + 350	
	O.L.P Name		-	
Fan(Indoor)	Type		Cross Flow Fan	
	Motor Output	W	91	
Fan(outdoor)	Type		Propeller	
	Motor Type		AC	
	Motor Output	W	140	
Circuit Breaker*		A	30	
Power Supply Cable		No.*mm²	3*2.08	
Power and Transmission Cable		No.*mm²+No.*mm²	4*0.82	
Piping	Liquid Side	mm(in)	6.35(1/4)	
Connections	Gas Side	mm(in)	15.88(5/8)	
Drain Hose	O.D , I.D	mm(in)	21.5,16(0.85,0.63)	
Dimension	Indoor(W*H*D)	mm	1209*346*205	
		inch	47.6*13.6*8.1	
	Outdoor(W*H*D)	mm	800*870*320	
		inch	31.5*34.3*12.6	
Net Weight	Indoor	kg(lbs)	17(37.5)	
	Outdoor	kg(lbs)	67(147.7)	
Operation Range	Cooling(Outdoor)	°C(°F)	-5°C~43°C (23~109.4)	
	Heating(Outdoor)	°C(°F)	-5°C~27°C(23~80.6)	
Max. Piping Length		m(ft)	30(98.4)	
Max. Elevation Difference		m(ft)	15(49)	
Tool Code(Chassis)	Indoor + Outdoor		SD+UE1	
Functions	Temperature Control		Thermistor	
	Plasma Filter		Neo	
	Prefilter(washable/anti-fungus)		O	
	Auto Clean		O	
	CHAOS Wind(Auto Wind)		O(-)	
	Steps, Fan/Cool/Heat		3/4/4	
	Airflow Direction Control(up&down)		Auto	
	Airflow Direction Control(left&right)		Manual	
	Remocon Type		Wireless LCD	
	Setting Temperature Range	Cooling		18 ~ 30
		Heating		16 ~ 30
	Auto Operation (Micom Control)		-	
	Auto Changeover (Micom Control)		O	
	Self Diagnosis		O	
	Timer		24h, On/Off	
	Sleep Operation		O	
	Soft Dry Operation		O	
	Restart Delay(minute)		2	
	Deice Control(Defrost)		O	
	Hot Start		O	
	Jet Cool		O	
	Low Ambient Operation		O	
	Special Function		-	
Network Functions	Dry Contact		-	
	Network Solution(LGAP)		-	
	PI485		-	

Note:

O : Applied, - : No relation

* For circuit breaker rating, please conform to local standards wherever necessary.

* Some of functions are slightly different depending upon models.

* The specification may be subject to change without prior notice for purpose of improvement.

2. Piping Diagrams

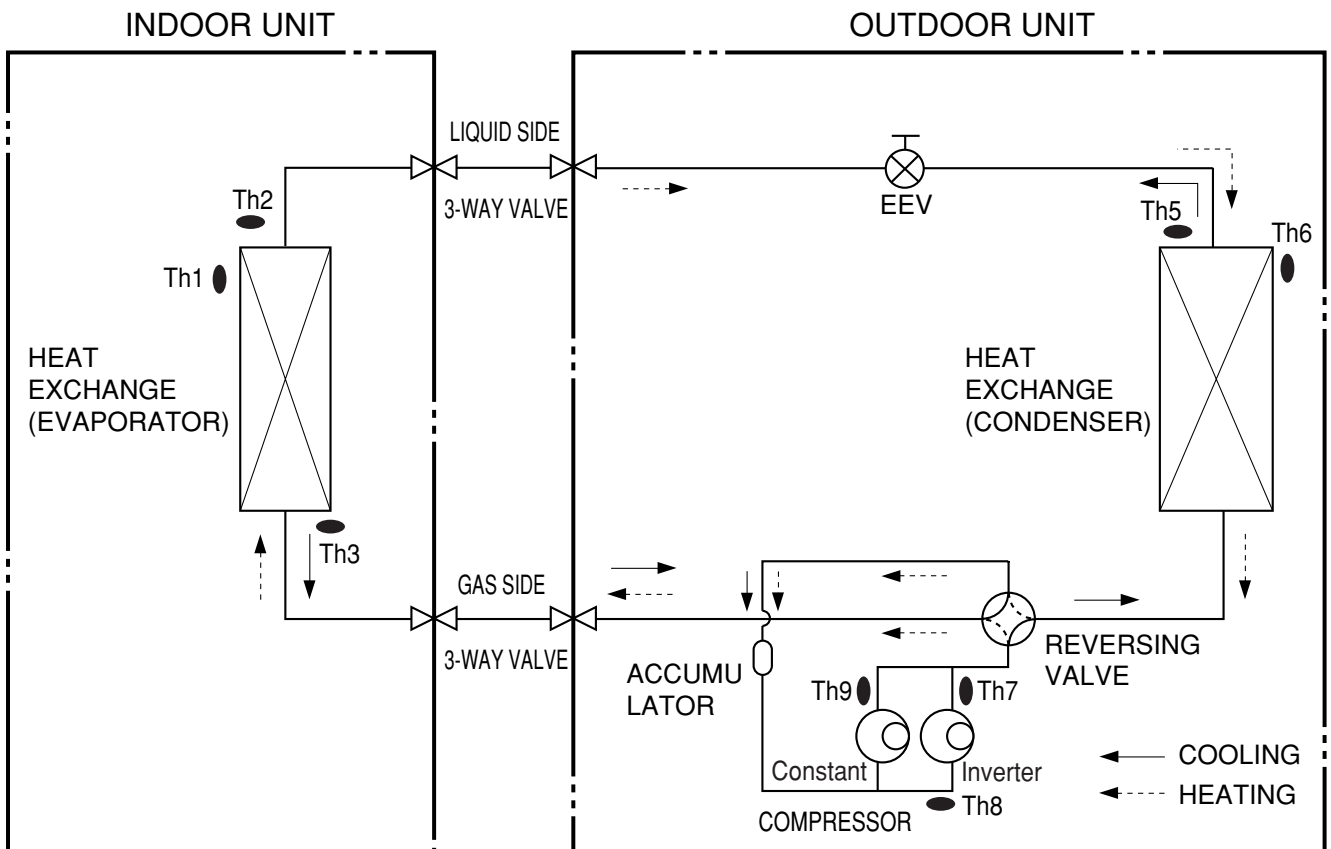

LOC.	Description	PCB Connector
Th1	Thermister for indoor air temperature	CN-TH1(Indoor)
Th2	Thermister for indoor pipe(in) temperature	
Th3	Thermister for Indoor pipe(out) temperature	CN-TH2(Indoor)
Th4	Thermister for outdoor heat sink temperature	CN-TH1(Outdoor)
Th5	Thermister for outdoor pipe temperature	CN-TH2(Outdoor)
Th6	Thermister for outdoor air temperature	
Th7	Thermister for outdoor discharge pipe temperature(Inverter)	CN-TH3(Outdoor)
Th8	Thermister for outdoor suction pipe temperature (Inverter)	
Th9	Thermister for outdoor discharge pipe temperature(Constant)	CN-TH4 (Outdoor)

* EEV : Electronic Expansion Valve

3. Wiring Diagrams

Indoor Unit

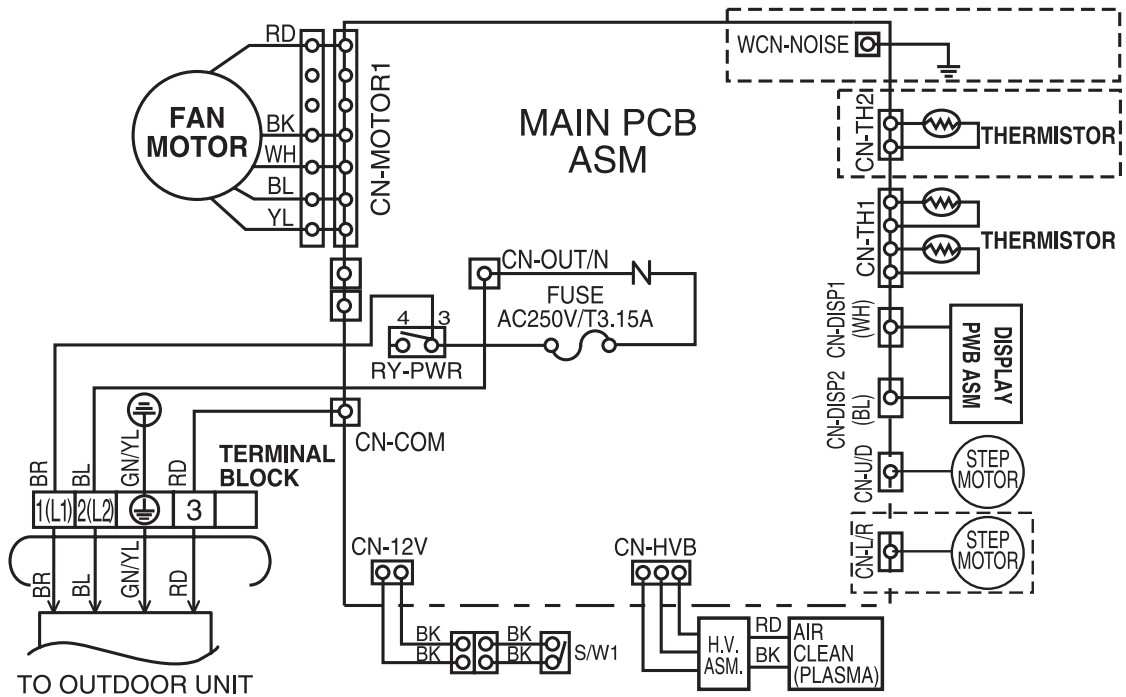

P/No : EBY38909701

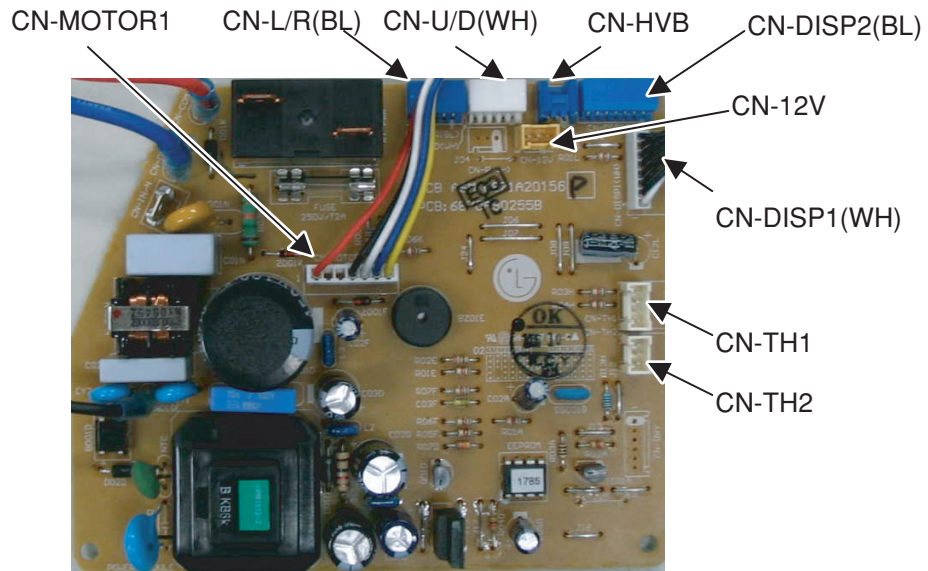

Outdoor Unit

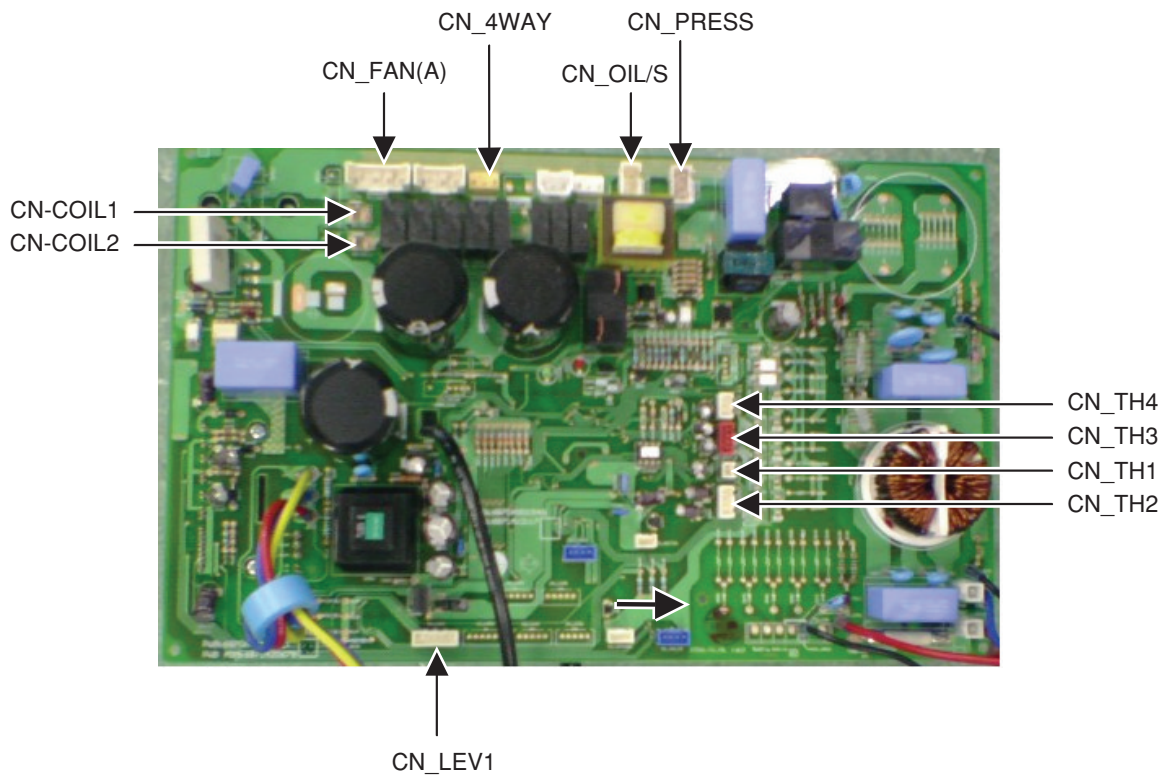
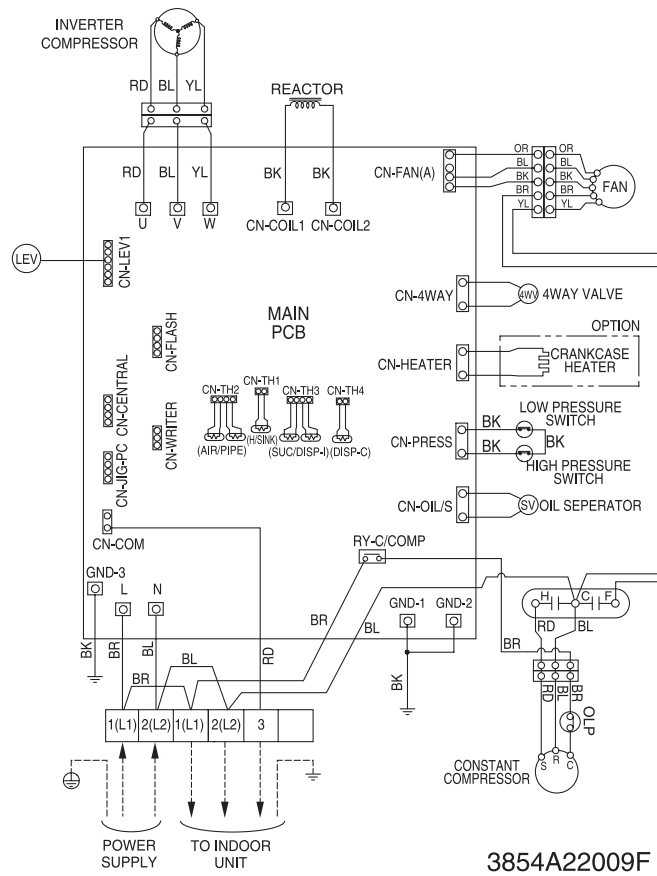

4. Exploded View

Indoor Unit

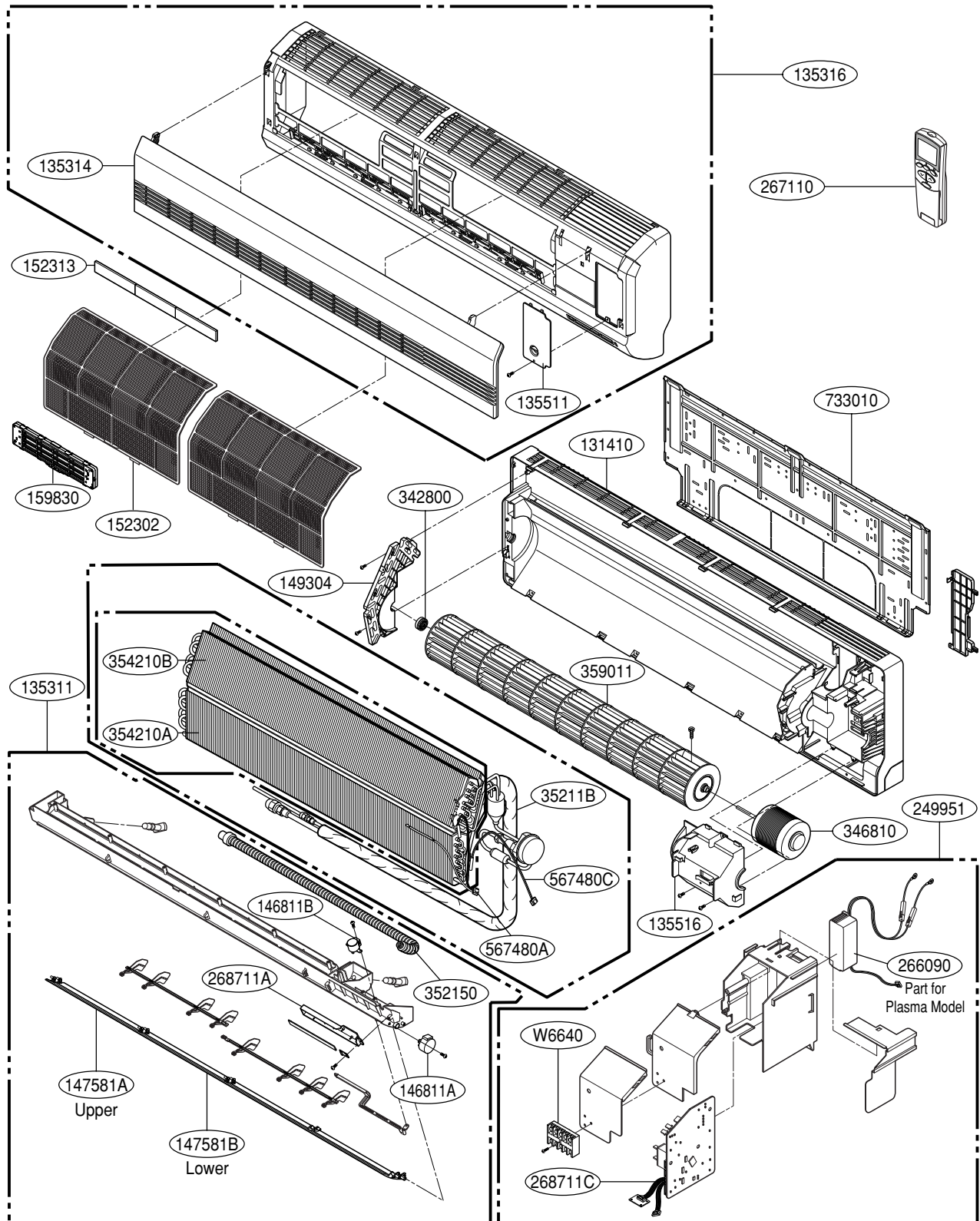

Note) * Please ensure GCSC since the replacement parts may be changed depending upon the buyer's request.
Please check the correct parts in View RPL(Replacement Part List) on GCSC.
(GCSC Website <http://biz.Lgservice.com>.)



P/NO : 3828A20195Y

DECEMBER, 2007