

This Owner's Manual is provided and hosted by [Appliance Factory Parts](#).



Kenmore 253.74131401 Owner's Manual

[Shop genuine replacement parts for Kenmore
253.74131401](#)



[Find Your Kenmore Air Conditioner Parts - Select From 261 Models](#)

----- Manual continues below -----

Owner's Manual



Read and Save These Instructions

This Owner's Guide provides specific operating instructions for your model. Use the air conditioner only as instructed in this guide. These instructions are not meant to cover every possible condition and situation that may occur. Common sense and caution must be practiced when installing, operating, and maintaining any appliance.

Record Your Model and Serial Numbers

Record in the space provided below the model and serial numbers. The serial plate is located on the outside of the cabinet, or behind filter at the bottom of unit. Reading the numbers may be easier by using a flashlight or by removing the cabinet front as instructed under "Care and Cleaning."

Model Number: _____

Serial Number: _____

Purchase Date: _____

Important Safety Instructions

Read all instructions before using this air conditioner.

⚠ WARNING For Your Safety

Do not store or use gasoline or other flammable vapors and liquids in the vicinity of this or any other appliance. Read product labels for flammability and other warnings.

⚠ WARNING Prevent Accidents

To reduce the risk of fire, electrical shock, or injury to persons when using your air conditioner, follow basic precautions, including the following:

- Be sure the electrical service is adequate for the model you have chosen.
- If the air conditioner is to be installed in a window, you will probably want to clean both sides of the glass first. If the window is a triple-track type with a screen panel included, you may want to remove the screen completely before installation.
- Be sure the air conditioner has been securely and correctly installed according to the separate installation instructions provided with this manual. Save this manual. Save this manual and installation instructions for possible future use in removing or reinstalling this unit.
- When handling the air conditioner, be careful to avoid cuts from sharp metal fins on front and rear coils.

⚠ WARNING Electrical Information

The complete electrical rating of your new room air conditioner is stated on the serial plate. Refer to the rating when checking the electrical requirements.

- Be sure the air conditioner is properly grounded. To minimize shock and fire hazards, proper grounding is important. The power cord is equipped with a three-prong grounding plug for protection against shock hazards.
- ⚡ Your air conditioner **must** be used in a properly grounded wall receptacle. If the wall receptacle you intend to use is not adequately grounded or protected by a time delay fuse or circuit breaker, have a qualified electrician install the proper receptacle.
- Do not run air conditioner with outside protective cover in place. This could result in mechanical damage within the air conditioner.
- ⚡ **Do not use an extension cord or an adaptor plug.**

⚠ WARNING Avoid fire hazard or electric shock. Do not use an extension cord or an adaptor plug. Do not remove any prong from the power cord.

Grounding type wall receptacle

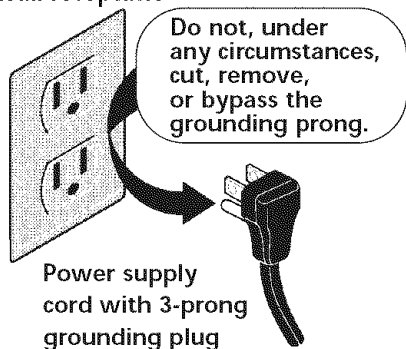

Energy Saving Ideas ⚡



- The capacity of the room air conditioner must fit the room size for efficient and satisfactory operation.
- Install the room air conditioner on the shady side of your home. A window that faces north is best because it is shaded most of the day.
- Do not block air flow inside with blinds, curtains or furniture; or outside with shrubs, enclosures, or other buildings.
- Close the fireplace damper, floor and wall registers so cool air does not escape up the chimney and into the duct work.
- Keep blinds and drapes in other windows closed during the sunniest part of the day.
- Clean the air filter as recommended in the section "Care and Cleaning."
- Proper insulation and weather stripping in your home will help keep warm air out and cool air in.
- External house shading with trees, plants or awnings will help reduce the air conditioner's work load.
- Operate heat producing appliances such as ranges, washers, dryers and dishwashers during the coolest part of the day.

⚡ Troubleshooting Tips

How and Why

Your room air conditioner provides the following functions to make hot weather living more comfortable:

- Cools and circulates room air.
- ↳ Lowers humidity by removing excess moisture. High moisture levels may cause the air conditioner to drip excess moisture outside.
- Filters out summertime dust, dirt, and some airborne impurities.

The air conditioner performs these functions by drawing room air through a filter which traps dust and dirt particles. The air then passes over a cooling coil which refrigerates the air and removes excess moisture. The same air is then returned to the room — cooler, drier and cleaner. Moisture removed from the room air is carried to the outside and evaporated. This moisture may form ice on the inside coil if the outside temperature is below 65 degrees. Setting the air conditioner on the fastest fan setting in FAN ONLY will defrost the coil.

- ↳ Your air conditioner is designed to be easy to operate and to provide plenty of cooling power. Your air conditioner is also more efficient than (most) older models and may run longer to cool the room, but will use less energy due to higher energy efficiency ratings.

Capacity and Running Time

Proper unit size is important in deciding the desired comfort for the area you want to cool. The proper size is determined by the number of square feet in the area to be cooled.

Whenever the heat or humidity load is above normal the air conditioner must run longer and more often to keep the desired temperature you have selected. Under heavy heat load conditions the air conditioner may need to run constantly to keep the temperature you want. Allow some time to cool the room if the air conditioner was recently turned on. Using the "AUTO START" feature will allow you to start cooling the room prior to returning home.

At times using the fastest Fan setting to circulate the room air may make it comfortable even though you do not have the air conditioner set to cool the air. This will decrease your cost to use.

Normal Sounds

High Pitched Chatter
Today's high efficiency compressors may have a high pitched chatter during the cooling cycle.

Vibration
Unit may vibrate and make noise because of poor wall or window construction or incorrect installation.

Sound of Rushing Air
At the front of the unit, you may hear the sound of rushing air being moved by the fan.

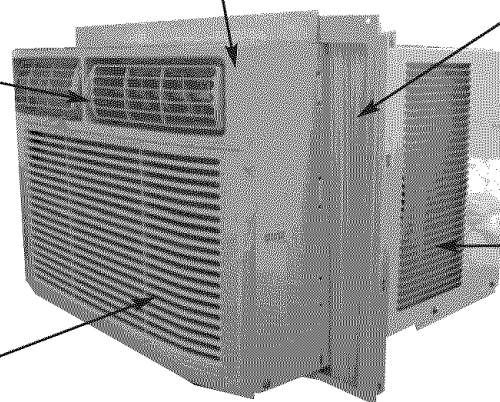

Pinging or Swishing
Droplets of water hitting condenser during normal operation may cause "pinging or swishing" sounds.

Gurgle/Hiss
"Gurgling or hissing" noise may be heard due to refrigerant passing through evaporator during normal operation.

Using Air Conditioner

WARNING To reduce the risk of fire, electric shock, or injury to persons, read the IMPORTANT SAFETY INSTRUCTIONS before operating this appliance.

To begin operating the air conditioner, follow these steps:

1. Plug in the air conditioner. (To prevent electrical hazards, do not use an extension cord or an adapter plug.)
2. Press " On/Off " button to turn unit on.
3. Press Mode " COOL "
4. Press " TEMP/TIME " up (^) or down (v) to the desired set temperature. Review the " Air Conditioner Features " section for other settings.

Air Conditioner Features

ELECTRONIC CONTROL OPERATING INSTRUCTIONS

Before you begin, thoroughly familiarize yourself with the control panel and remote as shown below and all its functions, then follow the symbol for the functions you desire. **The unit can be controlled by the touch pad alone or with the remote.**

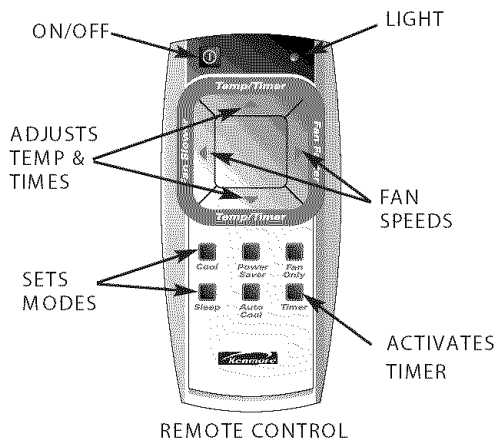
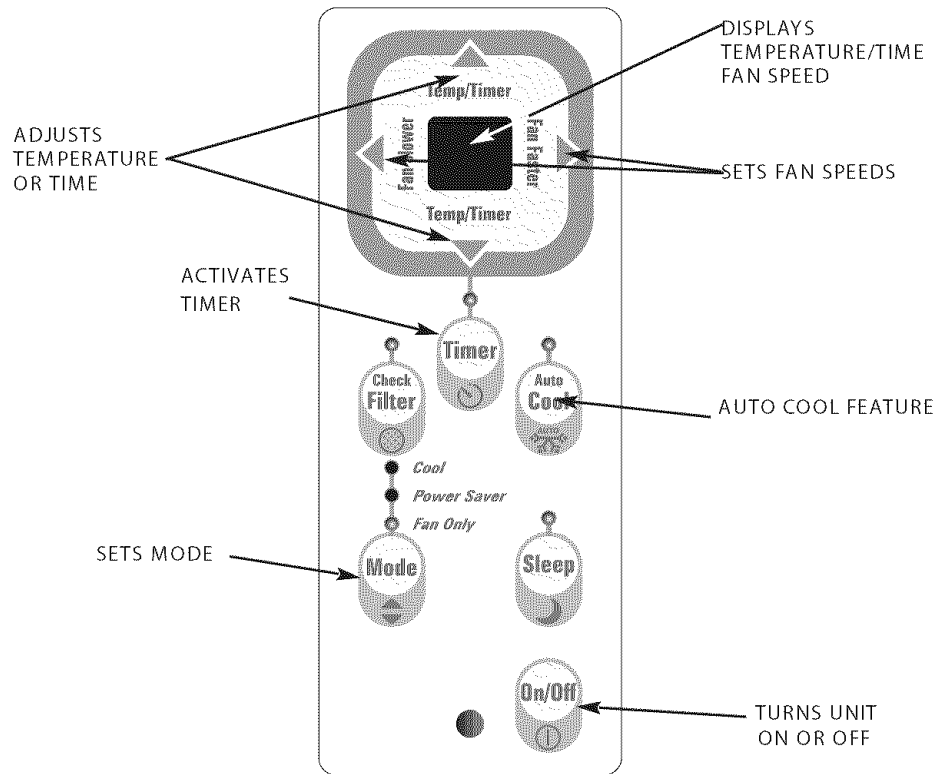

Fig." A"



Air Conditioner Features (continued)

NOTE: The following instruction represent the Touch Pad, the same instructions can be used for the Remote Control.

TO TURN UNIT ON:

YOU WILL SEE:

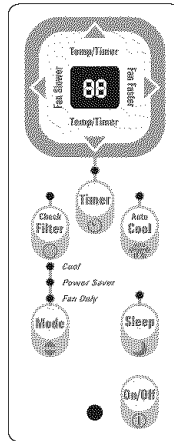
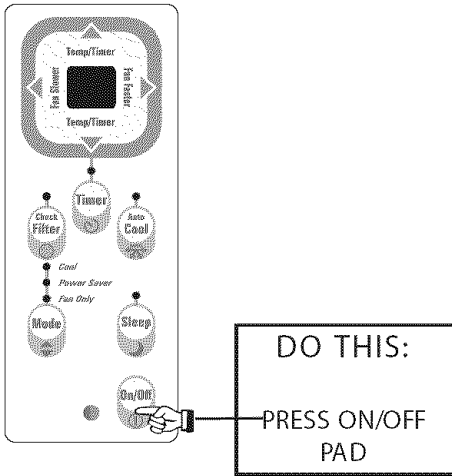

TO CHANGE TEMPERATURE SETTING:

YOU WILL SEE:

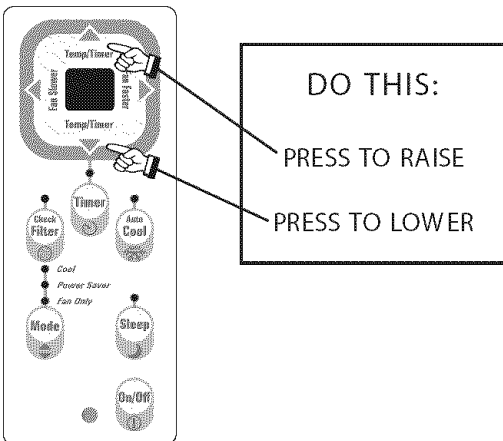

Note: Tap or hold either up(^) or down(v) button until the desired temperature is seen on the display. This temperature will be automatically maintained anywhere between 60F (16C) and 90F (32C). If you want the display to read the actual room temperature. See "To Operate on Fan Only" section on Page 6.

TO ADJUST FAN SPEEDS:

YOU WILL SEE:

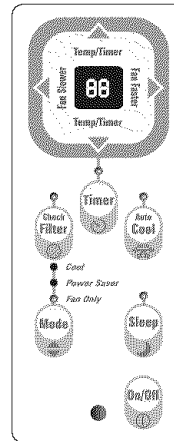
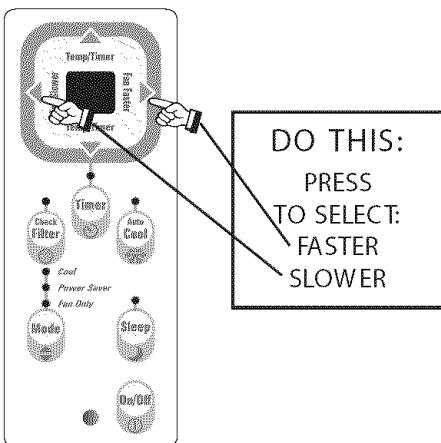

A 2 Digit Display is used to indicate the Fan Speed setting, from 10 through 99. When the "SLOWER" button is pressed the motor speed will slow down at various intervals, to a minimum setting of 10. To speed the motor up, press the "FASTER" button. The speed will increase at various intervals to a maximum setting of 99.

Air Conditioner Features (continued)

TO USE AUTO COOL FEATURE:

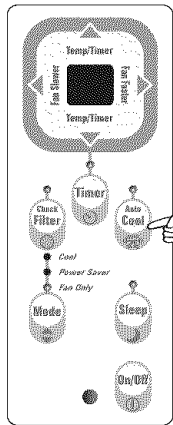

DO THIS:
PRESS AUTO
COOL

YOU WILL SEE:

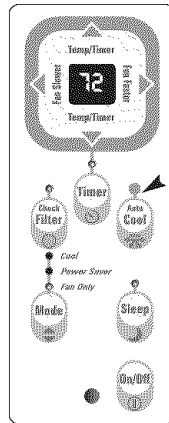

LIGHT On

Note: Fan speed starts at high and adjusts to a slower speed as the room temperature dictates. For example, if the room doesn't get too warm it will stay at the slowest speed. If the room temperature rises quickly, such as a door being opened, it will automatically go to the highest speed. The fan speeds will readjust back to the slowest speed as the room returns to the original set temperature. Press either the Fan Slower or Fan Faster button to adjust the fan speed manually.

TO OPERATE ON FAN ONLY:

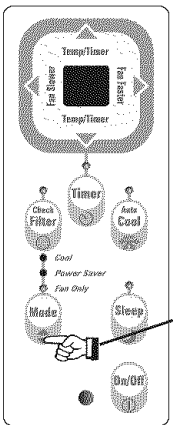

DO THIS:
PRESS
MODE BUTTON
CHOOSE
FAN ONLY

YOU WILL SEE:

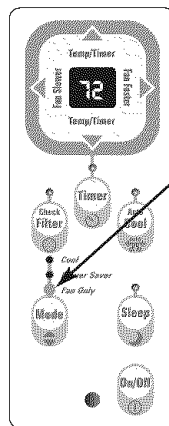

LIGHT On

Note: Use this function only when cooling is not desired, such as for room air circulation or to exhaust stale air. You can choose any fan speed you prefer. During this function, the display will show the actual room temperature, not the set temperature as in the cooling mode.

TO USE THE POWER SAVER FEATURE:

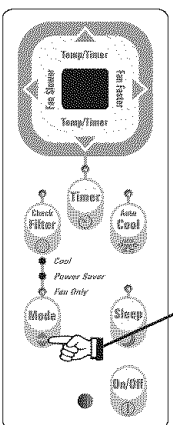

DO THIS:
PRESS
MODE BUTTON
CHOOSE
POWER SAVER

YOU WILL SEE:

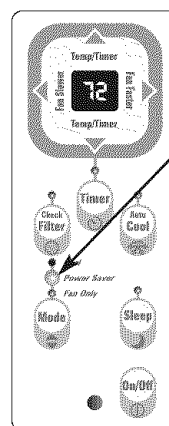

LIGHT On

Note: In this mode, the fan will continue to run for 3 minutes after the compressor shuts off. The fan then cycles on for 2 minutes at 10 minute intervals until the room temperature is above the set temperature, at which time the unit turns back on.

Air Conditioner Features

(continued)

TIMER: DELAY STOP / START FEATURE

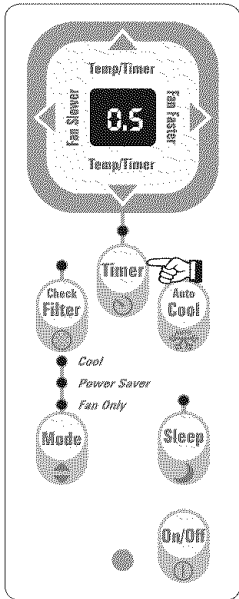

DO THIS:
PRESS
TIMER BUTTON

YOU WILL SEE: TIMER SETTING

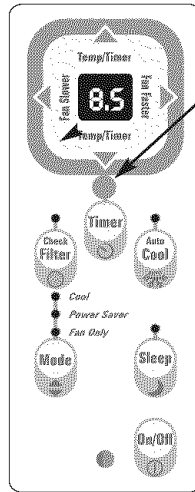

LIGHT On

Note: For Delay Stop, the unit must be in the On position.

Note: For Delay Start, the unit must be in the Off position.

To adjust timer setting, tap or hold the UP arrow(^) DOWN arrow(v) to change delay timer at .5 hour increment, up to 10 hours, then at 1 hour increments up to 24 hours. The control will count down the time remaining until start (8, 7.5, 7, etc.). The Delay Start mode automatically selects cooling with maximum Fan Speed. The temperature maintained will be the same as previously set. To change the set temperature, press "COOL" then Up or Down arrows until the desired temperature is indicated on the display. After 5 seconds, the control will automatically change the display back to the hours remaining until the unit will start/stop. Turning the unit "ON" or "OFF" at any time will cancel the Delay Start/Stop function.

SLEEP FEATURE:

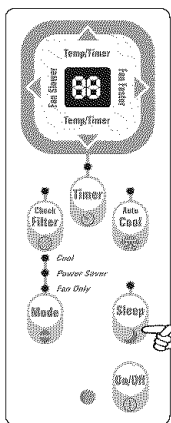

DO THIS:
PRESS SLEEP
BUTTON

YOU WILL SEE:

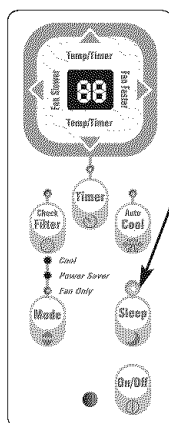

LIGHT On

Note: In this "MODE" the selected temperature will increase by 2 degrees F 30 minutes after the mode is selected. The temperature will then increase by another 2 degrees F after an additional 30 minutes. This new temperature will be maintained for 7 hours before it returns to the originally selected temperature. This ends the "Sleep" MODE and the unit will continue to operate as originally programmed. The "Sleep" MODE program can be cancelled at any time during operation by pressing "Sleep" MODE button.

Air Conditioner Features (continued)

CHECK FILTER FEATURE:

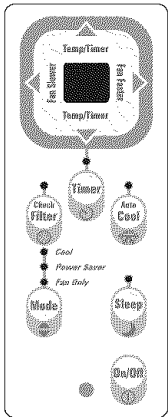

YOU WILL SEE:

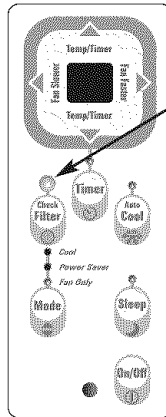

LIGHT On

Note: This feature is a reminder to clean the Air Filter (See Care and Cleaning) for more efficient operation and cooling. The LED (light) will illuminate after 250 hours of operation. To reset after cleaning the filter, press the "Check Filter" button and the light will go off.

TO TURN UNIT OFF:

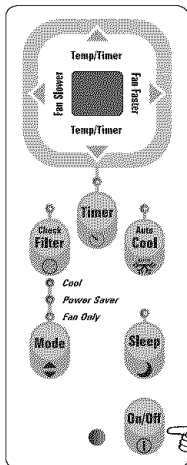

DO THIS:
PRESS ON/OFF
BUTTON

ADDITIONAL THINGS YOU SHOULD KNOW

Now that you have mastered the operating procedure, here are more features in your control that you should become familiar with.

- * The "Cool" circuit has an automatic 3 minute time delayed start if the unit is turned off and on quickly. This prevents overheating of the compressor and possible circuit breaker tripping. The fan will continue to run during this time.
- * The control will maintain the set temperature within 2 degrees Fahrenheit, between 60F and 90F degrees.
- * The control is capable of displaying temperature in degrees Fahrenheit or degrees Celsius. To convert from one to the other and back, press and hold the "TEMP/TIMER " Up (^) and Down (v) buttons together for 3 seconds.

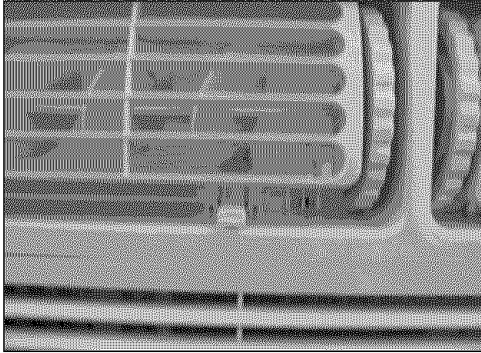

Figure 1 (VENT CLOSED)

Fresh Air Vent Control (On some models)

The Fresh Air Vent allows the air conditioner to:

1. Recirculate inside air — Vent Closed (see Fig. 1)
2. Draw fresh air into the room— Vent Open (see Fig. 2)
3. Exchange air from the room and draws fresh air into the room — Vent and Exhaust Open (see Fig. 3)

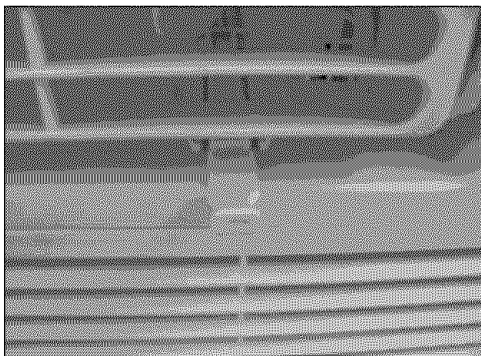

Figure 2 (VENT OPEN)

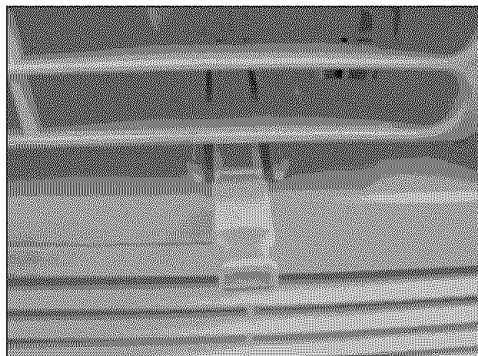

Figure 3 (VENT & EXHAUST OPEN)

Air Conditioner Features

Air Directional Louvers

Air directional louvers control air flow direction. Your air conditioner has the louver type described below.

Auger Type

The louvers will allow you to direct the air flow Up or Down and Left or Right throughout the room as needed. Rotate the Auger Wheel until the desired direction is obtained.

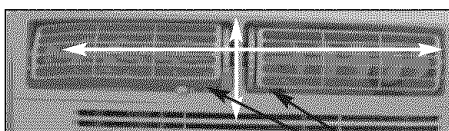

(8-WAY)

AUGER WHEELS

Care and Cleaning

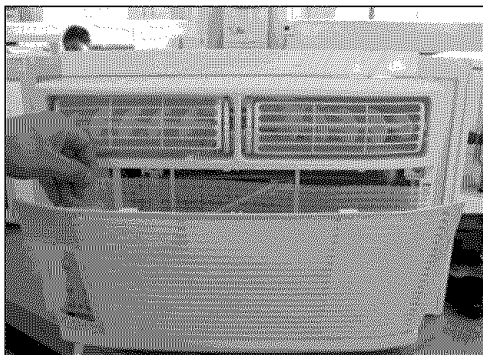

Clean your air conditioner occasionally to keep it looking new. **Be sure to unplug the unit before cleaning to prevent shock or fire hazards.**

Air Filter Cleaning

The air filter should be checked at least once a month to see if cleaning is necessary. Trapped particles in the filter can build up and cause an accumulation of frost on the cooling coils.

- Push the vent handle to the Vent Closed position (where applicable).
- Open the front panel.
- Grasp the filter by the center and pull up and out.
- Wash the filter using liquid dishwashing detergent and warm water. Rinse filter thoroughly. Gently shake excess water from the filter. Be sure filter is thoroughly dry before replacing.
- Or, instead of washing you may vacuum the filter clean.

Cabinet Cleaning

- Be sure to unplug the air conditioner to prevent shock or fire hazard. The cabinet and front may be dusted with an oil-free cloth or washed with a cloth dampened in a solution of warm water and mild liquid dishwashing detergent. Rinse thoroughly and wipe dry.
- Never use harsh cleaners, wax or polish on the cabinet front.
- Be sure to wring excess water from the cloth before wiping around the controls. Excess water in or around the controls may cause damage to the air conditioner.
- Plug in air conditioner.

Winter Storage

If you plan to store the air conditioner during the winter, remove it carefully from the window according to the installation instructions. Cover it with plastic or return it to the original carton.

NOTE: To prevent rust or electrical connections from being damaged, store air conditioner in an upright position and a dry place. A winter cover can be purchased from your dealer. The cover will protect the air conditioner when it is left in place through the winter.



Room Air Conditioner Troubleshooting Guide

THE AIR CONDITIONER WILL NOT OPERATE

Check if ...	Then ...
Power supply cord is disconnected.	Firmly push the cord into a live wall outlet with proper voltage. (Page 2)
House fuse has blown or circuit breaker tripped.	Replace the fuse with a time delay type or reset the circuit. (Page 2)
Power is OFF.	Push ON/OFF Button to turn unit ON. (Page 5)
Temperature setting is warmer than room temperature.	Set temperature to a lower setting. (Page 5)
Unit was turned OFF and ON too quickly.	Built-in delay will prevent compressor from turning off for 3 minutes.
Timer shut unit OFF.	Push ON/OFF Button to turn unit ON. (Page 5)
Touch Pad and Remote not responding.	Unit is in a lock-up mode. Unplug and then plug in again and the controls will reset.

THE AIR CONDITIONER BLOWS FUSES OR TRIPS CIRCUIT BREAKER

Check if ...	Then ...
House fuse has blown or circuit breaker tripped.	Replace the fuse with a time delay type or reset the circuit. (Page 2)
Too many electrical devices are being used on the same circuit.	Unplug or relocate electrical devices being shared on same circuit. (Page 2)
Unit is rated over 7.5 amps.	Unit should be plugged into a single circuit outlet. (Page 2)
Unit is plugged into an extension cord.	Do not use an extension cord to run the unit. (Page 2)
Unit was turned OFF and ON too quickly.	Turn unit OFF and wait 3 minutes before restarting. (Page 5)

THE AIR CONDITIONER TURNS ON AND OFF BY ITSELF

Check if ...	Then ...
Outside temperature is extremely hot.	Set fan speed at the fastest setting for maximum cooling. (Page 5)
POWER SAVE feature is on.	POWER SAVE feature does not circulate air continually. Set mode to COOL for constant air circulation. (Page 6)
Timer turned unit ON or shut unit OFF.	Push ON/OFF Button to turn unit ON or OFF. (Page 5)

THE AIR CONDITIONER DOES NOT COOL THE ROOM - ICE BEHIND FRONT PANEL

Check if ...	Then ...
Outside temperature is below 60F	Set mode to FAN ONLY and fan speed to fastest setting to defrost coil. (Page 3)
Filter is dirty.	Open front panel. Remove filter. Rinse or vacuum filter. Replace filter. Close Panel. (Page 10)
BTU size is too large.	A lower capacity unit may be required depending on the size of the room being cooled. (Page 3)

THE AIR CONDITIONER DOES NOT COOL THE ROOM - NO ICE BEHIND FRONT PANEL

Check if ...	Then ...
Filter is dirty.	Open front panel. Remove filter. Rinse or vacuum filter. Replace filter. Close Panel. (Page 10)
Temperature setting is warmer than room temperature.	Set temperature to a lower setting. (Page 5)
Room temperature is below 60F.	Unit is not designed to cool below 60F. (Page 3)
Front of unit is blocked by furniture, drapes, blinds, etc.	Clear away area in front of unit. (Page 2)
Back of unit is blocked by leaves, dirt, branches, etc.	Clear away back of unit. (Page 2)
Doors, windows, registers, etc. are open.	Close doors, windows, registers, etc. (Page 2)
Unit recently turned on.	Allow time to cool a larger room. (Page 3)
Temperature sensor is touching the coil.	Open front panel. Remove filter. Turn end of temperature sensor away from coil. Replace filter. Close panel. (Page 10)
Excessive heat in the room being cooled.	Use exhaust vents while cooking or bathing. Limit use of heat producing appliances during the hottest part of the day. (Page 2)
Vent control is pulled open.	Push in vent control for maximum cooling. (Page 9)

THE AIR CONDITIONER RUNS TOO MUCH

Check if ...	Then ...
Current Unit replaced an older unit.	Newer, higher efficiency Air Conditioner may run longer to cool the room. Total energy consumption is less due to higher efficiency. (Page 3)
BTU size is tool small.	A higher capacity unit may be required depending on the size of the room being cooled. (Page 3)

WATER DRIPPING FROM AIR CONDITIONER - INSIDE ROOM

Check if ...	Then ...
Unit is not properly installed.	Unit should be mounted on a 1/4" downward slope to the outside (1/2 bubble on a carpenter's level) to provide proper drainage. Reposition or shim cabinet as necessary. DO NOT drill drain pan.

WATER DRIPPING FROM AIR CONDITIONER - OUTSIDE ROOM

Check if ...	Then ...
Room is hot and humid.	Normal operation during hot and humid days. (Page 3)

THE REMOTE WILL NOT OPERATE AIR CONDITIONER

Check if ...	Then ...
Batteries are not installed properly.	Verify the plastic shipping strip is removed from the batteries and the batteries are installed properly. (Page 4)
Red Light does not flash on the remote when the remote buttons are pushed.	Verify the plastic shipping strip is removed from the batteries and the batteries are installed properly. Install a new set of batteries. (Page 4)
The remote is pointed at the unit.	The remote may not work properly when used at extreme angles to the front of the unit. (Page 4)

TYPICAL AIR CONDITIONER SOUNDS YOU MAY HEAR

Check if ...	Then ...
High pitched horn or pulsating noise that cycles on and off.	Compressor - Normal noise due to modern high efficiency compressors. (Page 3)
Rushing air sound.	Fan / Motor - Normal noise of higher efficiency fans pushing air further into the room. (Page 3)
Pinging or swishing sounds.	Condenser - Normal noise of water hitting the condenser to increase energy efficiency. (Page 3)
Gurgling or hissing sounds.	Evaporator - Normal noise of refrigerant passing through evaporation. (Page 3)
Beeping.	Electronic Control - Normal noise when electronic control settings are changed. (Page 3)
Vibration.	Unit Vibration - Due to poor wall or window construction or incorrect installation. (Page 3)

Warranty

WARRANTY

Full One-Year Warranty on Air Conditioner

For one year from date of purchase, when this air conditioner is operated and maintained for normal room cooling according to instructions in this owner's manual, Sears will repair it, free of charge, if defective in material or workmanship.

Full Five-Year Warranty on Sealed Refrigeration System

For five years from the date of purchase, when this air conditioner is operated and maintained for normal room cooling according to instructions in this owner's manual, Sears will repair the sealed refrigeration system (consisting of refrigerant, connecting tubing, and compressor), free of charge, if defective in material or workmanship.

Warranty Service

Warranty service is available by contacting the nearest service center in the United States.

This warranty gives you specific legal rights, and you may have other rights which vary from state to state.

SEARS, ROEBUCK and CO. Dept. 817WA, Hoffman Estates, IL 60179

Sears Service

Maintenance Agreement

"We Service What We Sell" is our assurance you can depend on Sears for service. Your air conditioner has added value when you consider that Sears has service units nationwide, staffed with professional technicians trained on all appliances Sears sells. They have the knowledge and skills, tools, parts, and equipment to insure our pledge to you that "We Service What We Sell."

Sears Maintenance Agreement

Maintain the value of your air conditioner with a Sears Maintenance Agreement. Sears air conditioners are designed, manufactured, and tested for years of dependable operation. Yet, any modern appliance may require service from time to time. The Sears Maintenance Agreement offers you an outstanding service program for your air conditioner.

The Sears Maintenance Agreement

- Is your way to buy tomorrow's service at today's price.
- Eliminates repair bills resulting from normal use.
- Allows for as many service calls as required.
- Provides an annual Preventive Maintenance Check at your request to keep your Air Conditioner in proper running condition.

For more information, call 1-800-827-6655