

This Owner's Manual is provided and hosted by [Appliance Factory Parts](http://ApplianceFactoryParts.com).

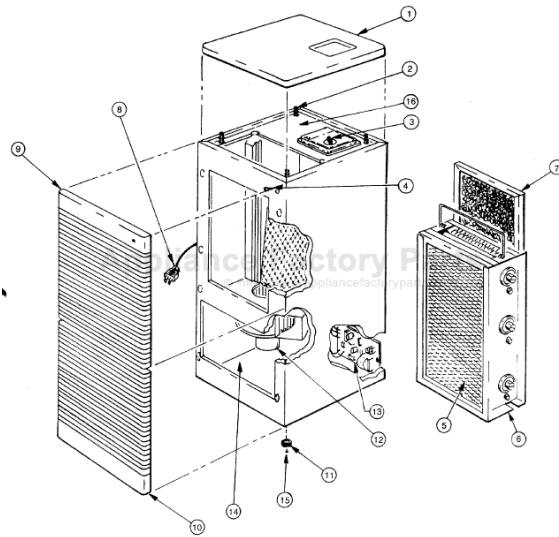

TRION 442857-007 Owner's Manual

[Shop genuine replacement parts for TRION 442857-007](#)



[Find Your TRION Air Cleaner Parts - Select From 28 Models](#)

----- Manual continues below -----

TRION
MODEL NO.

442857-001

442857-007

OWNER'S
MANUAL

CAUTION:
READ AND
SAVE THESE
INSTRUCTIONS.



TRION®
CONSOLE 250
ELECTRONIC
AIR CLEANER

- OPERATING INSTRUCTIONS
- REPAIR PARTS

Any questions or comments?
Call 1-800-227-3917
Mon. - Fri. 8 a.m. - 5 p.m. EST

INTRODUCTION

Your Trion air cleaner has been designed to let you enjoy a refreshing experience in clean air living.

Airborne particles and odors are removed from air passing through the unit by the process of electrostatic precipitation and an activated charcoal filter.

NOTE: This owner's manual should be read thoroughly before your air cleaner is operated. Retain your owner's manual for future reference.

HOW TRION'S TRUE ELECTRONIC AIR CLEANER WORKS

The air around you is filled with thousands of particles of air pollution. Some of the pollutants - dust, smoke and lint are visible to the naked eye, but most of the pollutants - pollen and bacteria, to name a few, are microscopic in size.

Polluted air enters the air cleaner through the top front grill of the air cleaner. (Figure 1) The fan pulls in dirty air and the pre-filter (Figure 2) traps large particles (hair, lint, etc.). The smaller particles (dust, smoke, pollen) in the dirty air receive a positively electrical charge as they pass through the ionizer (Figure 2.). The positive charged particles then enter the collector (Figure 2) which uses a series of alternately charged aluminum plates to attract and retain the particles. It works like a powerful magnet and the particles remain there through natural adhesion until removed by the washing process. The air then passes through a charcoal filter (Figure 2) that helps remove household odors. Finally, electronically cleaned air passes back into the room through the bottom front grill (Figure 1).

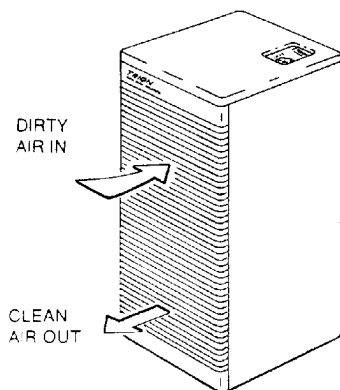

Figure 1

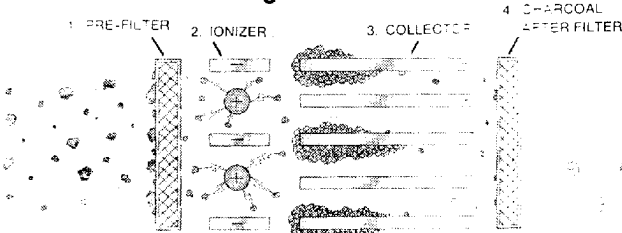

Figure 2

PREPARING FOR OPERATION

Before you operate your air cleaner you must:

1. Remove the polybag surrounding your air cleaner.
2. Remove the cabinet top by lifting up. Using the carrying handle, remove the collector cell from the cabinet and **remove the plastic bag covering the charcoal filter**. Return the charcoal filter back in its original position in the collector cell.
3. Install the collector cell into the air cleaner. (Metal aluminum pre-filter will face the front grill.)

4. Replace the cabinet top.

Your air cleaner is now ready for operation.

UNIT LOCATION

Select the location for your air cleaner with an electrical outlet nearby. An example of locating your air cleaner is shown in Figure 3.

NOTE: Do not use an extension cord to supply power to your air cleaner.

Your console air cleaner can be placed almost anywhere as long as the air can freely circulate into the top front grill and out of the bottom front grill. (Figure 1)

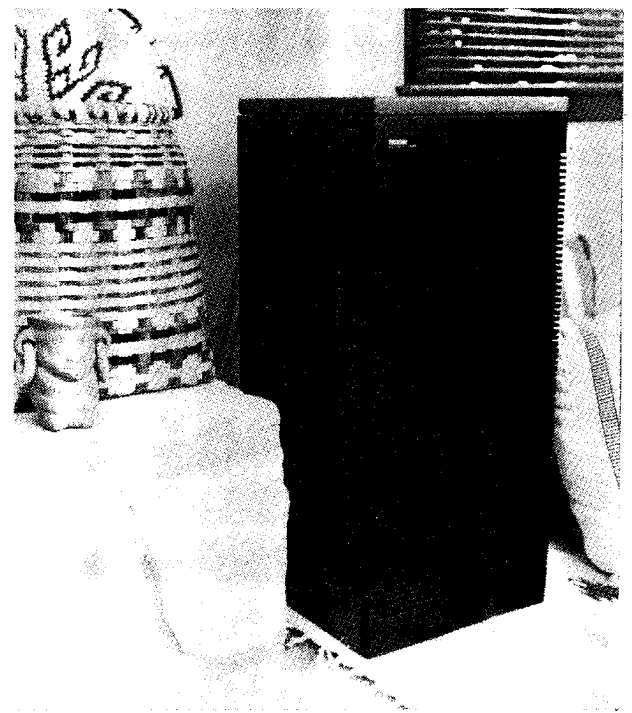

Figure 3

OPERATION

WARNING: DO NOT USE THIS ELECTRONIC AIR CLEANER WHEN OXYGEN IS BEING USED OR WHEN COMBUSTIBLE GASES ARE PRESENT.

Plug the cord into any standard household electrical outlet. (See data label for electrical specifications and power consumption. This data label can be seen when the cabinet top is removed.)

Turn the unit on by turning the On/Off switch to the desired speed. (Low, High, or Super Clean - Figure 4). The air cleaner should be set on High for 1 minute before switching to desired speed to initially start-up the unit. Your electronic air cleaner is designed for continuous operation -- **peak efficiency is obtained if the air cleaner remains on constantly.**

An operating light is located on the top right front grill and indicates that the unit is operating. (Figure 5)

The Fan Only switch is provided to assist in the drying cycle after cleaning the cell. The light does not come on during the fan cycle because the cell is not activated.

NOTE: You may notice an occasional, infrequent sharp snapping sound coming from your unit. This is a normal occurrence called "arcing" and results as large particles of dust are collected in the ionizing-collecting cell. Should prolonged or continuous arcing occur, the ionizing-collecting cell should be thoroughly cleaned and dried. (See "To Clean Cell".)

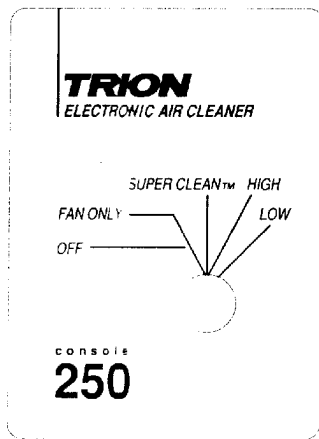

Figure 4

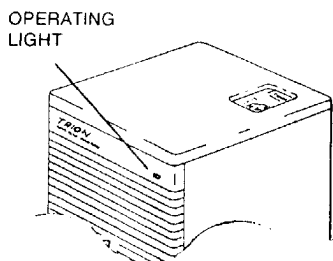

Figure 5

MAINTENANCE

CARE OF CABINET

You should treat the cabinet of your air cleaner as you would any other piece of fine furniture. Soft cloths and furniture polish will keep it clean and attractive for many years. The front grill can be cleaned using a vacuum cleaner with a brush attachment.

ELECTRONIC CELL

After several weeks of collecting dirt, dust, pollen, and other pollutants, the electronic cell of your unit will need to be cleaned.

TO REMOVE CELL FOR CLEANING

Turn off the air cleaner and unplug it from the electrical power source.

Remove the cabinet top by lifting up and lift out the cell using the flip-up handle. (Figure 6)

The front filter (metal mesh) is the pre-filter. The electronic collecting cell is the middle (large) filter, and the charcoal after-filter is in the back of the cell assembly. (Figure 7)



Figure 6

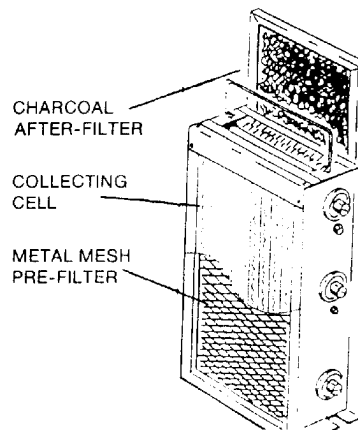

Figure 7

REPLACEMENT OF CHARCOAL FILTER

ACTIVATED CHARCOAL FILTER HELPS REMOVE HOUSEHOLD ODORS

Remove the charcoal filter from the electronic cell. The charcoal filter **cannot be cleaned**. It should be replaced every 3-6 months under average conditions. These filters are available in your retail store.

TO CLEAN CELL

NOTE: When handling the collecting cell, care should be taken to avoid damaging wires and metal plates. (Do not wash charcoal filter.)

Slide out pre-filter located on front of the cell. Rinse thoroughly with clean warm water. Set aside to dry.

Use dishwashing detergent and the hottest water available to make a good soaking solution.

NOTE: If the cell is extremely dirty, spray the cell with a household cleaning agent such as 409, Fantastik or Lysol. Let the cell soak five (5) minutes before proceeding to washing instructions.

Completely immerse the cell and soak for 20 to 30 minutes in a tub or large basin. (Figure 8)

After the cell has soaked sufficiently, the cell should be moved up and down to agitate the water until clean.

Thoroughly rinse both sides of the cell. Check to make sure the cell plates are clean. (Figure 9) If not, gently repeat the wash procedure described in the 3 previous paragraphs if necessary.

NOTE: Slight discoloration of cell plates is normal after use.

Shake as much water out of the cell as possible. Replace cell in the unit as described in the next step.

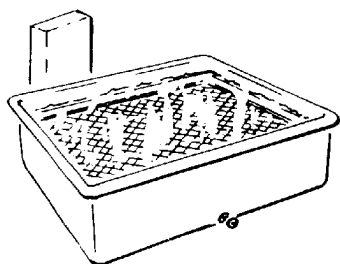

SOAK

Figure 8

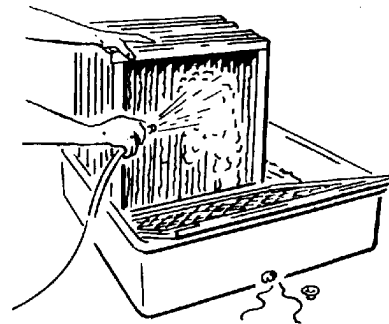

RINSE

Figure 9

TO REPLACE CELL AFTER CLEANING

NOTE: Use directions on the side of the cell for proper placement of the filters into the cell and for replacing the cell into the unit. Unit will not operate properly if the cell is not replaced correctly.

Slide the metal pre-filter in the slots provided in the front of the cell.

Slide the charcoal filter in the slots provided in the back of the cell.

Using the handle, slide the cell assembly back into the cabinet. The cell handle must be flipped toward the back of the cell, so the cabinet top can be seated properly.

TO REPLACE CABINET TOP

Replace the cabinet top by positioning over the unit and placing on cabinet. (Figure 10) Insure that the plastic ball and socket are engaged.

Plug the cord into the electrical power source.

Operate the unit in "Fan Only" position for a minimum of one hour to insure the cell is thoroughly dry. After the cell is dry, unit can be operated normally.

NOTE: An occasional "arcing" sound is normal when operating the unit immediately after cleaning the cell and should stop after a few minutes of operation.

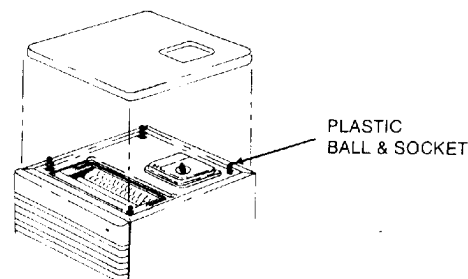

Figure 10

TROUBLESHOOTING CHECK LIST

Many times questions that appear to be major can be solved quite easily. The chart below lists potential questions/problems and how to correct them. Remember, check the simple things first.

CONDITION	WHAT TO CHECK	WHAT TO DO
Unit fails to turn on.	<ol style="list-style-type: none"> 1. Power cord 2. On/Off Switch 3. Cabinet Top is properly installed. 4. Cell is properly installed. 	<ol style="list-style-type: none"> 1. Plug in power cord. 2. Set On/Off switch for desired blower speed. 3. Refer to Page 3, "To Replace Cabinet Top." 4. Use directions on the side of the cell. Metal pre-filter will face the front grill. Cell handle must be flipped toward the back of the cell.
Unit does not operate at Low speed.	Setting of On/Off switch	Set On/Off switch on High. Run unit for one minute and reset On/Off switch at Low speed.
Unit does not remove pollutants / Reduced air flow	Ionizer-Collector Cell	<ol style="list-style-type: none"> 1. Plastic bag covering charcoal after-filter not removed. Refer to "Preparing For Operation," page 1. 2. Wash ionizer-collector cell by following the directions listed in "To Clean Cell". Operate unit for one week, remove the cell and look at the cell. If operating correctly, the cell will have a collection of "adhered pollutants" attached to the plates of the cell. (Should look like a thin layer of fine dust on cell plates.)
Unit sparks, crackles and pops.	Ionizer-Collector Cell	<ol style="list-style-type: none"> 1. Collection cell may be dirty/not dry. 2. Wash ionizer-collector cell. Make sure cell is thoroughly dry.
Unit still does not operate properly.	Re-check the above points	Have unit serviced.

NOTES:

1. Discoloration of aluminum collector cell plates is normal with use, even after cleaning.
2. Blowing smoke directly into the front grill is not a test for unit performance.

REPAIR PARTS

Key Number	Part Number	Description
1	442975-001	Cabinet Top
2	142898-001	Plastic Ball & Socket
3	242235-001	Switch Knob
4	134516-011	Operating Light Assy. - L.E.D. (Must order Item 19 also)
5	143106-001	Metal Mesh Pre-Filter
6	422167-005	Ionizer-Collector Cell
7	222838-002	Charcoal After-Filter
8	142585-002	Power Cord
9	442839-001	Top Grille
10	442839-002	Bottom Grille
11	142979-001	Rubber Cabinet Mount (1) (4 required)
12	442867-001	Motor Blower Assembly *
13	342402-101	Power Supply Assembly *
14	442965-001	Bottom Plate
15	142722-515	Phillip Truss Head Machine Screw
16	442880-001	Sub-Plate
17	242331-003	Transformer * (not shown)
18	143136-001	Grille Retainers (not shown) (Requires 4 for Item 9 & 4 for Item 10)
19	142928-001	Retainer Clip (Required for Item 4 (not shown))

* Service through bottom of unit.

