

This Owner's Manual is provided and hosted by [Appliance Factory Parts](#).



# Broil King 9887-84 Owner's Manual

[Shop genuine replacement parts for Broil King 9887-84](#)



[Find Your Broil King Grill Parts - Select From 1348 Models](#)

----- Manual continues below -----

# Broil King®

REDDI-BILT BARBECUES

ASSEMBLY MANUAL & PARTS LIST

MANUEL DE MONTAGE & LISTE DE PIÈCES



**Broil King®**  
SOVEREIGN XLS 20  
9887-14  
9887-17



**Broil King®**  
SOVEREIGN XL 70  
9887-34  
9887-37

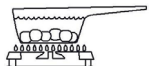

**Broil King®**  
SOVEREIGN XLS 90  
9887-44  
9887-47  
SOVEREIGN XL 90 PRO  
9887-84  
9887-87



RETAIN FOR FUTURE REFERENCE

VEUILLEZ CONSERVER POUR REFERENCE ULTERIEURE

1-800-265-2150

info@omcbbq.com

*Onward*  
MANUFACTURING COMPANY  
SINCE 1906  
585 KUMPF DRIVE LIMITED  
WATERLOO, ONTARIO, CANADA  
N2V 1K3

10084-E60 REV B 11/07

%

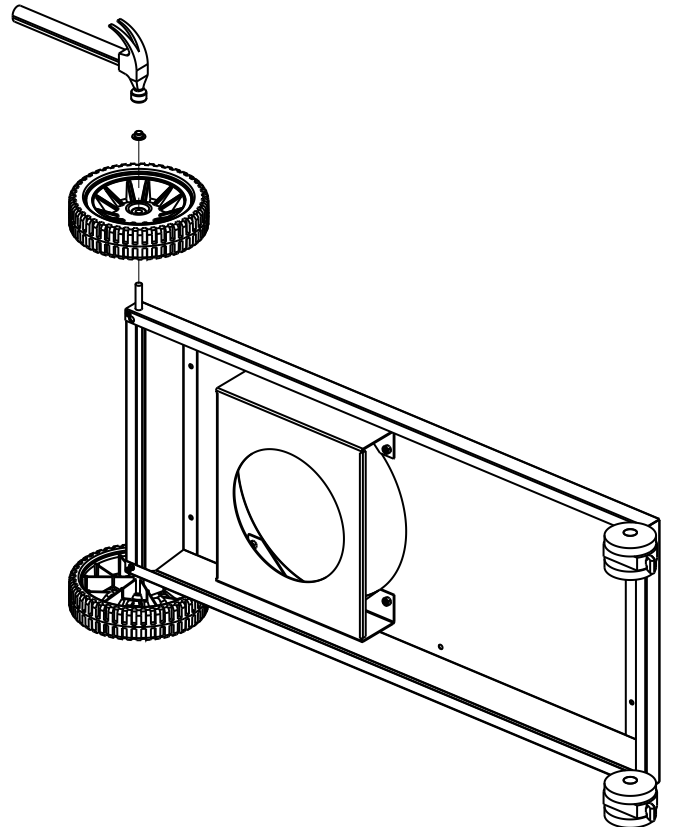
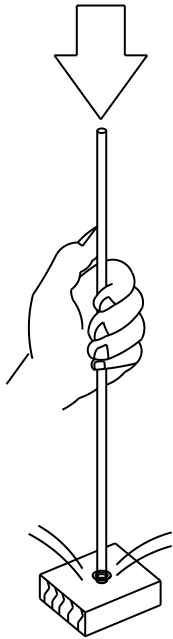
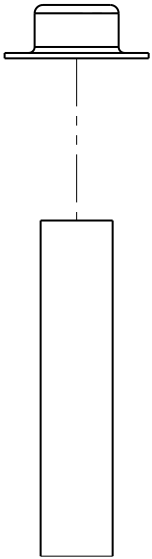
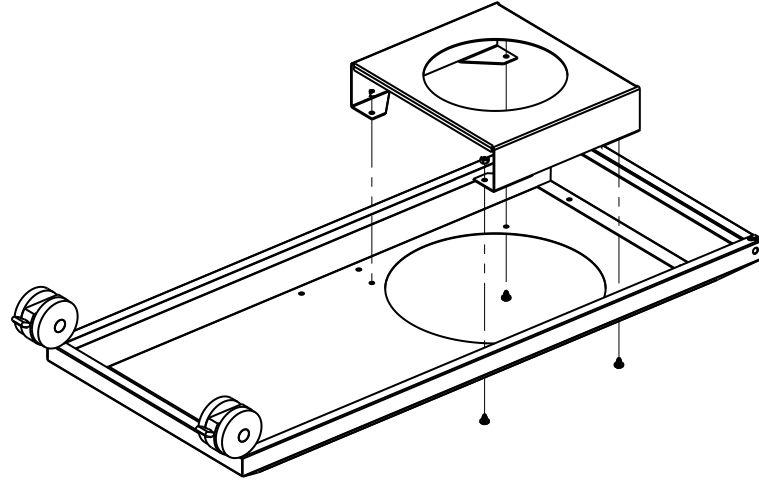
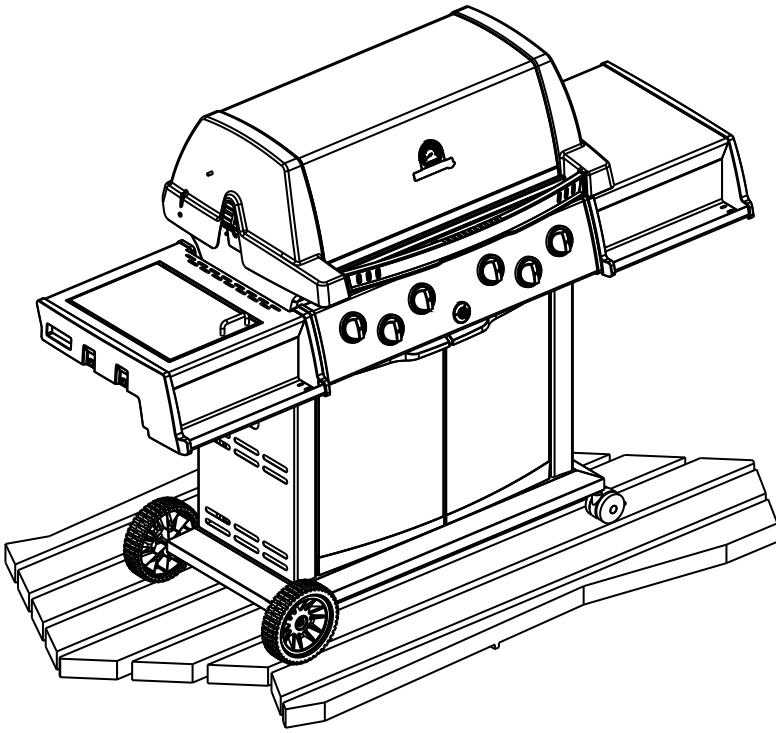
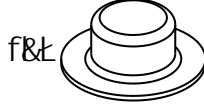
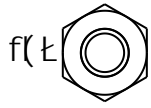
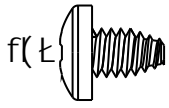

2

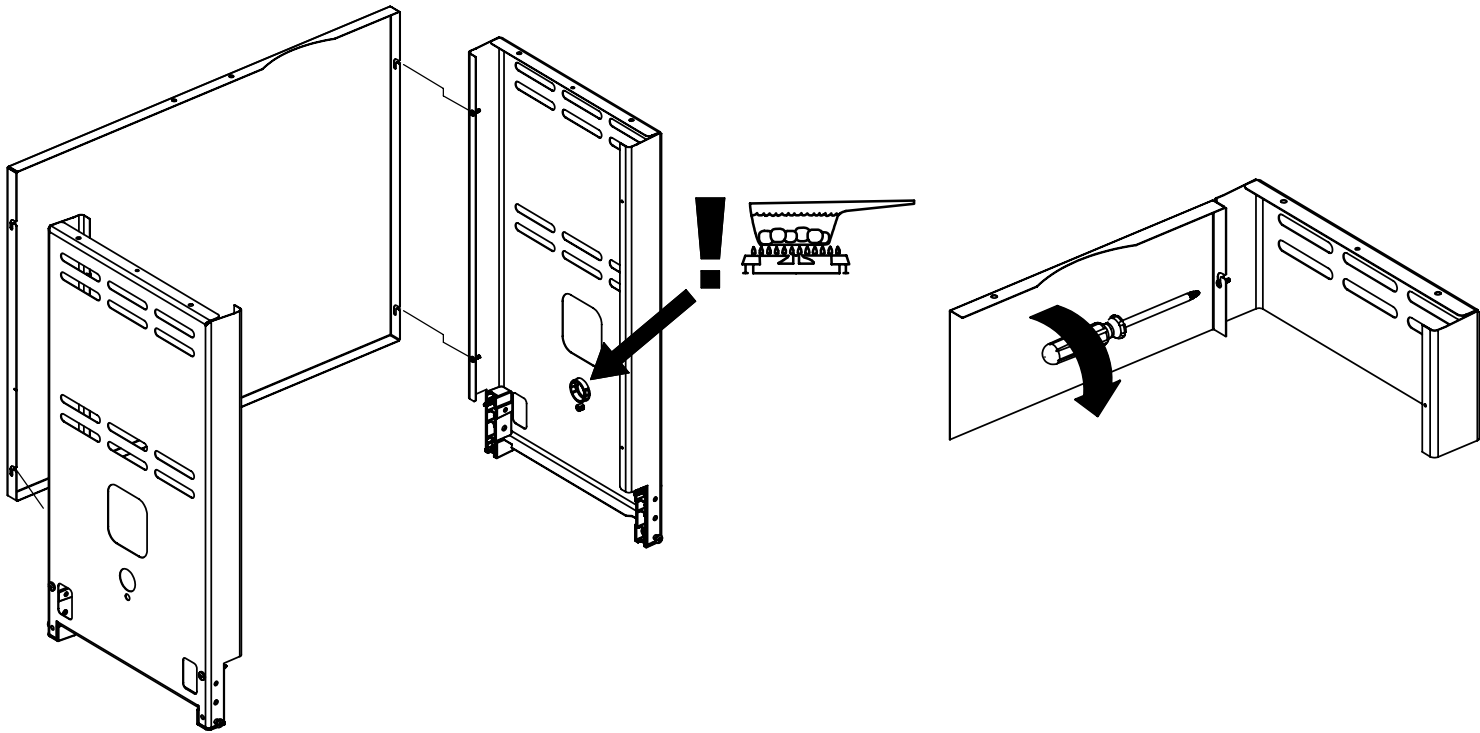

3

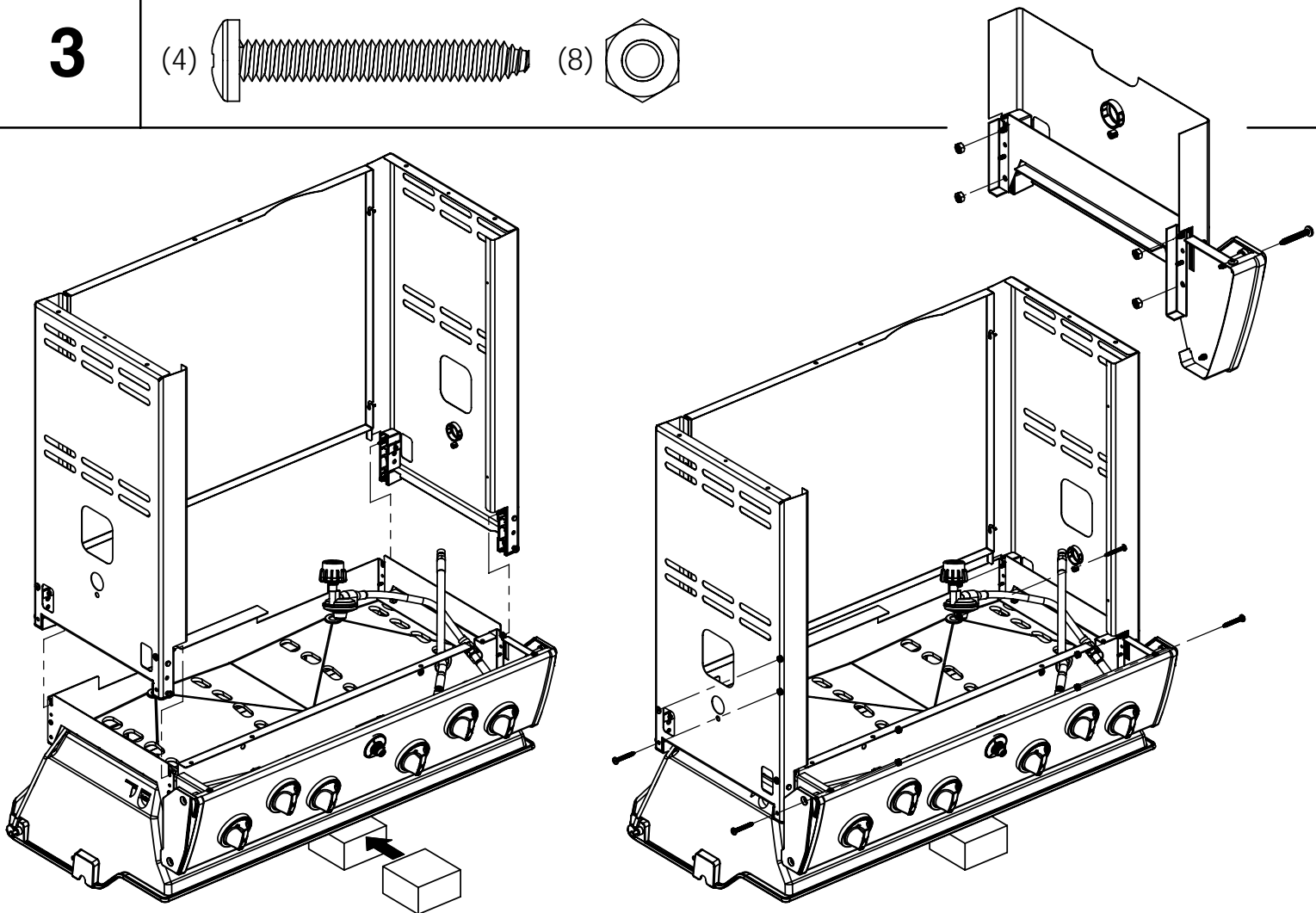
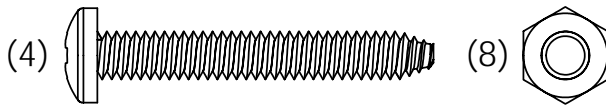

4

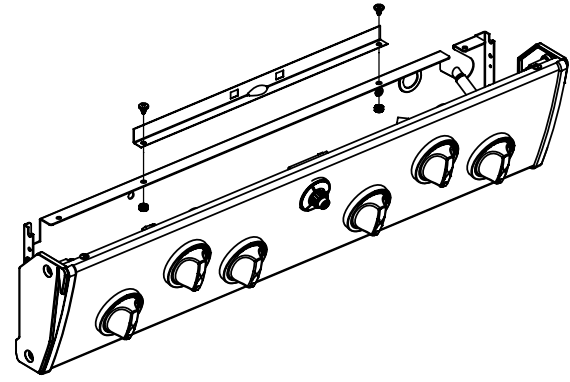
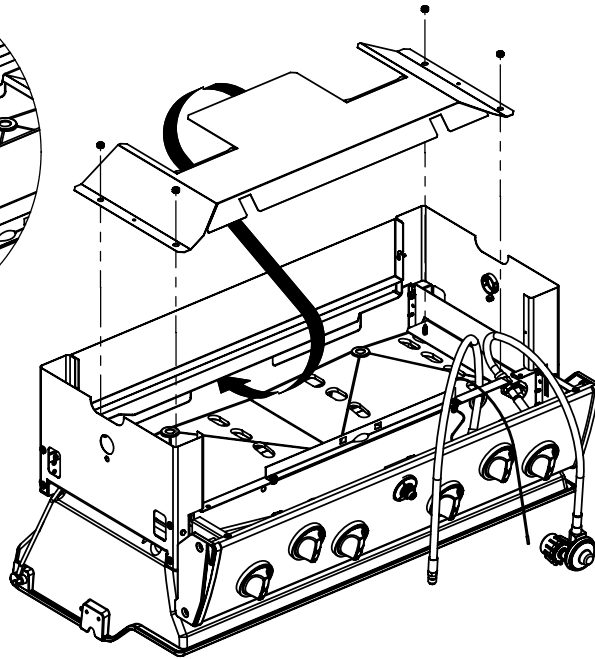
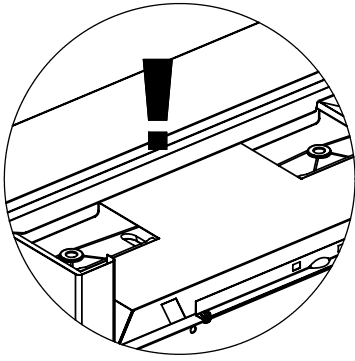
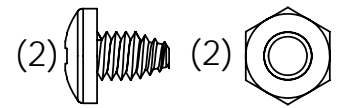
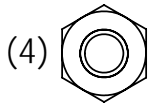

5

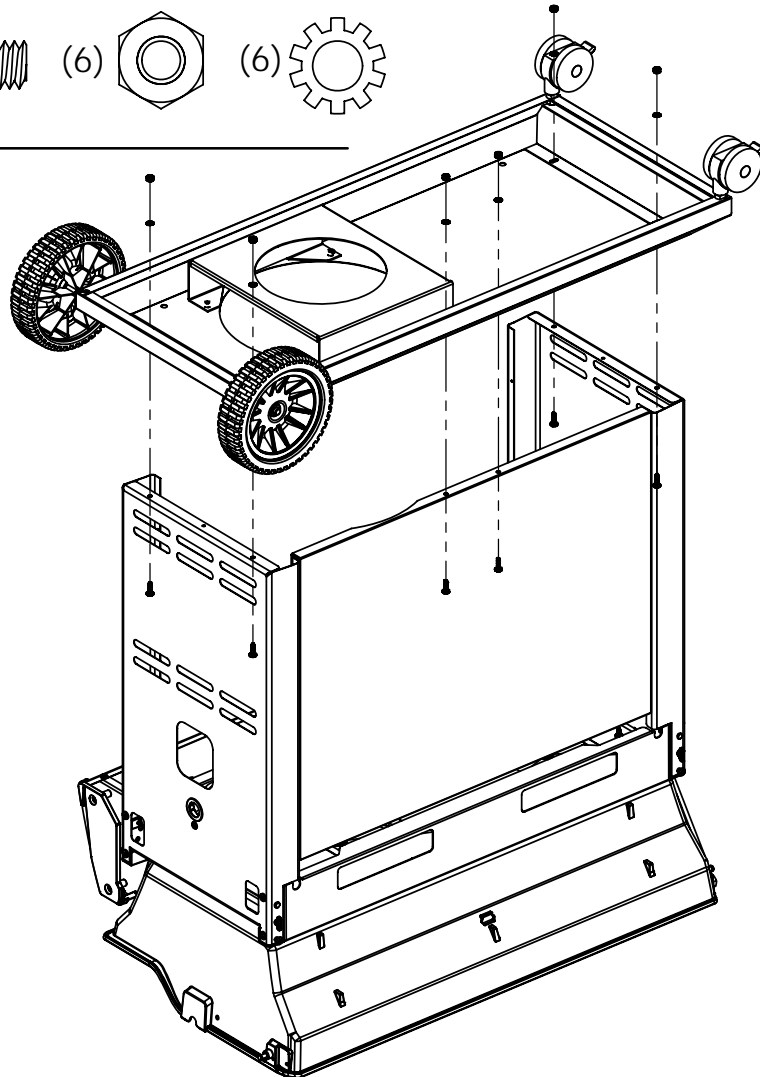
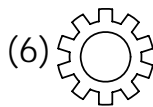
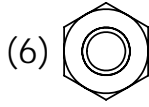
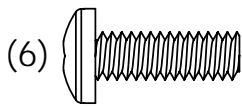

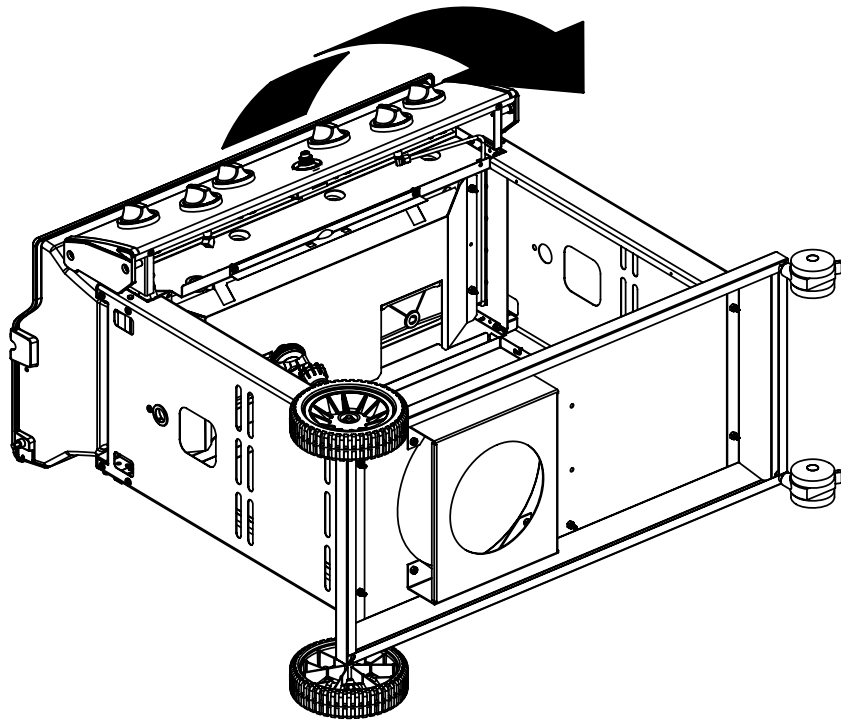
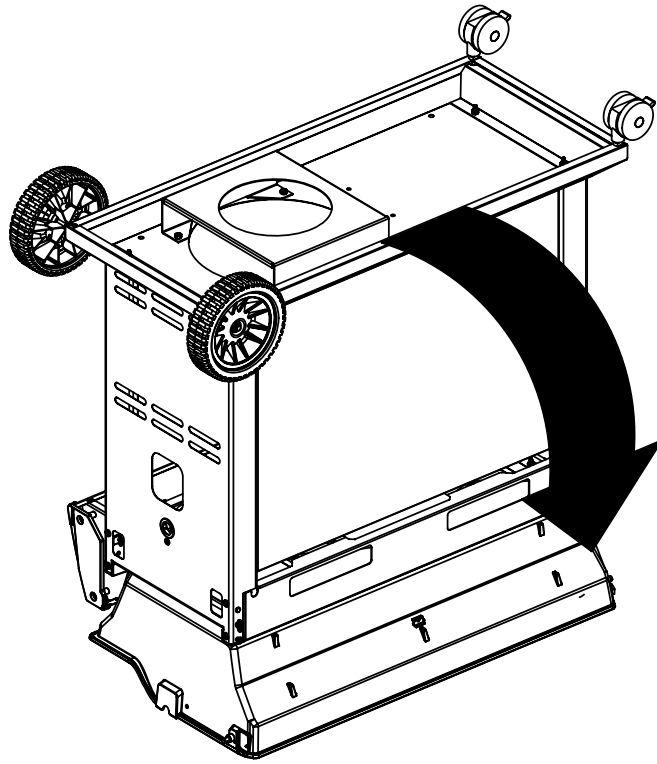

7

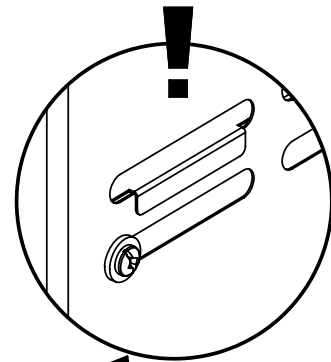
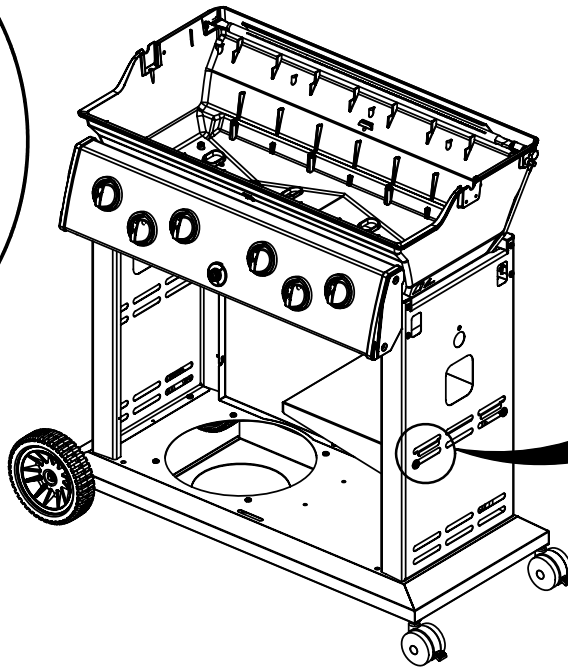
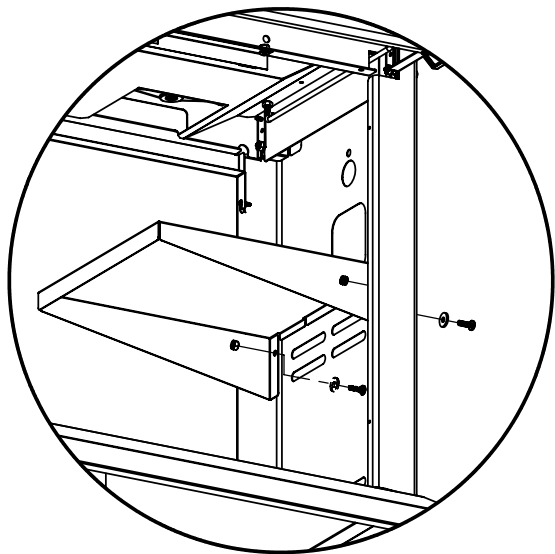
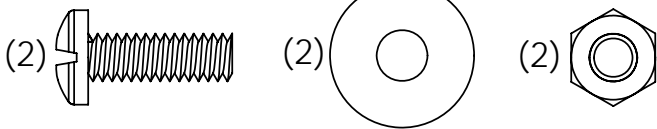

8

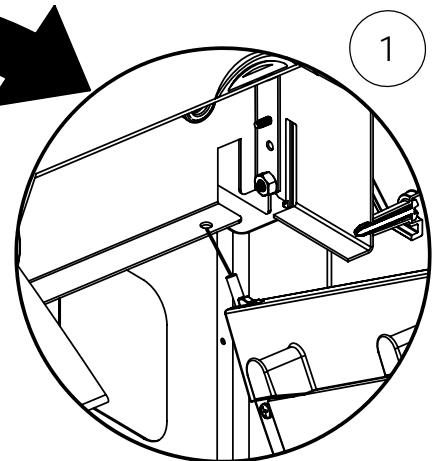
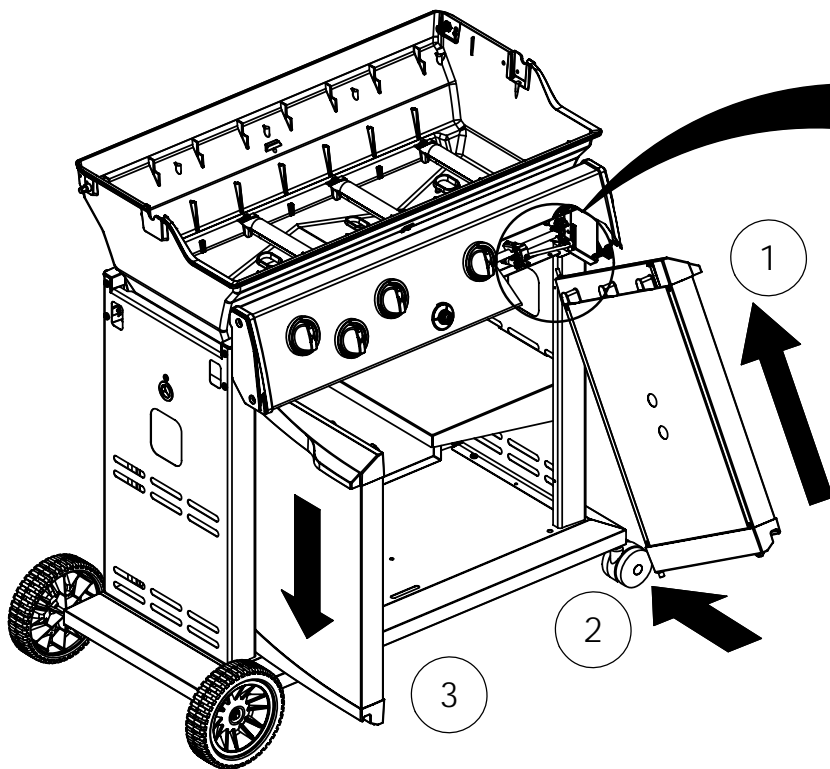

9

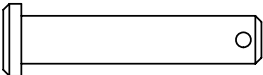
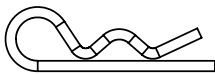
(2)  (2)  (1)

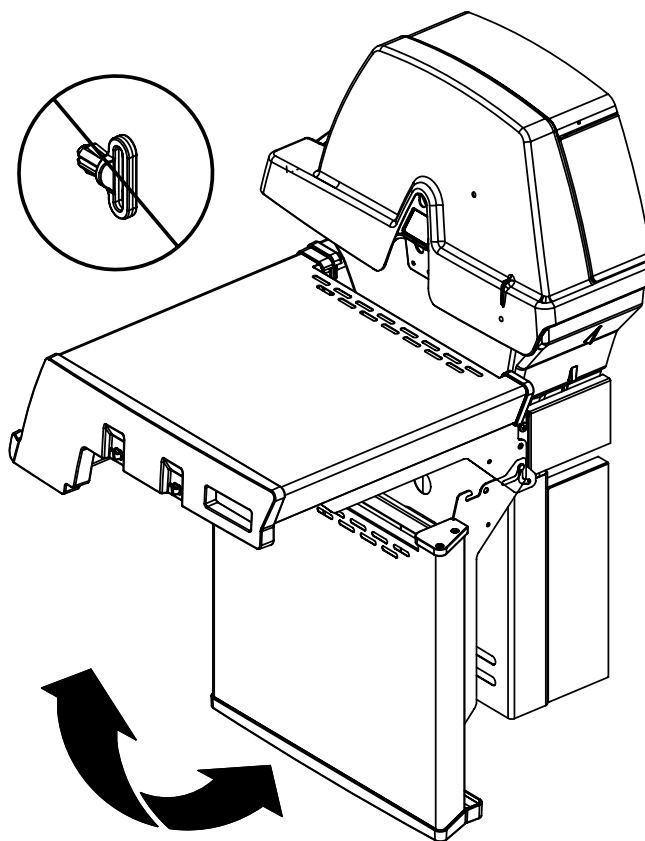
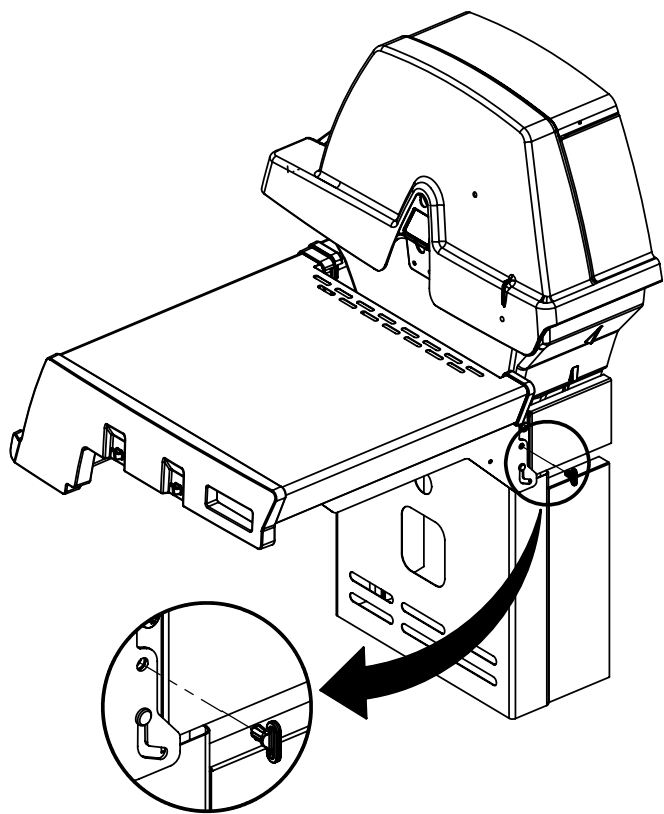
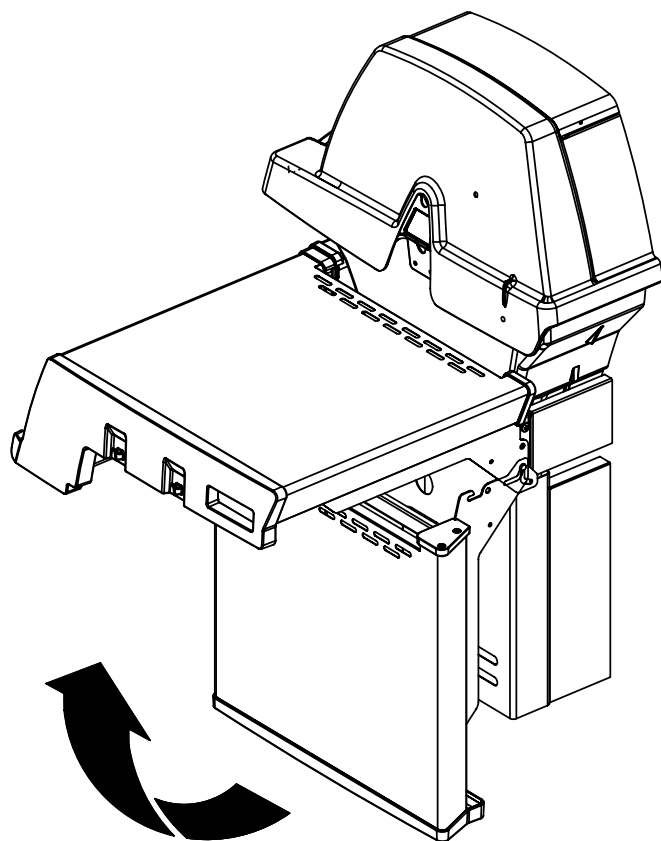
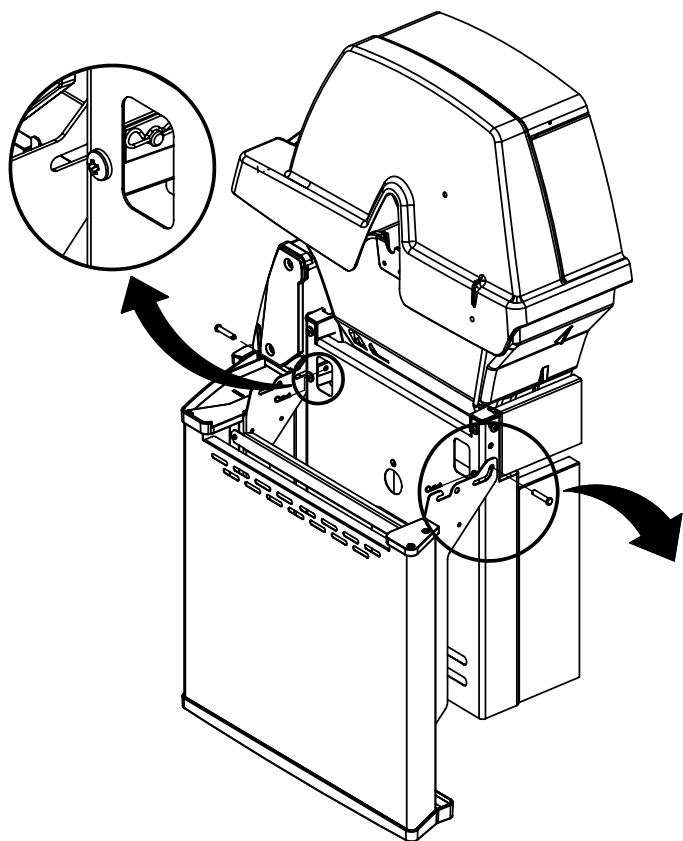
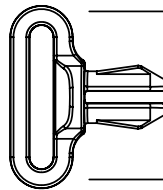

**10**

(2)

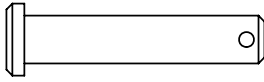

(2)

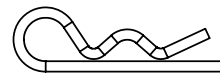

(1)

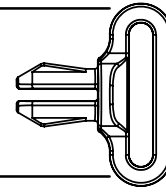

(2)

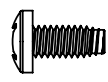

(1)

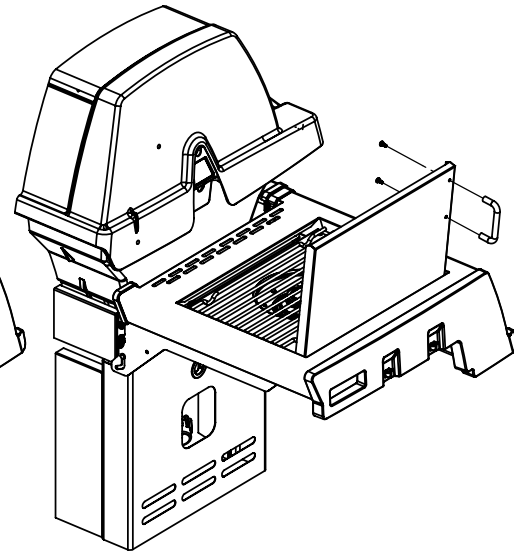
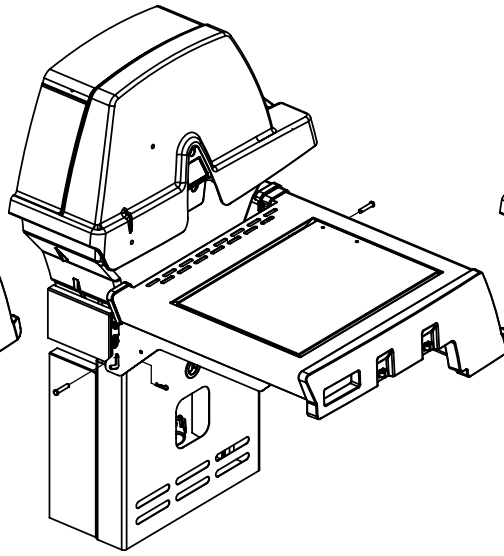
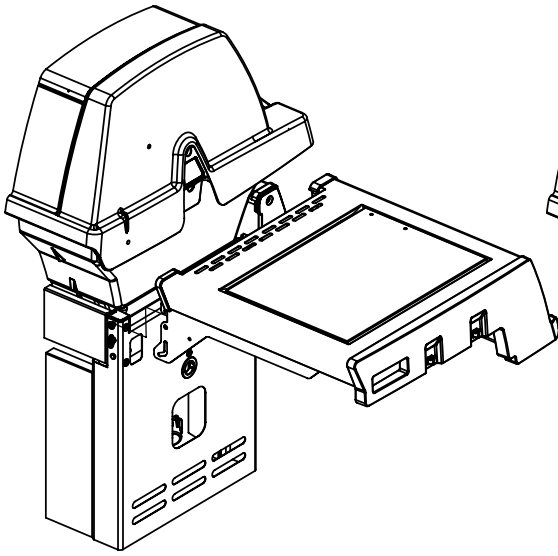
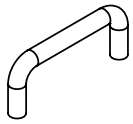

**11**

(1)

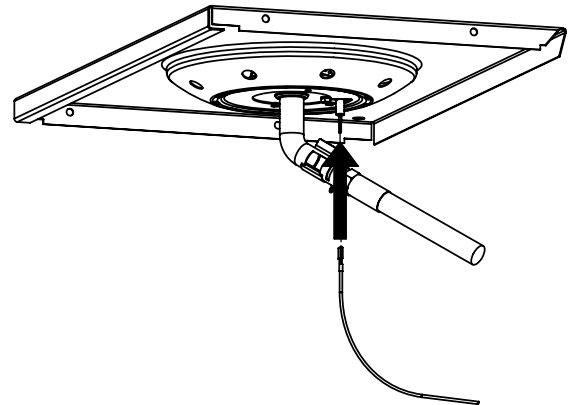
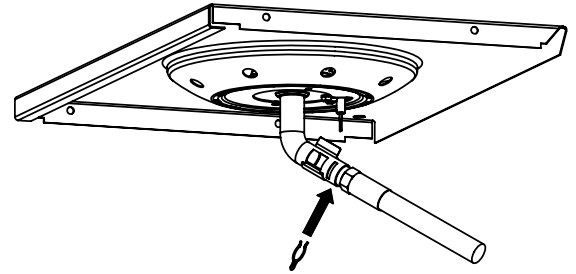
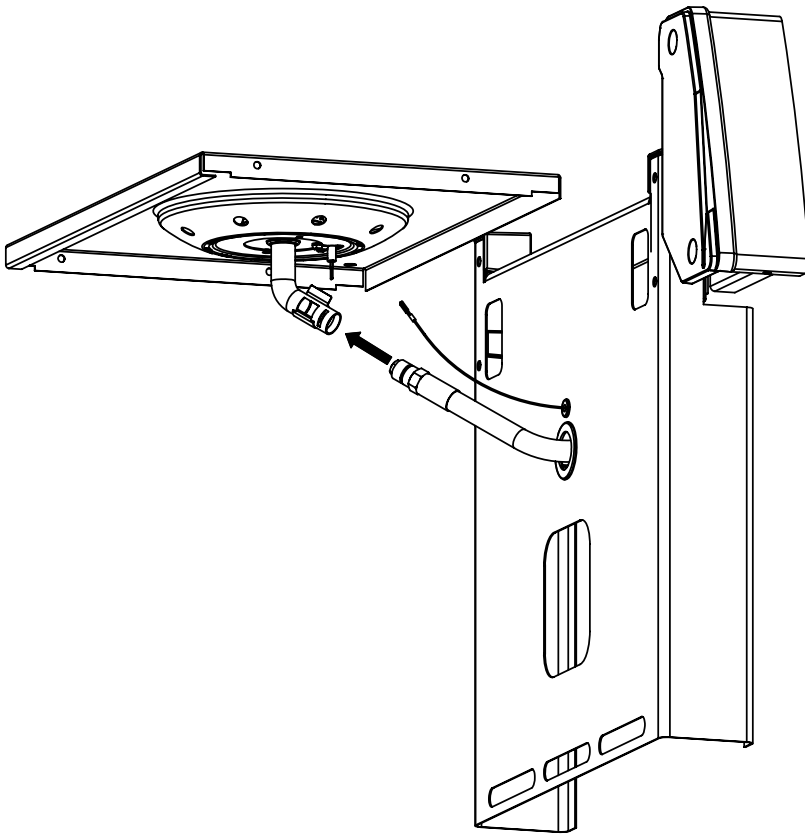
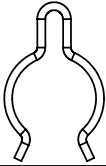

12

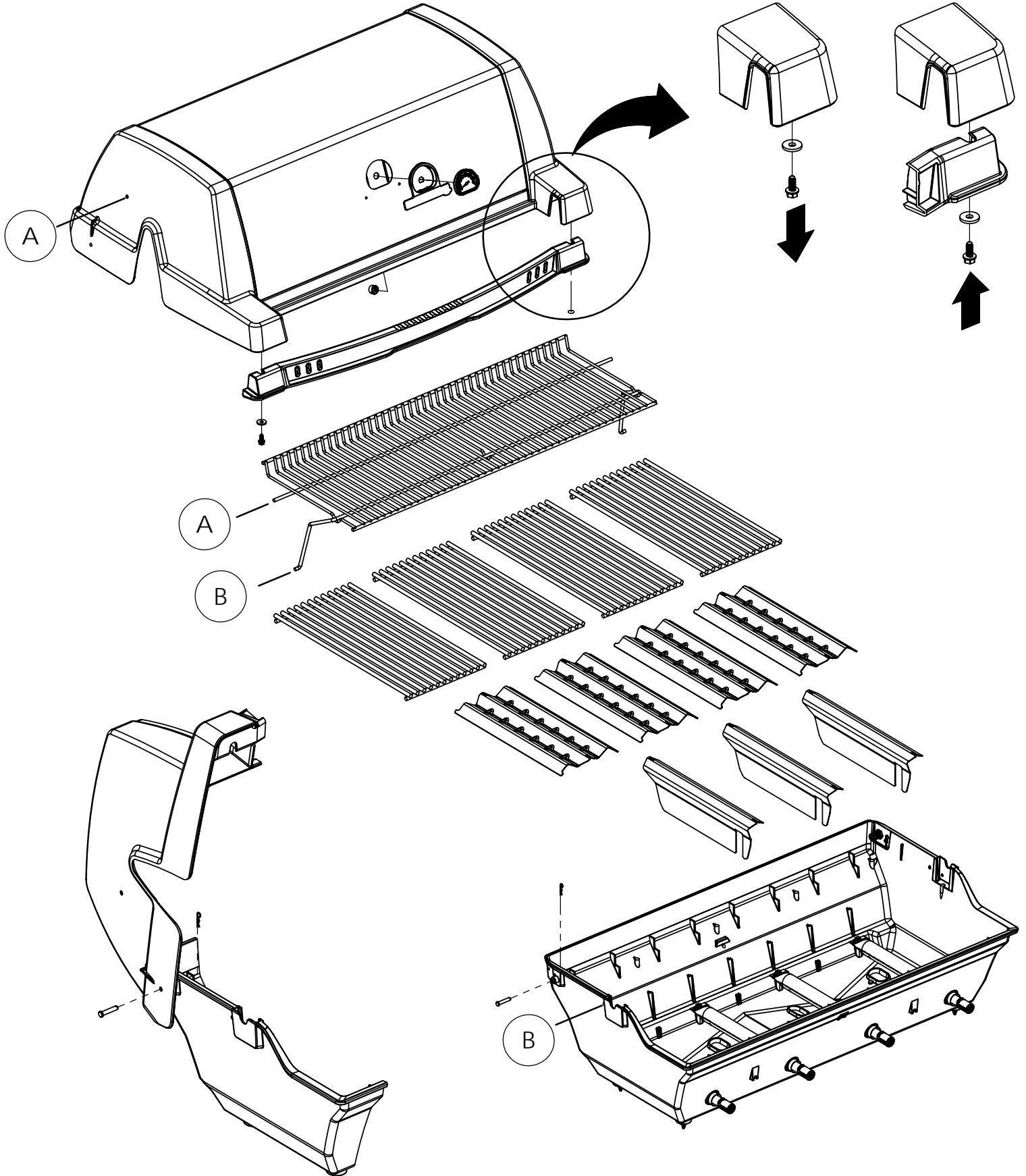
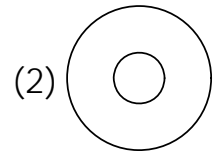
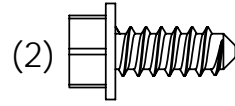
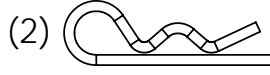
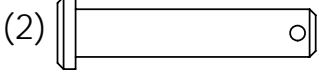

13

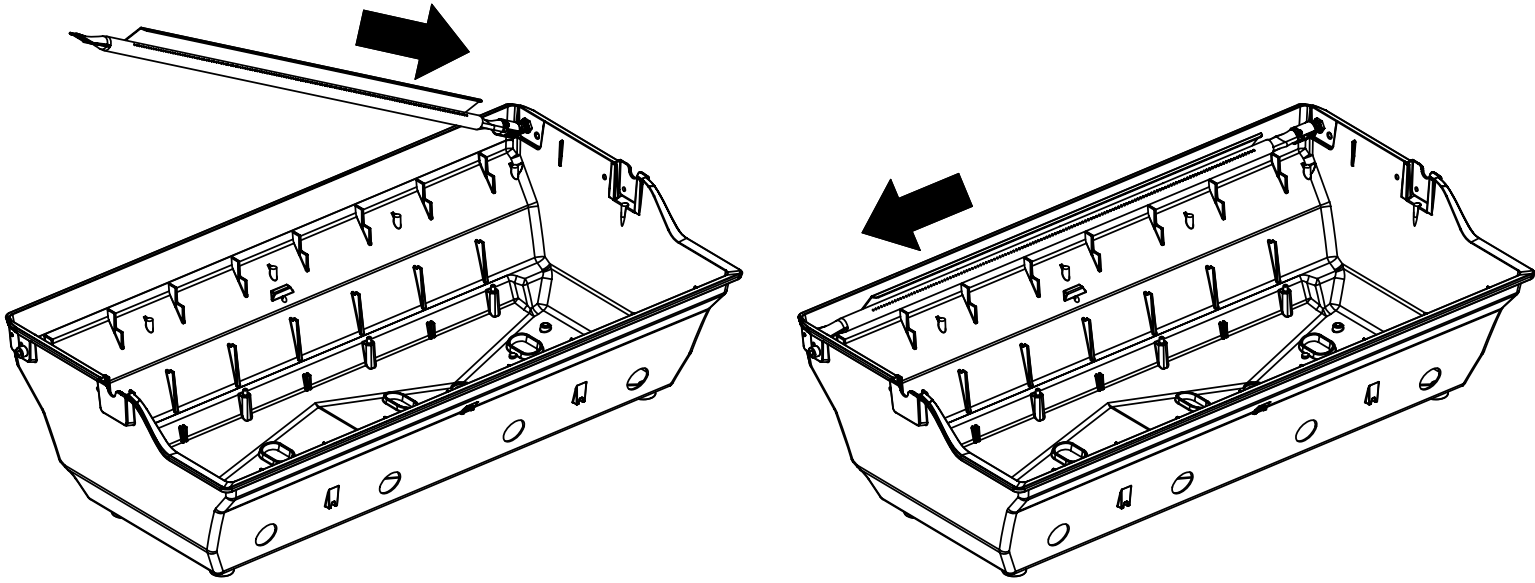

14

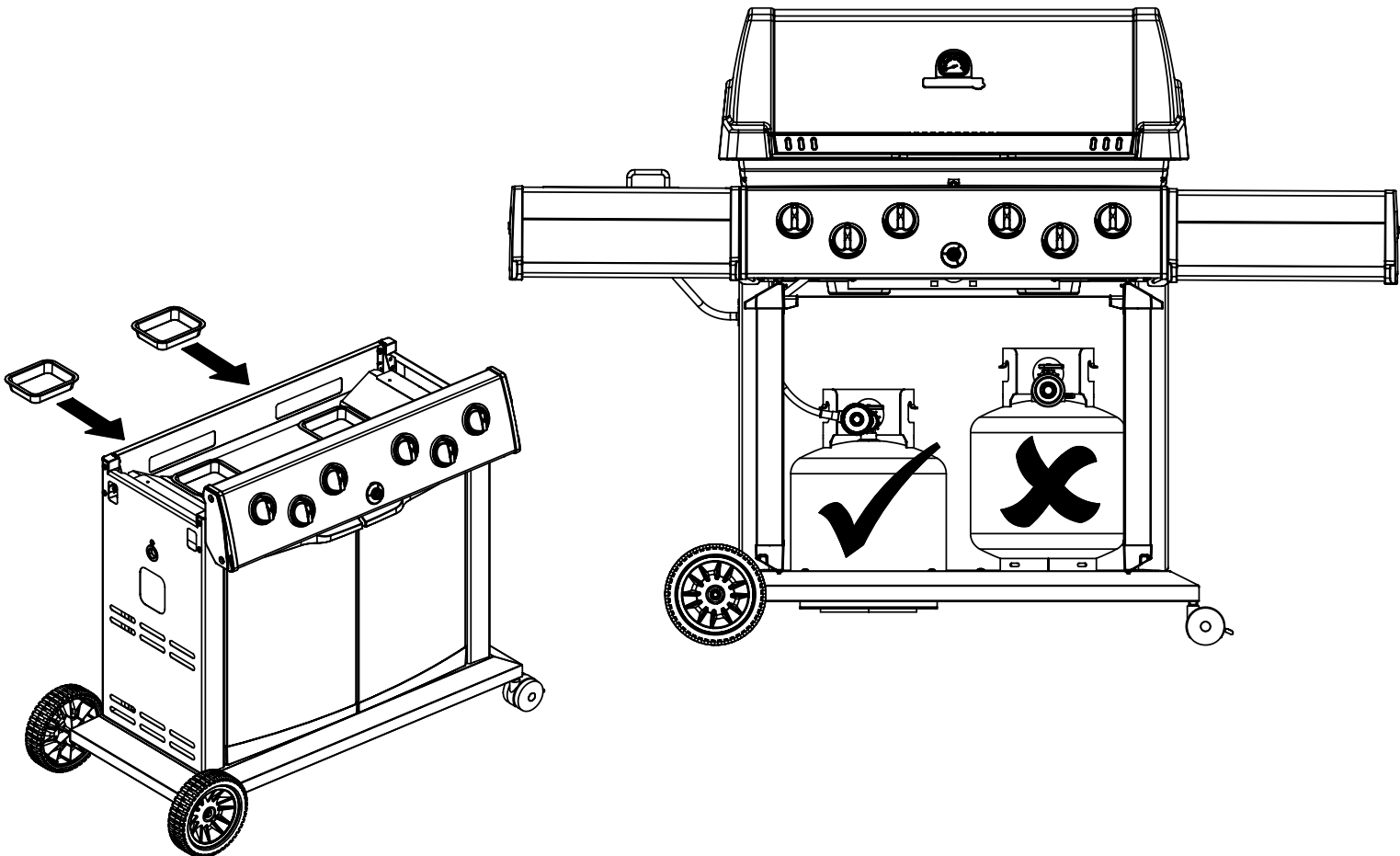

15

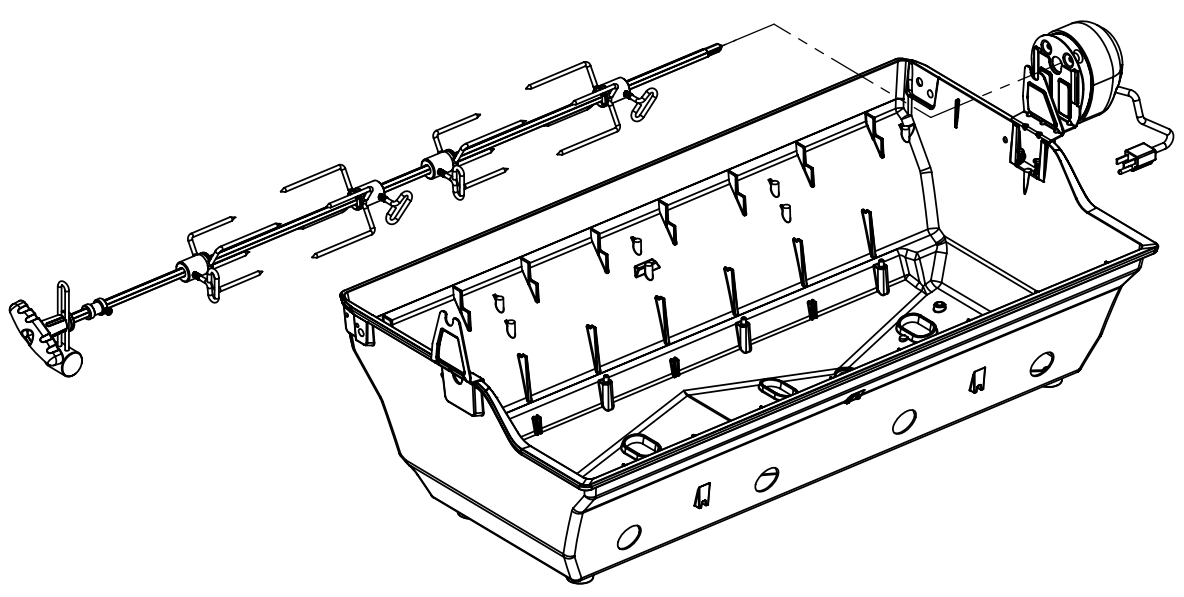
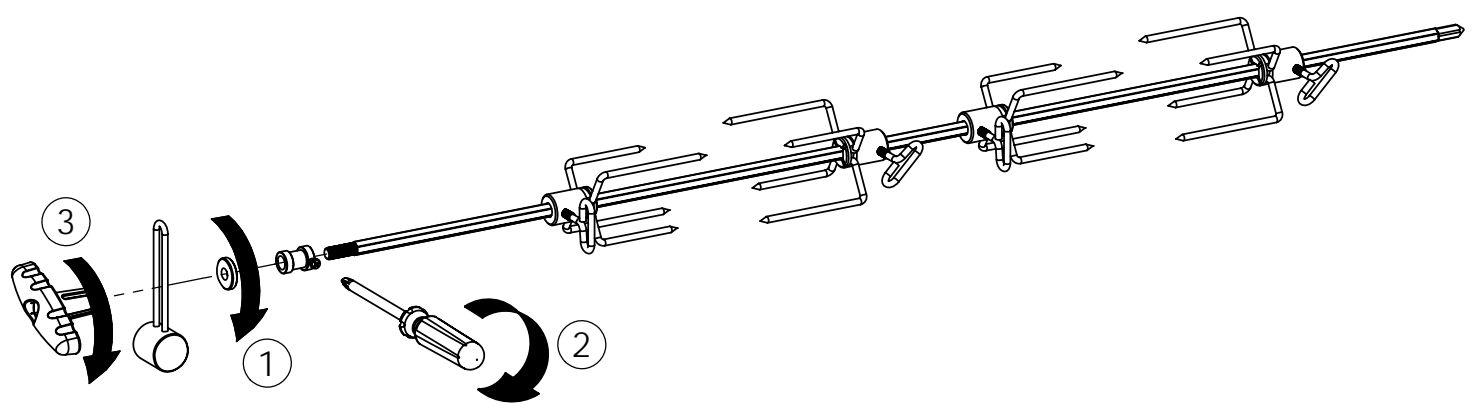
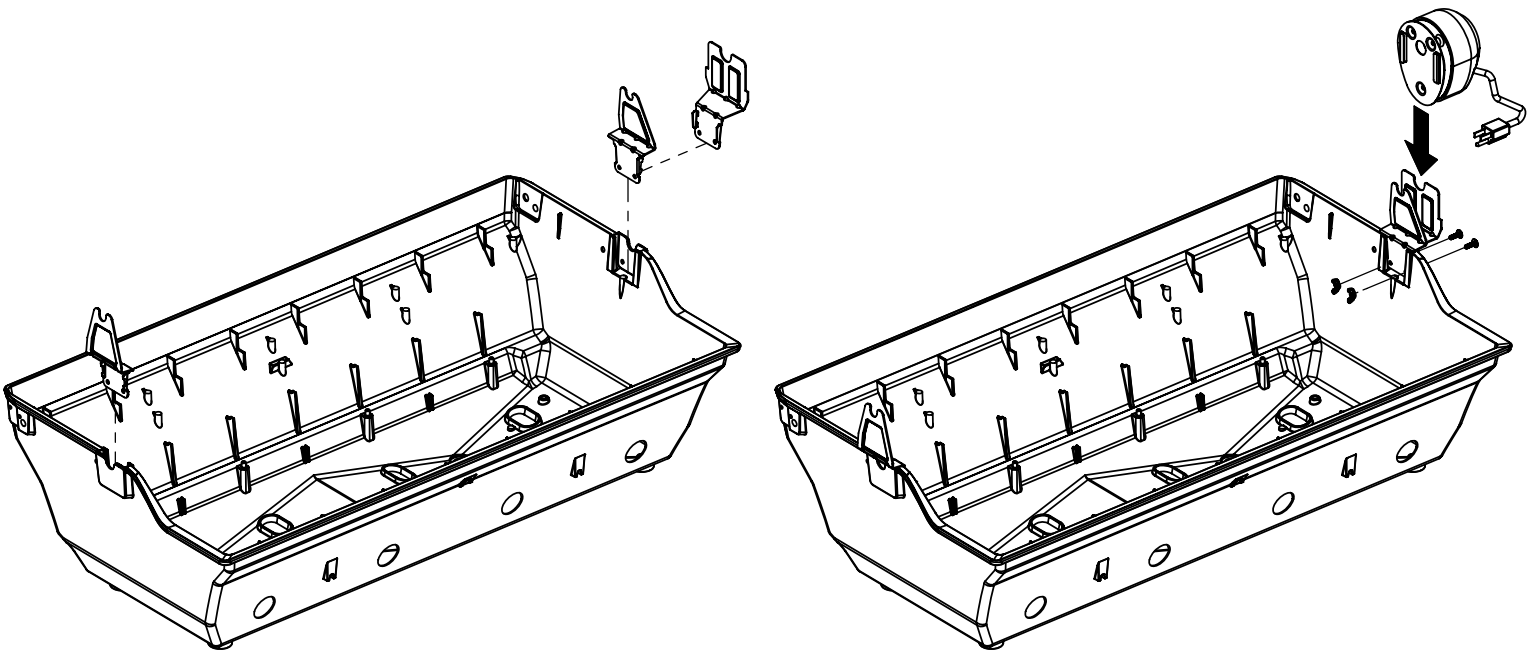
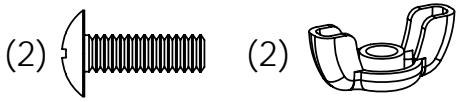



## PARTS LIST / LISTE DES PIECES

KEY #	ITEM #	DESCRIPTION	DESCRIPTION	9887-14	9887-17	9887-34	9887-37	9887-44	9887-47	9887-84	9887-87
60	10711-E47	END CAP - SHELF - RIGHT	MONTURE D'EMBOUT	1	1	1	1	1	1	1	1
61	10711-E43	EDGE CAP - SHELF - RIGHT REAR	PAC DE BORD	1	1	1	1	1	1	1	1
62	10711-E45	EDGE CAP - SHELF - RIGHT FRONT	PAC DE BORD	1	1	1	1	1	1	1	1
63	10711-E48	END CAP - SHELF - LEFT	MONTURE D'EMBOUT	1	1	1	1	1	1	1	1
64	10711-E44	EDGE CAP - SHELF - LEFT REAR	PAC DE BORD	1	1	1	1	1	1	1	1
65	10711-E46	EDGE CAP - SHELF - LEFT FRONT	PAC DE BORD	1	1	1	1	1	1	1	1
66	S13016	BURNER ROTISSERIE	BRULEUR A ROTISS	•	•	1	1	1	1	1	1
68	S21362	SPRING	RESSORT	•	•	1	1	1	1	1	1
70	Y-11990	HEX NUT	ECROU	•	•	1	1	1	1	1	1
71	10696-127	REARBURNER-ORIFICE LP	ORIFICE DU BRULEUR ARRIERE PL	•	•	1	•	1	•	1	•
	10696-185	REARBURNER-ORIFICE NG	ORIFICE DU BRULEUR ARRIERE GN	•	•	•	1	•	1	•	1
73	S21420	PUSH NUT	POUSSE ECROU	2	2	2	2	2	2	2	2
74	S21084	SCREW - #14 x 3/4	VIS - #14 x 3/4	10	10	10	10	10	10	10	10
75	10338-600	HANDLE	POIGNÉE	1	1	1	1	1	1	1	1
75A	10184-E713	STRAP - HANDLE	COURROIE - POIGNÉE	1	1	1	1	1	1	1	1
76	S21255	WASHER	RONDELLE	4	4	4	4	4	4	4	4
78	10892-22	CASTOR	ROULETTES	2	2	2	2	2	2	2	2
79	Y-11561	BOLT - 1/4-20 x 1 3/4	BOULON - 1/4-20 X 1 3/4	8	8	8	8	8	8	8	8
80	Y-11546	SCREW- 1/4-20 X 5/8	VIS - 1/4-20 X 5/8	4	4	4	4	4	4	4	4
81	Y-12860	SCREW - 1/4-20 X 1 3/8	VIS - 1/4-20 X 1 3/8	8	8	8	8	8	8	8	8
82	Y-12673	SHELF - LOCK PIN	ÉTAGÈRE - GOUPILLE DE SERRURE	2	2	2	2	2	2	2	2
82A	Y-12855A	BOLT- 1/4-20 X 3/8	BOULON - 1/4-20 X 3/8	6	2	6	2	6	2	6	2
83	Y-12310	BOLT- 1/4-20 X 3/4	BOULON - 1/4-20 X 3/4	8	8	8	8	8	8	8	8
84	S15170	AXLE	ESSIEU	1	1	1	1	1	1	1	1
85	Y-12288	NUT- 3/8	ECROU - 3/8	2	2	2	2	2	2	2	2
87	Y-11793	NUT- 1/4-20	ECROU - 1/4-20	26	22	26	22	26	22	26	22
89	Y-11211	WASHER	RONDELLE	6	6	6	6	6	6	6	6
96	S21125	SCREW - 8 X 1/2	VIS - 8 X 1/2	12	12	12	12	12	12	12	12
98	S21124	SCREW - 8 X 1/2	VIS - 8 X 1/2	36	36	37	37	38	38	38	38
98A	Y-12643	SCREW - 8 X 1/2	VIS - 8 X 1/2	16	16	16	16	16	16	16	16
99	Y-12646	SCREW - SHOULDER 8 X 1/2	VIS - 8 X 1/2	•	•	•	•	2	2	2	2
104	Y-12835	SCREW - 6-32 X 1/4	VIS - 6-32 X 1/4	•	•	•	•	2	2	2	2
105	Y-29307	NUT - 10-24	ECROU - 10-24	•	•	•	•	4	4	4	4
108	PB20-60	LID HANDLE	POIGNEE	•	•	•	•	1	1	1	1
109	S21136	SCREW - 8-32 X 3/8	VIS - 8-32 X 3/8	•	•	•	•	2	2	2	2
110	10225-T10	GRID	GRILLE	•	•	•	•	1	1	1	1
111	10390-E10	SIDE BURNER	BRULEUR DE COTE	•	•	•	•	1	1	1	1
113	10342-T18	ELECTRODE - SIDE BURNER	ELECTRODE - BRULEUR DE COTE	•	•	•	•	1	1	1	1
114	10393-K40	COVER-SIDE BURNER	COUVERCLE LATÉRAL	•	•	•	•	1	1	1	1
115	Y-29304	SCREW - 10-24 X 3/8	VIS - 10-24 X 3/8	•	•	•	•	4	4	4	4
117	10393-R50	SHELF-SIDE BURNER	SUPPORT DE BRULEUR DE COTE	•	•	•	•	1	1	1	1
121	10184-E611	BRACKET - CASTOR SUPPORT	SUPPORT DE ROULETTE	2	2	2	2	2	2	2	2
123	S15115	GREASE PAN - DISPOSABLE	CUVETTE A GRAISSE	2	2	2	2	2	2	2	2
125	Y-12220	BUSHING	DOUILLE	•	•	•	•	1	1	1	1
135	Y-12119	3/8 HEYCO BUSHING	DOUILLE DE 3/8 HEYCO	2	2	2	2	3	3	3	3
136	10184-E43	ROTISSERIE SHIELD	BOUCLIER DE ROTISSERIE	1	1	1	1	1	1	1	1
137	10184-E42	ROTISSERIE BRACKET	CROCHET DE ROTISSERIE	1	1	1	1	1	1	1	1
138	10184-E44	ROTISSERIE SHIELD	BOUCLIER DE ROTISSERIE	1	1	1	1	1	1	1	1
139	S21061	WING NUT	ECROU PAPILLON	2	2	2	2	2	2	2	2
140	Y-29306	BOLT - 10-24 x 5/8	BOULON - 10-24 x 5/8	2	2	2	2	2	2	2	2
141	S15271	ROTISSERIE HANDLE	POIGNEE DE ROTISSERIE	•	•	1	1	1	1	1	1
142	S15270	ROTISSERIE COUNTER WEIGHT	CONTREPOIDS DE ROTISSERIE	•	•	1	1	1	1	1	1
143	S15263	ROTISSERIE BUSHING	DOUILLE	•	•	1	1	1	1	1	1
144	S15287	ROTISSERIE FORKS	FOURCHETTE DE ROTISSERIE	•	•	4	4	4	4	4	4
145	S15258	SPIT ROD	BROCHETTE	•	•	1	1	1	1	1	1
146	S15236	ROTISSERIE MOTOR	MOTEUR DE ROTISSERIE	•	•	1	1	1	1	1	1
147	S15299	ROTISSERIE WASHER	RONDELLE	•	•	1	1	1	1	1	1





