

This Owner's Manual is provided and hosted by [Appliance Factory Parts](http://www.appliancefactoryparts.com).



DE'LONGHI KS500 Owner's Manual

[Shop genuine replacement parts for DE'LONGHI KS500](#)



[Find Your DE'LONGHI Small Appliance Parts - Select From 131 Models](#)

----- Manual continues below -----

CITRUS JUICER
IMPORTANT INSTRUCTIONS
SAVE THESE INSTRUCTIONS

PRESSE-AGRUMES
MODE D'EMPLOI IMPORTANT
CONSERVEZ LES PRESENTES INSTRUCTIONS

EXPRIMIDOR DE CÍTRICOS
INSTRUCCIONES PARA EL USO
REPASE Y GUARDE ESTAS INSTRUCCIONES

SPREMIAGRUMI
ISTRUZIONI IMPORTANTI
CONSERVARE LE ISTRUZIONI

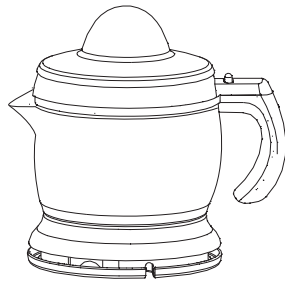

MODEL/MODELE/MODELO/MODELLO
KS500

Register this product on-line and receive a free trial issue of Cook's Illustrated. Visit www.prodregister.com/delonghi.
Visit www.delonghi.com for a list of service centers near you. (U.S. Only)

Enregistrez ce produit en ligne et recevez un numéro gratuit de Cook's Illustrated. Visitez www.prodregister.com/delonghi. Visitez www.delonghi.com pour y voir une liste des centres de réparation proches de chez vous. (É.-U. uniquement)

Registre este producto en línea y reciba un ejemplar gratis de Cook's Illustrated. Visite www.prodregister.com/delonghi.
Visite www.delonghi.com para ver la lista de centros de servicios cercanos a usted. (Solamente en los Estados Unidos)

Registra questo prodotto "on-line" per ricevere una copia omaggio della rivista. Visita www.prodregister.com/delonghi. Visita www.delonghi.com per una lista dei centri di servizio a te più vicini. (Solo negli Stati Uniti)

CARACTERISTICAS ELECTRICAS
120V-60Hz 30W

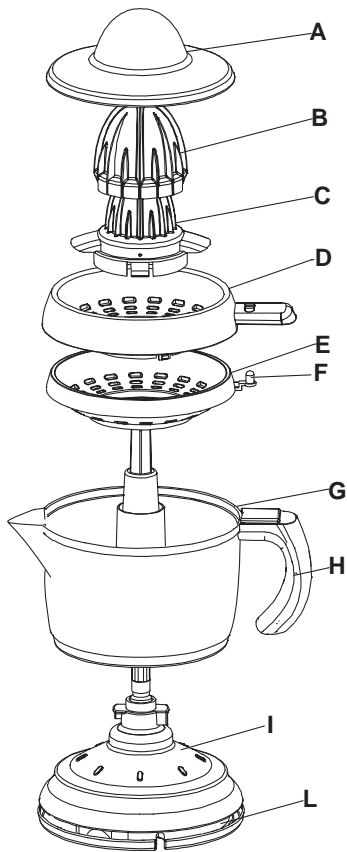

DESCRIPTION OF THE APPLIANCE

- A) Lid
- B) Juicing cone for large citrus fruit
- C) Juicing cone for small citrus fruit
- D) Upper sieve
- E) Lower sieve
- F) Adjusting slider
- G) Juicer collector
- H) Handle
- I) Motor base
- L) Cable winder



DESCRIPTION DE L'APPAREIL

- A) Couvercle
- B) Cône pour les plus grands agrumes
- C) Cône pour les plus petits agrumes
- D) Filtre supérieur
- E) Filtre inférieur
- F) Curseur de réglage filtre
- G) Bol pour le jus
- H) Poignée
- I) Bloc moteur
- L) Enroule-câble



DESCRIPCIÓN DEL APARATO

- A) Tapa
- B) Cono para cítricos más grandes
- C) Cono para cítricos más pequeños
- D) Filtro superior
- E) Filtro inferior
- F) Cursor de regulación filtro
- G) Recipiente para el zumo
- H) Asa
- I) Cuerpo motor
- L) Recoge cable



DESCRIZIONE DELL'APPARECCHIO

- A) Coperchio
- B) Cono per agrumi più grandi
- C) Cono per agrumi più piccoli
- D) Filtro superiore
- E) Filtro inferiore
- F) cursore di regolazione
- G) Contenitore succo
- H) Maniglia
- I) Corpo motore
- L) Avvolgicavo

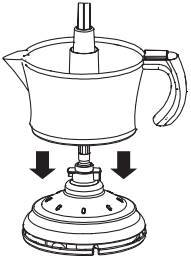

Fig.1

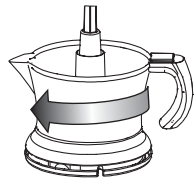

Fig.2

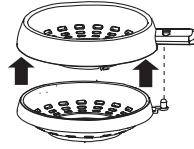

Fig.3

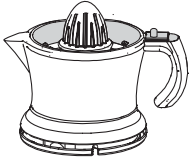

Fig.4



Fig.5

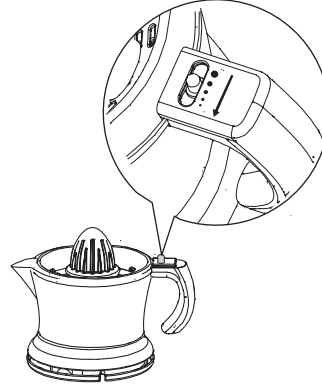

Fig.6



IMPORTANT SAFEGUARDS

READ ALL THESE INSTRUCTIONS

When using electrical appliances, basic safety precautions should always be followed, including the following:

- **READ ALL INSTRUCTIONS.**
- After having removed the appliance from the packaging, make sure that it is complete in all of its components. If there is any doubt, do not use the appliance and return it to be checked by qualified personnel.
- The plastic bag containing the appliance should be kept away from children as it may represent a suffocation hazard.
- Do not touch hot surfaces. Use handles or dials.
- To protect against fire, electric shock and injury to persons, never immerse the cord or plug in water or other liquids.
- Close supervision is necessary when any appliance is used by or near children.
- Unplug from outlet when not in use and before cleaning. Allow to cool before inserting or removing parts and before cleaning the appliance.
- Do not operate any appliance with a damaged cord or plug or after the appliance malfunctions, or has been damaged in any manner. Return appliance to the nearest authorized service facility for examination, repair or adjustment.
- The use of accessory attachments not recommended by the appliance manufacturer may cause injuries.
- Do not use outdoors.
- Do not let cord hang over edge of table or counter, or touch hot surfaces.
- Do not place on or near a hot gas or electric burner, or in a heated oven.
- To disconnect, remove the plug from the wall outlet.
- After unpacking the appliance, be sure to dispose carefully of the plastic bags so that children or the infirm cannot reach them.
- Ensure that your mains supply voltage is the same as that marked on the underside of your citrus juicer.
- Take care when pouring - do not over-fill the citrus juicer as juice may enter into the switch mechanism.
- Do not allow the cord to hang over the edge of the table or work surface, or anywhere it may be accidentally caught or tripped over.
- Never move the appliance while it is in use.
- Do not use the appliance if you have wet hands.
- The power cable must not be replaced by the user, as this requires the use of special tools. If the power cable is damaged, contact an authorized Service Center.
- If the citrus juicer is overfilled, juice may overflow.

HOUSEHOLD USE ONLY

SAVE THESE INSTRUCTIONS

SHORT CORD INSTRUCTIONS

- A short power cord is provided to reduce risks resulting from becoming entangled in or tripping over a longer cord.
- Longer, detachable power supply cords or extension cords are available and may be used if care is exercised in their use.
- If an extension cord is used, the marked electrical rating should be at least as great as the electrical rating of the appliance. If the appliance is provided with 3- wire, grounding type cord, the extension should be a **GROUNDING TYPE 3 - WIRE CORD**. The longer cord should be arranged so that it will not drape over the counter-top or table top where it can be pulled on by children or tripped over.
- Your product is equipped with a polarized alternating current line plug (a plug having one blade wider than the other). This plug will fit into the power outlet only one way.
This is a safety feature. If you are unable to insert the plug fully into the outlet, try reversing the plug. If the plug should still fail to fit, contact your electrician to replace your obsolete outlet. Do not defeat the safety purpose of the polarized plug.

BEFORE USING THE APPLIANCE, PLEASE READ

Check that the voltage of the electrical outlet corresponds to that which is indicated on the label on the appliance. Before using the appliance for the first time, carefully wash and dry the juicing cones, the filter and the juice collecting container.

HOW TO USE

- Position the juice collector (G) onto the motor (I) (Fig. 1) and turn it clockwise until it clicks into place (Fig. 2).
- Attach the lower sieve (E) to the upper sieve (D) (Fig. 3), making sure to insert the adjusting slider (F) into the corresponding slot on the handle of the upper filter (D).
- Put the filter into the carafe and then the juicing cone in a way that the teeth on the cone line up with the grooves in the filter and make sure that the filter tightly grips the juice collecting container (Fig. 4).
- Insert the plug into the electrical outlet.
- By simply placing the citrus fruit onto the cone and pressing slightly, the appliance will begin to operate and extract juice into the collecting container.
- According to the type of fruit to be juiced, either the smaller or larger cone can be used. The larger cone is suitable for oranges, the smaller one for lemons. To use the larger cone, simply place it on top of the smaller one (fig.5).
- The motor is equipped to rotate in either direction to obtain optimal juicing effect; press the fruit intermittently and the motor will invert its rotational direction.
- The quantity of pulp in the juice can be regulated by adjusting the filter regulator (F) to reduce or enlarge the holes in the filter (see fig. 6).
To reduce the quantity of pulp, move the regulator (F) as far as it will go to the left. To increase the pulp, move the regulator (F) in the opposite direction.

Important: Do not operate the Citrus Juicer continuously for more than 1 minute.

If a large quantity of juice needs to be extracted, the juicer should operate 15 seconds and pause 15 seconds. The total running time shall not exceed 5 minutes.

CLEANING- MAINTENANCE- SUGGESTIONS

- All cleaning and maintenance procedures should be done when the appliance is unplugged from the electrical outlet.
- Remove the filter by lifting it off. Detach the cone from the filter.
- Proceed to eliminate the bits of pulp and fruit remaining and clean the various components.
- In order to avoid having the remainders dry on the appliance and be therefore difficult to remove, disassemble the appliance and clean the components immediately following use.
- Wash the juice collecting container, filter, juicing cones and the lid in lukewarm water with mild detergent. The components should not be washed in the dishwasher.
- The motor and its components should be cleaned only with a damp cloth.



This warranty applies to all products with De'Longhi or Kenwood brand names.

LIMITED WARRANTY

What does the warranty cover?

We warrant each appliance to be free from defects in material and workmanship. Our obligation under this warranty is limited to repair at our factory or authorized service center of any defective parts or part thereof, other than parts damaged in transit. In the event of a products replacement or return, the unit must be returned transportation prepaid. The repaired or new model will be returned at the company expense. This warranty shall apply only if the appliance is used in accordance with the factory directions, which accompany it, and on an Alternating current (AC) circuit.

How long does the coverage last?

This warranty runs for one year (1) from the purchase date found on your receipt and applies only to the original purchaser for use.

What is not covered by the warranty?

The warranty does not cover defects or damage of the appliance, which result from repairs or alterations to the appliance outside our factory or authorized service centers, nor shall it apply to any appliance, which has been subject to abuse, misuse, negligence or accidents. Also, consequential and incidental damage resulting from the use of this product or arising out of any breach of contract or breach of this warranty are not recoverable under this warranty. Some states do not allow the exclusion or limitation of incidental or consequential damage, so the above limitation may not apply to you.

How do you get service?

If repairs become necessary, see contact information below:

U.S. Residents:

Please contact our toll free hotline at 1-800-322-3848 or log onto our website at www.delonghi.com. For all accessories, spare parts or replacement parts, please contact our parts division at 1-800-865-6330.

Residents of Canada: Please contact our toll free hotline at 1-888-335-6644 or log onto our website at www.delonghi.com.

Residents of Mexico: Please refer to the Limited Warranty statement for Mexico. Please refer to the back page of the manual for De'Longhi addresses.

The above warranty is in lieu of all other express warranties and representations. All implied warranties are limited to the applicable warranty period set forth above. This limitation does not apply if you enter into an extended warranty with De'Longhi. Some states do not allow limitations on how long an implied warranty lasts, so the above exclusions may not apply to you. De'Longhi does not authorize any other person or company to assume for it any liability in connection with the sale or use of its appliance.

How does state law apply?

This warranty gives you specific legal rights, and you may also have other rights, which vary from state to state.



De'Longhi America, Inc.
Park 80 West, Plaza One
Saddle Brook, NJ 07663
1-800-322-3848

De'Longhi Canada, Inc.
6150 McLaughlin Road
Mississauga, Ontario
L5R 4E1 Canada
1-888-335-6644

FIDUCIA ITALIANA S.A DE C.V
Pestalozzi #814
Col. Narvarte
Del. Benito Juarez
C.P. 03100
tels: 5543 1447
lada sin costo: 01 800 711 8805

www.delonghi.com

Printed in China

521IDL/05.06