

This Owner's Manual is provided and hosted by [Appliance Factory Parts](http://www.appliancefactoryparts.com).



DE'LONGHI DCM900 Owner's Manual

[Shop genuine replacement parts for DE'LONGHI
DCM900](#)



[Find Your DE'LONGHI Coffee Maker Parts - Select From 289 Models](#)

----- Manual continues below -----



Living innovation

Instruction Manual
Coffee Maker

Mode D'emploi
Cafetière

Manual de instrucciones
de cafetera automática

Manuale di istruzioni
Macchine da caffè



DCM900 Series / Serié

**PRODUCT REGISTRATION / Registro Del Producto
ENREGISTREMENT DU PRODUIT / Registro Del Prodotto**

Register this product on-line and receive a free trial issue of Cook's Illustrated.
Visit www.prodregister.com/delonghi. *(U.S. and Canada)*

Enregistrez ce produit en ligne et recevez un numéro gratuit de Cook's Illustrated.
Visitez www.prodregister.com/delonghi. *(E.U. et Canada)*

Registre este producto en línea y reciba un ejemplar gratis de Cook's Illustrated.
Visite www.prodregister.com/delonghi. *(Los Estados Unidos y Canada)*

Registra questo prodotto "on-line" per riceuere una copia omaggio délla rivista.
Visita www.prodregister.com/delonghi. *(Stati Uniti e Canada)*

**SERVICE CENTERS / Centros De Servicios
CENTRES DE RÉPARATION / Centri Di Servizio**

Visit www.delonghi.com for a list of **service centers** near you. *(U.S. and Canada)*

Visitez www.delonghi.com pour y voir une liste des centres de réparation
proches de chez vous. *(E.U. et Canada)*

Visite www.delonghi.com para ver la lista de centros de servicios cercanos a
usted. *(Los Estados Unidos y Canada)*

Visita www.delonghi.com per una lista dei centri di servizio a te piu vicini. *(Stati
Uniti and Canada)*

Read and Save These Instructions - Lisez et conservez ces instructions
Guardar estas instrucciones después de haberlas leído - Leggete e conservate queste istruzioni

INTRODUCTION

Thank you for choosing De'Longhi!

A steadfast commitment to quality and innovation has made De'Longhi a leader in household appliances around the world for over 100 years. Our Italian heritage is reflected in every product, every feature and every design. And we are dedicated to creating products that enhance and benefit the lives of our consumers. We hope that you'll enjoy your De'Longhi appliance for years to come!

Now that you've discovered us, we think you'll agree, that each and every De'Longhi appliance is truly a "Living Innovation".

Get to know us better...visit us at www.delonghi.com for our full line of products.



TABLE OF CONTENTS

Product Registration.....	<i>Front Cover</i>
Service Centers.....	<i>Front Cover</i>
Important Safeguards.....	4
Short Cord Instructions.....	6
Before First Use.....	6
Know Your Coffee Maker.....	7
Operating Your Coffee Maker.....	9
Decalcification.....	12
Cleaning Your Coffee Maker.....	13
Limited Warranty.....	14
Customer Service.....	15
Purchase Parts and Accessories.....	15
Corporate Information.....	15
Technical Information.....	15

IMPORTANT SAFEGUARDS

When using electrical appliances, basic safety precautions should always be followed to reduce the risk of fire, electrical shock and/or personal injury.

1. Read all instructions carefully.
2. Watch out for the release of steam, and never lift the filter holder lid during the brewing cycle.
3. Always lift the filter holder using the opening tab.
4. Do not touch hot surfaces. Use the handle on the carafe.
5. Never touch the warming plate.
6. To protect against electrical shock, do not place cord, plug or coffee maker in water or other liquid.
7. Close supervision is necessary when any appliance is used by or near children.
8. Turn off and unplug from outlet before filling with water, when not in use and before cleaning. Allow to cool before putting on or taking off parts, and before cleaning the appliance.
9. Do not operate any appliance with a damaged cord or plug or after the appliance malfunctions or has been damaged in any manner. Return appliance to authorized service facility for examination, repair or adjustment.
10. The use of accessory attachments is not recommended by the manufacturer. It may be dangerous and should be avoided.
11. Do not use outdoors.
12. Do not let cord hang over edge of table or counter, or touch hot surfaces. Wind excess cord into the cord storage device.
13. Do not place on or near hot gas or electric burner, or in heated oven.
14. Always plug cord into the wall outlet before turning on any controls. To disconnect turn power OFF, then remove plug from wall outlet.
15. Always use cold water to make coffee. Warm water or other liquids could cause damage to the coffee maker. Always make sure there is water in the tank before turning the machine on.
16. Scalding may occur if the cover is lifted or removed during the brewing cycle.
17. Do not use this appliance for other than intended use.
18. Do not set a hot carafe on a wet or cold surface.
19. Do not place hot carafe on or near paper, cloth or other flammable material.
20. Never use the carafe on a range top or in a microwave oven.

IMPORTANT SAFEGUARDS

21. Do not allow liquid to evaporate from carafe. Do not heat carafe when empty.
22. Do not move entire unit when carafe contains hot liquid.
23. Use the lid on the carafe while brewing and pouring coffee.
24. Discard carafe if damaged in any manner, or a carafe having a loose or weakened handle. A chip or crack could result in breakage or contaminate liquid contents with glass particles.
25. Do not clean carafe with scouring powders, steel wool pads or other abrasive materials.
26. This carafe is designed for use with this coffee maker only.
27. **WARNING:** To reduce the risk of fire or electrical shock, do not remove the bottom cover. No user serviceable parts inside. Repairs should be performed by authorized service personnel only. **NOTE:** Do not immerse in any liquid.
28. **WARNING:** Do not lift the water tank lid during operation, could cause severe burns. Always lift the lid by the opening lip and when the unit is turned off.
29. Do not touch hot parts.
30. Save these instructions.

Household Use Only
SAVE THESE INSTRUCTIONS

SHORT CORD INSTRUCTIONS

A short power cord is provided to reduce the risk resulting from entanglement or tripping over a longer cord. Longer detachable power supply cords are available and may be used if care is exercised in their use. If a longer detachable power cord or extension cord is used (1) the marked electrical rating of the extension cord should be at least as great as the electrical rating of the appliance, and (2) the longer cord should be arranged so that it will not drape over the countertop or table top where it can be pulled on by children or tripped over unintentionally. The electrical rating of the appliance is listed on the bottom of the unit. If the appliance is of the grounded type, the extension cord should be a grounded type 3 wire cord. This appliance has a polarized plug. One blade is wider than the other. To reduce the risk of electrical shock this plug will fit in a polarized plug only one way. If the plug does not fit, contact a qualified electrician. Do not attempt to modify the plug in any way.

BEFORE FIRST USE

Place the box on a large, sturdy flat surface. Carefully unpack your coffee maker and remove all packaging material and literature. Remove any labels or stickers from the coffee maker. To remove any dust that may have accumulated during packaging, you may wipe the unit with a clean, damp cloth. Dry thoroughly. Do not immerse the coffee maker in water or other liquid. Clean the carafe, carafe lid, filter basket and filter in warm water with mild detergent. Rinse and dry thoroughly. Do not use harsh or abrasive cleaners. (See "Cleaning Your Coffee Maker" section of this manual for detailed instructions.) Keep all plastic bags away from children.

NOTE: We recommend that prior to brewing your first pot of coffee, operate the coffee maker once or twice with water only and without ground coffee or with just a small amount of ground coffee. This will remove any dust that may have settled inside the coffee maker, which may affect the flavor of the coffee.

IMPORTANT: Use cold water only. The automatic drip system works best with cold water.

KNOW YOUR COFFEE MAKER

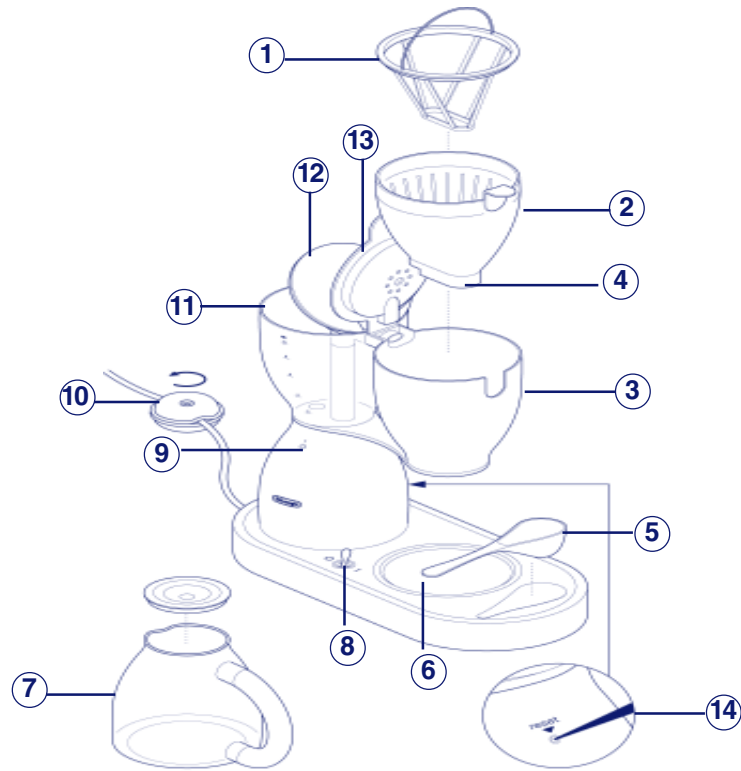

- | | |
|--------------------------------------|-----------------------------------|
| 1. Permanent Gold-Tone Filter | 8. On/Off Switch with Power Light |
| 2. Filter Basket | 9. Decalcification Warning Light |
| 3. Filter Holder | 10. Cord Storage |
| 4. Anti-Drip Device (Pause 'N Serve) | 11. Water Tank |
| 5. Measuring Spoon | 12. Water Tank Lid |
| 6. Non-Stick Warming Plate | 13. Filter Holder Lid |
| 7. Glass Carafe and Lid | 14. Decalcification Reset Button |

KNOW YOUR COFFEE MAKER

FEATURES:

1. **SEAMLESS ALUMINUM BODY** Beautiful seamless design is stylish, yet durable.
2. **EXCLUSIVE DUAL-HEATING SYSTEM** The first part of the system, the stainless steel boiler, creates a faster brewing process. The second part of the system, a dedicated heating element for the warming plate, maintains the optimal keep warm temperature.
3. **PERMANENT GOLD-TONE FILTER:** Specially designed to keep even the finest grounds out of your coffee. And because it's more durable than most filters, it lasts longer.
4. **REMOVABLE FILTER BASKET:** Allows for convenient filling and easy cleaning.
5. **NON-STICK WARMING PLATE:** Keeps coffee hot after brewing is complete, and makes cleanup quick and easy.
6. **CORD STORAGE:** Keeps power cord out of harm's way when coffee maker is not in use.
7. **DECALCIFICATION WARNING LIGHT:** Lets you know when it's time to decalcify the coffee maker.
8. **PAUSE 'N SERVE:** Allows you to interrupt the brewing cycle and pour a cup of coffee before the entire carafe is finished brewing. To restart the brewing process, return the carafe to warming plate and coffee will automatically begin flowing through filter basket. Make sure carafe is placed all the way on the non-stick warming plate. **CAUTION:** Do not remove carafe for longer than 30 seconds or the filter basket will overflow.
9. **WATER LEVEL INDICATOR:** Large easy-to-read numbers indicate how many cups of water have been poured into the coffee maker.
10. **2-HOUR AUTOMATIC SHUT-OFF** for safe operation.

OPERATING YOUR COFFEE MAKER

PREPARING COFFEE MAKER FOR BREWING COFFEE:

1. Place the coffee maker on a flat, level surface away from any edge.
2. Plug the unit into a 120V / 60Hz only outlet.
3. The lid of the carafe must be fitted properly during the brewing process. And the carafe must be set on the warming plate.
4. **WARNING: The lid of the coffee maker must be completely closed during operation.**

FILLING THE WATER TANK:

5. Remove the lid from the water tank.
6. Fill the tank with the desired amount of cold water. The water level must be between the top and bottom cup marks. **NOTE:** Do not fill above the MAX level.
7. Always use cold water.

NOTE: The amount of brewed coffee after the brewing process is complete will always be slightly less than the amount of water placed in the coffee maker's water tank, since some water is absorbed by the coffee grounds and filter. Add a little extra water at the beginning so that you have the exact number of cups desired.

PREPARING THE COFFEE:

8. Lift the lid on the filter holder. Be sure the filter basket and filter are properly positioned inside the filter holder. The permanent gold-tone filter (included) may be used instead of or in addition to a paper filter (not included). If using paper filters, insert a #4 cone-shaped filter into the filter basket before filling with coffee.
9. Place the desired amount of ground coffee in the filter using the measuring spoon provided. According to coffee industry standards, use one standard coffee measure (2 level tablespoons) of grounds for each cup/mug of water. After using your coffee maker several times, the amount of coffee may be adjusted to suit your particular taste by decreasing or increasing the amount of coffee used. **NOTE:** Be sure to use coffee grounds prepared specifically for use with automatic drip coffee makers.

OPERATING YOUR COFFEE MAKER

10. Close the filter holder lid. **WARNING:** Do not operate your coffee maker if the lid does not close completely. If the lid does not close completely, check to see that the filter basket is properly positioned inside the filter holder.
11. Secure the lid on the glass carafe until it locks into place. Place the carafe on the non-stick warming plate. For brewing the lid should be completely closed.
12. Plug the unit into an outlet and flip the ON/OFF switch into the ON position. The ON/OFF switch will illuminate and the coffee maker will start the brewing process.
13. Do not remove the glass carafe from the warming plate until the brewing process is complete.
14. In a few minutes the coffee maker will complete the brewing cycle. **NOTE:** To terminate the brewing process at any time, flip the ON/OFF switch into the OFF position.
15. **NOTE:** If you would like a cup of coffee before the full pot is brewed, the Pause 'N Serve feature allows you to interrupt the brewing process. The brewing process does not stop during this period; only the flow of coffee from the basket. ***Do not remove the carafe for longer than 30 seconds or the coffee may overflow from the basket stops.*** While we offer this feature, we do not recommend you pour the coffee before the cycle has reached completion, since the coffee brewed at the beginning of the cycle has a flavor which is very different from the flavor at the end of the cycle. Removing a cup during the brewing cycle will alter the flavor of the finished pot.
16. The separate heating element for the non-stick warming plate ensures that the coffee maintains the correct temperature after brewing is complete.
17. To pour coffee after brewing is complete, remove the carafe from the non-stick warming plate. Once the desired amount of coffee has been poured, return the carafe to the non-stick warming plate.
18. The non-stick warming plate will keep your coffee hot, but the sooner you drink it, the better it will taste. The coffee maker will keep the coffee hot and then automatically shut-off after 2 hours.
19. Flip the ON/OFF switch to turn the unit OFF when the carafe is empty or when the coffee maker is not in use. After brewing cycle is complete, discard the grounds and rinse the permanent gold-tone filter and filter basket thoroughly with water. (See "Cleaning Your Coffee Maker" section of this manual for more details).

OPERATING YOUR COFFEE MAKER

20. **NOTE:** If you have not used the coffee maker in awhile, run one cycle with water only (without coffee) to clean it out. Fill the water tank to the top cup when you perform this procedure. **WARNING:** Never put the carafe in the microwave.

HINTS FOR GREAT TASTING COFFEE

1. A clean coffee maker is essential for making great tasting coffee. Regular cleaning is recommended, as specified in the "Cleaning Your Coffee Maker" section of this manual.
2. Always use fresh, cold water in your coffee maker.
3. Fine grind coffee promotes fuller extraction and provides rich, full-tasting coffee. Regular grind will require slightly more coffee grounds per cup to provide the strength of a finer grind.
4. Store coffee grounds in a cool, dry place. Once coffee has been opened, keep it tightly sealed in refrigerator to maintain freshness.
5. For optimum coffee, buy whole beans and grind them just before brewing.
6. Do not re-use coffee grounds since this will lessen coffee flavor.
7. Reheating coffee is not recommended. Coffee is at its peak flavor immediately after brewing.
8. Small oil droplets on the surface of brewed black coffee are due to the extraction of oil from the coffee grounds. Oiliness may occur more frequently if heavily roasted coffee is used. Over-extraction may also cause oiliness, indicating a need to clean your coffee maker.

DECALCIFICATION

Calcium deposits may build up in the coffee maker as a result of minerals commonly found in drinking water. The build-up is normal and may result in a slow down of the coffee maker's brewing time. The slow down can be eliminated by periodically decalcifying the coffee maker.

DECALCIFICATION INDICATOR

1. After approximately 90 brew cycles the coffee maker will automatically indicate when it needs to be cleaned.
2. The decalcification warning light will flash to indicate that the coffee maker requires decalcification.

HOW TO DECALCIFY YOUR COFFEE MAKER

3. To decalcify, fill the carafe with cold water and two tablespoons of white vinegar.
4. Pour the solution into the water tank, and then close the lid. Place the carafe on the warming plate and allow the coffee maker to brew the vinegar solution.
5. While decalcifying, do not use a filter in the filter basket. When the vinegar solution has finished brewing, empty the carafe and rinse it out with cold water.
6. Refill the water reservoir with cold water only and run another brew cycle to remove any remaining vinegar solution. Repeat if necessary.
7. To reset the machine after decalcification is complete, press the reset button located in the back of the machine.

CLEANING YOUR COFFEE MAKER

1. **WARNING:** Make sure your coffee maker is unplugged before attempting to clean. To protect against electric shock, do not immerse cord, plug or unit in water or other liquid.
2. The outside of your coffee maker can be cleaned by wiping the surface with a damp, soft cloth. **WARNING:** Never immerse the coffee maker in water or other liquid.
3. Clean inside of coffee maker with a damp cloth and mild detergent. Do not use harsh abrasives or scouring pads on carafe, it will scratch the surface.
4. Carafe lid and removable filter basket may be washed with warm, soapy water. Rinse and dry thoroughly. Do not place any parts of the coffee maker in the dishwasher.
5. To clean the permanent gold-tone filter, empty the grounds and rinse thoroughly.
6. Do not clean the inside of the water tank with a cloth as the cloth may have a lint residue that could clog the coffee maker.
7. For stubborn stains, use a nylon or plastic pad with a non-abrasive cleanser (inside of coffee maker only). Do not use metal scouring pads or abrasive cleansers.

LIMITED WARRANTY

De'Longhi is the distributor of Kenwood home appliances. This warranty applies to all home appliances with De'Longhi or Kenwood brand names.

What does the warranty cover?

We warrant each appliance to be free from defects in material and workmanship. Our obligation under this warranty is limited to repair at our factory or authorized service center of any defective parts or part thereof, other than parts damaged in transit. In the event of a products replacement or return, the unit must be returned transportation prepaid. The repaired or new model will be returned at the company expense.

This warranty shall apply only if the appliance is used in accordance with the factory directions, which accompany it, and on an Alternating current (AC) circuit.

How long does the coverage last?

This warranty runs for one year (1) from the purchase date found on your receipt and applies only to the original purchaser for use.

What is not covered by the warranty?

The warranty does not cover defects or damage of the appliance, which result from repairs or alterations to the appliance outside our factory or authorized service centers, nor shall it apply to any appliance, which has been subject to abuse, misuse, negligence or accidents. Also, consequential and incidental damage resulting from the use of this product or arising out of any breach of contract or breach of this warranty are not recoverable under this warranty. Some states do not allow the exclusion or limitation of incidental or consequential damage, so the above limitation may not apply to you.

How do you get service?

If repairs become necessary, see contact information below:

U.S. Residents: Please contact our toll free hotline at 1-800-322-3848 or log onto our website at www.delonghi.com. For all accessories, spare parts or replacement parts, please contact our parts division at 1-800-865-6330.

Residents of Canada: Please contact our toll free hotline at 1-888-335-6644 or log onto our website at www.delonghi.com.

Residents of Mexico: Please refer to the Limited Warranty statement for Mexico.

Please refer to the back page of the manual for De'Longhi addresses.

The above warranty is in lieu of all other express warranties and representations. All implied warranties are limited to the applicable warranty period set forth above. This limitation does not apply if you enter into an extended warranty with De'Longhi. Some states do not allow limitations on how long an implied warranty lasts, so the above exclusions may not apply to you. De'Longhi does not authorize any other person or company to assume for it any liability in connection with the sale or use of its appliance.

How does state law apply?

This warranty gives you specific legal rights, and you may also have other rights, which vary from state to state.

IMPORTANT INFORMATION

CUSTOMER SERVICE

Visit www.delonghi.com or call

U.S. Residents: 1-800-322-3848 (8:30 - 5:00 EST) Mon-Fri

Canada Residents: 1-800-335-6644 (8:30 - 4:30) Mon-Fri

PURCHASE PARTS AND ACCESSORIES

Visit www.delonghi.com or call:

U.S. Residents: 1-800-865-6330 (8:30 – 5:00 EST) Mon-Fri

Canada Residents: 1-888-335-6644 (8:30 – 4:30) Mon-Fri or fill out the form provided.

CORPORATE INFORMATION

De'Longhi America, Inc.
Park 80 West, Plaza One
Saddle Brook, NJ 07663
1-800-322-3848

De'Longhi Canada, Inc.
6150 McLaughlin Court
Mississauga, Ontario
L5R 4E1 Canada
1-888-335-6644

Centro Nacional de Servicio:
Fiducia Italiana S.A. de C.V.
Hortencia 129 Col. Florida
México D.F., C.P. 01030
01-800-711-88-05 (lada sin costo)
56-62-53-68 y 69 (D.F.)

De'Longhi S.p.A.
Via L. Seitz 47
Treviso, Italy 31100

www.delonghi.com

TECHNICAL INFORMATION

Made in PRC
Power Requirement: 120 Volts / 60 Hz
Power Consumption: 1500 Watts



Living innovation

www.delonghi.com