



Instruction Manual  
Electric Kettle

Mode D'emploi  
Bouilloire électrique

Manual de instrucciones  
Tetera eléctrica

Manuale di istruzioni  
Bollitore elettrico



DSJ900 Series / Série

**Register this product on-line and receive a free trial issue of Cook's Illustrated.** Visit [www.prodregister.com/delonghi](http://www.prodregister.com/delonghi).

**Enregistrez ce produit en ligne et recevez un numéro gratuit de Cook's Illustrated.** Visitez [www.prodregister.com/delonghi](http://www.prodregister.com/delonghi).

**Registre este producto en línea y reciba un ejemplar gratis de Cook's Illustrated.** Visite [www.prodregister.com/delonghi](http://www.prodregister.com/delonghi).

**Registra questo prodotto "on-line" per riceuere una copia omaggio délla rivista.** Visita [www.prodregister.com/delonghi](http://www.prodregister.com/delonghi).

Visit [www.delonghi.com](http://www.delonghi.com) for a list of service centers near you. (U.S. Only)

Visitez [www.delonghi.com](http://www.delonghi.com) pour y voir une liste des centres de réparation proches de chez vous. (É.-U. uniquement)

Visite [www.delonghi.com](http://www.delonghi.com) para ver la lista de centros de servicios cercanos a usted. (Solamente en los Estados Unidos)

Visita [www.delonghi.com](http://www.delonghi.com) per una lista dei centri di servizio a te piu vicini. (Solo negli Stati Uniti)

Read and Save These Instructions - Lisez et conservez ces instructions  
Guardar estas instrucciones después de haberlas leído - Leggete e conservate queste istruzioni

## **IMPORTANT SAFEGUARDS**

When using electrical appliances, basic safety precautions should always be followed to reduce the risk of fire, electrical shock and/or personal injury.

1. Read all instructions carefully.
2. Do not touch hot surfaces. Use the handle on the kettle.
3. To protect against electrical shock, do not place power base, cord, plug or kettle in water or other liquid.
4. Close supervision is necessary when any appliance is used by or near children.
5. Unplug from outlet when not in use and before cleaning. Allow to cool before putting on or taking off parts, and before cleaning the appliance.
6. Do not operate any appliance with a damaged cord or plug or after the appliance malfunctions or has been damaged in any manner. It may be dangerous and should be avoided. Return appliance to authorized service facility for examination, repair or adjustment.
7. Do not use outdoors.
8. Do not let cord hang over edge of table or counter, or touch hot surfaces.
9. Do not place on or near hot gas or electric burner, or in heated oven.
10. Always plug cord into the wall outlet before turning on any controls. To disconnect turn power OFF, then remove plug from wall outlet.
11. Scalding may occur if the cover is lifted or removed during the boiling process.
12. Do not use the kettle for any purpose other than heating water. Do not place any utensils into the kettle.
13. Do not place hot kettle on or near paper, cloth or other flammable material.
14. Never use the kettle on a range top or in a microwave oven.
15. Do not allow liquid to evaporate from kettle. Do not heat kettle when empty.
16. Do not clean kettle with scouring powders, steel wool pads or other abrasive materials.
17. Only use the power base provided, and keep it clean and dry.
18. Make sure the lid is secure before switching the kettle on.
19. Make sure the kettle is switched off before lifting or pouring.
20. Remove the kettle from the base before filling or pouring.
21. Do not touch the kettle if you have wet hands.
22. Position the kettle properly on the power base before switching on.
23. Always use the filter and never overfill the kettle. Boiling water may splash out.



## KNOW YOUR KETTLE

FIGURE 1

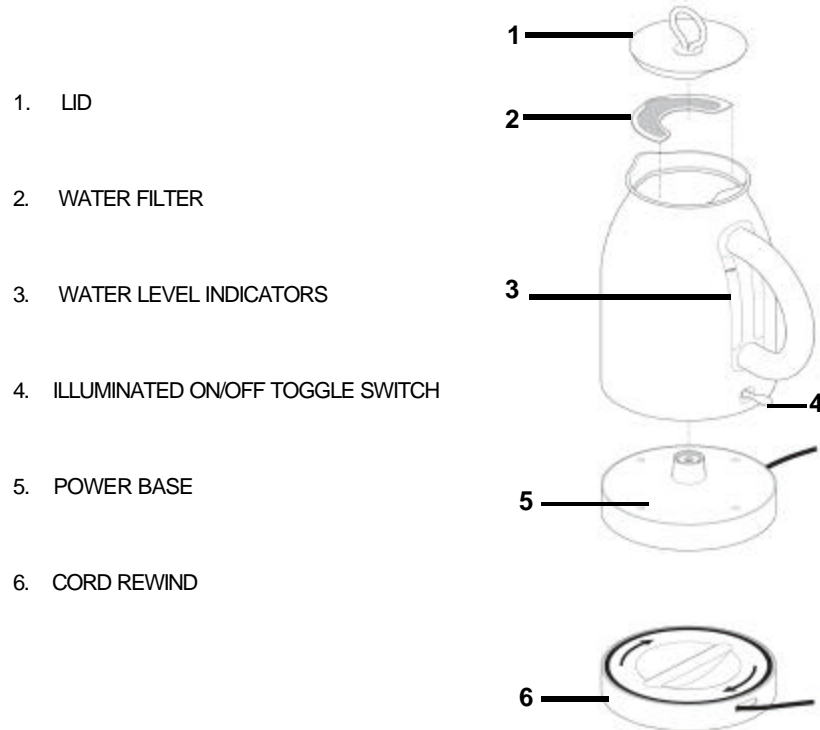
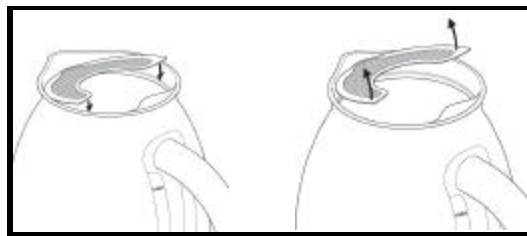

FIGURE 2



## **KNOW YOUR KETTLE (continued)**

### **FEATURES:**

1. **CORDLESS OPERATION WITH DETACHABLE BASE:** Cordless kettle design makes serving easy.
2. **WATER FILTER:** Removable, washable filter prevents lime scale and other deposits from water.
3. **CONCEALED HEATING ELEMENT AND STAINLESS STEEL INTERIOR:** Durable non-stick, die-cast stainless steel heating element maintains the purity of the water.
4. **CORD REWIND:** Allows for easy cord storage.
5. **WATER LEVEL INDICATORS:** Easy-to-read indicators, located inside the handle (on both the right and left-hand sides of the handle), lets you know exactly how much water is left.
6. **TWO LEVEL AUTO SHUT-OFF:** The unit will automatically shut off when:
  - Water begins to boil
  - Kettle is empty
7. **SEAMLESS BRUSHED ALUMINUM BODY:** Durable and stylish, it beautifully accents any kitchen decor.
8. **ILLUMINATED TOGGLE SWITCH AND DETACHABLE RUBBERIZED LID:** Allow for easy and convenient use.

## OPERATING YOUR KETTLE

### PREPARING YOUR KETTLE:

1. Place the kettle on a flat, level surface away from any edge.
2. Plug the unit into a 120V / 60Hz only outlet.
3. The kettle must be properly positioned on the power base, or it will not operate.
4. The lid must be properly closed during the boiling process. **CAUTION:** If the lid is not completely closed, boiling hot water could splash out.

### SUGGESTIONS:

1. To improve the quality of your drink, always use fresh water.
2. Empty the kettle after each use.

### OPERATING YOUR KETTLE:

1. Fill the kettle with water. The kettle must be filled between MAX and 200ml (1 cup). Never overfill the kettle, this could cause hot boiling water to splash out.
2. Place the front of the water filter into the spout area, and then clip into place. Never use the kettle without the filter. **Figure 2.**
3. Make sure the lid is properly positioned on top of the kettle.
4. Place the kettle on the power base. If the kettle is not positioned properly on the power base, the kettle will not operate.
5. Switch the kettle on by moving the toggle into the "ON" (down) position. The toggle switch will illuminate indicating that the kettle's power is on.
6. The kettle will now boil the water and switch off automatically when it's complete. You will know when it's done boiling when the toggle switch is no longer illuminated.
7. Remove the kettle from the base for convenient and easy serving. **CAUTION:** Do not place hot kettle on furniture or flammable materials. Make sure to place the toggle switch in the up position to turn the kettle "OFF" before removing the kettle from the base for serving.
8. To boil water again, wait a few seconds. The kettle needs time to reset itself. Push the toggle switch down into the "ON" position. The switch will illuminate and the kettle is reset and ready to boil water again.
9. **NOTE:** If you switch the kettle on with too little water, your kettle will automatically shut off. Let the kettle cool down before refilling. When it has cooled down, the kettle will reset itself. **-6-**

## TROUBLESHOOTING

1. If you experience difficulties with your kettle switching on and off during use or switching off before boiling, check that the interior of the kettle is free from lime scale build-up. (See "Cleaning your Kettle" section for more details about decalcification.)
2. If you see drops of water under your kettle this is just condensation.

## WATER FILTER

1. Your kettle is equipped with a water filter to prevent loose particles of scale being poured into your beverage. This filter is both removable and washable. **Figure 2.**
2. The frequency with which you will need to clean any scale deposits from your filter depends on the hardness of the water in your area and how often you use the kettle.
3. You should remove and clean the water filter when you notice any deposits being left on the filter or if the pouring efficiency is impaired. Refer to the "Cleaning your Kettle" section of this manual for more details on cleaning your water filter and decalcification.

### REMOVING THE WATER FILTER

1. Allow the kettle to cool down completely.
2. Disconnect the appliance from the outlet.
3. Make sure that your hands are clean and free from soap, cream or anything that might taint the water.
4. Clean the water filter according to the directions listed in the "Cleaning your Kettle" section of the manual.

## CLEANING YOUR KETTLE

**CAUTION:** Make sure your appliance is unplugged and cooled down before attempting to clean. To protect against electric shock, do not immerse cord, plug, power base or unit in water or other liquid.

### *Exterior Cleaning*

1. The outside of your kettle can be cleaned by wiping the surface with a damp, soft cloth, then dry thoroughly. Do not use harsh abrasives to clean the exterior of the kettle, they will scratch the surface. **CAUTION:** Never immerse the kettle in water or other liquid.

## **CLEANING YOUR KETTLE**

### ***Interior Cleaning***

1. To clean the inside of the kettle, use a damp cloth. Even though your kettle includes a water filter, you still need to clean the interior and the filter regularly.

### ***Water Filter***

1. Remove the lid and lift out the water filter. Rinse the filter under running water or use a soft brush to clean. Or when decalcifying your kettle, keep the filter in place. Then rinse the water filter thoroughly.
2. Replace the filter by placing the front of the filter into the spout area, and then clip into place. **Figure 2**

### ***Decalcification***

#### ***What is lime scale?***

Lime scale is mainly calcium carbonate, a harmless, naturally occurring mineral found in most water supplies. "Hard" water contains more of this mineral than "soft water". When the water is heated, the minerals in the water solidify, making the water appear cloudy. These minerals form a thin film on the walls, element and on the surface of the water. The water may look as though it has white colored pieces of plastic floating on the surface. On traditional kettle heating elements, scale forms a hard white "crust" that adversely affects performance and reduces the life of the heating element.

1. Regular decalcification of the interior will improve the performance of the kettle. If the kettle is not decalcified regularly, the lime scale build-up may result in the following:
  - a) The kettle may switch on and off during use or may switch off before boiling.
  - b) The kettle may take longer to boil water than normal.
  - c) The heating element may become damaged.
2. When lime scale starts to build-up on the interior of the kettle, we recommend using white vinegar as follows:
  - a) Pour into kettle 2 oz. of white vinegar and then fill with water up to the MAX level indicated and then boil as usual. Allow the contents to cool, and then rinse thoroughly.
  - b) Do not use a concentrated solution. If the filter requires decalcification, remove the filter and place into the white vinegar solution in the kettle.
3. **NOTE:** To prevent lime scale build-up, use filtered water to fill your kettle.



**De'Longhi is the distributor of Kenwood home appliances.  
This warranty applies to all home appliances with De'Longhi or Kenwood brand names.**

**Limited Warranty**

**What does the warranty cover?**

We warrant each appliance to be free from defects in material and workmanship. Our obligation under this warranty is limited to repair at our factory or authorized service center of any defective parts or part thereof, other than parts damaged in transit. In the event of a products replacement or return, the unit must be returned transportation prepaid. The repaired or new model will be returned at the company expense. This warranty shall apply only if the appliance is used in accordance with the factory directions, which accompany it, and on an Alternating current ( AC ) circuit.

**How long does the coverage last?**

This warranty runs for one year ( 1 ) from the purchase date found on your receipt and applies only to the original purchaser for use.

**What is not covered by the warranty?**

The warranty does not cover defects or damage of the appliance, which result from repairs or alterations to the appliance outside our factory or authorized service centers, nor shall it apply to any appliance, which has been subject to abuse, misuse, negligence or accidents. Also, consequential and incidental damage resulting from the use of this product or arising out of any breach of contract or breach of this warranty are not recoverable under this warranty. Some states do not allow the exclusion or limitation of incidental or consequential damage, so the above limitation may not apply to you.

**How do you get service?**

If repairs become necessary, see contact information below:

**U.S. Residents:**

Please contact our toll free hotline at 1-800-322-3848 or log onto our website at **www.delonghi.com**. For all accessories, spare parts or replacement parts, please contact our parts division at 1-800-865-6330.

**Residents of Canada:** Please contact our toll free hotline at 1-888-335-6644 or log onto our website at **www.delonghi.com**.

**Residents of Mexico:** Please refer to the Limited Warranty statement for Mexico.

**Please refer to the back page of the manual for De'Longhi addresses.**

The above warranty is in lieu of all other express warranties and representations. All implied warranties are limited to the applicable warranty period set forth above. This limitation does not apply if you enter into an extended warranty with De'Longhi. Some states do not allow limitations on how long an implied warranty lasts, so the above exclusions may not apply to you. De'Longhi does not authorize any other person or company to assume for it any liability in connection with the sale or use of its appliance.

**How does state law apply?**

This warranty gives you specific legal rights, and you may also have other rights, which vary from state to state.



DSJ900 Series / DSJ900 Séries  
Series DSJ900 / Serie DSJ900

Made in PRC / Fabriqué en RPC  
Fabricado en la RPC / Fabricato nella RPC

Power Requirement: 120 Volts / 60 Hz  
Caractéristiques électriques: 120 Volts / 60 Hz  
Alimentación eléctrica: 120 Voltios / 60 Hz  
Per uso con corrente: 120 Volt / 60 Hz

---

De'Longhi America, Inc.  
Park 80 West, Plaza One  
Saddle Brook, NJ 07663  
1-800-322-3848

---

De'Longhi Canada, Inc.  
6150 McLaughlin Court  
Mississauga, Ontario  
L5R 4E1 Canada  
1-888-335-6644

---

Centro Nacional de Servicio:  
Fiducia Italiana S.A. de C.V.  
Hortencia 129 Col. Florida  
México D.F., C.P. 01030  
01-800-711-88-05 (lada sin costo)  
56-62-53-68 y 69 (D.F.)

---

[www.delonghi.com](http://www.delonghi.com)

© De'Longhi 2004