

This Owner's Manual is provided and hosted by [Appliance Factory Parts](#).



# DE'LONGHI ESAM6600 Owner's Manual

[Shop genuine replacement parts for DE'LONGHI  
ESAM6600](#)



[Find Your DE'LONGHI Coffee Maker Parts - Select From 289 Models](#)

----- Manual continues below -----



De'Longhi Appliances  
via Seitz, 47  
31100 Treviso Italia

5713218221/02.13

# BEAN TO CUP ESPRESSO AND CAPPUCCINO MACHINE

Instruction for use



ESAM6600/ESAM6620/ESAM6650

## ELECTRICAL REQUIREMENTS

Before using this appliance ensure that the voltage indicated on the product corresponds with the main voltage in your home, if you are in any doubt about your supply contact your local electricity company.

The flexible mains lead is supplied connected to a B.S. 1363 fused plug having a fuse of 13 amp capacity.

Should this plug not fit the socket outlets in your home, it should be cut off and replaced with a suitable plug, following the procedure outlined below.

**Note:** Such a plug cannot be used for any other appliance and should therefore be properly disposed of and not left where children might find it and plug it into a supply socket - with the obvious consequent danger.

**N.B.** We recommend the use of good quality plugs and wall sockets that can be switched off when the machine is not in use.

**IMPORTANT:** the wires in the mains lead fitted to this appliance are coloured in accordance with the following code:

GREEN AND YELLOW  
BLUE  
BROWN

EARTH  
NEUTRAL  
LIVE

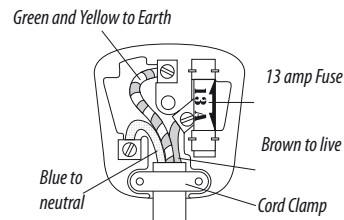

As the colours of the wires in the mains lead of this appliance may not correspond with the coloured markings identifying the terminals in your plug, proceed as follows:

- The wire which is coloured green and yellow must be connected to the terminal in the plug which is marked with the letter E or by the earth symbol  $\text{⏏}$  or coloured green or green and yellow.
- The wire which is coloured blue must be connected to the terminal which is marked with the letter N or coloured black.
- The wire which is coloured brown must be connected to the terminal which is marked with the letter L or coloured red.

When wiring the plug, ensure that all strands of wire are securely retained in each terminal. Do not forget to tighten the mains lead clamp on the plug. If your electricity supply point has only two pin socket outlets, or if you are in doubt, consult a qualified electrician.

Should the mains lead ever require replacement, it is essential that this operation be carried out by a qualified electrician and should only be replaced with a flexible cord of the same size.

After replacement of a fuse in the plug, the fuse cover must be refitted. If the fuse cover is lost, the plug must not be used until a replacement cover is obtained. The colour of the correct replacement fuse cover is that of the coloured insert in the base of the fuse recess or elsewhere on the plug. Always state this colour when ordering a replacement fuse cover.

Only 13amp replacement fuses which are asta approved to B.S. 1362 should be fitted.

This appliance conforms to the Norms EN 55014 regarding the suppression of radio interference.

**Warning - this appliance must be earthed**

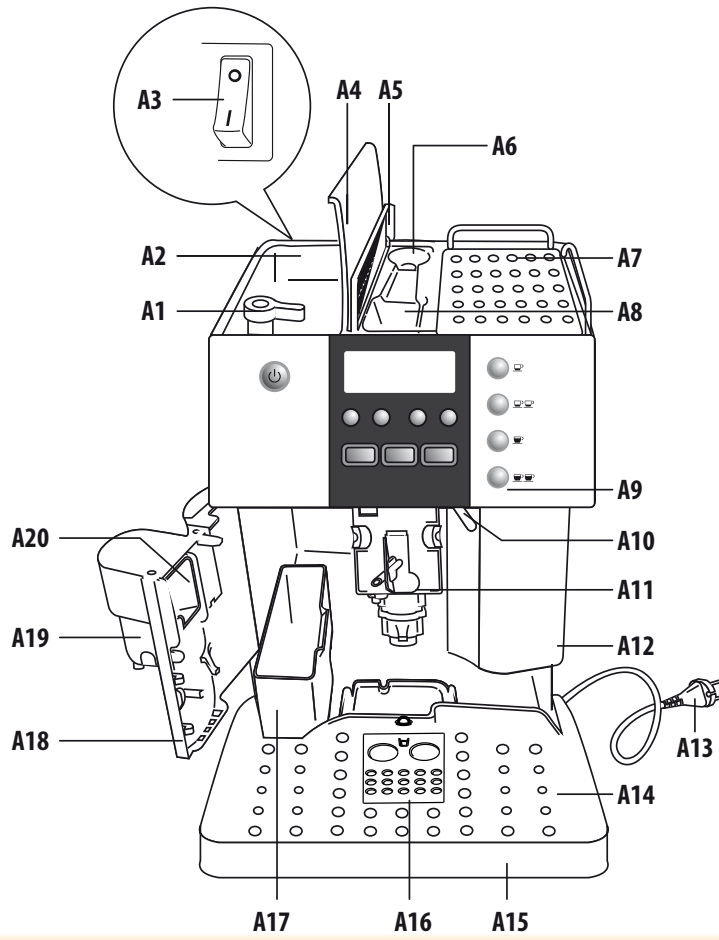
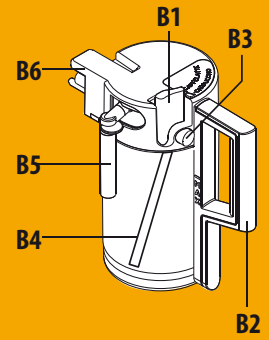
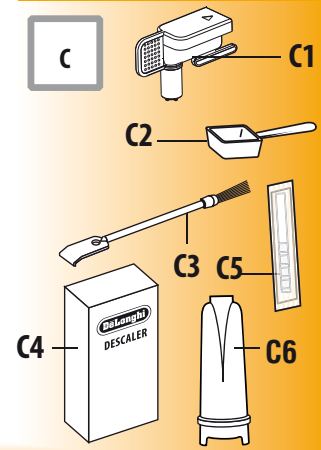
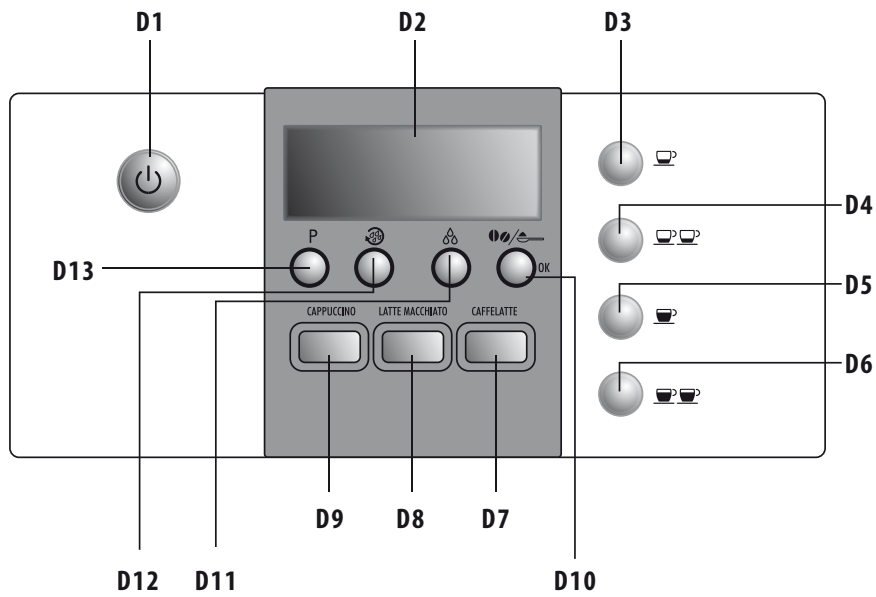
**A****B****C****D**

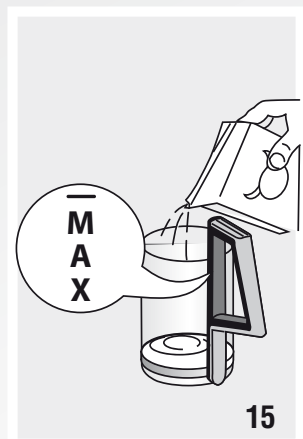
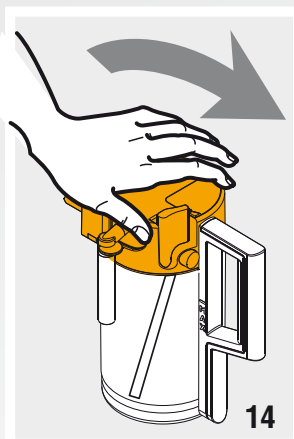
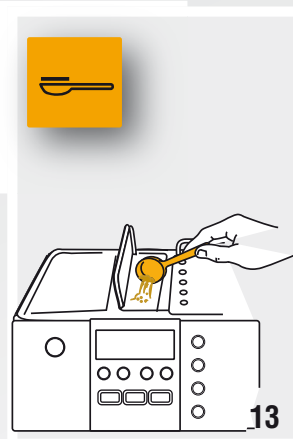
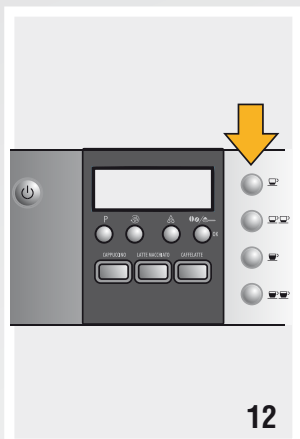
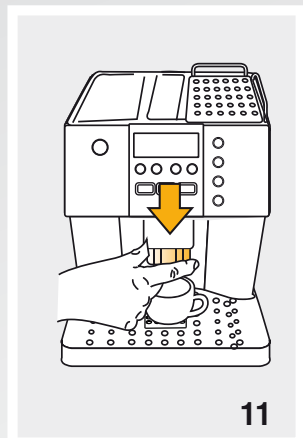
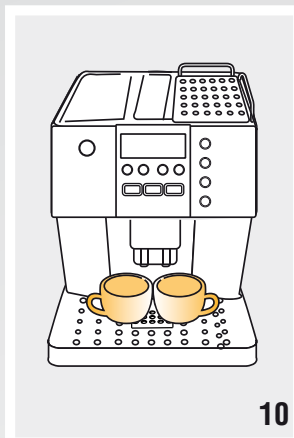
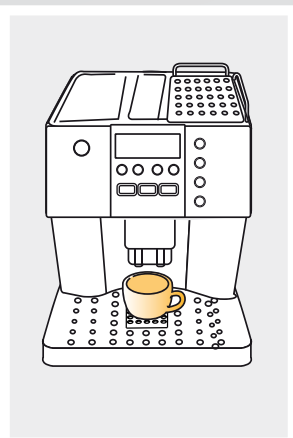
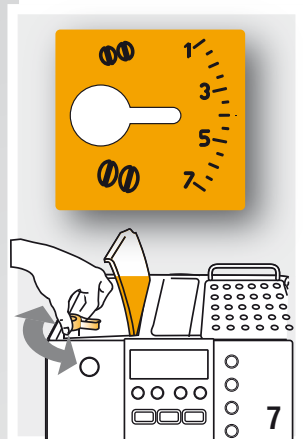
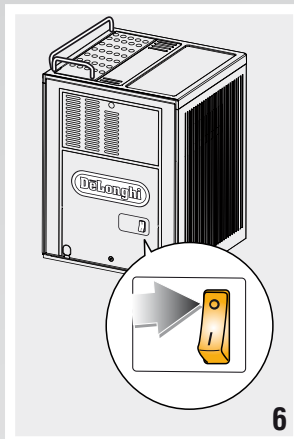
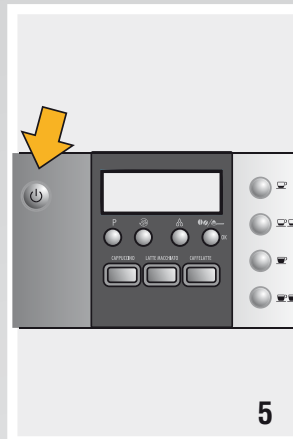
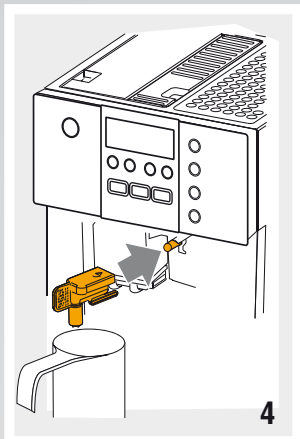
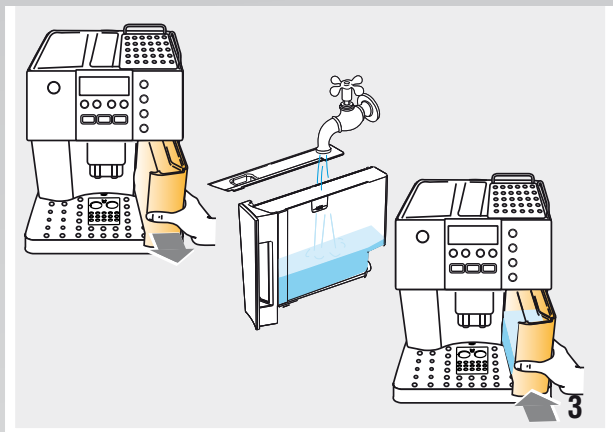
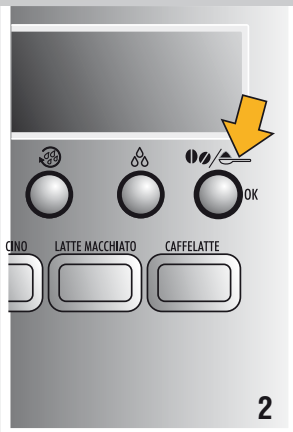
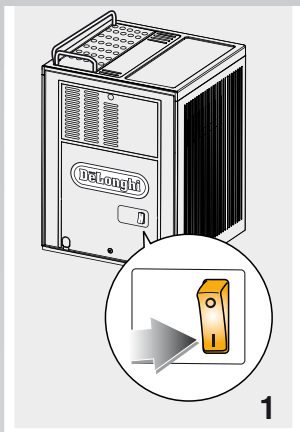

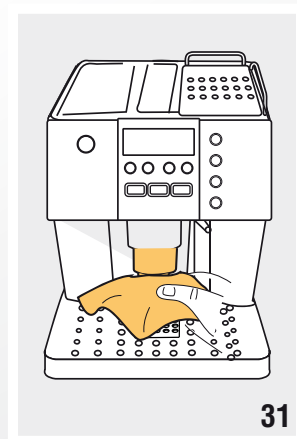
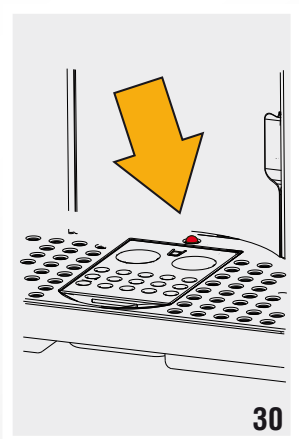
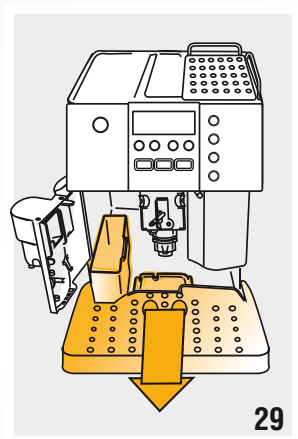
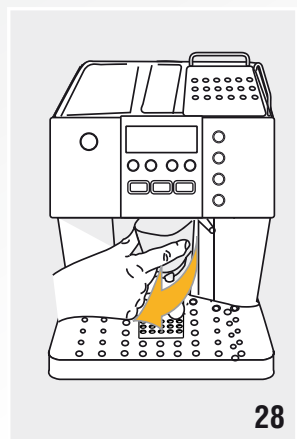
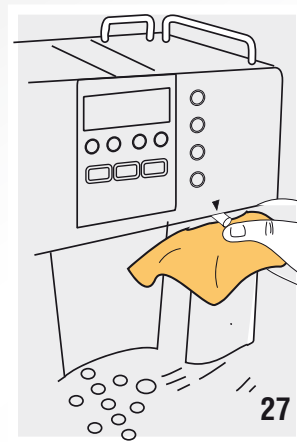
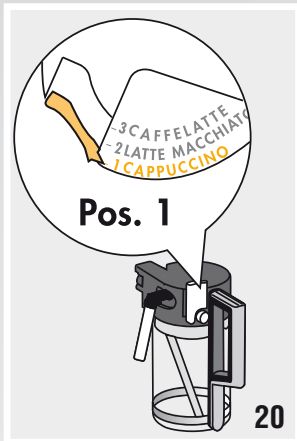
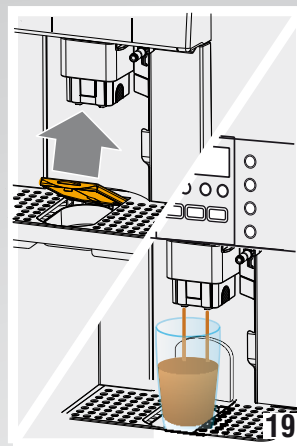
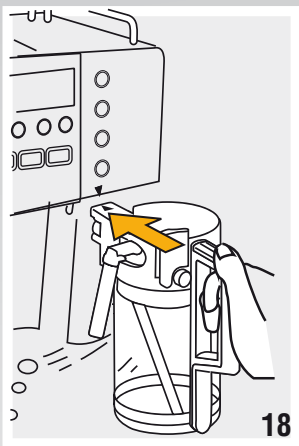
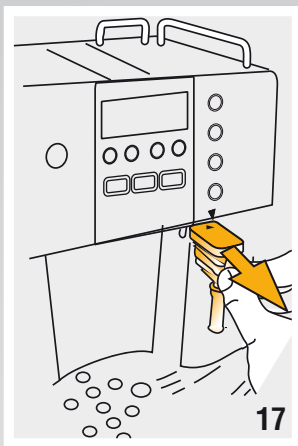
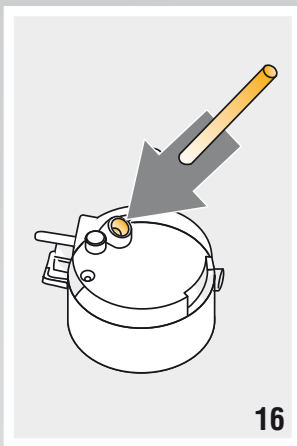

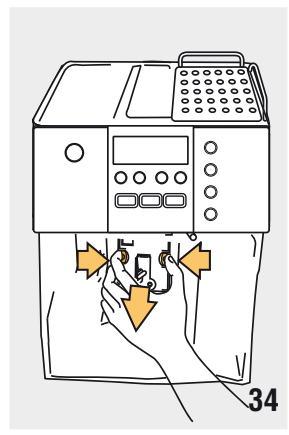
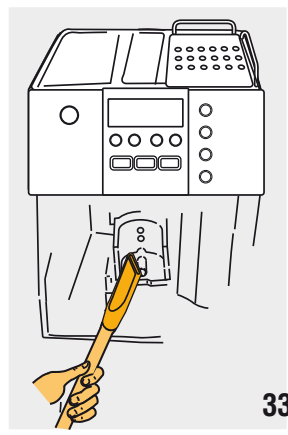
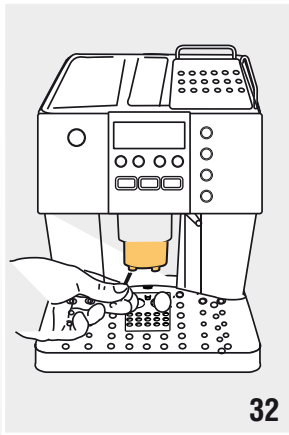

## CONTENTS

|  |           |
|--|-----------|
| <b>ELECTRICAL REQUIREMENTS .....</b>                   | <b>2</b>  |
| <b>INTRODUCTION .....</b>                              | <b>8</b>  |
| Symbols used in these instructions .....               | 8         |
| Letters in brackets .....                              | 8         |
| Troubleshooting and repairs .....                      | 8         |
| <b>SAFETY .....</b>                                    | <b>8</b>  |
| Fundamental safety warnings .....                      | 8         |
| <b>DESIGNATED USE .....</b>                            | <b>8</b>  |
| <b>INSTRUCTIONS .....</b>                              | <b>9</b>  |
| <b>DPRIPTION.....</b>                                  | <b>9</b>  |
| DPription of the appliance .....                       | 9         |
| DPription of the milk container .....                  | 9         |
| DPription of accessories .....                         | 9         |
| DPription of control panel .....                       | 9         |
| <b>PRELIMINARY CHECKS .....</b>                        | <b>10</b> |
| Checking the appliance .....                           | 10        |
| Installing the appliance .....                         | 10        |
| Connecting the appliance .....                         | 10        |
| Using the appliance for the first time .....           | 10        |
| <b>TURNING THE APPLIANCE ON .....</b>                  | <b>10</b> |
| <b>TURNING THE APPLIANCE OFF .....</b>                 | <b>11</b> |
| <b>MENU SETTINGS .....</b>                             | <b>11</b> |
| Setting the clock .....                                | 11        |
| Setting auto-start .....                               | 11        |
| Activating auto-start .....                            | 11        |
| Descaling .....  | 11        |
| Setting the temperature .....                          | 11        |
| Auto-Off.....  | 12        |
| Setting water hardness .....                           | 12        |
| Default values (reset) .....                           | 12        |
| Washing procedure .....                                | 12        |
| Beep ON/OFF (activates and deactivates the beep) ..... | 12        |
| <b>MAKING COFFEE .....</b>                             | <b>12</b> |
| Selecting the coffee taste.....                        | 12        |
| Selecting the quantity of coffee in the cup .....      | 12        |
| Customising the quantity.....                          | 12        |
| Adjusting the coffee mill .....                        | 13        |
| Tips for a hotter coffee .....                         | 13        |
| Making coffee using coffee beans .....                 | 13        |
| Making coffee using pre-ground coffee .....            | 13        |
| <b>MAKING DRINKS WITH MILK.....</b>                    | <b>14</b> |
| Filling and attaching the milk container .....         | 14        |
| Making cappuccino .....                                | 14        |
| Making macchiato .....                                 | 14        |
| Preparazione del caffelatte .....                      | 14        |
| Making frothed milk and hot milk (WITHOUT COFFEE)..... | 14        |

|   |    |
|---|----|
| Cleaning the milk container after use .....                   | 14 |
| Programming the quantities of coffee and milk in the cup .... | 15 |

## HEATING WATER .....

|  |    |
|--|----|
| Preparation .....  | 15 |
| Change the quantity of water delivered automatically. .... | 15 |

## CLEANING .....

|   |    |
|---|----|
| Cleaning the coffee maker .....             | 15 |
| Cleaning the coffee grounds container.....  | 15 |
| Cleaning the drip tray .....                | 16 |
| Cleaning the inside of the machine.....     | 16 |
| Cleaning the water tank.....                | 16 |
| Cleaning the coffee spouts .....            | 16 |
| Cleaning the pre-ground coffee funnel ..... | 16 |
| Cleaning the infuser .....                  | 16 |
| Cleaning the milk container .....           | 17 |
| Cleaning the hot water/steam nozzle .....   | 17 |

## DESCALING.....

## SETTING WATER HARDNESS.....

|   |    |
|---|----|
| Measuring water hardness.....   | 18 |
| Set water hardness .....  | 18 |
| The machine is now reprogrammed with the new water hardness setting. .... | 18 |

## SETTING THE LANGUAGE .....

## TECHNICAL SPECIFICATION.....

## DISPOSAL.....

## DISPLAYED MESSAGES .....

## TROUBLESHOOTING .....

## INTRODUCTION

Thank you for choosing the automatic coffee and cappuccino maker. We hope you enjoy using your new appliance. Take a few minutes to read these instructions. This will avoid all risks and damage to the machine.

### Symbols used in these instructions

Important warnings are identified by these symbols. These warnings must absolutely be respected.



*Danger!*  
Failure to observe the warning could result in possibly life threatening injury from electric shock.



*Important!*  
Failure to observe the warning could result in injury or damage to the appliance.



*Danger of burns!*  
Failure to observe the warning could result in scalds or burns.



*Please note:*  
This symbol identifies important advice or information for the user.

### Letters in brackets

The letters in brackets refer to the legend in the DPrption of the appliance on page 3.

### Troubleshooting and repairs

In the event of problems, first try and resolve them following the information given in the sections "Displayed messages" on page 18 and "Troubleshooting" on page 19.

If this does not resolve the problem or you require further information, you should consult Customer Services by calling the number given on the annexed "Customer Service" sheet.

If your country is not among those listed on the sheet, call the number given in the guarantee.

If repairs are required, contact De'Longhi Customer Services only.

The addresses are given in the guarantee certificate provided with the machine.

## SAFETY

### Fundamental safety warnings



*Danger!*  
This is an electrical appliance and may cause electric shock.

You should therefore respect the following safety warnings:

- Never touch the appliance with damp hands or feet.
- Never touch the plug with damp hands.

- Make sure the socket used is freely accessible at all times, enabling the appliance to be unplugged when necessary.
- Unplug directly from the plug only. Never pull the power cable as you could damage it.
- To disconnect the appliance completely, place the main switch at the back of the appliance in the 0 position (fig. 6).
- If the appliance is faulty, do not attempt to repair. Turn it off, unplug from the mains socket and contact Customer Services.
- If the plug or power cable is damaged, it must be replaced by De'Longhi Customer Services only to avoid all risk.



- *Important!*  
Keep all packaging (plastic bags, polystyrene foam) away from children.
- The appliance is not intended for use by persons (including children) with reduced physical, sensory or mental capabilities, or lack of experience and knowledge, unless they have been given supervision or instruction concerning use of the appliance by a person responsible for their safety. Children must be supervised to ensure they do not play with the appliance.



*Danger of burns!*  
This appliance produces hot water and steam may form while it is in operation.  
Avoid contact with splashes of water or hot steam.

## DESIGNATED USE

This appliance is designed and made to prepare coffee and heat drinks.

All other use is considered improper.

This appliance is not suitable for commercial use.

The manufacturer is not liable for damage deriving from improper use of the appliance.

This is a household appliance only.

It is not intended for use in:

- staff kitchen areas in shops, offices and other working environments;
- farm houses;
- by clients in hotels, motels and other residential type environments;
- bed and breakfast type environments.

## INSTRUCTIONS

Read these instructions carefully before using the appliance.

- Failure to respect these instructions may result in burns or damage to the appliance.  
The manufacturer is not liable for damage deriving from failure to respect these instructions.



*Please note:*

Keep these instructions.

If the appliance is passed to other persons, they must also be provided with these instructions.

## DPRIPTION

### DPription of the appliance

(page 3 - **A** )

- A1. Grinding adjustment knob
- A2. Beans container
- A3. Main switch
- A4. Beans container lid
- A5. Cover for funnel and measure compartment
- A6. Measure compartment
- A7. Cup warmer
- A8. Pre-ground coffee funnel
- A9. Control panel
- A10. Hot water and steam nozzle
- A11. Infuser
- A12. Water tank
- A13. Power cable
- A14. Cup tray
- A15. Drip tray
- A16. Compartment for macchiato / caffelatte glass (some models only)
- A17. Grounds tray
- A18. Service door
- A19. Coffee spout (adjustable height)
- A20. Coffee guide

### DPription of the milk container

(page 3 - **B** )

- B1. Froth regulator
- B2. Container handle
- B3. CLEAN button
- B4. Milk intake tube
- B5. Frothed milk spout
- B6. Lid with milk frother
- B6. Lid with milk frother

### DPription of accessories

(page 3 - **C** )

- C1. Hot water spout
- C2. Measure
- C3. Cleaning brush
- C4. Descaler
- C5. Reactive strip to detect water hardness (Total hardness test)
- C6. Water hardness filter (some models only)

### DPription of control panel

(page 3 - **D** )

*A number of buttons on the panel have a dual function. This is indicated in brackets in the dPription.*

- D1. ON/STAND-BY button
- D2. Display
- D3. 1 short coffee button
- D4. 2 short coffees button
- D5. 1 long coffee button
- D6. 2 long coffees button
- D7. CAFFELATTE button: delivers 1 caffelatte (or hot milk if pressed twice consecutively)
- D8. LATTE MACCHIATO button: delivers 1 macchiato (or frothed milk if pressed twice consecutively)
- D9. CAPPUCCINO button: delivers 1 cappuccino (or frothed milk if pressed twice consecutively)
- D10. Button to select coffee taste or use pre-ground coffee. (*OK button to confirm changes to menu settings*)
- D11. Hot water button.  
(*> button to change menu settings*)
- D12. Rinse button. (*< button to change menu settings*).
- D13. **P** button to access or exit the menu.

## PRELIMINARY CHECKS

### Checking the appliance

After removing the packaging, make sure the product is complete and undamaged and that all accessories are present. Do not use the appliance if it is visibly damaged. Contact De'Longhi Customer Services.

### Installing the appliance



*Important!*

When you install the appliance, you should respect the following safety warnings:

- The appliance gives off heat. After positioning the appliance on the worktop, leave a space of at least 3 cm between the surfaces of the appliance and the side and rear walls and at least 15 cm above the coffee maker.
- Water penetrating the appliance could cause damage. Do not place the appliance near taps or sinks.
- The appliance could be damaged if the water it contains freezes. Do not install the appliance in a room where the temperature could drop below freezing point.
- Arrange the power cable in such a way that it cannot be damaged by sharp edges or contact with hot surfaces (e.g. electric hot plates).

## Connecting the appliance



*Important!*

Check that the mains power supply voltage corresponds to the value indicated on the rating plate on the bottom of the appliance.

Connect the appliance to an efficiently earthed and correctly installed socket with a minimum current rating of 10A only. If the power socket does not match the plug on the appliance, have the socket replaced with a suitable type by a qualified professional.

## Using the appliance for the first time



*Please note :*

- Coffee has been used to factory test the appliance and it is therefore completely normal for there to be traces of coffee in the grinder. The machine is, however, guaranteed to be new.
- You should customise water hardness as soon as possible following the instructions in the section "Setting water hardness" on page 17.

1. Plug the appliance into the mains socket and place the main switch on the back of the appliance in the I position (fig. 1).

You must first choose the language (the languages scroll through at intervals of about 3 seconds).

2. When "English" appears, press the **OK** button (fig. 2). Once the language has been saved, the message "ENGLISH SET" is displayed.

Follow the instructions indicated by the appliance:

3. "FILL TANK": remove the water tank, fill to the MAX line with fresh water then replace in the appliance (fig. 3).
4. "INSERT WATER SPOUT AND PRESS OK": Check that the hot water spout is inserted on the nozzle and place a container holding a minimum of 100 ml underneath (fig. 4).
5. Press the OK button (fig. 2). "PLEASE WAIT" is displayed and the appliance begins to deliver water from the hot water spout.

The appliance ends the first start up procedure, then the message "TURNING OFF PLEASE WAIT" is displayed and the appliance goes off.

The coffee maker is now ready for normal use.



*Please note:*

- When using the appliance for the first time, you need to make 4-5 cups of coffee or 4-5 cappuccinos before the

appliance starts to give satisfactory results.

## TURNING THE APPLIANCE ON



*Please note:*

Before turning the appliance on, make sure the main switch on the back of the appliance is in the I position (fig. 1).

Each time the appliance is turned on, it performs an automatic preheat and rinse cycle which cannot be interrupted.

The appliance is ready for use only after completion of this cycle.



*Danger of burns!*

During rinsing, a little hot water comes out of the coffee spouts and is collected in the drip tray underneath. Avoid contact with splashes of water.

- To turn the appliance on, press the  button (fig. 5). The message "HEATING UP PLEASE WAIT" is displayed. After heating, the message "Rinsing" is displayed, together with a progress bar which gradually fills as preparation progresses. As well as heating the boiler, the appliance also heats the internal circuits by circulating hot water. The appliance is at temperature when the message indicating the taste and quantity of coffee appears.

## TURNING THE APPLIANCE OFF

Each time the appliance is turned off, it performs an automatic rinse cycle which cannot be interrupted.



*Important!*

To avoid damaging the appliance, always press the  button to turn off.



*Danger of burns!*

During rinsing, a little hot water flows from the coffee spouts (only if coffee has been made).

Avoid contact with splashes of water.

To turn the appliance off, press the button  (fig. 5). The appliance performs a rinse cycle then goes off.



*Please note:*

If the appliance is not used for an extended period, place the main switch in the 0 position (fig. 6).

Never place the main switch in the 0 position while the appliance is on.

No rinse is performed if no drinks with coffee have been made while the machine has been on.

## MENU SETTINGS

When you access the programming menu by pressing the **P** button, the following menu items are available: Descale, Set language, Energy





Saving, Adjust time, Auto-start, Auto-off, Coffee temperature, Water hardness, Water filter, Beep, Statistics, Default values.

## Descaling

For instructions on descaling, see page 21.



## Setting the language

To modify the language on the display, proceed as follows:

1. Press the **P** button to enter the programming menu;
2. Press the  or  button (corresponding to the < and > symbol on the display) until "Set language" is displayed;
3. Press the **OK** button;
4. Press the  or  button until (corresponding to the < and > symbol on the display) the required language is displayed;
5. Press the **OK** button to confirm;
6. Press the **P** button to exit the menu.

## Energy Saving

Use this function to enable or disable energy saving mode. When enabled, the function reduces energy consumption in compliance with European regulations.

1. Press the **P** button to enter the programming menu;
2. Press the  or  button (corresponding to the < and > symbol on the display) until "Energy saving" is displayed;
3. Press the **OK** button. "Disable?" is displayed, or "Enable?" if the function has already been disabled.
4. Press the **OK** button to disable or enable the function or **P** to exit the menu.

When the function is enabled, if the appliance is not used for about 1 minute, "Energy Saving" is displayed.







*Please note!*



- A few seconds may elapse between "Energy Saving" mode and delivery of the first drink. This is indicated by the rapid increase then decrease of the progress bar and display of the message "Preparation underway".
- When "Energy Saving" is disabled, the appliance turns the cup warmer on automatically.

## Adjust time

To adjust the time on the display, proceed as follows:

1. Press the **P** button to enter the programming menu;
2. Press the  or  button (corresponding to the < and > symbol on the display) until "Adjust time" is displayed;
3. Press the **OK** button: the hours flash on the display;
4. Press the  or  button (corresponding to the < and > symbol on the display) until to change

the hours;

5. Press the **OK** button to confirm. The minutes flash on the display;
6. Press the  or  button (corresponding to the < and > symbol on the display) to change the minutes;
7. Press the **OK** button to confirm;
8. Press the **P** button to exit the programming menu.







## Auto-start

You can set the auto-start time in order to have the appliance ready at a certain time (for example in the morning) so you can make coffee immediately.





*Please note!*

To enable this function, **the time must be set correctly.**



1. Press the **P** button to enter the programming menu;
2. Press the  or  button (corresponding to the < and > symbol on the display) until "Auto-start Disabled" is displayed;
3. Press the **OK** button. "Enable?" is displayed;
4. Press the  or  button (corresponding to the < and > symbol on the display) to choose the hours;
5. Press the **OK** button to confirm. The minutes flash on the display;
6. Press the  or  button (corresponding to the < and > symbol on the display) to change the minutes;
7. Press the **OK** button to confirm. "Auto-start Enabled" is displayed.
8. Press the **P** button to exit the menu. The  symbol appears next to the clock to indicate that auto-start has been programmed.



To disable the function:

1. Press the **P** button to enter the programming menu;
2. Press the  or  button (corresponding to the < and > symbol on the display) until "Auto-start Enabled" is displayed;
3. Press the **OK** button. "Disable?" is displayed;
4. Press the **OK** button to confirm;
5. Press the **P** button to exit the menu. The  symbol is no longer displayed.

## Auto-off (Stand by)





Auto-off can be changed so that the appliance goes off after 15 or 30 minutes, or after 1, 2 or 3 hours.

1. Press the **P** button to enter the programming menu;
2. Press the  or  button (corresponding to the < and > symbol on the display) until "Auto-off"

- is displayed;
3. Press the **OK** button;
  4. Press the  or  button (corresponding to the < and > symbol on the display) until the required time appears (15 or 30 minutes, or 1, 2 or 3 hours);
  5. Press the **OK** button to confirm;
  6. Press the **P** button to exit the menu.
- Auto-off is programmed.

### Coffee temperature

To modify the temperature of the water used to make the coffee, proceed as follows:

1. Press the **P** button to enter the programming menu;
2. Press the  or  button (corresponding to the < and > symbol on the display) until "Coffee temperature" is displayed;
3. Press the **OK** button;
4. Press the  or  button (corresponding to the < and > symbol on the display) until the required temperature (● = low; ●●●● = high) is displayed;
5. Press the **OK** button to confirm;
6. Press the **P** button to exit the menu.

### Setting water hardness



For instructions on setting water hardness, see page 21.

### Install filter

For instructions on the water filter, see page 20.

### Beep





This enables or disables the beep emitted by the machine each time a button is pressed or an accessory is inserted/removed. The beep is active by default.

1. Press the **P** button to enter the menu;
2. Press the  or  button (corresponding to the < and > symbol on the display) until "Beep enabled" is displayed;
3. Press the **OK** button. "Disable?" is displayed;
4. Press the **OK** button to disable the beep. "Beep Disabled" is displayed;
5. Press the **P** button to exit the programming menu.

### Statistics function

This displays statistics relating to the machine.

To display, proceed as follows:



1. Press the **P** button to enter the programming menu;
2. Press the  or  button (corresponding to the < and > symbol on the display) until "Statistics" is displayed;
3. Press the **OK** button;
4. By pressing the  or  button (corresponding

to the < and > symbol on the display), you can check:

- how many coffees have been made;
  - the total of drinks with milk made (CAPPUCCINO, MACCHIATO, CAFFELATTE, MILK);
  - how many times the machine has been descaled;
  - the total number of litres of water delivered;
  - how many filters have been used.
5. Press the **P** button twice to exit the menu.

### Default values (reset)

This resets all menu settings and programmed quantities back to the default values (with the exception of the language which remains as set).

1. Press the **P** button to enter the menu;
2. Press the  or  button (corresponding to the < and > symbol on the display) until "Default Values" is displayed;
3. Press the **OK** button;
4. The message "Confirm?" is now displayed.
5. Press the **OK** button to confirm and exit.

## MAKING COFFEE



*Please note!*

A few seconds may elapse between energy saving mode and delivery of the first coffee.

### Selecting the coffee taste

The appliance is set by default to make coffee with a standard taste.





You can also choose one of these tastes:

- Extra-mild taste
- Mild taste
- Standard taste
- Strong taste
- Extra-strong taste

To change the taste, press the  button (fig. 2) repeatedly until the required taste is displayed.

### Selecting the quantity of coffee in the cup

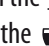
The appliance is set by default to automatically make the following quantities of coffee:

- short coffee when the  button is pressed;
- long coffee when the  button is pressed;
- two short coffees when the  button is pressed;
- two long coffees when the  button is pressed.

### Customising the quantity

To change the quantity of coffee the appliance delivers automatically into the cup, proceed as dPribed below.

- press for a few seconds, then release the the ☕ (short coffee) or ☕ (long coffee) button, until the message "PROGRAM QUANTITY" is displayed and coffee delivery commences;
- when the coffee in the cup reaches the required level, press the same button again to memorise the new amount. This is confirmed by two beeps.

The appliance is now reprogrammed with the new settings and the message "READY" is displayed.



*Please note:*

You can customise one cup coffee only: the double quantity is automatically updated.

### Adjusting the coffee mill

The coffee mill is set by default to prepare coffee correctly and should not require regulating initially.

However, if after making the first few coffees you find that delivery is either too fast or too slow (a drop at a time), this can be corrected by adjusting the grinding adjustment knob (fig. 10).



*Please note!*

The grinding adjustment knob must only be turned when the coffee mill is in operation.

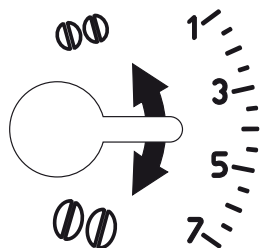

For faster delivery (not a drop at a time), turn one click clockwise towards "7" (coarser ground coffee).

For fuller bodied creamier coffee, turn one click anticlockwise towards "1" (finer ground coffee).

These adjustments will only be

evident after at least 2 cups of coffee have been delivered.

If delivery is still too fast or too slow, repeat the correction, turning the knob another click.

### Tips for a hotter coffee

For a hotter coffee, you are recommended to:

- before delivering the coffee, perform a rinsing cycle by pressing the ☕ button to select the "Rinsing" function. Hot water is delivered from the spout, heating the internal circuits of the appliance and thus raising the coffee temperature.
- place the cups on the cup warmer until they are warm.

- warm the cups by rinsing them with hot water (using the hot water function).
- set a higher coffee temperature in the menu.

### Making coffee using coffee beans



*Important!*

Do not use caramelised or candied coffee beans as they could stick to the coffee mill and make it unusable.

1. Fill the container with coffee beans (fig. 8).
2. Place under the coffee spouts:
  - 1 cup, if you want to make 1 coffee (fig. 9);
  - 2 cups, if you want 2 coffees (fig. 10);
3. Lower the spouts as near as possible to the cup. This makes a creamier coffee (fig. 11).
4. Press the button corresponding to the number of coffees required.
5. Preparation begins.

Once the coffee has been made, the appliance prepares for use again.



*Please note:*

- While the machine is making coffee, delivery can be interrupted at any moment by pressing one of the coffee buttons.
- At the end of delivery, to increase the quantity of coffee in the cup, just press (within 3 seconds) one of the coffee buttons.

Once the coffee has been made, the appliance is ready to use again.



*Important!*

If the coffee is delivered a drop at a time, too fast and not creamy enough or too cold, read the tips in the "Troubleshooting" section on page 19.

Various alarm messages could be displayed while using the machine. Their meaning is explained in the section "Displayed messages" (page 18).

### Making coffee using pre-ground coffee



*Important!*

- Never add pre-ground coffee when the machine is off or it could spread through the inside of the machine and dirty it. This could damage the appliance.
- Never use more than one level measure or it could dirty the inside of the machine or block the funnel.



 *Please note!*

If you use pre-ground coffee, you can only make one cup of coffee at a time.

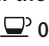
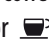
1. Press the  button (fig. 2) repeatedly until "READY PRE-GROUND" flashes on the display.
2. Put one level measure of pre-ground coffee into the funnel (fig. 13).
3. Place a cup under the coffee spouts.
4. Press the 1 cup  or  button (fig. 12).
5. Preparation begins.

After using the machine with pre-ground coffee, to go back to making coffee using beans, deactivate the pre-ground coffee function by pressing the  button again to enable the coffee mill.

## MAKING DRINKS WITH MILK

 *Please note!*

A few seconds may elapse between energy saving mode and delivery of the first drink.

### Filling and attaching the milk container

1. Turn the lid of the milk container clockwise until it becomes noticeably difficult to turn, then remove (fig. 14).
2. Fill the milk container with a sufficient quantity of milk, not exceeding the MAX level marked on the handle (fig. 15).

 *Please note!*

- For a denser more even froth, you must use skimmed or partially skimmed milk at refrigerator temperature (about 5°C). To avoid producing milk with poor froth or large bubbles, always clean the milk container lid and hot water nozzle as dPribed in the section "Cleaning the milk container" and "Cleaning the hot water/steam nozzle" (page 16).
3. Make sure the milk intake tube is correctly inserted in the bottom of the milk container lid (fig. 16).
  4. Replace the milk container lid and turn anticlockwise as far as it will go.
  5. Remove the hot water spout from the nozzle (fig. 17).
  6. Attach the container to the nozzle and push as far as it will go (fig. 18). The machine emits a beep (if the beep function is active).
  7. Place a sufficiently large cup under the coffee spouts and frothed milk spout.  
To use particularly tall cups/glasses, raise the lid of the compartment in the cup tray (fig. 19).

### Making cappuccino

1. After attaching the milk container, position the container pointer on 1 "CAPPUCCINO" printed on the milk container lid (fig. 20).  
The quantity of froth can be adjusted during delivery by moving the pointer slightly towards 2 "MACCHIATO" for a denser froth.  
Moving it towards 1 "CAPPUCCINO" obtains a less dense froth.
2. Press the CAPPUCCINO button (fig. 21). The message "CAPPUCCINO CONTAINER POINTER IN POSITION 1" appears. (After a few seconds, frothed milk flows out of the milk spout into the cup below. Milk delivery stops automatically and coffee delivery begins).

 *Please note:*

If during delivery you want to stop making milk or coffee, press the **CAPPUCCINO** button again.

### Making macchiato

1. After attaching the milk container, position the container pointer (B1) on 2 "LATTE MACCHIATO" (fig. 22) printed on the milk container lid.
2. Press the **LATTE MACCHIATO** button (fig. 23). The message "LATTE MACCHIATO CONTAINER POINTER IN POSITION 2" appears. After a few seconds, frothed milk flows out of the milk spout into the cup below. Milk delivery stops automatically and coffee delivery begins.

 *Please note:*

If during delivery you want to stop making milk or coffee, press the **LATTE MACCHIATO** button again.

### Making caffelatte

1. After attaching the milk container, position the container pointer on "3 CAFFELATTE" (fig. 24) printed on the milk container lid.
2. Press the **CAFFELATTE** button (fig. 25). The message "CAFFELATTE CONTAINER POINTER IN POSITION 3" appears. After a few seconds, milk is delivered from the milk spout into the cup below. Milk delivery stops automatically and coffee delivery begins.

 *Please note:*

If during delivery you want to stop making milk or coffee, press the **CAFFELATTE** button again.

### Making frothed milk and hot milk (WITHOUT COFFEE)

1. After attaching the milk container, position the container pointer (B1) according to the quantity of froth you require (pos. 3 caffelatte = little froth; pos. 1 cappuccino = fuller froth).

2. Press the CAPPUCCINO, LATTE MACCHIATO or CAFFELATTE button twice (within 2 seconds).

### Cleaning the milk container after use



*Important! Danger di scottature*

When cleaning the internal tubes of the milk container, a little hot water leaks out of the frothed milk tube (B5).

Avoid contact with splashes of water.

“PRESS CLEAN BUTTON” flashes on the display each time you use a milk function. To eliminate all milk residues, proceed as follows:

1. Leave the milk container in the machine (you do not need to empty it);
2. Place a cup or other recipient under the frothed milk spout.
3. Press the “CLEAN” button (fig. 26) and keep pressing until the progress bar which appears on the display together with the message “Cleaning...” is complete.
4. Remove the milk container and always clean the nozzle with a sponge (fig. 27).



*Please note!*

- When “PRESS CLEAN BUTTON” flashes on the display, you can still prepare any type of coffee or milk. If you have to make a number of drinks with milk, wait until you have delivered the last cup before cleaning the container.
- The milk left in the container can be kept in the refrigerator.

### Programming the quantities of coffee and milk in the cup

The appliance is set by default to automatically deliver standard quantities.

To change these quantities, proceed as follows:

1. Place a cup under the coffee spouts and milk spout.
2. Press the **CAPPUCCINO** button and hold down for at least 8 seconds until the message “MILK FOR CAPPUCCINO PROGRAM QUANTITY” is displayed.
3. The appliance starts delivering milk. Release the button.
4. Once the required quantity of milk has been delivered into the cup, press the **CAPPUCCINO** button again.
5. After a few seconds, the appliance starts delivering coffee into the cup and the message “COFFEE F. CAPPUCCINO PROGRAM QUANTITY” is displayed.
6. Once the required quantity of coffee has been delivered into the cup, press the **CAPPUCCINO** button. Coffee delivery stops and the appliance is ready for use.

The machine is now reprogrammed with the new quantities.

The quantities of coffee and milk for macchiato and caffelatte can also be programmed via the same procedure

## HEATING WATER

---



### Preparation



*Important! Danger of burns.*

Never leave the machine unsupervised while delivering hot water.

The hot water spout becomes hot while water is being delivered and must be handled by the handle only.

1. Make sure the hot water spout is attached correctly (fig. 4).
2. Place a container under the water spout (as close as possible to avoid splashes).
3. Press the  button. The message “HOT WATER” is displayed.
4. Water flows out of the spout. Delivery stops automatically after about 250 ml.
5. To interrupt delivery of hot water manually, press the  button again.





*Please note!*

You should not deliver hot water for more than 2 minutes at a time.

### Change the quantity of water delivered automatically.

The appliance is set by default to automatically deliver 250ml. To modify these quantities, proceed as follows:

1. Position a container under the spout.
2. Press the  button until the message “HOT WATER PROGRAM QUANTITY” is displayed.
3. When the hot water in the cup reaches the required level, press the  button again.

The machine is now reprogrammed with the new quantity.

## CLEANING

---



*Important!*

- Do not use solvents, abrasive detergents or alcohol to clean the appliance. With De'Longhi superautomatic coffee makers, you need not use chemical products to clean the machine.
- None of the components can be washed in a dishwasher apart from the milk container (B).
- Do not use metal objects to remove encrustations or coffee deposits as they could scratch metal or plastic surfaces.

### Cleaning the coffee maker

The following parts of the machine must be cleaned regularly:

- coffee grounds container (A17),
- drip tray (A15),
- the inside of the machine, accessible after opening the

- service door (A18),
- water tank (A12),
- coffee spouts (A19) and hot water nozzle (A10),
- pre-ground coffee funnel (A8),
- infuser (A11)
- milk container (B).

### Cleaning the coffee grounds container

When "EMPTY GROUNDS CONTAINER" is displayed, the grounds container must be emptied and cleaned.

Until the grounds container has been cleaned, the appliance continues to display the message and coffee cannot be made. Even if not full, the empty grounds container message is displayed 72 hours after the first coffee has been prepared. For the 72 hours to be calculated correctly, the machine must never be turned off with the main switch in the 0 position.

1. Open the service door on the front of the appliance (fig. 28), extract the drip tray (fig. 29), empty and clean.
2. Empty the grounds container and clean thoroughly to remove all residues left on the bottom. This can be done with the spatula on the brush provided.
3. Replace the drip tray complete with grounds container.
4. Close the service door.



When removing the drip tray, the grounds container **must** be emptied, even if it contains few grounds. If this is not done, when you make the next coffees, the grounds container may fill up more than expected and clog the machine.

### Cleaning the drip tray



If the drip tray is not emptied regularly, the water could overflow from the edge and seep inside or around the machine. This could damage the machine, the surface it rests on or the surrounding area.

The drip tray is fitted with a level indicator (red) showing the level of water it contains (fig. 30).

Before the indicator protrudes from the cup tray, the drip tray must be emptied and cleaned.

To remove the drip tray:

1. Open the service door (fig. 28);
2. Remove the drip tray and the grounds container (fig. 29);
3. Empty the drip tray and grounds container and wash them;
4. Replace the drip tray complete with grounds container;
5. Close the service door.

### Cleaning the inside of the machine



Before cleaning internal parts, the machine must be turned off (see "Turning off", page 10) and unplugged from the mains power supply.

Never immerse the coffee maker in water.

1. Check regularly (about every 100 coffees) that the inside of the appliance (accessible after removing the drip tray) is not dirty. If necessary, remove coffee deposits with the brush supplied.
2. Remove the residues with a vacuum cleaner (fig. 32).

### Cleaning the water tank

1. Clean the water tank (A12) regularly (about once a month) with a damp cloth and a little mild washing up liquid.
2. Clean to remove all washing up liquid residues, then rinse the water tank thoroughly.
3. Fill the tank with fresh water and put back in the appliance.

### Cleaning the coffee spouts

1. Clean the coffee spouts with a sponge or cloth (fig. 31).
2. Check the holes in the coffee spout are not blocked. If necessary, remove coffee deposits with a toothpick (fig. 32).

### Cleaning the pre-ground coffee funnel

Check regularly (about once a month) that the pre-ground coffee funnel (A7) is not blocked. If necessary, remove coffee deposits with the brush (A22) supplied.

### Cleaning the infuser

The infuser must be cleaned at least once a month.



The infuser may not be extracted when the machine is on.

1. Make sure the machine is correctly turned off (see "Turning off", page 10).
2. Open the service door (fig. 28).
3. Extract the drip tray and the grounds container (fig. 29).
4. Press the two red release buttons inwards and at the same time pull the infuser outwards (fig. 34).



RINSE WITH WATER ONLY

NO WASHING UP LIQUID - NO DISH WASHER

Do not use washing up liquid to clean the infuser as it could cause damage.

5. Soak the infuser in water for about 5 minutes, then rinse under the tap.

- Use the brush (A22) to remove any coffee residues left in the infuser housing, visible through the infuser door.
- After cleaning, replace the infuser by sliding it onto the internal support and pin at the bottom, then push the PUSH symbol fully in until it clicks into place.

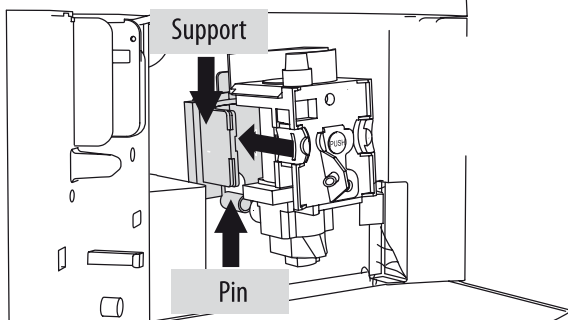

**i** Please note!

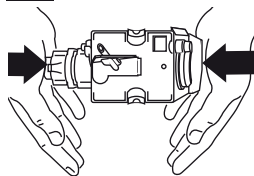

If the infuser is difficult to insert, you must first adapt it to the right dimensions by pressing it forcefully from the bottom and top as shown in the figure.

- Once inserted, make sure the two red buttons have snapped out.
- Replace the drip tray and waste coffee container.
- Close the service door.

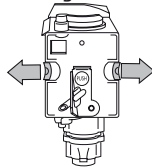

### Cleaning the milk container

Clean the milk container each time you prepare milk as dPribed below:

- Turn the milk container lid clockwise then remove it.
- Remove the milk spout and intake tube.
- Wash all the components thoroughly with hot water and mild washing-up liquid. **All components are dishwasher safe, placing them in the top basket of the dishwasher.**
- Make sure there are no milk residues left inside the holes.
- Check that the intake tube and spout are not clogged with milk residues.
- Replace the milk

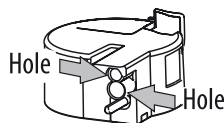
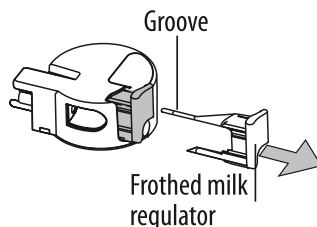
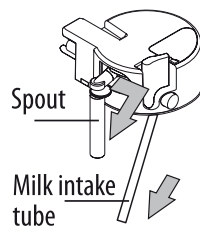

spout and intake tube.

- Replace the lid on the milk container, turning it anticlockwise to hook it in place.

### Cleaning the hot water/steam nozzle

Each time you prepare milk, clean the nozzle with a sponge to remove milk residues from the gaskets (fig. 24).

### DESCALING

Descale the machine when the message "Descal" flashes on the display.



**Important!**

Descaler contains acids which may irritate the skin and eyes. It is vital to respect the manufacturer's safety warnings given on the descaler pack and the warnings relating to the procedure to follow in the event of contact with the skin and eyes.



**Please note!**

Use De'Longhi descaler only. Under no circumstances should you use sulphamic or acetic based descalers. Their use invalidates the guarantee.

Failure to descale the appliance as dPribed above also invalidates the guarantee.

- Turn the machine on.
- Enter the settings menu by pressing the **P** button.
- Select by pressing the **OK** button. "Descaling Confirm?" is displayed. Press **OK** to enable the function.
- The message "Add descaler" "Press OK" is displayed.
- Before confirming, empty the water tank (A13). Pour the descaler diluted with water (respecting the proportions indicated on the descaler pack) into the water tank. Place an empty container with a minimum capacity of 1.5 litres under the hot water spout.



**Important! Danger of burns**

Hot water containing acid flows out of the hot water spout. Avoid contact with splashes of water.

- Confirm by pressing the **OK** button.
- The message "Descaling..." is displayed. The descaling programme starts and the descaler liquid comes out of the water spout. The descale programme automatically performs a series of rinses and pauses to remove limescale deposits from inside the machine. After about 30 minutes, the message "Rinsing FILL TANK!" is displayed.
- The appliance is now ready for rinsing through with clean water. Remove the water tank, empty, rinse under running

water, fill with clean water and replace. "Rinsing... Press OK" is displayed.

9. Empty the container used to collect the descaler solution and replace it under the hot water spout.
10. Press the **OK** button to start rinsing. Hot water flows out of the spout and the message "Rinsing..." is displayed.
11. When the water tank is completely empty, the message "Rinsing Complete... Press OK" is displayed.
12. Press the **OK** button. The appliance goes off.

To use it again, turn the appliance on by pressing the  button.

## SETTING WATER HARDNESS

The Descale message is displayed after a period of time established according to water hardness.

The machine is set by default for a hardness value of 4.



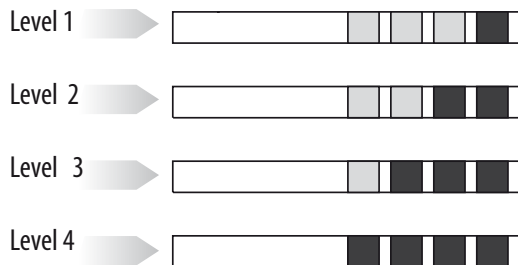

The machine can also be programmed according to the actual hardness of the mains water in the various regions, varying the frequency with which the message is displayed.

### Measuring water hardness

1. Remove the "TOTAL HARDNESS TEST" indicator paper from its pack.
2. Immerse the paper completely in a glass of water for one second.
3. After about a minute, 1, 2, 3, or 4 red squares form, depending on the hardness of the water. Each square corresponds to one level.



### Set water hardness

1. Press the **P** button to enter the menu.
2. Press the  or  button (corresponding to the < and > symbol on the display) repeatedly until the menu arrow is on "WATER HARDNESS".
3. Confirm the selection by pressing the **OK** button.
4. Press the  or  button (corresponding to the < and > symbol on the display) to set the number of squares formed on the reactive strip (see figure in the previous section).
5. Press the **OK** button to confirm the setting.
6. Press the **P** button (corresponding to the **ESC** symbol flashing on the display) to exit programming mode or > to change other parameters.

The machine is now reprogrammed with the new water hardness setting.

## WATER SOFTENER FILTER

Certain models are fitted with a water softener filter. If this is not the case with your model, you are recommended to purchase one from De'Longhi Customer Services. To use the filter correctly, follow the instructions below.

### Installing the filter

1. Remove the filter from the packaging.
2. Turn the date indicator disk until the next two months of use are displayed. (fig. 35).





#### Nota Bene

The filter lasts about two months if the appliance is used normally. If the coffee machine is left unused with the filter installed, it will last a maximum of three weeks.

3. To activate the filter, let tap water go in the hole of the filter as shown in the figure as long as the water comes out from the side openings for over one minute (fig. 36).
4. Extract the tank from the appliance and fill with water.
5. Insert the filter in the water tank and immerse it completely for about 30 seconds, turning it upside down to enable the air bubbles to escape (fig. 37).
6. Insert the filter in the filter housing and press as far as it will go (fig. 38).
7. Close the tank with the lid, then put the tank back in the machine (fig. 39).

When you install the filter, you must notify the appliance of its presence.



8. Access the menu by pressing the **P** button;
9. Scroll through the menu by pressing the  or  button (corresponding to the < and > symbol on the display) repeatedly until "Install water filter" is displayed.
10. Press the **OK** button.
11. The message "Water filter, Install?" is displayed.
12. Press the **OK** button to confirm the selection. The message "Insert water spout and press OK".
13. Position a container under the hot water spout (min. capacity: 100 ml).
14. Press **OK** to confirm the selection. The appliance begins delivering hot water and "Please wait" is displayed.
15. After delivery, the appliance is automatically ready to make the next drink.

Now the filter is activated and the appliance is ready to use.

### Replacing the filter

When "REPLACE FILTER" is displayed, after two months (see date indicator) or if the appliance has not been used for 3



weeks, you should replace the filter:

1. Extract the tank and exhausted filter;
2. Remove the new filter from the packaging and proceed as illustrated on the previous paragraph (points 3-4-5-6).
3. Position a container with a minimum capacity of 100 ml under the hot water spout.
4. Access the menu by pressing the **P** button;
5. Scroll through the menu by pressing the  or  button (corresponding to the  $<$  and  $>$  symbol on the display) until "Replace filter?" is displayed.
6. Press the **OK** button.
7. "CONFIRM?" is displayed.
8. Press the **OK** button to confirm.
9. "Insert water spout and press OK" is displayed;
10. Press **OK** to confirm the selection. The appliance begins delivering hot water and "Please wait" is displayed.
11. After delivery, the appliance is automatically ready to make the next drink.

The new filter is now active and you can use the coffee machine.

### Removing the filter

If you want to continue using the appliance without a filter, you must remove it and notify the appliance of its removal as follows:

1. Extract the tank and exhausted filter;
2. Reinsert the water tank;
3. Press the **P** button to enter the menu;
4. Press the  or  button (corresponding to the  $<$  and  $>$  symbol on the display) until "remove water filter" is displayed.
5. Press **OK**.
6. "CONFIRM?" is displayed.
7. Press **OK** to confirm and **P** to exit.

### TECHNICAL SPECIFICATION

|                                |                              |
|--------------------------------|------------------------------|
| Voltage:                       | 220-240 V~ 50/60 Hz max. 10A |
| Absorbed power:                | 1350W                        |
| Pressure:                      | 15 bar                       |
| Water tank capacity:           | 1,8 L                        |
| Size: LxHxD:                   | 282x364x425 mm               |
| Cable length:                  | 1,5 m                        |
| Weight:                        | 11 Kg                        |
| Max. beans container capacity: | 200 g                        |

 The appliance complies with the following EC directives:

- Stand-by Directive no. 1275/2008
- Low Voltage Directive 2006/95/EC and subsequent amendments;

- EMC Directive 2004/108/EC and subsequent amendments
- Materials and accessories coming into contact with food conform to the provisions of EC regulation 1935/2004.

### DISPOSAL



Important information for correct disposal of the product in accordance with EC Directive 2002/96/EC. At the end of its working life, the product must not be disposed of as urban waste.

It must be taken to a special local authority differentiated waste collection centre or to a dealer providing this service.

Disposing of a household appliance separately avoids possible negative consequences for the environment and health deriving from inappropriate disposal and enables the constituent materials to be recovered to obtain significant savings in energy and resources.

As a reminder of the need to dispose of household appliances separately, the product is marked with a rubbish bin bearing a cross.

## DISPLAYED MESSAGES

| DISPLAYED MESSAGE           | POSSIBLE CAUSE  | REMEDY   |
|-----------------------------|---|--|
| FILL TANK                   | Insufficient water in the tank.   | Fill the tank with water and/or insert it correctly, pushing it as far as it will go until it clicks into place (fig. 3).  |
| GROUND TOO FINE ADJUST MILL | The grinding is too fine and the coffee is delivered too slowly or not at all.                          | Repeat coffee delivery and turn the grinding adjustment knob one click clockwise towards "7" while the coffee mill is in operation.<br>If after making at least 2 coffees delivery is still too slow, repeat the correction procedure, turning the Grinding adjustment knob another click until delivery is correct.   |
| INSERT WATER SPOUT          | The water spout is not inserted or is inserted incorrectly.   | Insert water spout as far as it will go (fig. 4).  |
| EMPTY GROUNDS CONTAINER     | The grounds container is full.  | Empty the grounds container and clean, then replace. Important: when removing the drip tray, the grounds container MUST be emptied, even if it contains few grounds. If this is not done, when you make the next coffees, the grounds container may fill up more than expected and clog the machine. (To ensure the 72 hours are calculated correctly, the appliance must never be turned off with the main switch in the 0 position.) |
|                             | 72 hours have passed since the first coffee after the grounds container was last emptied.               |  |
| INSERT GROUNDS CONTAINER    | After cleaning, the grounds container has not been replaced.  | Open the service door, remove the drip tray and insert the grounds container.  |
| ADD PRE-GROUND COFFEE       | The "pre-ground coffee" function has been selected without placing any pre-ground coffee in the funnel. | Place pre-ground coffee in the funnel or deselect the "pre-ground" function.   |
| DESCALE                     | The machine must be descaled.   | The descaling procedure dPribed in the "Descaling" section needs to be performed as soon as possible.  |
| LESS COFFEE                 | Too much coffee has been used.  | Select a milder taste or reduce the quantity of pre-ground coffee.   |
| FILL BEANS CONTAINER        | The coffee beans have run out.  | Fill the beans container   |
|                             | The pre-ground coffee funnel is clogged.  | Empty the funnel as dPribed in the section "Cleaning the pre-ground coffee funnel".  |
| INSERT INFUSER ASSEMBLY     | The infuser has not been replaced after cleaning.   | Insert the infuser as dPribed in the paragraph "Cleaning the infuser".   |
| CLOSE DOOR                  | The service door is open  | Close the service door.  |
| INSERT MILK CONTAINER       | The milk container is not inserted correctly.   | Insert the milk container as far as it will go.  |
| PRESS CLEAN                 | Milk has been delivered recently and the tubes inside the milk container must be cleaned.               | Press the "CLEAN" button and keep pressing until the progress bar is complete. "Cleaning underway" is displayed.   |
| GENERAL ALARM               | The inside of the appliance is very dirty.  | Clean the inside of the appliance thoroughly, as dPribed in the section "Cleaning and maintenance". If the message is still displayed after cleaning, contact a service centre.  |

## TROUBLESHOOTING

Below is a list of some of the possible malfunctions. If the problem cannot be resolved as dPribed, contact Customer Services.

| PROBLEM   | POSSIBLE CAUSE   | REMEDY   |
|---|--|--|
| The coffee is not hot   | The cups were not preheated.   | Warm the cups by rinsing them with hot water (using the hot water function).   |
|   | The infuser has cooled down because 2/3 minutes have elapsed since the last coffee was made. | Before making the coffee, heat the infuser using the rinse  button.  |
|   | A low coffee temperature is set.   | Set maximum coffee temperature in the menu   |
| The coffee is not creamy enough.  | The coffee is ground too coarsely.   | Turn the grinding adjustment knob one click anticlockwise towards "1" while the coffee mill is in operation (fig. 8). Continue one click at a time until coffee delivery is satisfactory. The effect is only visible after delivering 2 coffees (see the section: "Adjusting the coffee mill" on page 12). |
|   | Wrong type of coffee   | Use a type of coffee for espresso coffee makers.   |
| The coffee is delivered too slowly or a drop at a time.                       | The coffee is ground too finely.   | Turn the grinding adjustment knob one click clockwise towards "7" while the coffee mill is in operation (fig. 11). Continue one click at a time until coffee delivery is satisfactory. The effect is only visible after delivering 2 coffees (see the section: "Adjusting the coffee mill" on page 12).    |
| The coffee does not come out of the spouts, but from around the service door. | The holes in the spouts are clogged.   | Clean the spouts with a toothpick (fig. 29).   |
|   | The coffee guide inside the service door is blocked.   | Thoroughly clean the coffee guide, particularly near the hinges.   |
| The milk contains bubbles or squirts out of the milk spout.                   | The milk is not cold enough or is not semi-skimmed.  | You should ideally use skimmed or semi-skimmed milk at refrigerator temperature (about 5°C). If the result is not as you wished, try changing brand of milk.   |
|   | The milk container lid is dirty.   | Clean the milk container lid as dPribed in the section "Cleaning the milk container" (page 16).  |
|   | The hot water/steam nozzle is dirty  | Clean the nozzle as dPribed in the section "Cleaning the hot water/steam nozzle" (page 16).  |
| The milk is not frothed.  | The milk container lid is dirty.   | Clean the milk container lid as dPribed in the section "Cleaning the milk container" (page 16).  |
|   | The hot water/steam nozzle is dirty  | Clean the nozzle as dPribed in the section "Cleaning the hot water/steam nozzle" (page 16).  |
|   | the frothed milk regulator is in the "CAFFELATTE" position.                                  | Put the milk regulator in the "CAPPUCCINO" position.   |
| The appliance does not come on.   | It is not plugged into the mains socket.   | Plug into the mains socket.  |
|   | The main switch is not in position I.  | Place the main switch in the I position (fig. 1).  |
| The milk does not come out of the milk spout.                                 | The milk container lid is dirty.   | Clean the milk container lid as dPribed in the section "Cleaning the milk container" (page 16).  |