

This Owner's Manual is provided and hosted by [Appliance Factory Parts](#).



Coleman 5055-710 Owner's Manual

[Shop genuine replacement parts for Coleman 5055-710](#)



[Find Your Coleman HVAC Parts - Select From 36 Models](#)

----- Manual continues below -----



Assembly and Instruction Sheet Dome Fireplace

Model 5055-710



Follow these instructions for assembly and read carefully, particularly the safety statements. The safety alert symbol, **▲** is a universally recognized symbol used to identify safety information about hazards that can result in personal injury. When this symbol is used you should pay very close attention to what is written. Review these instructions before beginning assembly or using your fireplace.

FOLLOW INSTRUCTIONS AND WARNINGS TO AVOID FIRE, SERIOUS INJURY OR DEATH.

▲WARNING

- Outdoor use only. Never use in enclosed area. Use in unventilated areas will endanger your life.
- Keep away from all combustible materials including gasoline and other flammable liquids and vapors.
- Use on a level, noncombustible surface only. Keep away from house, garage, balconies, or eave overhangs.
- Keep out of the reach of children.
- Be sure screen is in place while in use and do not use in windy conditions.
- Do not overfill firebowl or use to burn leaves and trash.
- Exercise the same care you would with an open fire.
- Never leave unit unattended when hot or in use.
- Completely extinguish fire before leaving.
- Use gloves when handling or moving. Ashes can remain warm for a long time after extinguishing.
- Dispose of cold ashes properly.
- Do not modify in any way nor use with parts not expressly approved by Coleman.
- Combustion by-products produced when using this product contain chemicals known to the State of California to cause cancer, birth defects, or other reproductive harm.

Contact local authorities regarding possible burn restrictions before using product.

Fireplace Parts Check List

• Check package for all parts needed for assembly.

- | | |
|---|--|
| <input type="checkbox"/> 1. Firebowl | <input type="checkbox"/> 7. Leg Support Ring |
| <input type="checkbox"/> 2. 4 Pc. Screen Assembly | <input type="checkbox"/> 8. Screen Support Rings (2) |
| <input type="checkbox"/> 3. Handle | <input type="checkbox"/> 9. Hardware Kit |
| <input type="checkbox"/> 4. Dome Lid | <input type="checkbox"/> 10. Leg Assemblies |
| <input type="checkbox"/> 5. Protective Cover | <input type="checkbox"/> 11. Grates |
| <input type="checkbox"/> 6. Top Ring | |

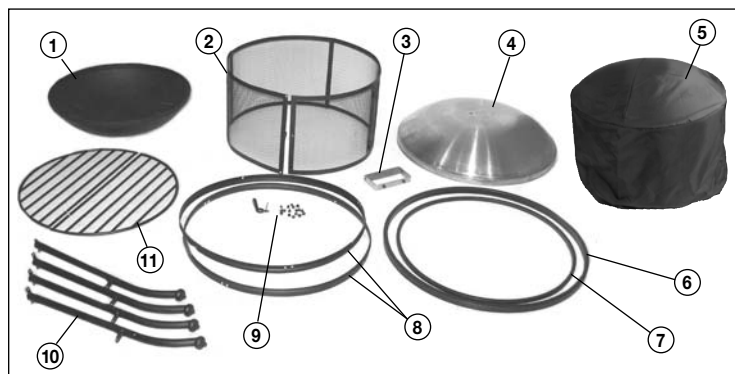

- Check all items for shipping damage. Call Coleman at 1-800-835-3278 or TDD: 316-832-8707 if you have any problems.

Assembly

1. Carefully unpack all parts from shipping box.

NOTE: In Steps 2 and 3, the stand is assembled up side down for ease of assembly. Use a ground cloth to protect the finish.

2. Align holes in Leg Assembly Brackets with holes in Top Ring. Attach with two small screws per leg. Hand tighten.

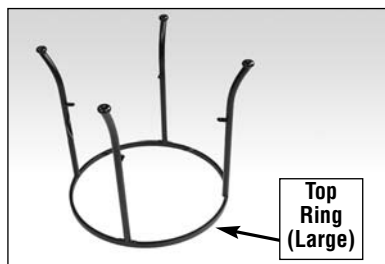

Assembly (cont.)

3a. Assemble Leg Support Ring to the four leg assemblies. Fasten to Leg Brackets with one small screw per leg (see arrows). Tighten all fasteners.

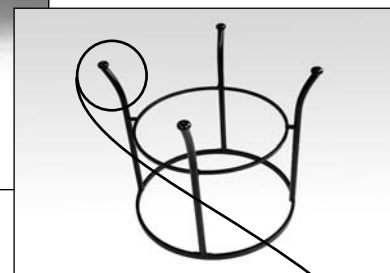
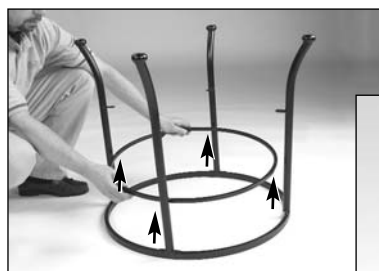

3b. Install four foot pads, one into each leg.

NOTE: In some models, the foot pads are pre-installed by the factory.



4a. To assemble screen, align holes in the 3 screen panels with the holes on outside edge of screen support ring. Attach with small screws and hex nuts but do not tighten at this time.

NOTE: Make sure latch bracket panel and hinge panel are positioned as shown for proper installation.

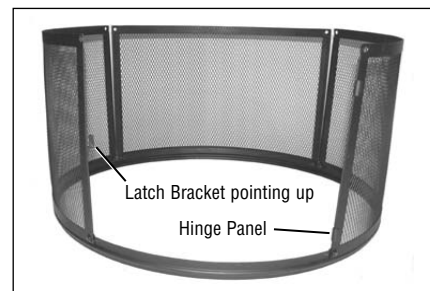

Assembly (cont.)

4b. Align holes in the 3 screen panels with the holes on outside edge of the remaining screen support ring. Attach with small screws and hex nuts. Tighten all screws and hex nuts on the screen assembly at this time.

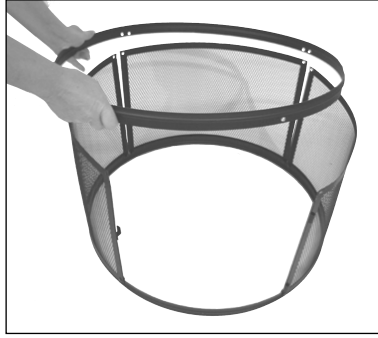

4c. Install screen door by inserting pins into hinge slots on the screen hinge panel

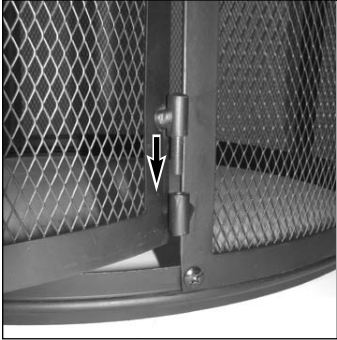

5. Turn frame right side up. Place Screen Assembly into frame. Make sure door is centered between two Leg Assemblies, and can open and close properly.



6a. Assemble screen door latch.
NOTE: Two hex nuts and latch bar will assemble on the inside of the screen door.

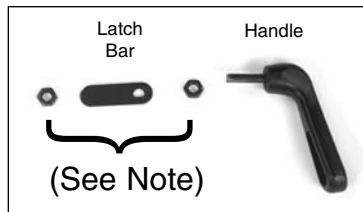

6b. Insert handle from outside. Loosely assembly one hex nut. The handle should freely turn. Point the handle downward to begin the next step.



6c. Slip latch bar onto handle threads. Align "D" slot in latch bar with flat on handle threads. The latch bar should point toward the left. Assemble the second hex nut to finish the assembly. This hex nut functions as a "jam nut", and will tighten against the first hex nut assembled in Step 5b.

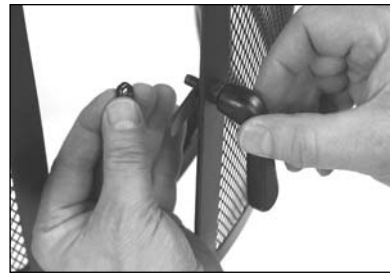

6d. Tighten the "jam nut" with a wrench.



6e. Proper installation of the latch assembly.



7. Install the firebowl.

NOTE: An inch or two of sand should be used in firebowl beneath the grate.



8. Install two grates.



Assembly (cont.)

9. Attach handle to lid using 2 screws and hex nuts. Tighten fasteners.



Set Up and Use

⚠ WARNING

Never leave unit unattended when hot or in use. Keep out of reach of children. For outdoor use only. Never use in enclosed area. Use in unventilated areas will endanger your life.

1. Place unit on a level, noncombustible surface. Keep well away from house, garage, balconies or eave overhangs. Do not use on wooden decks.
2. Be sure grate is placed in firebowl. Add newspaper, kindling & wood on top of grate.
3. Ignite newspaper & kindling with match or butane lighter.
4. Once fire is lit, close and latch the screen door.
5. Screen door handle is hot when in use. Take care when opening and closing the screen door.

After Use

⚠ WARNING

To avoid burns – use heavy gloves when handling hot surfaces.

1. Completely extinguish fire before leaving.
2. Do not use water to douse the fire as this may warp the firebowl.
3. Dispose of cold ashes properly.
4. Be careful – fire may be out but firebowl can still be hot. Handle carefully.
5. Store in covered enclosure.
6. Only place vinyl cover on unit after unit is completely cooled to touch.

Repair Parts List

Model 5055-710

Part No.	Description
5055-5011	Screen Panels (4 pcs.)
5055-1001	Protective Cover
5055-1101	Top Ring
5055-5301	Hardware Kit
5055-1501	Leg Support Ring
5055-4001	Grates (2 pcs.)
5055-5001	Leg Assembly (1 pk.)
5055-1551	Foot Pads (4 pk.)
5055-1051	Lid Handle
5055-1121	SS Dome Lid
5055-1171	Screen Support Rings (2 pcs.)

Limited One Year Warranty

The Coleman Company, Inc. ("Coleman") warrants that for a period of one year from the date of original retail purchase, this product will be free from defects in material and workmanship. Coleman, at its option, will repair or replace this product or any component of the product found to be defective during the warranty period. Replacement will be made with a new or remanufactured product or component. If the product is no longer available, replacement may be made with a similar product of equal or greater value. This is your exclusive warranty.

This warranty is valid for the original retail purchaser from the date of initial retail purchase and is not transferable. Keep the original sales receipt. Proof of purchase is required to obtain warranty performance. Coleman dealers, service centers, or retail stores selling Coleman® products do not have the right to alter, modify or in any way change the terms and conditions of this warranty.

What This Warranty Does Not Cover

This warranty does not cover normal wear of parts, parts that are not genuine Coleman® parts, or damage resulting from any of the following: negligent use or misuse of the product; use on improper voltage or current; commercial use of the product; use contrary to the operating instructions; disassembly, repair or alteration by anyone other than Coleman or an authorized service center. Further, the warranty does not cover Acts of God, such as fire, flood, hurricanes and tornadoes. Warranty void if damage to product results from the use of a part other than a genuine Coleman® part.

COLEMAN SHALL NOT BE LIABLE FOR DEFECTS THAT ARE CAUSED BY THE USE OF UNAUTHORIZED PARTS OR SERVICE. COLEMAN SHALL NOT BE LIABLE FOR ANY INCIDENTAL OR CONSEQUENTIAL DAMAGES CAUSED BY THE BREACH OF ANY EXPRESS OR IMPLIED WARRANTY OR CONDITIONS. EXCEPT TO THE EXTENT PROHIBITED BY APPLICABLE LAW, ANY IMPLIED WARRANTY OF MERCHANTABILITY OR FITNESS FOR A PARTICULAR PURPOSE IS LIMITED IN DURATION TO THE DURATION OF THE ABOVE WARRANTY OR CONDITIONS. SOME STATES, PROVINCES, OR JURISDICTIONS DO NOT ALLOW THE EXCLUSION OR LIMITATION OF INCIDENTAL OR CONSEQUENTIAL DAMAGES OR LIMITATIONS ON HOW LONG AN IMPLIED WARRANTY LASTS, SO THE ABOVE LIMITATIONS OR EXCLUSION MAY NOT APPLY TO YOU. THIS WARRANTY GIVES YOU SPECIFIC LEGAL RIGHTS, AND YOU MAY ALSO HAVE OTHER RIGHTS THAT VARY FROM STATE TO STATE OR PROVINCE TO PROVINCE.

How to Obtain Warranty Service

Take the product to an authorized Coleman service center. You can find the nearest authorized Coleman service center by visiting www.coleman.com or calling 1-800-835-3278 or TDD 316-832-8707 in the United States. If a service center is not conveniently located, attach to the product a tag that includes your name, address, daytime telephone number and description of the problem. Include a copy of the original sales receipt. Carefully package the product and send either by **courier** or **insured mail** with shipping and insurance prepaid to:

For products purchased in the United States:

The Coleman Company, Inc.
3600 North Hydraulic
Wichita, KS 67219

The costs of transporting the product to Coleman or an authorized service center for warranty service is the responsibility of the purchaser.

Do not mail products with fuel in tanks, or with disposable propane cylinders. Remove glass globes from lanterns and wrap separately.

DO NOT RETURN THIS PRODUCT TO THE PLACE OF PURCHASE.

If you have any questions regarding this warranty please call 1-800-835-3278 or TDD 316-832-8707 in the United States.

The Coleman Company, Inc. • 3600 N. Hydraulic • Wichita, KS 67219
1-800-835-3278 • TDD: 316-832-8707

© 2006 The Coleman Company, Inc. All rights reserved. Coleman® and  are registered trademarks of The Coleman Company, Inc.