

This Owner's Manual is provided and hosted by [Appliance Factory Parts](http://www.appliancefactoryparts.com).



Royal 1018 Owner's Manual

[Shop genuine replacement parts for Royal 1018](#)

Model: 1018(Z), 1025, 1030(Z), 1038(Z), 089000

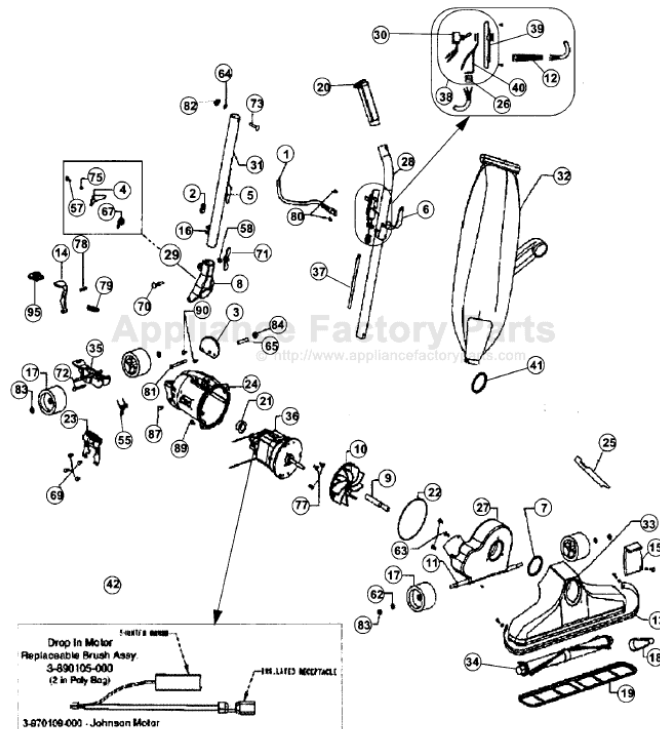

[Find Your Royal Vacuum Cleaner Parts - Select From 772 Models](#)

----- Manual continues below -----

Model: 1018(Z), 1025, 1030(Z), 1038(Z), 089000

Index	Part No.	Description
1	R-061136	Cord, 50 ft, orange
	R-061136B	Cord, 50 ft, gray (1025, 089000)
2	R-230324	Grommet
3	R-133716	Handle stop plate
4	R-133737	Handle fork latch
5	R-259316	Cord hook, lower
6	R-259317	Cord hook upper
7	R-2854270	Gasket, nozzle sealing
8	R-4285704	Handle fork, gray (1018, 1018Z)
	R-2857040	Handle fork, polished
9	R-380261	Shaft extension
10	R-608005	Fan, slip on
11	R-611101	Axle stud
12	R-611305	Strain relief, power cord
13	R-8012016	Bumper, black
	R-8012018	Bumper, gray
14	R-690715	Release pedal
15	R-167074	Nozzle plug, black
16	R-670844	Cord clip
17	R-671705	Wheel
18	R-672260	Belt
19	R-672270	Nozzle guard, 14"
20	R-880314	Handle grip, black
21	R-870006	Grommet, motor
22	R-870024	Motor housing o-ring
23	R-870130	Side plate
24	R-871201	Motor housing (1018, 1018Z)
	R-871101	Motor housing, polished
25	R-880262	Belt lifter
26	R-880304	Strain relief, internal cord
27	R-670116	Fancase assembly
	R-967011	Fancase assembly (1018, 1018Z)
28	R-891053	Upper handle assembly, includes #6 and #20 (1018, 1018Z)
	R-891052	Upper handle assembly, includes #6 and #20 (1025, 1030[Z], 1038[Z], 089000)
29	R-028580	Handle fork and latch assembly
	R-0285801	Handle fork and latch assembly (1018, 1018Z)
30	R-163309	Switch
31	R-891061	Handle adaptor assembly, includes #5 and #16
	R-891062	Handle adaptor assembly, includes #5 and #16 (1018, 1018Z)
32	R-066240	Hinged bag assembly, complete (1018, 1025, 1030, 1038)
	R-066248	Shake out bag assembly, orange (1018,1030,1038)
	R-0662421	Hinged bag assembly, complete, w/zipper orange (1018Z, 1030Z, 1038Z)
	R-028543	Scafitex bag assembly, red (089000)
33	R-671026B	Nozzle assembly
	R-671027	Nozzle assembly (1018, 1018Z)

Index	Part No.	Description
36	R-701020	10 amp
	R-970102	7 amp
37	R-703236	Short c
38	R-060837	Switch
39	R-608305	Switch
40	R-031103	Strain r
41	R-601407	Rubber
42	R-38901050000	Carbon
	R-970109	Carbon
55	R-003008	Wheel
56	R-003009	Rod sp
57	R-003022	Latch r
58	R-003311	Washes
59	R-003884	Spring
60	R-006318	Lockwa
61	R-004723	Handle
62	R-005138	Wheel
63	R-023309	Screw
64	R-074330	Lockwa
65	R-110773	Motor h
66	R-110775	Rod ad
67	R-133738	Handle
68	R-145734	Screw
69	R-186012	Self tap
70	R-230713	Carriag
71	R-285720	Large v
72	R-311031	Rear a
73	R-074329	Square
74	R-597743	Screw
75	R-601772	Latch s
76	R-606210	Headlig
77	R-670013	Motor p
78	R-670705	Spring
79	R-672009	Releas 1058, 0
80	R-801701	Screw
81	R-801708	Handle
82		Nut w/r
83	R-801711A	Wheel
84	R-801714	Nut
85	R-802244	Screw
86	R-870013	Adjuste
87	R-880707	Screw
88	R-884708	Eye bo
89	R-980743	Thread
90	R-990104	screw
91	R-996011	Adjuste
92	R-996101	Retaini
93	R-996711	E-ring
94	N/A	Screw