

ROYAL

METAL UPRIGHTS

Models: 7910

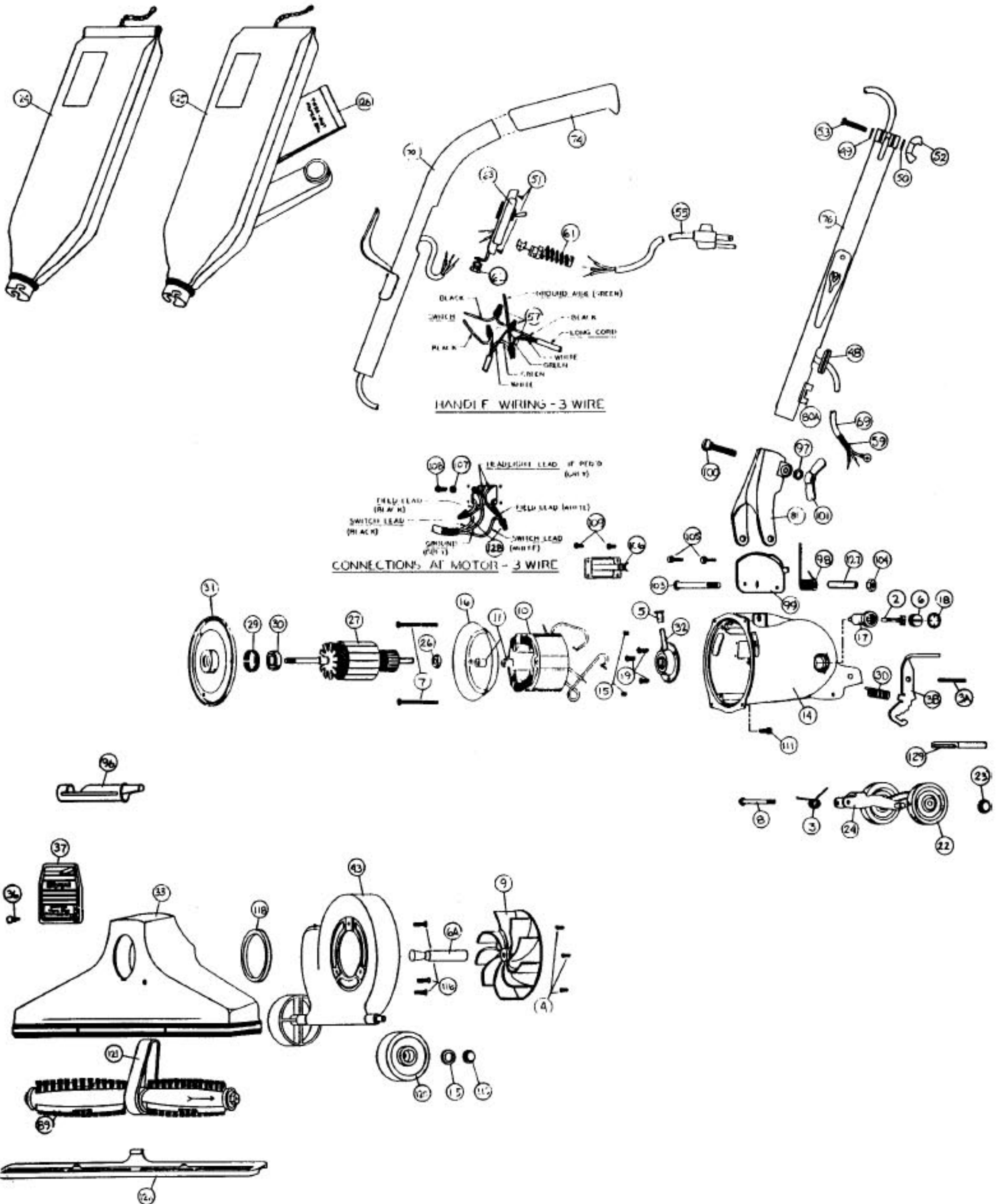

Models: 7910

NLA.....	Motor Unit Assy	97	R-003311	Washer, handle clamp bolt	
2	R-672105	Carbon Brush Assy (pair)	98	R-004723	Handle Ford Spring
3	R-003008	Spring, rear fork	99	R-133714	Handle Stop Plate
3A	R-670705	Spring Pin	100	R-230713	Bolt, handle clamp
3B	R-690715	Release Pedal, incremental	101	R-285720	Wingnut, large
3D	R-672009	Spring, release pedal	103	R-801708	Bolt, handle fork ret.
4	R-670013	Screw, motor plate ret.	104	R-801714	Nut, nylon insert
5	R-065028	Oiler Cap	105	R-990104	Screw, handle stop plate
6	R-672103	Brush Holder & Screw Assembly	106	R-183749	Side Plate
6A	R-380261	Drive Shaft	107	R-006318	Lockwasher
7	R-618016	Screw, field retainer	108	R-880707	Screw, ground lead
8	R-311031	Screw & Washer Assembly	109	R-360753	Screw, side plate
9	R-608005	Fan, heavy duty	111	R-980743	Screw, motor housing
10	R-780002	Field, 120v	115	R-005138	Washer, wheel retainer
11	R-618772	Spacer, baffle	116	R-023309	Screw, nozzle & fan case
14	NLA.....	Motor Housing Assembly	118	R-2854270	Gasket, nozzle sealing
15	R-801014	Set Screw, brush holder	119	NLA.....	Wheel Retainer
16	R-801017	Baffle Plate	120	R-671705	Wheel, wide
17	R-801019	Brush Holder	121	R-672260	Belt
18	R-801034	Brush Holder Protector Cap	122	R-692270	Nozzle Guard
19	R-801701	Screw, rear bearing retainer	124	R-770040	Bag Assy, shakeout, 7910
18	R-133715	Adjuster Release	125	NLA.....	Bag Assy, zipper, 7910Z
	R-067105	Rear Wheel, Fork & Shaft Assy	126	R-3067247	Paper Bag, 3 pack
22	R-880705	Wheel, 2 1/2" diam.	126	R-671075	Paper Bag, Microfresh, 3 pack
23	R-801711A	Wheel Retainer	126	R-66247	Paper Bag, 10 pack
24	R-670007	Rear Fork & Shaft Assembly	126	745.....	Paper Bag, 3 pack (R)
	R-078007	Motor Plate & Armature Assy	127	R-110773	Insert, motor housing
26	R-175053	Washer, oil slinger	128	R-259761	Wire Connector
27	R-780001	Armature, 120v	129	R-1300086	Foot Adjustment Cover
	NLA.....	Motor Plate & Bearing Assy			
29	R-880046	Tolerance Ring			
30	R-880026	Ball Bearing			
31	R-884003	Motor Plate			
32	R-080126	Rear Bearing Assembly			
33	R-381026	Nozzle Assembly			
36	NLA.....	Rivet, nozzle plug			
37	R-670744B	Nozzle Plug			
43	R-061810	Fancase Assembly			
	R-670118	Handle & Cord Assembly, 50ft			
48	R-230324	Grommet			
50	R-023311	Lockwasher			
51	R-801701	Screw, switch plate			
42	R-801710	Wingnut, small			
53	R-360713	Screw, adaptor clamp			
	R-060831	Switch & Cord Assembly, 50 ft			
55	NLA.....	Cord & Plug Assembly, 50 ft			
57	R-259761	Wire Connector			
59	NLA.....	Cord Protecting Sleeve			
61	R-611305	Strain Relief, switch plate			
62	R-880304	Strain Relief, handle			
63	R-060837	Switch & Plate Assembly			
70	NLA.....	Upper Handle Assembly			
74	R-801314	Handle Grip			
76	R-0655330	Handle Adaptor Assembly			
80A	R-670844	Cord, clip			
81	R-028580	Handle Fork & Latch Assy			
89	R-692225	Revolving Brush Assembly			
96	R-880262	Belt Lifter			