

Models: 9700

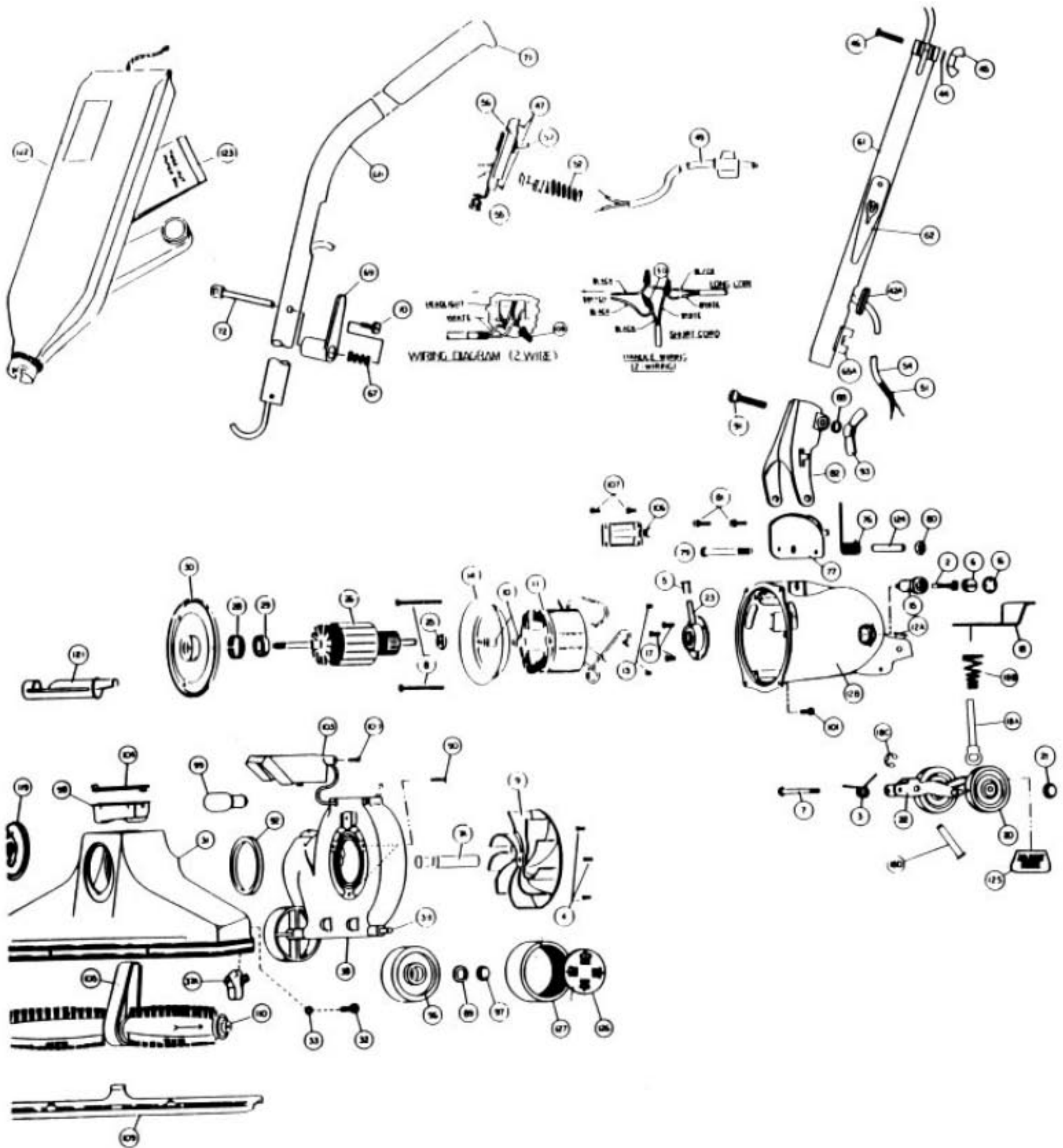

Models: 9700

| | | | | | |
|-----------|-------------------------------|-------------------------------|-----------|--|---------------------------------------|
| NLA | Motor Unit Assy | 52 | R-322305 | Strain Relief, switch plate | |
| 2 | R-672105 | Carbon Brush Assy | 54 | NLA | Short Cord |
| 3 | R-003008 | Spring, rear fork | 55 | R-880305 | Strain Relief |
| 4 | R-670013 | Screw, motor plate ret. | 56 | R-028537 | Switch & Plate Assembly |
| 5 | R-065028 | Oiler Cap | 57 | R-163302 | Toggle Switch |
| 6 | R-672103 | Brush Holder & Screw Assembly | 61 | R-0655330 | Handle Adaptor Assembly |
| 7 | R-311031 | Screw & Washer Assembly | 62 | R-259316 | Cord Hook, lower |
| 7A | R-380261 | Drive Shaft | 65A | R-670844 | Cord, clip |
| 8 | R-618016 | Screw, field retainer | 66 | R-0887328 | Upper Handle Assembly |
| 9 | R-608005 | Fan, heavy duty | 67 | R-003884 | Spring |
| 10 | R-618772 | Spacer, baffle | 68 | NLA | Guide Pin |
| 11 | R-780002 | Field, 120v | 69 | R-259318 | Upper Cord Hook |
| NLA | Motor Housing Assembly | 70 | R-597743 | Screw | |
| 12A | R-110775 | Sleeve, rod adjuster | 71 | R-801314 | Handle Grip, burgundy |
| 12B | NLA | Motor Housing | 72 | R-884708 | Eye Bolt |
| 13 | R-801014 | Set Screw, brush holder | 76 | R-004723 | Spring, handle fork |
| 14 | R-801017 | Baffle Plate | 77 | R-133714 | Handle Stop Plate |
| 15 | R-801019 | Brush Holder | 79 | R-801708 | Bolt, handle fork retainer |
| 16 | R-801034 | Brush Holder Protector Cap | 80 | R-801714 | Nut, nylon insert |
| 17 | R-801701 | Screw, rear bearing retainer | 81 | R-990104 | Screw, handle stop plate |
| 18 | R-133715 | Adjuster Release | 82 | R-028580 | Handle, Fork & Latch Assembly |
| 18A | R-996011 | Rod Adjuster | 88 | R-003311 | Washer, handle fork clamp screw |
| 18B | R-003009 | Spring, rod | 89 | R-005138 | Washer, wheel retainer |
| 18C | R-996711 | E-Ring | 90 | R-023309 | Screw, nozzle & fancase |
| 18D | R-996101 | Pin, retaining | 91 | R-230713 | Carriage Bolt, handle clamp |
| R-099206 | Rear Wheel, Fork & Shaft Assy | 92 | R-2854270 | Gasket, nozzle sealing | |
| 20 | R-880705 | Wheel, 2 1/2" diam. | 93 | R-285720 | Wingnut, large |
| 21 | R-801711A | Wheel Retainer | 96 | R-880705 | Wide Front Wheel, 2 1/2" diam. |
| 22 | R-996575 | Rear Fork & Shaft Assembly | 97 | N/A | Wheel Retainer |
| 23 | R-080126 | Rear Bearing Assembly | 98 | R-880118 | Chemical Chamber |
| R-078007 | Motor Plate & Armature Assy | 99 | R-880629 | Headlight Bulb | |
| 25 | R-175053 | Washer, oil slinger | 100 | R-880707 | Screw, headlight assy retainer |
| 26 | R-780001 | Armature, 120v | 101 | R-980743 | Screw, machine-thread forming |
| NLA | Motor Plate & Bearing Assy | 103 | NLA | Headlight Assembly | |
| 28 | R-880046 | Tolerance Ring | 104 | R-028563 | Cover, chemical chamber |
| 29 | R-880026 | Ball Bearing | 105 | R-672260 | Belt |
| 30 | R-884003 | Motor Plate | 106 | R-183749 | Side Connection Plate |
| 31 | R-080226 | Nozzle Assembly | 107 | R-360753 | Screw, side connection plate |
| 32 | NLA | Screw | 108 | R-259762 | Connector Wire |
| 33 | R-004221 | Lock Washer | 109 | R-672270 | Nozzle Guard |
| 37A | R-802260 | Brush Speed Indicator Assy | 110 | R-673274 | Brush Roll Assembly, hex |
| 38 | R-060810 | Fancase Assembly | R-802259 | Brush Roll Assembly, old style, square | |
| 39 | R-611101 | Axle Stud | 119 | R-080169 | Adjust-O-Rite Plate |
| R-099430A | Handle & Cord Assembly | 121 | R-880262 | Belt Lifter | |
| 42A | R-230324 | Grommet | 122 | R-90843C | Bag Assembly, zipper |
| 44 | R-023311 | Lockwasher | 123 | R-3067247 | Paper Bag, type B, 3 pack |
| 45 | R-801710 | Wingnut, small | 123 | R-671075 | Paper Bag, type B, Microfresh, 3 pack |
| 46 | R-360713 | Screw, adaptor clamp | 123 | R-66247 | Paper Bag, type B, 10 pack |
| 47 | R-801701 | Screw, switch plate | 123 | 745 | Paper Bag, type B, 3 pack (R) |
| NLA | Switch & Cord Assembly | 124 | R-110773 | Insert, motor housing | |
| 49 | R-028539A | Cord & Plug Assembly | 125 | R-1300086 | Cover, lever |
| 50 | R-259761 | Wire Connector | 126 | NLA | Hub Cap |
| 51 | NLA | Cord Protecting Sleeve | | | |