

This Owner's Manual is provided and hosted by [Appliance Factory Parts](#).



# PANASONIC HQ-2101SH Owner's Manual

[Shop genuine replacement parts for PANASONIC  
HQ-2101SH](#)



[Find Your PANASONIC Air Conditioner Parts - Select From 287 Models](#)

----- Manual continues below -----



# Quasar®

ROOM AIR CONDITIONER

## OPERATING INSTRUCTIONS

ENGLISH

MODEL: HQ-2101SH  
HQ-2121SH



*Please read these operating instructions thoroughly before using your air conditioner and keep them for future reference.*

*For assistance, please call: 1-800-211-PANA (7262) or send e-mail to [consumerproducts@panasonic.com](mailto:consumerproducts@panasonic.com) or refer to [www.panasonic.com](http://www.panasonic.com)*

F563445

Please observe these following safety precautions when using your air conditioner.

- Failure or negligence in observing these safety precautions could cause fire, electrical shock or personal injury.



This symbol (with a white background) denotes an action that is **PROHIBITED**.



These symbols (with a blue background) denote actions that are **COMPULSORY**.

## INSTALLATION PRECAUTIONS



- Due to the weight of this product, we recommend that you have a helper to assist in the installation. To avoid injury, use the proper method of lifting. Avoid any sharp edges.

- Make sure the window frame to be used can properly support this product.

- This product must be installed in accordance with all local codes and ordinances.



- Do not install the unit in places where inflammable gas, fumes or soot may be generated.

## OPERATION PRECAUTIONS



- Operate your air conditioner from a stable 115 volt AC supply.

- Plug into a separate 15 amp grounded outlet only.

- Use of extension cords

Avoid using extension cords. If there are no alternatives, ensure that the cord is a UL listed 3-wire grounding type, rated 125 volts with a minimum current-carrying rating of 15 amps, number 14 or heavier wire.



- Use a 15 amp time delay fuse or a circuit breaker.

- Do not switch off by unplugging the power plug while it is operating. Press the OFF/ON pad to "OFF" before unplugging.

## POWER SUPPLY

Time Delay Fuse : 15 Amps  
Rated Voltage : 115V



• Socket Type



• Line Cord Plug

## INSTALLATION BOX CONTENTS

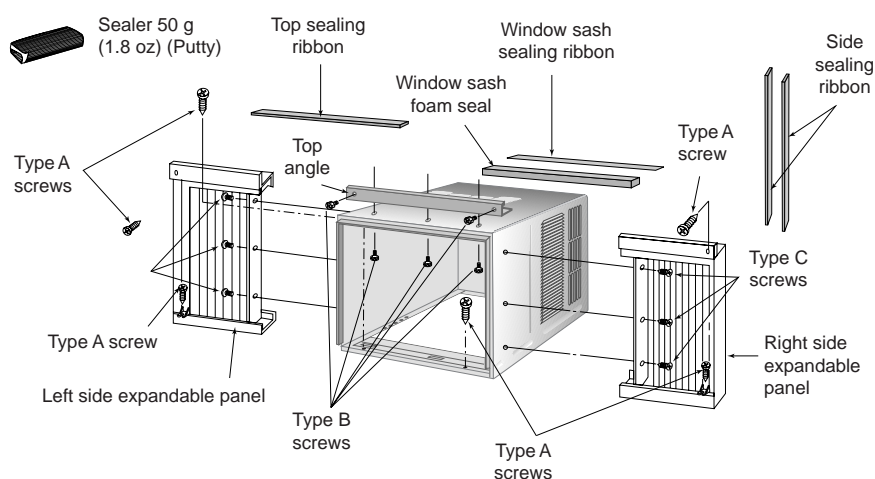

### SCREW FURNISHED

Type A (Qty 6)	Type B (Qty 5)	Type C (Qty 6)
Wood Screw	Machine Screw	Tapping Screw

### SUGGESTED TOOL LIST

	Medium sized screwdriver (#2 Phillips)
	Tape Measure
	Pencil
	Level
	Knife or Scissor

## OPERATION PRECAUTIONS



**WARNING** This sign warns of risk of death or serious injury.



- Do not modify the length of the power cord or use an extension cord.

- Do not touch or operate with wet hands. Do not modify or damage the cord.

- Do not turn on the unit by inserting the power plug. Do not switch off the unit by pulling out the power plug.

- Avoid an extended period of direct airflow.

- Do not insert sticks, fingers or other objects into the unit.

- Do not try to repair the unit yourself.



- Plug in properly before operating and use a specified power cord.

- If abnormal conditions (burnt smell, etc) occur, switch off and remove the power plug.



**CAUTION** This sign warns of injury or damage to property.



- Do not use the unit for other purposes, than its intended use.

- Do not remove the power plug by pulling the cord.

- Do not block the air intake and outlet vanes.

- Do not splash or direct water at the unit.

- Do not expose the unit to direct sunlight during operation.

- Do not operate the unit without the air filter installed or when the front intake grille has been removed.

- Do not place any objects on the unit.

- Do not operate any combustion equipment near the unit's airflow area.



- Switch off the breaker and remove the power plug from the socket if the unit will not be operated for a long period.

- Pay attention to any damages on the unit caused by extensive usage.

- Ventilate the room occasionally where the unit is installed.

- Remove the power plug when cleaning the unit.

**ACCESSORIES**

(6 pcs) XTN5D25A  
 (5 pcs) CWH4580211  
 (6 pcs) XTT4D10C

**NOTE**  
 Check that none of the accessories are missing.

**WINDOW REQUIREMENTS**

- Hot sun rays hitting the outside surface of the cabinet will create considerable heat load. If the outside of the cabinet is exposed to direct sunlight, consider building an awning to shade the cabinet while providing ample area for the heated air to be exhausted from the condenser (both sides) and the top.

This unit is designed for installation in standard double hung windows.

**NOTE**  
 The unit may also be installed "through the wall". You should, however, observe standard carpentry practices and frame the opening without violating local ordinances.

**INSTALLATION PROCEDURES**

- Remove the rear cabinet screws and save for later use.
- Slide the chassis out from the cabinet.

**HOW TO ASSEMBLE THE EXPANDABLE PANELS**

**NOTE**  
 This procedure applies to left and right of assembling expandable panel.

- Attach the top angle to the cabinet using screw type B (3 pcs).
- Insert expandable panels to cabinet sides as shown.
- Secure the first fold of expansion panel to cabinet using screw type C (3 each).

**SELECT THE BEST LOCATION**

(Single or Double hung window)

**SIDE VIEW**

**CABINET INSTALLATION**

- Cut the "Sealing Ribbon" to the proper length, and attach it along the bottom edge of the bottom window sash.
- To prevent condensation water from dripping inside, the cabinet should be installed level or very slightly tilted to the outside.
- Secure the cabinet using screws.

Type A screw  
 Type B screws  
 Window sill  
 Window sash foam seal

Inside of sash  
 Outside of sash  
 Window sash  
 Top angle  
 Sealing ribbon  
 Expandable panel

- Expand the expandable panel fully into the grooves of the window frame, secure the expandable panel, left, right and top mounting frames to the bottom of the window sash using 4 screws type A and 2 screws type B.
- Secure the cabinet using wood screws type A.
- Cut the window sash foam seal to the proper size and seal the opening between the top of the inside window sash and the outside window sash.

**NOTE**  
 If a gap exists between the unit and window sash, you may use "Sealer" supplied with the installation kit for a better seal.

**CHASSIS INSTALLATION INTO THE CABINET**

- Slide the chassis into the cabinet.
- Reinstall the cabinet screws. Secure the cabinet to chassis by using screws (from rear cabinet).

## INSTALLATION OF THE FRONT GRILLE

Depending upon the location of the AC outlet, route the AC cord to either the left or right side while installing the front grille.

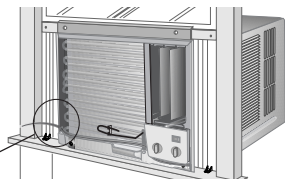

This figure shows the AC cord routed to the left side.

- ① Place the front grille on the cabinet first.
- ② Secure the front grille to the main chassis using screw provided.

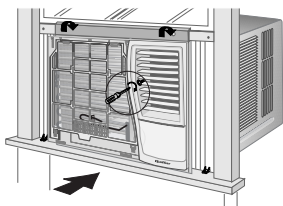

## INSERT THE $\oplus$ filter (OPTIONAL)

Attach the  $\oplus$ filter (part no. CZ-SF6P) to the frame.

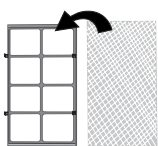

Slot in the  $\oplus$ filter and the frame (part no. CZ-SFW6P) to the front grille.

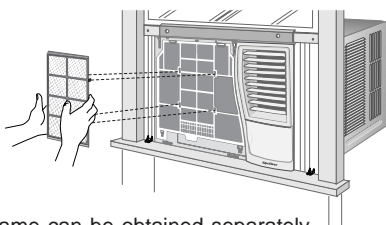

The  $\oplus$ filter and the frame can be obtained separately from your nearest servicerenter.

## INSERT THE AIR FILTER

Attach the air filter to the intake grille.

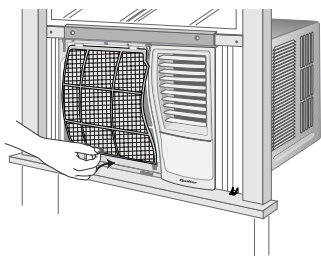

## PLACE FRONT INTAKE GRILLE OVER THE FRONT GRILLE

Slide the front intake grille slightly to the right to reattach the tabs and then push it down to close tight.

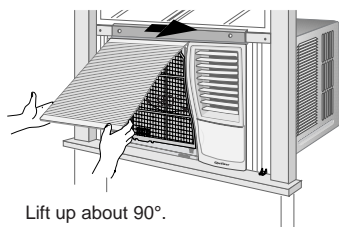

Lift up about 90°.

## REMOVAL OF FRONT GRILLE

- ① Remove the front intake grille.

Pull up the front intake grille about 90° and slide it slightly to the left to unhook the tabs.

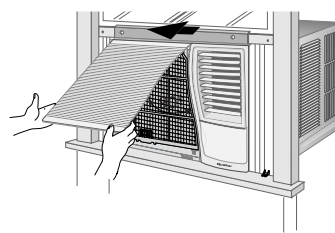

- ② Remove the air filter.

Tilt up and pull out the air filter by the holder.

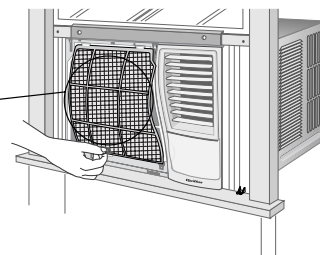
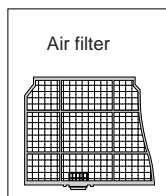

- ③ Remove the front grille.

- a Remove the adhesive tape from all sides of the front grille.
- b At bottom right side of the front grille, press inward on cabinet near the power cord, and pull the grille outward to the right until right tab releases.
- c At the bottom left side, push inward on cabinet and pull the grille outward to the left to release the left tab. Do not pull the bottom edge toward you more than 3 inches to prevent the two top tabs from damage.
- d Slide the front grille upwards to free the two top tabs from slots at the top of the cabinet.

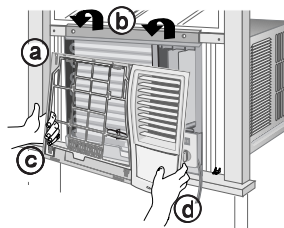

## HOW TO ATTACH THE DRAIN PAN (OPTIONAL)

### Condensed water drainage

This air conditioner employs a "Slinger-Up System" which is designed to splash the condensed water on the condenser coil for maximum cooling efficiency, thus producing a splashing sound. If the splashing sound annoys you, you can provide an outside drainage by using the following procedure which may, however, cause a small loss of performance.

### NOTE

The cabinet should be installed tilted slightly lower to the rear for necessary condensate drainage. (Max. 13/32")

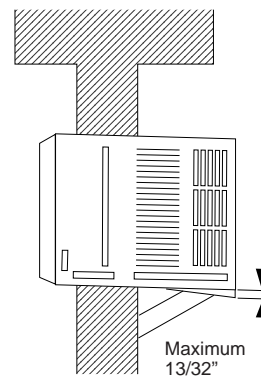

Condensed water

**HOW TO ATTACH THE DRAIN PAN (OPTIONAL)**

① Remove the rubber plug and slide the chassis out from the cabinet.

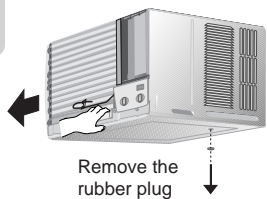

③ Connect a drain hose (optional). Fit the drain hose to the drain pan.

**NOTE**  
Drain hose or tubing can be purchased locally to satisfy your particular needs.

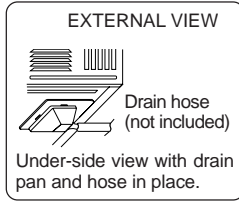

② Install the optional drain pan (part no. CWH40175).

Install the drain pan at the right corner of the cabinet using 2 screws (part no. CWG86C733).

**NOTE**  
The drain pan (part no. CWH40175) can be obtained from nearest servicerenter.

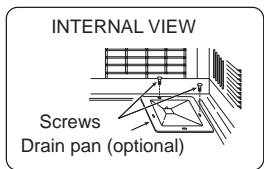

④ Slide the chassis back into the cabinet. Reinstall the cabinet to chassis by using screws.

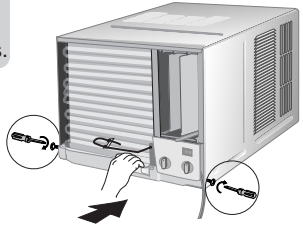

**MAIN UNIT**

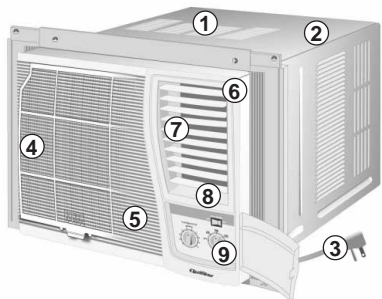

- ① Air inlet louver
- ② Cabinet
- ③ Power cord
- ④ Air filter
- ⑤ Front intake grille
- ⑥ Front grille
- ⑦ Vertical airflow direction vane (Airflow direction adjustment up-down). The vertical airflow direction vane is controlled by rotating the horizontal vane forward or backward.



⑧ Ventilation lever



**CLOSE** **VENT** **OPEN**

The ventilation lever must be in the **CLOSE** position in order to maintain the best cooling conditions. When fresh air is necessary in the room, set the ventilation lever to the **OPEN** position. The damper is opened and room air is drawn out.

⑨ Main control panel

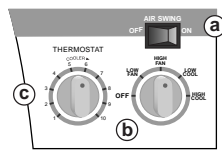

**a** Air Swing Switch  
**OFF** Stops the operation of Air Swing.  
**ON** Air Swing is in operation.  
 (Only for LOW COOL, MED COOL, HIGH COOL and ECONOMY operation.)



**b** Main Control Knob

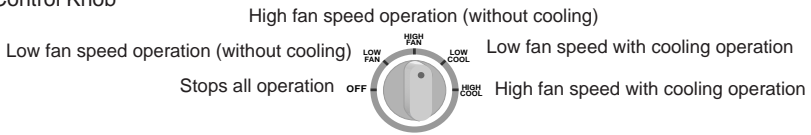

**c** Thermostat Control Knob

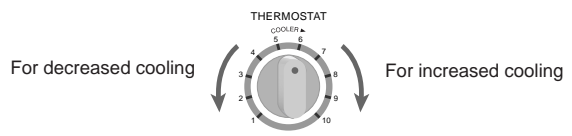

① Open the control panel cover.



③ Thermostat Control Knob.

NOTE : Recommended setting

- For a room that is too warm, set the control knob to a clockwise direction.
- If the room is too cool, set the control knob to a counter clockwise direction.
- \* Note : Usually 6~7 is the recommended setting position.

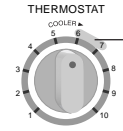

② Power Supply.

Switch off the breaker and set the main control knob to the OFF position; confirm that the power supply cord is connected to a proper AC outlet. < 115V, 60Hz >

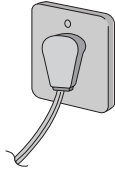

④ Air Swing Switch.

(Airflow direction adjustment Side-to-Side)  
To obtain a fix airflow direction, set the air swing switch to "ON" for the vanes to swing from side to side until the desired flow direction is reached, then switch it to "OFF".  
For continuous side-to-side air circulation, set the air swing switch to "ON".



Model			HQ-2101SH	HQ-2121SH
COOLING CAPACITY		Btu/h	10,000	11,500
ELECTRICAL RATING	Phase		Single	←
	Frequency	(Hz)	60	←
	Voltage	(V)	115	←
	Current	(Amps)	8.7	9.8
	Input	(W)	980	1120
EER		(Btu/W.h)	10.2	←
MOISTURE REMOVAL		(Pints/h)	2.5	3.0
ROOM AIR CIRCULATION		(Cf/min)	320	330
DIMENSIONS	Height	cm (inches)	37.5 (14- <sup>25</sup> / <sub>32</sub> "	←
	Width	cm (inches)	56 (22- <sup>1</sup> / <sub>16</sub> "	←
	Depth	cm (inches)	60.6 (23- <sup>27</sup> / <sub>32</sub> "	←
NET WEIGHT		kg (lb)	35 (77)	←
GROSS WEIGHT		kg (lb)	39 (86)	←
NOISE LEVEL	Indoor (Hi/Lo)	dB (A)	50/46	51/47
	Outdoor (Hi/Lo)	dB (A)	57/54	58/55

\* Specifications are subject to change without notice for further improvement.

**ENERGY SAVING HINTS**



- This may affect your well-being as well as increase power consumption.
- The cooling capacity of the room air conditioner must match the room size for efficient and satisfactory operation.
- Prevent hot air from entering and cool air from escaping.
- Ensure that curtains and drapes are always closed to keep out direct sunlight during cooling operation. Avoid heat.
- Clean the air filter every 2 weeks. Dirty filters may reduce cooling efficiency.

**CARE AND MAINTENANCE**

Always turn off the air conditioner and the main power supply before clean the unit.  
Switch off the power supply if the unit is not going to be used for a long period of time.



- Clean the cabinet, front grille with a mild soap or detergent and lukewarm water.
- The front intake grille can be easily removed for cleaning purposes. Gently wash it with water and a sponge.
- The filter can be easily cleaned using a vacuum cleaner. Vacuum the front of the filter and then wash the rear with water. If it is badly soiled, wash with a mild household detergent.

It is recommended to replace the **E** filter (part no.CZ-SF6P) every 3 months.

- Do not clean with benzene, thinner, scouring powder or cloth soaked in caustic chemicals.
- If the unit is extremely dirty, heat transfer is less efficient and the unit may not cool effectively. Contact your nearest servicenter for an annual check.
- If the air filter becomes clogged with dust, the cooling capacity will drop, and 6% of the electricity used to operate the air conditioner will be wasted.

**NOTE**

Do not dry the front panel or the air filter in direct sunlight. (Exposure to direct sunlight may discolor or deform the panel.)

**PRE-SEASON INSPECTION**

- *Is the discharged air cold?*

After 15 minutes of operation, it is normal for the temperature difference between intake and outlet air to be more than 14.4°F for cooling.



- *Are the air intake and outlet vanes of the indoor and outdoor side obstructed?*

**RECOMMENDED INSPECTION**

- Usage over several seasons will reduce performance as the unit becomes dirty.  
A dirty unit may produce foul odors and dust may clog the dehumidifying drainage.  
Seasonal inspection is recommended in addition to regular cleaning. Consult your nearest servicenter.

**BEFORE**

Check the following points before calling for repairs or service. If the malfunction persists, please contact your nearest servicenter. For assistance, please call: 1-800-211-PANA (7262) or send e-mail to: [consumerproducts@panasonic.com](mailto:consumerproducts@panasonic.com)

**POSSIBLE CAUSES OF THE ABOVE PROBLEMS**

**Condition ①** If the unit is too noisy during operation.

The following sounds are normal during operation:

- A low humming sound indicating that the unit is operating.
- A soft clicking sound when the compressor turns on and off.
- A flowing sound due to circulation of the refrigerant when the compressor is turned on.
- A splashing sound indicating condensation in the condenser coil.

If you hear other noises, please consult your nearest servicenter.

**Condition ②** If the unit does not operate.

- The main power cord is not plugged in.
- The internal fuse has blown.
- The main circuit breaker has tripped.

**Condition ③** If the unit does not cool properly.

- The room is too big for the unit's cooling capacity.
- The ventilation lever is set to OPEN.
- The air circulation is impeded by curtains or furniture.
- After 15 minutes of operation, it is normal for the temperature difference between intake and outlet air to be more than 14.4°F for cooling.

**Condition ④** If water drips off the rear of the unit.

- Humidity is high.
- Condensed water is overflowing.
- To rectify the problem, mount a drain pan to the unit.

**Condition ⑤** If water drips inside the room.

- The unit is tilted inward. To rectify this, tilt the unit slightly outward.
- Mount the optional drain pan if you prefer.
- The drain pan may be blocked.

If the trouble persists after you have checked all of these, call your authorized Panasonic dealer or servicenter. Service information can be obtained 24 hours/day by calling: 1-800-211-PANA (7262)

To expedite the repair of your air conditioner:

- Please have your proof of purchase.
- List all symptoms the unit is exhibiting.

**Panasonic Consumer Electronics Company,  
Division of Matsushita Electric Corporation  
of America**

One Panasonic Way  
Secaucus, New Jersey 07094

**Panasonic Sales Company,  
Division of Matsushita Electric of Puerto Rico, Inc.,**

Ave. 65 de Infanteria, Km. 9.5  
San Gabriel Industrial Park  
Carolina, Puerto Rico 00985

## **Quasar Room Air Conditioner Limited Warranty**

Panasonic Consumer Electronics Company or Panasonic Sales Company (collectively referred to as "the Warrantor") will repair this product with new or refurbished parts in case of defects in material or workmanship, free of charge, in the USA or Puerto Rico in accordance to the following (All time periods start from the date of the original purchase).

**SEALED REFRIGERATING SYSTEM (compressor and interconnecting tube): FIVE (5) YEARS - PARTS AND LABOR**

**ALL OTHER COMPONENTS: ONE (1) YEAR - PARTS AND LABOR**

In-home service in the USA can be obtained during the warranty period by contacting a Panasonic Service Company (PASC) Factory Servicenter listed in the Servicenter Directory. Or call toll free, 1-800-211-PANA(7262), to locate a PASC authorized Servicenter. In-home service in Puerto Rico can be obtained during the warranty period by calling the Panasonic Sales Company telephone number listed in the Servicenter Directory.

Note: If the unit is installed at the other than normal window height and/or has been custom-installed (e.g., through the wall), the customer is responsible for removing the unit from its installation prior to the performance of in-home service.

This warranty is extended only to the original purchaser. A purchase receipt or other proof of date of the original purchase is required for service and parts replacement under this warranty.

This warranty only covers failures due to defects in materials and workmanship and does not cover normal wear or cosmetic damage. The warranty does not cover damages which occur in shipment, or failures which are caused by products not supplied by the warrantor, or failures which result from accident, misuse, abuse, neglect, mishandling, misapplication, faulty installation, maladjustment of customer controls, improper maintenance, alteration, modification, power line surge, lightning damage, improper voltage supply, commercial use such as hotel, office, restaurant, or other business or rental use of the product, or service by anyone other than a PASC Factory Servicenter or a PASC authorized Servicenter, or damage that is attributable to acts of God.

### **LIMITS AND EXCLUSIONS**

There are no express warranties except as listed above.

THE WARRANTOR SHALL NOT BE LIABLE FOR INCIDENTAL OR CONSEQUENTIAL DAMAGES RESULTING FROM THE USE OF THIS PRODUCT, OR ARISING OUT OF ANY BREACH OF THIS WARRANTY. ALL EXPRESS AND IMPLIED WARRANTIES, INCLUDING THE WARRANTIES OF MERCHANTABILITY, ARE LIMITED TO THE APPLICABLE WARRANTY PERIOD SET FORTH ABOVE.

Some states do not allow the exclusion or limitation of incidental or consequential damages, or limitations on how long an implied warranty lasts, so the above exclusions or limitations may not apply to you.

This warranty gives you specific legal rights and you may also have other rights which vary from state to state. If a problem with this product develops during or after the warranty period, you may contact your dealer or Servicenter. If the problem is not handled to your satisfaction, then write to the Consumer Affairs Department at the company address indicated above.

SERVICE CALLS WHICH DO NOT INVOLVE DEFECTIVE MATERIALS OR WORKMANSHIP AS DETERMINED BY THE WARRANTOR, IN ITS SOLE DISCRETION, ARE NOT COVERED. COSTS OF SUCH SERVICE CALLS ARE THE RESPONSIBILITY OF THE PURCHASER.

[For assistance, please call: 1-800-211-PANA (7262) or send e-mail to [consumerproducts@panasonic.com](mailto:consumerproducts@panasonic.com)]

Printed in Malaysia

F0201-0

F563445