

This Owner's Manual is provided and hosted by Appliance Factory Parts.

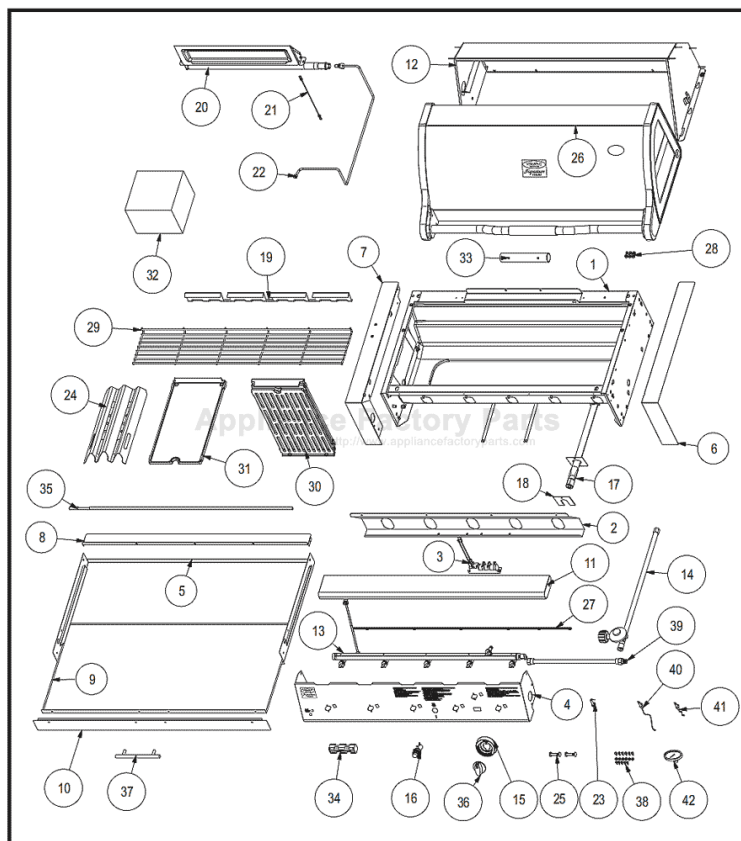

Vermont Castings VCS3507B1 Owner's Manual

[Shop genuine replacement parts for Vermont Castings
VCS3507B1](#)



[Find Your Vermont Castings Grill Parts - Select From 273 Models](#)

----- Manual continues below -----



VCS3507BI / VCS5007BI ASSEMBLY PROCEDURES

Tools Required: knife or scissors, Phillips or Robertson (square head) screwdriver.

Model VCS5007BI
Shown

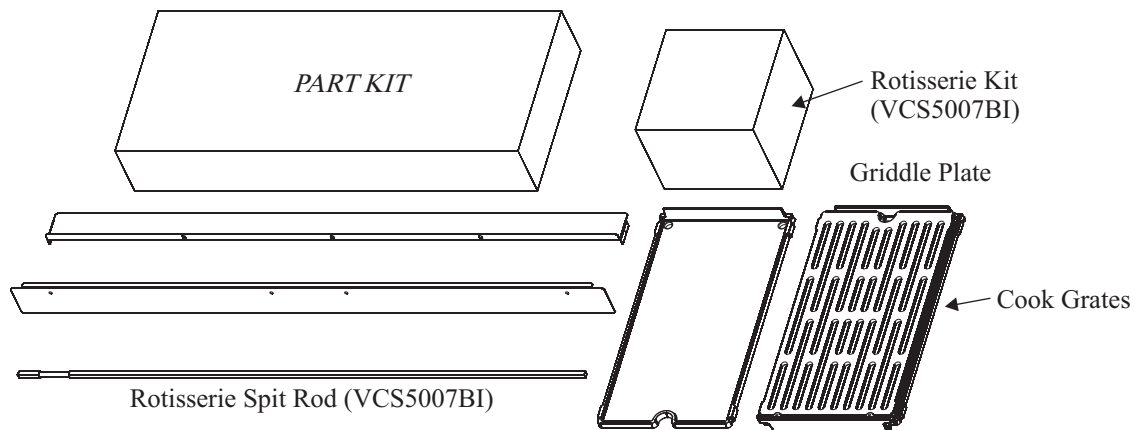
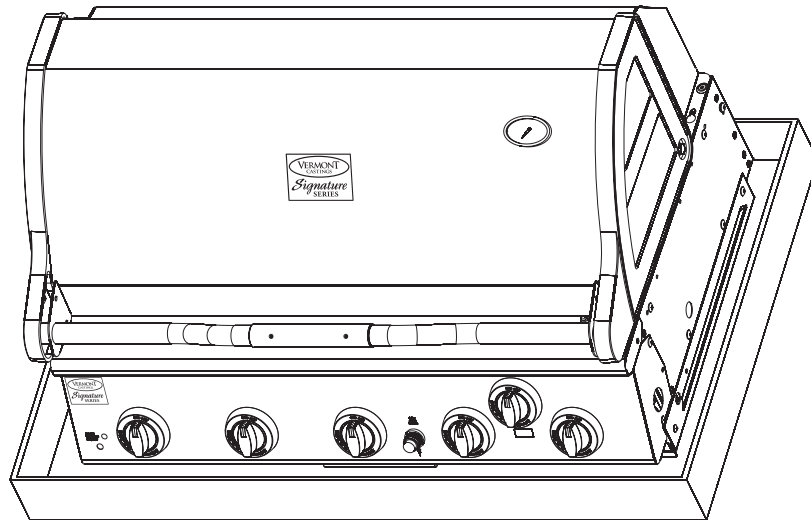

Step 1: Unpack Carton and Verify Contents

Use a sharp cutting tool to cut the straps on the packaging and then lift off the carton top. The sleeve surrounding the barbecue can be removed by lifting it straight up and over the top of the unit. Next, remove the protective plastic coverings from the metal parts. Be careful not to scratch or damage the finish of the metal parts when removing the protective plastic. Compare all contents to the parts list that accompanies this assembly manual. Refer to the parts list for fastener detail.

CAUTION: Some parts may have sharp edges; to avoid injury, wearing gloves during assembly is strongly recommended

VCS3507BI / VCS5007BI FRAMING DIMENSIONS

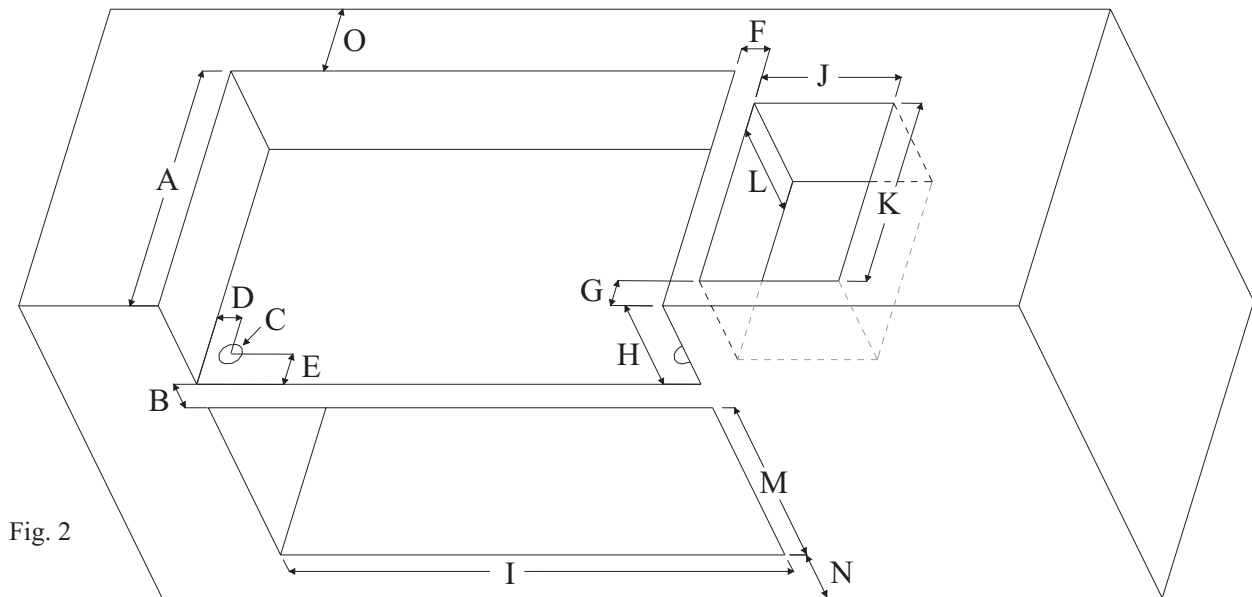

Fig. 2

Ref.	Non-Combustible Clearances		Combustible Clearances With ZC Insulated Jacket	
	VCS3507BI	VCS5007BI	VCS3507BI	VCS5007BI
A	23-3/4" [603.3mm]	23-3/4" [603.3mm]	23-3/4" [603.3mm]	23-3/4" [603.3mm]
B	4" [101.6mm]	4" [101.6mm]	3" [76.2mm]	3" [76.2mm]
C	2" [50.8mm] Dia.	2" [50.8mm] Dia.	2" [50.8mm] Dia.	2" [50.8mm] Dia.
D	2 1/8" [54.0mm]	2 1/8" [54.0mm]	2 1/8" [54.0mm]	2 1/8" [54.0mm]
E	3" [76.2mm]	3" [76.2mm]	3" [76.2mm]	3" [76.2mm]
F	2-1/2" [63.5mm] Min.	2-1/2" [63.5mm] Min.	2-1/2" [63.5mm] Min.	2-1/2" [63.5mm] Min.
G	2-1/2" [63.5mm] Min.	2-1/2" [63.5mm] Min.	2-1/2" [63.5mm] Min.	2-1/2" [63.5mm] Min.
H	9" [228.6mm]	9" [228.6mm]	10" [254.0mm]	10" [254.0mm]
I	31-3/8" [796.9mm]	43-3/8" [1101.7mm]	31-3/8" [796.9mm]	43-3/8" [1101.7mm]
J	12" [304.8mm]	12" [304.8mm]	12" [304.8mm]	12" [304.8mm]
K	18" [457.2mm]	18" [457.2mm]	18" [457.2mm]	18" [457.2mm]
L	10" [254.0mm]	10" [254.0mm]	10" [254.0mm]	10" [254.0mm]
M	18-3/4" [476.3mm]	18-3/4" [476.3mm]	18-3/4" [476.3mm]	18-3/4" [476.3mm]
N	4" [101.6mm] Min.	4" [101.6mm] Min.	4" [101.6mm] Min.	4" [101.6mm] Min.
O	4" [101.6mm] Min.	4" [101.6mm] Min.	4" [101.6mm] Min.	4" [101.6mm] Min.

Note: Ensure that your grill enclosure has been constructed according to the exact specifications shown in Fig. 2. If the enclosure is constructed of wood or other similar combustible materials, the use of the insulated jacket Model VCS3500IJ or VCS5000IJ is required.

If you have an L.P. model with a 20lb cylinder stored in the enclosure, ensure that there at least two air ventilation openings of 10sq inches 180 degrees apart and they are level with the cylinder valve. Another two openings with the same dimensions and distance are required to be level with the base of the cylinder. For other requirements, see section 1.7 of ANSI Z21.58-2005/CGA 1.62005 American National Standard/ Canadian Gas Association Standard for outdoor cooking gas appliances.

Step 3: Assemble Fascia Brackets

Parts Required:

- (1) Main Grill Unit
- (1) Left Fascia Bracket
- (1) Right Fascia Bracket
- (4) #10 x 1/2" Bolts
- (4) #10 Lock Nuts

Prop up the front of the Grill Unit on a 2" or 3" block of wood or some other similar item. Remove the two (2) 1/4"-20 x 3/8" bolts located at the top-right corner on the left and right side of the base assembly and loosen the two (2) front 1/4"-20 x 3/8" bolts as shown in the adjacent diagram.

Next: Attach the Right Fascia Bracket to the grill base by aligning the holes over the loosened bolts and gently pushing down on the Fascia until the bolts settle into the grooves.

Note: Ensure the bottom of the flanges on the Left and Right Fascia Brackets slides between the flange of the bottom cover and the console.

Then secure the rear of the Brackets to the Grill Unit using the 1/4"-20 x 3/8" bolt you initially removed. Secure the Brackets to the lower-front of the Grill Body by inserting two (2) #10 x 1/2" Bolts and two (2) #10 nuts as shown in the adjacent diagram.

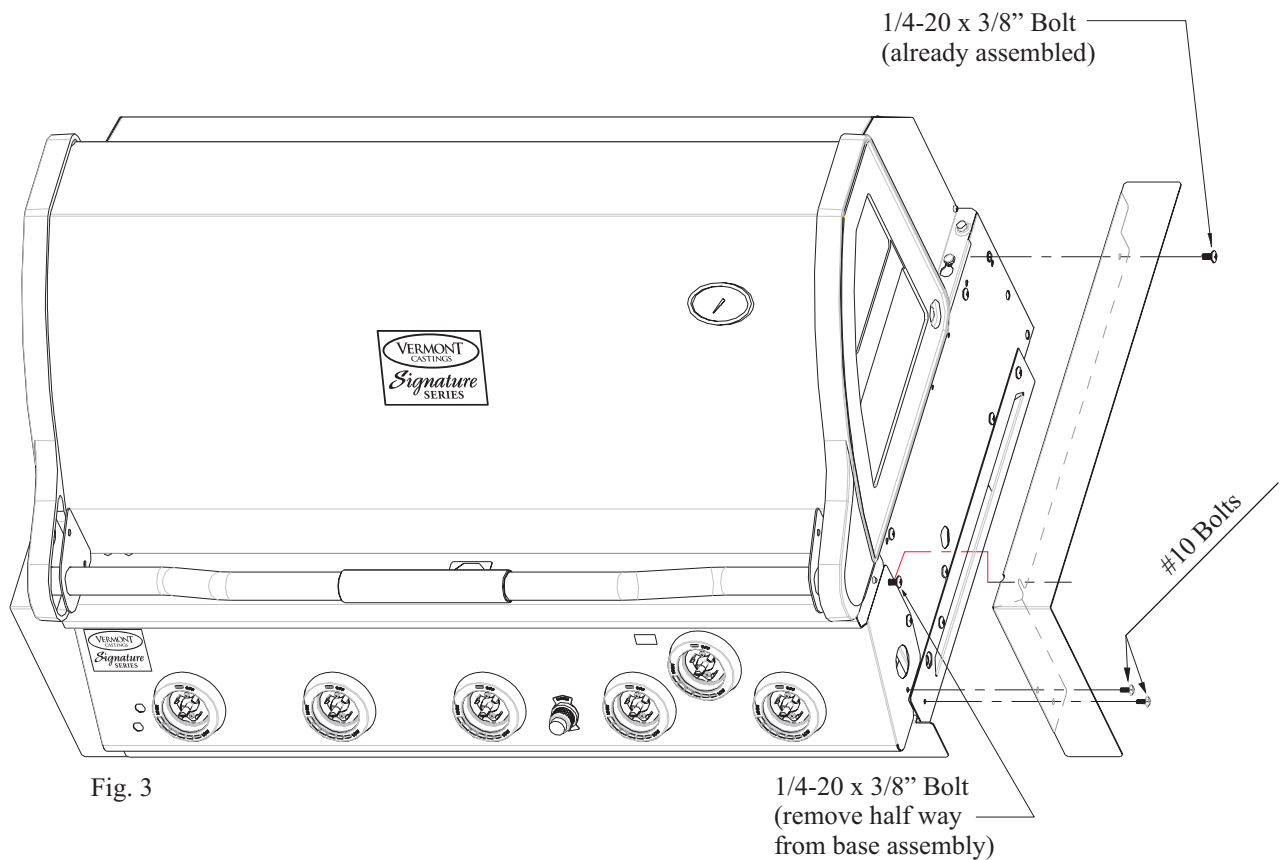

Step 4: Assemble the Rear Panel

Parts Required:

- (1) Rear Panel
- (1) Back Flange
- (5) Self-Tapping Screws

Attach the Back Flange of the Rear Panel to the Grill Base with three (3) Self-Tapping screws.

Next: Fasten the ends of the Rear Panel to the Left and Right Fascia Brackets with (2) Self-Tapping screws.

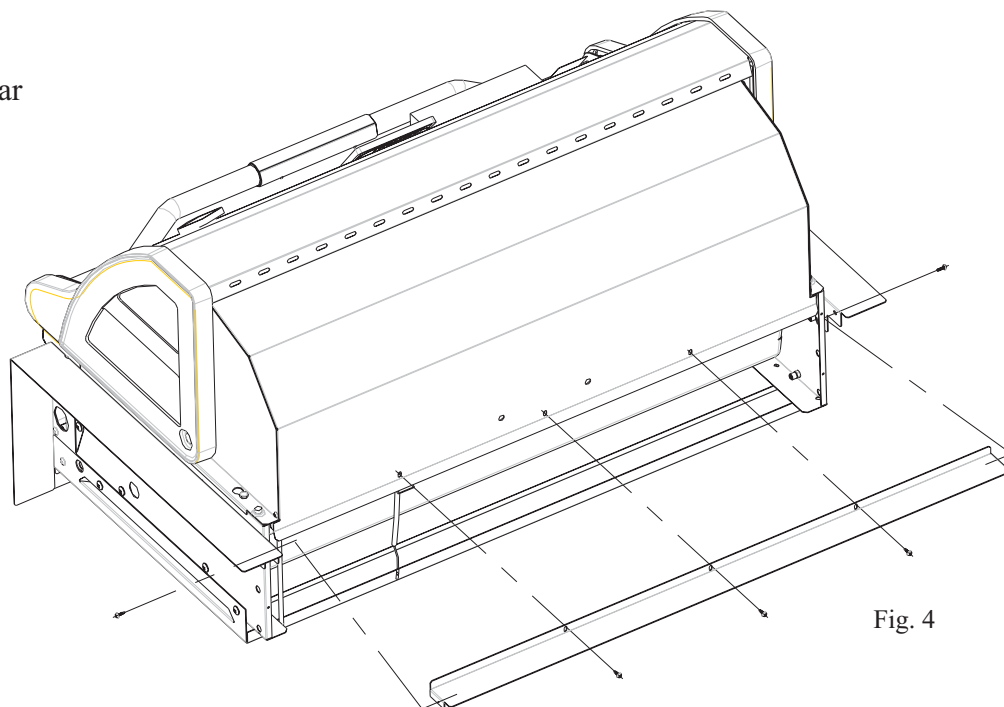

Fig. 4

Step 5: Assemble the Grease Tray Front and Handle

Parts Required:

- (1) Grease Tray Front
- (1) Handle (with screws)
- (2) #10 Bolts
- (2) #10 Nuts

Remove the Grease Tray from the front of the Grill Base (Below the Control Console). Remove the protective plastic from the Grease Tray Front and attach it to the front lip of the Grease Tray with the two (2) #10 Bolts and tighten using the two (2) #10 Nuts.

Next: Attach the handle to the tray with the two (2) screws supplied with the handle.

Note: Do not reinsert the Grease Tray into the Grill Base at this time.

Service Note: Due to the shallow depth of the grease tray, ensure it is cleaned frequently to avoid a possible "Grease Fire".

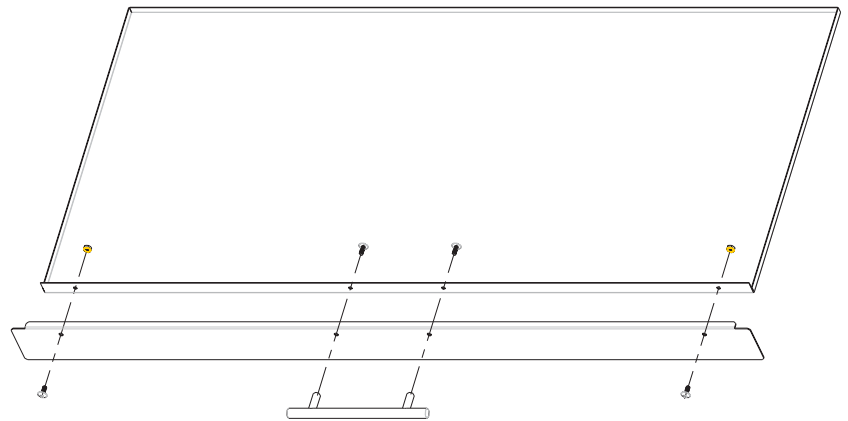

Fig. 5

Step 6: Assemble the Grill Unit to the Enclosure

Note: This step should be performed by two (2) persons wearing gloves.

Before positioning the Grill Unit into the prepared enclosure or insulated jacket, depending on available access, it may be necessary to temporarily disconnect the LP regulator or 12 ft. Natural Gas Hose from the Steel Flex Line.

Carefully position the Grill Unit into the opening from the front and raised slightly, while ensuring the gas feed tubing is fed through the hole provided in the bottom of the enclosure opening. Push the unit back into its final position and check for proper fit.

Next: Reattach the LP Regulator or hose if it was removed and check all connections for leaks. Reinsert the Grease Tray into its place.

Caution: The end of the Steel Flex Line should be clamped to the surrounding structure to prevent excessive movement.

Caution: Do not turn on the grill until after performing a leak check at all connection points and fittings. Use a spray solution of 50% dish soap and 50% water onto all connection points and fittings. Formation of bubbles indicates air leaks.

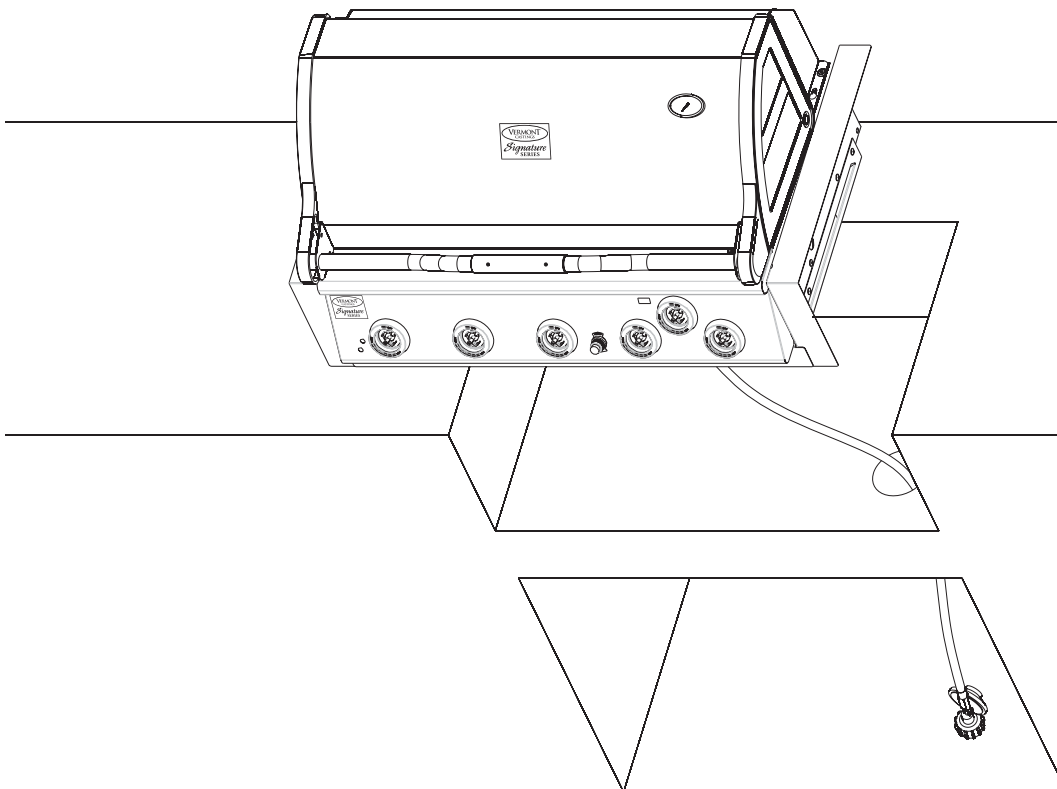

Fig. 6

Step 7: Install Internal Components and Knobs

Parts Required:

VCS3506 - (3) Sear Plates, (2) Cooking Grates, (1) Warming Rack, (4) Knobs

VCS5006 - (5) Sear Plates, (4) Cooking Grates, (1) Warming Rack, (6) Knobs

Carefully place each of the Sear plates side by side inside the barbecue by making sure the semicircular finger groove is facing toward the front of the grill. Do the same using the cooking grates, making sure the finger groove is facing toward the front of the grill. Next set the warming rack into the supports located on either side of the rear lid.

Next: Align the knobs on the valve stems and push inward until the knob sits snugly on the stem.

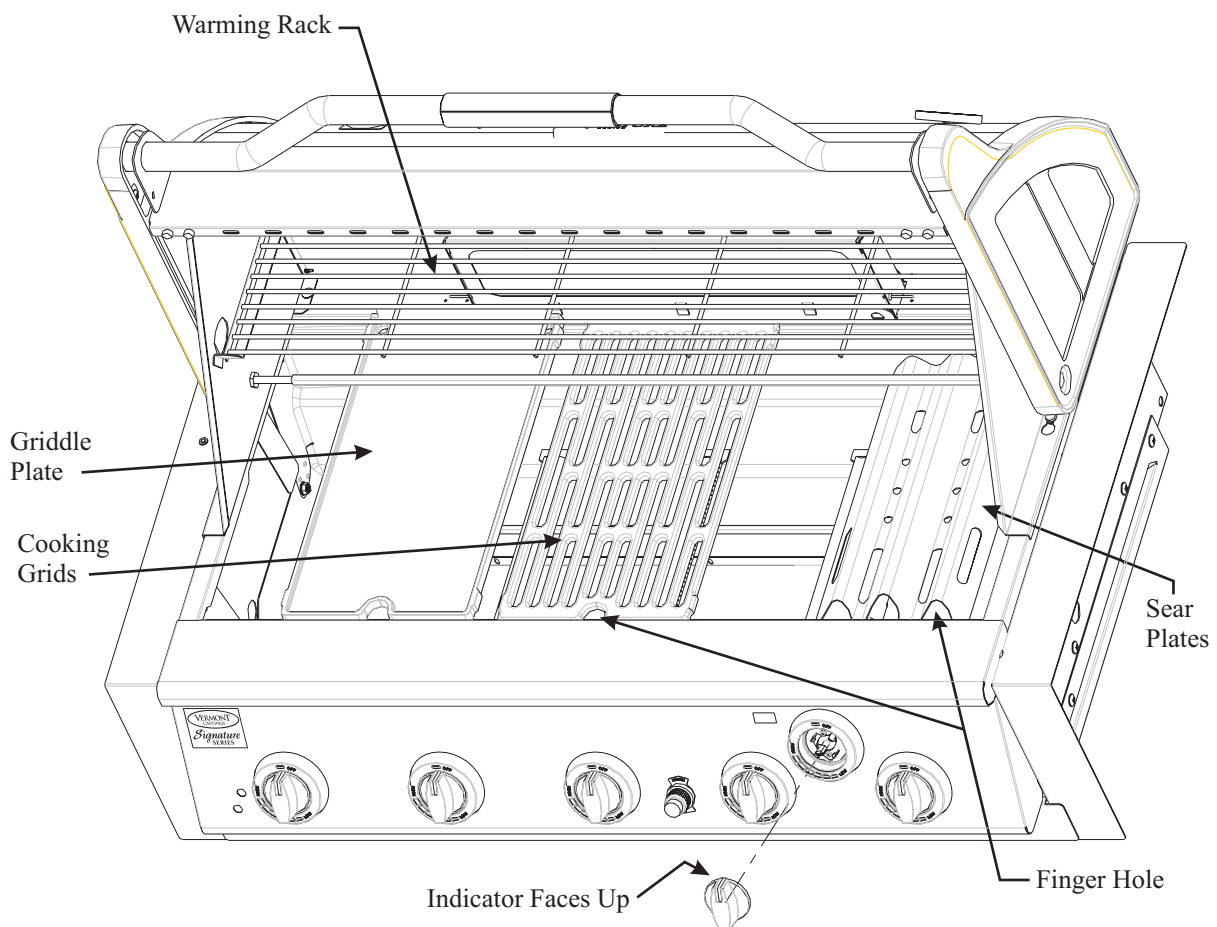



CFM Corporation
410 Admiral Boulevard
Mississauga, Ontario L5T 2N6 Canada
(800) 668-5323

www.cfmcorp.com

Service Note: If you are experiencing difficulties or are dissatisfied with your purchase, please contact CFM at the telephone number listed above prior to returning your grill to the store.