

This Owner's Manual is provided and hosted by [Appliance Factory Parts](http://www.appliancefactoryparts.com).



# Weber GENESIS S-310 LP (2008) Owner's Manual

[Shop genuine replacement parts for Weber GENESIS  
S-310 LP \(2008\)](#)



[Find Your Weber Grill Parts - Select From 2037 Models](#)

----- Manual continues below -----



# GENA

## UNPACKING INSTRUCTIONS • INSTRUCCIONES DESEMPAQUETAR • INSTRUCCIONES



**Cookbox Assembly - 1**  
smblo de la caja de cocción - 1  
Ensemble du boîtier de cuisson - 1

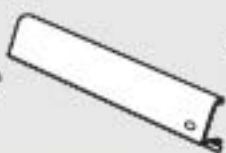

**Front Panel - 1**  
Panel delantero - 1  
Panneau avant - 1



**Drip Tray - 1**  
Bandeja de goteo - 1  
Plateau de recueil des gouttes - 1

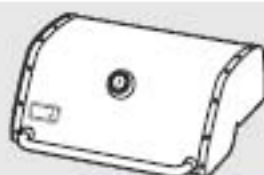

**Shroud - 1**  
Delantisa - 1  
Structure - 1



**Right Side Table - 1**  
Mesa lateral derecha - 1  
Tablette latérale droite - 1

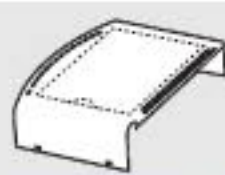

**Left Side Table - 1**  
Mesa lateral izquierda - 1  
Tablette latérale gauche - 1

**Door H**  
Asa de



**Left Frame - 1**  
Bastidor izquierdo - 1  
Coffrage gauche - 1



**Right Frame - 1**  
Bastidor derecho - 1  
Coffrage droit - 1

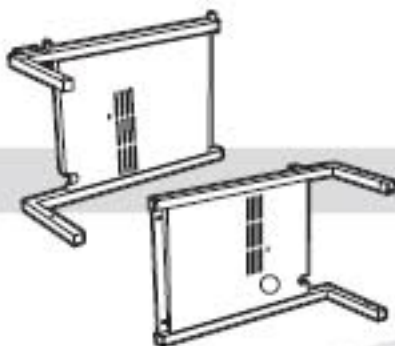

**Front Frame Support - 1**  
Soporte delantero del bastidor - 1  
Support du châssis avant - 1



**Cooking Grate - 2**  
Parrilla de cocción - 2  
Grille de cuisson - 2



**Knob - 3**  
Perilla - 3  
Bouton - 3

**Rear Frame Support - 1**  
Soporte posterior del bastidor - 1  
Support du châssis arrière - 1



**Catch Pan - 1**  
Plato recolector - 1  
Egoutoir - 1

**Bottom Tray - 1**  
Bandeja del fondo - 1  
Plateau inférieur - 1



**Disposable Drip Pan - 2**  
Bandeja de goteo desechable - 2  
Egoutoir jetable - 2

**Rear Panel - 1**  
Panel trasero - 1  
Panneau arrière - 1



**Flavorizer® Bar - 5**  
Barras Flavorizer® - 5  
Barras Flavorizer® - 5

### HARDWARE • HERRAJES • MATÉRIEL

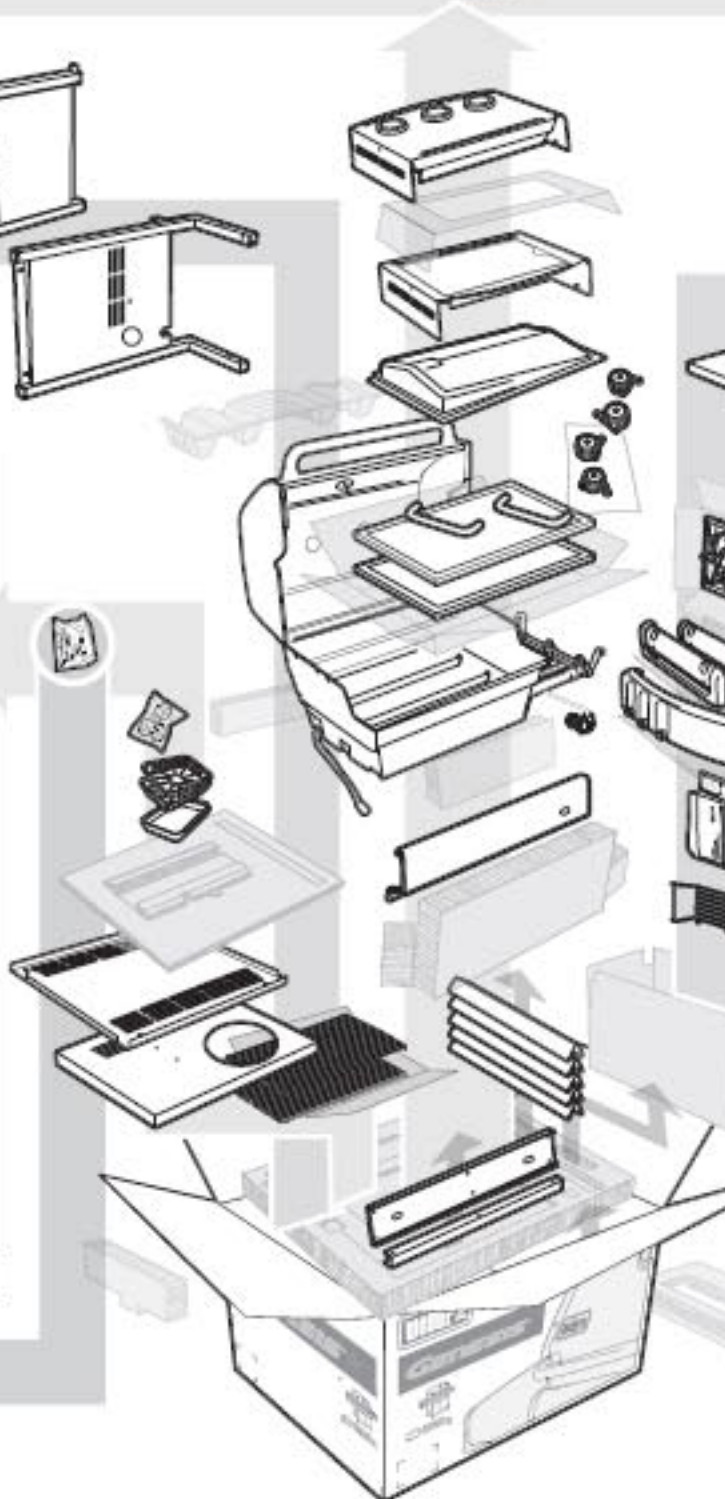

Hardware  
Herrajes  
Matériel



**a**  
11 mm (7/16 in.)  
Wrench - 1  
Llave de 11 mm  
(7/16 pulg.) - 1  
Clé de 11 mm  
(7/16 po.) - 1



**b**  
1/2 Inch Stainless  
Steel Hex Bolts  
(1/4 x 20 x 1/2 in.) - 10  
Acero inoxidable  
1/2 pulgada  
Pernos hexagonales  
(1/4 x 20 x 1/2 pulg.) - 10  
Ecrus hexagonaux  
en acier inoxydable  
de 1/2 pouce  
(1/4 x 20 x 1/2 po.) - 10



**c**  
1 Inch Zinc Screw  
(1/4 x 20 x 1 in.) - 4  
Tornillo de zinc de 1 pulgada  
(1/4 x 20 x 1 pulg.) - 4  
Vis en zinc  
de 1 pouce  
(1/4 x 20 x 1 po.) - 4

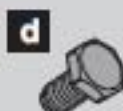

**d**  
1/2 Inch Black Zinc  
Hex Bolts  
(1/4 x 20 x 1/2 in.) - 10  
Cinc negro 1/2 pulgada  
Pernos hexagonales  
(1/4 x 20 x 1/2 pulg.) - 10  
Ecrus hexagonaux  
en zinc noir de 1/2 pouce  
(1/4 x 20 x 1/2 po.) - 10



**e**  
Nylon Washer - 10  
Aroñola de nylon - 10  
Rondelle en nylon - 10

1

2- 2-

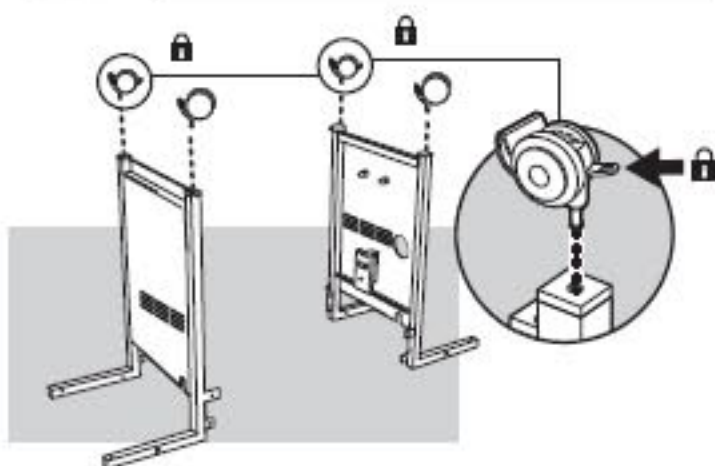

2

4- **d** 2- **b** 6- **o**  
1- **n**

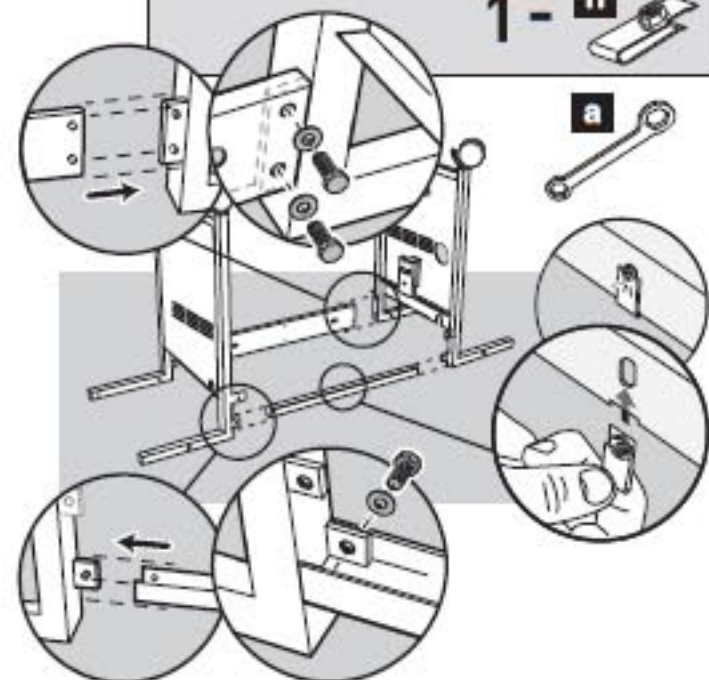

3A

6- **n**

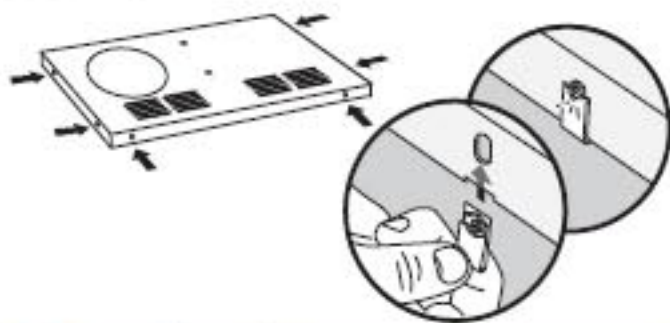

3B

- Flip over frame assembly so the casters are on a flat surface.
- Voltee el ensamble del bastidor de manera que las ruedas locas queden sobre una superficie plana y horizontal.
- Retournez l'ensemble du châssis de sorte que les roues reposent sur une surface plane et à niveau.

5A

2- **f**

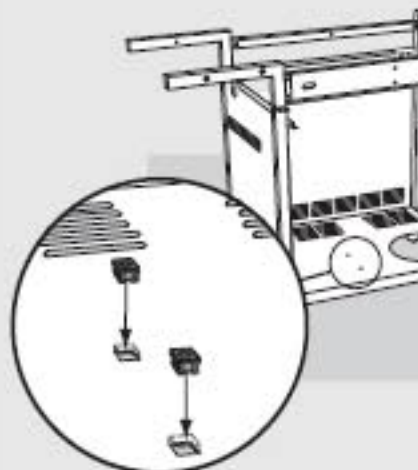

5B

3- **k**

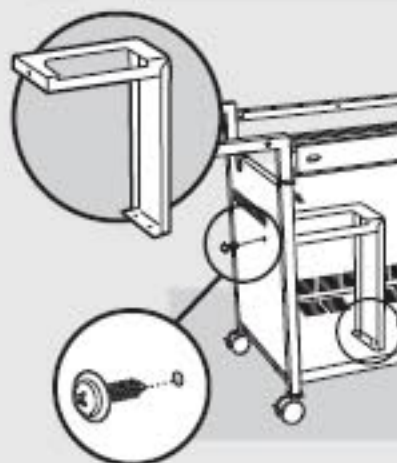

6

x2

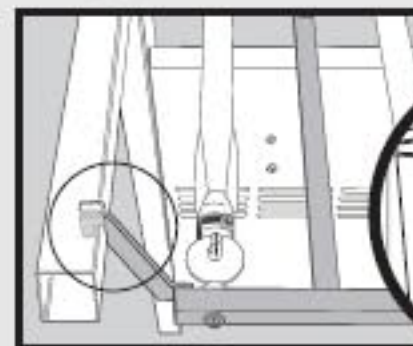
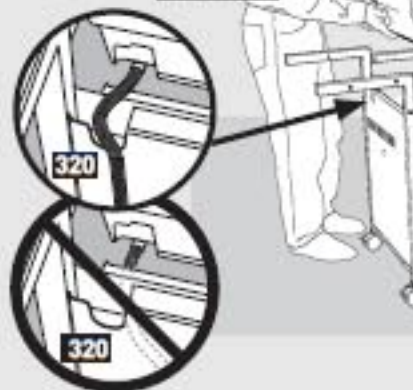

**Hardware**  
Herrajes  
Matériel



**Plastic Plug - 2**  
Tapón plástico - 2  
Bouchon en plastique - 2



**1 Inch Black Zinc Hex Bolts**  
(1/4 x 20 x 1 in.) - 2  
Clic negro 1 pulgada  
Pernos hexagonales  
(1/4 x 20 x 1 pulg.) - 2  
Ecrus hexagonaux en zinc noir de 1 pouce  
(1/4 x 20 x 1 po.) - 2



**Black Zinc Hex Nut - 1**  
Tuerca hexagonal  
negra de zinc - 1  
Ecrus à tête hexagonale  
en zinc noir - 1



**Door Handle Hardware - 4**  
Componentes De La  
Empuñadura De La Puerta - 4  
Poignée De Porte - 4



**#8 - 32 Machine Screw - 4**  
Tornillo de máquina  
#8 - 32 - 4  
Vis de mécanique de  
#8 - 32 - 4

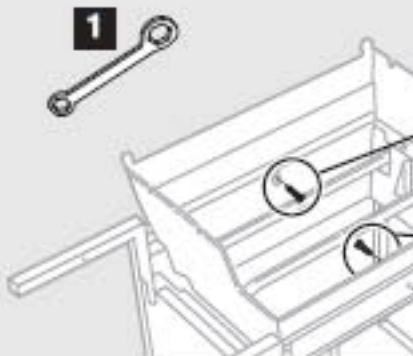
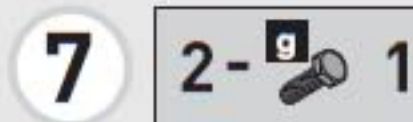
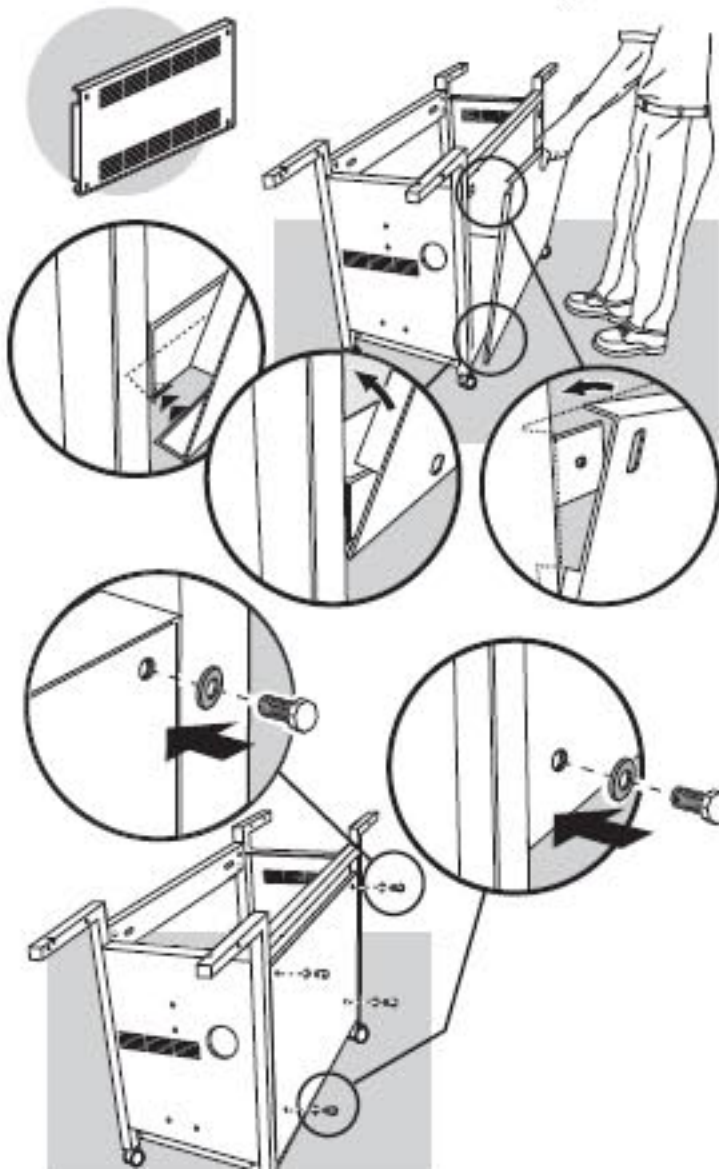
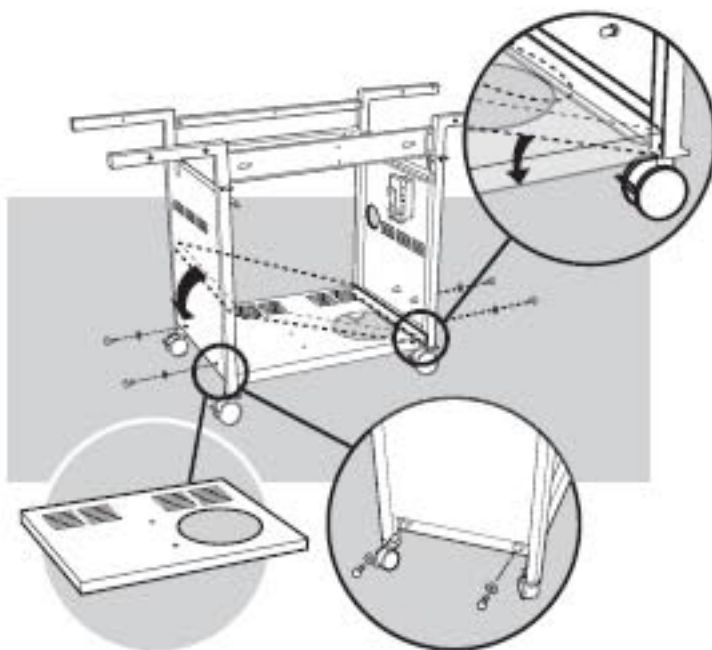
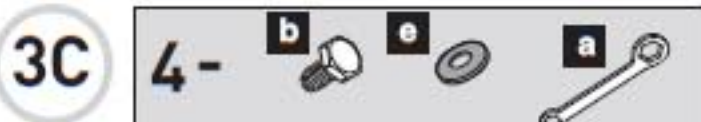

**Before installing, remove protective film from stainless steel parts.**  
Antes de instalar, retire la película protectora de la pieza de acero inoxidable.  
Avant d'installer, retirez la pellicule protectrice de la pièce en acier inoxydable.

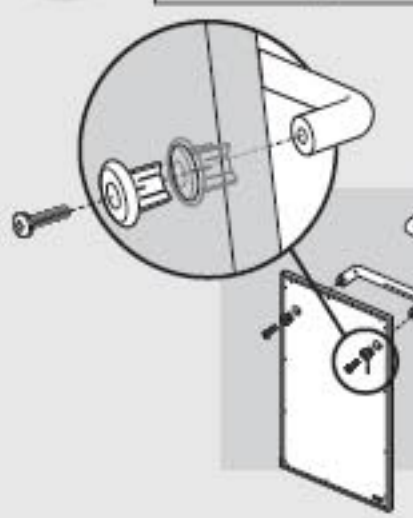
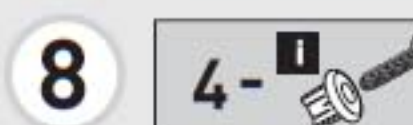

Hardware  
Herrajes  
Matériel



Screw - 5  
Tornillo - 5  
Vis - 5



Clevis Pin - 2  
Pasador de horquilla - 2  
Axe - 2



Cutter Pin - 2  
Clavija hendida - 2  
Goupille fendue - 2



J-Clip - 7  
Grapa J - 7  
Pince en J - 7



Aluminium Washer - 6  
Arandela de aluminio - 6  
Rondelle en aluminium - 6

16

3 -

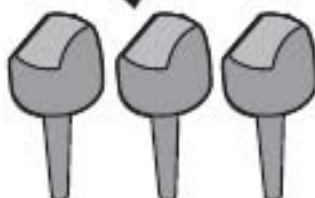

**△ IMPORTANT:**  
Knob bezels must be adjusted at this point.

See sheet in control knob packaging for bezel adjustment instructions.



**△ IMPORTANTE:**  
Las molduras decorativas de la perilla deben ajustarse ahora.

Refiérase a la hoja dentro del empaque de la perilla de control para las instrucciones sobre como ajustar las molduras decorativas.



**△ IMPORTANT:**  
La collerette du bouton doit être ajustée à ce stade.

Voir la fiche fournie avec le bouton de commande pour les instructions de réglage de la collerette.

17

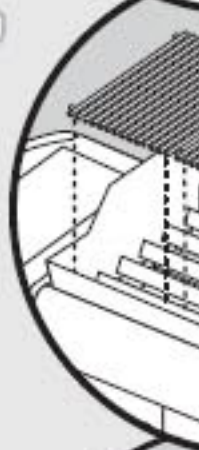
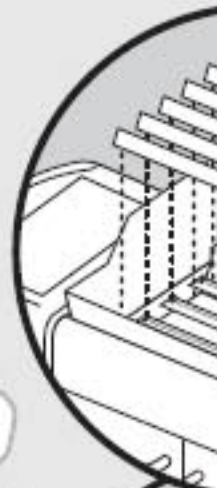

18

