

This Owner's Manual is provided and hosted by [Appliance Factory Parts](#).



# Centro 85-1117-6 (2009) Owner's Manual

**Shop genuine replacement parts for Centro 85-1117-6  
(2009)**



**Find Your Centro Grill Parts - Select From 150 Models**

----- Manual continues below -----



## **Breakfast Centre Assembly Manual**

---

**85-1117-6 (G21201) Propane  
Limited 3-Year Warranty**

**Read and save manual for future reference.**

**Assemble your grill immediately.  
Missing or damaged parts should be  
claimed within 15 days of purchase.  
Call the Centro Hotline at 1-877-707-5463.**



**HEAVY ARTICLE NEEDS 2 TO LIFT**

**THIS MANUAL MUST REMAIN WITH THE PRODUCT AT ALL TIMES**

---

To ORDER non-warranty replacement parts or accessories,  
or to register your warranty, please visit us on the web at  
[www.centrobbqs.com](http://www.centrobbqs.com).

---

**⚠ CAUTION**

Sharp edges. Wear gloves when assembling your grill.

---

**⚠ CAUTION**

Read and follow all safety statements, assembly instructions, and use and care directions before attempting to assemble and cook.

---

**⚠ INSTALLER OR ASSEMBLER/CONSUMER**

This manual should be kept with the BBQ at all times.

---

**⚠ WARNING**

Failure to follow all of the Manufacturer's instructions could result in hazardous fires, explosions, property damage, or serious personal injury or even death.

Follow all leak check procedures carefully prior to operation of barbecue, even if grill was dealer assembled. Do not try to light this barbecue without reading the Lighting Instructions section of this manual.

---

**⚠ DANGER**

1. If you smell Gas:
  - a. Shut off gas to the appliance
  - b. Extinguish any open flame
  - c. Open lid
  - d. If odor continues, keep away from the appliance and immediately call your gas supplier or your fire department
2. Do not store or use gasoline or other flammable vapours and liquids in the vicinity of this or any other appliance.
3. An LP cylinder not connected for use shall not be stored in the vicinity of this or any other appliance.
4. Requires two people to complete the assembly process.
5. Beware of sharp edges.

**THIS BARBECUE IS FOR OUTDOOR USE ONLY**

**CONTACT CALL CENTRE IF ANY PARTS ARE MISSING**

## HARDWARE PACK

### TOOLS NEEDED FOR ASSEMBLY

- #2 Phillips screwdriver (long and short)
- 1/4" Slotted screwdriver (long and short)
- Adjustable wrench
- Pliers
- Rubber Mallet

**Before assembling the barbecue, read these instructions carefully.**

Assemble the barbecue on a flat, clean surface. Grill is heavy.

**Notes:** Do not fully tighten all the nuts during this initial stage.

No.	Description	Part Number	Quantity
1	1/4"×38mm Screw	20120-13038-250	4
2	1/4"×13mm Screw	20120-13013-250	6
3	ø7 Lock Washer	41400-07000-250	10
4	ø7 Washer	40300-07000-250	10
5	ST4.2×10 Tapping Screw	22500-42010-137	1
6	NO.10-24UNC x10 Screw	20124-10010-250	12
7	ø5 Lock Washer	41400-05000-250	12
8	ø5 Washer	40300-05000-250	12
9	NO.8-32UNC x10 Screw	20332-08010-250	4
10	Wrench	G413-0032-9082	1



### Caution:

Sheet metal can cause injury. Wear gloves when installing the grill.

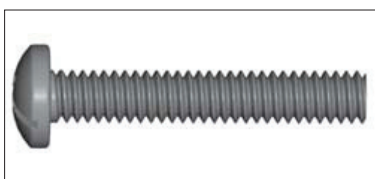

#1. 1/4" x 38mm Screw (x4)

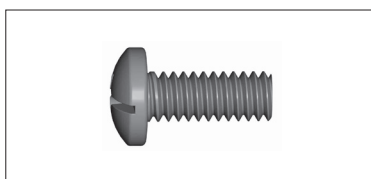

#2. 1/4" x 13mm Screw (x6)

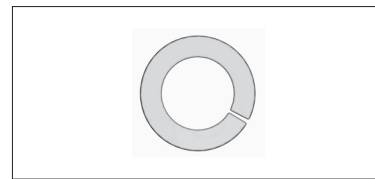

#3. ø7 Lock Washer (x10)

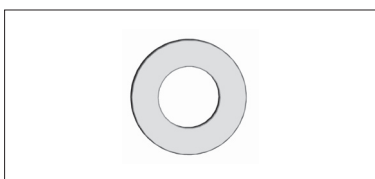

#4. ø7 Washer (x10)

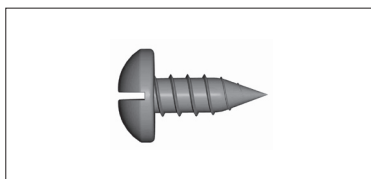

#5. ST4.2x10 Tapping Screw (x1)

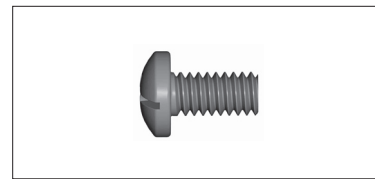

#6. NO. 10-24UNCx10 Screw (x12)

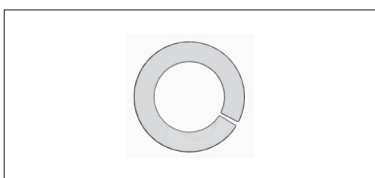

#7. ø5 Lock Washer (x12)

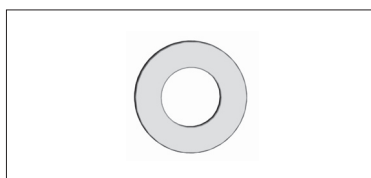

#8. ø5 Washer (x12)

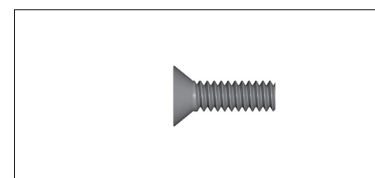

#9. No. 8-32UNCx10 Screw (x4)

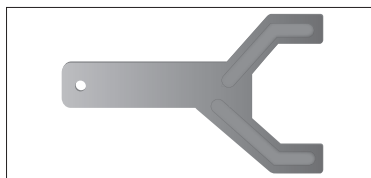

#10. Wrench (x1)

## PARTS LIST FOR 85-1117-6 (G21201)

Item	Quantity	Description	Part No.
A1	1	Top Lid Cover	G212-2000-01
A2	2	Upper Hinge	G508-8202-01
B	1	Upper Rear Panel	G212-0013-01
C1	1	Main Cart Frame	G212-0004-01
C2	2	Lower Hinge	G508-8104-01
D	1	Cooking Grate, Sideburner	G212-0012-01
E	1	Side Burner Assembly	G212-0300-01
F	1	Sideburner Electrode Set	G433-0047-01
G	1	Side Burner Drip Pan	G212-0005-01
H1	1	Control Panel	G212-0009-01
H2	1	Cuisine Logo	A012-0006-01
I	3	Tool Hooks	G212-0006-01
J	1	Tank Exclusion, Wire Frame	G212-0016-01
K	1	Manifold Assy (main valve/ rotisserie valve)	G212-4000-01
L	1	Regulator	G419-0013-01
M	2	Control Knob	G412-4500-01
N1	1	Electronic Igniter Assembly	G501-0072-02
N2	1	Electronic Ignition Button	G501-0072-01
O	1	Electrode set, main burner	G617-0017-01
P	1	Front Brace	A012-0001-01
Q	1	Grease Tray	G212-0400-01
R	1	Grease Cup	G416-0015-01
S	1	Griddle	G212-0002-01
T	1	Cooking Grate	G212-0001-01
U	1	Flame Tamer	G212-0011-01
V	1	Main Burner	G502-1700-01
W	1	Burner Box Weldment	G212-0200-01
X	1	Left Side Panel, Cart	A012-0200-01
Y	1	Right Side Panel, Cart	A012-0300-01
Z1	1	Pillar - Left	A012-0600-01
Z2	2	Magnet Assy	G401-0052-01
AA	1	Pillar - Right	A012-0700-01
BB	1	Door Assy	G212-6000-01
CC	1	Bottom Shelf	G212-0500-01
DD	2	Caster Assy W/ Lock	G401-0061-01
EE	2	Caster Assy	G606-0027-01
FF	1	Match Holder	G608-0019-01
GG	1	Joint Hook	A012-0016-01
	1	Hardware Pack	G212-B001-01
	1	Assembly Manual	G212-M001-01
	1	Safety & Care Manual	G617-M001-02

# EXPLOADED DIAGRAM FOR 85-1117-6 (G21201)

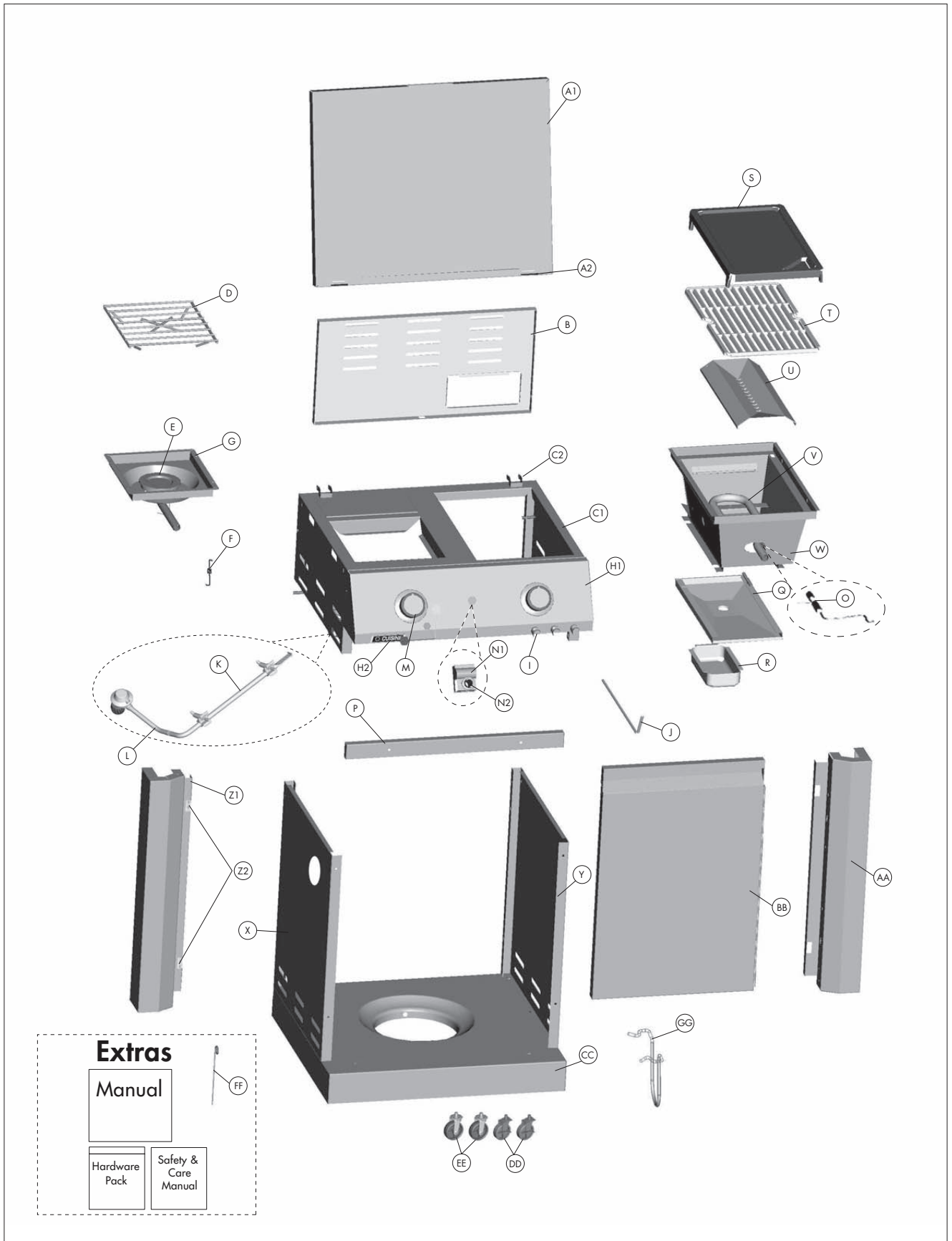

## ASSEMBLY INSTRUCTIONS

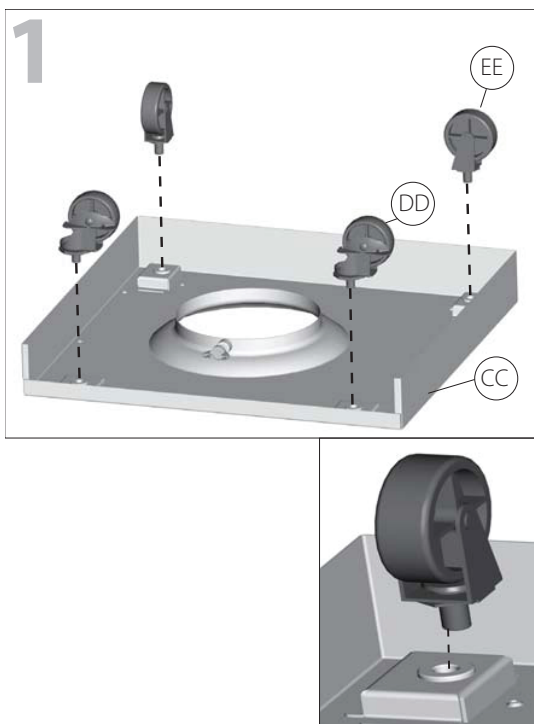

Separate the 2 different types of wheels, 2 locking wheels (DD) and 2 regular wheels (EE).

Attach the locking wheels (DD) to the back of the bottom shelf (CC) and the regular wheels (EE) to the front of the bottom shelf (CC).

To secure the 4 wheels, hand tighten first. Then, tighten further using the wrench provided in the hardware pack.

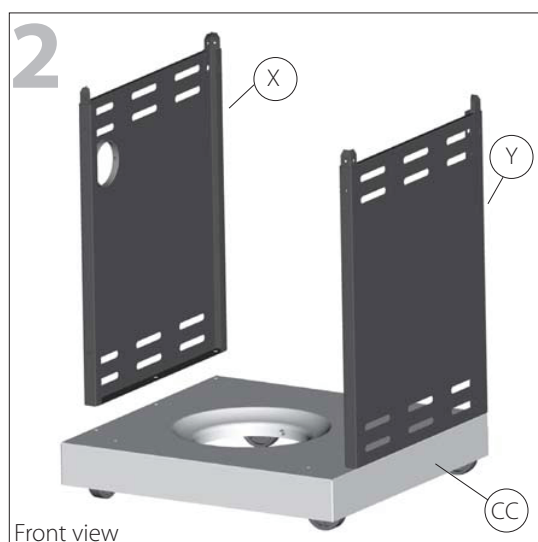

Front view

Ensure that the wheels are firmly locked in the "ON" position before continuing.

Assemble the left side panel (X) and the right side panel (Y) to the bottom shelf (CC).



#2 1/4"X13mm Screw(X6)



#3 ø7 Lock Washer(X6)



#4 ø7 Washer(X6)

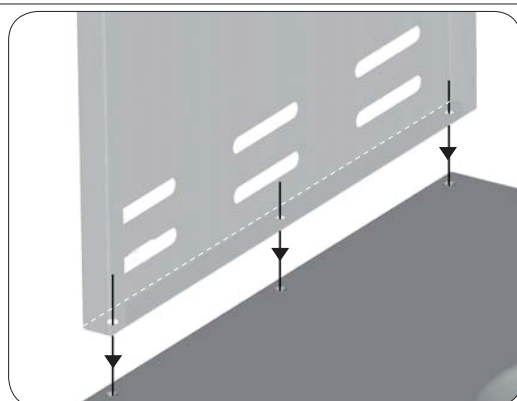

## ASSEMBLY INSTRUCTIONS

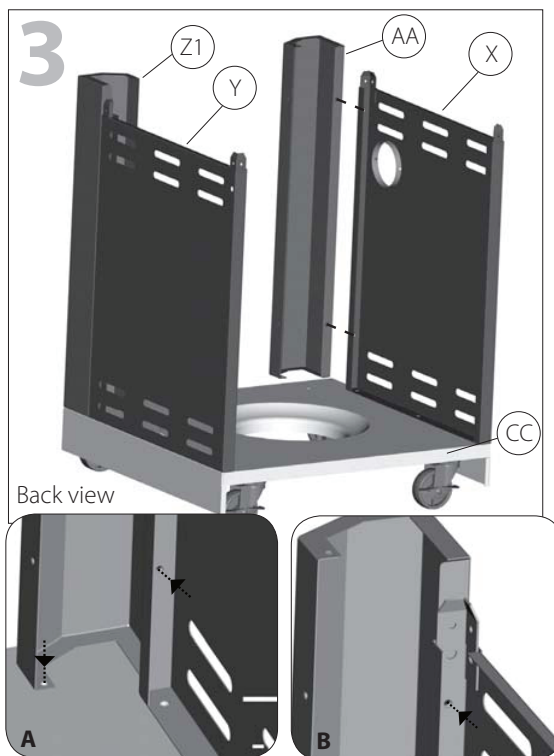

Attach the left pillar (AA) and the right pillar (Z1) to the side panels (X & Y) and to the bottom shelf (CC), as shown in Figure A and B.



#6 NO.10-24UNC x10 Screw (X6)



#7 ø5 Lock washer (X6)



#8 ø5 Washer (X6)

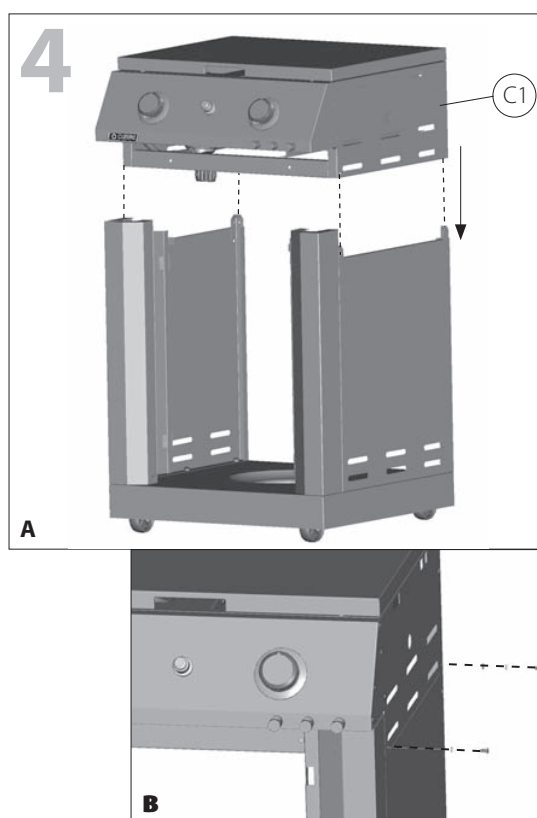

**THIS STEP REQUIRES 2 OR MORE PEOPLE.  
DO NOT ATTEMPT ALONE. EXTREMELY HEAVY!**

a. Position the main cart frame (C1) onto cart assembly, as shown in Figure A.

b. Use the hardware to connect both parts, on the left and right sides, at the four points indicated in Figure B.



#6 NO.10-24UNC x10 Screw (X4)



#7 ø5 Lock washer (X4)



#8 ø5 Washer (X4)



## ASSEMBLY INSTRUCTIONS

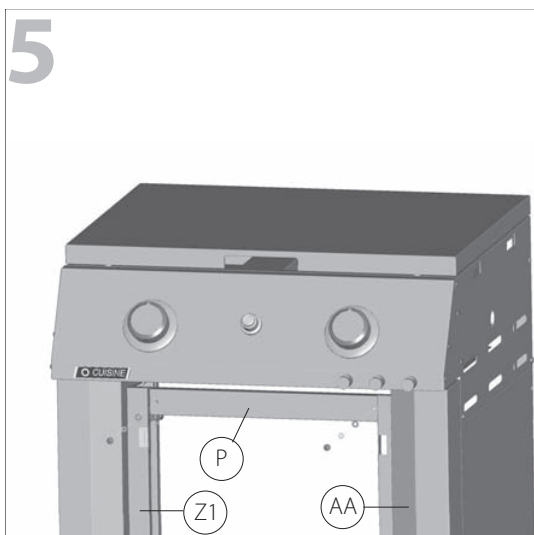

Front view



Attach the front brace (P) to the left and right pillars (Z1 & AA).

**TIP:** One person should align the left side, while the second person assembles the right side.



#6 NO.10-24UNC x10 Screw(X2)



#7 ø 5 Lock Washer(X2)



#8 ø 5 Washer(X2)

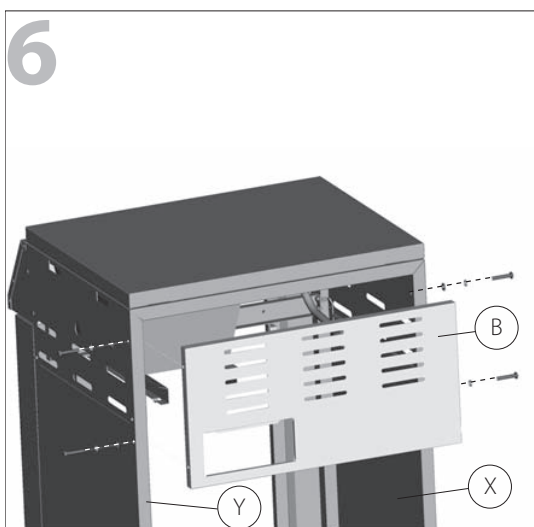

Back view

Attach the upper back panel (B) to both the left and right side panels (X & Y).



#1 1/4"X38mm Screw(X4)



#3 ø7 Lock Washer(X4)



#4 ø7 Washer(X4)

## ASSEMBLY INSTRUCTIONS

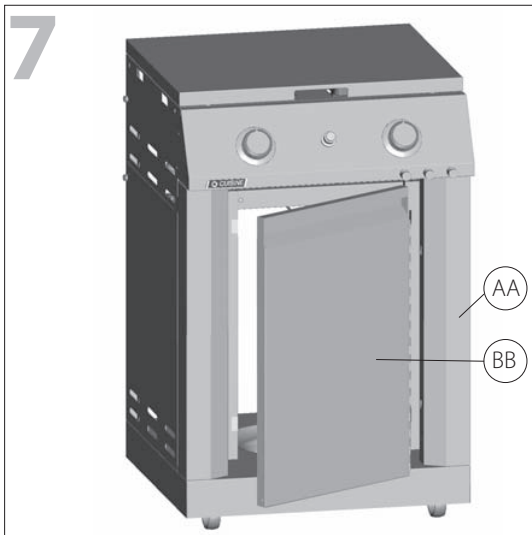

Front view



**TIP:** Before attempting to assemble the door (BB) to the right pillar (AA), locate the two clasps on the door hinge. Next, locate the two small openings on the right side pillar.

a. Hold the door perpendicular to the cart. Align the two clasps on the door hinge (BB), with the two holes on the right side pillar (AA). Once aligned push the two clasps into the openings, and immediately push down to lock clasps in place.

b. Assemble the door (BB) to the right pillar (AA), as shown in Figure B, using the screws provided.



#9 NO.8-32UNC x10 Screw(X4)

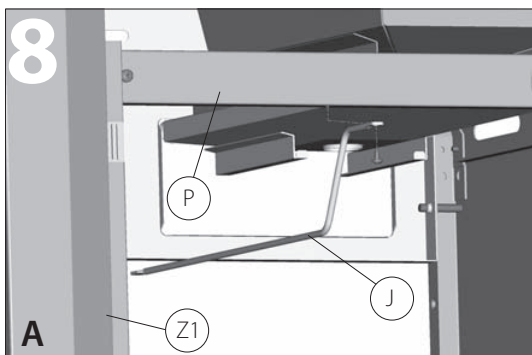

Front view

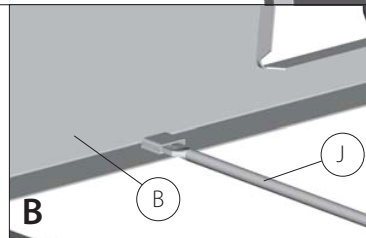

Insert the flat end of the tank exclusion bar (J) into the groove on the upper back panel (B), as shown in figure B. Next, attach the tank exclusion bar (J) to the front brace (P) using the self tapping screw, as shown in figure A.



#5 ST4.2X10 Tapping Screw(X1)

## ASSEMBLY INSTRUCTIONS

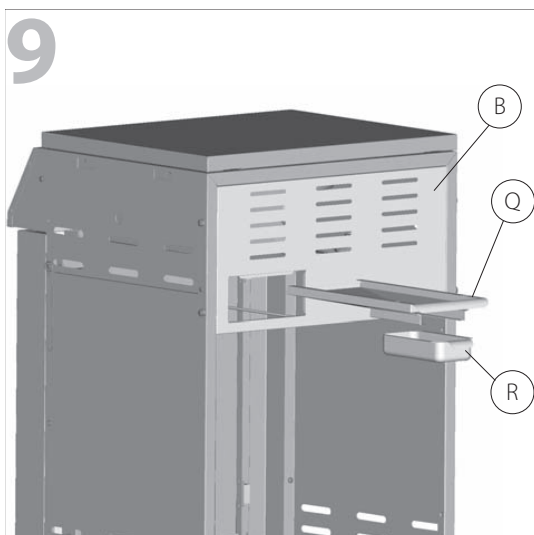

Back view

- a. Insert the grease tray (Q) into the opening in the upper back panel (B), making sure to engage tracks located under burner box.
- b. Place the grease cup (R) onto the tracks, located on the underside of the grease tray (Q).

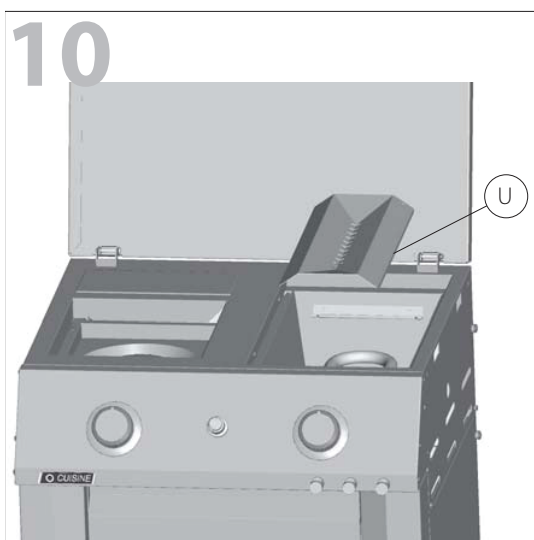

Lift lid. Place the flame tamer (U) into the burner box (W).

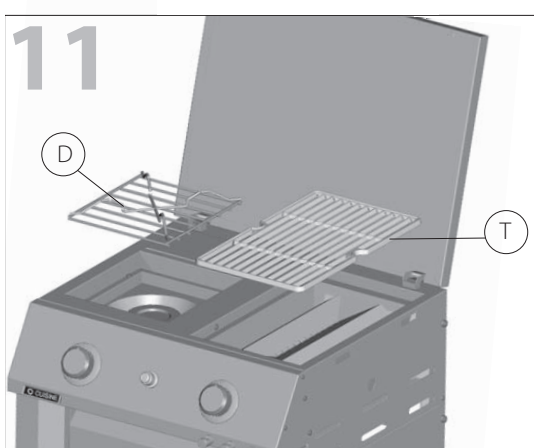

- a. Place the side burner cooking grate (D) on the side burner.
- b. Place the main burner cooking grate (T) on the burner box (W).

## ASSEMBLY INSTRUCTIONS

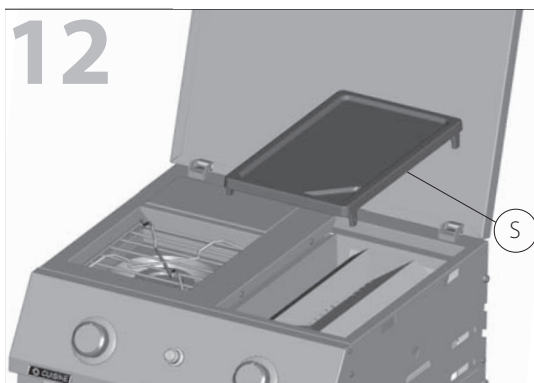

**TIP:** Please note that you can only use the cooking grate (T) or the cooking griddle (S) on the main burner.

To use the cooking griddle (S), remove the cooking grate (T) and place the cooking griddle (S) into the burner box (W).

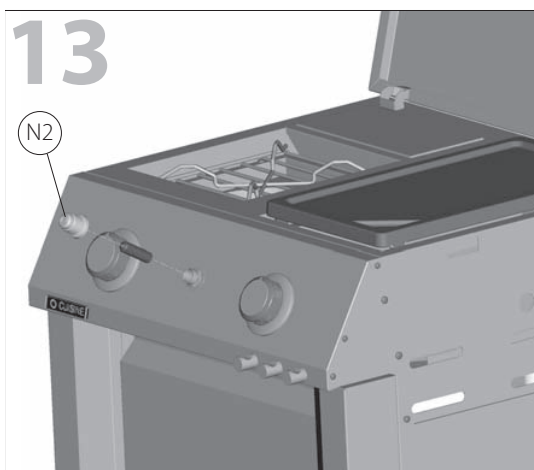

Unscrew the electronic ignitor button (N2) and insert one AA battery into the electronic ignitor battery compartment, with the positive end facing outward.

**\* Battery not included.**

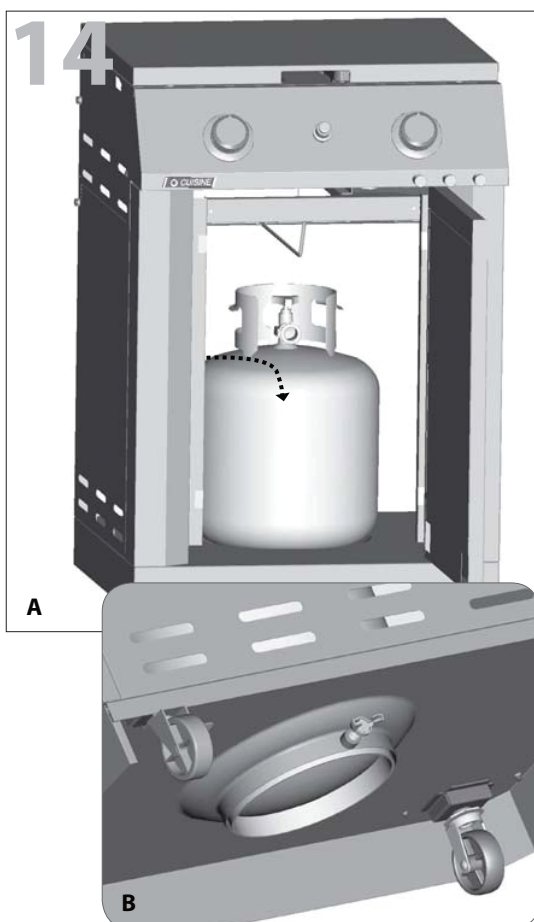

a. Position the 20 lb propane tank onto the bottom shelf (CC), and secure using the bolt (already attached) located on the underside of the bottom shelf, as shown in Figure B.

b. Attach the Regulator coupling nut to the LP cylinder valve.

**ATTENTION:** For your families' safety, do not attempt to light this BBQ until you have reviewed pages 4-7 of the CENTRO Safety & Care Manual. All Safety and Leak test MUST BE PERFORMED BY THE END-USER, prior to lighting this BBQ.

**WARNING** Do not store extra propane tanks within BBQ cart.

**NOW AVAILABLE!**

## Centro Countertop Corner Leaf (# 85-1147-4/ A01301)

- o Extend your counter space
- o Arrange your Centro BBQ and Centro Cuisine outdoor appliances at a 45° angle
- o Connect your Centro BBQ and Centro Cuisine outdoor appliances for a seamless outdoor kitchen experience.

