

This Owner's Manual is provided and hosted by [Appliance Factory Parts](#).



# Craftsman 338.17929 Owner's Manual

[Shop genuine replacement parts for Craftsman  
338.17929](#)



[Find Your Craftsman Vacuum Cleaner Parts - Select From 14 Models](#)

----- Manual continues below -----

Save This Manual  
For Future Reference

## Owner's Manual

MODEL NO.  
**338.17920**  
**338.17921**  
**338.17922**  
**338.17929**

Model Number \_\_\_\_\_

The model number may be found on the nameplate. You should record the model number in a safe place for future use.

**⚠ CAUTION:** Before using this vacuum, read this manual and follow all its Safety Rules and Operating Instructions.

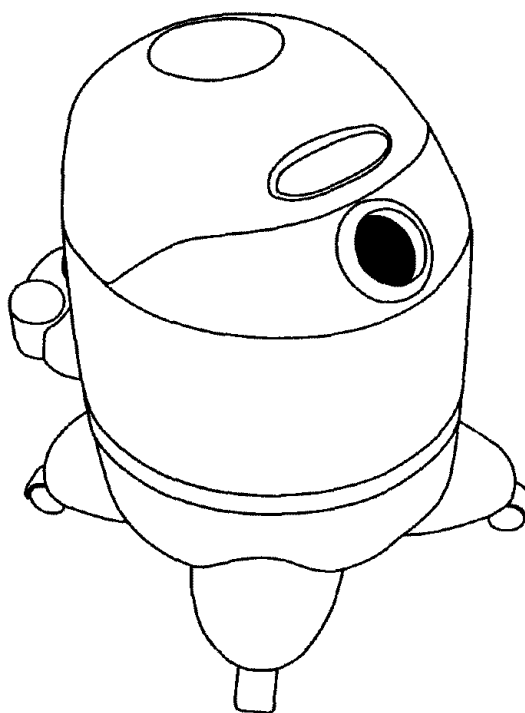

# CRAFTSMAN

## WET/DRY VACUUM

- **Safety**
- **Assembly**
- **Operating**
- **Repair parts**
- **Español p. 6**

## OWNER'S MANUAL CONTENTS

Item	Page
Warranty Information . . . . .	2
Safety Instructions . . . . .	2,3
Unpacking Carton Contents . . . . .	3
Assembly . . . . .	3
Operation . . . . .	4
Storage . . . . .	5
Troubleshooting . . . . .	5
Repair Parts . . . . .	See Insert

## WARRANTY

### FULL ONE YEAR WARRANTY ON CRAFTSMAN WET/DRY VACUUM

If this Craftsman Wet/Dry Vacuum fails due to a defect in materials or workmanship within one year from the date of purchase, Sears will repair or replace it, at Sears option, free of charge. For warranty service, return the Wet/Dry Vacuum to your nearest Sears Service Center or Sears Store in the United States.

If this Craftsman Wet/Dry Vacuum is used for commercial enterprise of any sort, including rental use, this warranty coverage applies for only 90 days from the date of purchase.

This warranty applies only while this product is used in the United States.

This warranty gives you specific legal rights, and you may also have other rights which vary from state to state.

Sears, Roebuck and Co., Dept. 817WA, Hoffman Estates, IL 60179

## SAFETY INSTRUCTIONS

When using an electrical appliance, basic precautions should always be followed, including the following:  
**Read all instructions before using this product.**

- ⚠ WARNING:** To reduce the risk of fire, electric shock or injury.
- Do not leave appliance when plugged in. Unplug from outlet when not in use and before servicing. Connect to a properly grounded outlet only. See Grounding Instructions.
- Do not expose to rain – store indoors.
- Do not allow to be used as a toy. Close attention is necessary when used by or near children.
- Use only as described in this manual. Use only Craftsman attachments.
- Do not use with damaged cord or plug. If appliance is not working as it should, has been dropped, damaged, left outdoors or dropped into water, return it to a Sears service center.
- Do not pull or carry by cord, use cord as a handle, close a door on cord or pull cord around sharp edges or corners. Do not run appliance over cord. Keep cord away from heated surfaces.
- Do not unplug by pulling on cord. To unplug, grasp the plug, not the cord.
- Do not handle plug or appliance with wet hands.

- Do not put any object into openings. Do not use with any openings blocked; keep free of dust, lint, hair and anything that may reduce air flow.
- Keep hair, loose clothing, fingers and all parts of body away from openings and moving parts.
- Do not pick up anything that is burning or smoking, such as cigarettes, matches or hot ashes.
- Do not use without dust bag and/or filters in place.
- Turn off all controls before unplugging.
- Use extra care when cleaning on stairs.
- Do not use to pick up flammable or combustible liquids such as gasoline or use in areas where they may be present.
- Do not use your cleaner as a sprayer of flammable liquids such as oil base paints, lacquers, household cleaners, etc.
- Do not vacuum toxic, carcinogenic, combustible or other hazardous materials such as asbestos, arsenic, barium, beryllium, lead, pesticides or other health endangering materials.
- Do not pick up soot, cement, plaster or drywall dust without cartridge filter and collection filter bag in place. These are very fine particles that may pass through the foam and affect the performance of the motor or be exhausted back into the air. Additional collection filter bags are available from Sears.
- Do not leave the cord lying on the floor once you have finished the cleaning job. It can become a tripping hazard.
- Use special care when emptying heavily loaded tanks.
- To avoid spontaneous combustion, empty tank after each use.
- The operation of a utility vac can result in foreign objects being blown into eyes, which can result in eye damage. Always wear safety goggles when operating vacuum.
- STAY ALERT.** Watch what you are doing and use common sense. Do not use vacuum cleaner when you are tired, distracted or under the influence of drugs, alcohol or medication causing diminished control.

## GROUNDING INSTRUCTIONS

This vacuum cleaner is equipped with a cord having an equipment-grounding conductor and grounding plug. If vacuum cleaner should malfunction or breakdown, grounding provides a path of least resistance for electric current to reduce the risk of electric shock. The plug must be inserted into an appropriate outlet that is properly installed and grounded in accordance with all local codes and ordinances.

- ⚠ WARNING:** Improper connection of the equipment-grounding conductor and grounding plug can result in a risk of electric shock. Check with a qualified electrician or service person if you are in doubt as to whether the outlet is properly grounded. Do not modify the plug provided with the vacuum cleaner – if it will not fit the outlet, have a proper outlet installed by a qualified electrician.

This appliance is for use on a nominal 120-volt circuit, and has a grounded plug that looks like the plug illustrated in **sketch A**. A temporary adapter that looks like the adapter illustrated in **sketches B and C** may be used to connect this plug to a 2-pole receptacle as shown in **sketch B** if a properly grounded outlet is not available. The temporary adapter should be used only until a properly grounded outlet (**sketch A**) can be installed by a qualified electrician. The green colored rigid ear, lug or the like extending from the adapter must be connected to a permanent ground such as a properly grounded outlet box cover. Whenever the adapter is used, it must be held in place by a metal screw.

**NOTE:** In Canada, the use of a temporary adapter is not permitted by the Canadian Electrical code.

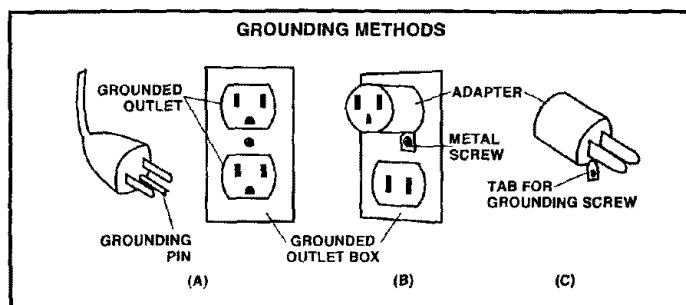

## EXTENSION CORDS

When using the vacuum cleaner at a distance where an extension cord becomes necessary, a 3-conductor grounding cord of adequate size must be used for safety, and to prevent loss of power and overheating. Use the table below to determine A.W.G. wire size required. To determine ampere rating of your vacuum, refer to nameplate located on rear of motor cover.

Before using vacuum cleaner, inspect power cord for loose or exposed wires and damaged insulation. Make any needed repairs or replacements before using your vacuum cleaner. Use only three-wire outdoor extension cords which have three-prong grounding-type plugs and three-pole receptacles which accept the extension cord's plug. When vacuuming liquids, be sure the extension cord connection does not come in contact with the liquid.

Volts	Total length of cord in feet			
	25	50	100	150
120V				
Ampere Rating More Than	AWG			
Not More Than				
0.....6	18	16	16	14
6.....10	18	16	14	12
10.....12	16	16	14	12
12.....16	14	12	<b>Not recommended</b>	

**NOTE:** Static shocks are common in dry areas or when the relative humidity of the air is low. This is only temporary and does not affect the use of the appliance. To reduce the frequency of static shocks in your home, the best remedy is to add moisture to the air with a console or installed humidifier.

## ASSEMBLY

1. Pull tank cover latches in an outward motion and remove tank cover and any accessories which may have been shipped in the tank. (**Figure 1**)
2. Before replacing tank cover, refer to Dry Pick-Up or Wet Pick-Up Operation in this manual to ensure you have the proper filters installed and inlet deflector is positioned correctly for your cleaning operation.

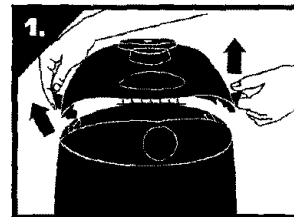

3. Your vacuum comes with the filters already installed for dry pick-up. For filters recommended for wet pick-up refer to wet pick-up operation.
4. Be sure inlet deflector (**Figure 2**) is in proper position. Opening up for wet, down for dry vacuuming.

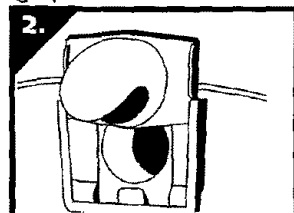

5. You will find four casters, four caster supports and four screws with your wet/dry vacuum. Model 17920 includes four casters only.

6. With tank cover removed, invert tank so that the bottom is facing up.
7. Insert caster supports into slots and secure with screws. (**Figure 3**)
8. Insert caster stems into supports by applying pressure until you feel the casters are firmly in place.

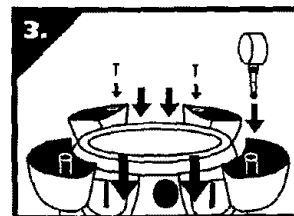

9. On model 17920, insert casters directly into holes provided in the bottom of the tank.
10. Replace tank cover and apply pressure with thumbs to each latch until it snaps tightly in place. Make sure both lid latches are clamped securely. (**Figure 4**)

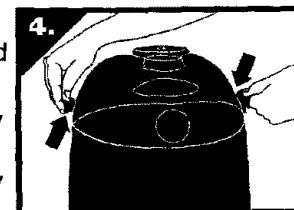

11. Insert hose end with locking-nut into inlet of tank and tighten nut. Do not over-tighten.

12. Attach the extension wands to the accessory end of the hose.
13. Attach one of the cleaning accessories (depending on your cleaning requirements) onto the extension wands.

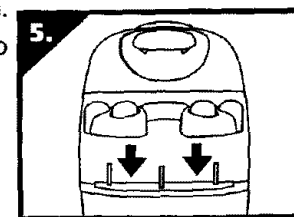

14. Align tool holder with the lugs near bottom of tank. Slide tool holder down until it snaps into place (**Figure 5**) Your vacuum is now equipped for tool storage (**Figure 6**).

15. Plug the cord into the wall outlet. Your cleaner is ready for use. I = ON, O = OFF

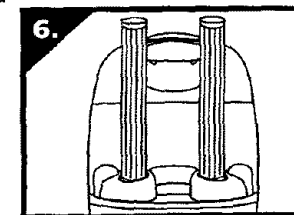

## OPERATION

### DRY PICK-UP OPERATION

With the tank cover in an upside down position, slide the cartridge filter down over the lid cage, pushing until the filter seals against cover (**Figure 7**). Foam sleeve will remain in place. Place filter retainer into the top of the cartridge filter, and holding the tank cover with one hand, turn the handle on the filter retainer clockwise to tighten, locking the filter into place (**Figures 8 & 9**). To remove the filter for cleaning, again hold the tank cover and turn the filter retainer counterclockwise to loosen and remove, then slide the cartridge filter off the lid cage (**Figures 10 & 11**). To clean the cartridge filter, shake or brush off excess dirt (**Figure 12**) or rinse (from the inside of the filter) with water (**Figure 13**). Dry completely and re-install.

Your vac filter is color coded with a black stripe. When replacing, just match the color.

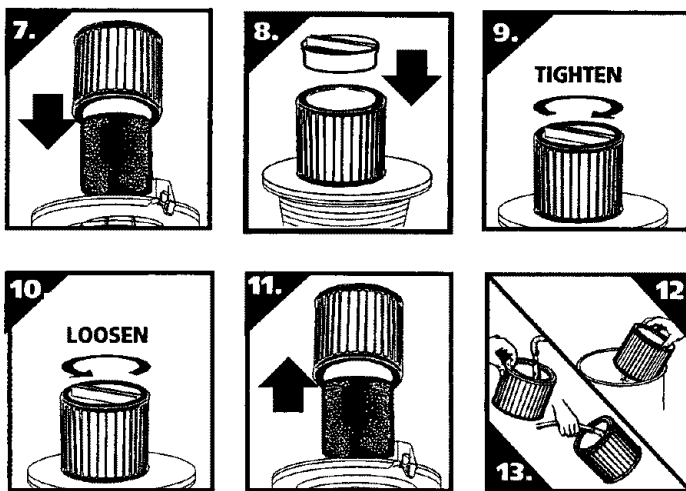

### INSTALLING THE DISPOSABLE FILTER BAG

(Not standard with all models)

1. Use for dry pick-up only. Use only when cartridge filter is installed on wet/dry vacuum.
2. With cord disconnected from receptacle, pull latches in an outward motion and remove tank cover.
3. Unscrew hose locking-nut and remove hose from inlet. (**Figure 14**)
4. Remove inlet deflector from deflector guide. (**Figure 14a**) **NOTE:** Hose must be removed before inlet deflector can be taken out.
5. With the opening of the inlet deflector facing the bottom of the filter bag, slide collection bag collar over deflector, matching notches of bag collar to tabs on inlet deflector. Bag will only fit properly one way. (**Figure 14b**)
6. Slide deflector with collection bag attached into deflector guide (**Figure 14c**)
7. Reinsert hose into inlet and tighten locking-nut. (**Figure 14d**)

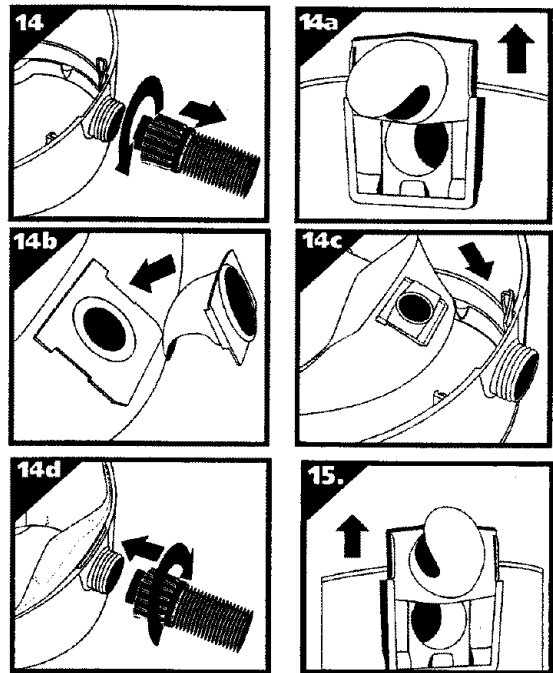

### WET PICK-UP OPERATION

For best results for wet pick-up remove cartridge filter and utilize the foam sleeve (already in place over the lid cage). For wet pick-up remove inlet deflector from deflector guide sliding in an upward motion. Invert and insert into guide with opening facing up. **NOTE:** Hose must be removed before inlet deflector can be taken out. Be sure the opening of the inlet deflector is facing the top of the tank (**Figure 15**).

Misting may occur if inlet deflector is not inserted properly. Misting in exhaust air may also occur if the foam sleeve becomes saturated during wet pick-up. If misting occurs, remove and dry the saturated foam sleeve or replace with another dry foam sleeve to eliminate the misting and possible dripping of liquid around the lid.

Turn the unit off immediately upon completing a wet pick-up job or when tank is full and ready to be emptied, and raise the hose to drain any excess liquid into the tank. The interior of the tank should be periodically cleaned. The foam sleeve should be cleaned periodically as described in the following steps:

1. Always disconnect the plug from the wall receptacle before removing the tank cover. Remove foam sleeve by sliding it up and off the lid cage.
2. Shake excess dust off foam sleeve with a rapid up and down movement.
3. Hold sleeve under running water, rinsing from the inside. A water wash is not always required, depending on the condition of the sleeve.
4. Gently wring out excess water, and blot sleeve with a clean towel. The foam sleeve is now ready to be reinstalled on the lid cage. **NOTE:** Bottom of sleeve should be TUCKED in groove between lid cage and tank lid. (**Figure 16**)

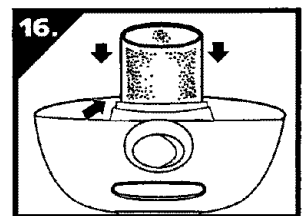

# Get it fixed, at your home or ours!

## Your Home

For repair – **in your home** – of **all** major brand appliances, lawn and garden equipment, or heating and cooling systems, **no matter who made it, no matter who sold it!**

For the replacement parts, accessories and owner's manuals that you need to do-it-yourself.

For Sears professional installation of home appliances and items like garage door openers and water heaters.

**1-800-4-MY-HOME®** (1-800-469-4663)

Call anytime, day or night (U.S.A. and Canada)

[www.sears.com](http://www.sears.com)    [www.sears.ca](http://www.sears.ca)

---

## Our Home

For repair of carry-in items like vacuums, lawn equipment, and electronics, call or go on-line for the location of your nearest **Sears Parts & Repair Center.**

**1-800-488-1222**

Call anytime, day or night (U.S.A. only)

[www.sears.com](http://www.sears.com)

---

To purchase a protection agreement on a product serviced by Sears:

**1-800-827-6655** (U.S.A.)

**1-800-361-6665** (Canada)

---

Para pedir servicio de reparación a domicilio, y para ordenar piezas:

**1-888-SU-HOGAR<sup>SM</sup>**

(1-888-784-6427)

Au Canada pour service en français:

**1-800-LE-FOYER<sup>MC</sup>**

(1-800-533-6937)

[www.sears.ca](http://www.sears.ca)

# SEARS

® Registered Trademark / <sup>TM</sup> Trademark / <sup>SM</sup> Service Mark of Sears, Roebuck and Co.

® Marca Registrada / <sup>TM</sup> Marca de Fábrica / <sup>SM</sup> Marca de Servicio de Sears, Roebuck and Co.

<sup>MC</sup> Marque de commerce / <sup>MD</sup> Marque déposée de Sears, Roebuck and Co.

© Sears, Roebuck and Co.