

This Owner's Manual is provided and hosted by [Appliance Factory Parts](#).

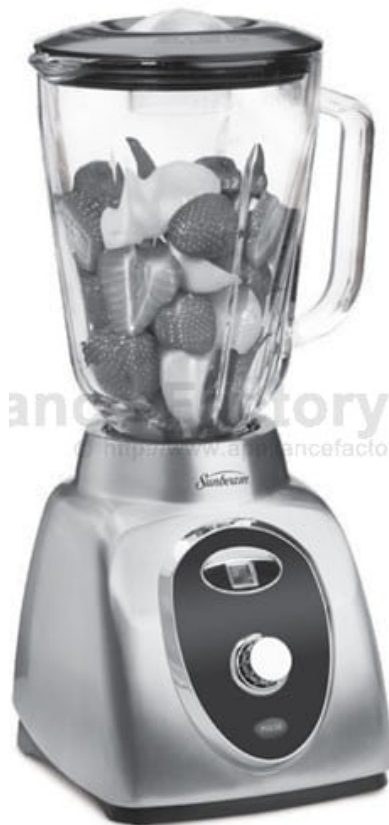

# SUNBEAM 6092 Owner's Manual

[Shop genuine replacement parts for SUNBEAM 6092](#)



[Find Your SUNBEAM Small Appliance Parts - Select From 72 Models](#)

----- Manual continues below -----

# *Sunbeam*<sup>®</sup>

*User Manual* **5 SPEED BLENDER**

**MODEL 6092, 6094**



*www.sunbeam.com*

*P.N. 123244*

# IMPORTANT SAFEGUARDS

When using electrical appliances, basic safety precautions should always be followed, including the following:

- Read all instructions. Keep these instructions for future use.
- Verify that the voltage in your home corresponds to that of your appliance.
- To protect against risk of electrical shock, do not put cord, plug, base, or motor in water or other liquid.
- Close supervision is necessary when any appliance is used by or near children.
- Unplug cord from outlet when not in use, before putting on or taking off parts and before cleaning.
- Avoid contact with moving parts.
- Do not operate any electrical appliance with a damaged cord or plug or after the appliance malfunctions or has been dropped or damaged in any manner. Return appliance to nearest Sunbeam Appliance Authorized Service Center for examination, electrical repair, mechanical repair, or adjustment.
- The use of attachments, including canning jars, not recommended by the manufacturer may cause a risk of injury to persons.
- Do not use outdoors.
- Do not let cord hang over the edge of a table or counter or touch hot surfaces, including the stove.
- Keep hands and utensils out of container while blending to reduce the risk of severe personal injury and/or damage to blender. A rubber spatula may be used but must be used only when blender is not running.
- Do not use a broken, chipped or cracked blender jar.
- Do not use broken, cracked or loose cutting blades.
- To reduce the risk of injury, never place cutting unit blades on base without jar properly attached.
- Blades are sharp, handle with care.
- Always operate blender with cover in place.
- Screw on blade assembly firmly. Injury can result if moving blades accidentally become exposed.

- When blending hot liquids, remove filler cap from lid. Do not fill blender container beyond 3-cup level. Always begin processing at the lowest speed setting. Keep hands and other exposed skin away from the cover opening to prevent possible burns. Jar will become hot from hot contents.
- If the jar should turn during operation, the blade assembly is loose. Switch OFF immediately and tighten blade assembly.
- Do not leave blender unattended while it is operating.
- To disconnect cord, turn the control to “0” (zero), then remove the plug from wall outlet.
- If glass jar is chipped or cracked, do not use. It could break during operation.
- Do not use appliance for other than intended purpose.

## **SPECIAL INSTRUCTIONS**

- This appliance intended for household use only. Use for food or liquids only.
- This appliance is equipped with a polarized plug. This type of plug has one prong that is wider than the other. The plug will fit in a polarized outlet only one way. This is a safety feature intended to help reduce the risk of electrical shock. If you are unable to insert the plug into the outlet, reverse the plug. If it the plug should still fail to fit, contact a qualified electrician to replace the obsolete outlet. Do not attempt to defeat this safety purpose of the polarized plug by modifying the plug in any way.
- The length of the cord used on this appliance was selected to reduce the hazards of becoming tangled in, or tripping over a long cord. If a longer cord is necessary an approved extension cord may be used. The electrical rating of the extension cord must be equal to or greater than the electrical rating of the blender (500 watts). Care must be taken to arrange the extension cord so that it will not drape over the countertop or tabletop where it can be pulled on by children or accidentally tripped over.
- If the blender blades lock and do not move, it will damage the motor. Do not use. Call the toll-free customer service number for information.
- Do not place blender in the freezer filled with food or liquid. This will freeze and damage the blade assembly, jar and motor.

## **SAVE THESE INSTRUCTIONS**

# WELCOME

Congratulations on your purchase of a SUNBEAM® Blender! Sunbeam has designed your blender to provide the utmost in quality, ease of use and convenience. Sunbeam offers you a blender to fit your lifestyle.

Date product received:

Service number: US: 1 800 458-8407

Canada: 1 800 667 8623

## TABLE OF CONTENTS

Welcome .....	4
Learning About your Blender .....	5
How to Assemble and Use .....	6
5 Speed Rotary Control .....	7
For Controlled Cycle Operation .....	7
Pulse Button .....	7
Hints for Best Use .....	8
Maintaining Your Blender .....	9
Customer Service .....	9
One-Year Limited Warranty .....	10
How to Obtain Warranty Service .....	10

# LEARNING ABOUT YOUR BLENDER

1. Filler-Cap
2. Lid
3. Glass Jar (48 ounces)
4. Blade Assembly (also called cutting blades)
5. Base
6. Control Panel
7. Speed Window
8. Rotary Control Dial
9. Pulse Button

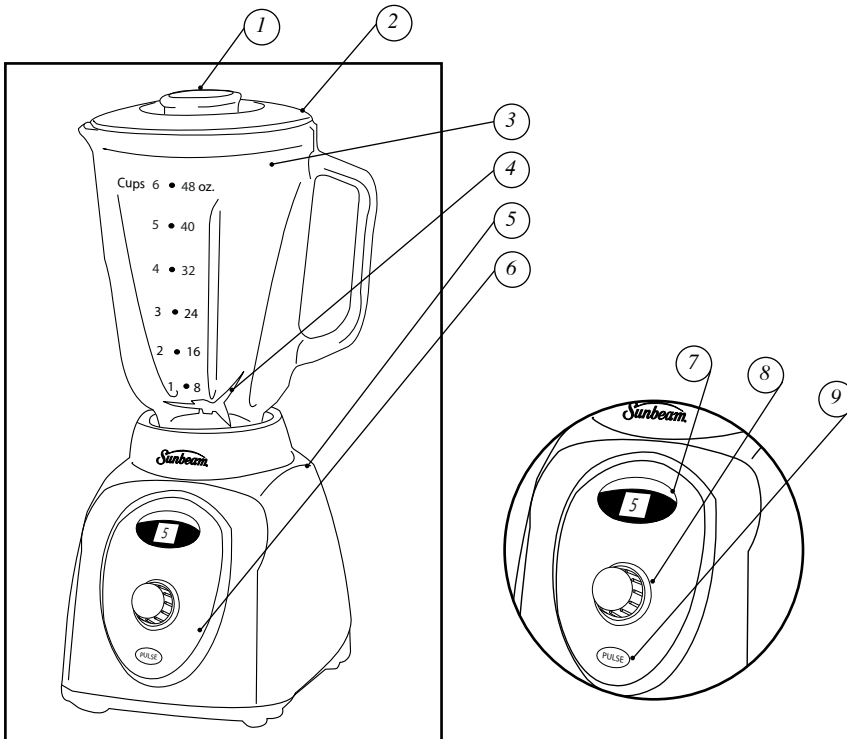

# YOUR BLENDER

After unpacking the blender, wash everything except the blender base in warm, soapy water. Dry thoroughly. Do not place in dishwasher. Wipe the blender base with a damp cloth or sponge. Do not immerse the base in water. Care should be taken when handling the blades, as they are very sharp.

## How to Assemble and Use

**Important:** *Your blender jar and cutting blades are subject to wear during normal use. Always inspect cutting blades for broken, cracked or loose blades. If jar or cutting blades are damaged, do not use. Call our toll-free customer service number to obtain replacement parts.*

- Make sure blender is unplugged. Place blender base on clean, dry surface to keep foreign particles from being pulled up into motor during operation.
- Before inserting blade assembly, be sure that the gasket is seated around blade base.
- In order to insert blade assembly, tilt it slightly and enter with the blade that curves up. Move as needed to clear the remaining blades. To remove, just reverse the process; lower slightly and in the direction of the blade. Tilt up and the other blades will clear the jar bottom opening.
- Attach collar onto jar by screwing it clockwise onto jar until secure.
- Plug cord into outlet.
- Put ingredients in jar, place lid with filler cap in place on jar making sure it is pushed down completely into position.
- Process food or beverages. Place hand on lid when blending liquids. Push desired button on control panel to start blender.
- Always turn blender OFF (turn rotary control dial to "0") and wait until blades have stopped rotating before removing jar or lid.
- Never place jar onto unit while motor is running.
- Never run empty.
- Never run without jar.

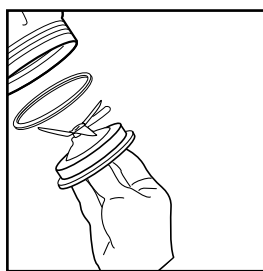

Figure 1

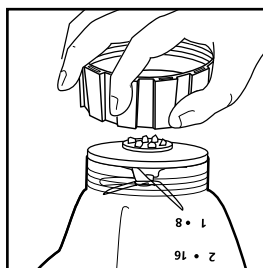

Figure 2

## 5 SPEED ROTARY CONTROL

Your blender has 5 speeds for maximum control. This blender has been designed to gently process foods when operating on low speeds. If blades do not rotate during operation, simply choose a higher speed. Use high speeds to Blend, Liquefy or Crush Ice. To operate your 5 Speed blender, turn the rotary control dial clockwise from “0” to “1” for the lowest blender setting. To increase speeds continue to turn the dial clockwise for speeds 2-5. To stop blending return the rotary control dial to “0”. To turn blender OFF, turn the rotary control dial to “0”. For the lowest Pulse Setting push the “Pulse” button while the blender is set at “0”. DO NOT PUT HANDS IN JAR WHILE UNIT IS ON. DO NOT TOUCH BLADES WHILE UNIT IS ON.

### FOR CONTROLLED CYCLE OPERATION

Rest one hand on top of blender jar with lid securely in place. Press “Pulse” button and hold down for about 2 seconds. Release “Pulse” button and allow blades to coast to a stop. Repeat cycles until contents reach desired consistency. Release of the “Pulse” button turns blender off. Note: “Pulse” button can be held longer than 2 seconds as needed.

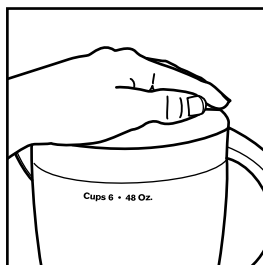

### PULSE BUTTON

For instant control, the pulse function operates only as long as the button is held down. The blender motor stops when the button is released.

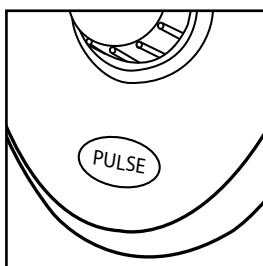
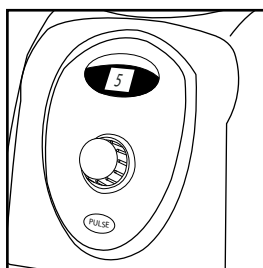

## HINTS FOR BEST USE

- Processing hot foods or liquids in the blender may cause hot liquid to spurt out when the cover is removed. Always remove the filler-cap from the cover before blending hot foods or liquids. Do not exceed 3 cups capacity when blending hot foods or liquids. Jar will become hot from hot contents. (*Please review Important Safeguards section*).
- To add foods while the blender is operating remove filler-cap from container cover and add ingredients through the opening.
- If blending action stops during blending or ingredients stick to the sides of the jar, turn blender OFF. Remove the cover and use a rubber spatula to push mixture towards blades.
- If using your blender to make salsa or other recipes using tomatoes, onions and other vegetables, you may have better results using a slower speed function or the pulse function.
- Do not try to mash potatoes, mix stiff dough, whip egg whites, grind corn, raw meat, or extract juices from fruits and vegetables. The blender is not made to perform these tasks
- Do not store food or liquids in the blender jar.
- Avoid bumping or dropping the blender.

# MAINTAINING YOUR **5** SPEED BLENDER

## HOW TO CLEAN THE BLENDER

- Unplug the blender from electrical outlet.
- Wipe blender base, control panel, and cord with a damp cloth or sponge. To remove stubborn spots, use a mild, non-abrasive cleanser.
- To clean jar, unscrew the blade assembly from jar, keeping jar tilted. Lower blade assembly in the direction of the blade. Tilt up and the other blades will clear the jar bottom opening.
- Carefully remove gasket from outer rim of blade assembly.
- Carefully wash blade assembly, gasket, jar and cover in warm, soapy water. Rinse and dry thoroughly. Do not soak. Do not wash blade assembly, gasket, or cover in a dishwasher.
- Replace gasket onto blade assembly and re-insert blade assembly into glass jar. Do so by tilting it slightly and entering jar with the blade that curves up. Move as needed to clear the remaining blades.

## CUSTOMER SERVICE

If you have a question about your blender, call our toll-free customer service number in the US:1-800-458-8407 and in Canada:1-800-667-8623. Before calling, please note the model, type, and serial numbers. These numbers can be found on the bottom of your blender. This information will help us answer your question much more quickly.

# 1-YEAR LIMITED WARRANTY

Sunbeam Products, Inc., doing business as Jarden Consumer Solutions, or if in Canada, Sunbeam Corporation (Canada) Limited, doing business as Jarden Consumer Solutions, (collectively "JCS") warrants that for a period of one year from the date of purchase, this product will be free from defects in material and workmanship. JCS, at its option, will repair or replace this product or any component of the product found to be defective during the warranty period. Replacement will be made with a new or remanufactured product or component. If the product is no longer available, replacement may be made with a similar product of equal or greater value. This is your exclusive warranty from JCS.

This warranty is valid for the original retail purchaser from the date of initial retail purchase and is not transferable. Keep the original sales receipt. Proof of purchase is required to obtain warranty performance. JCS dealers, service centers, or retail stores selling JCS products do not have the right to alter, modify or any way change the terms and conditions of this warranty.

This warranty does not cover normal wear or damage resulting from any of the following: negligent use or misuse of the product, use on improper voltage or current, use contrary to the operating instructions, disassembly, repair or alteration by anyone other than JCS or an authorized JCS service center. Further, the warranty does not cover: Acts of God, such as fire, flood, hurricanes and tornadoes.

## WHAT ARE THE LIMITS ON JCS'S LIABILITY?

JCS shall not be liable for any incidental or consequential damages caused by the breach of any express, implied or statutory warranty or condition. Except to the extent prohibited by applicable law, any implied warranty or condition of merchantability or fitness for a particular purpose is limited in duration to the duration of the above warranty.

JCS disclaims all other warranties, or conditions or representations, express, implied, statutory or otherwise.

JCS shall not be liable for any damages of any kind resulting from the purchase, use or misuse of, or inability to use the product including incidental, special, consequential or similar damages or loss of profits, or for damages arising from any tort, including negligence or gross negligence, or fault committed by JCS, its agents or employees or for any breach of contract, fundamental or otherwise, or for any claim brought against purchaser by any other party.

Some provinces, states or jurisdictions do not allow the exclusion or limitation of incidental or consequential damages or limitations on how long an implied warranty lasts, so the above limitations or exclusions may not apply to you.

This warranty gives you specific legal rights, and you may also have other rights that vary from province to province, state to state or jurisdiction to jurisdiction.

## HOW TO OBTAIN WARRANTY SERVICE

### In the U.S.A.

If you have any question regarding this warranty or would like to obtain warranty service, please call 1-800-458-8407 and a convenient service center address will be provided to you.

### In Canada

If you have any question regarding this warranty or would like to obtain warranty service, please call 1-800-667-8623 and a convenient service center address will be provided to you.

In the U.S.A., this warranty is offered by Sunbeam Products, Inc., doing business as Jarden Consumer Solutions, located in Boca Raton, Florida 33431.

In Canada, this warranty is offered by Sunbeam Corporation (Canada) Limited, doing business as Jarden Consumer Solutions, located at 20B Hereford Street, Brampton, Ontario L6Y 0M1

**PLEASE DO NOT RETURN THIS PRODUCT TO ANY OF THESE ADDRESSES  
OR TO THE PLACE OF PURCHASE.**