

This Owner's Manual is provided and hosted by [Appliance Factory Parts](#).



# HAMILTON BEACH 70760 Owner's Manual

[Shop genuine replacement parts for HAMILTON  
BEACH 70760](#)



[Find Your HAMILTON BEACH Small Appliance Parts - Select From 252 Models](#)

----- Manual continues below -----

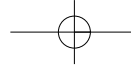

**READ BEFORE USE**  
**LIRE AVANT UTILISATION**  
**LEA ANTES DE USAR**

Visit [hamiltonbeach.com](http://hamiltonbeach.com) for delicious recipes, tips, and to register your product online!



Consultez [hamiltonbeach.ca](http://hamiltonbeach.ca) pour de délicieuses recettes, des conseils pratiques et pour enregistrer votre produit !

¡Visite [hamiltonbeach.com.mx](http://hamiltonbeach.com.mx) para recetas deliciosas, consejos, y para registrar su producto en línea!

**Questions?**

Please call us – our friendly associates are ready to help.  
USA: 1.800.851.8900

**Questions ?**

N'hésitez pas à nous appeler – nos associés s'empresseront de vous aider.  
CAN: 1.800.267.2826

**¿Preguntas?**

Por favor llámenos – nuestros amables representantes están listos para ayudar.  
MEX: 01.800.71.16.100

*Le invitamos a leer cuidadosamente este instructivo antes de usar su aparato.*



# Hamilton Beach

## Food Processor

### Robo Processor

### Procesador de Alimentos

English  
Français  
Español

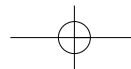

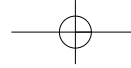

## IMPORTANT SAFEGUARDS

When using electrical appliances, basic safety precautions should always be followed, including the following:

1. Read and save all instructions.
2. To protect against risk of electrical shock, do not immerse base, motor, cord, or plug in water or other liquid.
3. Close supervision is necessary when any appliance is used by or near children.
4. This appliance should not be used by children.
5. Unplug cord from outlet when not in use, before putting on or taking off parts, and before cleaning.
6. Avoid contacting moving parts.
7. Do not operate any appliance with a damaged cord or plug or after the appliance malfunctions or is dropped or damaged in any manner. Call our toll-free customer service number for information on examination, repair, or electrical or mechanical adjustment.
8. The use of attachments not recommended or sold by the appliance manufacturer, may cause fire, electric shock, or injury.
9. Do not use your food processor if any part is broken.
10. Do not use appliance outdoors.
11. Do not let cord hang over edge of table or counter, or touch hot surfaces.
12. Keep hands and utensils away from moving blade and disc while processing food to reduce the risk of severe personal injury and/or damage to the food processor. A rubber scraper may be used but ONLY when the food processor is not running.
13. The blade and disc are sharp. Handle carefully. Store out of reach of children.
14. To reduce the risk of injury, never place cutting blade or disc on base without first putting bowl properly in place.
15. Be certain lid is securely locked in place before using.
16. Never feed food into food chute by hand. Always use pushers.
17. Do not attempt to defeat the lid interlock mechanism.
18. Make sure the blade or disc has come to a full stop before removing lid.
19. To reduce the risk of injury, be sure to insert the disc using hubs provided for this purpose. Use the correct hub when removing blade and disc from the bowl, when cleaning the bowl, and when cleaning.
20. Be sure to turn switch to OFF position after emptying the pushers to clear the food chute. When the food chute is empty, turn the motor off and disassemble unit to remove remaining food.
21. The appliance is not intended for commercial or industrial use. It is designed and built exclusively for home use only.
22. Never use appliance for a longer period or with more than the recommended ingredients other than that recommended by the manufacturer.
23. The maximum rating of this unit is based on the maximum mixing blade. Using the slicing/shredding disc will result in a significantly less power.
24. Do not place on or near a hot gas or electric oven.
25. Do not use appliance for other than intended use.

## SAVE THESE INSTRUCTIONS!

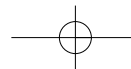

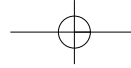

## OTHER CONSUMER SAFETY INFORMATION

**This appliance is intended for household use only.**

**WARNING!** Shock Hazard: This appliance has a polarized plug (one wide blade) that reduces the risk of electric shock. The plug fits only one way into a polarized outlet. Do not defeat the safety purpose of the plug by modifying the plug in any way or by using an adapter. If the plug does not fit, reverse the plug. If it still does not fit, have an electrician replace the outlet.

The length of the cord used on this appliance will reduce the hazards of becoming tangled in or tripping over the cord. If a longer cord is necessary, an approved extension cord should be used. The electrical rating of the extension cord should be greater than the rating of the appliance. Care must be taken to secure the extension cord so that it will not drape over the top where it can be pulled on by children or accidentally damaged.

To avoid an electrical circuit overload, do not use a power cord for this appliance on the same circuit with your food processor.

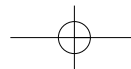
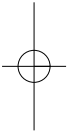

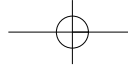

# Parts and Features

**Before First Use:** Unpack processor. Handle blade and disc(s) carefully; they are very sharp. Wash all parts except base in hot, soapy water. Rinse, then dry. These parts can also be placed in the top rack of a dishwasher.

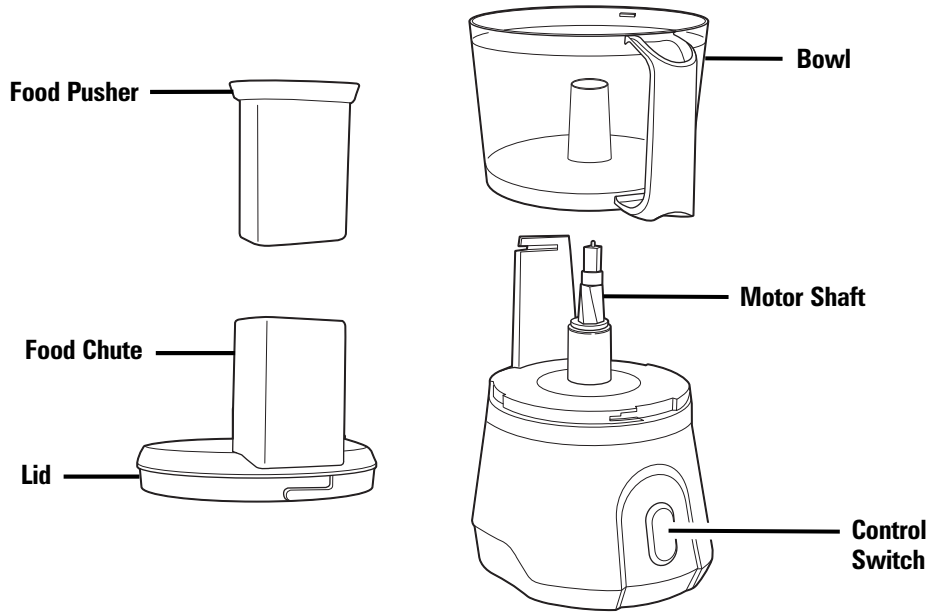

**Chopping**  
Use to coarsely chop, knead, mix



**Reversible Slicing**  
Use to shred cheese, slice, and cut a variety of foods including pepperoni, carrots

**OPTIONAL**  
**French Crinkle Cutter**  
To order call  
1.800.848.1234  
hamilton  
1.800.267.1234  
hamilton

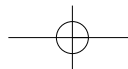

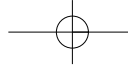

# How to Use Chopping/Mixing Blade

**⚠ WARNING** Laceration carefully; it

Make sure control switch is turned to **OFF** and unit is unplugged. **NOTE:** Operate using only one blade or disc at a time.

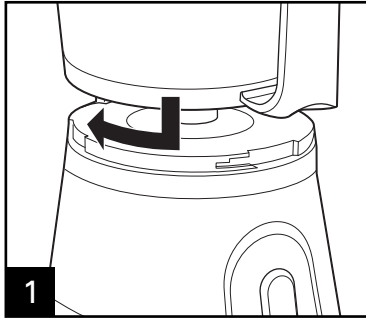

**1**

Align bowl and base. Turn bowl clockwise to lock into place. **NOTE:** Unit will not work unless bowl is locked.

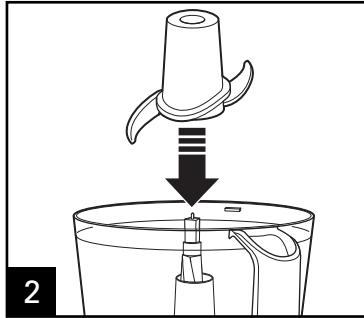

**2**

Carefully place blade onto motor shaft.

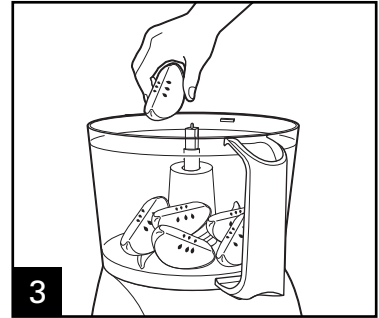

**3**

**4**

Align lid and

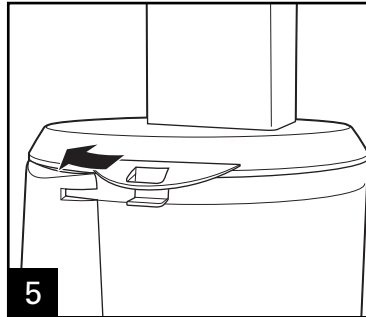

**5**

Turn lid clockwise to lock into place. **NOTE:** Unit will not work unless lid is locked.

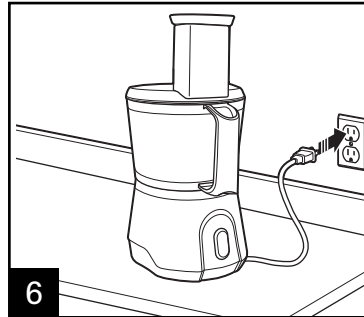

**6**

Place food pusher in food chute. **Always use food pusher to feed food into the chute. NEVER PUSH FOOD THROUGH CHUTE WITH HANDS.**

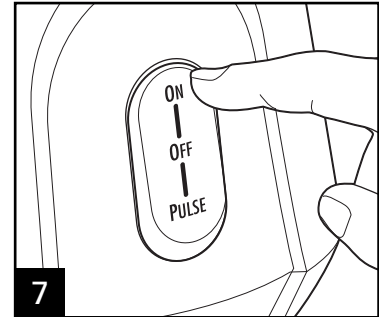

**7**

Select **ON** or **PULSE** on control switch. **ON:** Processor will run continuously. **PULSE:** For instant on and off control.

**8**

When finished unplug.

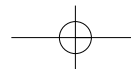

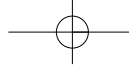

## How to Use Chopping/Mixing Blade (cont.)

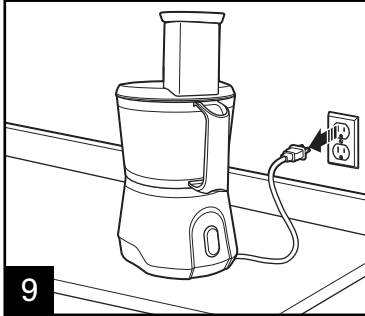

**WARNING!** Laceration Hazard:  
Always wait until blade has  
stopped moving before removing  
lid.

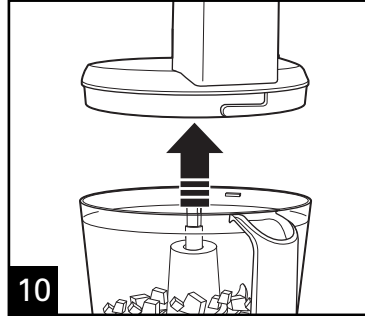

Always remove the lid before  
removing bowl to avoid possible  
damage to the appliance.

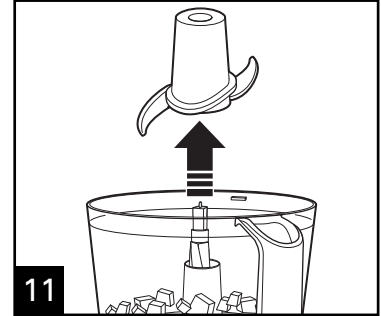

Carefully remove blade from  
motor shaft.



12

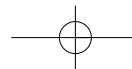
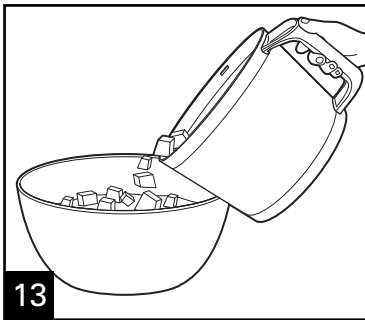

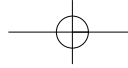

# How to Use Slicing/Shredding Disc

**⚠ WARNING** Laceration carefully; it

Make sure control switch is turned to **OFF** and unit is unplugged. **NOTE:** Operate using only one blade or disc at a time.

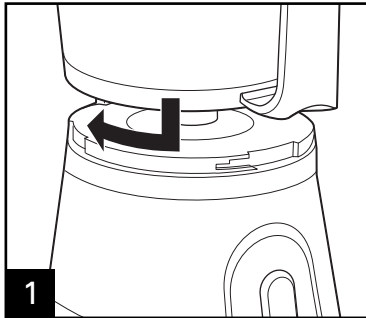

**1** Align bowl and base. Turn bowl clockwise to lock into place. **NOTE:** Unit will not work unless bowl is locked.

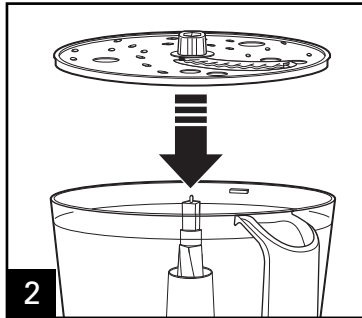

**2** Carefully place disc onto motor shaft with desired side (Slice or Shred is stamped on each side of the blade) facing UP.

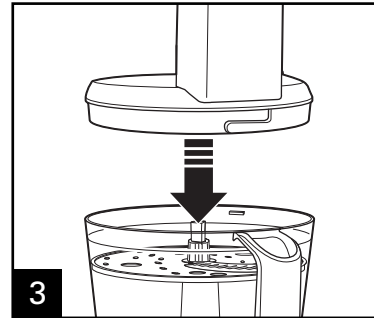

**3** Align lid and bowl.

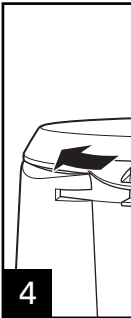

**4** Turn lid clockwise to lock in place. **NOTE:** unless lid is

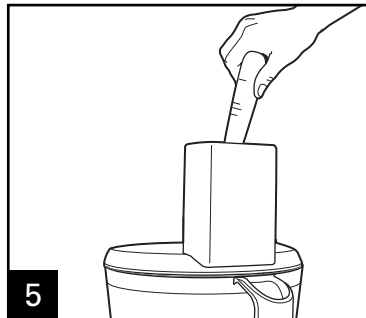

**5** Cut food to fit food chute. Fill chute with food.

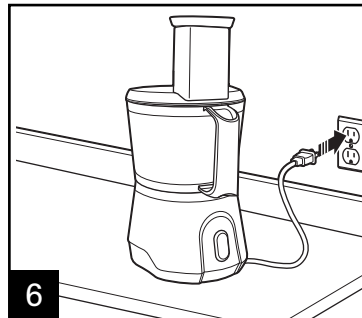

**6**

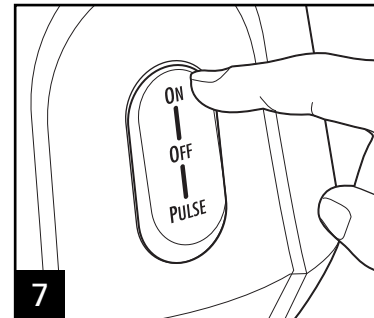

**7** Select **ON** or **PULSE** on control switch. **ON:** Processor will run continuously, **PULSE:** For instant on and off control.



**8** Always use food pusher to push food into the chute. **FOOD THROUGH HANDS.**

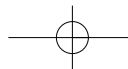

## How to Use Slicer/Shredder Disc (cont.)

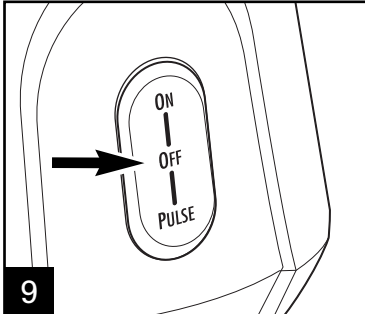

**9** When finished, turn to **OFF** and unplug.

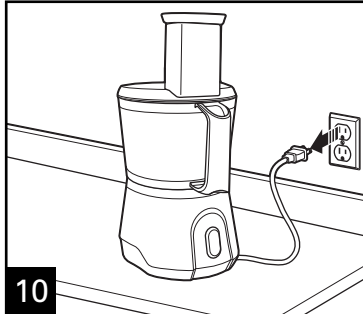

**10** **WARNING! Laceration Hazard:** Always wait until blade has stopped moving before removing lid.

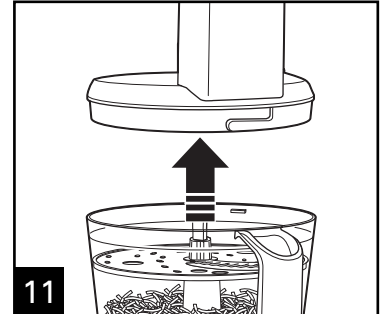

**11** Always remove the lid before removing bowl to avoid possible damage to the appliance.



**12** Carefully remove the bowl from the motor shaft.

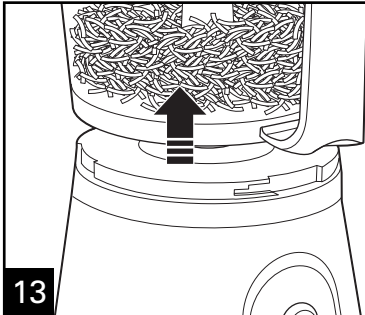

**13**

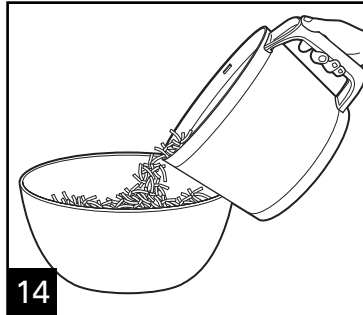

**14**

## Tips and Techniques

- For a more uniform consistency, start with pieces of food that are similar in size. Cut food into 1-inch (2.5-cm) pieces before processing with chopping/mixing blade and leave room in the bowl for the food to be tossed around.
- This food processor is excellent to chop, mix, slice, or shred most foods. However, to maintain peak performance, do not use your food processor for the following: grinding grain, coffee beans, or spices; slicing frozen meat; or crushing ice.
- When chopping foods, pulsing on and off will produce the best results.
- Operating time will depend on quantity of food being processed. Most foods can be sliced, chopped, or shredded in seconds. If unit is operated for 2 minutes continuously, let the processor rest about 4 minutes before continuing.
- Do not puree or mash starchy vegetables like potatoes as they are easily overprocessed and will turn gummy.
- To slice or shred cheese, select firm cheese like cheddar, Monterey Jack, or Swiss. For best results, process cheese that is well-chilled.
- The reversible slicing/shredding disc has a slicing blade on one side and shredding teeth on the other. The name stamped on the blade, facing up, is the function selected. Place on motor shaft with desired cutting edge facing up.
- To julienne vegetables, slice and then remove from bowl. Restack the vegetables. Pack into food chute with slices vertical. Slice again to make matchstick-cut vegetables.

## Processing Charts

Disc attachments are reversible and labeled. Turn UP for the desired function. When using disc attachment, do not process past the MAX LEVEL on the bowl.

ATTACHMENT	FOODS
Chopping/Mixing Blade	Chop: nuts, meat, garlic, herbs, bread (for crumbs) Mince/Puree: vegetables Mix: salad dressings Puree: soups, sauces Grate: cheese such as Parmesan
Slicing Disc (slicing side facing UP)	Cucumbers, apples, mushrooms, cabbage, tomatoes, peppers, firm cheeses (chilled)
Shredding Disc (shredding side facing UP)	Cabbage, potatoes, carrots

For best results do not exceed the following amounts when chopping, mincing, or pureeing with the chopping/mixing blade.

FOOD	MAXIMUM AMOUNT
Fruits and Vegetables	2 to 3 cups (500 ml to 750 ml) (cut in 1" [2.5-cm] cubes)
Meats	1 lb. (450 g) (cut in 1" [2.5-cm] cubes)
Parmesan or Romano	5 ounces (140 g) (cut in 1" [2.5-cm] cubes)
Cheddar, Jack, Mozzarella	8 ounces (226 g) (cut in 1" [2.5-cm] cubes)
Crackers	10 cups (2.3 L) (can fill bowl)

## Cleaning and Care

**⚠ WARNING**

**Electrical Shock Hazard.**

Disconnect power before cleaning. Do not immerse or base in any liquid.

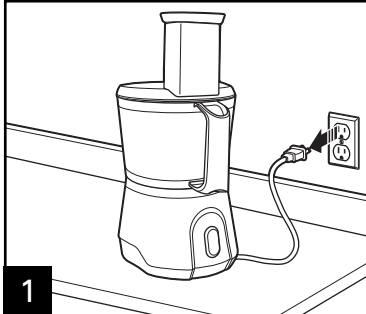

**1**

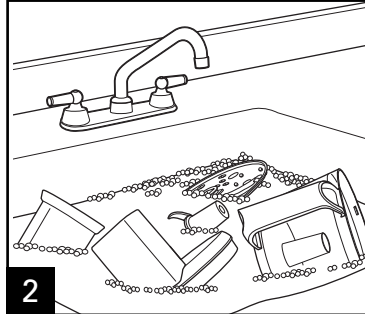

**2**

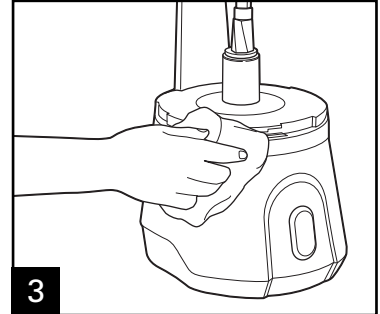

**3**

Wipe base, control switch, and cord with a damp cloth or sponge. To remove stubborn soil, use a mild nonabrasive cleanser.



**DISHW**

## Space-Saving Storage

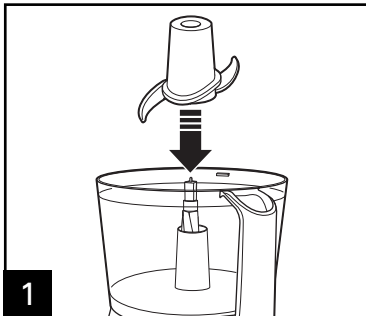

**1**

Place chopping/mixing blade on motor shaft.

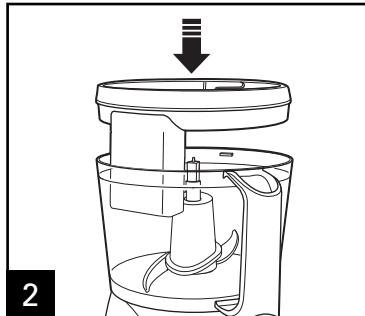

**2**

Flip lid upside down and place in bowl.

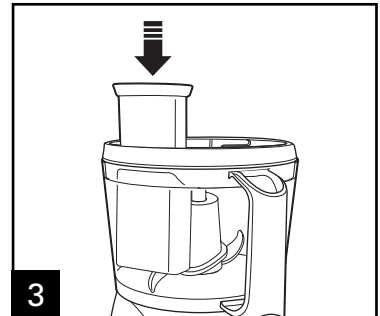

**3**

Place food pusher in food chute.



**4**

Slide slicing motor shaft. **CAUTION!** Store sliding slicing side c

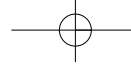

# Troubleshooting

## POTENTIAL PROBLEM

## PROBABLE CAUSE

**Unit does not operate on any speed or Pulse.**

- Is the unit plugged in? Does the outlet work?
- Are the bowl and lid locked in place? See How to Use sections.

**Food is not sliced or shredded uniformly.**

- Packing too much food in the food chute or pushing too hard on the food pushers may cause processed food to be irregularly sliced or shredded. Refer to the food processing charts for recommended sizes and quantities.

**Unit stops and will not come back on.**

- Are the bowl and lid locked in place? They may have moved slightly during processing. See the How to Use section.
- Is the outlet still working? Check it by plugging in a working lamp or other appliance. If the outlet is overloaded, it may have blown a fuse or tripped the circuit breaker.
- Turn unit OFF, allow to stand for 3 to 4 minutes, and then turn back ON. If none of these steps correct the problem, DO NOT attempt to repair the unit. Call the Customer Service number or the name of your nearest Authorized Service Center.

**Unit has a burning smell.**

- There may be a residue left on the motor from the manufacturing process, causing a burning smell during initial use. This will go away. If a strong odor or any visible smoke appears, turn the unit OFF and IMMEDIATELY call the Customer Service number.

**Motor seems weak.**

- Are you using the recommended food size and quantity to be processed? Refer to the Food Processing Charts for recommended food sizes and speeds.

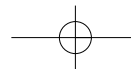
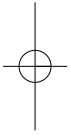

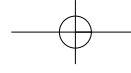

## Limited Warranty

This warranty applies to products purchased in the U.S. and Canada. This is the only express warranty for this product and any other warranty or condition.

This product is warranted to be free from defects in material and workmanship for a period of one (1) year from the purchase. During this period, your exclusive remedy is repair or replacement of this product or any component found to be defective at our option; however, you are responsible for all costs associated with returning the product to us and our return shipping costs. If a component under this warranty to you. If the product or component is no longer available, we will replace with a similar or greater value.

This warranty does not cover glass, filters, wear from normal use, use not in conformity with the printed directions, or damage to the product resulting from accident, alteration, abuse, or misuse. This warranty extends only to the original consumer purchaser. Keep the original sales receipt, as proof of purchase is required to make a warranty claim. This warranty is not valid if used for other than single-family household use.

We exclude all claims for special, incidental, and consequential damages caused by breach of express or implied warranty. The amount of the purchase price. **Every implied warranty, including any statutory warranty or condition of merchantability or fitness for a particular purpose, is disclaimed except to the extent prohibited by law, in which case the implied warranty or condition is limited to the duration of this written warranty.** This warranty gives you specific legal rights. Other legal rights that vary depending on where you live. Some states or provinces do not allow limitations on implied warranties, so the foregoing limitations may not apply to you.

To make a warranty claim, do not return this appliance to the store. Please call 1.800.851.8900 in the U.S. or 1.800.235.8900 in Canada or visit [hamiltonbeach.com](http://hamiltonbeach.com) in the U.S. or [hamiltonbeach.ca](http://hamiltonbeach.ca) in Canada. For faster service, locate the model, type, and serial number on your appliance.

