

This Owner's Manual is provided and hosted by [Appliance Factory Parts](#).



# HAMILTON BEACH 62676 Owner's Manual

[Shop genuine replacement parts for HAMILTON  
BEACH 62676](#)



[Find Your HAMILTON BEACH Small Appliance Parts - Select From 252 Models](#)

----- Manual continues below -----

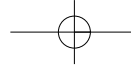

**READ BEFORE USE**  
**LIRE AVANT D'UTILISER**  
**LEA ANTES DE USAR**

Visit [hamiltonbeach.com](http://hamiltonbeach.com) for  
delicious recipes, tips, and to register  
your product online!



Consulter [hamiltonbeach.ca](http://hamiltonbeach.ca) pour les  
recettes délicieuses, conseils pratiques,  
et pour enregistrer votre produit !

¡Visite [hamiltonbeach.com.mx](http://hamiltonbeach.com.mx) para  
recetas deliciosas, consejos, y para  
registrar su producto en línea!

**Questions?**

Please call us – our friendly  
associates are ready to help.  
USA: 1.800.851.8900

**Questions ?**

N'hésitez pas à nous appeler –  
nos associés s'empresseront  
de vous aider.  
CAN : 1.800.267.2826

**¿Preguntas?**

Por favor llámenos – nuestros  
amables representantes están  
listos para ayudar.

**MEX: 01 800 71 16 100**

*Le invitamos a leer cuidadosamente  
este instructivo antes de usar su  
aparato.*

# Ham Hand Batteur Batidora a

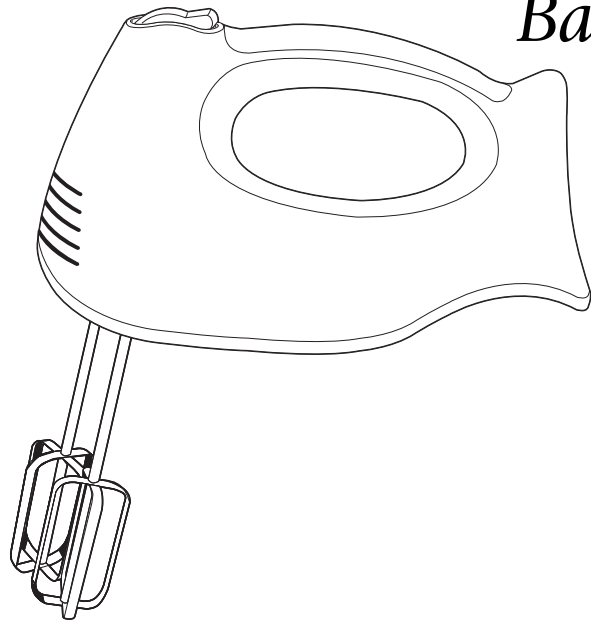

Engl  
Fran  
Espa

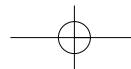

## IMPORTANT SAFEGUARDS

When using electrical appliances, basic safety precautions should always be followed to reduce the risk of fire, electric shock, or injury to persons, including the following:

1. Read all instructions.
2. To protect against risk of electrical shock, do not put cord, plug, or mixer body in water or other liquid.
3. Close supervision is necessary when any appliance is used by or near children.
4. Unplug from outlet when not in use, before putting on or taking off parts, and before cleaning.
5. Avoid contacting moving parts. Keep hands, hair, and clothing, as well as spatulas and other utensils, away from beaters during operation to reduce risk of injury to persons and/or damage to mixer.
6. Remove beaters from mixer before washing.
7. Do not let cord hang over edge of table or counter.
8. Do not let cord contact hot surfaces, including the stove.
9. Do not operate any appliance with a damaged cord, plug, or power source. If the appliance malfunctions or is dropped, do not use it until it has been repaired in a safe manner. Call our toll-free customer service number for more information on examination, repair, or electrical or mechanical service.
10. The use of attachments not recommended by the appliance manufacturer for use with this model may cause electric shock, or injury.
11. Do not use outdoors.
12. Do not place on or near a hot gas or electric oven.
13. Check that control is off before plugging cord into a wall outlet. Disconnect, turn control to **O** (OFF) and then plug into wall outlet.
14. Do not use appliance for other than intended purposes.

## SAVE THESE INSTRUCTIONS!

### OTHER CONSUMER SAFETY INFORMATION

**This appliance is intended for household use only.**

**WARNING! Shock Hazard:** This appliance has a polarized plug (one wide blade) that reduces the risk of electric shock. The plug fits only one way into a polarized outlet. Do not defeat the safety purpose of the plug by modifying the plug in any way or by using an adapter. If the plug does not fit, reverse the plug. If it still does not fit, have an electrician replace the outlet.

The length of the cord used on this appliance was selected to reduce the hazards of becoming tangled in or tripping over a longer cord. If a longer cord is necessary, an approved extension cord may be used. The electrical rating of the extension cord must be equal to or greater than the rating of the appliance. Care must be taken to

arrange the extension cord so that it will not drape over the top or tabletop where it can be pulled on by children or tripped over.

#### **CAUTION! Moving Parts Hazard.**

To reduce the risk of personal injury, always unplug the appliance before inserting or removing beaters.

#### **WATTAGE/PEAK POWER INFORMATION**

The marked rating of the hand mixer is determined by UL Laboratories as the maximum stabilized power consumed by the hand mixer at high speed under a loaded condition. Peak power is an average of the maximum wattage consumed during initial operation at high speed.

# Parts and Features

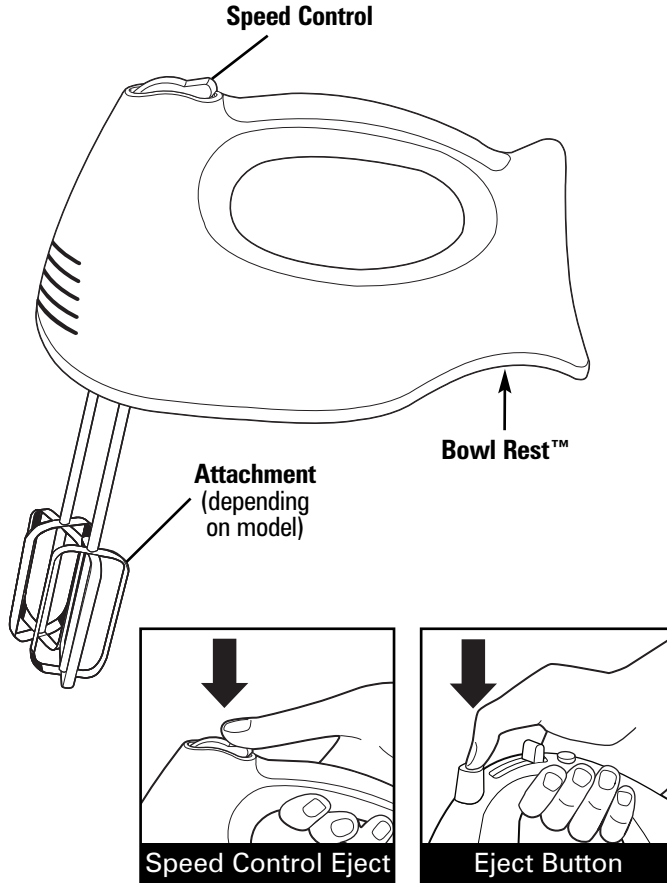

## General Mixing Guide

The following mixing guide is a suggestion of speeds for 6-speed mixers. Begin on speed 1 and increase to the desired speed depending on the recipe contents.

SPEED	FUNCTION
0	OFF and/or Eject
1	<b>LOW</b> speed for folding or mashing; muffins, or quick breads
2	To cream butter and sugar; mashing
3	<b>MEDIUM</b> speed for most pastries
4	Frosting and mashed potatoes
5	Beating egg whites; kneading
6	<b>HIGH</b> speed for whipping cream

## Cookie Dough Mixing Guide

- Use a large mixing bowl so that the ingredients are mixed more easily.
- Butter and margarine should be at room temperature.
- Add flour one cup at a time, mixing thoroughly.
- Chips and nuts should be stirred by hand.

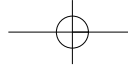

# Features Chart

Model number can be found on hand mixer or hand mixer carton.

\*Select models may have different or additional letter suffixes.

MODEL	ATTACHMENTS						STORAGE	
	FLAT	STRAIGHT WIRE	TWISTED WIRE	WHISK	MILK SHAKE	DOUGH HOOKS		
62630	✓			✓			Snap-On	Pre
62650	✓	✓		✓			Snap-On	Pr
62660R		✓		✓		✓	Suitcase	Pre
62670	✓			✓			None	Pr
62676			✓	✓	✓		Snap-On	Pr
62680R	✓						None	Pre
62682R	✓			✓			Snap-On	Pre
62683	✓			✓			Snap-On	Pre
62695N	✓	✓		✓			Snap-On	Pre
62695V	✓			✓			Snap-On	Pr

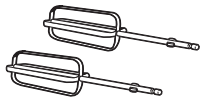

**Flat Beaters**  
(General Use)

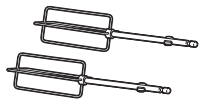

**Straight Wire Beaters**  
(General/Heavy Use)

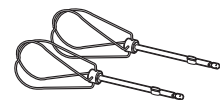

**Twisted Wire Beaters**  
(General Use)



**Whisk**  
(Whipping/Aerating)



**Milk Shake**  
(Ice Cream/Powdered Drink Mixes)



**Dough Hooks**  
(Mixing/Kneading)

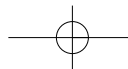

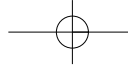

# How to Use Your Hand Mixer

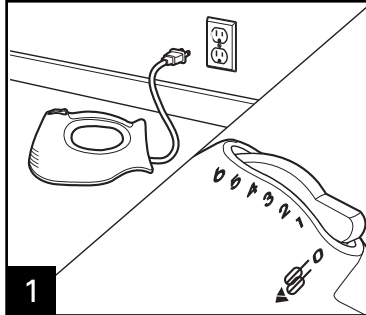

**1** Make sure mixer is unplugged and turned to **O** (OFF).

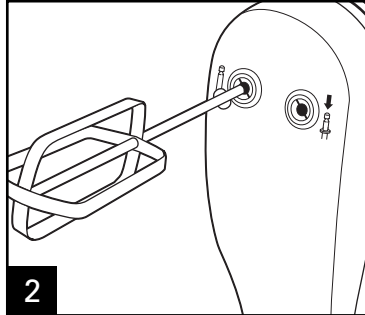

**2** Following diagrams on bottom of mixer, insert desired attachment(s) into proper openings on bottom of mixer. Push and click into place.

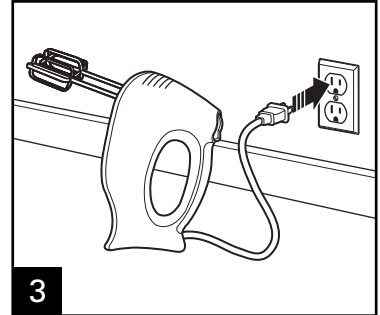

**3**



**4**

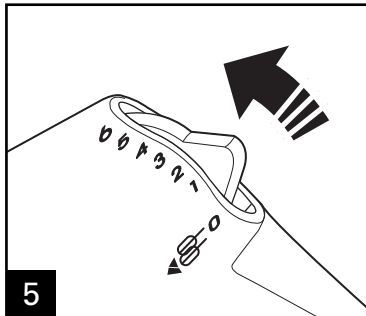

**5** Move speed control to desired speed. Start at 1 and increase speed as needed.

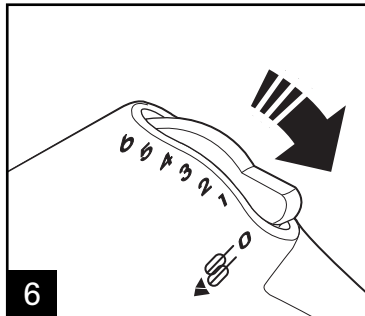

**6** When finished, turn speed control to **O** (OFF) and unplug mixer.

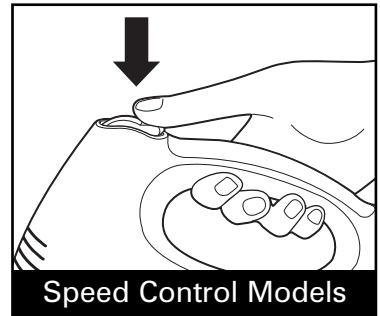

**Speed Control Models**

Push speed control to eject attachments.

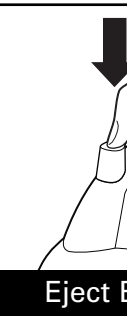

**Eject B**

Push eject b attachments

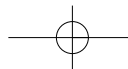

## *Additional Features*

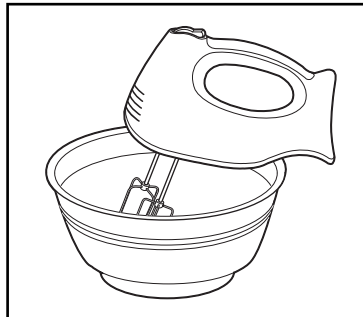
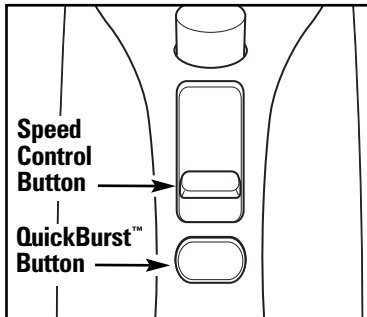

### **QuickBurst™**

Press and hold down the QuickBurst button for additional power at any speed.

**NOTE:** Do not use QuickBurst for more than two minutes at a time or motor may overheat.

### **Bowl Rest™**

Use the Bowl Rest while adding ingredients or checking a recipe. To use, TURN MIXER OFF; then set the mixer on the edge of the bowl.

Never use Bowl Rest when mixer is on.

Do not use Bowl Rest on small or plastic mixing bowls.

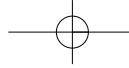

# Cleaning and Storage

**⚠ WARNING**

**Electrical Shock Hazard.** Disconnect power before cleaning. Do not immerse mixer, cord,

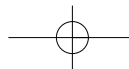
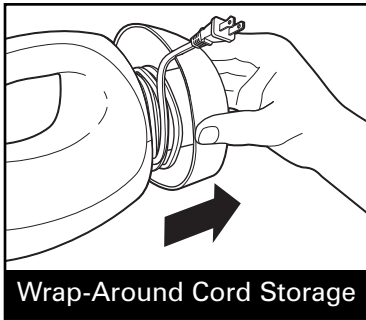
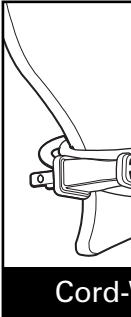
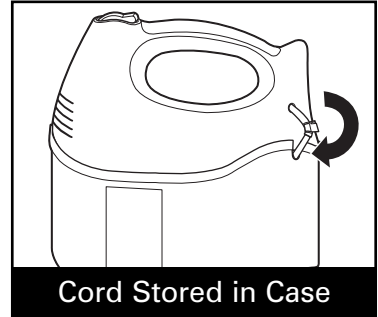
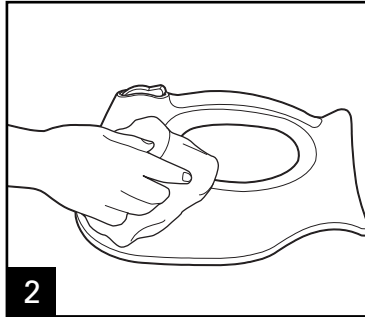
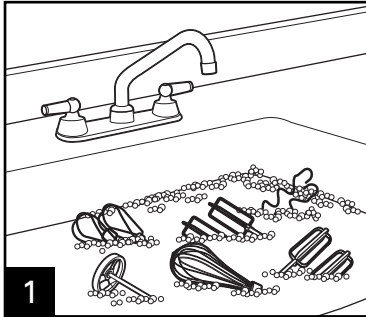

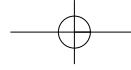

## Limited Warranty

This warranty applies to products purchased in the U.S. and Canada. This is the only express warranty for this product and any other warranty or condition.

This product is warranted to be free from defects in material and workmanship for a period of one (1) year from the date of purchase. During this period, your exclusive remedy is repair or replacement of this product or any component found to be defective at our option; however, you are responsible for all costs associated with returning the product to us and our return shipping charges. A component under this warranty to you. If the product or component is no longer available, we will replace with a similar or greater value.

This warranty does not cover glass, filters, wear from normal use, use not in conformity with the printed directions, or damage to the product resulting from accident, alteration, abuse, or misuse. This warranty extends only to the original consumer purchaser. Keep the original sales receipt, as proof of purchase is required to make a warranty claim. This warranty is not valid if used for other than single-family household use.

We exclude all claims for special, incidental, and consequential damages caused by breach of express or implied warranty. The amount of any award is limited to the amount of the purchase price. **Every implied warranty, including any statutory warranty or condition of sale, is limited to the duration of this written warranty.** This warranty gives you specific legal rights. You may have other legal rights depending on where you live. Some states or provinces do not allow limitations on implied warranties or special, incidental, or consequential damages, so the foregoing limitations may not apply to you.

To make a warranty claim, do not return this appliance to the store. Please call 1.800.851.8900 in the U.S. or 1.800.235.8900 in Canada or visit [hiltonbeach.com](http://hiltonbeach.com) in the U.S. or [hiltonbeach.ca](http://hiltonbeach.ca) in Canada. For faster service, locate the model, type, and serial number on your appliance.

