

This Owner's Manual is provided and hosted by [Appliance Factory Parts](#).



# CUISINART CSB-78 Owner's Manual

[Shop genuine replacement parts for CUISINART  
CSB-78](#)



[Find Your CUISINART Small Appliance Parts - Select From 213 Models](#)

----- Manual continues below -----

# Cuisinart®

INSTRUCTION BOOKLET

Recipe  
Booklet  
Reverse Side



## Cordless Rechargeable Hand Blender

CSB-78

For your safety and continued enjoyment of this product, always read the instruction book carefully before using.

---

## CONTENTS

Important Safeguards . . . . .	2
Features and Benefits . . . . .	4
Before You Begin . . . . .	5
Assembly . . . . .	5
Operation . . . . .	8
Charging & Battery Life . . . . .	10
Storage Stand / Wall Brackets . . . . .	11
Cleaning . . . . .	12
Disposal / Recycling of Batteries . . . . .	12
Warranty . . . . .	13
Template for Wall Mount Storage . . . . .	14

## IMPORTANT SAFEGUARDS

When using an electrical appliance, basic safety precautions should always be followed, including the following:

1. READ ALL INSTRUCTIONS.
2. To protect against electrical shock, do not put the charger handle or motor body of this hand blender in water or other liquid. The drive shaft of this appliance, where blades are interchanged, has been designed for submersion in water or other liquids. Never submerge any other portion of this unit. If hand blender falls into liquid, remove immediately. Carefully remove, clean and dry unit thoroughly before continuing.
3. This appliance should not be used by children. To avoid possible accidental injury, close supervision is necessary when any appliance is used by or near children.
4. Do not operate in the presence of explosive and/or flammable fumes.
5. To avoid possibility of personal injury, always detach the charger handle from the motor body before attaching or removing blades and/or attachments.
6. Unplug charger handle from outlet when not in use, before putting on or taking off parts and before cleaning.
7. Avoid contact with moving parts. Keep hands, hair, clothing, as well as spatulas and other utensils away from attachments and mixing container during operation to reduce risk of injury to persons, and/or damage to the appliance. A spatula may be used, but must be used only when the unit is not operating.
8. Remove detachable shaft from the blender before washing the blades or shaft.
9. **Blades are SHARP. Handle carefully when removing, inserting or cleaning the blending shaft and chopper attachment.**
10. When mixing liquids, use a tall container or make small quantities at a time to reduce spillage and possibility of injury.
11. Charger handle should be plugged into an electrical outlet away from sink or hot surfaces.
12. Do not use an extension cord. Plug charger handle directly into an electrical outlet.
13. Do not attempt to use this charger handle with any other product. Also, do not attempt to charge the batteries with any other charger.
14. Do not use appliance for other than intended use.
15. Do not charge batteries with handle charger plugged into an outdoor outlet.
16. Do not operate any appliance with a damaged cord or plug, or after the appliance has malfunctioned or has been dropped or damaged in any way, or is not operating properly. Return the appliance to the nearest Cuisinart Repair Center for examination, repair, or mechanical or electrical adjustment.
17. The use of attachments or accessories not recommended by Cuisinart may cause fire, electrical shock or risk of injury.
18. Make sure the appliance is OFF and the motor has stopped completely before putting on or taking off attachments, and before cleaning.
19. This appliance is intended for household use only and not for commercial or industrial use.

---

## **SAVE THESE INSTRUCTIONS FOR HOUSEHOLD USE ONLY**

20. Do not use this hand blender for other than intended use of preparing foods and beverages.
21. Use care when stirring hot liquids, to avoid splattering.
22. To reduce the risk of fire or electric shock, do not operate any heating appliance beneath the mounted charging handle unit.
23. Do not mount the storage bracket/unit over or near any portion of a heating or cooking appliance, or a sink or wash basin.
24. Unplug the charger handle from the outlet before attempting any routine cleaning of the charger handle.
25. Do not operate a damaged charger. Have damaged charger replaced immediately.
26. Do not incinerate the hand blender, even if it is severely damaged. The batteries can explode in a fire.
27. This product contains nickel cadmium batteries which must be recycled at the end of the life of the hand blender and disposed of properly. (See Disposal / Recycling of Batteries, page 12.) Do not incinerate or compost batteries, as they will explode at high temperatures.
28. Leaks from battery cells can occur under extreme conditions. If the liquid, which is a 20-35% solution of potassium hydroxide, gets on the skin, (1) wash quickly with soap and water or (2) neutralize with a mild acid such as lemon juice or vinegar. If the liquid gets into eyes, flush them immediately with clean water for a minimum of 10 minutes. Seek medical attention.
29. To reduce the risk of injury, never place chopper/grinder attachment cutting blade on base without first putting prep bowl properly in place.
30. Be certain the chopper/grinder attachment cover is securely locked in place before operating appliance. Do not attempt to remove cover until blade has stopped rotating.
31. Check prep bowl for presence of foreign objects before using.

## FEATURES AND BENEFITS

### 1. Cordless Operation

No cord! Operates on battery power.

### 2. Three Stages Snap Together Easily

Disassemble for compact storage, either separately or together in storage stand.

#### a. Charger Handle

Batteries are in the handle. Release button allows this combination handle and charger to detach from main motor body. Plug extends from handle to plug charger into wall socket.

#### b. Motor Body

Contains powerful DC motor.

#### c. Detachable Shaft

Release button allows shaft to detach from motor body for easy cleaning in dishwasher or under running water from faucet.

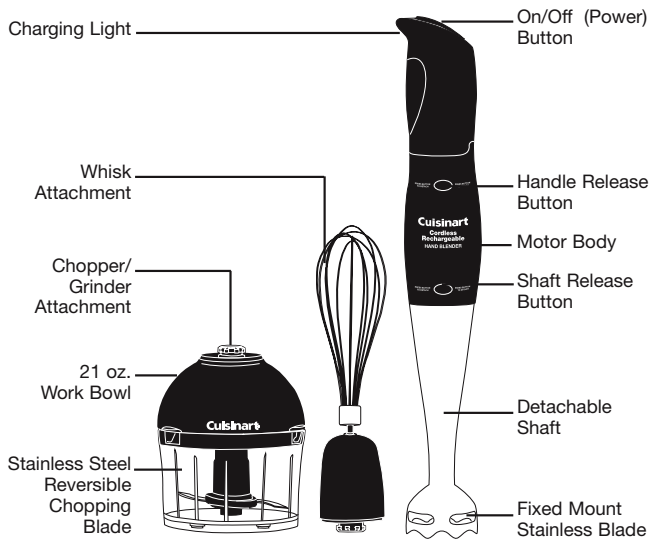

### 3. Easy-to-Recharge Batteries

Runs up to 20 minutes under normal use (depending on specific uses) and regains over half of full power within 3 hours. Full charge in 12 to 24 hours. Normal time required for a blending task is 10 seconds to 2 minutes.

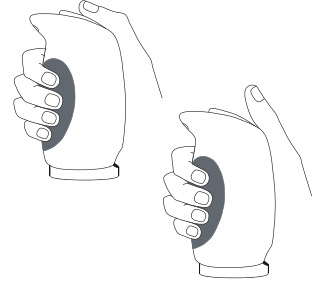

### 4. Maximum Comfort Handle

The hand blender handle and power button are designed around the way you actually hold a stirring utensil. The shape of this handle gives you comfortable control and easy access to the power button. Rubberized handle gives better grip, especially when your hands are wet.

### 5. One Step ON/OFF (Power) Button

Press and hold the rubberized power button to operate blender. Release button to stop motor.

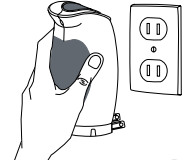

### 6. Plug-In Charger with Charging Light

Plugs into wall outlet to recharge the batteries. Charging light is on to let you know the outlet is in operation and batteries are recharging. Light remains on when charging is completed. Detach charger handle from motor body with release button, slide wall plug out of housing, and plug directly into wall outlet. No cords necessary.

### 7. Detachable Shaft

Easy to use, easy to clean and easy to store. Detach from motor body by pressing release button.

### 8. Blending Attachment with Stainless Steel Blade and Blade Guard

This attachment easily snaps into the motor body housing. The stainless blade is partially covered by a stainless housing that keeps splashing to a minimum.

## 9. Whisk Attachment

### Attachment

Whisk attachment snaps into the motor body housing. This attachment is great for whipping cream, egg whites and other delectable treats.



## 10. Chopper/Grinder Attachment

Chop, mince and grind with the Cuisinart® Chopper/Grinder attachment. Chopper/Grinder attaches to the blender motor body in place of the blender shaft or whisk attachment.

## 11. Long Running Time

The Cordless Rechargeable Hand Blender runs for 10 to 20 minutes during normal use with a full charge. Maximum usage time for most applications is only 1 to 2 minutes!

## 12. Convenient Storage

Storage stand is made of two pieces. One side holds the detachable shaft. The other holds the motor body, either with or without the charger handle attached. The 2 storage pieces snap together for compact countertop storage of the motor body and shaft. Detach and mount one section to the wall and hang the entire appliance from the wall as shown. The appliance can also be hung from the wall with charger handle detached. Use anchor and screws included with this appliance.

## 13. Easy To Clean

The Cuisinart® Cordless Rechargeable Hand Blender has a smooth surface that wipes clean instantly and easily.

## 14. Mixing/Measuring Beaker

See-through mixing beaker is marked in liters and cups for convenient measuring. Use for drinks, shakes, salad dressings, etc. Designed for easy gripping and drip-free pouring.

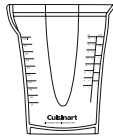

## 15. Detachable Blending Blade

Blade can be detached from shaft for cleaning. Blade can also be cleaned without detaching.

## BEFORE YOU BEGIN

Place the package containing the Cuisinart® Cordless Rechargeable Hand Blender on a sturdy surface. Unpack the hand blender from its box by removing the upper protective insert. Carefully remove each piece from the box.

**Note: The blending blade is extremely sharp. Use caution when removing and unpacking the storage stand. The blending blade is stored in the storage stand.**

Remove all support materials from the box and replace the upper insert. Save packaging for possible repacking of the unit.

Before using the Cuisinart® Cordless Rechargeable Hand Blender for the first time, we recommend that you wipe the unit with a clean, damp cloth to remove any dirt or dust. Dry it thoroughly with a soft, absorbent cloth. Handle carefully. Wash the blending blade, whipping disc, mixing beaker and detachable shaft by hand or in the dishwasher (upper rack only). Dry thoroughly before use. Read all instructions completely for detailed operating procedures.

**The batteries in your Cuisinart® Cordless Rechargeable Hand Blender have not been charged. Before the first use of this appliance, the batteries must be charged for 24 hours! See Charging and Battery Life on page 10.**

## ASSEMBLY

**Note: To avoid possibility of personal injury, always detach the charger handle from the motor body before attaching or removing attachments.**

### 1. Attach/detach blender shaft to motor body.

- Align blender shaft with motor body as shown in illustration. Push together until you feel and hear a click.
- To detach: Press the release button and pull the shaft away from the body. Do not grasp shaft around the blade or whipping disc.

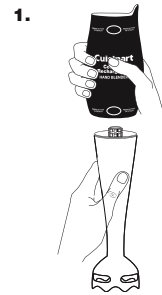

**2. Attach/Detach charger handle to motor body.**

- a. After batteries are fully charged, remove charger handle from wall socket. Push down on thumb grip and slide the plug to the retracted position inside the housing.
- b. Press the release button. Align two slots on bottom of charger with two tabs on top of motor body. Press together until you hear a click and the two sections fit together without gaps.
- c. To detach: Hold motor body firmly in one hand. Detach charger handle by pressing release button located at top of motor body, then pull charger handle away from motor body by lifting up with other hand.

Note: Detach the charger handle from the motor body after each use.

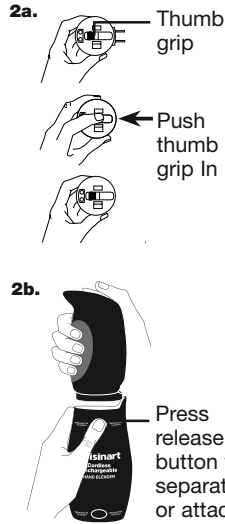

- A. Chopper/Grinder Prep Bowl
- B. Cover Slots (3) for Attaching Cover
- C. Metal Blade Assembly Shaft
- D. Rubber Feet
- E. Blade Assembly
- F. Blade Ring
- G. Plastic Blade Sheath
- H. Chopper/Grinder Cover
- I. Lift Tabs
- J. Chopper/Grinder Spline

**REVERSIBLE BLADE**

The Cuisinart® Cordless Rechargeable Hand Blender chopper/grinder attachment is equipped with a reversible blade. This blade is sharp on one side and blunt on the other. The blade is attached to a plastic ring which slides over the blade assembly shaft, remove the blade to reverse edges, so it can be easily turned over to select the appropriate blade. To remove this blade twist in a counterclockwise motion. A guide for proper blade selection follows in the section, Frequent Uses for Chopper/Grinder (page 9.)

Before you process any food, assemble the parts.

1. Place the prep bowl on a flat, dry, stable surface.
2. The metal blade assembly shaft is attached to the bottom of the prep bowl. If not already in place, slide the fully assembled blade assembly over the top of the blade assembly shaft.

To put together the blade assembly: Connect the blade ring (F) to the plastic blade sheath (G). Line up the blade ring opening with the plastic sheath. Let the blade ring slide to the bottom of the plastic sheath. **HOLD THE BLADE RING BY THE CENTRAL HUB HOLDING RIBS (grips) (K) ONLY. DO NOT TOUCH THE RAZOR-SHARP BLADES.**

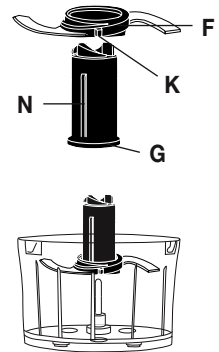

**CHOPPER/GRINDER ATTACHMENT**

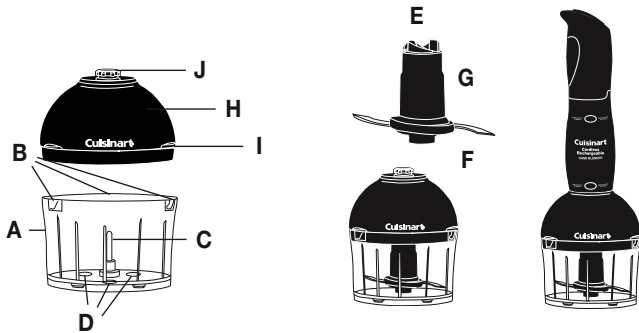

Note these important features of the blade ring. The blade ring can be placed over the plastic blade sheath in two different ways:

If you hold it as in figure A, you will see the word "Sharp" on the blade. Assemble the blade this side up to use the sharp edge. (See the section on processing food, page 9, for information about when to use the sharp edge.)

If you hold it as in figure B, you will see no writing on the blade. Assemble the blade this side up to use the blunt edge.

See the section on processing food, page 9, for information about when to use the blunt edge.

There are notches (C) on opposite sides of the interior of the hub. These fit over ridges on the sides of the plastic blade sheath.

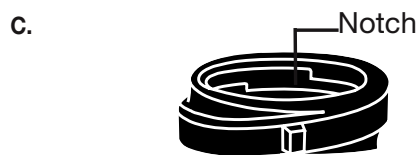
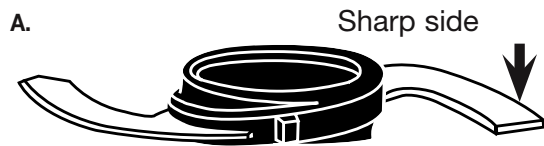

Pick up the blade ring by its hub holding ribs (grips) and line up the notches in the interior of the blade ring hub with the ridges on the sides of the plastic blade sheath. Let the blade ring slide down to the bottom of the plastic blade

sheath. The lower blade should almost touch the bottom of the prep bowl.

Lift the prep bowl, holding it firmly from the bottom. Pick up the blade ring by its hub holding ribs (grips) and turn it very slightly clockwise. This locks it in place on the plastic blade sheath and prevents it from sliding up during processing.

3. Connect the hand blender motor body to the top of the chopper/grinder attachment cover. Align the spline in the chopper/grinder cover's drive shaft with the ribbed opening on the underside of the motor body. When aligned properly, slide the two pieces together until they mate. You will feel and hear a slight click. It may be helpful to press the rubber release button when sliding these pieces together.

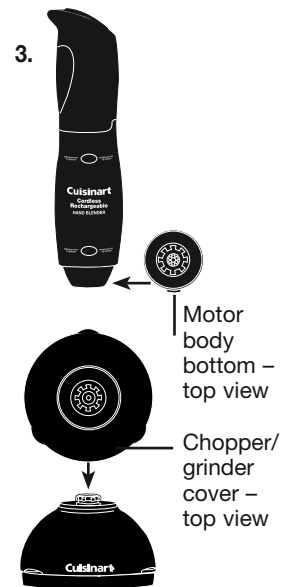

4. With the hand blender in place, locate the chopper/grinder cover and place it on top of the prep bowl.

- a. Be sure that the 3 ridges at the top of the blade assembly line up with the 3-arm propeller gear in the underside of the chopper/grinder cover, and that the cover is seated all around the top of the prep bowl.

- b. To properly seat the cover, you must line up the three molded pins from the cover with the 3 slots at the top of

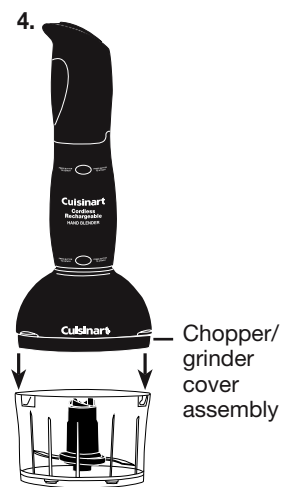

the prep bowl. Rotate cover counterclockwise to secure it to the prep bowl. Rotate the cover until the pins are in the far left position in the slots.

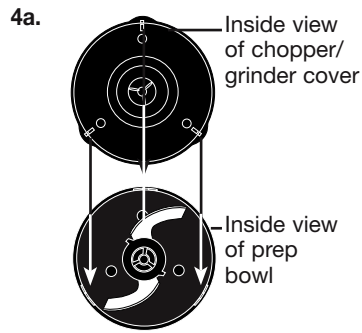

5. Place one hand on the cover of the chopper/grinder attachment, while gripping the hand blender motor body handle with the other. Press the On/Off button with your fingers to start the motor and run the chopper/grinder.

To turn the unit off, remove your fingers from the On/Off button.

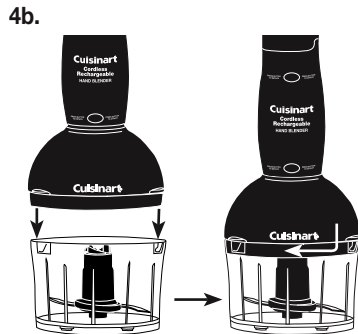

6. WHEN THE BLADE STOPS MOVING, remove the motor body from the chopper/grinder cover, and remove the cover from the prep bowl.

#### WHISK ATTACHMENT

1. Align the end of the whisk with the small opening of the whisk gearbox.
2. Push end into opening until it locks into position.
3. Align the motor body with the assembled whisk attachment and slide the pieces together until you hear and feel the pieces click together. It may be helpful to press the release button when assembling.



## OPERATION

### TURNING CORDLESS RECHARGEABLE HAND BLENDER ON/OFF

Keep hands, hair, clothing and other utensils away from blending blade.

Press and hold rubberized On/Off button on top of handle to turn motor On. The On/Off button is marked PRESS. The hand blender will continue to run as long as the switch is pressed in. To turn hand blender off, release On/Off button and the motor will stop.

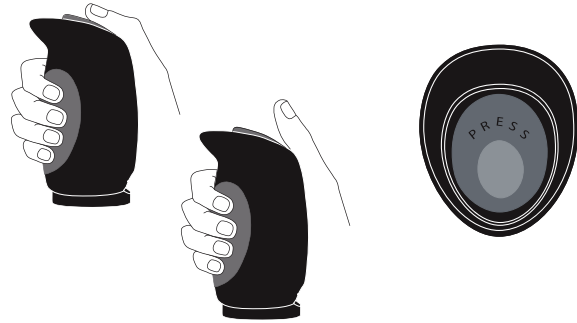

## BLENDING

### Blending & Mixing

The specially designed blade is for mixing and stirring all kinds of foods, including salad dressings, powdered drink products, and sauces. It is ideal for combining dry ingredients, and can be used to emulsify mayonnaise, too.

This blade mixes and stirs while adding only a minimum of air to your mixture. A gentle up-and-down motion is all you need to make the most flavorful, full-bodied liquid recipes. Be careful never to remove the hand blender from the liquid while in operation.

## WHISKING

1. Insert the whisk attachment into the motor body. (See, page 8.)
2. Place the whisk into mixture that will be blended.
3. Press and hold the On/Off button. The hand blender will continue to run as long as the switch is pressed in. To turn hand blender off, release the On/Off button and the motor will stop.

## CHOPPING AND GRINDING

### Processing Food

1. Place the prep bowl firmly on a flat sturdy surface like a countertop. Be sure the blade is assembled to use the blade edge that is appropriate for the food to be processed.
2. Place food in the prep bowl. Be sure the food is cut into small pieces, and the bowl is not overloaded.
3. Place the chopper/grinder cover on top of the prep bowl. Be sure the cover is properly seated.
4. Press the On/Off button on the hand blender.
5. Do not operate the chopper/grinder attachment for longer than 15 seconds at a time.

**Note: Due to the powerful motor provided with this unit, Cuisinart recommends using one hand to support the chopper/grinder during operation.**

6. When you have finished processing the food, stop the machine by taking your fingers off the On/Off button.
7. WHEN THE BLADE STOPS MOVING, remove the hand blender motor body from the chopper/grinder cover, and remove the cover from the chopper/grinder.
8. Carefully remove the blade assembly, holding it by the gripping ridges on the plastic sheath. NEVER TOUCH THE BLADE ITSELF.
9. Remove food with a spatula.

**Note: Do not operate the chopper/grinder attachment without food contents in the prep bowl.**

## FREQUENT USES FOR CHOPPER GRINDER

Ingredient	Comments
Baby foods (always consult pediatrician or family physician for appropriate food recommendations)	Place small amounts of cooked foods into chopper/grinder bowl. Add small amount of appropriate liquid. Use pulse action to chop, then continuous-hold action to blend.
Bread crumbs – fresh or dry (day old)	1 cup; Pulse to chop, then process until desired consistency is reached.
Hard cheese (Asiago, Locatelli, Parmesan, Romano, etc.) (Not recommended for softer cheeses unless making dip or dressing.)	Cut into ¼-inch pieces. Pulse to chop, then process until desired consistency is reached, no more than 1 ounce at a time.
Chocolate	Cut into ½-inch pieces; may chill in freezer for 3 minutes before chopping. Pulse to chop, then process, no more than 1 ounce at a time, until desired texture is reached.
Creamy Dressings/Dips	Place ingredients in chopper grinder bowl; do not cover or spill on stem. Pulse to chop, then process as needed to desired consistency.
Garlic	Peel cloves, up to 6 cloves. Pulse to chop.
Gingerroot (fresh)	Peel, cut into ½-inch pieces. Pulse to chop, ½ ounce (1-inch) at a time.
Herbs, fresh	½ cup; must be clean and dry. Pulse to chop.
Nuts	Shelled, toast first for best flavor. Pulse to chop, then process up to ½ cup at a time, until desired chop is reached from coarse to fine. May be processed to nut-butter stage.
Onion	Peel, cut into ½-inch pieces. Pulse to chop, up to ½ cup at a time (about 1 small onion), until desired chop is reached.
Vegetables (cooked)	Cut into ½-inch pieces and cook until fork tender. Pulse to chop, up to ½ cup at a time. May need to add cooking liquid, stock or milk to process to a vegetable purée. Not recommended for mashed potatoes.
Vegetables (uncooked)	Peel as needed, cut into ½-inch pieces. Peel celery with vegetable peeler to remove tough strings. Pulse to chop ½ cup at a time.
Meat (Beef, Pork - Cold)	2.5 oz or 75g, cut into ½-inch pieces.

## CHARGING & BATTERY LIFE

Your Cuisinart® Cordless Rechargeable Hand Blender is equipped with nickel cadmium batteries. We have selected these batteries to give you maximum life and long running times, as well as rapid recharging times.

If you run your batteries down completely, it will take between 12 and 24 hours to completely recharge them. They will be over 50% charged after only 3 hours. Normally, you will not run them down completely. The normal running time with a full charge varies depending on what you are blending, but you can expect up to 20 minutes. The maximum time for most mixing tasks is up to 2 minutes.

## CHARGING PROCEDURES

When brand new, the Cuisinart® Cordless Rechargeable Hand Blender is not fully charged. Plug the charger handle into the electrical socket and leave it plugged in for 24 hours to insure maximum operating capability. For best performance, fully discharge and recharge the battery 3 times before first use.

### TO CHARGE

Detach charger handle from motor body. Turn charger handle upside down. Using the thumb grip on the underside of the charger handle, push down slightly and slide the plug as far as it will go until it is fully exposed and extending from the handle housing (see illustration). Plug the prongs into a wall outlet. The batteries will begin charging. The charging light will be illuminated.

### CONTINUOUS CHARGING

The unit is designed so that the batteries may remain on continuous charge. It is recommended that the Cuisinart® Cordless Rechargeable Hand Blender charger be kept plugged into a wall socket to charge, so that it will always be ready to use. Leaving the unit on continuous charge is very inexpensive in terms of the amount of electricity being used.

### HOLDING THE CHARGE

The batteries will keep most of their charge even when not plugged in. The batteries will lose approximately 20% of their total charge per month, if they are not plugged in and charging.

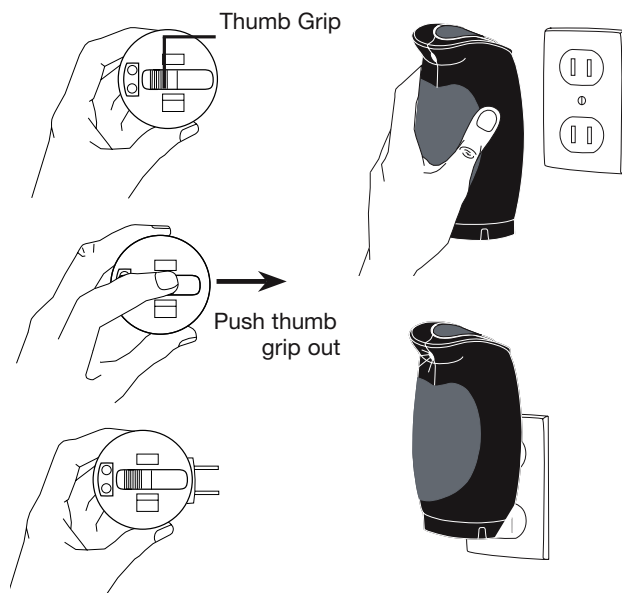

### SHORT RUN TIMES

If after repeated use the run time seems to get shorter and the hand blender has less power, it may not be the result of a faulty unit. This condition can be remedied by allowing the Cuisinart® Cordless Rechargeable Hand Blender to run until it stops. Then recharge the unit for 24 hours for a new charge. This procedure improves the batteries' capacity. You may need to repeat this a few times for the best results.

### CHARGING LIGHT

The charging light on the tip of the handle glows when the unit is charging. This light will be illuminated even when the batteries are fully charged. If the unit does not function, make sure that the charger handle is securely plugged into the outlet, and check to see if the outlet is controlled by a wall switch. Also, check for a blown house fuse. Note that if this light is on, the charger is operating.

## STORAGE STAND / WALL BRACKETS

The Cuisinart® Cordless Rechargeable Hand Blender includes a two-part storage stand that can be assembled into a single piece for countertop use. You can also separate the stand into two pieces, and mount one of the pieces to your wall to use as a wall storage bracket.

Storage stand kit consists of six (6) pieces: two anchor bolts, two plastic wall anchors, and two storage pieces that can fit together for countertop, or be separated for wall mount.

### COUNTERTOP OPTION

The two storage pieces fit together. (See diagram below.)

Align the two pieces back to back on a flat surface, with the ring-shaped reservoirs facing right and left. The raised walls should be in the middle. Lift up the right piece; align the two tabs in the back with the two slots of the left piece. Gently slide the tabs into the slots until both pieces are resting flat on the countertop.

To store the hand blender, detach the shaft and place the bottom part (blade guard) into one of the reservoirs. Place the motor body (right side up) into the other reservoir. You should be able to read the Cuisinart® logo when the motor body is in the stand.

The charger handle can be attached to the motor body when you store the unit. This is especially helpful when you want the hand blender close at hand during a period of heavy use. Plug the charger handle into the electrical socket to keep the battery charged during other times. The counter storage unit can also be placed in a cupboard or on a shelf.

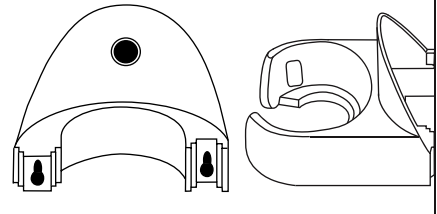
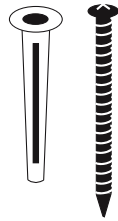
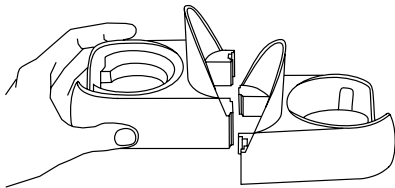

### WALL MOUNT OPTION

Separate the two plastic storage stand pieces. You will need only one for wall mount. (See diagram on left.)

When selecting a mounting location, be sure to leave enough room above the storage stand for your hand to remove the Cuisinart® Cordless Rechargeable Hand Blender. Also be sure to leave enough room below the stand to allow the appliance to hang freely.

You will need to drill two holes  $2\frac{2}{3}$ " apart from each other, measured from the center of each hole. To assist in proper location of holes for the mounting screws, remove the wall mount template from this instruction book (page 13). Place the template over the back of the wall unit, aligning the outline of the template with the wall bracket. When you have done this, place the template and wall bracket against the wall in the desired location. Remove the wall bracket, leaving the template in place. Mark the wall with a pencil in the locations indicated for screw holes by the template. Remove the template.

With a drill, make a  $\frac{3}{16}$ " starter hole for each screw. Place the plastic anchor in each hole. Push completely into the hole with fingers, or tap in gently with a hammer. Screw a mounting screw into each hole, leaving  $\frac{1}{8}$ " to  $\frac{1}{4}$ " of the head and screw exposed.

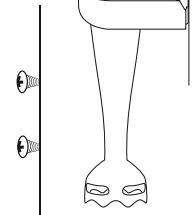
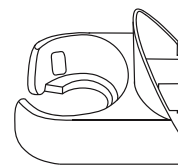

---

Position the two mounting holes of the wall bracket over the screw heads, and slide wall bracket down the wall until the bracket is resting against the screw head, and will not slide any further. If the wall bracket feels too loose against the wall, remove bracket, put screws further into wall, and replace bracket.

Place the assembled hand blender into the wall bracket. The unit will hang from the bracket, held in place by the motor body width.

The charger handle can be attached to the motor body when you store the unit. This is especially helpful when you want the hand blender close at hand during a period of heavy use. At other times, keep the charger handle plugged into the electrical socket to assure the battery is always 100% charged.

## CLEANING

Always clean the hand blender thoroughly after using.

### HAND BLENDER

Detach the charger handle from the motor body before cleaning. Remove the shaft with the blade from the motor body. The shaft with the blade can be cleaned by hand in hot water with a mild detergent. It is not necessary to remove the blade from the shaft. Do not use abrasive cleansers which could scratch the surface.

Clean the motor body and the charger handle with a sponge or damp cloth only. Do not use abrasive cleansers which could scratch the surface.

The mixing/measuring beaker can be cleaned in the dishwasher (upper rack) or by hand in hot water with a mild detergent.

**Never immerse the motor body or charger handle in water.**

### CHOPPER/GRINDER ATTACHMENT

To simplify cleaning, rinse the prep bowl, cover and blade immediately after use, so that food won't dry onto them. Wash blade ring, plastic sheath, and prep bowl in warm soapy water. Rinse and dry. Wipe the underside of the chopper/grinder cover with a sponge or damp cloth to remove any food. **Do not submerge the cover in water or place in the dishwasher.** Wash the blade carefully. Avoid leaving it in soapy water where

it may disappear from sight.

If you have a dishwasher, you can wash the prep bowl and blade assembly on the upper shelf. Insert the prep bowl upside down. Put the blade in the cutlery basket. Unload the dishwasher carefully to avoid contact with the sharp blade. Wipe the top cover with a damp sponge or cloth. Dry it immediately.

The chopper/grinder attachment is intended for HOUSEHOLD USE ONLY. Any service, other than cleaning and normal user maintenance, should be performed by an authorized Cuisinart Service Representative.

### WHISK ATTACHMENT

To clean your whisk attachment, simply release the attachment from the motor body housing. Once the whisk is removed, detach the metal whisk from the gearbox by pulling pieces apart. To clean the gearbox, simply wipe with a damp cloth. To clean the metal whisk, wash with warm, soapy water or place in the dishwasher. Do not submerge the gearbox in water or any other liquid.



### DISPOSAL/RECYCLING OF BATTERIES

This product uses four nickel-cadmium rechargeable and recyclable batteries. At the end of the batteries' useful life, they should be recycled. These batteries must not be incinerated or composted.

Nickel-cadmium batteries should not be put in municipal waste systems. Contact your local waste collection agency for proper recycling and disposal information for your area.

Please do not attempt to dismantle the charger handle to replace these batteries on your own. Damage could result to the unit.

When it is time to replace and/or recycle the batteries, or to receive additional instructions for disposing of old batteries, call toll-free 1-800-726-0190 to order a new charger handle which will include the four new batteries. Or send the charger handle to Cuisinart, 150 Milford Road, E. Windsor, NJ 08520.

# CUISINART® CORDLESS RECHARGEABLE HAND BLENDER

## LIMITED 3-YEAR WARRANTY

This warranty is available to consumers only. You are a consumer if you own a Cuisinart® Cordless Rechargeable Hand Blender that was purchased at retail for personal, family or household use. Except as otherwise required under applicable law, this warranty is not available to retailers or other commercial purchasers or owners.

We warrant that your Cuisinart® Cordless Rechargeable Hand Blender will be free of defects in materials and workmanship under normal home use for 3 years from the date of original purchase.

We suggest you complete and return the enclosed product registration card promptly to facilitate verification of the date of original purchase. However, return of the product registration card does not eliminate the need for the consumer to maintain the original proof of purchase in order to obtain the warranty benefits. In the event that you do not have proof of purchase date, the purchase date for purposes of this warranty will be the date of manufacture.

If your Cuisinart® Cordless Rechargeable Hand Blender should prove to be defective within the warranty period, we will repair it, or if we think necessary, replace it. To obtain warranty service, simply call our toll-free number 1-800-726-0190 for additional information from our Customer Service Representatives, or send the defective product to Customer Service at Cuisinart, 150 Milford Road, East Windsor, NJ 08520.

To facilitate the speed and accuracy of your return, please enclose \$10.00 for shipping and handling of the product.

Please pay by check or money order (California residents need only supply proof of purchase and should call 1-800-726-0190 for shipping instructions).

NOTE: For added protection and secure handling of any Cuisinart® product that is being returned, we recommend you use a traceable, insured delivery service. Cuisinart cannot be held responsible for in-transit damage or for packages that are not delivered to us. Lost and/or damaged products are not covered under warranty. Please be sure to include your return address, daytime phone number, description of the product defect, product model number (located on bottom of product), original date of purchase, and any other information pertinent to the product's return.

Your Cuisinart® Cordless Rechargeable Hand Blender has been manufactured to the strictest specifications and has been designed for use with the authorized accessories and replacement parts.

This warranty expressly excludes any defects or damages caused by accessories, replacement parts, or repair service other than those that have been authorized by Cuisinart.

This warranty does not cover any damage caused by accident, misuse, shipment or other ordinary household use.

This warranty excludes all incidental or consequential damages. Some states do not allow the exclusion or limitation of these damages, so they may not apply to you.

### CALIFORNIA RESIDENTS ONLY:

California law provides that for In-Warranty Service, California residents have the option of returning a nonconforming product (A) to the store where it was purchased or (B) to another retail store which sells Cuisinart products of the same type.

The retail store shall then, at its discretion, either repair the product, refer the consumer to an independent repair facility, replace the product, or refund the purchase price less the amount directly attributable to the consumer's prior usage of the product. If the above two options do not result in the appropriate relief to the consumer, the consumer may then take the product to an independent repair facility if service or repair can be economically accomplished. Cuisinart and not the consumer will be responsible for the reasonable cost of such service, repair, replacement, or refund for nonconforming products under warranty.

California residents may also, according to their preference, return nonconforming products directly to Cuisinart for repair, or if necessary, replacement, by calling our Consumer Service Center toll-free at 1-800-726-0190.

Cuisinart will be responsible for the cost of the repair, replacement, and shipping and handling for such products under warranty.

### BEFORE RETURNING YOUR CUISINART® PRODUCT

If you are experiencing problems with your Cuisinart® product, we suggest that you call our Cuisinart® Service Center at 1-800-726-0190 before returning the product serviced. If servicing is needed, a Representative can confirm whether the product is under warranty and direct you to the nearest service location.

**Important:** If the nonconforming product is to be serviced by someone other than Cuisinart's Authorized Service Center, please remind the servicer to call our Consumer Service Center at 1-800-726-0190 to ensure that the problem is properly diagnosed, the product is serviced with the correct parts, and the product is still under warranty.

## TEMPLATE FOR WALL MOUNTING

