

This Owner's Manual is provided and hosted by [Appliance Factory Parts](http://www.ApplianceFactoryParts.com).

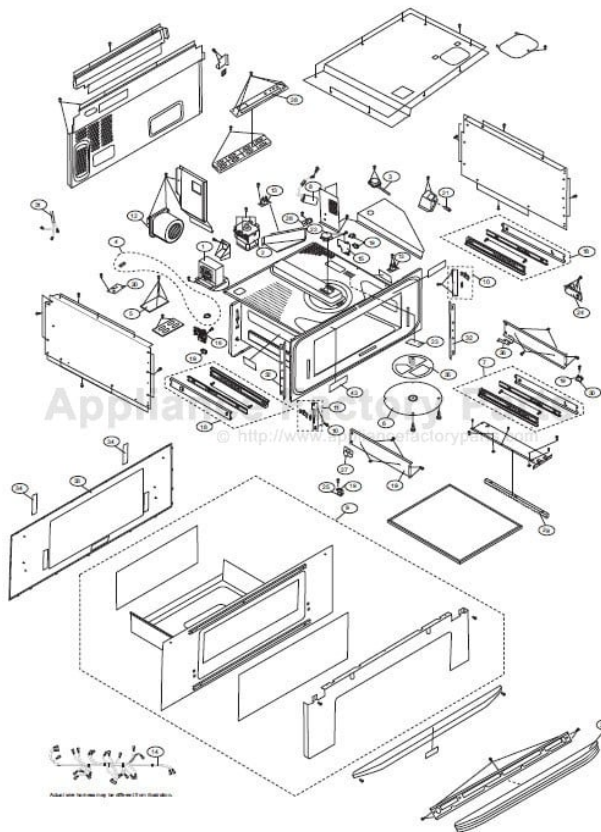

# Wolf MWD30-2F/S Owner's Manual

[Shop genuine replacement parts for Wolf MWD30-2F/S](#)



[Find Your Wolf Microwave Parts - Select From 13 Models](#)

----- Manual continues below -----



### 30" Drawer Microwave Ovens

As true cooking instruments, Wolf microwave ovens have features that make fast meals better meals. With easy access to the food, drawer microwaves can be built in undercounter or below a Wolf E series oven. They are designed to match the trim style of Wolf E series ovens and can be installed in a standard or flush inset application.



Model MWD30-2U/S shown.

#### FEATURES

- Stainless steel finish.
- Trim styles match Wolf framed and unframed E series ovens.
- Can be built in to fit below a Wolf E series oven.
- Can be installed in a standard or flush inset application.
- 950 watts of power with one cu ft of interior drawer space.
- Interior easily accommodates a 9" x 13" pan.
- Easy-to-operate control panel has 11 programmable power levels.
- Sensor cooking to monitor and adjust settings.
- Micro warm allows you to keep food warm up to 30 minutes.
- Interactive display—99 minutes, 99 seconds.
- Window in drawer allows you to view food as it cooks.
- One-touch pads to open and close the drawer.
- Control panel can be deactivated or locked.

MODEL	MWD30-2F/S	MWD30-2U/S
Trim Style	Framed	Unframed



Control panel.



Model MWD30-2F/S  
Framed Trim Style



Model MWD30-2U/S  
Unframed Trim Style

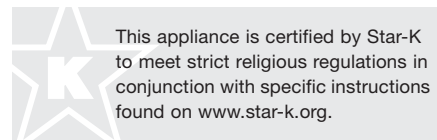



## 30" Drawer Microwave Ovens

## OVERALL DIMENSIONS

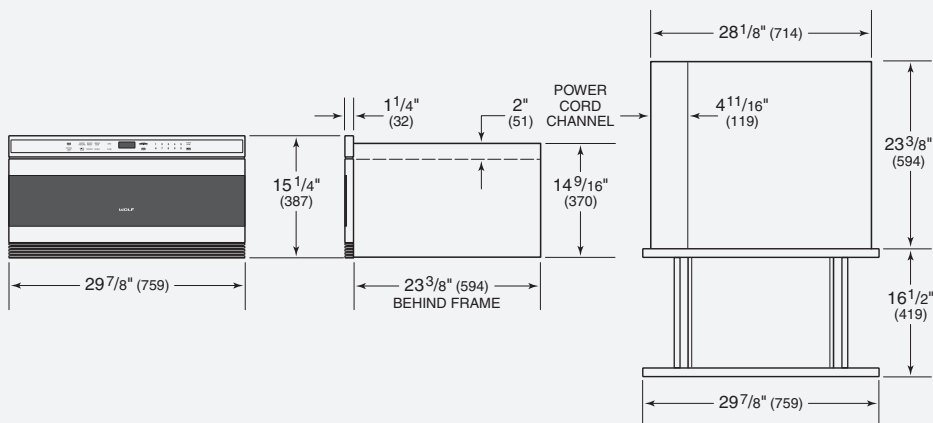

Unit dimensions may vary by  $\pm 1/8$ ".

## SPECIFICATIONS

Overall Width	29 <sup>7</sup> / <sub>8</sub> "
Overall Height	15 <sup>1</sup> / <sub>4</sub> "
Overall Depth	23 <sup>3</sup> / <sub>8</sub> "
Oven Interior Capacity	1 cu ft
Oven Interior Dimensions	17 <sup>3</sup> / <sub>8</sub> " W x 5 <sup>7</sup> / <sub>8</sub> " H x 17 <sup>1</sup> / <sub>8</sub> " D
Minimum Cabinet Depth	Standard 24" Flush Inset 25"
Opening Width	28 <sup>3</sup> / <sub>8</sub> "
Min Flush Inset Width	30 <sup>3</sup> / <sub>8</sub> "
Opening Height	14 <sup>3</sup> / <sub>4</sub> "
Min Flush Inset Height	15 <sup>3</sup> / <sub>4</sub> "
Minimum Base Support	100 lbs
Power	950 W
Electrical Rating	1.5 kW
Electrical Requirements	120 V AC, 60 Hz 15 amp circuit
Power Cord	4' cord with grounded plug
Shipping Weight	96 lbs

## INSTALLATION SPECIFICATIONS

### Standard Installation

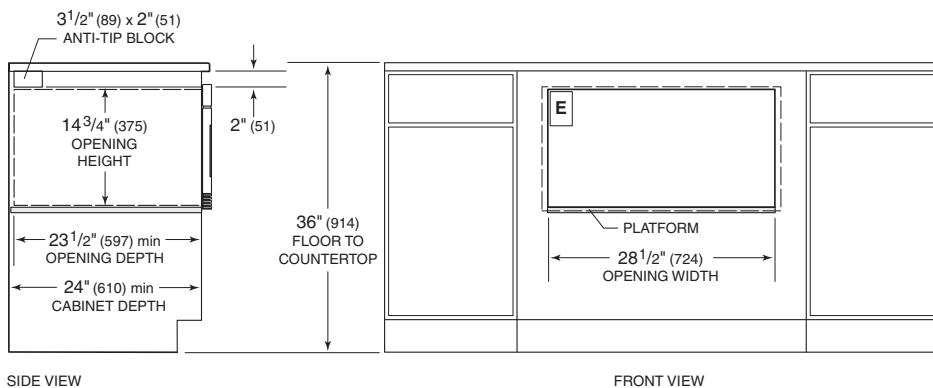

Dashed line represents profile of unit.

### Flush Inset Installation

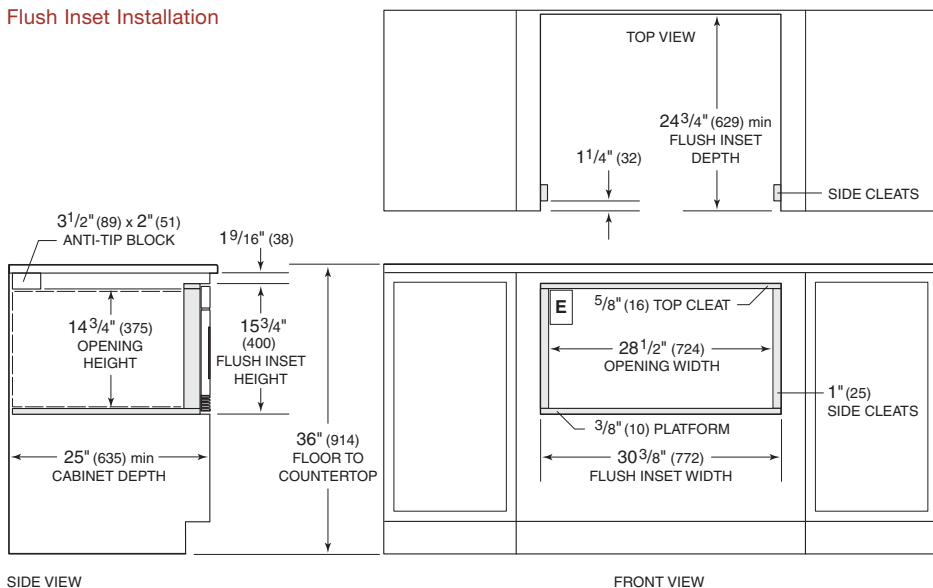

Dashed line represents profile of unit.

Dimensions in parentheses are in millimeters unless otherwise specified.

## INSTALLATION NOTES

Wolf drawer microwave ovens may be used in a standard installation, where the face trim overlaps stiles and rails, or in a flush inset installation with the front of the oven flush with surrounding cabinetry.

30" drawer microwaves can be built in to fit below a Wolf E series oven.

Complete installation specifications can be found on our website, [wolfappliance.com](http://wolfappliance.com).