



Internal Use Only

<http://biz.lgservice.com>

Multi Air Conditioner SVC MANUAL(Exploded View)

Model : A4UW363FA1(LMU366HV)

CAUTION

Before Servicing the unit, read the safety precautions in Standard SVC manual.
Only for authorized service personnel.

1. Specification

| Outdoor Unit | | A4UW363FA1(LMU366HV) | |
|---|--------------------------------------|----------------------|--------------------------------------|
| Capacity(*) | | Btu/h Class | 36,000 |
| Power Input (Min. Rated~ Max.) | Cooling | kW | 0.72~3.75~ 3.92 |
| | Heating | kW | 0.72~3.70~4.10 |
| Running Current (Rated) | Cooling | A | 3.0~17.4~18.2 |
| | Heating | A | 4.5~17.2~18.8 |
| Starting Current | Cooling/Heating | A | - |
| Power Supply | | Ø / V / Hz | 1/208~230/60 |
| Power Supply Cable (Outdoor) | | No.x AWG | 3 x 12 |
| Transmission Cable (Outdoor to Indoor unit) | | No.x AWG | 4 x 18 (Including Earth) |
| Dimensions | W x H x D | mm(inch) | 870x808x320(34 1/4x31 13/16x12 9/16) |
| Net Weight | | kg(lbs) | 65(143.3) |
| Max. Number of Connectable Indoor Units | | | 4 |
| Compressor | Type | | Twin-Rotary |
| | Qty x Model | | 5KD240X |
| | Motor type | | BLDC |
| | Oil charge volume | cc | 900 |
| | Oil Type | | FV50S |
| Refrigerant | Cycle A Charge (at 7.5m) | g(oz) | 2,550(89.95) |
| | Cycle B Charge (at 7.5m) | g(oz) | - |
| | Type | | R410A |
| Heat Exchanger | Control | | EEV |
| | (Rows x Column x FPI) x No. | | (2Rx36Cx18) x1 |
| | Coil tube dia. | mm(inch) | 7(0.276) |
| | Defrosting Method | | Reversing cycle |
| Fan motor | Capacitor | µ/Vac | - |
| | Drive | | Direct (DC) |
| | Discharge Direction(Side/Top) | | Side |
| | Air Flow Rate x No. of Fan | CMM(CFM) | 60(2,118) |
| Sound Level(H/L) | Sound Pressure | dB(A)+3 | 52 |
| | Liquid(Cycle A) | mm(inch) | 6.35(1/4) x 4EA |
| Piping Connections | Gas(Cycle A) | mm(inch) | 9.52(3/8) x 4EA |
| | Liquid(Cycle B) | mm(inch) | - |
| | Gas(Cycle B) | mm(inch) | - |
| Piping length spec. | Max. total piping | m(ft.) | 75(246.1) |
| | Max. OD-ID piping | m(ft.) | 25(82.0) |
| | Piping Length (no add'l refrigerant) | m(ft.) | 37.5(123.0) |
| Max. Elevation Difference | Outdoor Unit~Indoor Unit | m(ft.) | 15(49.2) |
| | Indoor Unit~Indoor Unit | m(ft.) | 7.5(24.6) |
| Operation Range (Outdoor) | Cooling | °C(°F) | -10 ~ 46 (14 ~114.8) |
| | Heating | °C(°F) | -15 ~ 24 (5~75.2) |

Note :

1. Capacities are based on the following conditions:

Cooling: - Indoor Temperature 26.7°C(80°F) DB/19.4°C(67°F) WB

- Outdoor Temperature 35°C(95°F) DB/23.9°C(75°F) WB

Heating: - Indoor Temperature 21.1°C(70°F) DB/15.6°C(60°F) WB

- Outdoor Temperature 8.3°C(47°F) DB/6.1°C(43°F) WB

Piping Length - Interconnecting Piping Length 7.5m(24.6 ft.)

- Level Difference of Zero

2. Wiring cable size must comply with the applicable local and national code.

3. The specification may be subject to change without prior notice for purpose of improvement.

4. At least two indoor units should be connected.

5. For more Capacity(*), refer to the combination table

Conversion Formula

kW = Btu/h class X 0.0002931

cfm = CMM x 35.3

2. List of Functions

| Category | Function | A4UW363FA1(LMU366HV) |
|----------------------|---|----------------------|
| Reliability | Defrost / Deicing | O |
| | High Pressure Switch | X |
| | Low Pressure Switch | X |
| | Phase protection | X |
| | Restart Delay (3-minutes) | O |
| | Self Diagnosis | O |
| | Soft Start | O |
| | Test Function | X |
| Convenience | Auto operation(Artificial intelligence) | O |
| | Auto Restart Operation | O |
| CAC Network Function | Central control(LGAP) | O |
| | PDI(Power Distribution Indicator) | PQNUD1S00 |
| | PI485 | PMNFP14A0 |
| Special function kit | Low ambient operation | O |
| Others | Thermistor | - |

Note :

O : Applied, X : Not applied, - : No relation

Option: Model name & price are different according to options, and assembled in factory with main unit.

Accessory: Installed at field, ordered and purchased separately by the corresponding model name, supplied with separate package.

3. Piping Diagrams

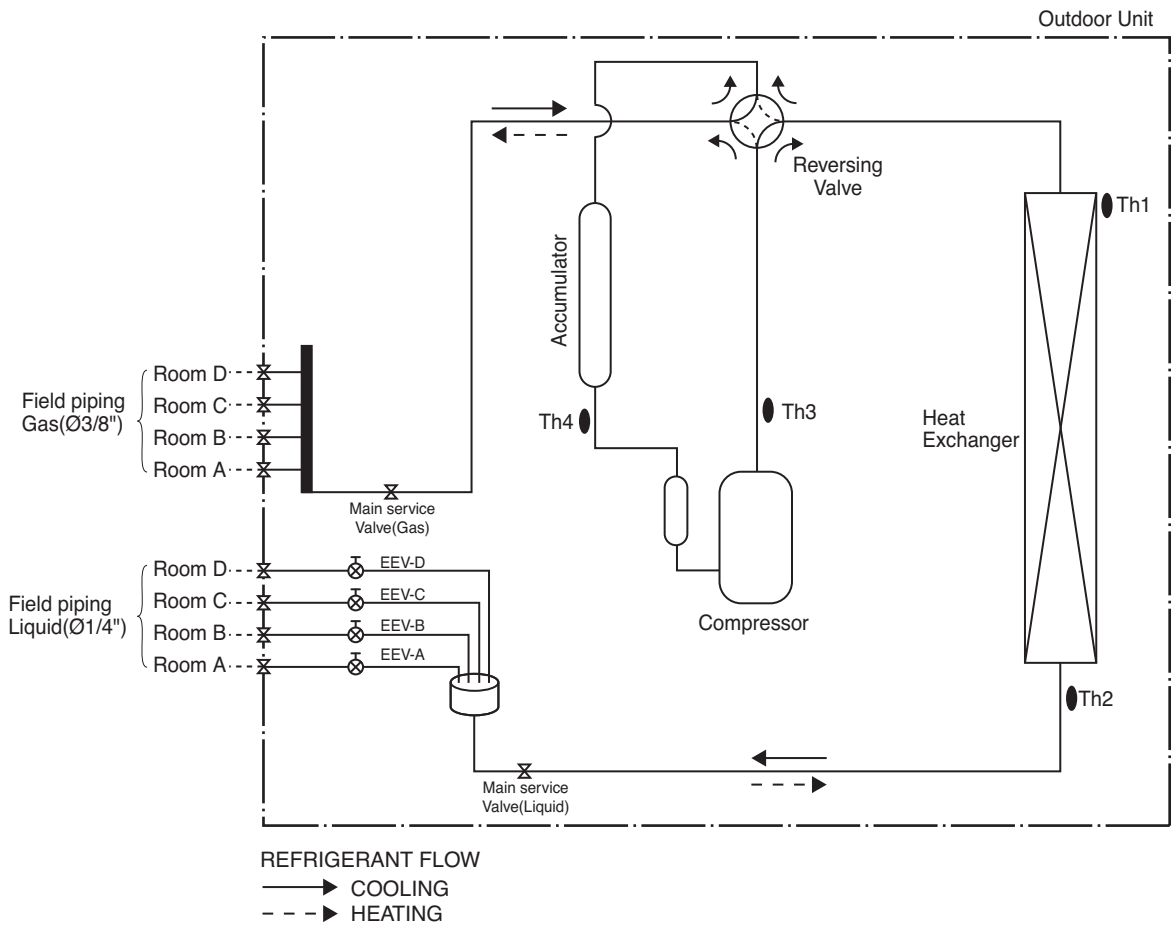

| LOC. | Description | PCB Connector |
|------|---|---------------|
| Th1 | Thermistor for outdoor air temperature | CN_TH2 |
| Th2 | Thermistor for condensing temperature | CN_TH2 |
| Th3 | Thermistor for discharge pipe temperature | CN_TH3 |
| Th4 | Thermistor for suction pipe temperature | CN_TH3 |

4. Wiring Diagrams

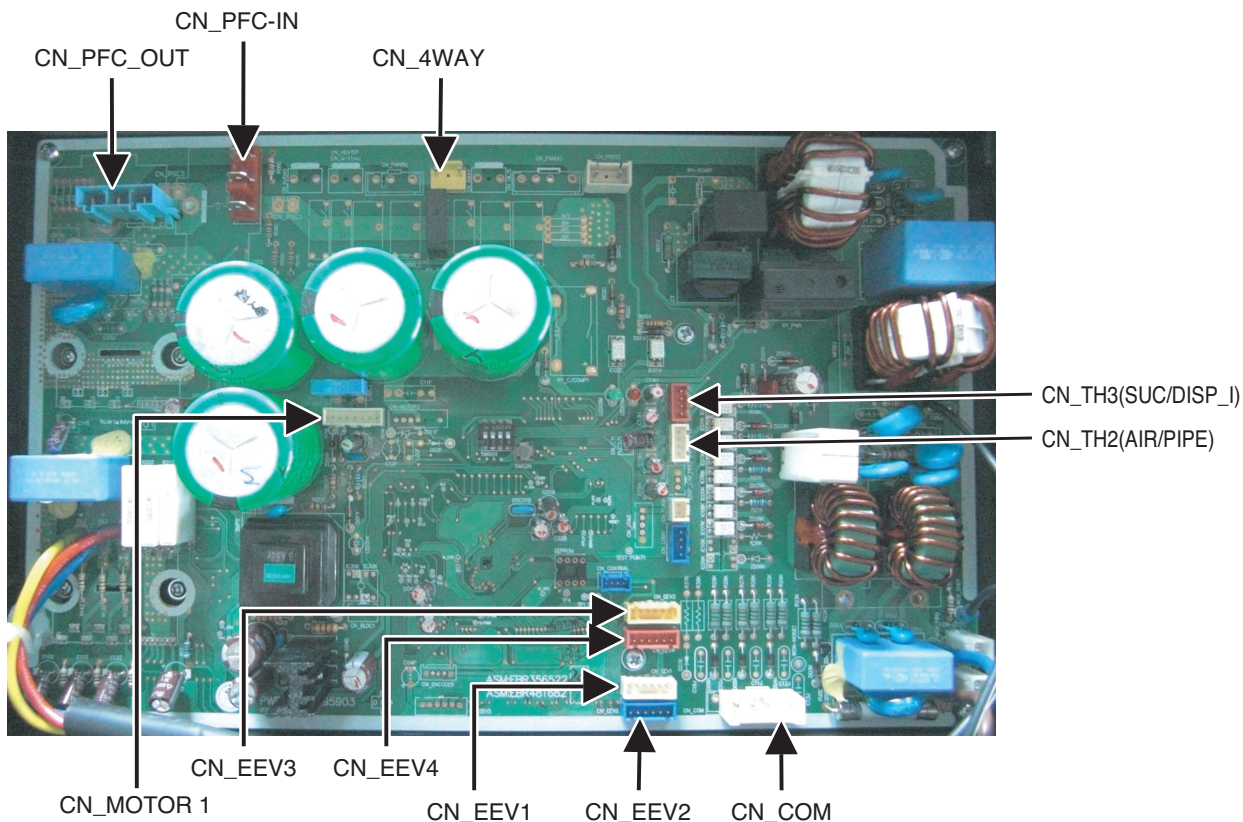
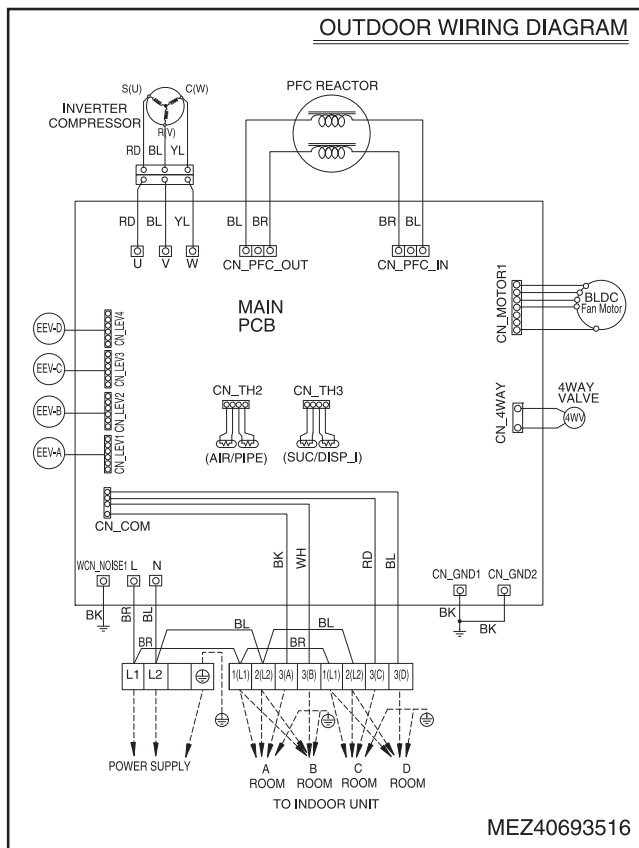

5. Exploded View

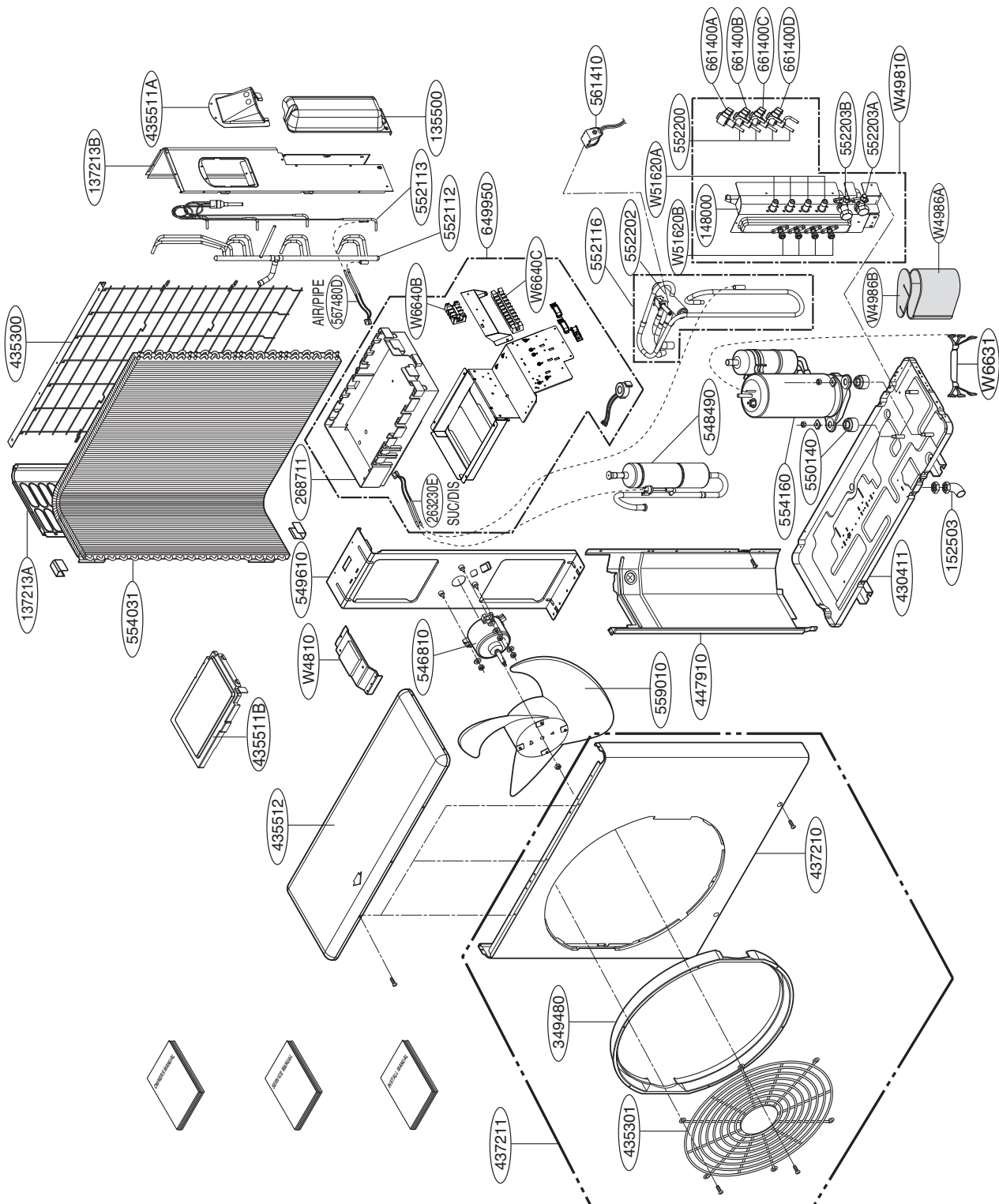

| Model | Classification | Description | Part Number | Location Number | Remark |
|------------|-----------------------|---------------|-------------|-----------------|--------|
| A4UW363FA1 | Inverter Heating/Pump | Compressor | 5416A90055D | 554160 | - |
| | | Harness,Multi | EAD41346203 | W6631 | |

Note) * Please ensure GCSC since the replacement parts may be changed depending upon the buyer's request. Please check the correct parts in View RPL(Replacement Part List) on GCSC. (GCSC Website <http://biz.Lgservice.com>.)



P/NO : MFL63721201

JANUARY, 2010