

This Owner's Manual is provided and hosted by [Appliance Factory Parts](http://ApplianceFactoryParts.com).

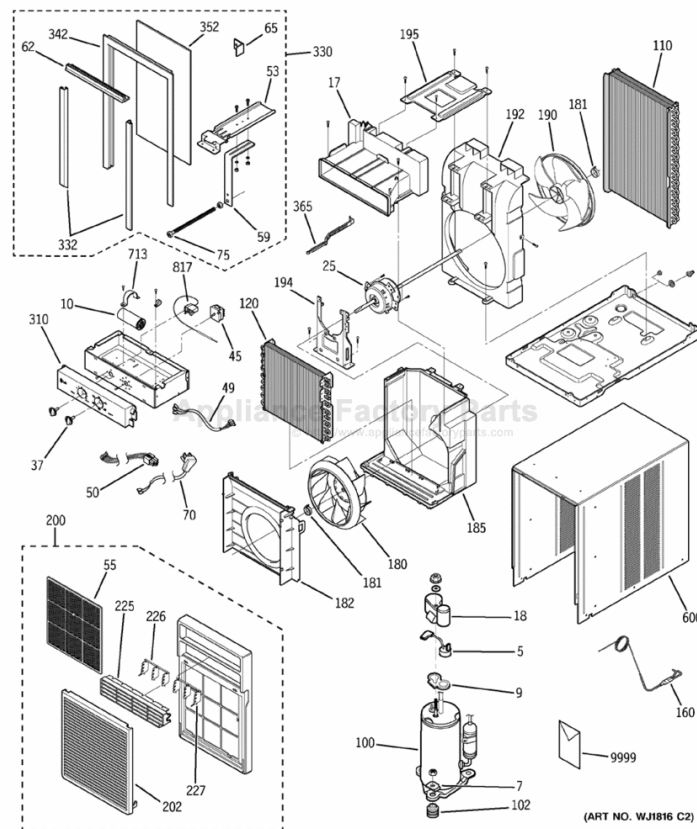

GE AGX10AJ Owner's Manual

[Shop genuine replacement parts for GE AGX10AJ](#)



[Find Your GE Air Conditioner Parts - Select From 2757 Models](#)

----- Manual continues below -----

Technical Data

AGX08FJG1

3828A20875G

**DISCONNECT POWER BEFORE SERVICING
IMPORTANT - RECONNECT ALL GROUNDING DEVICES**

All parts of this appliance capable of conducting electrical current are grounded. If grounding wires, screws, straps, clips nuts or washers used to complete a path to ground are removed for service, they must be returned to their original position and properly fastened.

IMPORTANT SAFETY NOTICE

This information is intended for use by individuals possessing adequate backgrounds of electrical, electronic and mechanical experience. Any attempt to repair a major appliance may result in personal injury and property damage. The manufacturer or seller cannot be responsible for the interpretation of this information, nor can it assume any liability in connection with its use.

WARNING

DISCONNECT UNIT FROM ELECTRICAL POWER SUPPLY BEFORE MAKING ANY ELECTRICAL CHECKS.

MAXIMUM CURRENT LEAKAGE:
0.75 MILL.AMP - ALL MODELS

MAXIMUM GROUND PATH RESISTANCE:
0.1 OHM - ALL MODELS

CURRENT- TEMPERATURE CHECK DATA(115V)

AIR TEMPERATURE CONDENSER IN °F	COOLING CURRENT	
	MIN.	MAX.
80	6.12	6.14
95	7.56	7.58
110	9.51	9.53

POWER SUPPLY

RATED VOLTAGE	VOLTAGE LIMITS
115	103 - 127

TEMPERATURE DIFFERENTIAL CHECK DATA(115V)

EVAPORATOR AIR TEMP. IN °F (COOLING)	EVAP. AIR TEMP. OUT °F	
	MIN.	MAX.
70	45.1	45.5
85	57.7	58.1
90	65.0	66.0

R-22 16.2 OZ

**WARNING - COMPRESSOR DIRECT CHECK
CAUTION:**

1. Keep head clear of terminal area when cover is removed.
2. Check windings first. If open or grounded, "DO NOT" apply power to compressor terminals.

