

This Owner's Manual is provided and hosted by [Appliance Factory Parts](#).



Bissell 1693 Series Owner's Manual

[Shop genuine replacement parts for Bissell 1693 Series](#)



[Find Your Bissell Vacuum Cleaner Parts - Select From 376 Models](#)

----- Manual continues below -----



PowerSteamer™

USER'S GUIDE

1693 SERIES

3 Safety Instructions

4 Product View

5 Assembly Instructions

6-8 Operations / Special Tools

9 Routine Maintenance

10 Troubleshooting

11 Consumer Services

11 Replacement Parts

12 Warranty



Thanks For Buying A BISSELL PowerSteamer Deep Cleaner

We're glad you purchased a BISSELL PowerSteamer Deep Cleaner. Everything we know about floor care went into the design and construction of this complete, high-tech home cleaning system.

Your PowerSteamer is well made, and we back it with a limited one-year warranty. We also stand behind it with a knowledgeable, dedicated Consumer Services department, so, should you ever have a problem, you'll receive fast, considerate assistance.

My great-grandfather invented the floor sweeper in 1876. Today, BISSELL is a global leader in the design, manufacture, and service of high quality homecare products like your PowerSteamer.

Thanks again, from all of us at BISSELL.

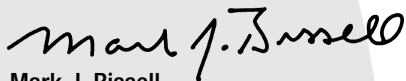

Mark J. Bissell
President and Chief Executive Officer

IMPORTANT SAFETY INSTRUCTIONS

When using an electrical appliance, basic precautions should be observed, including the following:

Read all instructions before using your POWERSTEAMER™.

⚠ WARNING: To reduce the risk of fire, electric shock, or injury:

- Do not immerse.
- Use only on surfaces moistened by cleaning process.
- Always connect to a properly grounded outlet. See Grounding Instructions.
- Unplug from outlet when not in use and before conducting maintenance or troubleshooting.
- Do not leave machine when it is plugged in.
- Do not service machine when it is plugged in.
- Do not use with damaged cord or plug.
- If appliance is not working as it should, has been dropped, damaged, left outdoors, or dropped in to water, have it repaired at an authorized Service Center.
- Use indoors only.
- Do not pull or carry by cord, use cord as a handle, close door on cord, pull cord around sharp corners or edges, run appliance over cord, or expose cord to heated surfaces.
- Do not carry the appliance while in use.
- Do not unplug by pulling on cord. Unplug by grasping the plug, not the cord.
- Do not handle plug or appliance with wet hands.
- Do not put any object into appliance openings, use with blocked opening, or restrict air flow.
- Do not expose hair, loose clothing, fingers or body parts to openings or moving parts.
- Do not pick up hot or burning objects.
- Do not pick up flammable or combustible materials (lighter fluid, gasoline, kerosene, etc.) or use in the presence of explosive liquids or vapour.
- Do not use appliance in an enclosed space filled with vapours given off by oil base paint, paint thinner, some moth proofing substances, flammable dust, or other explosive or toxic vapours.
- Do not pick up toxic material (chlorine bleach, ammonia, drain cleaner, gasoline, etc.).
- Do not modify the 3-prong grounded plug.
- Do not allow to be used as a toy.
- Do not use for any purpose other than described in this User's Guide.
- Do not operate the appliance unless the belt door is securely assembled in the location provided.
- Use only manufacturer's recommended attachments.
- Use only cleaning products formulated by BISSELL for use in this appliance.
- Keep openings free of dust, lint, hair, etc.
- Keep appliance on a level surface.
- Turn off all controls before unplugging.

Be extra careful when cleaning stairs. Close attention is necessary when used by or near children.

SAVE THESE INSTRUCTIONS.

THIS MODEL IS FOR HOUSEHOLD USE ONLY. Commercial use of this unit voids the manufacturer's warranty.

GROUNDING INSTRUCTIONS

This appliance must be connected to a grounded wiring system. If it should malfunction or break down, grounding provides a safe path of least resistance for electrical current, reducing the risk of electrical shock. The cord for this appliance has an equipment-grounding conductor and a grounding plug. It must only be plugged into an outlet that is properly installed and grounded in accordance with all local codes and ordinances.

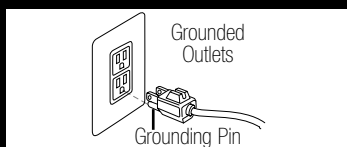

⚠ WARNING: Improper connection of the equipment-grounding conductor can result in a risk of electrical shock. Check with a qualified electrician or service person if you aren't sure if the outlet is properly grounded. DO NOT MODIFY THE PLUG. If it will not fit the outlet, have a proper outlet installed by a qualified electrician. This appliance is designed for use on a nominal 120-volt circuit, and has a grounding attachment plug that looks like the plug in the drawing above. Make certain that the appliance is connected to an outlet having the same configuration as the plug. No plug adapter should be used with this appliance.

Product View

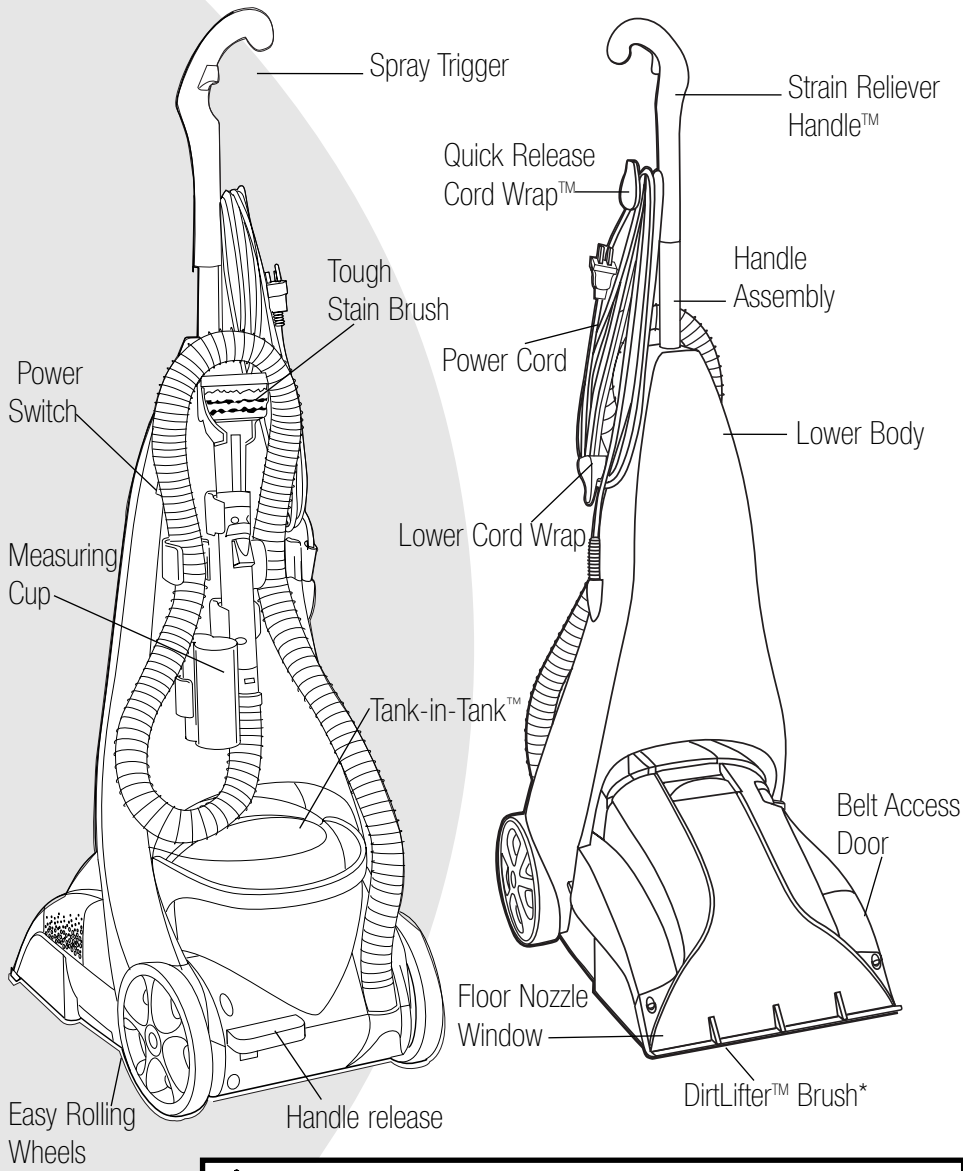

⚠ WARNING:

To reduce the risk of fire, use only BISSELL Advanced Deep Cleaning Formulas in your PowerSteamer. Use of cleaning formulas that contain lemon or pine oil may damage this appliance and void the warranty. Chemical spot cleaners or solvent-based soil removers should not be used. These products may react with the plastic materials used in your PowerSteamer causing cracking or pitting.

Assembly

Your PowerSteamer assembles in two quick steps. The only tool you will need to assemble your cleaner is a Phillips head  screwdriver.

Your PowerSteamer is packaged as two primary components... the Lower Body and the Handle Assembly. To assemble:

1. Slide the Handle Assembly (with attached Quick Release Cord Wrap™) down into the Lower Body until it will go no further.
2. Secure the handle by placing one (1) Phillips head  screw (supplied) through the screw opening in the Lower Body and into the rear of the Handle Assembly. Tighten with screwdriver until secure.

Assembly is now complete.

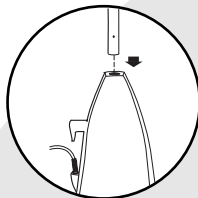

The Basics: How Your PowerSteamer Works

Your PowerSteamer is a home cleaning system that uses a combination of hot tap water, BISSELL advanced deep cleaning formula and suction to safely clean carpets and upholstery.

Getting Ready

The Power Switch controls power to the machine.

Measuring Cup

Your PowerSteamer is equipped with a Measuring Cup for adding the proper amount of cleaning formula to the Tank-in-Tank™. Before using the machine, simply fill the Measuring Cup to the fill line with BISSELL Advanced Deep Cleaning Formula. Pour the formula into the Tank-in-Tank as shown on page 6. For convenience, the Measuring Cup stores on the back of the unit.

To Fill The Tank-in-Tank

This easy-to-use system is designed with a bladder inside to hold clean water. As you clean, the bladder will empty. Dirty water collects in the tank outside the bladder.

NOTE: Make sure to add formula to the tank before filling it with water.

1. Depress the Handle Release pedal to tilt back the handle.

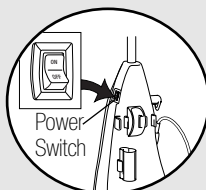

Tip:

Deep cleaning carpeting and upholstery regularly can reduce dust and allergens in your home.

⚠ WARNING:
To reduce the risk of fire, electric shock or injury unplug from outlet before servicing.

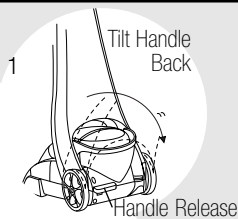

To Fill The Tank-in-Tank Continued

2. Lift the Tank-in-Tank handle. The handle locks the lid in place. Carry the Tank-in-Tank like a bucket to fill at the sink.
3. Set the Tank down and rotate the handle forward to unlatch the Lid. Lift off and set the Lid aside.
4. Using the Measuring Cup, pour BISSELL Deep Cleaning Formula into the mouth of the bladder.
5. Fill to the bottom of the neck with hot tap water. Do not boil or microwave water.
NOTE: Fill slowly to reduce sudsing.
6. Replace the Tank Lid, matching the Lid and Tank edges. Rotate the handle to carrying position. Replace Tank in machine base, seating firmly in place. Rotate handle back down to latched position.

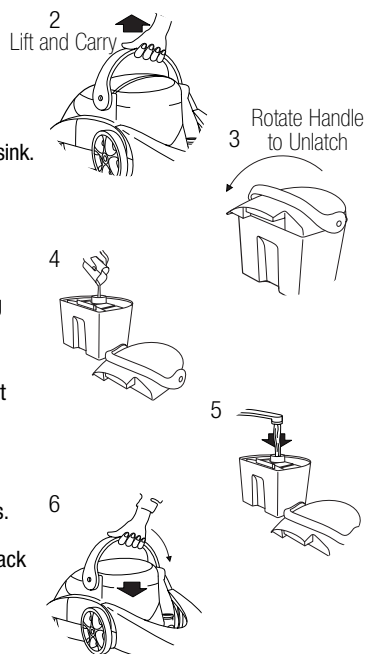

When It's Time To Empty The Tank-in-Tank

NOTE: Remove the Tank-in-Tank, following step 1 on page 5 and step 2 above.

1. Carry the Tank-in-Tank, like a bucket, to the sink. Remove Tank Lid. Pour out dirty water.
2. After each use, remove and rinse the Lint Screen located on the Tank Lid.
 - A. Remove Tank Lid.
 - B. Remove Lint Screen and rinse under faucet. Remove any debris caught in Lint Screen.
 - C. Reinsert Lint Screen on Tank Lid. The screen will click into place.
 - D. Replace Tank Lid.
3. Refill with cleaning solution and clean tap water—follow steps 2-5 above.
4. When a cleaning job is complete, rinse out the Tank-in-Tank by running clean water between the bladder and the tank.
5. Return the Tank-in-Tank to the machine, follow step 6 above.
6. Refer to the Storage section on page 8 for final cleanup.

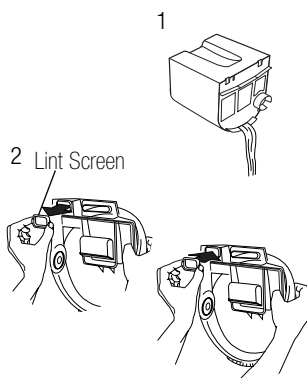

Tip:

A special red float device in the tank will cause the cleaner to stop removing solution from the carpet. The motor sound will rise in pitch to let you know the dirty water tank is full.

ReadyTools™ Dial

This provides floor or upholstery cleaning with the turn of a dial. For carpet/floor cleaning make sure the dial is set to FLOOR CLEANING. For upholstery or fabric cleaning, attach the Tough Stain Tool to the Flex Hose, switch to Tools Settings and the PowerSteamer is ready to clean upholstery, fabrics and more*

* Set the switch to FLOOR CLEANING when cleaning carpets, or set it to TOOLS/PRETREAT when using the Flex Hose attachments.

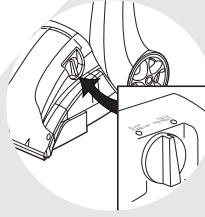

How To Clean Carpets

1. Plan activities to give carpet time to dry.
2. Remove easily moved furniture from the room (chairs, lamps, coffee tables, etc.).
3. Vacuum thoroughly to pick up loose debris and pet hair before using the PowerSteamer.
4. Plan your cleaning route to leave an exit path. It is best to begin cleaning in the corner farthest from your exit.

NOTE: You may notice hair and debris deposits on carpet that were loosened by brushing action (especially with newer carpets that have never been deep cleaned before). This debris should be picked up by hand and thrown away.

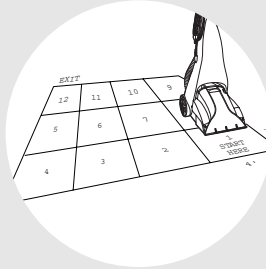

Normal Cleaning

1. Plug the PowerSteamer into a proper outlet and turn ON the Power Switch.
2. While pressing the Spray Release Trigger, make one slow forward and back wet pass. Let the BISSELL Advanced Deep Cleaning Formula and DirtLifter Brush do the work for you.
Caution: Do not overwet.
3. Release the Trigger and make one slow forward and back pass over the same area to remove any residual dirty water.
4. Repeat cleaning passes without pressing the Trigger until you can't see any more water being suctioned up.
5. When cleaning job is complete, refer to the Maintenance/Storage section on page 8.

Tip:

Thorough vacuuming before deep cleaning will prevent early clogging of the lint trap.

How To Clean Upholstery and Small Areas

Important - Check Upholstery Tags

1. Check manufacturer's tag before cleaning. A "W" or "WS" on the tag means you can use your PowerSteamer. If the tag is coded with an "X" or "S" (with a diagonal strike through), or says "Dry Clean Only," do not proceed. Do not use your PowerSteamer on velvet or silk. If manufacturer's tag is missing or not coded, check with your furniture dealer.
2. Check for colorfastness in an inconspicuous place.
3. If possible, check upholstery stuffing. Colored stuffing may bleed through fabric when wet.
4. Plan activities to give upholstery time to dry.
5. Vacuum thoroughly to pick up loose debris and pet hair. Use a vacuum with a brush attachment and a crevice tool to clean in fabric folds and tufts.



Machine Preparation

1. Set up the machine following instructions in The Basics section, pages 5-7.
2. Using the Measuring Cup provided, pour BISSELL Advanced Deep Cleaning Formula into the Tank-in-Tank.
3. Set the ReadyTools Dial to TOOLS/PRETREAT.

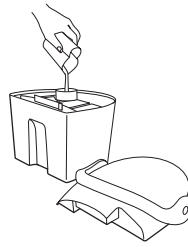

Maintenance/Storage

1. Turn Power Switch OFF.
2. Unplug Power Cord from outlet and coil cord around Power Cord Quick Release.
3. Remove and rinse tools, if used, in clean, running water. Dry and replace.
4. Coil Flex Hose through storage brackets.
5. Remove Tank-in-Tank. Dispose of dirty water. See The Basics section, page 6.
6. Rinse out Tank-in-Tank and reseat the tank unto the machine.
7. Wipe all exterior surfaces with a soft cloth.
8. Store cleaner in a protected, dry area.

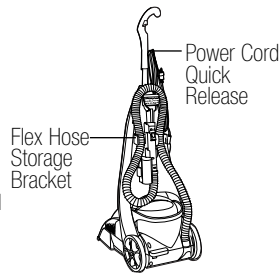

CAUTION:
PowerSteamer™ uses water and must not be stored where there is a danger of freezing. Freezing will damage internal components and void the warranty.

Pump Belt Replacement

To Remove Broken Pump Belt

NOTE: Turn off machine and unplug from wall outlet.

1. Step on Handle Release pedal and recline Handle on floor (see illustration).
2. Remove the Tank-in-Tank. Set aside (see illustration).
3. Remove the Belt Access Door located near the ReadyTools Dial. Insert a flathead screwdriver into the slot nearest the handle to gently pry off the door (see illustration).
4. Turn the machine onto its side so the belt access area is facing upward (see illustrations).
5. On the bottom of the machine, near the belt access area, is a White Retainer Plate that holds the black Brush Arm and Brush in place. Using a Phillips head screwdriver remove the screw that holds the White Retainer Plate in place. Set White Retainer Plate and Phillips head screw aside (see illustrations).
6. Remove the black Brush Arm that holds the Brush in place. Set the black Brush Arm aside (see illustrations).
7. Locate and remove the broken Pump Belt.

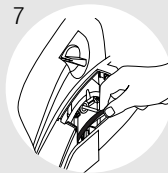
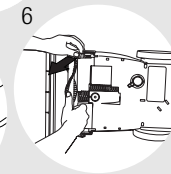
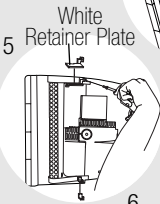
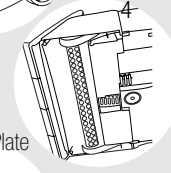
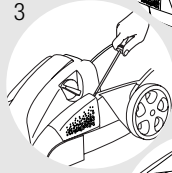
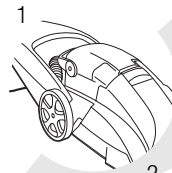

To Replace Broken Pump Belt

1. With the unit still on its side, loop one end of the replacement Pump Belt around the Red Pump Pulley and the other end around the silver motor shaft (see illustration). Do not twist the replacement Pump Belt.
2. Re-install the Brush into the base of the unit.
3. Place the black Brush Arm onto the Brush and slide black Brush Arm into original position (see illustrations). Reattach White Retainer Plate and secure with screw.

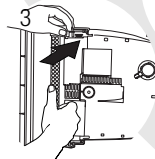
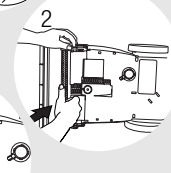



Reduced Spray Or No Spray.

Possible Causes

- 1 Bladder may be empty
- 2 The lint screen may be clogged
- 3 Tank-in-Tank may not be seated properly
- 4 Pump may have lost prime
- 5 The Pump Belt may be broken

Remedies

- 1 Turn power OFF, refill tank with hot tap water.
- 2 Turn power OFF, clean out lint screen, follow step 2 on page 6.
- 3 Turn power OFF; remove and reseal tank
- 4 Turn power OFF; after 1 minute, turn ON and depress Spray trigger.
- 5 See page 9 for directions on replacing Belt.

PowerSteamer is not picking up solution.

Possible Causes

- 1 Nozzle Window may not be properly attached
- 2 Tank-in-Tank Lid is not properly installed
- 3 Tank-in-Tank is not properly seated
- 4 Tank-in-Tank has picked up the maximum
- 5 ReadyTools Dial may be at the wrong setting for cleaning job.
- 6 Poor tool position.
(Handheld attachments only.)

Remedies

- 1 Make sure the two tabs on the back of the Floor Nozzle Window are inserted through the mating slots in the main housing. Reinstall if necessary.
- 2 Reinstall lid; refer to page 6.
- 3 Tank-in-Tank must be firmly seated to function. Remove and reseal Tank-in-Tank.
- 4 Empty tank and refill; refer to page 6.
- 5 Set ReadyTools Dial to either FLOOR CLEANING or TOOLS/PRETREAT.
- 6 Readjust angle; apply more downward pressure.

Thank you for selecting a BISSELL product.

If you should happen to need assistance during assembly or operations, call 1-800-263-2535.

Please do not return this product to the store

BISSELL Consumer Services

For information about repairs or replacement parts, or questions about your warranty, call:

BISSELL Consumer Services

1-800-263-2535

Monday - Friday 8 a.m. — 10 p.m. ET

Saturday 9 a.m. — 8 p.m. ET

Or write:

BISSELL Canada Corporation

P.O. Box 1003

Niagara Falls, ON L2E 6W2

ATTN Consumer Services

Or visit the BISSELL website - www.bissell.com









When contacting BISSELL, have model number of unit available.

Please record your Model Number: _____

Please record your Purchase Date: _____

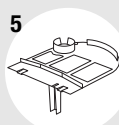
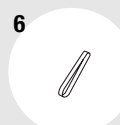
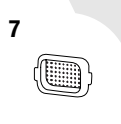
NOTE: Please keep your original sales receipt. It provides proof of date of purchase in the event of a warranty claim. See "About Your Warranty" on page 12 for details.

Replacement Parts

Item	Part No.	Part Name	
1	214-9156	Tough Stain Brush	
2	015-9043	Tank Assembly Complete	
3	015-4439	Tank Lid Assembly	
4	015-9041	Tank Bottom	
5	213-0213	Baffle with Red Float	
6	215-0628	Replacement Pump Belt (with instructions)	
7	213-3501	Lint Screen	
8	213-3010	Measuring Cup	
9	710C	48 oz. BISSELL Fiber Cleansing Formula with Scotchgard™	
10	400C	22 oz. BISSELL Tough Stain PreCleaner	

Warranty

If you need additional instruction regarding this warranty or have questions regarding what it may cover, please contact BISSELL Consumer Services by e-mail, telephone, or regular mail as described below.

Limited One Year Warranty

Subject to the *EXCEPTIONS AND EXCLUSIONS identified below, upon receipt of the product, BISSELL Canada Corporation will repair or replace (with new or remanufactured components or products), at BISSELL's option, free of charge from the date of purchase by the original purchaser, for one year any defective or malfunctioning part. See information below on "If your BISSELL product should require service". This warranty applies to product used for personal, and not commercial or rental service. This warranty does not apply to routine maintenance components such as belts or brushes. Damage or malfunction caused by negligence, abuse, or use not in accordance with the User's Guide is not covered.

If your BISSELL product should require service:

Call BISSELL Consumer Services at the number listed below or visit the BISSELL website - www.bissell.com to locate a BISSELL Authorized Service Centre in your area. If there are no authorized BISSELL Service Centres in your area, a BISSELL Representative at canada.custhelp@bissell.com or at the phone number below will issue you a Return Authorization Number and a pre-paid mailing label to return the unit to BISSELL for warranty repair.

- The machine should be returned with a photocopy of your proof of purchase. (Your dated sales receipt is your warranty - do not send original.) If you need information about repairs or replacement parts, or if you have questions about your warranty, contact **BISSELL Consumer Services**.

E-mail: canada.custhelp@bissell.com
Or call: BISSELL Consumer Services
1-800-263-2535
Monday - Friday 8 a.m. - 10 p.m. ET
Saturday 9 a.m. - 8 p.m. ET
Or write: BISSELL Canada Corporation
ATTN: Consumer Services
Box 1003,
Niagara Falls, ON L2E 6W2

*EXCEPTIONS AND EXCLUSIONS FROM THE TERMS OF THE LIMITED WARRANTY

BISSELL CANADA CORPORATION IS NOT LIABLE FOR INCIDENTAL OR CONSEQUENTIAL DAMAGES OF ANY NATURE ASSOCIATED WITH THE USE OF THIS PRODUCT. BISSELL'S LIABILITY WILL NOT EXCEED THE PURCHASE PRICE OF THE PRODUCT.

THIS WARRANTY IS EXCLUSIVE AND IN LIEU OF ANY OTHER WARRANTIES EITHER ORAL OR WRITTEN. ANY IMPLIED WARRANTIES WHICH MAY ARISE BY OPERATION OF LAW, INCLUDING THE IMPLIED WARRANTIES OF MERCHANTABILITY AND FITNESS FOR A PARTICULAR PURPOSE, ARE LIMITED TO THE ONE YEAR DURATION FROM THE DATE OF PURCHASE AS DESCRIBED ABOVE.



©2004 BISSELL Homecare Inc.
BISSELL Canada Corporation
Niagara Falls, ON, L2E 6W2
All rights reserved.
Part Number 310-5821
Visit our Web Site at:
www.bissell.com