

# PARTS LIST

for

# **KitchenAid®**

## **2-SLICE TOASTER**

### **2 EXTRA-WIDE SLOTS**

#### **MODELS:**

**KTT340WH0 (White)**  
**KTT340BU0 (Cobalt Blue)**  
**KTT340OB0 (Onyx Black)**  
**KTT340ER0 (Empire Red)**  
**KTT340PK0 (Pink)**  
**KTT340TG0 (Tangerine)**  
**4KTT340WH0 (White)**  
**4KTT340OB0 (Onyx Black)**



FOR CUSTOMER SATISFACTION ALWAYS USE  
FACTORY SPECIFICATION PARTS



# HOUSING PARTS

For Models: KTT340\_\_0, 4KTT340\_\_0

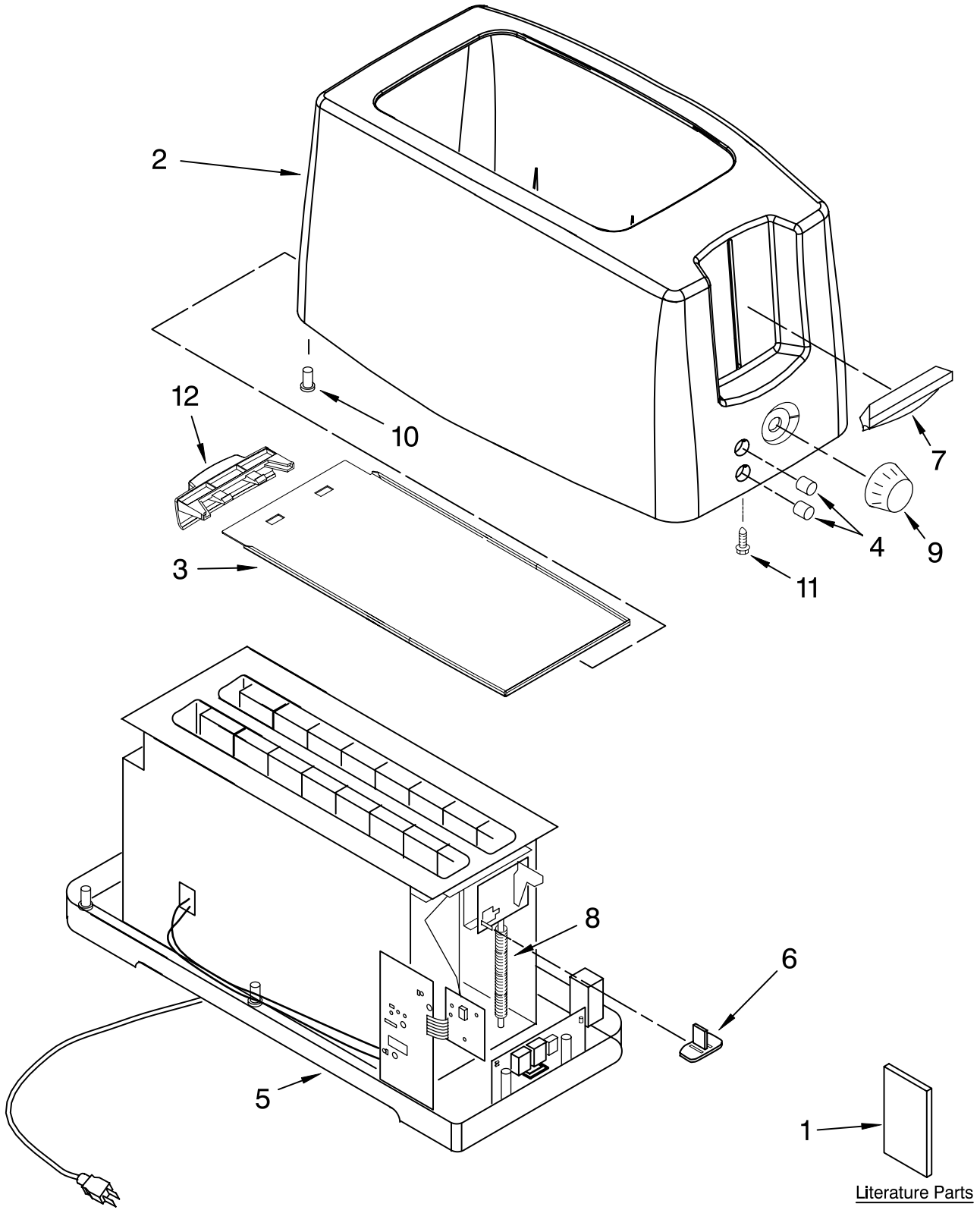

Literature Parts

FOR ORDERING INFORMATION REFER TO PARTS PRICE LIST

# HOUSING PARTS

For Models: KTT340\_\_0, 4KTT340\_\_0

Illus. No.	Part No.	DESCRIPTION
1		Literature Parts
	8204530	Guide, Use & Care
	8211951	Repair Parts List
2		Housing, Upper Assembly (Includes Item 4)
	8211909	White
	8211911	Cobalt Blue
	8211912	Onyx Black
	8211910	Empire Red
	8212268	Pink
	8212272	Tangerine
3	8211950	Tray, Crumb
4		Button, Function
	8211948	Top
	8211949	Bottom
5		Base-Core Assembly (Not Serviced)
6	4176690	Holder, Magnet
7		Knob, Lifter
	4176791	White
	4176792	Cobalt Blue
	4176793	Onyx Black
	4176794	Empire Red
	8212269	Pink
	8212273	Tangerine
8	4176801	Spring, Compression
9		Knob, Darkness
	8211940	White
	8211941	Cobalt Blue
	8211942	Onyx Black
	8211943	Empire Red
	8212271	Pink
	8212275	Tangerine
10	4176775	Foot, Rubber
11	4176800	Screw, Housing
12		Handle, Crumb Tray
	8211944	White
	8211945	Cobalt Blue
	8211946	Onyx Black
	8211947	Empire Red
	8212270	Pink
	8212274	Tangerine

FOR ORDERING INFORMATION REFER TO PARTS PRICE LIST