

Read & Save This  
Instruction Manual

# Instruction Manual



Box Fan  
Evaporative  
Cooler

Model  
**BFC2200**

FROM  
THE ESSICK  
FAMILY



ES-1-022M  
1

Lea y mantenga este  
manual de instrucción

# Manual de Instrucción



Enfriadera  
con  
Ventilador  
de Caja

Ejemplo  
**BFC2200**

DE LA  
FAMILIA  
ESSICK



ES-1-022M  
1

**C**ongratulations on your Essick purchase. It's the best cooler your money can buy! Your new box fan cooler functions two ways: as an evaporative cooler and as a fan.



**ESSICK AIR**

5800 Murray Street  
Little Rock, AR 72209

[www.essickair.com](http://www.essickair.com)

ES-1-022M  
2

71096/E-018-December 2003

**F**elicitaciones en su compra de Essick. ¡Es la mejor enfriadera su dinero puede comprar! Su nueva enfriadera de caja funciona de dos maneras: como una enfriadera y como un ventilador.



**ESSICK AIR**

5800 Murray Street  
Little Rock, AR 72209

[www.essickair.com](http://www.essickair.com)

ES-1-022M  
2

71096/E-018-December 2003

# EVAPORATIVE COOLER OPERATION



**WARNING:** To reduce the risk of fire or electrical shock, do not use this fan with any solid state speed control device.

Unpack your Essick cooler and select the area you wish to cool. Evaporative coolers work best near a partially opened window to draw in fresh air. An equal amount of air should be discharged out of the room to dispel heat and humidity. The cooler can be placed on the floor or on a table. Pour water into the water trough located in the lower portion of the back grille. The reservoir holds 3 1/4 gallons of water. The level can be seen through the front grille. **DO NOT OVER FILL.** Water will leak out and could cause water damage to the surrounding area. If the reservoir runs dry, it will not harm the pump.

When transporting the unit to a different location, be very careful not to spill the water. It is best to re-locate the cooler, and then add water. Plug the electrical cord into a 115-120 volt grounded outlet. You may operate your cooler on one of three speeds: low, medium or high. Turn the switch knob clockwise to activate the pump and fan. This will cool the air. Turn the switch counterclockwise to operate the cooler as a fan only (pump will be off).

**FAN OPERATION** When you operate your cooler without the water circulating, it functions as a fan to circulate air.

ENGLISH  
3

# TROUBLE SHOOTING



**CAUTION:** Always unplug the cooler before attempting service of any kind.

**PROBLEM:** COOLER DOES NOT PUMP WATER

- POSSIBLE CAUSE/REMEDY:**
1. The pump hose may have worked loose. Check the connection at the pump and at the water tube located in the back grille assembly. Reconnection of pump hose is necessary.
  2. The water tube may be blocked. Remove the tube and clean it out to make sure water holes are clear.
  3. The pump or switch may be defective. Replace pump or switch, if necessary.

**PROBLEM:** FAN DOES NOT OPERATE

- POSSIBLE CAUSE/REMEDY:**
1. Check the electrical outlet to verify it provides 115-volt power. Check fuse or breaker to ensure no fuses are blown or breaker switches thrown.
  2. The fan switch or motor may be defective. Replace switch or motor, if necessary.

ENGLISH  
5

# MAINTENANCE



**CAUTION:** To reduce the risk of fire, always unplug the cooler before attempting service of any kind.

- MOTOR** The motor does not require oil or lubrication. It is permanently lubricated at the factory.
- PUMP** The pump does not require oil or lubrication. Clean any debris under the pump in the inlet area.
- FILTER** The filter should be replaced each season, if it becomes dirty or clogged.
- WATER TANK** Drain and clean the water tank. To drain, disconnect the clear hose from the black tube in the back grille. Turn unit on "COOL" and pump out most of the water. Wipe dry and clean with a towel. Before reattaching the back grille, reconnect the clear hose to the black water tube.
- TOUCH UP** Use spray paint on the interior of the cabinet to touch up scratches or dings, if necessary.

ENGLISH  
4

# LIMITED WARRANTY

This warranty is extended to the original purchaser only. It does not cover damages incurred during shipping or through accident, neglect, or abuse by the owner. Essick Air Products, Inc. does not authorize any person or representative to assume any other or different liability in connection with this cooler.

**TERMS AND CONDITIONS OF WARRANTY** All original parts provided by Essick Air Products, Inc. are warranted against defects in material or factory workmanship for one year.

**EXCLUSIONS FROM WARRANTY** Essick Air Products, Inc. is not responsible for incidental or consequential damage resulting from any malfunction.

Essick Air Products, Inc. is not responsible for any damage occurring from the use of water softeners, chemicals, materials that de-scale, or if a higher horsepower motor than what Essick Air Products, Inc. recommends is used in the unit.

Essick Air Products, Inc. is not responsible for the cost of service calls to diagnose cause of trouble, or labor charge to repair and/or replace parts.

**HOW TO OBTAIN SERVICE UNDER THIS WARRANTY** Contact the Dealer where you purchased the evaporative cooler. If for any reason you are not satisfied with the response from the Dealer, contact the Customer Service Department: Essick Air Products Inc. 5800 Murray Street, Little Rock, Arkansas 72209. 1-501-562-1094.

ENGLISH  
6

# REPLACEMENT PARTS LIST

## LA LISTA DE PARTES REEMPLAZO

NO.	PART NO.	DESCRIPTION	DESCRIPCIÓN
1	71135	Front grille	La rejilla anterior
2	523095	Water pan	Cacerola de rege
3	71085	Blade	La hoja
4	71079	Fan mount (2 req'd)	La monta de la hoja (2 req'd)
5	514491	Motor mount (2 req'd)	La monta del motor (2 req'd)
6	581249	Motor	El motor
7	71086	Housing	Albegue
8	523097	Handle	El asidero
9	71084	Knob	La perilla
10	70817	Switch	El interruptor
11	598429	Hose	La manguera
12		See #21	Vea #21
13		See #21	Vea #21
14	516037	Tube	El tubo
15	523089	Cap	La tapa
16	71078	Back grille	Rejilla del apoye
17	71110	Pad retainer	Iguala de colchón
18	595153	Power cord	Cuerda de accione
19	71091	Pump mount	La monta de la bomba
20	581189	Pump	La bomba
21	512462	Pad assembly	Asamblea de colchón
22	71096	Owner's manual (not shown)	Manual del dueño (no mostrado)

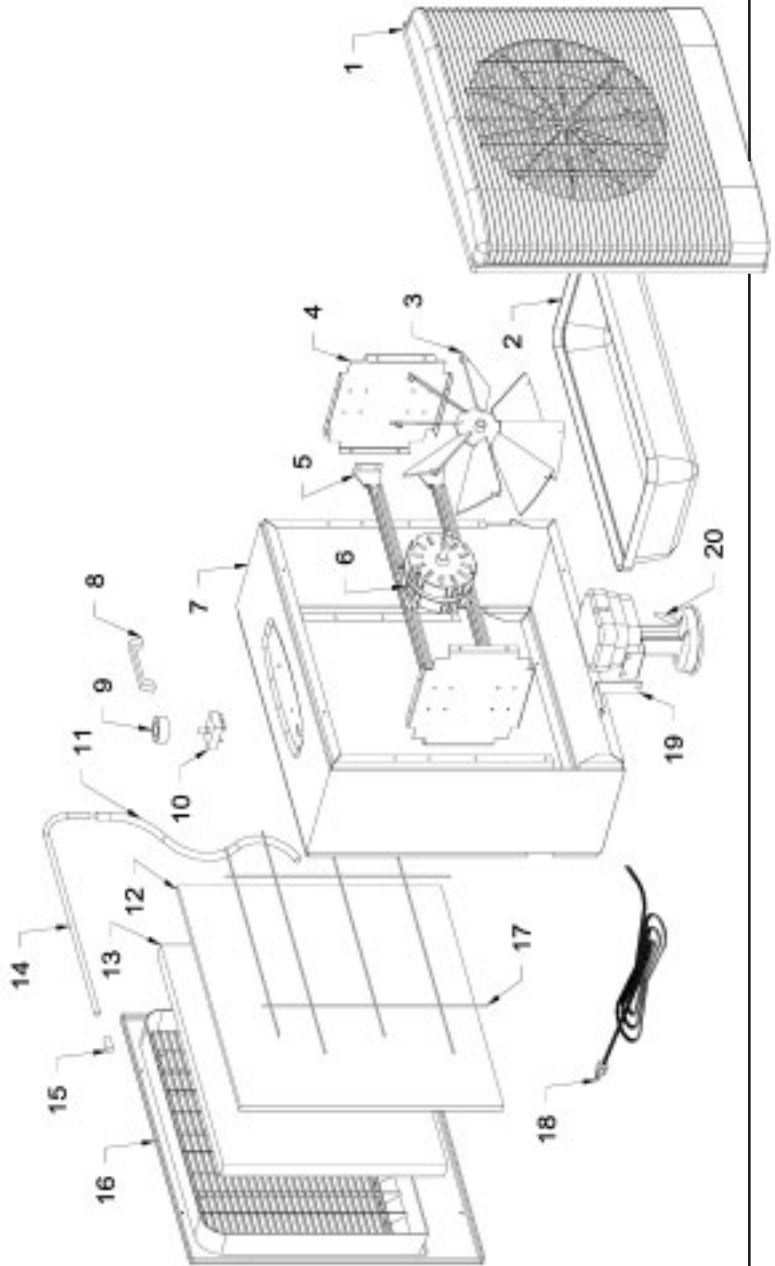

WIRING DIAGRAM

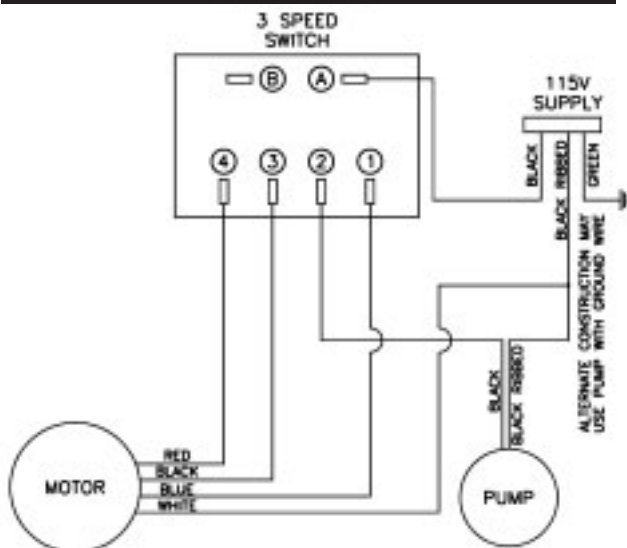

DIAGRAM DE CABLEADO

