

This Owner's Manual is provided and hosted by [Appliance Factory Parts](#).



MOIST AIR MAO601 Owner's Manual

[Shop genuine replacement parts for MOIST AIR
MAO601](#)



[Find Your MOIST AIR Humidifier Parts - Select From 4 Models](#)

----- Manual continues below -----

READ AND SAVE THESE INSTRUCTIONS
Use and Care Guide

MoistAir

TOWER HUMIDIFIER
6 Gallon Output with
Digital Readout
Model MA0600



**5800 Murray St.
Little Rock, AR 72209
1-800-547-3888**

CAUTION: Before using this product, read this manual and follow all its Safety Rules and Operating Instructions.



Essick

**5800 Murray St. L
www.mo**

1B71754

Printed in China
04/08

Part No. 1B71754

GENERAL SAFETY INSTRUCTIONS

Safety Signal Words

DANGER: Means if the safety information is not followed someone will be seriously injured or killed.

WARNING: Means if the safety information is not followed someone could be seriously injured or killed.

CAUTION: Means if the safety information is not followed someone may be injured.

1. To reduce the risk of fire or shock hazard, plug humidifier directly into a 120 V, A.C. electrical outlet. Do not use extension cords.
2. Keep the electric cord out of traffic areas. To reduce the risk of fire hazard, never put the electric cord under rugs, near heat registers, radiators, stoves or heaters.
3. Always unplug the humidifier before moving it, before cleaning, or whenever the humidifier is not in service.

WARNING: To reduce risk of fire, electric shock, or injury always unplug before servicing or cleaning.

4. Keep the humidifier clean
5. Do not put foreign objects inside the humidifier.
6. Do not allow to be used as a toy. Close supervision is necessary when used by or near children.
7. Never use your humidifier while any part is missing or damaged in any manner.
8. To reduce the risk of electrical hazard or damage to humidifier, do not tilt, jolt or tip humidifier while unit is running.
9. To reduce the risk of damage to humidifier, unplug when not in use.
10. To reduce the risk of accidental electrical shock, do not touch the cord or controls with wet hands.
11. To reduce the risk of fire, do not use next to an open flame source, such as a candle or other flame source.
12. Note the warning label shown adjacent.

Table of Contents

General Safety Information	2	Operating the Controls.....	7
Know Your Humidifier	3	Using Your Humidifier	8
How Your Humidifier Works	4	Filter Replacement and Care	10
Getting your Humidifier Up and Running.....	4	Cleaning and Maintenance	11
Location	4	Troubleshooting	13
Electrical Hook-up	5	Parts List for Moist Air P/N MA0600	14
Water Fill.....	6	Warranty Information	15
Setting the Controls.....	7		

**Moist Air
HUMIDIFIER WARRANTY**

**EFFECTIVE AS OF 10/1/00
SALES RECEIPT REQUIRED
FOR ALL WARRANTY CLAIMS**

This product is warranted against defects in workmanship and materials from the date of sale except for motors, which are warranted for a limited period. This warranty does not apply to filters or wicks which are consumable items. This warranty applies only to the original purchaser of the product purchased from a reputable retailer/dealer.

This warranty does not apply to damage from unauthorized repairs, unauthorized use, misuse, or accidents, including failure to perform reasonable maintenance. The warranty is void if the connected voltage is more than 5% above the rated voltage or if the equipment or products being improperly installed. See this Owner's Manual.

Alterations include the substitution of name brand wicks and bacteria treatment.

THIS PRODUCT IS NOT INTENDED FOR CHILDREN. THE WARRANTY IS LIMITED AND EXCLUSIVE WARRANTY GIVEN BY MANUFACTURER. THE PRODUCTS AND, TO THE MAXIMUM EXTENT PERMITTED BY LAW, THE MANUFACTURER DISCLAIMS ALL OTHER WARRANTIES, EXPRESS OR IMPLIED, ARISING BY OPERATION OF LAW OR OTHERWISE, INCLUDING WITHOUT LIMITATION, MERCHANTABILITY AND FITNESS FOR A PARTICULAR PURPOSE.

No employee, agent, dealer or other person is authorized to make any conditions on behalf of the manufacturer. The manufacturer is not responsible for costs incurred in the removal or reinstallation of the product.

Within the limitations of this warranty, purchaser must contact customer service @ 800-547-3888 for return of the unit for repair. A copy of the sales receipt is required. Authorization to return a unit for repair is approved only if the unit is replaced by the manufacturer, at its discretion, at no charge to the purchaser. It is agreed that such remedy is the sole remedy available from the manufacturer and that the purchaser shall not be PERMITTED BY LAW, THE MANUFACTURER DISCLAIMS ALL OTHER DAMAGES OF ANY KIND, INCLUDING INCIDENTAL DAMAGES OR LOSS OF PROFITS OR REVENUE.

This warranty will be null & void if purchaser replaces any parts which are mechanical or electrical.

The warranty gives the customer specific legal rights which vary from province to province.

Parts List for MoistAir Humidifier Model No. MA0600

KNOW YOUR HUMIDIFIER

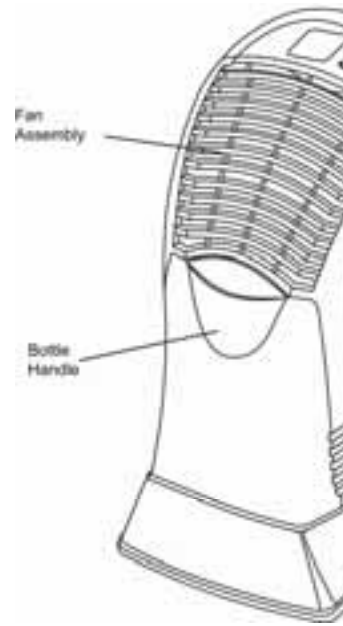
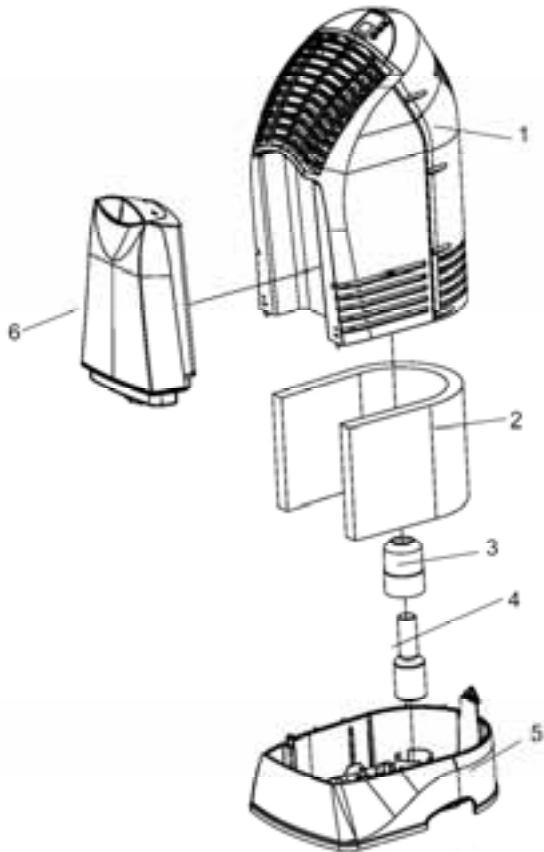

Always order by part number - Not by key number

Key No.	Part No.	Description
1	MA0600	* Housing, Upper Assembly (includes all parts 1-7)
2	MAF2	± Filter
3	831188-1	Support, Float
4	831189	Float, Reservoir
5	1B71760	Base
6	1B71762	Bottle Assembly
7	1B71754	Operator's Manual (not shown)

± Stock item - May be secured through the Hardware Department of most retail stores.

Description
* Gallon Output 24/hrs
Capacity of Bottle
Capacity of Base
* Sq. Ft. Coverage
Fans Speeds
Replacement Filter
Auto Humidistat
Auto Shut Off
Controls
UL/CUL Listed
Volts
Hertz
Amps (High Speed)
Watts (High Speed)

* Based on an area with average ins

How Your Humidifier Works

Your new humidifier is designed to satisfy home humidity requirements through the principle of evaporation of water in the air.

Once the filter becomes saturated, air is drawn in, passes through the filter and moisture is absorbed into the air. All evaporation occurs in the humidifier so any residue remains in the filter. This natural process of evaporation virtually eliminates white dust.

CAUTION: To reduce the risk of injury, fire or damage to humidifier, use only cleaners specifically recommended for humidifiers. Never use flammable, combustible or poisonous materials to clean your humidifier. To reduce the risk of scalds and damage to humidifier, never put hot water in humidifier.



Getting Your Humidifier Up and Running

Once removed from its carton, remove all packing materials. Verify the filter is properly installed (See page 10).

Step 1. Location

WARNING: For your own safety, do not use humidifier if any parts are damaged or missing.

Selecting a Location

Place humidifier on a flat level surface; take extra care in leveling when placing the unit on carpet. Position the humidifier where the most humidity is needed or where the most air will be circulated throughout the house such as near a cold air return.

Moist air (humidity) produced will disperse into the whole house, but the area closest to the unit will have the highest humidity. If the unit is positioned close to a window, condensation may form on the window pane. If this occurs the unit should be repositioned in another location.

Troubleshooting

Trouble	Probable Cause
Digital display not illuminated.	<ul style="list-style-type: none"> No Power Power button has not been depressed.
Fan not operating (digital display is illuminated).	<ul style="list-style-type: none"> ROOM humidity level is more below SET humidity level. Reservoir is empty.
Fan running continuously.	<ul style="list-style-type: none"> SET humidity level is reached. ROOM humidity level is reached 1% or more above humidity level.
Poor evaporation of water.	<ul style="list-style-type: none"> CHECK FILTER message flashing. Mineral buildup on filter.
Bottle empties completely.	<ul style="list-style-type: none"> This is normal for initial filling.
Bottle continues to empty after complete filling.	<ul style="list-style-type: none"> Air is entering water bottle.
Bottle not emptying.	<ul style="list-style-type: none"> Spring Valve Assembly or missing post in bottle. Base full of water.
Display blinks or fan moves slightly when humidifier is plugged in.	<ul style="list-style-type: none"> Normal
Fan operating slower than speed registered on digital display	<ul style="list-style-type: none"> Humidifier in "DRY OUT MODE"
Humidifier not shutting off during "DRY OUT MODE"	<ul style="list-style-type: none"> Filter not dry.
Alternating "F" and room humidity displayed.	<ul style="list-style-type: none"> Reservoir is empty.
Alternating "CF" and room humidity displayed.	<ul style="list-style-type: none"> Filter may be dirty.

Step 3

Bi-Weekly Maintenance

Removing Scale

1. Fill the humidifier base with water and add one 8-ounce cup of white vinegar. Let solution stay 20 minutes.
2. Clean all interior surfaces with a soft brush. Dampen a soft cloth with white vinegar and wipe out the base to remove scale.
3. Rinse thoroughly with clean warm water to remove scale and cleaning solution.

Disinfecting Base

1. Pour 1/2 gallon of water and 1/2 teaspoon chlorine bleach into the base. Let solution stay for 20 minutes, carefully swishing every few minutes. Wet all surfaces normally exposed to water.
2. Empty base after 20 minutes. Rinse with water until bleach smell is gone. Allow unit to dry out completely.

NOTE: The water bottle should be cleaned in the same manner as the base. Rinse thoroughly with clean water after all steps are complete.

End of Season Maintenance

1. Follow "Bi-Weekly Maintenance" instructions at end of humidification season.
2. Remove filter.
3. Let humidifier dry completely before storing.
4. Store in cool, dry location.
5. Install a new filter in clean humidifier before next season begins.

NOTE: "Bi-Weekly Maintenance" procedure is also recommended if you do not plan to run the humidifier for one week or more.



Positioning the Unit

The humidifier should be positioned with the back (cord exit side) and sides, at least 2 inches away from the wall. Air needs to enter through all of the louvers in the housing assembly in order for the humidifier to operate at peak efficiency.

NOTE: Be sure humidistat (located approximately 4 inches outside humidifier body on power cord) is free from obstruction and away from any hot air register.

NOTE: Due to release of cool, moist air from away from thermostat and hot air registers inside wall. Unit should not be placed where air from a hot air register blows directly on it.

Step 2. Electrical Hook-Up

Locate nearest 120V A.C. wall socket in the inside wall. With the humidifier in the desired location, mark the wall for the outlet safely so no one will trip or knock over the unit.

Plug in the electrical cord.

WARNING: To reduce the risk of fire or shock, do not plug the humidifier into a 120V A.C. outlet. Do not use extension cords.

To reduce the risk of electrical shock, this humidifier has a polarized plug (one blade is wider than the other). This plug will fit in a polarized outlet only one way.

If the plug does not fit fully in the outlet, reverse plug. If it still does not fit, contact a qualified electrician to install the proper outlet. Do not change the plug in any way.

Step 3. Water Fill

WARNING: To reduce the risk of fire or shock hazard, do not pour or spill water into control or motor area. If controls get wet, let them dry completely and have unit checked by qualified service personnel before plugging in.



After the humidifier is positioned where it will be operating, you are ready to fill the humidifier. The bottle tilts out and away from the base. Take care not to bump or damage fill valve assembly on the bottom of the bottle.

Invert the bottle. Press the valve stem button into the bottle and turn clockwise to lock in open position. Place bottle under the faucet. Fill the bottle, being careful not to allow any debris to get in the valve seating. Once the bottle is full, press the valve stem button and turn counter clockwise to release and close.

CAUTION: Use only EPA Registered Bacteriostat. **Under no circumstances** should you use water treatment products designed for Rotobelt or Ultrasonic humidifiers.

Place the water bottle back into the humidifier base. When positioned properly, the plunger will open and the water will flow into the base. The base will hold the entire contents of the water bottle. Once the bottle is empty, remove it and repeat the filling process. The humidifier is now filled to capacity. For less frequent filling let the humidifier exhaust both the water from the bottle and the base before filling.

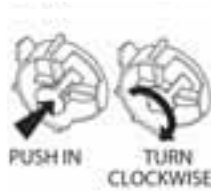

Press valve stem and turn clockwise to lock in open position - Counterclockwise to release and close

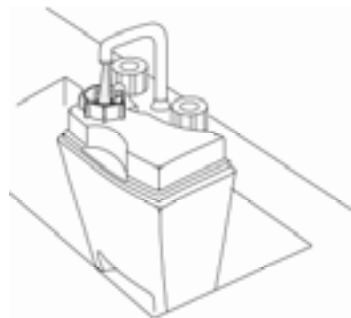
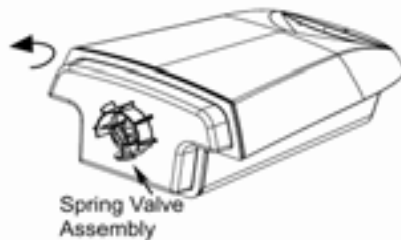

Cleaning and Maintenance

WARNING: To reduce the risk of shock, always unplug humidifier before cleaning or servicing. If humidifier is not unplugged, fan could start after housing is removed.

WARNING: To reduce the risk of injury, fire or damage to humidifier, use only cleaners specifically recommended for humidifiers. Never use flammable, combustible or poisonous materials to clean your humidifier. To reduce the risk of scalds and damage to humidifier, never put hot water in humidifier.

CAUTION: Local water purity varies from area to area and under certain conditions water impurities and airborne bacteria may promote the growth of microorganisms in the reservoir of the humidifier. To retard bacteria growth that may cause odors and be harmful to your health, use only recommended replacement filters. Also use EPA registered Bacteriostat.

Filter Replacement and Care

CAUTION: To help retard bacteria growth and keep maximum efficiency, the filter should be replaced at least once per season, or more often under hard water conditions. Use MAF2 replacement filter.

WARNING: To reduce the risk of shock or injury from moving parts, always unplug humidifier before removing or replacing any parts.

Replace the evaporative wicking filter at least once per humidification season or more depending on water conditions in your area.

Filter Replacement

1. Unplug humidifier. Before removing the filter, move the humidifier to an area not susceptible to water damage. (i.e. kitchen or bath areas).
2. Remove the water bottle and set aside. Be sure not to bump or damage the fill valve.
3. The upper housing and the base are held together by two hooks at the front of the housing and a flexible snap in the rear. To remove the housing, press in on the triangular shaped snap at the rear of the humidifier, below the cord exit, while lifting upward, tilting the upper housing forward to clear the hooks at the front of the base.
4. Set the upper housing aside. The filter is now accessible.

5. Take note of the filter position. Remove the filter. You may want to clean the base at this time. See the "Cleaning and Maintenance" section of this manual.
6. Install a new filter (MAF2) into the base. Position the filter between the uprights in the bottom of the base. The filter should be resting on the floor of the base.
7. Return the upper housing to the base by first placing the hooks located near the front of the base into the mating holes in the upper housing. Then tilt the upper housing down towards the base until the rear snap engages the main housing.
8. Reposition the humidifier to its operating position.
9. The humidifier is now ready to be filled for operation.



Step 4. Setting the Contr

Where you set your desired humidity levels depends on your personal comfort level, outside temperature and inside temperature. A starting Set point of 30%-40% ROOM humidity is recommended but there may be conditions that require a different setting.

**When O
Temper**

-10°F
2°F
10°F
≥ 20°F

The chart provided offers general guidelines.

IMPORTANT: Water damage may result on windows or walls. Humidity SET point condensation no longer forms. We recommend do not exceed 50%.

Operating the Controls

Digital Display

Press the power button once to turn the unit on* . Initially there is a slight delay while the electronics calibrate. Two bars (--) appear during this time.

Once calibration is complete a ROOM humidity reading between 20% – 95% will be displayed. A flashing 20 display indicates that the room humidity is less than 20%.

NOTE: The default settings at initial startup are **(LOW)** F1 fan speed and **65% SET** humidity. After desired settings are selected by the user, they remain as long as the unit remains plugged in and there is no power interruption. If the unit is unplugged the **original** default settings will be restored.

Operating the Controls - continued

Speed Button

This humidifier is equipped with a 3-speed fan control. Initially depressing the speed button will display the current speed setting. Each push of the speed button advances the mode through the settings of **(HIGH) F3**, **(MEDIUM) F2** and **(LOW) F1**.

The selected setting is displayed on the digital readout. The higher the setting, the faster water is evaporated and released into the air. **F1 (LOW)** is the quietest setting and is provided for conditions that do not require a rapid evaporation rate.

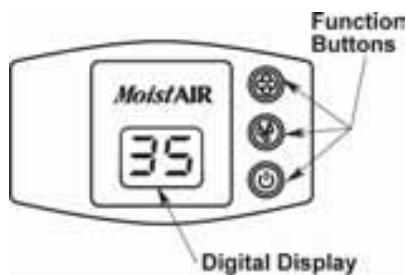

Using Your Humidifier

Refill Display

For maximum run time both the bottle and the base should be filled. When both the bottle and the base are empty the display alternates the room humidity reading and **"F" (FILL)**, indicating that additional water is required. Also at this time the unit will automatically switch into **DRY OUT MODE** and continue to run on the lowest speed until the filter is dry.

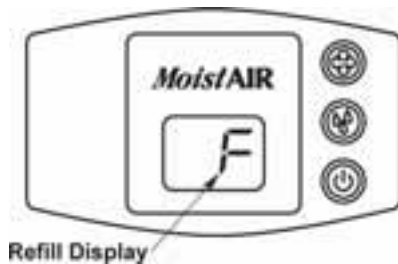

Humidity Control

This button allows you to adjust the humidity to suit your needs. This humidifier will automatically cycle on and off as required to maintain the selected setting. The readout displays both actual **(ROOM)** and desired **(SET)** humidity percentage (%) settings when humidity control button is pressed. The **ROOM** readout has a range of 20% to 95%. If the room humidity level is equal to or less than 20% the display will show a flashing 20.

The **SET** readout has a range of 25% to 65% and is adjusted in increments of 5%. Initially depressing the humidity button will display the current humidity setting. Each additional press of the button increases the setting by 5%. A **SET** point of 65% operates the humidifier continuously regardless of the **ROOM** reading. The humidistat that senses the readings is located on the power cord. Insure that it is free from obstructions.

NOTE: During this time the room humidity and the humidifier will cycle the fan on and off. The fan will shut off leaving you with a dry environment and mildew growth. If **DRY OUT MODE** is reached, the fan will return to the set speed.

NOTE: Fan automatically switches to low speed.

Check Filter Indicator

The ability of any humidifier to efficiently supply humidity output relies heavily on the condition of the filter. As the filter loads with impurities it gradually loses its wicking capability. When this happens, moisture output is reduced and the humidifier has to work longer to satisfy the selected setting. This humidifier has a check filter reminder timed to appear after 720 hours of operation. When display shows an alternating "CF" and "room humidity" setting at 5 second intervals it is a reminder to check the filter condition.

Humidistat

The humidistat located on the power cord senses the humidity in the air. It causes the humidifier to cycle on and off at the humidity **SET** point. The fan will turn on if the **ROOM** humidity is below the **SET** point and will continue to run until the **ROOM** humidity is above the **SET** point again.

NOTE: Be sure that the humidistat, which is located on the power cord, is free from obstruction and away from any hot surfaces.