

This Owner's Manual is provided and hosted by [Appliance Factory Parts](#).



Coleman 2000000850 Owner's Manual

[Shop genuine replacement parts for Coleman
2000000850](#)



[Find Your Coleman Camping Parts - Select From 855 Models](#)

----- Manual continues below -----



5-Year Limited Warranty

The Coleman Company, Inc. ("Coleman") warrants that for a period of five years from the date of original retail purchase, this product will be free from defects in material and workmanship. Coleman, at its option, will repair or replace this product or any component of the product found to be defective during the warranty period. Replacement will be made with a new or remanufactured product or component. If the product is no longer available, replacement may be made with a similar product of equal or greater value. No warranty is provided for batteries and lightbulbs. This is your exclusive warranty.

This warranty is valid for the original retail purchaser from the date of initial retail purchase and is not transferable. Keep the original sales receipt. Proof of purchase is required to obtain warranty performance. Coleman dealers, service centers, or retail stores selling Coleman® products do not have the right to alter, modify or in any way change the terms and conditions of this warranty.

What This Warranty Does Not Cover

This warranty does not cover normal wear of parts, parts that are not genuine Coleman® parts, or damage resulting from any of the following: negligent use or misuse of the product; use on improper voltage or current; commercial use of the product; use contrary to the operating instructions; disassembly, repair or alteration by anyone other than Coleman or an authorized service center. Further, the warranty does not cover Acts of God, such as fire, flood, hurricanes and tornadoes. Warranty void if damage to product results from the use of a part other than a genuine

How to

RECHARGE

BATTERIE

Pro

LANTERNE

RECHARGE

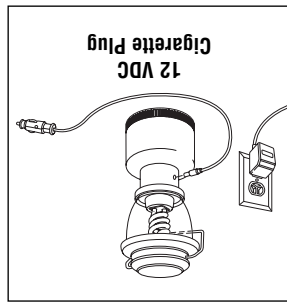

Fig. 1

overdischarging the battery can occur, immediately switch the storage (more than 6 months),

AC wall outlet in your home or in a car, boat, or RV, using the

turn base counterclockwise to

small plug from the lantern is

12 VDC cigarette lighter socket.

socket first! This caution applies

plug is used.

on and off by the ignition switch.

hole in the lantern collar.

electrical outlet. See Figure 1.

cord hole, will glow when the

the lantern is not being recharged.

continuously or intermittently.

ght and may be dim until it

ry should be recharged. If this is

cloth and mild dishwashing

lantern.

offers slower drain and longer

will never leak acid or corrosive

g power for many years.

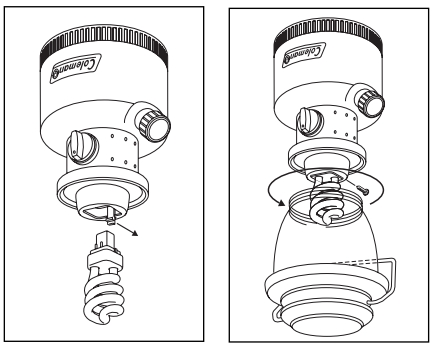

Fig. 3

Fig. 2

TO CHANGE FLUORESCENT BULB

NOTE: This lantern uses an 11-watt Spiral Fluorescent Bulb (See Parts List for replacement #).

1. With lantern in normal upright position, remove small screw along back side just below clear globe. See Figure 2.
2. Then remove top cover and globe by unscrewing counterclockwise as shown in Figure 2.
3. Pull the bulb-holder lever outward away from the fluorescent tube. See Figure 3. Then pull bulb from socket.
4. Handle new bulb by socket base only, avoiding contact with glass. Install new bulb and push lever inward to secure bulb in place.
5. Assemble top cover and globe to lantern by rotating clockwise until hand tight. Reinstall small screw on back side of lantern. Check that globe is securely fastened to lantern before transporting.

TO CHANGE NIGHTLIGHT BULB

NOTE: The nightlight in this lantern can be replaced with Coleman part number 5357-129.

1. Remove nightlight cap by twisting counterclockwise 1/4 turn until cap can be pulled away from lantern. See Figure 4.
2. Unscrew old bulb and replace with new bulb.
3. Reinstall nightlight cap by twisting clockwise 1/4 turn until cap is tight.

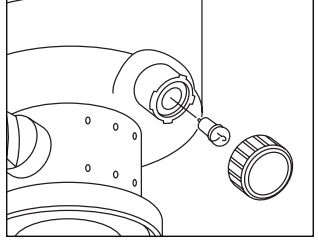

Fig. 4

Fluorescent tube(s) contains mercury (Hg) and must be recycled or disposed of according to local, state or federal laws. Call (800) 835-3278 or visit www.coleman.com/recycle for recycling instructions or safe disposal locations.



RECHARGEABLE BATTERY MUST BE RECYCLED OR DISPOSED OF PROPERLY. See recycling information that came with your Coleman Battery Lantern.



