

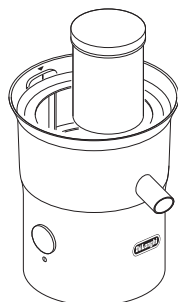

**INDUCTION JUICE EXTRACTOR
INSTRUCTIONS FOR USE
SAVE THESE INSTRUCTIONS**

**EXTRACTEUR DE JUS CENTRIFUGE
MODE D'EMPLOI
CONSERVEZ CE MODE D'EMPLOI**

**EXPRIMIDOR CENTRIFUGO
INSTRUCCIONES PARA EL USO
REPASE Y GUARDE ESTAS INSTRUCCIONES
LEA CUIDADOSAMENTE ESTE INSTRUCTIVO ANTES DE USAR
SU APARATO**



MODEL/MODELE/MODELO

DJE950

Register this product on-line and receive a free trial issue of Cook's Illustrated. Visit www.delonghiregistration.com.

Visit www.delonghiusa.com for a list of American service centers.

Visit www.delonghicanada.com for a list of Canadian service centers.

Enregistrez ce produit en ligne et recevez un numéro gratuit de Cook's Illustrated. Visitez www.delonghiregistration.com.

Visitez www.delonghiusa.com pour y voir une liste des centres de réparation des États-Unis

Visitez www.delonghicanada.com pour y voir une liste des centres de réparation Canadienne

Registre este producto en línea y reciba un ejemplar gratis de Cook's Illustrated. Visite www.delonghiregistration.com.

Visite www.delonghiusa.com para ver la lista de centros de servicios de los Estados Unidos

Visite www.delonghicanada.com para ver la lista de centros de servicios de Canadá

**ELECTRONIC CHARACTERISTICS/CARACTÉRISTIQUES ÉLECTRONIQUES
CARACTERISTICAS ELECTRICAS
120V~60HZ 300 W**



DESCRIPTION

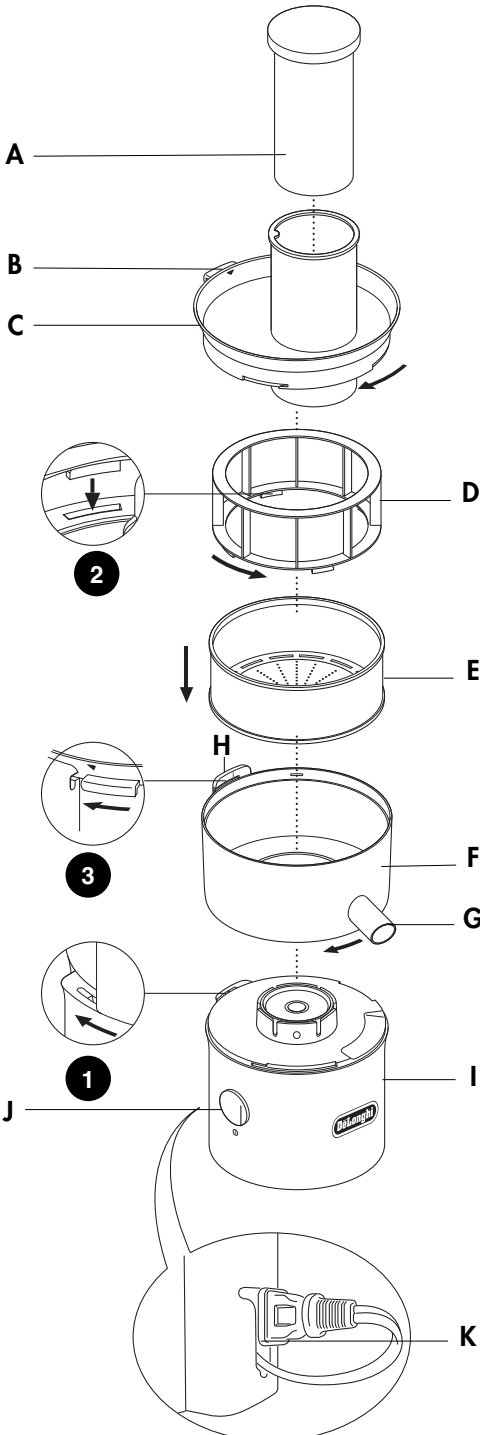

DESCRIPTION DE L'APPAREIL

- A Pousoir
- B Langue de verrouillage du couvercle
- C Couvercle
- D Dépulpeur
- E Tambour filtrant
- F Cuve
- G Orifice d'extraction du jus
- H Verrou
- I Unité motrice
- J Bouton de marche - arrêt
- K Logement du cordon d'alimentation



DESCRIPCIÓN DEL APARATO

- A Embudidor
- B Lengüeta de enclavamiento de la tapa
- C Tapa
- D Despulpador
- E Tambor del filtro
- F Bol
- G Boca de salida del zumo
- H Enclavamiento
- I Bloque motor
- J Botón de encendido/apagado
- K Guardacable

SAFETY PRECAUTIONS



When using electrical appliances, basic safety precautions should always be followed:

- Read all instructions.
- After removing the packaging, make sure the product is complete and undamaged. If in doubt, do not use the appliance and contact a qualified professional only.
- The plastic bag containing the product must not be left within reach of children as it represents a potential hazard.
- If the plug fitted to the appliance does not match the power socket, have the socket replaced with a suitable type by a qualified professional. The use of adapters, multiple sockets and/or extensions is not recommended. If their use is unavoidable, only adapters, multiple sockets and extensions complying with current safety standards and regulations should be used, taking care not to exceed the power limit indicated on the adapter and/or extension.
- In the event of malfunction, contact an authorized service center only.
- The appliance must be used only for those purposes for which it was specifically designed. Any other use is considered improper and thus dangerous. The manufacturer is not liable for damage caused by inappropriate, incorrect or irresponsible use of the appliance and/or repairs carried out by unqualified persons.
- Make sure that hands, hair, clothing and kitchen utensils are clear of the container before starting the appliance. Handle with care.

Special attention must be paid to the following fundamental safety rules:

- Do not use the juicer without the pulp remover or filter drum or if the filter is damaged.
- The cutting blades on the base of the filter drum are very sharp, take care when handling and cleaning the drum.
- Only use the food pusher supplied. Never put your fingers in the feed tube. Unplug before unblocking the feed tube.
- Before removing the lid, switch off and wait for the filter to stop.
- Never put the motor unit, cord or plug in water – you could get an electric shock.
- Switch off and unplug:
 - before fitting or removing parts
 - before cleaning
 - after use.
- Never use a damaged machine. Get it checked or repaired : see 'service'.
- Never use an unauthorized attachment.
- Never leave the machine on unattended.
- Never let the cord touch hot surfaces or hang down where a child could grab it.
- Don't touch moving parts.
- Always use the juicer on a flat, level surface.
- This appliance is not intended for use by persons (including children) with reduced physical, sensory or mental capabilities, or lack of experience and knowledge, unless they have been given supervision or instruction concerning use of the appliance by a person responsible for their safety.
- Children should be supervised to ensure that they do not play with the appliance.
- Only use the appliance for its intended domestic use. De'Longhi will not accept any liability if the appliance is subject to improper use, or failure to comply with these instructions.
- Save these instructions in a safe place for future reference.

SAVE THESE INSTRUCTIONS

HOUSEHOLD USE ONLY

SHORT CORD INSTRUCTIONS

A short power cord is provided to reduce the risk resulting from entanglement or tripping over a longer cord. Longer detachable power supply cords are available and may be used if care is exercised in their use. If a longer detachable power cord or extension cord is used the marked electrical rating of the extension cord should be at least as great as the electrical rating of the appliance, and the longer cord should be arranged so that it will not drape over the countertop or table top where it can be pulled on by children or tripped over unintentionally. The electrical rating of the appliance is listed on the bottom of the unit. If the appliance is of the grounded type, the extension cord should be a grounded type 3 wire cord. This appliance has a polarized plug. One blade is wider than the other. To reduce the risk of electrical shock this plug will fit in a polarized plug only one way. If the plug does not fit, contact a qualified electrician. Do not attempt to modify the plug in any way.

BEFORE USING FOR THE FIRST TIME

- 1 Wash the parts: see 'Cleaning'.
- 2 Store excess cord in the storage area "K" at the back of the juicer.

TO USE YOUR INDUCTION JUICE EXTRACTOR

With your Induction Juice Extractor you can enjoy the delicious, natural taste of the freshest juice - from your own choice of fruit and vegetables. And being a De'Longhi, it's easy to use. So enjoy a healthier lifestyle with your De'Longhi Induction Juice Extractor.

Preparing food

- Remove stones (plums, peaches, cherries, mangos etc).
- Remove tough skins (melons, pineapples, mangos, guava etc).
- Soft-skinned and other foods just need washing (apples, pears, carrots, radishes, lettuce, cabbage, parsley, spinach, grapes, strawberries, celery etc).

Assembly and use

- 1 Fit the bowl and turn clockwise until it locks ❶ .
- 2 Place the pulp remover into the filter drum and push down - ensuring the tabs fit inside the slots in the bottom of the drum ❷ .
- 3 Fit the filter drum – push down to ensure the drum is located correctly.
 - If the filter drum does not automatically drop down into the correct position, turn the basket slightly in either direction.
- 4 Put the lid on and turn clockwise until it locks ❸ and the arrow on the lid matches the line on the bowl.

Your juicer will not work if the lid is unlocked.
- 5 Place a suitable glass or jug under the juice spout.
- 6 Cut the food to fit the feed tube if necessary.
- 7 Plug in and the on/off button light will come on. Press the on/off button to operate the juicer - the light will glow brighter. Push the food down with the pusher.
 - After adding the last piece, let the juicer run for a further 20 seconds to extract all the juice from the filter drum.

Important

- If the juicer starts to vibrate, switch off and empty the pulp from the drum. (The juicer vibrates if the pulp becomes unevenly distributed).
- Maximum capacity that can be processed at one time is 2.2 lbs (1Kg) of fruit or vegetables.

- Some very hard foods may make your juicer slow down or stop. If this happens switch off and unblock the filter.
- Switch off and clear the pulp collector regularly during use.

TO TAKE YOUR JUICER APART

- Reverse the assembly procedure to take the juicer apart.

Hints

- Insert soft food slowly to get the most juice.
- Vitamins disappear - the sooner you drink your juice, the more vitamins you'll get.
- If you need to store the juice for a few hours put it in the refrigerator. It will keep better if you add a few drops of lemon juice.
- Don't drink more than three 8 fl.oz. (230mls) glasses of juice a day unless you're used to it.
- Dilute juice for children with an equal amount of water.
- Juice from dark green (broccoli, spinach etc) or dark red (beetroot, red cabbage etc) vegetables is extremely strong, so always dilute it.
- Fruit juice is high in Fructose (fruit sugar), so people with diabetes or low blood sugar should avoid drinking too much.

CLEANING

- Always switch off, unplug and dismantle before cleaning.
- For easier cleaning always wash the parts immediately after use.
- Never let the power unit, cord or plug get wet.
- Some foods, eg carrot, will discolour the plastic. Rubbing with a cloth dipped in vegetable oil helps remove discoloring.

Power unit

- Wipe with a damp cloth, then dry.

Filter

- Lift out the pulp remover and tap lightly to release the pulp.
- Clean using a soft brush.
- **Check the filter regularly for signs of damage. Do not use if the filter is damaged.**

Other parts

- Wash, then dry.
- Alternatively they can be washed on the top rack of your dishwasher. A short low temperature program is recommended.

TROUBLESHOOTING

Problem	Cause/Solutions
• Juicer will not work when on/off button is pressed.	• The juicer lid (C) or bowl (F) are not correctly locked. Ensure both parts are correctly locked.
• Juicer will not work when on/off button is pressed.	• Too much pulp has collected inside of the juice bowl. Empty pulp collector and wipe the excess juice from the exterior of the machine.



LIMITED WARRANTY

This warranty applies to all products with De'Longhi or Kenwood brand names.

What does the warranty cover?

We warrant each appliance to be free from defects in material and workmanship. Our obligation under this warranty is limited to repair at our factory or authorized service center of any defective parts or part thereof, other than parts damaged in transit. In the event of a products replacement or return, the unit must be returned transportation prepaid. The repaired or new model will be returned at the company expense.

This warranty shall apply only if the appliance is used in accordance with the factory directions, which accompany it, and on an Alternating current (AC) circuit.

How long does the coverage last?

This warranty runs for one year (1) from the purchase date found on your receipt and applies only to the original purchaser for use.

What is not covered by the warranty?

The warranty does not cover defects or damage of the appliance, which result from repairs or alterations to the appliance outside our factory or authorized service centers, nor shall it apply to any appliance, which has been subject to abuse, misuse, negligence or accidents. Also, consequential and incidental damage resulting from the use of this product or arising out of any breach of contract or breach of this warranty are not recoverable under this warranty. Some states do not allow the exclusion or limitation of incidental or consequential damage, so the above limitation may not apply to you.

How do you get service?

If repairs become necessary, see contact information below:

U.S. Residents:

Please contact our toll free hotline at 800-322-3848 or log onto our website at www.delonghi.com.

For all accessories, spare parts or replacement parts, please contact our parts division at 1-800-865-6330.

Residents of Canada: Please contact our toll free hotline at 1-888-335-6644 or log onto our website at www.delonghi.com.

Residents of Mexico: Please refer to the Limited Warranty statement for Mexico.

Please refer to the back page of the manual for De'Longhi addresses.

The above warranty is in lieu of all other express warranties and representations. All implied warranties are limited to the applicable warranty period set forth above. This limitation does not apply if you enter into an extended warranty with De'Longhi. Some states do not allow limitations on how long an implied warranty lasts, so the above exclusions may not apply to you. De'Longhi does not authorize any other person or company to assume for it any liability in connection with the sale or use of its appliance.

How does state law apply?

This warranty gives you specific legal rights, and you may also have other rights, which vary from state to state.



De'Longhi America, Inc.
Park 80 West, Plaza One
Saddle Brook, NJ 07663
1-800-322-3848

De'Longhi Canada, Inc.
6150 McLaughlin Road
Mississauga, Ontario
L5R 4E1 Canada
1-888-335-6644

Fiducia Italiana S.A de C.V.
Pestalozzi 814
Col. Del Valle
Del. Benito Juarez
México D.F. 03100
tels: 5543 1447 y 5543 6492
Lada sin costo: 01800 711 8805

www.delonghi.com