

This Owner's Manual is provided and hosted by [Appliance Factory Parts](#).

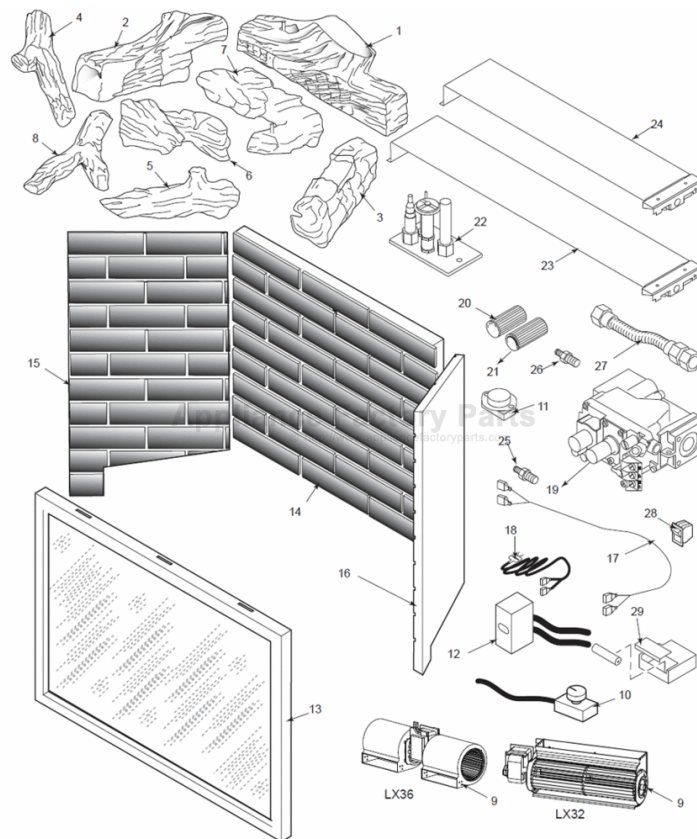

# MAJESTIC LEXINGTON LX36PV Owner's Manual

[Shop genuine replacement parts for MAJESTIC  
LEXINGTON LX36PV](#)



[Find Your MAJESTIC Fireplace Parts - Select From 585 Models](#)

----- Manual continues below -----



Lexington Series Direct Vent Fireplaces

MAJESTIC 

## Lexington Direct Vent Fireplace Series

Add the traditional look and warmth of a fireplace to any room with our wide selection of direct vent fireplaces from Majestic. These direct vent fireplaces combine the heritage appeal of fine craftsmanship with the convenience of contemporary technology to ensure optimal functionality and timeless beauty.

LX36 direct vent gas fireplace shown with the Nantucket arched front and arched screen doors in Brushed Pewter shown on cover



LX36 direct vent gas fireplace shown with Lexington arched front in Textured Black

Give people a place to gather – make fire the focal point of your room again with a direct vent fireplace from Majestic.



LX36 direct vent gas fireplace shown with the Nantucket decorative arched front in Gold Tone

### THE LEXINGTON DIRECT VENT FIREPLACE SERIES

The Lexington Fireplace Series, like all Majestic appliances, is built to stand the test of time. We understand that durability and performance are important criteria when selecting a fireplace for your home. While we deliver these features on every product we produce, we also know that more often than any other product, a fireplace is the focal point of a room. A fireplace adds value, comfort and beauty to any setting. Our designers and craftsmen have meticulously scrutinized every detail to ensure that you receive the finest fireplace built today.



## STANDARD FEATURES:

- Flush face design
- Ceramic glass with large viewing area –710 square inches (LX32) –802 square inches (LX36)
- Featuring the exclusive LexFire Burn System™ with a realistic detailed dual burner log set, a beautiful glow with five distinct flame areas and a large ember bed
- Optional decorative fronts and fire screen doors available in several different finishes
- Fireplace interior offers a beautiful, richly colored ceramic brick pattern
- Battery operated pilot ignitor
- Quick glass release
- Operator friendly deluxe control panel with color illustrated decal including Off/Pilot/On knob, Hi/Lo knob, blower control, optional remote receiver and an easily accessible shut off valve
- Variable flame control  
LX32–26,000 to 36,000 Btu/hr input (natural gas) and 22,000 to 38,000 Btu/hr input (propane gas)  
LX36–36,000 to 44,000 Btu/hr input (natural gas) and 32,000 to 44,000 Btu/hr input (propane gas)
- Up to 80% efficient
- Standard heat activated blower with variable speed control
- Built in adjustable flue restrictor
- Convertible top or rear flue outlet
- CSA design certified

## LEXFIRE BURN SYSTEM™

**Exclusive LexFire Burn System™** – combines all of the elements of a natural wood fire to produce flames so realistic, you'll forget it's not real wood.

**Realistic Logs** – starting with hand carved samples that are perfectly proportioned to fit the stove size and viewing area and then color enhanced to match real wood.

**Yellow Flames** – bright yellow flames appear almost translucent in color.

**Log glow** – as log surfaces heat up they produce a bright reddish orange glow, similar to wood in the secondary stages of combustion.

**Ember Bed** – a large area of burning ember replicates the look of wood in the final stages of combustion.

**Primary Combustion Zone** – primary combustion of fuel load.

**LexFire Burn** – gas and oxygen are precisely metered and strategically distributed to provide optimum flame presentation.

## PATENTED DIRECT VENT TECHNOLOGY



**Sealed Combustion Chamber** – The Lexington Series includes an air passage located between the inner and outer firebox to bring in fresh air from the outer wall of the dual chimney system. This initiates the combustion process while releasing flue gases safely and directly back outside through the vented exhaust system.

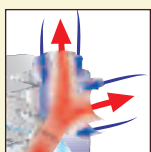

**Combustion Process** – The fresh air brought in from the sealed air passage mixes with gas and is then injected into the burner. It moves through the burner and is emitted through the unique hole design to create the unparalleled flame pattern and stunning realism which is the hallmark of the LexFire Burn System™.

**Chimney System** – Our dual chimney system allows outside air to be brought in for combustion, and flue gases to be released safely back outside. This ensures maximum efficiency and safety.



**Venting Options** – Vent vertically through the roof or horizontally through the wall with our unique venting system by simply removing a plate and rotating the elbow. Installation is trouble free.

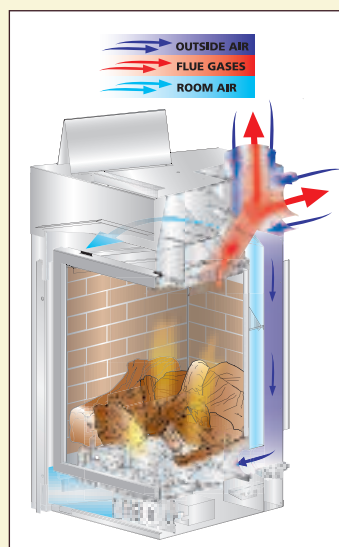

Install a complete system in just two easy steps and achieve the complete look of a designer fireplace.

### TWO EASY STEPS...

- Choose and set the fireplace model in place
- Select a decorative front design and choose from a number of luxurious decorative finishes

## The Lexington Series Direct Vent Fireplaces

| Model                                     | LX32              | LX36              |
|---|-------------------|-------------------|
| Shipping Weight (Lbs)                     | 215               | 225               |
| Width                                     | 39"               | 43"               |
| Depth                                     | 21 3/4"           | 21 3/4"           |
| Height                                    | 46 1/2"           | 46 1/2"           |
| Fire Viewing Area (Sq. Inch)              | 710               | 802               |
| Flue Size                                 | 4" x 6.625"       | 4" x 6.625"       |
| Fan                                       | 135 CFM           | 200 CFM           |
| BTU/hr Input Rate (NG)                    | 26,000–36,000     | 30,000–44,000     |
| BTU/hr Input Rate (LP)                    | 22,000–36,000     | 32,000–44,000     |
| FE/P4 Ratings (Cdn. Fireplace Efficiency) | 63% NG / 64.5% LP | 65% NG / 67.4% LP |
| Thermal Efficiency (%)                    | Up to 80          | Up to 80          |
| Heating Capacity (sq. ft.)                | 2,200             | 2,400             |

**Note:** Square foot heating capacities are approximations only. They will vary depending upon the level of insulation, climate, house design, ceiling height, ambient outside temperatures and how the appliance is operated. Tested to Canadian Standards Association's CSAP.4.1-02 testing method for measuring fireplace efficiency.

### Optional Accessories

The Lexington Series has many options and accessories available to compliment any style home. Choose from decorative fronts, fire screen doors and remote controls, wall switch or wall thermostat available for the added value of convenience.

Lexington decorative arched front—Textured Black and fire screen doors—Vintage Iron



Lexington decorative arched front—Brushed Pewter and fire screen doors—Brushed Pewter



Lexington decorative arched front—Vintage Iron and fire screen doors—Brushed Pewter



Multi-functional Ambient Technologies® remote controls available for all units



Programmable wireless wall thermostat with receiver



Touch screen hand held ON/OFF remote

Nantucket decorative arched front—Vintage Iron and fire screen doors—Vintage Iron



Nantucket decorative arched front—Gold Tone



Nantucket decorative arched front—Black



Nantucket decorative arched front—Brushed Pewter and fire screen doors—Brushed Pewter



Nantucket decorative arched front—Textured Black

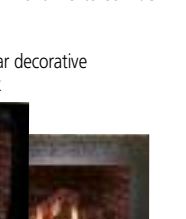

Nantucket rectangular decorative front—Textured Black



Nantucket rectangular decorative front—Black



Nantucket rectangular decorative front—Vintage Iron



For more information about MHSC and Majestic efficient and environmentally friendly products, please visit [www.majesticproducts.com](http://www.majesticproducts.com)



# MAJESTIC



A Brand of Monessen Hearth Systems Co.  
149 Cleveland Drive, Paris, Kentucky 40361  
[www.majesticproducts.com](http://www.majesticproducts.com)

Your Majestic Dealer:

To avoid personal injury or property damage, the product described by this brochure must be installed, operated and maintained in strict compliance with the instructions packaged with the product and all applicable building or fire codes. Contact local building or fire officials about restrictions and installation inspection requirements. All photographs and drawings on this brochure are for illustrative purposes only and are not intended for, nor should they be used as a substitute for the instructions packaged with the unit. Appearance and specifications of the product are subject to change without notice. © 2010 Monessen Hearth Systems Co.

Ver.01 1010MAJ