

This Owner's Manual is provided and hosted by [Appliance Factory Parts](#).



Bissell 17G5 Owner's Manual

[Shop genuine replacement parts for Bissell 17G5](#)



[Find Your Bissell Vacuum Cleaner Parts - Select From 376 Models](#)

----- Manual continues below -----

PRO lite®

USER'S GUIDE
17G5 SERIES



3 Safety Instructions

4 Product View

5 Assembly

6-8 Operations

8-12 Maintenance and Care

13 Troubleshooting

14 Consumer Services

15 Replacement Parts

15 Additional Accessories

16 Warranty



Part# 110-4164

Thank you for buying a BISSELL PROlite Multi Cyclonic vacuum

We're glad you purchased a BISSELL vacuum. Everything we know about floor care went into the design and construction of this complete, high-tech home cleaning system. By purchasing this product you are helping BISSELL with our commitment to reducing our impact on the environment through an expanding range of sustainable design efforts.

Your carpet cleaner is well made, and we back it with a limited five-year warranty. We also stand behind it with a knowledgeable, dedicated Consumer Services department, so, should you ever have a problem, you'll receive fast, considerate assistance.

My great-grandfather invented the floor sweeper in 1876. Today, BISSELL is a global leader in the design, manufacture, and service of high quality homecare products like your carpet cleaner.

Thanks again, from all of us at BISSELL.

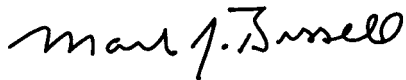

Mark J. Bissell

President and Chief Executive Officer

IMPORTANT SAFETY INSTRUCTIONS

When using an electrical appliance, basic precautions should be observed, including the following:

READ ALL INSTRUCTIONS BEFORE USING YOUR UPRIGHT VACUUM.

Always connect to a polarized outlet (left slot is wider than right). Unplug from outlet when not in use and before conducting maintenance.

WARNING: To reduce the risk of fire, electric shock, or injury:

- Do not modify the polarized plug to fit a non-polarized outlet or extension cord.
- Do not leave vacuum cleaner unattended when it is plugged in.
- Unplug from outlet when not in use and before servicing.
- Do not use outdoors or on wet surfaces.
- Do not allow children to operate vacuum cleaner or use as a toy.
- Close attention is necessary when used by or near children.
- Do not use for any purpose other than described in this User's Guide.
- Use only manufacturer's recommended attachments.
- Do not use with damaged cord or plug.
- If appliance is not working as it should, has been dropped, damaged, left outdoors, or dropped into water, have it repaired at an authorized service center.
- Do not pull or carry by cord, use cord as a handle, close a door on cord, or pull cord around sharp edges or corners. Do not run appliance over cord. Keep cord away from heated surfaces.
- Do not unplug by pulling on cord. To unplug, grasp the plug, not the cord.
- Do not handle vacuum cleaner or plug with wet hands.
- Do not put any object into openings. Do not use with any opening blocked; keep openings free of dust, lint, hair, and anything that may reduce air flow.

- Keep hair, loose clothing, fingers, and all parts of body away from openings and moving parts.
- Turn off all controls before plugging or unplugging vacuum cleaner.
- Use extra care when cleaning stairs.
- Unplug before attaching the TurboBrush.
- Do not pick up flammable materials (lighter fluid, gasoline, kerosene, etc.) or use in the presence of explosive liquids or vapors.
- Do not pick up toxic material (chlorine bleach, ammonia, drain cleaner, etc.).
- Do not use vacuum cleaner in an enclosed space filled with vapors given off by oil base paint, paint thinner, some moth proofing substances, flammable dust, or other explosive or toxic vapors.
- Do not pick up hard or sharp objects such as glass, nails, screws, coins, etc.
- Do not pick up anything that is burning or smoking, such as cigarettes, matches, or hot ashes.
- Do not use without filters in place.
- Use only on dry, indoor surfaces.
- Keep appliance on a level surface.

SAVE THESE INSTRUCTIONS FOR FUTURE USE

THIS APPLIANCE HAS A POLARIZED PLUG.

To reduce the risk of electric shock, this appliance has a polarized plug (one blade is wider than the other). This plug will fit in a polarized outlet only one way. If the plug does not fit fully in the outlet, reverse the plug. If it still does not fit, contact a qualified electrician to install a proper outlet. Do not change the plug in any way.

This model is for household use only.

Product view

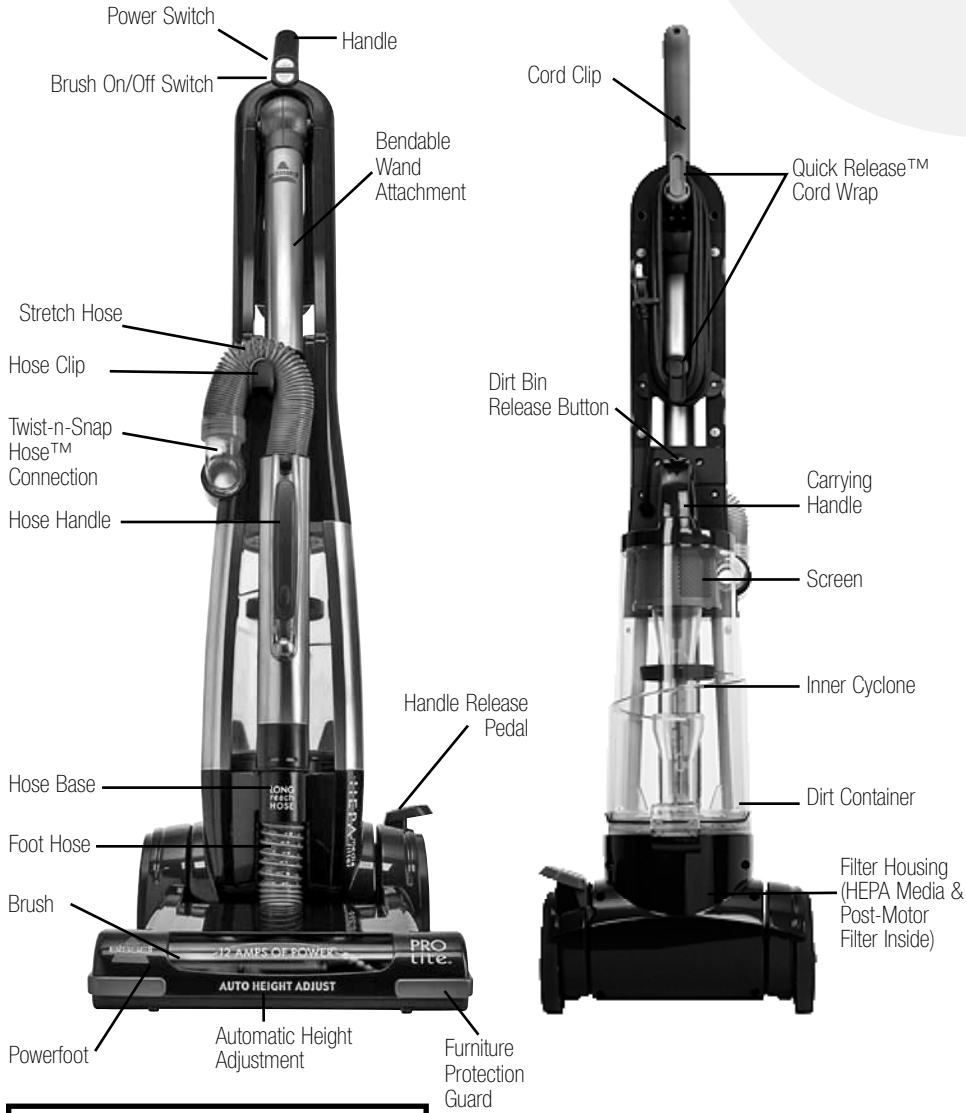

CAUTION:

Do not plug in your vacuum cleaner until you are familiar with all instructions and operating procedures.

Assembly

The only tool you'll need to assemble your vacuum cleaner is a Philips head screwdriver.

Remove handle and tools from box

1. Locate and remove the deluxe floor tool, extension wand, bendable wand attachment, dusting brush, TurboBrush®, crevice tool and accessory bag from box.
2. Locate and remove vacuum handle and Twist 'n Snap Hose and set aside.
3. Lift vacuum body out of box using carrying handle on dirt container.



WARNING:
Plastic film can be dangerous. To avoid danger of suffocation, keep away from babies and children.

Attach handle to vacuum

1. Take vacuum handle and remove the screw packet taped to the base of the handle.
2. Stand the vacuum upright and slide the base of the handle firmly into the grooves at the top of the vacuum body.
3. Check to be sure the handle is fitted to the vacuum body. If there is a gap in front, continue to push firmly until the handle is flush.
4. Insert the two screws from the screw packet into the existing holes. Tighten securely with a screwdriver.

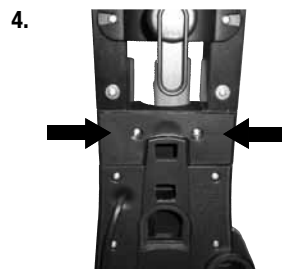
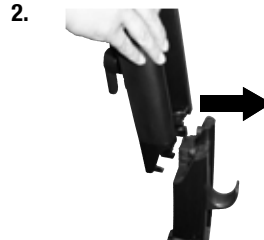

Attach vacuum hose & on-board tools

1. Position the Twist 'n Snap Hose assembly on the vacuum and line up the tabs on the base of the hose with the corresponding notches. Turn the Twist 'n Snap Hose to the right to lock into place.
2. Slide the end of the hose into the hose base. Make sure the tab on hose wand inserts into hole on front side of handle. Place the hose into the hose clip.
3. Snap the bendable wand attachment into front side of handle.
4. Place the remaining tools into accessory bag.

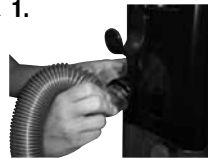

2.



3.



Operation

Power switch/brush power switch

The power switch is located on the handle just above the bendable wand attachment on the front of the vacuum. Push the "POWER" switch once to turn the vacuum on for cleaning, and push again to turn the vacuum off when cleaning is complete.

The Brush power switch is located just below the power switch on the handle and above the bendable wand attachment on the front of the vacuum. This switch turns the rotating brush on and off. The "BRUSH" power switch will turn on automatically when the "POWER" button is turned on and should be used for normal carpet cleaning. You may want to turn the brush power switch "OFF" by pressing the "BRUSH" switch once for bare floor cleaning or other delicate surfaces, or when using the hose.

Note: Your BISSELL PROlite Multi Cyclonic vacuum is equipped with a special internal switch that turns the rotating brush off whenever the unit is in the Upright position.

Handle position

1. **Upright-** For storage and above floor cleaning with special tools.
2. **Normal Cleaning-** Press handle release pedal once. Use for most household floor cleaning tasks.

Automatic height adjustment

The powerfoot on your vacuum has an automatic height adjustment and does not need to be manually adjusted when cleaning various floor surfaces. The foot design enables the vacuum to move directly from bare floors, to low pile and high pile carpets automatically.

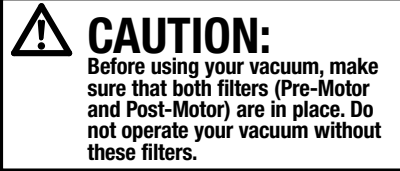

Tip:

Your vacuum features a Quick-Release Cord Wrap. To remove the power cord quickly and easily, rotate the upper cord wrap towards floor, and slip power cord from upper and lower cord wraps.

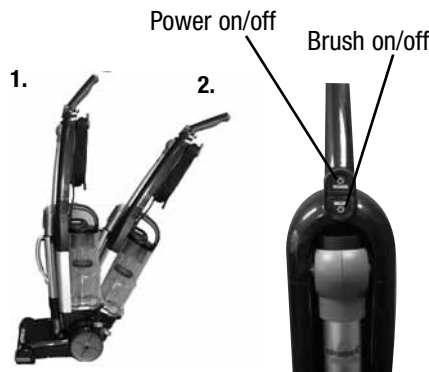

Tip:

Before cleaning under low furniture, check area first for objects that might harm the unit or block the Vacuum Hose.

Operation

Special tools

Your vacuum is not only a powerful floor vacuum cleaner, it's also a versatile above floor vacuum when you select one of the special tools.

1. Detach the vacuum hose by grasping the hose handle and lifting to separate from the hose grip base.
2. Attach tools by firmly pushing onto vacuum hose or extension wand.

Bendable wand attachment:

May be used for cleaning under couches, beds, dressers, and other hard to reach areas. Bend the top portion of the wand to desired angle and attach deluxe floor tool for cleaning.



Crevice tool:

Use in tight narrow spaces.

NOTE: The crevice tool does not store on board.



TurboBrush®

Use rotating brush action for small areas such as stairs and upholstery.

NOTE: Press gently when using the TurboBrush to gain maximum cleaning. Too much pressure could cause the brush to stop rotating. The TurboBrush does not store on board.



Deluxe floor tool:

Use with bendable wand attachment to clean under hard to reach areas. The pivoting lint brush bar collects hair, dust and other debris as you pull the attachment back, and releases debris into the suction path of the tool as you push it forward.

NOTE: The deluxe floor tool does not store on board.



Dusting brush:

Use brush to dust furniture, blinds, books, lamps, shelves, baseboards and other delicate surfaces.

NOTE: The dusting brush does not store on board.



Extension wand:

Use with desired attachment for a longer-reach.

NOTE: The extension wand does not store on board.



CAUTION:

Always place vacuum cleaner on floor in its fully upright position and make sure it is locked into place when using tools. Placing the PROlite in its full upright position automatically stops the rotating brush.

Operation

Power cord storage

When you are finished using your vacuum, return it to the Upright position and store the power cord.

1. Turn vacuum cleaner off by pushing the \odot power switch.
2. Unplug power cord by grasping the polarized plug (NOT the cord) and disconnect from outlet.
3. Loop power cord around cord wraps on back of handle.
4. Clip molded plug to power cord to secure.

Transporting cleaner

1. To move your vacuum cleaner from room to room, put the Handle in the Upright Position, tilt the cleaner back on its rear wheels and push forward.
2. The cleaner can also be moved by using the carrying handle on the dirt container.

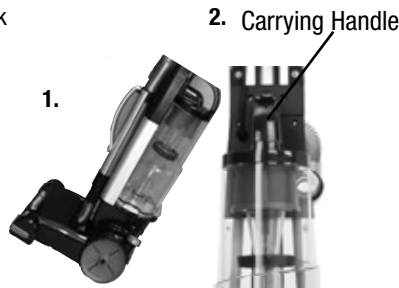

NOTICE:

While vacuuming, certain carpets and low humidity conditions may generate small static discharges. The discharges are entirely harmless and are not associated in any way with the main power supply.

Maintenance and care

To maintain maximum cleaning performance, the following maintenance steps must be performed:

1. Unplug cleaner from electrical outlet.
2. Empty the dirt container when the dirt reaches the "Full" line on the back.
3. Check the pre-motor filter at least once a month and clean and replace as needed.
4. Check and replace the HEPA media post-motor filter as needed.

NOTE: More frequent filter cleaning may be necessary if you are vacuuming new carpet, fine dust, or have allergy concerns.

Follow the instructions on the following pages to perform these simple maintenance steps.



WARNING:

To reduce the risk of electric shock, turn power switch OFF and disconnect polarized plug from electrical outlet before performing maintenance or troubleshooting checks.

Tip:

For maximum cleaning performance, check and clean or replace all filters as suggested.

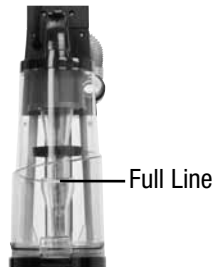

Maintenance and care

Emptying the dirt container

The dirt container needs to be emptied when the dirt reaches the “Full” line on the back of the container.

1. Press the release button on the top of the carrying handle to remove the dirt container.
2. Hold the dirt container over trash can and push the emptying button to open the bottom. Close the dirt container door when empty.
3. Replace dirt container on cleaner by aligning the bottom and pushing forward until it snaps into place.

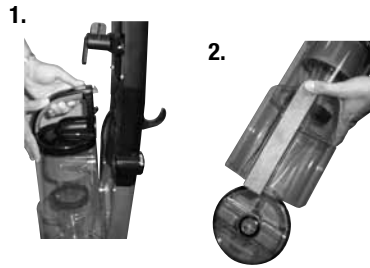

Cleaning the inner cyclone

Unplug the cleaner from electrical outlet.

1. The inner cyclone can be reached by removing the dirt container, releasing the debris door, reaching inside the tank and turning the entire assembly to the left to unlock. Pull straight down to remove.
2. The cyclone and screen may be separated for cleaning. Simply twist to unlock & firmly pull up on the screen to separate. Clean the screen with a cloth or soft brush to remove dust and debris.
3. The tank may also be wiped clean with a damp cloth. Make sure tank is completely dry before reassembling.
4. To reassemble, hold the carry handle and place the inner cyclone assembly back into tank and turning to lock. The section on the screen with no holes should be aligned with cyclone inlet. Close the bottom of the door after replacing.

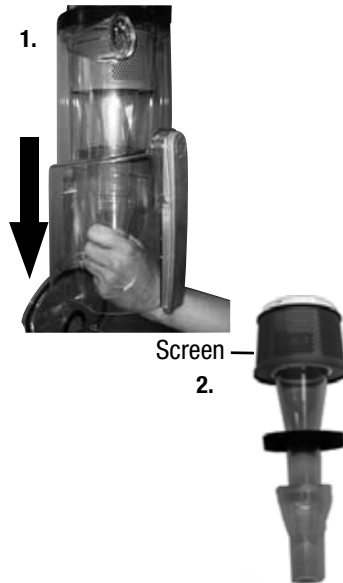

Maintenance and care

Cleaning the pre-motor and HEPA media post-motor filter

Unplug the vacuum from electrical outlet.

1. The pre-motor filter protects the motor from dirt particles. It is located in the filter compartment underneath the dirt container. If the filter becomes dirty, lift out the filter and clean. This filter may be hand washed in cold water with mild detergent. Rinse well and air dry thoroughly before replacing.
2. The HEPA media post-motor filter assists in the filtration process to return clean air to the room. It is also located in the filter compartment underneath the dirt container. If the filter becomes dirty, open the filter door, remove the filter and replace. The HEPA media filter is **not washable**.

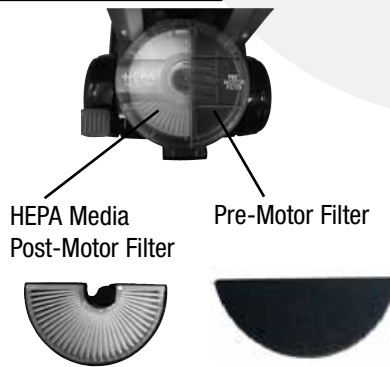

Rotating brush and drive belt maintenance

Check your vacuum cleaner's rotating floor brush and drive belt regularly for debris, wear or damage. Debris can wrap around the brush and hamper its ability to effectively clean your carpet.

1. Unplug cleaner from electrical outlet.
2. Recline handle and turn vacuum cleaner over so the bottom side is up.
3. Remove the five screws as shown with a Phillips head screwdriver. Lift the brush cover off.
4. Lift the rotating floor brush from the non-belt side and pull up and out until tension on belt loosens as shown. Slide the belt off the brush and motor pulley to remove brush completely.
5. Clean strings, hair and other debris from the brush. Brush ends caps are removable to allow for additional cleaning.
6. Check air passageway for obstructions. Remove any debris from this area. (see instructions on pg. 11)
7. Clean debris from the motor pulley and drive belt areas.
8. Check drive belt carefully for wear, cuts or stressed areas. If any damage is present, discard old drive belt and replace.

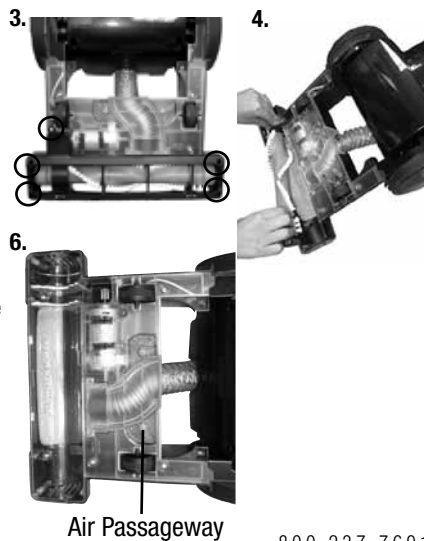
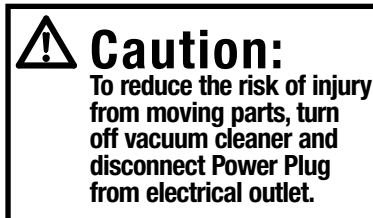

Maintenance and care

Rotating brush and drive belt maintenance continued

9. Place one end of the drive belt over motor pulley and the other end over the brush in the space between the bristles. Ensure the grooves on the belt line up with the grooves on the motor pulley and the brush.
10. Push the belt side of the brush down into the slots on the side and then push the non-belt side into the slots.
11. Reposition brush cover and screws. Tighten screws securely.
12. Plug in vacuum and make sure motor turns on.

10.



Brush reset

The brush power switch will blink 5 times and the motor will shut off if the rotating brush is jammed. To reset the brush, turn the cleaner off and unplug from the outlet. Remove the obstruction. The brush will automatically reset when the cleaner is plugged in and turned back on.

Cleaning clogs

Low suction or poor pickup may be due to a clog in the vacuum cleaner. If you notice a change in the sound of the motor or a reduction in the spinning action, check for clogs.

1. Unplug cleaner from electrical outlet.
2. Empty dirt container.
3. Check Tank for build up or clogs.
4. Remove the inner cyclone and check suction inlets for a clog.
5. Grasp the hose handle and lift to separate from the suction opening. Check for a clog in the base or the hose.

4.



5.

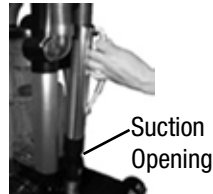

6.



To remove clogs from the hose base:

6. Recline handle and turn vacuum cleaner over so bottom side is up. Locate and turn the quick release tabs on the foot hose cover as shown and pivot the cover out to remove.
7. Pull foot hose straight up to remove from foot base. Turn the vacuum back over, straighten the foot hose and unclog with a long, narrow object such as a broomstick.

Maintenance and care

Cleaning clogs continued

To remove clogs from the hose:

8. Release the Twist n' Snap hose from the vacuum by turning to the left. Straighten the hose and unclog with a long, narrow object such as a broomstick.
9. If the low suction persists, follow the instructions for Checking the Rotating Brush on page 10 and inspect the air passageway for obstructions.

9.

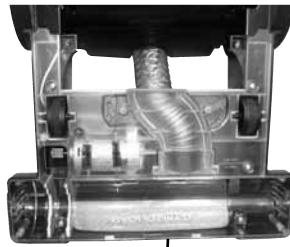

Air Passageway

TurboBrush maintenance

The TurboBrush should be checked regularly for clogs or debris wrapping around the brush.

1. Twist collar so opening is at the top and lift top cover to remove.
2. Remove the brush from the belt and clean debris.
3. Replace the brush inside the belt and place ends into slots on sides as shown.
4. Reposition top cover making sure to line up inside tab at the front with the opening on the cover. Twist collar until opening is at the bottom to lock into place.

1.



3.



4.



Electronic protector

An internal electronic protector has been designed into your cleaner to protect it from overheating. When the electronic protector activates, both power buttons will flash continuously and the cleaner will stop working. If this happens, proceed as follows:

1. Turn the cleaner OFF by pressing the \odot power switch and unplug from electrical outlet.
2. Check the inner cyclone area, pre-motor filter and HEPA media post-motor filter for dirt accumulation.
3. Refer to the "Cleaning Clogs" section on pg.12.
4. After the above steps are completed, plug vacuum in and continue cleaning. If the electronic motor protector continues to activate after following the above steps, your cleaner may need servicing. Call BISSELL Consumer Services, or visit the website.



Caution:

To reduce the risk of injury from moving parts, turn off vacuum cleaner and disconnect power plug from electrical outlet.

Troubleshooting



WARNING:

To reduce the risk of electric shock, turn power OFF and disconnect polarized plug from electrical outlet before performing maintenance or troubleshooting.

Vacuum cleaner won't turn on

Possible causes

1. Power cord not firmly plugged in
2. Blown fuse/tripped breaker
3. Electronic protector activated
4. Hose handle not full attached

Remedies

1. Check electrical plug
2. Check/replace fuse or reset breaker
3. Turn vacuum off and unplug, see page 12
4. Remove handle and reinstall

Brush not rotating fully

Possible causes

1. Brush switch turned "OFF"
2. Vacuum is in upright position
3. Brush is jammed

Remedies

1. Make sure brush switch is pushed "ON"
2. Recline vacuum to operate brush
3. Remove obstruction or debris unplug cleaner and reset brush (pages 11 & 12)
4. Unplug cleaner to reset brush (page 11)
5. Remove handle and reinstall

4. Brush needs to be reset
5. Handle not fully attached

Vacuum cleaner won't pick up or low suction

Possible causes

1. Hose wand not properly positioned
2. Dirt container not installed properly
3. Dirt container full
4. Clog in cleaner
5. Filters are dirty
6. Hose not properly attached

Remedies

1. Make sure hose wand is fully seated in base
2. Correctly position and snap into place
3. Empty dirt container
4. Follow instructions on page 11
5. Check and clean foam filter, check and replace HEPA media filter cartridge if needed
6. Check Twist-n-Snap hose connection and make sure hose is securely in hose base

Visible dirt escaping from cleaner

Possible causes

1. Dirt container full
2. Filters or inner cyclone missing or installed incorrectly
3. Dirt container not installed properly
4. Hose not installed properly
5. Hole or crack in hose

Remedies

1. Empty dirt container
2. Check inner cyclone, pre-motor and post-motor filters for correct installation
3. Make sure dirt container is correctly positioned and snapped into place
4. Make sure hose wand is fully seated in base
5. Check hose for holes or cracks and replace as needed

Troubleshooting

Other maintenance or service not included in the manual should be performed by an authorized service representative.

Thank you for selecting a BISSELL product.

If you should happen to need assistance during assembly or operation, call 1-800-237-7691.

Please do not return this product to the store.

For any questions or concerns, BISSELL is happy to be of service. Contact us directly at 1-800-237-7691.

BISSELL consumer service

For information about repairs or replacement parts, or questions about your warranty, call:

BISSELL Consumer Services

1-800-237-7691

Monday - Friday 8 a.m. — 10 p.m. ET

Saturday 9 a.m. — 8 p.m. ET

Or write:

BISSELL Homecare, Inc.

PO Box 3606

Grand Rapids, MI 49501

ATTN: Consumer Services

Or visit the BISSELL website - www.bissell.com

When contacting BISSELL, have model number of unit available.

Please record your Model Number: _____ Please record your Purchase Date: _____

NOTE: Please keep your original sales receipt. It is your proof of warranty.



Replacement parts – BISSELL PROlite Multi Cyclonic series

You may purchase replacement parts from your retailer, by calling BISSELL Consumer Services or by visiting our website. To locate a retailer near you, or to place an order using Visa, MasterCard, Discover or American Express, call

BISSELL Consumer Services

1-800-237-7691

Monday - Friday 8 a.m. — 10 p.m. ET

Saturday 9 a.m. — 8 p.m. ET

Or visit our Website - www.bissell.com

Item	Part No.	Part Name
1	203-2050	Style 20 Drive Belt (2-Pack)
2	203-2011	Twist 'n Snap Hose and Handle
3	203-2054	Brush Roll - Grey
4	203-2091	Style 20 Pre-Motor Filter
5	203-2093	Style 20 HEPA Media Post-Motor Filter
6	203-2097	Inner Cyclone Assembly

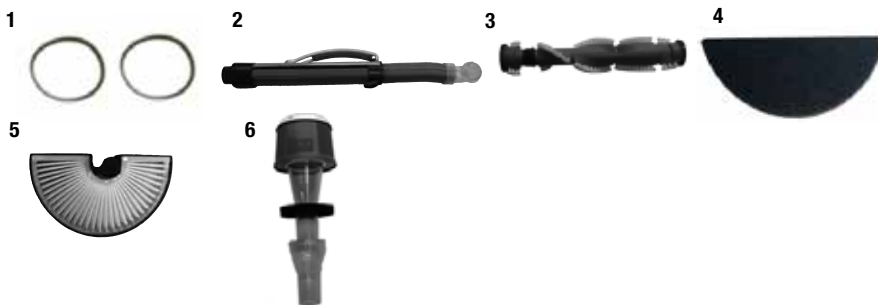

Additional accessories

These items are available for purchase as accessories for your BISSELL PROlite Multi Cyclonic: To purchase call 1-800-237-7691 or visit www.bissell.com.

Item	Part No.	Part Name
1	203-2002	Crevice Tool
2	203-1429	TurboBrush®
3	203-2001	Dusting Brush
4	203-2003	Extension Wand
5	203-2004	Deluxe Floor Tool
6	203-2006	Bendable Wand Attachment



www.bissell.com



800.237.7691

15

Warranty

This warranty gives you specific legal rights, and you may also have other rights which may vary from state to state. If you need additional instruction regarding this warranty or have questions regarding what it may cover, please contact BISSELL Consumer Services by E-mail, telephone, or regular mail as described below.

Limited Five Year Warranty

Subject to the *EXCEPTIONS AND EXCLUSIONS identified below, upon receipt of the product BISSELL Homecare, Inc. will repair or replace (with new or remanufactured components or products), at BISSELL's option, free of charge from the date of purchase by the original purchaser, for five years any defective or malfunctioning part.

See information below on "If your BISSELL product should require service".

This warranty applies to product used for personal, and not commercial or rental service. This warranty does not apply to fans or routine maintenance components such as filters, belts, or brushes. Damage or malfunction caused by negligence, abuse, neglect, unauthorized repair, or any other use not in accordance with the User's Guide is not covered.

If your BISSELL product should require service:

Contact BISSELL Consumer Services to locate a BISSELL Authorized Service Center in your area.

If you need information about repairs or replacement parts, or if you have questions about your warranty, contact BISSELL Consumer Services.

Website or E-mail:

www.bissell.com

Use the "Customer Services" tab.

Or Call:

BISSELL Consumer Services

1-800-237-7691

Monday - Friday 8 a.m. - 10 p.m. ET

Saturday 9 a.m. - 8 p.m. ET

Or write:

BISSELL Homecare, Inc.

PO Box 3606

Grand Rapids, MI 49501

ATTN: Consumer Services

BISSELL HOMEWARE, INC. IS NOT LIABLE FOR INCIDENTAL OR CONSEQUENTIAL DAMAGES OF ANY NATURE ASSOCIATED WITH THE USE OF THIS PRODUCT. BISSELL'S LIABILITY WILL NOT EXCEED THE PURCHASE PRICE OF THE PRODUCT.

Some states do not allow the exclusion or limitation of incidental or consequential damages, so the above limitation or exclusion may not apply to you.

*EXCEPTIONS AND EXCLUSIONS FROM THE TERMS OF THE LIMITED WARRANTY

THIS WARRANTY IS EXCLUSIVE AND IN LIEU OF ANY OTHER WARRANTIES EITHER ORAL OR WRITTEN. ANY IMPLIED WARRANTIES WHICH MAY ARISE BY OPERATION OF LAW, INCLUDING THE IMPLIED WARRANTIES OF MERCHANTABILITY AND FITNESS FOR A PARTICULAR PURPOSE, ARE LIMITED TO THE FIVE YEAR DURATION FROM THE DATE OF PURCHASE AS DESCRIBED ABOVE.

Some states do not allow limitations on how long an implied warranty lasts, so the above limitation may not apply to you.



©2009 BISSELL Homecare, Inc
Grand Rapids, Michigan
All rights reserved. Printed in Korea
Part Number 110-4164
Rev 10/09
Visit our website at:
www.bissell.com

800.237.7691

