

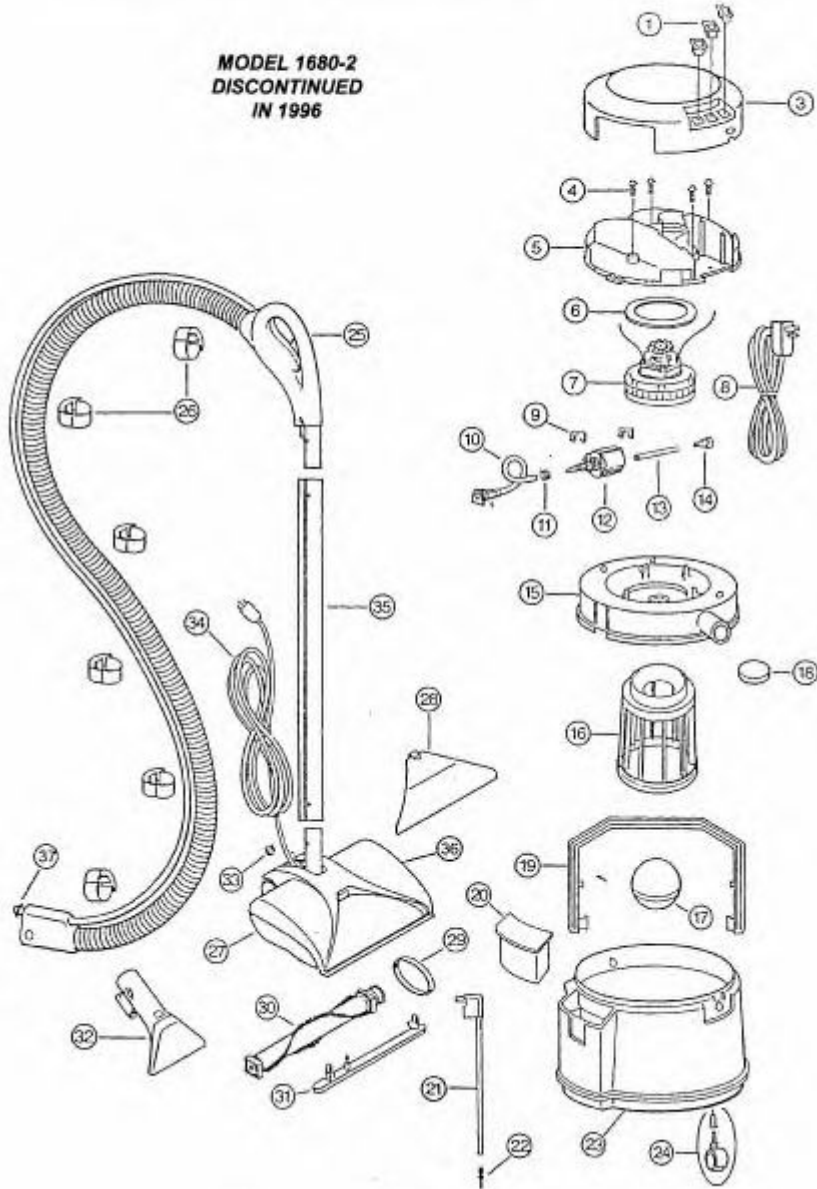

# DEEP CLEANER

WITH POWER BRUSH MOD 1680-2

MODEL 1680-2  
DISCONTINUED  
IN 1996



Key No.	Part No.	Part Desc.
01	<a href="#">2108873</a>	SWITCH WIDE W/O LEADS 1632REPL
03	<a href="#">0142916</a>	CVR & SWCH ASSY GRN 16801
04	<a href="#">8807038</a>	SCREW #8 X 3/4" PLAS PHL/HEX
05	<a href="#">0144935</a>	HOUSING-MOTOR GREEN 16801
06	<a href="#">0108311</a>	SEAL MOTOR 1671 MODELS NEW-RBO
07	<a href="#">2106007</a>	MOTOR 2 STG 1671 REPL
08	<a href="#">0103021</a>	CORDSET WALL 16801 22NEW ALCI
09	<a href="#">5559182</a>	CLIP PUMP 1660
10	<a href="#">0102657</a>	RECIEVER FEMALE 1680 - RBO
11	<a href="#">2102485</a>	CLAMP-LARGE REPL
12	<a href="#">5559002</a>	PUMP CP7H
13	<a href="#">0139490</a>	TUBE- PUMP TO INLET 1670G REPL
14	<a href="#">2132665</a>	CONNECTOR INLET FEM 1660 REPL
15	<a href="#">0142943</a>	COVER TANK GREEN 16801 *RBO
16	<a href="#">2131526</a>	CAGE BALL REPL
17	<a href="#">2130329</a>	FLOAT BALL 1671 BISSELL REPL
18	<a href="#">0173533</a>	SECONDARY FILTER 3-PK
19	<a href="#">0134470</a>	HANDLE LT GREY 1655 REPL
20	<a href="#">2133000</a>	CUP MEASURING ST GREY REPL
21	<a href="#">5559011</a>	SIPHON TUBE ASSEMBLY
22	<a href="#">5559036</a>	FILTER EXTRACTION UNIVERSAL1PK
24	<a href="#">0102284</a>	CASTER 118LT GREY-UNIV. 4PK
25	<a href="#">2034674</a>	HOSE ASSM P/BRUSH 1680 REPL
26	<a href="#">0132472</a>	CLIP HOSE 1680 -RBO
27	<a href="#">2032941</a>	FOOT ASSEM PWR BRUSH 1680 REPL
28	<a href="#">2139858</a>	WINDOW POWER FOOT 1676 REPL
29	<a href="#">2100603</a>	BELT DRIVE 1680 1-PACK REPL
30	<a href="#">2161160</a>	BRUSH ASSM 1680S REPL
31	<a href="#">2136101</a>	SPRAY BAR ASSM 1680 REPL
32	<a href="#">2159154</a>	UPHOL ASSM LONG REPL
33	<a href="#">2102485</a>	CLAMP-LARGE REPL
34	<a href="#">2032941</a>	FOOT ASSEM PWR BRUSH 1680 REPL
35	<a href="#">5559131</a>	WAND EXTRUDED 1680
36	<a href="#">0145106</a>	HOUSING UPPER ASSY 1680 FOOT
37	<a href="#">5559058</a>	O RING REPL