

This Owner's Manual is provided and hosted by [Appliance Factory Parts](#).

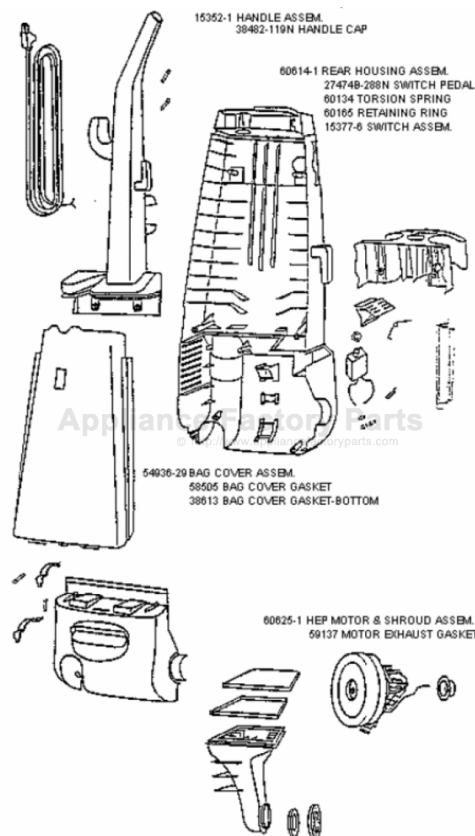

# Eureka 4372AT Owner's Manual

[Shop genuine replacement parts for Eureka 4372AT](#)



[Find Your Eureka Vacuum Cleaner Parts - Select From 853 Models](#)

----- Manual continues below -----

PARTS2 - 4372AT

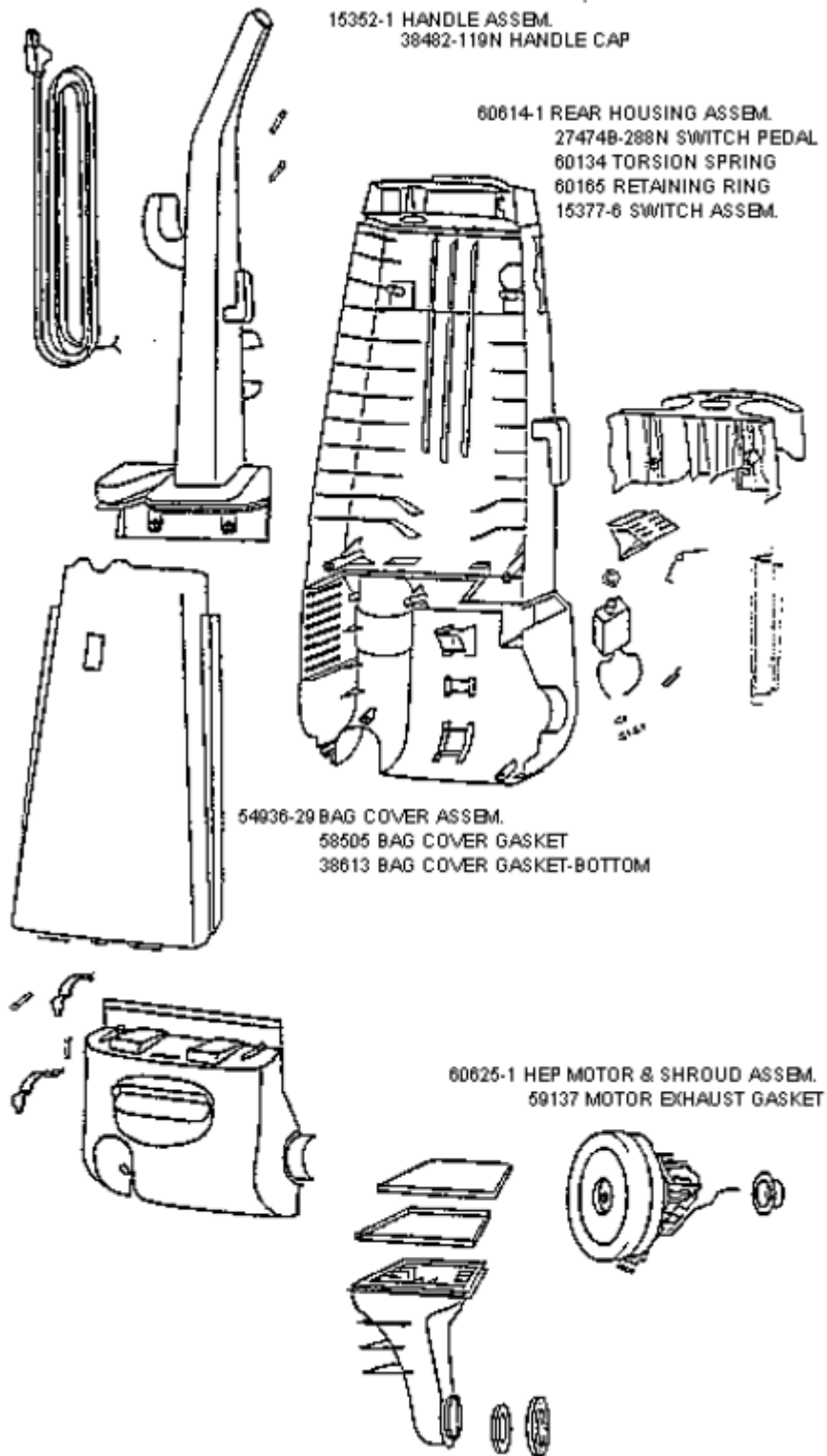

## PARTS2 - 4372AT

Ref #	Part	Description	Comments	Qty
1	15352-1	HANDLE & CAP ASSEMBLY		
2	15377-6	SWITCH ASSY		
3	15408-119N	DUCT - AIR		
4	15443-288N	TOOL CADDY		
5	27171	GASKET		
6	27474B-288N	SWITCH BUTTON use 27474C-288N		
7	27552B	GROMMET		
8	38420-2	CLAMP		
9	38482-119N	CAP - HANDLE		
10	38613	GASKET		
11	38680-8	SUPPLY CORD & TERMINAL AS		
12	39023	FLANGE - MOTOR INTAKE		
13	39046	FILTER - PRE-MOTOR		
14	53197-1	SCREW PACKAGE		
15	54936-29	BAG COVER ASSY - PACKAGED		
16	58505	GASKET - BAG COVER		
17	59137	GASKET - MOTOR EXHAUST		
18	60134	TORS SPRING PKG		
19	60165	RETAINING RING PKG		
20	60192-1	WIRE SPLICE 5		
21	60285	HEPA FILTER PKG (166603)		
22	60294-3	MOTOR COVER ASSEMBLY - PK		
23	60614-1	REAR HSNG - PKG		
24	60625-1	HEPA MOTOR & SHROUD ASSY		

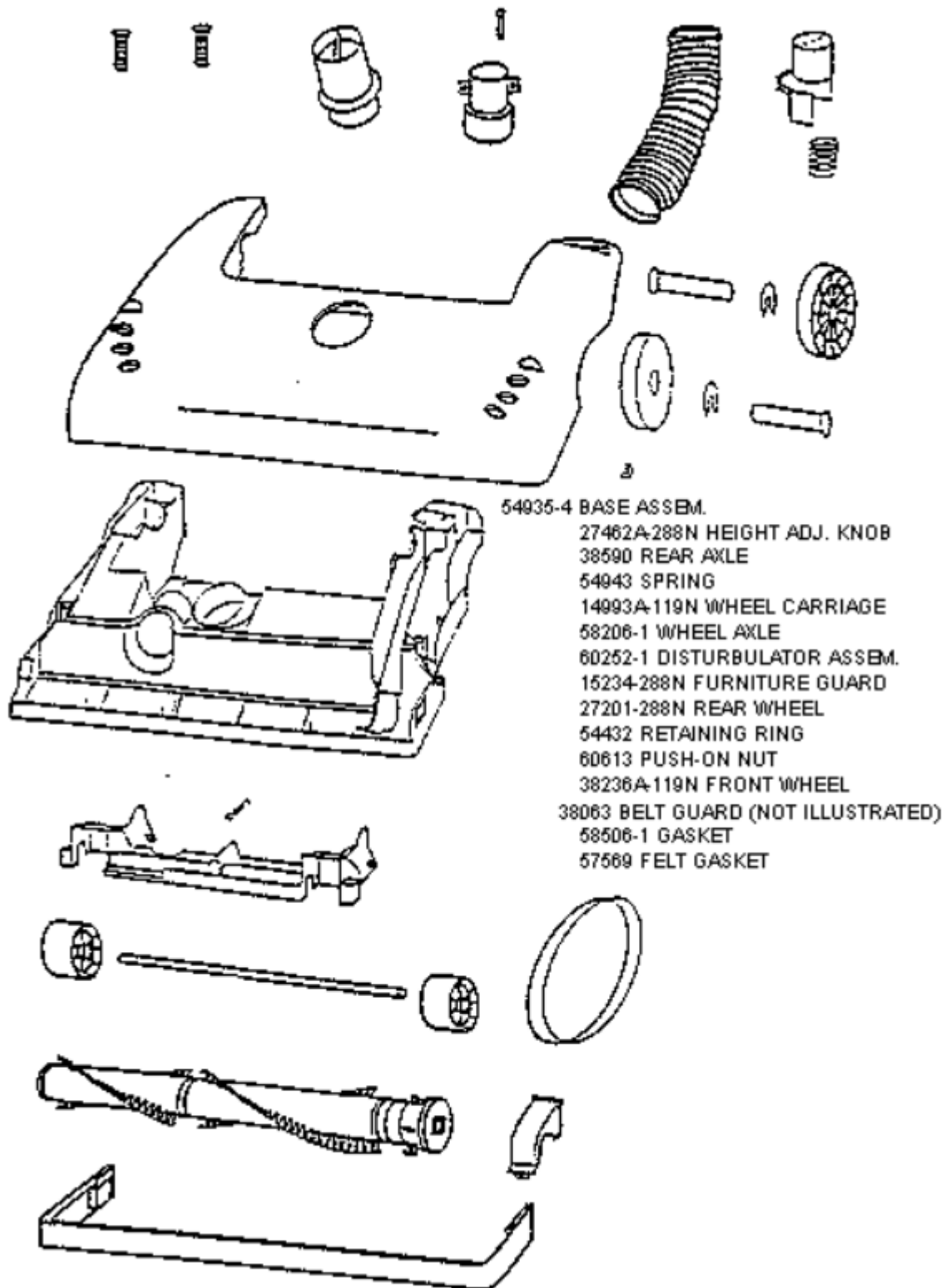

## PARTS1 - 4372AT

Ref #	Part	Description	Comments	Qty
1	14993A-119N	CARRIAGE - WHEEL		
2	15237-288N	GUARD - FURNITURE (12")		
3	27201-288N	WHEEL-REAR PEPPERCORN		
4	27462A-288N	OPERATOR - HEIGHT ADJUSTM		
5	27467-288N	RELEASE - HANDLE		
6	27468A-119N	CUFF-HOSE(SUB 27468B-119N)		
7	38063	GUARD - BELT		
8	38236A-119N	WHEEL - FRONT		
9	38479-2	HOSE - COMPRESSION (PURCH		
10	38590	AXLE - REAR		
11	53197-1	SCREW PACKAGE		
12	54312	BELTS BRAVO U PAK		
13	54376-2	BELT CAP & GASKET - PACKA		
14	54432	PACKAGE - RETAINING RING		
15	54669-2	SCREW PACKAGE		
16	54933-5	HOOD ASSEMBLY - PACKAGED		
17	54935-4	BASE ASSEMBLY - CARTONED		
18	54943	SPRING PACKAGE		
19	57569	GASKET - FELT		
20	58206-1	AXLE - WHEEL		
21	58506-1	GASKET		
22	60133	COMPRESSION SPRING - PACK		
23	60251-1	12" DISTURBULATOR ASSY -		
24	60613	PUSH ON NUT PKG		

ACCESSORIES - 4372AT

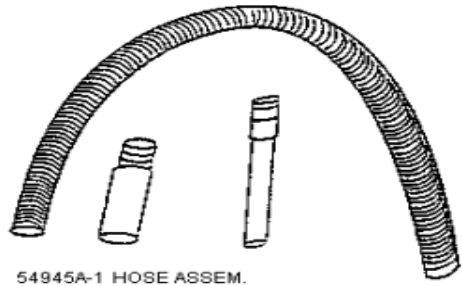

54945A-1 HOSE ASSEM.  
27461B-119N HOSE ADAPTER  
27624-119N STRAIGHT WAND

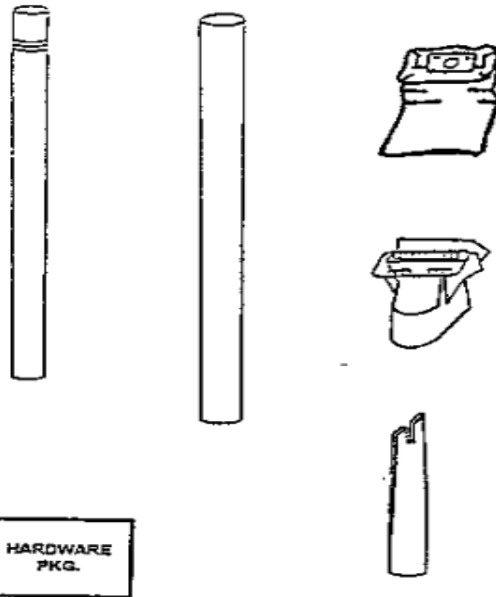

HARDWARE  
PKG.

59292 OWNERS GUIDE

ACCESSORIES - 4372AT

Ref #	Part	Description	Comments	Qty
1	27461B-119N	ADAPTER - HOSE		
2	54669-2	SCREW PACKAGE		
3	54780	TOOL - CREVICE		
4	54784	COMBINATION TOOL - PACKAG		
5	54945A-1	HOSE ASSY(SUB 54945A-2)		
6	58623	PAPER BAG PKG FILTERAIRE		
7	58728A	NESTED WAND use 58728B		