

Eureka 5184AT Owner's Manual

[Shop genuine replacement parts for Eureka 5184AT](#)

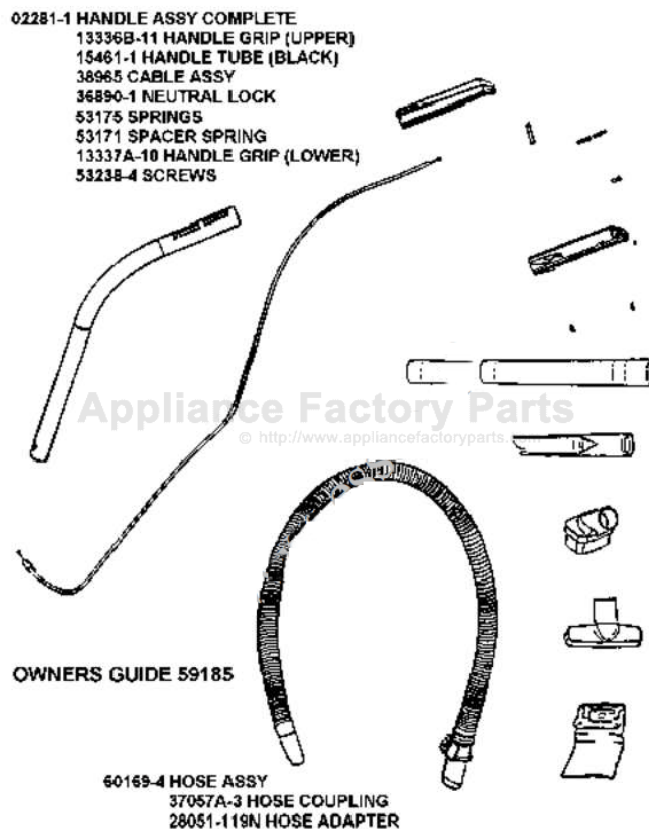

[Find Your Eureka Vacuum Cleaner Parts - Select From 855 Models](#)

----- Manual continues below part list -----

Available Replacement Parts for Eureka 5184AT

[e-39266](#)

BELT OEM EUREKA EXTENED LIFE 1 PACK

ACCESSORIES - 5184AT

Ref #	Part	Description	Comments	Qty
1	02281-1	HANDLE ASSEMBLY		
2	13336B-11	UPPER GRIP & GRAPHICS ASS		
3	13337A-10	GRIP - HANDLE (LOWER)		
4	15461-1	TUBE - HANDLE		
5	28051-119N	ADAPTER - HOSE		
6	36890-1	LOCK - NEUTRAL		
7	37057A-3	COUPLING - HOSE		
8	38965	This part is obsolete and there is no substitute available.		
9	53171	SPRING - SPACER PACKAGE		
10	53175	SPRING - CENTERING PACKAG		
11	53238-4	SCREW PACKAGE		
12	54780	TOOL - CREVICE		
13	54782	UPHOLSTERY NOZZLE ASSEMBL		
14	57782-4	DUSTING BRUSH - PACKAGED		
15	58623	PAPER BAG PKG FA (STYLE A		
16	58728A	NESTING WAND ASSEMBLY		
17	60169-4	HOSE ASSEMBLY - CARTONED		

02290-119N FRONT COVER

59542-1 FRONT COVER GASKET

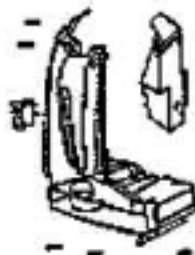

39035 NAMEPLATE

00080-3 BAG COVER ASSEM.

59331 BAG COVER GASKET

56750-1 BAG INDICATOR CLIP

37761-2 BAG INDICATOR

53238-1 SCREW

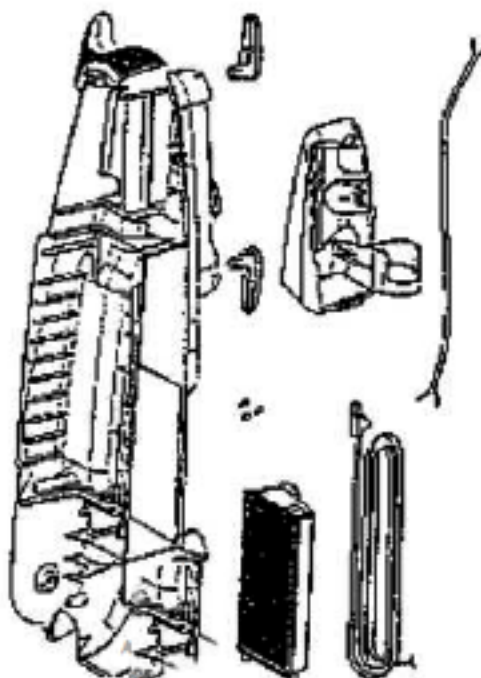
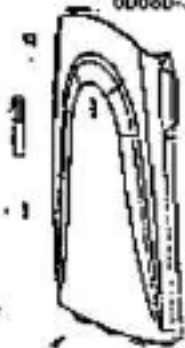

50213 THERMAL CUT OFF



60613 PUSH ON NUT



54937-20 MOTOR COVER ASSEM.

16072-313N LENS-MOTOR COVER

60068-2 SCREW

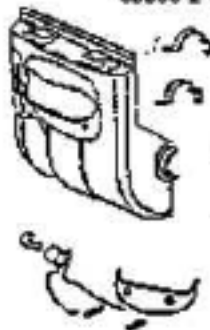

80625-1 HEPAMOTOR & SHROUD ASSEM.

59137 MOTOR EXHAUST GASKET

59319 SUPPORT GASKET

27552B GROMMET

59297-1 AIR DUCT GASKET

59297 AIR DUCT GASKET

15408A119N AIR DUCT ASSEM.

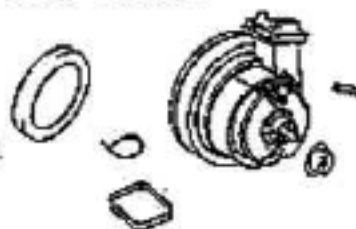

PARTS2 - 5184AT

Ref #	Part	Description	Comments	Qty
1	02282-119N	HOUSING - REAR		
2	02283-119N	INSERT - TOOL CADDY		
3	02290-119N	FRONT COVER ASSY - PKG		
4	15072-313N	LENS - MOTOR COVER		
5	15408A-119N	DUCT - AIR		
6	27171A	GASKET		
7	27552B	GROMMET		
8	28011	UPPER CORD ASSEMBLY		
9	28013-119N	RELEASE - CORD		
10	28073A	SWITCH - ROCKER		
11	37761-2	BAG INDICATOR ASSEMBLY		
12	38420-2	CLAMP		
13	38469	FILTER - PRE-MOTOR		
14	38680-12	SUPPLY CORD & TERMINAL AS		
15	38686-1	HEADLAMP SOCKET ASSEMBLY		
16	39023	FLANGE - MOTOR INTAKE		
17	39033-119N	SHIELD - WIRE		
18	39035	NAMEPLATE		
19	46713-5	TIE - CABLE (PURCHASED)		
20	48815	LAMP - HEADLIGHT		
21	53197-1	SCREW PACKAGE		
22	53238-1	SCREW PACKAGE		
23	54937-20	MOTOR COVER ASSY W/O LENS		
24	56750-1	CLIP - BAG INDICATOR		
25	59137	GASKET - MOTOR EXHAUST		
26	59213	THERMOSTAT 110 DEG (120V)		
27	59319	SUPPORT - GASKET		
28	59361A	ADAPTER - TUBE		
29	59362B	TUBE		
30	59408-2	LEAD & TERMINAL ASSEMBLY		
31	59542-1	GASKET		
32	60068-2	SCREW PACKAGE		
33	60192-1	WIRE SPLICE 5		
34	60285	HEPA FILTER PACKAGE		
35	60613	PUSH ON NUT PKG		
36	60625-1	HEPA MOTOR & SHROUD ASSY		
37	60680-3	BAG COVER ASSEMBLY - PKG		



PARTS1 - 5184AT

Ref #	Part	Description	Comments	Qty
1	14993A-119N	CARRIAGE - WHEEL		
2	15234-288N	GUARD - FURNITURE (14")		
3	27467-288N	RELEASE - HANDLE		
4	27468A-119N	CUFF - HOSE		
5	27794-119N	WHEEL - REAR		
6	28102-1	RECTIFIER & SWITCH ASSY		
7	38236A-119N	WHEEL - FRONT		
8	38479-2	HOSE - COMPRESSION (PURCH		
9	39034	SEAL - YOKE		
10	39047-119N	COVER - DRIVE MOTOR		
11	39121	KNOB ASSEMBLY		
12	53197-1	SCREW PACKAGE		
13	53238-42	SCREW PACKAGE		
14	54312	BELT PACKAGE ASSEMBLY (U)		
15	54376-2	BELT CAP & GASKET - PACKA		
16	54669-2	SCREW PACKAGE		
17	54943	SPRING PACKAGE		
18	57569	GASKET - FELT		
19	58206-1	AXLE - WHEEL		
20	58506-2	GASKET		
21	58814	REAR AXLE		
22	59552	GASKET - CABLE		
23	59586	GASKET - HOOD		
24	59587	SHIELD - MOTOR SPACING		
25	60133	COMPRESSION SPRING - PACK		
26	60253-1	14" DISTURBULATOR ASSY -		
27	60700-3	HOOD & GRAPHICS ASSY - PK		
28	60756-1	TRUARC RETAINING RING - P		
29	60758	DRIVE MOTOR - PKGD		
30	60760-1	BASE ASSY - PKGD		
31	60761-1	CABLE FLAG SCREW - PKGD		