

This Owner's Manual is provided and hosted by [Appliance Factory Parts](#).

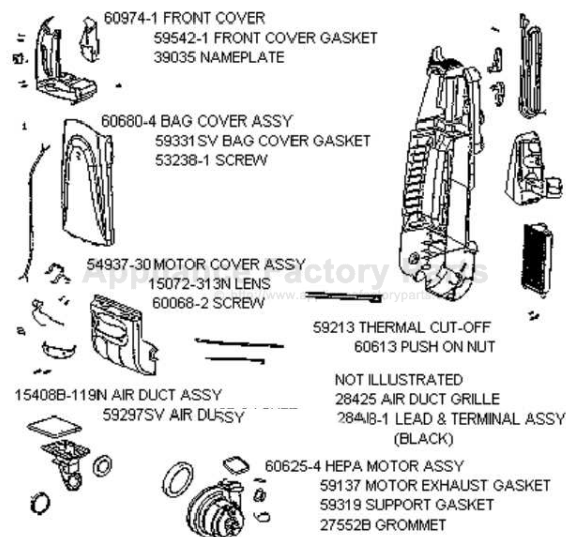

Eureka 5185AT Owner's Manual

[Shop genuine replacement parts for Eureka 5185AT](#)



[Find Your Eureka Vacuum Cleaner Parts - Select From 855 Models](#)

----- Manual continues below -----



PARTS2 - 5185AT

| Ref # | Part | Description | Comments | Qty |
|-------|-------------|---------------------------|----------|-----|
| 1 | 02282C-119N | HOUSING - REAR | | |
| 2 | 02283-119N | INSERT - TOOL CADDY | | |
| 3 | 15072-313N | LENS - MOTOR COVER | | |
| 4 | 15408B-119N | DUCT - AIR | | |
| 5 | 27171A | GASKET | | |
| 6 | 27552B | GROMMET | | |
| 7 | 28011 | UPPER CORD ASSEMBLY | | |
| 8 | 28013-119N | RELEASE - CORD | | |
| 9 | 28073A | SWITCH - ROCKER | | |
| 10 | 28425 | GRILLE - AIR DUCT | | |
| 11 | 38420-2 | CLAMP | | |
| 12 | 38680-12 | SUPPLY CORD & TERMINAL AS | | |
| 13 | 38686-1 | HEADLAMP SOCKET ASSEMBLY | | |
| 14 | 39023 | FLANGE - MOTOR INTAKE | | |
| 15 | 39033-119N | SHIELD - WIRE | | |
| 16 | 39035 | NAMEPLATE | | |
| 17 | 39292 | FILTER - PRE-MOTOR | | |
| 18 | 46713-5 | TIE - CABLE (PURCHASED) | | |
| 19 | 48815 | LAMP - HEADLIGHT | | |
| 20 | 53197-1 | SCREW PACKAGE | | |
| 21 | 53238-1 | SCREW PACKAGE | | |
| 22 | 54937-30 | MOTOR COVER ASSY W/O LENS | | |
| 23 | 59137 | GASKET - MOTOR EXHAUST | | |
| 24 | 59213 | THERMOSTAT 110 DEG (120V) | | |
| 25 | 59297SV | GASKET - AIR DUCT | | |
| 26 | 59319 | SUPPORT - GASKET | | |
| 27 | 59331SV | GASKET - BAG COVER | | |
| 28 | 59361A | ADAPTER - TUBE | | |
| 29 | 59362B | TUBE | | |
| 30 | 59408-1 | LEAD & TERMINAL ASSEMBLY | | |
| 31 | 59408-2 | LEAD & TERMINAL ASSEMBLY | | |
| 32 | 59542-1 | GASKET | | |
| 33 | 60068-2 | SCREW PACKAGE | | |
| 34 | 60192-1 | WIRE SPLICE 5 | | |
| 35 | 60285 | HEPA FILTER PACKAGE | | |
| 36 | 60613 | PUSH ON NUT PKG | | |
| 37 | 60625-4 | HEPA MOTOR & SHROUD ASSY | | |
| 38 | 60680-6 | BAG COVER ASSEMBLY - PKGD | | |
| 39 | 60974-1 | FRONT COVER ASSEMBLY-PACK | | |

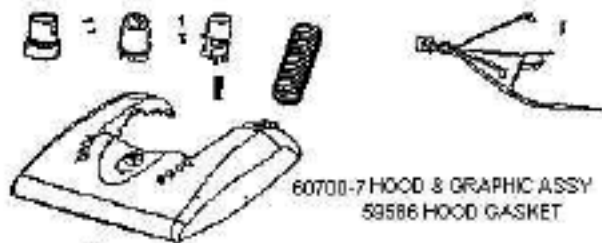

60700-7 HOOD & GRAPHIC ASSY
59586 HOOD GASKET



60757B TRANSMISSION ASSY
39034 YOKE SEAL
60756-1 RETAINING RING
60758 DRIVE MOTOR
59597 MOTOR SPACING SHIELD



60760-3 BASE ASSY
58506-2 GASKET
54843 SPRING
14890B-119N WHEEL CARRIAGE
58206-1 WHEEL AXLE
38173-119N FRONT WHEEL
70524 GASKET
27794-119N REAR WHEEL
58814 REAR AXLE



54376-2 BELT CAP ASSY
70524 GASKET

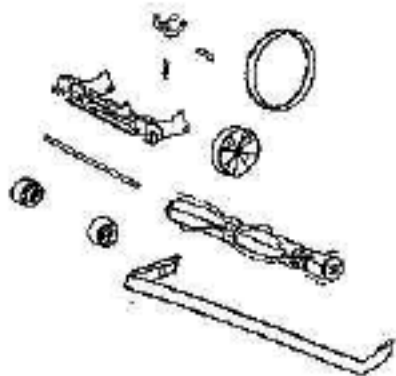

PARTS1 - 5185AT

| Ref # | Part | Description | Comments | Qty |
|-------|-------------|---------------------------|----------|-----|
| 1 | 14993B-119N | CARRIAGE - WHEEL | | |
| 2 | 15591-288N | GUARD - FURNITURE | | |
| 3 | 27462C-288N | OPERATOR - HEIGHT ADJUSTM | | |
| 4 | 27467A-288N | RELEASE - HANDLE | | |
| 5 | 27468D-119N | CUFF - HOSE | | |
| 6 | 27794-119N | WHEEL - REAR | | |
| 7 | 28102-1 | RECTIFIER & SWITCH ASSY | | |
| 8 | 38479-4 | HOSE - COMPRESSION (PURCH | | |
| 9 | 39034 | SEAL - YOKE | | |
| 10 | 39047-119N | COVER - DRIVE MOTOR | | |
| 11 | 39173-119N | WHEEL - FRONT | | |
| 12 | 53197-1 | SCREW PACKAGE | | |
| 13 | 53238-4 | SCREW PACKAGE | | |
| 14 | 54376-2 | BELT CAP & GASKET - PACKA | | |
| 15 | 54669-2 | SCREW PACKAGE | | |
| 16 | 54943 | SPRING PACKAGE | | |
| 17 | 58206-1 | AXLE - WHEEL | | |
| 18 | 58506-2 | GASKET | | |
| 19 | 58814 | REAR AXLE | | |
| 20 | 59552 | GASKET - CABLE | | |
| 21 | 59586 | GASKET - HOOD | | |
| 22 | 59587 | SHIELD - MOTOR SPACING | | |
| 23 | 60133 | COMPRESSION SPRING - PACK | | |
| 24 | 60252-2 | BRUSHROLL ASSEMBLY - CART | | |
| 25 | 60700-7 | HOOD & GRAPHICS ASSY - PK | | |
| 26 | 60756-1 | TRUARC RETAINING RING - P | | |
| 27 | 60757B | TRANSMISSION ASSY - PACKA | | |
| 28 | 60758 | DRIVE MOTOR - PKGD | | |
| 29 | 60760-3 | BASE ASSY - PKGD | | |
| 30 | 60761-1 | CABLE FLAG SCREW - PKGD | | |
| 31 | 70524 | GASKET - FELT | | |

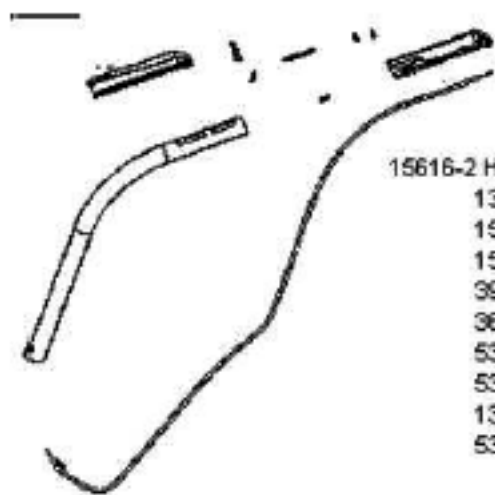

- 15616-2 HANDLE ASSY COMPLETE
- 13336B-11 HANDLE GRIP
- 15614-1 HANDLE TUBE
- 15615-1 HANDLE TUBE
- 39272 CABLE ASSY
- 36890-1 NEUTRAL LOCK
- 53175 SPRING
- 53171 SPACER SPRING
- 13337A-10 HANDLE GRIP
- 53238-4 SCREW

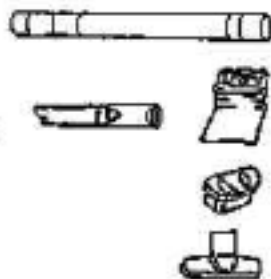

- 60169-7 HOSE ASSY
- 37057A-3 HOSE COUPLING
- 28051A-119N HOSE ADAPTER

59185C OWNERS GUIDE

ACCESSORIES - 5185AT

| Ref # | Part | Description | Comments | Qty |
|-------|-------------|---------------------------|----------|-----|
| 1 | 13336B-11 | UPPER GRIP & GRAPHICS ASS | | |
| 2 | 13337A-10 | GRIP - HANDLE (LOWER) | | |
| 3 | 15614-1 | TUBE - UPPER HANDLE | | |
| 4 | 15615-1 | TUBE - LOWER HANDLE | | |
| 5 | 26708-119N | TOOL - CREVICE | | |
| 6 | 28051A-119N | ADAPTER - HOSE | | |
| 7 | 36890-1 | LOCK - NEUTRAL | | |
| 8 | 37057A-3 | COUPLING - HOSE | | |
| 9 | 38284-3 | UPHOLSTERY NOZZLE ASSEMBL | | |
| 10 | 39272 | TRANSMISSION CABLE ASSEMB | | |
| 11 | 53171 | SPRING - SPACER PACKAGE | | |
| 12 | 53175 | SPRING - CENTERING PACKAG | | |
| 13 | 53238-4 | SCREW PACKAGE | | |
| 14 | 54787 | DUSTING BRUSH - PACKAGED | | |
| 15 | 58623A | PAPER BAG PKG FA (STYLE A | | |
| 16 | 58728B | NESTING WAND ASSEMBLY | | |
| 17 | 60169-7 | HOSE ASSEMBLY - CARTONED | | |