

| Ref # | Part | Description | Comments | Qty |
|-------|---------|---------------------------|----------|-----|
| 1 | 61053 | HEPA FILTER - WASHABLE | | |
| 2 | 61262 | FINAL FILTER | | |
| 3 | 61263 | MOTOR FILTER | | |
| 4 | 61368-1 | MOTOR ASSEMBLY - CARTONED | | |
| 5 | 61369-2 | FILTER COVER | | |
| 6 | 61370-1 | BODY | | |
| 7 | 61373 | HANDLE | | |
| 8 | 61374 | CORD REEL | | |
| 9 | 61375-3 | OUTER LID - PKGD | | |
| 10 | 61379-2 | PANEL | | |
| 11 | 61380-3 | MIDDLE COVER - PKGD | | |
| 12 | 61385 | SEALING | | |
| 13 | 61386 | MOTOR HOOD | | |
| 14 | 61387-1 | REAR CAP | | |
| 15 | 61388 | MOTOR SEAL | | |
| 16 | 61389-1 | INNER LID | | |
| 17 | 61390-2 | SPEED REGULATOR - CTND | | |
| 18 | 61392 | FILTER HOLDER | | |
| 19 | 61393 | COVER SEALING | | |
| 20 | 61394 | PIPE | | |
| 21 | 61395 | REAR WHEEL | | |
| 22 | 61396 | FRONT WHEEL | | |
| 23 | 61397 | RUBBER CUSHION | | |
| 24 | 61400-3 | SWITCH PEDAL - PKGD | | |
| 25 | 61401-3 | CORD REEL PEDAL - PKGD | | |
| 26 | 61403 | SPRING - PKGD | | |
| 27 | 61404 | VALVE COVER | | |
| 28 | 61405 | PISTON | | |
| 29 | 61407 | SPRING - PKGD | | |
| 30 | 61409 | SHAFT - PKGD | | |
| 31 | 61410-1 | LOWER SHELL WITH WHEELS | | |
| 32 | 61411 | HOLDER | | |
| 33 | 61412 | TUBE | | |
| 34 | 61413 | CATCH | | |
| 35 | 61415 | FLAP SPRING - PKGD | | |
| 36 | 61416 | BUSHING | | |
| 37 | 61418 | LOCK - PKGD | | |
| 38 | 61470 | HOSE (TUBE) | | |

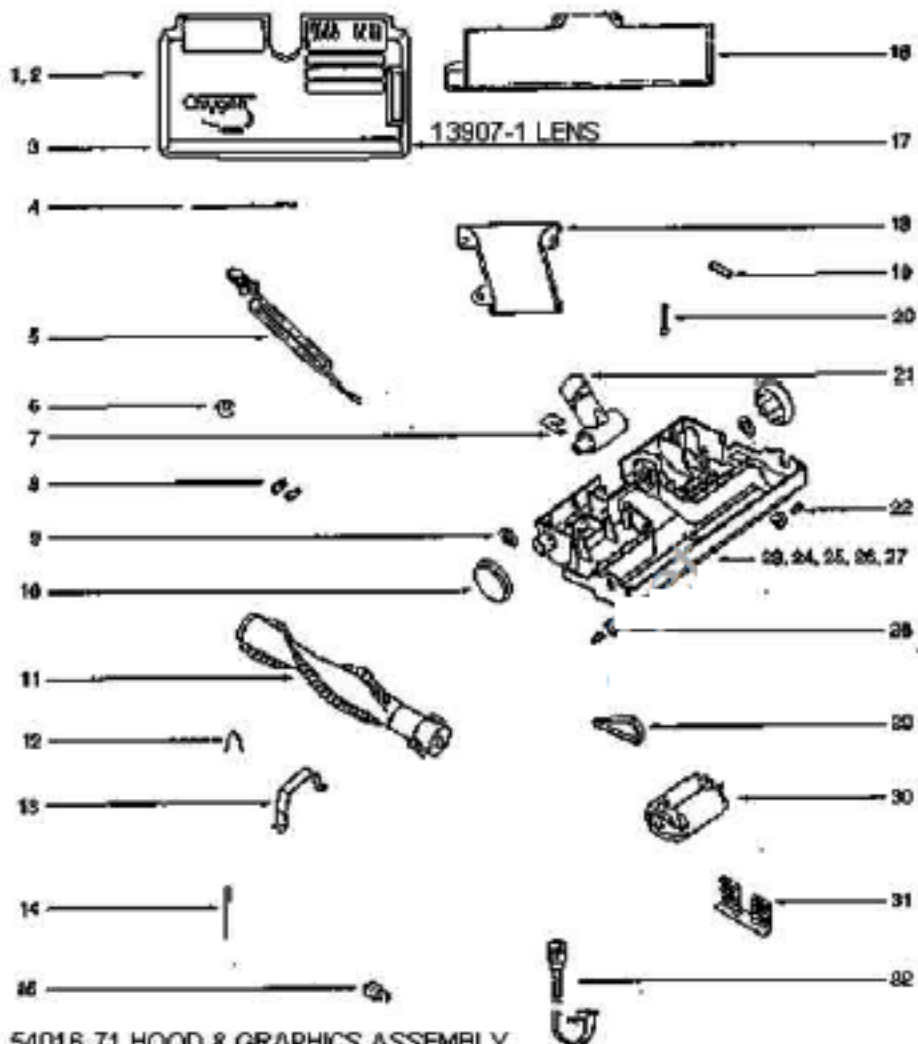

1. 54016-71 HOOD & GRAPHICS ASSEMBLY
 26469-1 BELT WINDOW
 37433-3 FURNITURE GUARD
 55971 FELT GASKET

23. 54340-1 BASE ASSEMBLY
 56489 FRONT AXLE
 55970 FELT GASKET
 55968 FELT GASKET
 55971 FELT GASKET
 56824 FRONT WHEEL ASSEMBLY

| Ref # | Part | Description | Comments | Qty |
|-------|----------|---------------------------|----------|-----|
| 1 | 13907-1 | LENS | | |
| 2 | 26469-1 | WINDOW - BELT | | |
| 3 | 36995 | BELT - DRIVE | | |
| 4 | 37433-3 | GUARD - FURNITURE | | |
| 5 | 37753-3 | CORD & PLUG ASSEMBLY | | |
| 6 | 37786-8 | WHEEL ASSEMBLY | | |
| 7 | 38063 | GUARD - BELT | | |
| 8 | 38156 | STRAP - MOTOR | | |
| 9 | 38177 | SHIELD - MOTOR | | |
| 10 | 38259 | HEADLAMP SOCKET ASSEMBLY | | |
| 11 | 40009A | LAMP - HEADLIGHT | | |
| 12 | 53190-1 | BUSHING - STRAIN RELIEF-P | | |
| 13 | 53238-8 | SCREW PACKAGE | | |
| 14 | 53411-1 | DISTURBULATOR ASSY - CRTN | | |
| 15 | 54016-71 | POWERHEAD HOOD ASSY - PAC | | |
| 16 | 54340-1 | KIT - POWER HEAD BASE ASS | | |
| 17 | 54343-1 | MOTOR ASSEMBLY - PACKAGED | | |
| 18 | 55968 | GASKET - FELT | | |
| 19 | 55970 | GASKET - FELT | | |
| 20 | 55971 | GASKET - FELT | | |
| 21 | 55974 | INSERT - LATCH | | |
| 22 | 55979 | SPRING STRAP | | |
| 23 | 55980-1 | STRAP | | |
| 24 | 56180 | FELT WASHER | | |
| 25 | 56232-1 | DISTURBULATOR COVER ASSEM | | |
| 26 | 56489 | AXLE | | |
| 27 | 56824 | WHEEL & SLEEVE ASSEMBLY | | |
| 28 | 56830-3 | HANDLE SOCKET ASSEMBLY | | |
| 29 | 57421-1 | WIRE & TERMINAL ASSEMBLY | | |
| 30 | 57710-1 | AIR DUCT COVER ASSEMBLY | | |
| 31 | 60192-1 | WIRE SPLICE 5 | | |

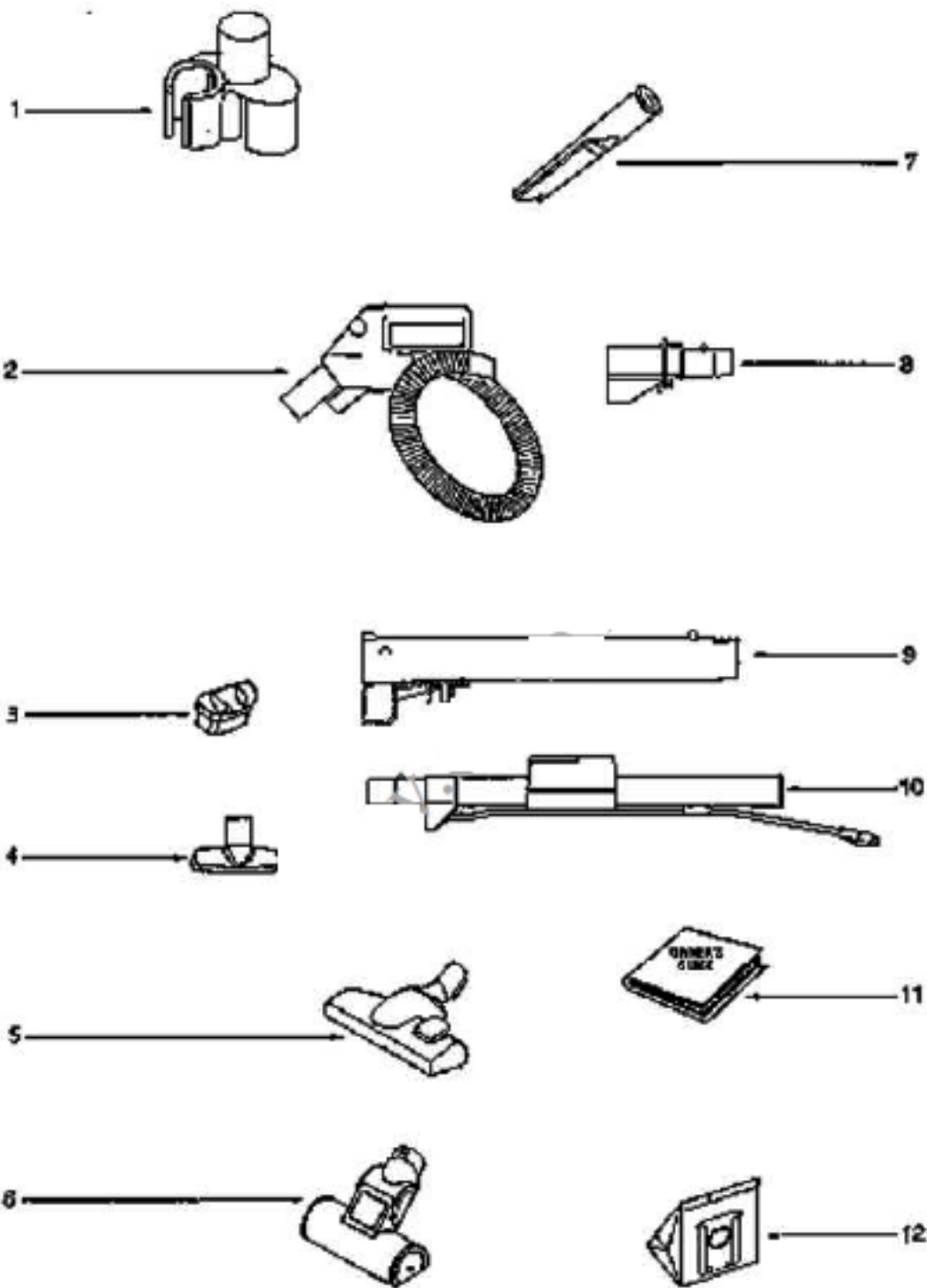

| Ref # | Part | Description | Comments | Qty |
|-------|------------|---------------------------|----------|-----|
| 1 | 22713-9 | UPHOLSTERY NOZZLE ASSEMBL | | |
| 2 | 26708-119N | TOOL - CREVICE | | |
| 3 | 37738-5 | UPPER WAND ASSEMBLY | | |
| | 39040A-2 | STRAIGHT WAND ASSEMBLY | | |
| 5 | 39040A-4 | STRAIGHT WAND ASSEMBLY | | |
| 6 | 39041 | COUPLING ASSY - EASY CHAN | | |
| 7 | 54910 | CLIP & TOOL | | |
| 8 | 59949 | TURBO NOZZLE ASSY (MODEL | | |
| 9 | 60290-1 | DUSTING BRUSH - PACKAGED | | |
| 10 | 60816 | FLOOR & WALL BRUSH ASSEMB | | |
| 11 | 61054-1 | SWIVEL HOSE ASSY - CARTON | | |
| 12 | 61230 | PAPER BAG PKG - STYLE OX | | |
| 13 | 70897A | OWNER'S GUIDE | | |