

**26176-3 UPPER HANDLE ASS'Y (INCLUDES)  
25103A-4 HANDLE GRIP**

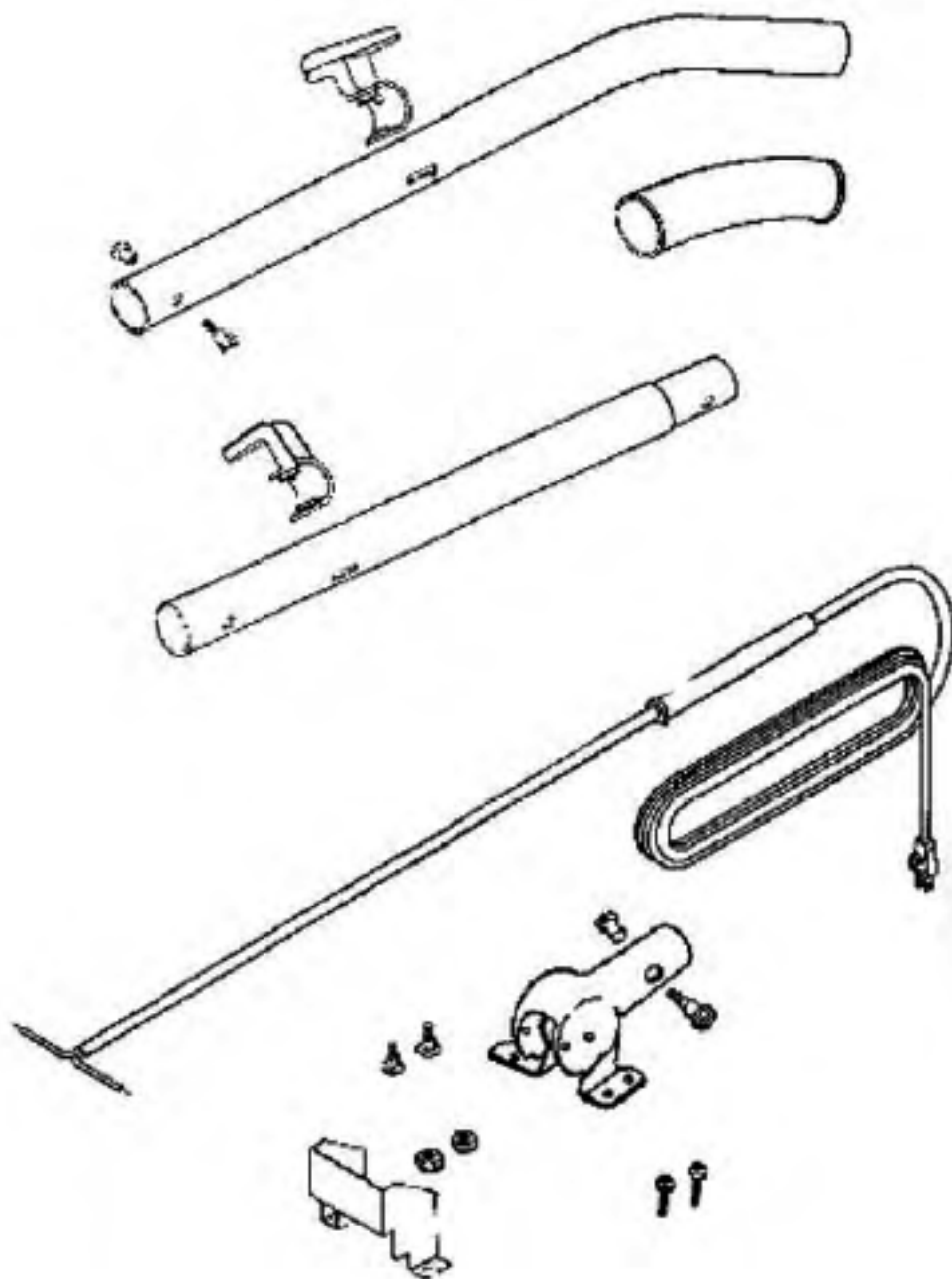

Ref #	Part	Description	Comments	Qty
1	E-13521-2	RETAINER - CORD (LOWER)		
2	E-25103A-4	GRIP - HANDLE		
3	E-26176-3	HANDLE ASSEMBLY (UPPER)		
4	E-34732-15	CORD & POLARIZED PLUG ASS		
5	E-36097-3	SLEEVE		
6	E-36439	SHIELD - HANDLE SOCKET		
7	E-36965-2	CORD RETAINER ASSY-BLACK		
8	E-38183-1	HANDLE SOCKET ASSEMBLY		
9	E-53145	BOLT PACKAGE (10)		
10	E-53198-1	HANDLE SCREW ASSY PACKAGE		
11	E-53213-5	NUTS - PACKAGE		
12	E-53238-13	SCREW PACKAGE		
13	E-57751-1	TUBE - HANDLE (LOWER)		



57917-2 HOOD & NAMEPLATE  
38322 NAMEPLATE



56383 AIR INLET DUCT ASS'Y. (R.H.)  
49052-3 FOAM TAPE



56382 AIR INLET DUCT ASS'Y. (L.H.)  
49052-3 FOAM TAPE

36409-13 PUSH SWITCH  
55448 SWITCH NUT



NOT ILLUSTRATED  
24964A CAM (R.H.)  
24965A CAM (L.H.)  
53118 RIVET-CAM  
PKG. 10 2 USED  
53133 WASHER  
PKG. 10 2 USED

Ref #	Part	Description	Comments	Qty
1	E-12601-8	LENS - HOOD		
2	E-14302-1	KNOB - 8 POSITION		
3	E-24834A-1	PEDAL - FOOT		
4	E-24964A	CAM (RIGHT)		
5	E-24965A	CAM (LEFT)		
6	E-30517	GASKET - MOTOR SEAL		
7	E-35958A	HEADLAMP SOCKET ASSEMBLY		
8	E-36263	COVER - WHEEL		
9	E-36409-13	SWITCH - PUSH		
10	E-38054-2	GRIP ASSEMBLY		
11	E-40009A	LAMP - HEADLIGHT		
12	E-49052-3	TAPE - FOAM		
13	E-53089-1	BUSHING & STRAIN RELIEF P		
14	E-53097	SPRING - FOOT PEDAL PKG (		
15	E-53117	SPRING - HOOD PACKAGE (10		
16	E-53118	RIVET - SHOULDER PACKAGE		
17	E-53133	STEEL WASHERS - PACKAGE 1		
18	E-53140	CLAMP & SCREW ASSY PKG		
19	E-53143	SCREW PACKAGE (10)		
20	E-53160	CABLE CLAMP PACKAGE		
21	E-53213-4	NUTS - PACKAGE 10		
22	E-53214-1	WIRE SPLICE 5		
23	E-53228-2	SCREWS - PACKAGE 10		
24	E-53228-3	SCREWS - PACKAGE 10		
25	E-53238-13	SCREW PACKAGE		
26	E-53238-14	SCREW PACKAGE		
27	E-54177	WIRE & TERMINAL ASSY		
28	E-54352-9	MOTOR ASSEMBLY - PACKAGED		
29	E-54408-2	BASE ASSEMBLY - 12" - CAR		
30	E-55446	NUT - SWITCH		
31	E-56382	DUCT ASSEMBLY (L)		
32	E-56383	DUCT ASSEMBLY (R)		



**37284-1 WHEEL & AXLE ASS'Y.(INCLUDES)**

68121 PUSH NUT(PKG. OF 10)(2 USED)

26242-1 REAR WHEEL (2)

63110 WHEEL WASHER  
(PKG. OF 10)(2 USED)

87183 REAR AXLE

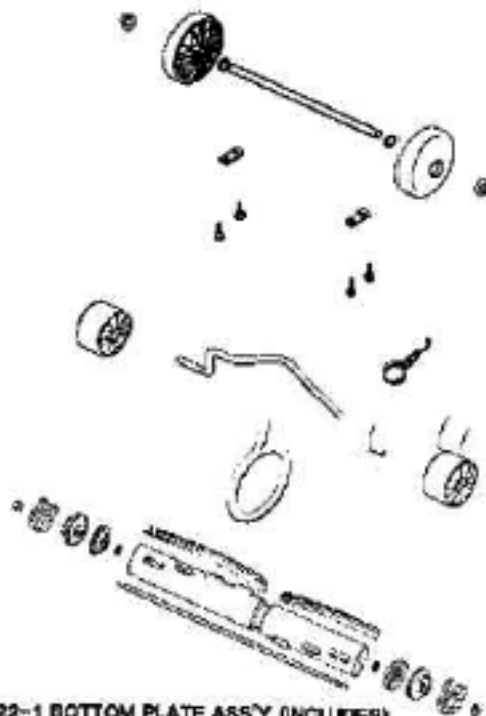

**25922-1 BOTTOM PLATE ASS'Y.(INCLUDES)**

46536 GASKET



**53892-1 DISTURBULATOR ASS'Y.(INCLUDES)**

39070 BEARING, RETAINER &  
WASHER ASS'Y. (2)

63187 SHAFT WASHER  
(PKG. OF 10)(2 USED)

27144 DISTURBULATOR CAP (2)

82282-3 BRISTLE STRIP SET

63158 NUT (PKG. OF 10)(2 USED)

53098 GAP COVER (PKG. OF 2)

37378 SHAFT

Ref #	Part	Description	Comments	Qty
1	E-13236-2	TUBE - DISTURBULATOR		
2	E-25922-1	BOTTOM PLATE ASSEMBLY		
3	E-26242-1	WHEEL - REAR		
4	E-26296-12	GUARD - FURNITURE		
5	E-27144	CAP - DISTURBULATOR		
6	E-35859A-1	WHEEL - FRONT		
7	E-35947A	AXLE - FRONT		
8	E-37183	AXLE - REAR		
9	E-37234-1	WHEEL & AXLE ASSY		
10	E-37378	DIST SHAFT & BRG ASSY - C		
11	E-46538	TAPE - FOAM		
12	E-52282-3	BRISTLE STRIP PACKAGE		
13	E-53066	CAP - COVER		
14	E-53076-2	SPRING & AXLE PACKAGE (6)		
15	E-53110	WASHER - WHEEL PACKAGE (1)		
16	E-53121	PUSH NUT PACKAGE (10)		
17	E-53158	LOCK NUT PACKAGE		
18	E-53167	WASHER - SHAFT PACKAGE		
19	E-53201	CLAMPS - PACKAGE 10		
20	E-53238-11	SCREW PACKAGE		
21	E-53892-1	DISTURBULATOR PACKAGE		

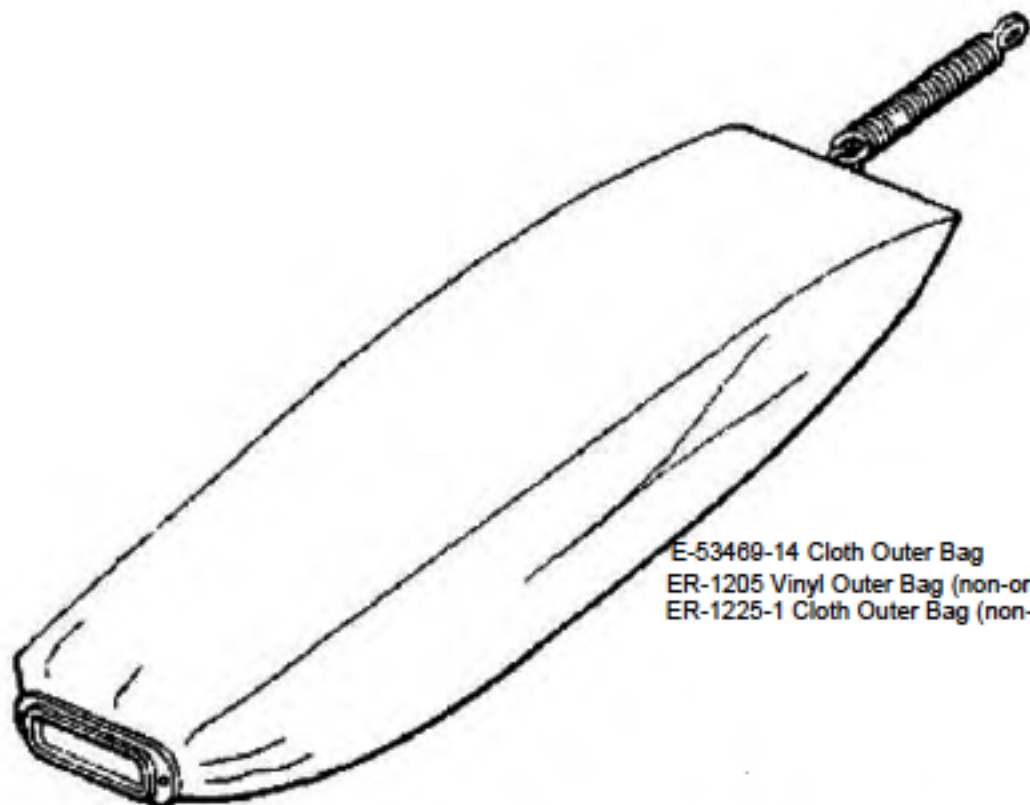

E-53489-14 Cloth Outer Bag  
ER-1205 Vinyl Outer Bag (non-original) Beige  
ER-1225-1 Cloth Outer Bag (non-original)

**55332 HARDWARE PKG.**



**1-CORD RETAINER (UPPER)**  
**1-CORD RETAINER (LOWER)**  
**2-CLAMP SCREWS**  
**2-HANDLE SCREW ASS'Y.**  
**1-BELT**

Ref #	Part	Description	Comments	Qty
1	E-36968	GASKET		
2	E-47722	SPRING - BAG		
3	E-54175-2	ADAPTER - BAG		
4	E-55332	HARDWARE PACKAGE		

E-53469-14 Cloth Outer Bag

ER-1205 Vinyl Outer Bag (non-original) Beige

ER-1225-1 Cloth Outer Bag (non-original)



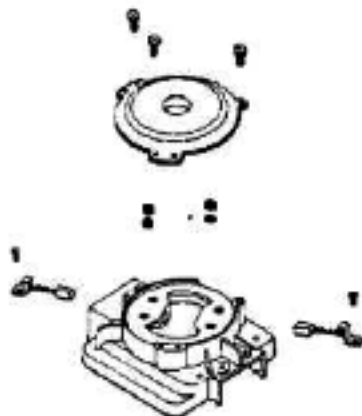

**54395-4 ARM, FAN & BEARING ASSEMBLY**

53088-1 BEARING PKG. 5 1 USED

30474A FAN

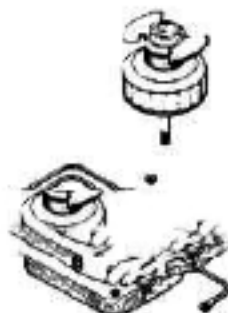

**54189-1 MOTOR BASE ASSEMBLY**

42875 BEARING & RETAINER ASS'Y.

53088-1 BEARING PKG. 5 1 USED

53087-1 RIVET PKG. 10 3 USED

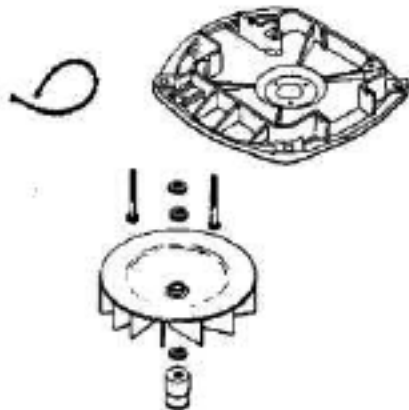

Ref #	Part	Description	Comments	Qty
1	E-12988	FAN BLOWER - MOTOR		
2	E-20217E	RETAINER - UPPER BEARING		
3	E-30474A	FAN - MOTOR COOLING		
4	E-30478	MOTOR BRUSH ASSEMBLY		
5	E-42875	BEARING RETAINER ASSY-W/L		
6	E-49507	PULLEY - MOTOR DRIVE		
7	E-53088-1	BALL BEARING - PACKAGE		
8	E-53138	SCREWS - PACKAGE 10		
9	E-53142	SCREW PACKAGE (10)		
10	E-53148	WASHER - FAN PACKAGE (10)		
11	E-53188-1	WASHER PACKAGE		
12	E-53213-4	NUTS - PACKAGE 10		
13	E-53219-2	SCREWS - PACKAGE 10		
14	E-53222-3	LOCKWASHERS - PACKAGE 10		
15	E-53441-10	FIELD ASSEMBLY - PACKAGED		
16	E-54169-1	MOTOR BASE ASSEMBLY		
17	E-54395-4	ARMATURE, FAN & BRG ASSY-		
18	E-54396	MOTOR COVER ASSEMBLY - LA		
19	E-56802-2	TIE - CABLE (PURCHASED)		