

This Owner's Manual is provided and hosted by [Appliance Factory Parts](#).



SANITAIRE S663A Owner's Manual

[Shop genuine replacement parts for SANITAIRE S663A](#)



[Find Your SANITAIRE Vacuum Cleaner Parts - Select From 78 Models](#)

----- Manual continues below part list -----

Available Replacement Parts for SANITAIRE S663A

[E-36409-13](#)

SWITCH - PUSH



Ref #	Part	Description	Comments	Qty
1	12901-8	LENS - HOOD		
2	13770-1	COVER - FAN SCROLL		
3	14302-1	KNOB - 8 POSITION		
4	24834A-1	PEDAL - FOOT		
5	24964A	CAM (RIGHT)		
6	24965A	CAM (LEFT)		
7	30517	GASKET - MOTOR SEAL		
8	35958A	HEADLAMP SOCKET ASSEMBLY		
9	36263	COVER - WHEEL		
10	36409-13	SWITCH - PUSH		
11	38054-2	CAP HEIGHT ADJUSTMENT 8 POSITION		
12	40009A	LAMP - HEADLIGHT		
13	52334	FAN CHAMBER REPLACEMENT K		
14	53089-1	BUSHING & STRAIN RELIEF P		
15	53097	SPRING - FOOT PEDAL PKG (
16	53117	SPRING - HOOD PACKAGE (10		
17	53118	RIVET - SHOULDER PACKAGE		
18	53133	STEEL WASHERS - PACKAGE 1		
19	53140	CLAMP & SCREW ASSY PKG		
20	53143	SCREW PACKAGE (10)		
21	53160	CABLE CLAMP PACKAGE		
22	53213-4	NUTS - PACKAGE 10		
23	53214-1	WIRE SPLICE 5		
24	53228-2	SCREWS - PACKAGE 10		
25	53228-3	SCREWS - PACKAGE 10		
26	53238-13	SCREW PACKAGE		
27	53238-14	SCREW PACKAGE		
28	53425-5	BASE ASSEMBLY - CARTONED		
29	54177	WIRE & TERMINAL ASSY		
30	54352-11	MOTOR ASSEMBLY - PACKAGED		
31	54407-3	MOTOR HOOD ASSEMBLY - PAC		
32	56382	DUCT ASSEMBLY (L)		
33	56383	DUCT ASSEMBLY (R)		

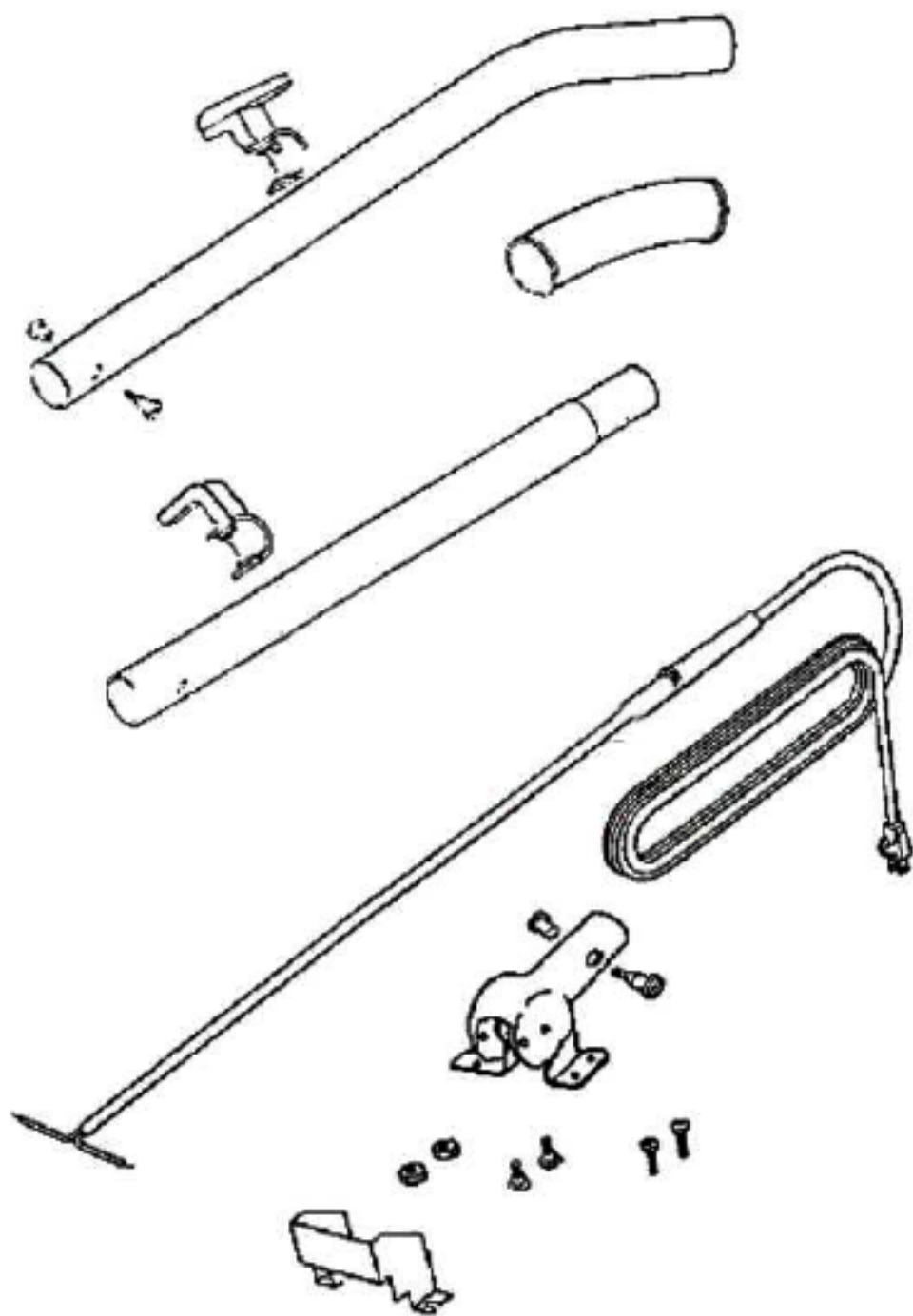

Ref #	Part	Description	Comments	Qty
1	12637-8	TUBE - HANDLE (LOWER)		
2	13521-2	RETAINER - CORD (LOWER)		
3	25103A-4	GRIP - HANDLE		
4	26176-4	HANDLE ASSEMBLY (UPPER)		
5	27382-6	CORD - LOW LEAD (18 GA)		
6	36097-3	SLEEVE		
7	36439	SHIELD - HANDLE SOCKET		
8	36965-2	CORD RETAINER ASSY-BLACK		
9	38183-1	HANDLE SOCKET ASSEMBLY		
10	53145	BOLT PACKAGE (10)		
11	53198-1	HANDLE SCREW ASSY PACKAGE		
12	53215-5	SCREW PACKAGE		
13	53238-13	SCREW PACKAGE		



WHEEL & AXLE ASS'Y.

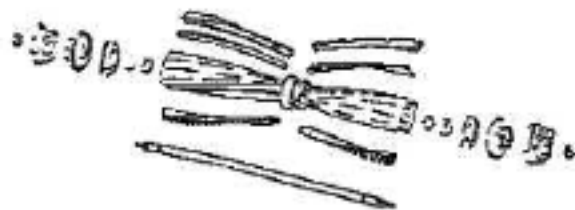
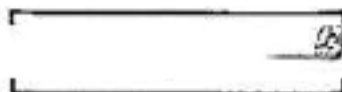
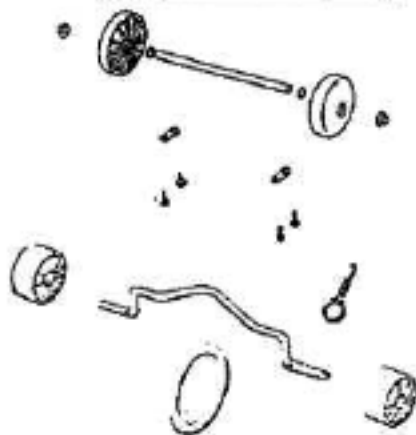

53469-17 BAG ASS'Y
47722 SPRING
54175-2 BAG ADAPTER, GASKET & SLEEVE ASS'Y

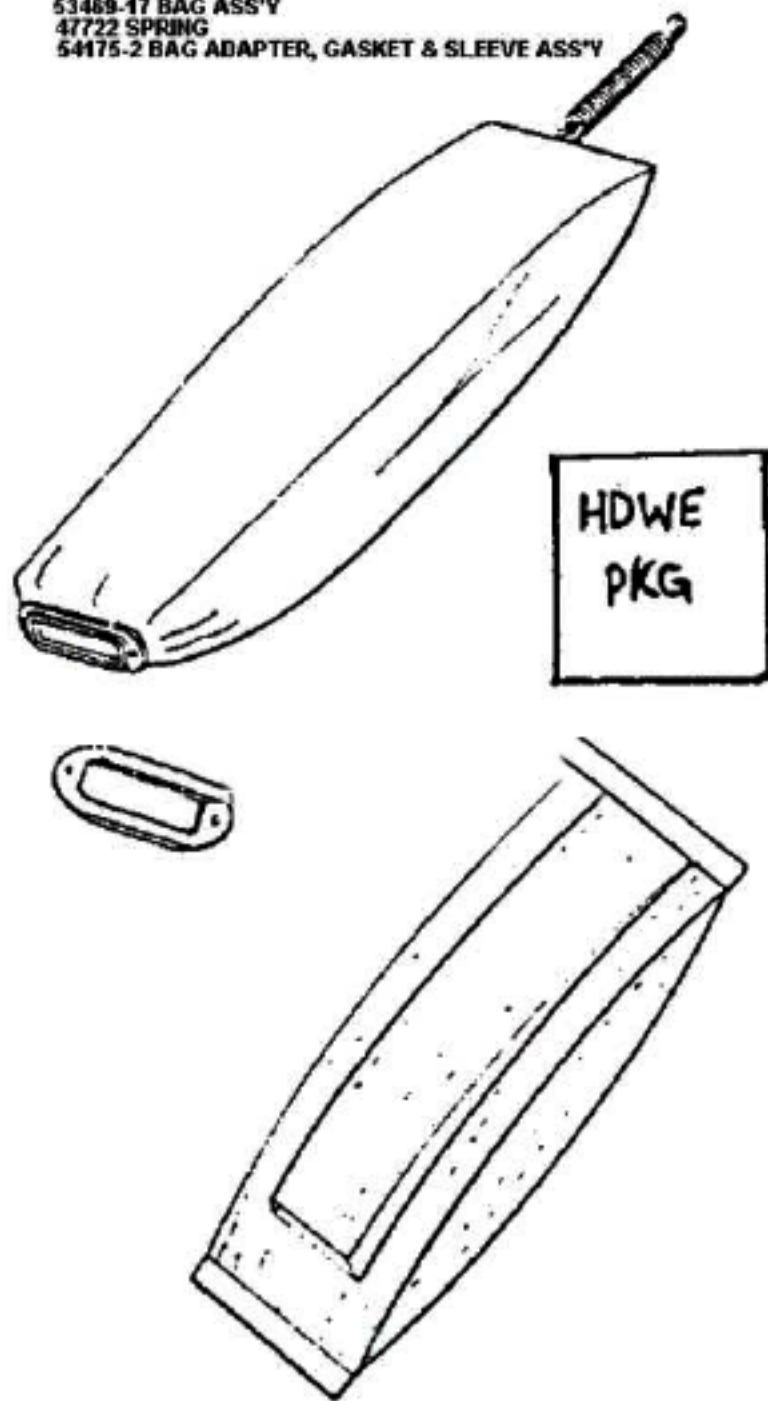

Ref #	Part	Description	Comments	Qty
1	35968	GASKET		
2	47722	SPRING - BAG		
3	52320	PAPER BAG PRG ASSY STYLE		
4	53469-17	ZIPPER BAG ASSY - PACKAGE		
5	54175-2	ADAPTER - BAG		
6	55332	HARDWARE PACKAGE		

Ref #	Part	Description	Comments	Qty
1	25922-1	BOTTOM PLATE ASSEMBLY		
2	26058A	CAP - DISTURBULATOR		
3	26059A	CAP - COVER		
4	26242-1	WHEEL - REAR		
5	26296-9	GUARD - FURNITURE		
6	35663A	SHAFT - DISTURBULATOR		
7	35664B	BAR - BEATER (SHORT)		
8	35665B	BAR - BEATER (LONG)		
9	35728A	PLATE - COVER		
10	35859A-1	WHEEL - FRONT		
11	35895-1	SUPPORT - BEATER BAR		
12	35895-2	SUPPORT - BEATER BAR		
13	35947A	AXLE - FRONT		
14	37183	AXLE - REAR		
15	37234-1	WHEEL & AXLE ASSY		
16	46538	TAPE - FOAM		
18	52140	PACKAGED - BRISTLE STRIP		
19	53076-2	SPRING & AXLE PACKAGE (6)		
20	53110	WASHER - WHEEL PACKAGE (1		
21	53114	BEARING - DISTURBULATOR P		
22	53115	PACKAGE - TOLERANCE RING		
23	53121	PUSH NUT PACKAGE (10)		
24	53158	LOCK NUT PACKAGE		
25	53201	CLAMPS - PACKAGE 10		
26	53238-11	SCREW PACKAGE		
27	53272	DISTURBULATOR ASSEMBLY		

54352-11 MOTOR ASSY - COMPLETE

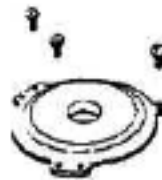

54425-3 ARMATURE BAR & BEARING ASSY
 53888-1 BEARING
 38475A PIN



54050-1 MOTOR BASE ASSY
 54452 BEARING RETAINER
 53888-1 BEARING
 53887-1 RING

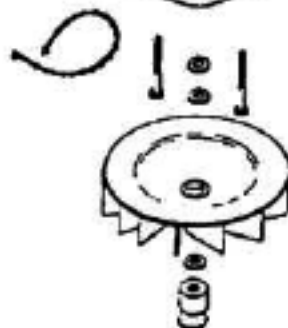

Ref #	Part	Description	Comments	Qty
1	12988	FAN BLOWER - MOTOR		
2	20217E	RETAINER - UPPER BEARING		
3	30474A	FAN - MOTOR COOLING		
4	30478	MOTOR BRUSH ASSEMBLY		
5	37012-2	PULLEY - MOTOR DRIVE		
6	53088-1	BALL BEARING - PACKAGE		
7	53142	SCREW PACKAGE (10)		
8	53148	WASHER - FAN PACKAGE (10)		
9	53158	LOCK NUT PACKAGE		
10	53187-1	RIVET PACKAGE		
11	53188-1	WASHER PACKAGE		
12	53213-4	NUTS - PACKAGE 10		
13	53219-2	SCREWS - PACKAGE 10		
14	53222-3	LOCKWASHERS - PACKAGE 10		
15	53441-10	FIELD ASSEMBLY - PACKAGED		
16	54169-1	MOTOR BASE ASSEMBLY		
17	54352-11	MOTOR ASSEMBLY - PACKAGED		
18	54396	MOTOR COVER ASSEMBLY - LA		
19	54412	BEARING RETAINER ASSY-W/L		
20	54425-3	KIT - ARMATURE REPLACEMEN		
21	56802-2	TIE - CABLE (PURCHASED)		