

This Owner's Manual is provided and hosted by [Appliance Factory Parts](#).



# EURO-PRO FS800 Owner's Manual

[Shop genuine replacement parts for EURO-PRO FS800](#)

[Find Your EURO-PRO Vacuum Cleaner Parts - Select From 258 Models](#)

----- Manual continues below -----



**Bagless S**

**OWNER'S MANUAL**  
**Model FS800**  
120V., 60Hz., 7.5 Amps.

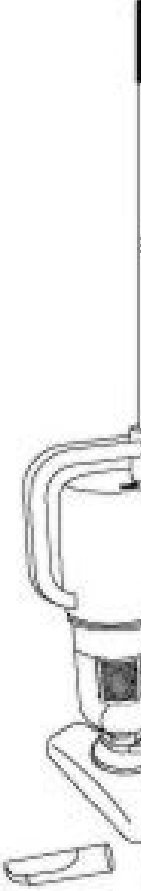

**FANT**  
94 Main Mill St  
Plattsburgh,  
Tel.: 1 (800)  
[www.fant](http://www.fant)

## ONE (1) YEAR LIMITED WARRANTY

**FANTOM** warrants this product to be free of defects in material and workmanship for a period of one (1) year from the date of purchase when utilized for normal household use. This warranty is subject to the following exclusions and exceptions.

If your appliance fails to operate properly under normal operating conditions within the warranty period, **FANTOM** will repair or replace the appliance, accessories, freight prepaid to:

**FANTOM**, 94 Main Mill Street, Danbury, CT 06810

If the appliance is found by **FANTOM** to be defective, **FANTOM** will repair or replace it free of charge. **FANTOM** will also pay for the cost of return shipping and handling charges.

Non-durable parts including, without limitation, filters, brushes, rollers, which normally require replacement are specifically excluded from this warranty.

The liability of **FANTOM** is limited solely to the repair or replacement of the unit at our option. This warranty does not cover damage due to negligent handling or damage due to fault. This warranty does not cover damages from shipping or repairs, service charges, or parts, which have been performed by a third party. **FANTOM** is not responsible for any damage to the unit or its parts.

This warranty is extended to the original purchaser. This warranty is limited to the specific obligations expressed in this limited warranty. **In no event is FANTOM liable for consequential damages of any nature whatsoever.** Some states do not allow the limitation of incidental or consequential damages. This limitation may not apply to you.

This warranty gives you specific legal rights. These rights may vary from state to state.

**\*Important: Carefully pack item to avoid damage. Please include proof of purchase date and to a separate envelope your name, complete address and purchase information, model number and serial number with item. We recommend you insure the item (damages not covered by your warranty). Mark the envelope "ATTENTION CUSTOMER SERVICE". We reserve the right to change our products, therefore the specifications are subject to change without notice.**

## TROUBLE SHOOTING GUIDE

PROBLEM	POSSIBLE REASON	POSSIBLE SOLUTION
VACUUM WILL NOT OPERATE	<ol style="list-style-type: none"> <li>Power cord not firmly plugged into outlet.</li> <li>No power in wall outlet.</li> <li>Needs servicing.</li> <li>Thermostat has tripped.</li> </ol>	<ol style="list-style-type: none"> <li>Plug unit in firmly.</li> <li>Check fuse or breaker. Replace fuse/reset breaker.</li> <li>Call 1-800-275-9251.</li> <li>Turn the unit off and unplug from outlet. Allow unit to cool down, then restart.</li> </ol>
VACUUM WILL NOT PICK-UP OR SUCTION POWER IS WEAK	<ol style="list-style-type: none"> <li>Dust cup is full.</li> <li>Unit clogged.</li> <li>HEPA-Type Filter needs cleaning or replacing.</li> <li>Debris screen needs cleaning.</li> </ol>	<ol style="list-style-type: none"> <li>Empty and clean dust cup.</li> <li>Turn unit off and unplug from wall outlet. Remove Dust Cup Filter and check for object(s) in air duct and remove.</li> <li>Clean or replace HEPA-Type Filter.</li> <li>Clean debris screen.</li> </ol>
DUST ESCAPING FROM VACUUM	<ol style="list-style-type: none"> <li>Dust cup is full.</li> <li>Dust Cup is not installed correctly.</li> </ol>	<ol style="list-style-type: none"> <li>Empty and clean dust cup.</li> <li>Review Dust Cup instructions.</li> </ol>
VACUUM, HOSE OR BRUSHES WILL NOT PICK-UP	<ol style="list-style-type: none"> <li>Hose clogged.</li> <li>Dust cup is full.</li> </ol>	<ol style="list-style-type: none"> <li>Remove hose and/or brushes. Remove obstruction from hose and /or brush.</li> <li>Empty and clean dust cup.</li> </ol>

## ORDERING REPLACEMENT DUST CUP FILTERS

### TO ORDER REPLACEMENT HEPA-TYPE FILTERS for Model FS800

Call: 1 (800) 275-9251  
Monday to Friday 8:30 A.M. - 5:00 P.M. Eastern Standard Time

### FOR TECHNICAL SUPPORT for Model FS800

Call: 1 (800) 275-9251  
Monday to Friday 8:30 A.M. - 5:00 P.M. Eastern Standard Time  
or  
visit our website: [www.fantom.com](http://www.fantom.com)

**Please Note:**

The HEPA-TYPE Filter is washable. It should, however, be replaced every three (3) months to ensure peak performance of your vacuum. Both the Pre-Motor and Post Motor Filters are washable. They should however be replaced every three (3) months to ensure peak performance of your vacuum.

**Important:**

Make sure that **ALL** filters have been completely air dried for 24 hours before re-installing back in the vacuum.

## IMPORTANT SAFETY

When using your **BAGLESS STICK VAC** always be observed, including the following:

- Read all instructions before using your **BAGLESS STICK VAC**.
- Use the system only for its intended use.
- To protect against a risk of electric shock, do not immerse any part of the system in water or other liquids.
- Never yank cord to disconnect from outlet; instead, grasp plug and pull to disconnect.
- Do not** allow cord to touch hot surfaces.
- Do not** run appliance over cord.
- Do not** operate the system with a damaged cord or plug, or if the appliance or any other part of the system has been dropped or damaged. To avoid the risk of electric shock, do not disassemble or attempt to repair the **BAGLESS STICK VAC**. Return the system to **FANTOM** (see warranty) for examination and repair. Incorrect re-assembly or repair can cause a risk of electrical shock or injury to persons when the **BAGLESS STICK VAC** is used.
- Close supervision is necessary for any appliance being used by or near children. Do not leave the system unattended while connected.
- Keep hair, loose clothing, fingers and all parts of body away from opening and moving parts.
- Do not** use to pick up flammable or combustible liquids such as gasoline or use in areas where they may be present.
- Do not** pick up anything that is burning or smoking such as cigarettes, matches or hot ashes.
- Use extra care when cleaning on stairs.
- Do not** use the hand vacuum without the HEPA-TYPE dust cup filter in place.
- This appliance is intended only for household use. Follow all user instructions in this manual.

## SAVE THESE INSTRUCTIONS For Household Use



**WARNING:** To reduce the risk of electric shock, do not use a polarized plug (one blade is wider than the other) in a polarized outlet only one way will fit. If it still does not fit, reverse the plug. If it still does not fit, do not attempt to install the proper outlet. Do not modify the plug.

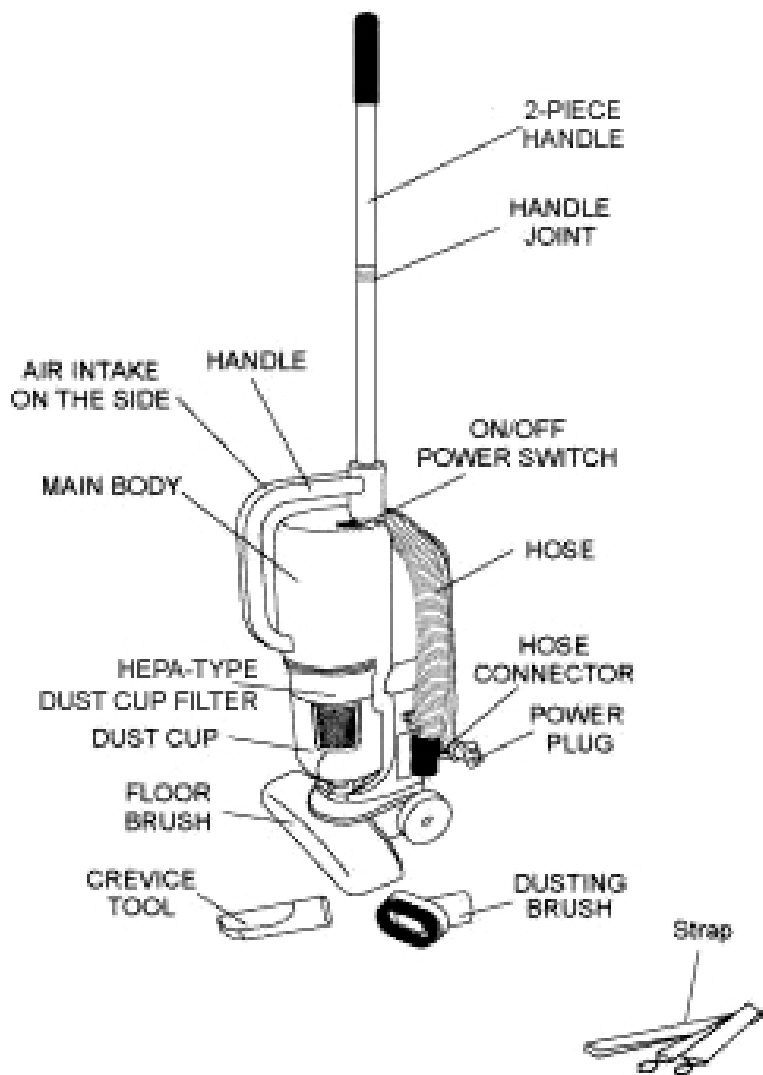

**Replacing The Dust Cup Into The Unit**

- Hold the dust cup in your hand.
- Make sure that the slot on the bottom of the cup is pointed in the same direction as the pins in the unit (see drawing #1).
- Slide the dust cup inside to the end of its place in the unit (see drawing #2).
- Turn the dust cup 90° in the direction shown in the drawing (#3) at right.
- The unit is now ready to be used again.

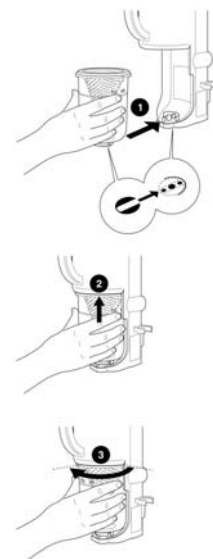

**Note:** To keep the vacuum cleaner looking new, it can be wiped with a damp cloth and a mild soap solution, then thoroughly dried. Never use any type of chemical cleaners as they can damage the vacuum cleaner. When not in use, store the vacuum cleaner in a dry, clean place.

**Technical Specifications**

Voltage: 120V., 60Hz.  
 Power: 7.5 Amps, 900 Watts

**NOTE:** Always turn off the power switch and unplug the electrical cord before emptying the Dust Cup.

**Cleaning & Changing the HEPA-TYPE Dust Cup Filter**

1. After you have emptied the dust from the Dust Cup (container), separate the debris screen from the HEPA-Type filter cartridge by grasping the debris screen with one hand and the filter frame with the other and pull apart.

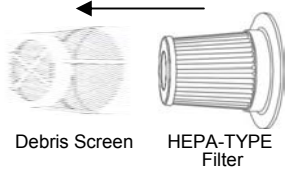

2. Rinse the debris screen under the faucet until clean. Allow to air dry or dry with a clean dish towel. Do NOT wash in dishwasher.
3. To clean the HEPA filter cartridge, hold filter by frame flange and tap filter on the inside wall of a dust container (garbage can).



Ensure that you do not damage the pleated filter material during cleaning. Also note that discoloration occurs during use. This does NOT affect the filter's performance.

4. Reassemble the debris screen to the HEPA-Type filter cartridge and replace into dust cup (container). Ensure that the filter assembly is completely seated inside the dust cup (container).
5. Attach the dust cup (container) to the vacuum.

**Important:** Do NOT use the HEPA-Type filter cartridge without the debris screen in place.

**PLEASE NOTE:** The white pleated filter material in the HEPA-TYPE Filter will discolor over time -This is NORMAL and will NOT affect the performance of the filter. If the HEPA-TYPE Filter is properly cleaned

after each use and suction does not return to 100%, then we suggest that the HEPA-TYPE Filter be cleaned vigorously until no more dust can be removed, then rinsed under the faucet and allowed to air dry for 24 hours before replacing into the vacuum. (Fig. A) **This should be done once a month or when suction appears to be reduced .**

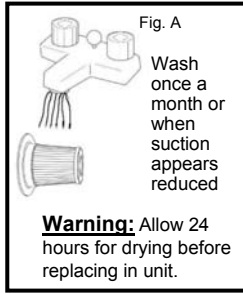

**NOTE: If you wash the HEPA-TYPE filter, make sure that it has completely air dried for 24 hours before inserting back in the vacuum.**

**Warning:** Always empty the dust cup and clean the HEPA-Type dust cup before each use and during prolonged usage. Never over fill the dust cup - remove dirt and clean the HEPA-Type dust cup filter during prolonged usage or risk motor damage. **Make sure that the debris screen and the HEPA-TYPE filter have completely air dried before replacing into the vacuum.**

**IMPORTANT:** If the suction opening in the vacuum cleaner and remove the blocking again.

1. Do not operate the vacuum cleaner too close to heaters, radiators or cigarette butts.

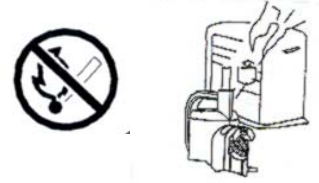

2. Before inserting the power plug into the wall outlet, make sure that your hands are dry.

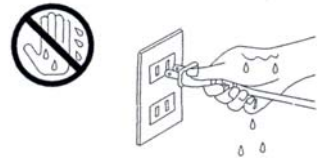

3. Before you start vacuuming, make sure to remove large or sharp objects that might damage the dust cup filter.

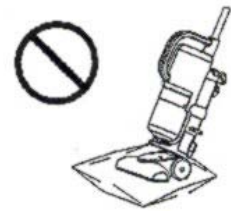

**NOTE:** Always remove the power plug from the wall outlet before assembling or removing accessories.

## INSERTING THE 2-PIECE METAL HANDLE INTO THE MAIN BODY

- Push in the pin at the end of the lower piece of the metal handle (see illustration).
- Insert the metal handle into the hole next to the handle. Make sure that the slot in the handle fits correctly into the opening. (See illustration.)
- When inserted correctly, the pin should rest in its hole.

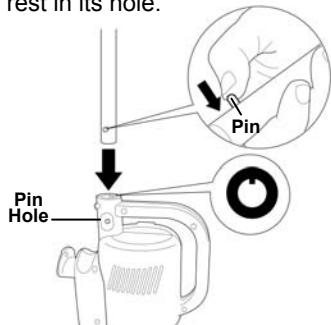

- To insert the upper piece of the metal handle, press on the pin that is on the upper handle and insert into the lower handle making sure that the pin comes out of the pinhole on the lower handle.

## ATTACHING THE FLOOR BRUSH TO THE MAIN BODY

- Push in the pin in the floor attachment as shown in the illustration at right.
- Insert the floor brush into its location, in the direction of the arrow.
- When inserted correctly, the pin will show in the pin hole.

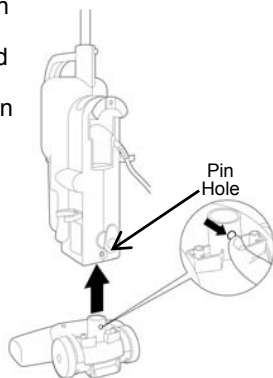

## ATTACHING THE HOSE TO THE MAIN BODY

- Press in the pin at the end of the hose (see illustration below).
- Insert the hose into its place (see arrow in illustration).
- When inserted correctly, the pin will show in the pin hole.

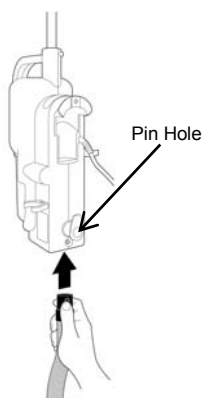

## ON/OFF SWITCH

- The On/Off switch has two different positions.
- Push on the "I" side to turn the vacuum ON.
- Push on the "O" side to turn the vacuum OFF.

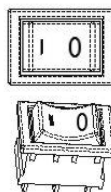
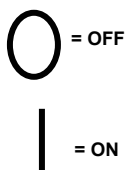

## WINDING & UNWINDING THE POWER CORD

- To wind the cord after usage, follow the illustration below.
- To unwind the power cord, follow the illustration below but in the opposite direction.



- When using the vacuum, attach the cord to the cord holder so that the cord is out of the way when you are vacuuming. (See below.)

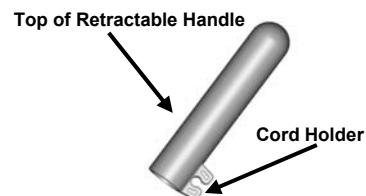

## USING THE UNIT AS AN UPRIGHT

- Unwind the power cord and plug into the 120V outlet.
- Push down in the direction of the arrow to obtain best results on carpets or on hard wood floors.

**NOTE:** When vacuuming deep pile carpets or hard to vacuum carpets, lower the angle of the 2-piece metal handle (see illustration at below) for easier maneuverability.

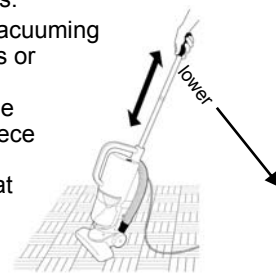

## USING THE UNIT AS A HAND VACUUM

- Disconnect the metal handle. (See page 4.)
- Disconnect the floor brush. (See page 4.)
- Attach the hose. (See page 4.)
- Attach the crevice tool or the dusting brush. (See below.)
- Attach the shoulder strap. (See page 7.)