

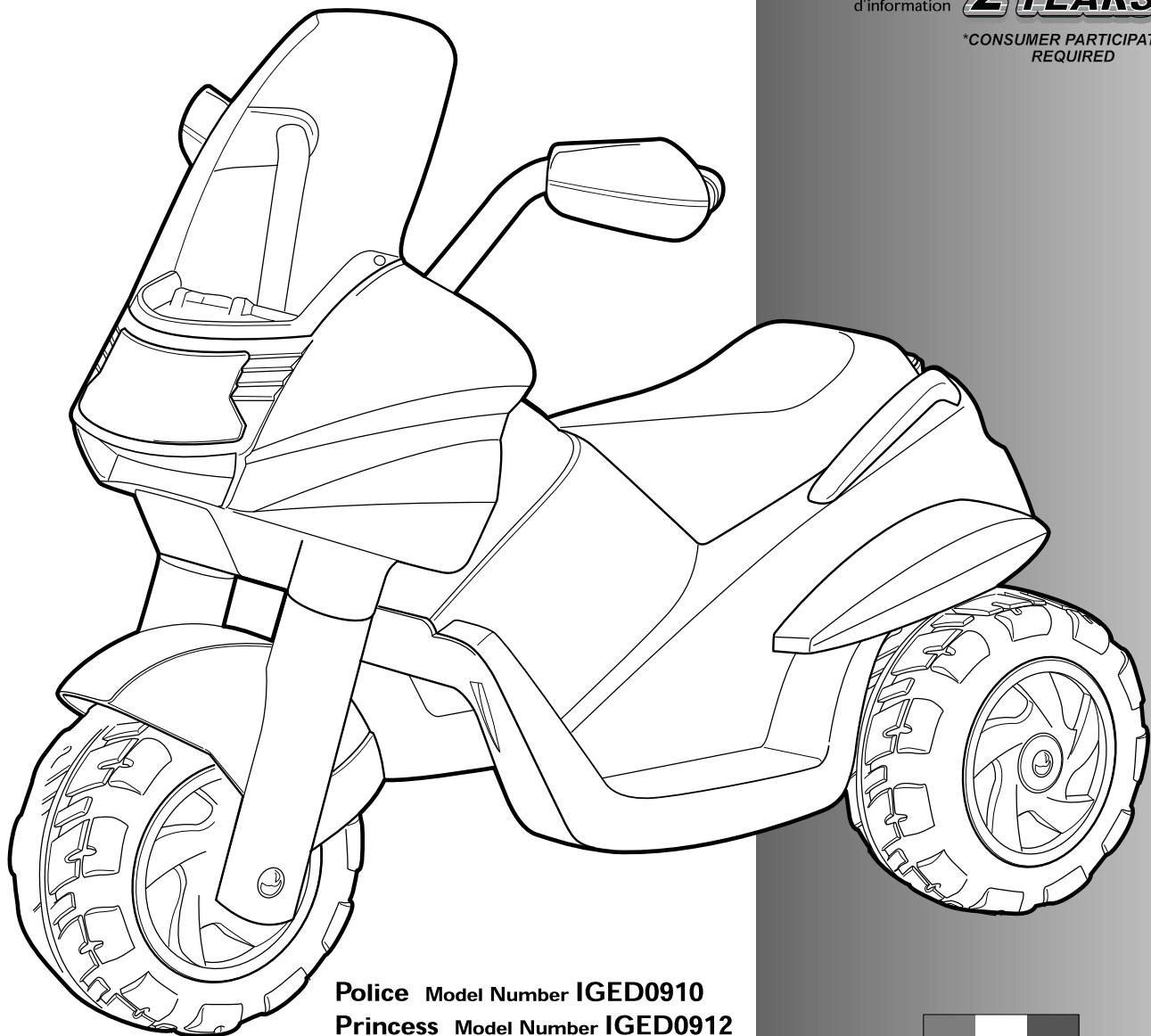

FIUS0901G136

# RAIDER 6VOLT



Police Model Number IGED0910  
Princess Model Number IGED0912

USE AND CARE **EN**

EMPLEOY MANUTENCION **ES**

UTILISATION ET ENTRETIEN **FR**

See separate insert  
sheet for more  
information

Vea la hoja separada del  
separador de millares  
para más información

Voir la feuille séparée  
d'insertion pour plus  
d'information



\*CONSUMER PARTICIPATION  
REQUIRED



MADE in ITALY

SEE VERBAL INSTRUCTIONS  
AFTER THE PICTURES

VER LAS INSTRUCCIONES  
DESPUÉS DE LOS DISEÑOS

VOIR LES INSTRUCTIONS APRÈS  
LES DESSINS

INITIAL BATTERY CHARGE

PRIMERA CARGA DE LA  
BATERÍA

PREMIÈRE CHARGE DE  
BATTERIE

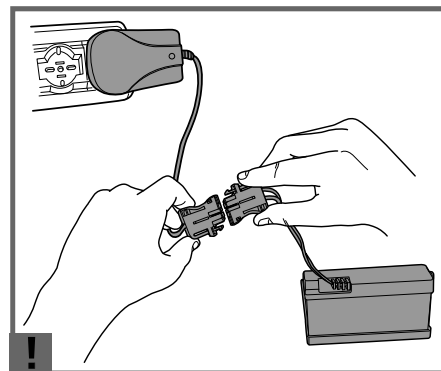

ASSEMBLY

MONTAJE

MONTAGE

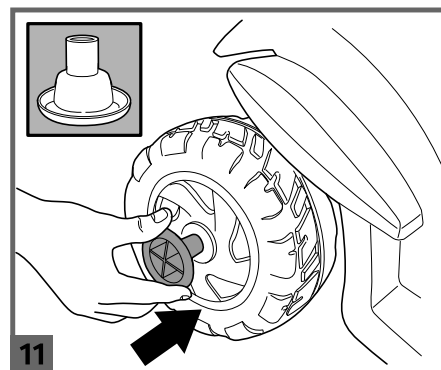
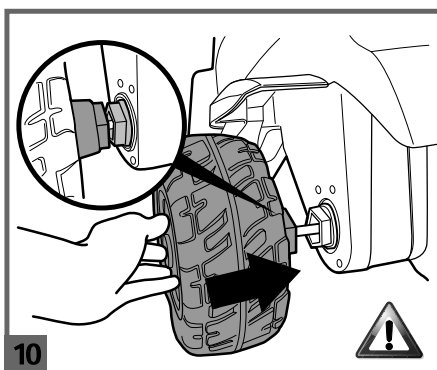
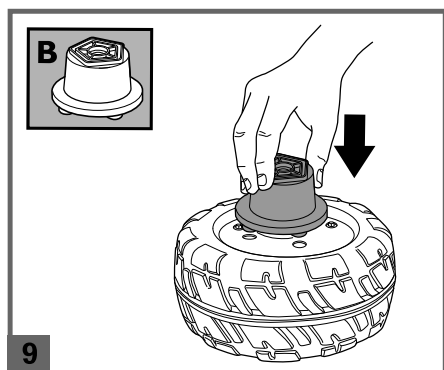
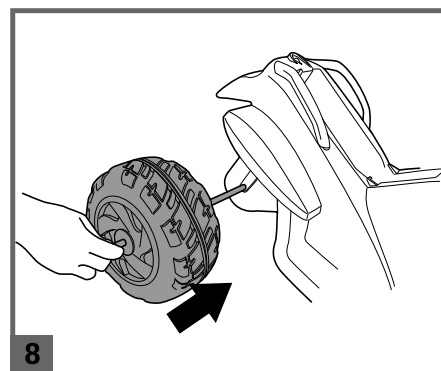
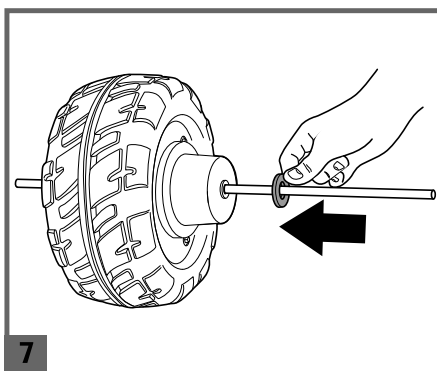
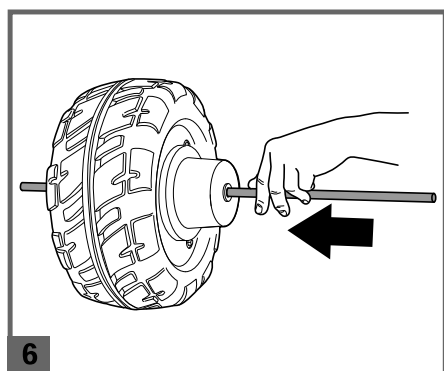
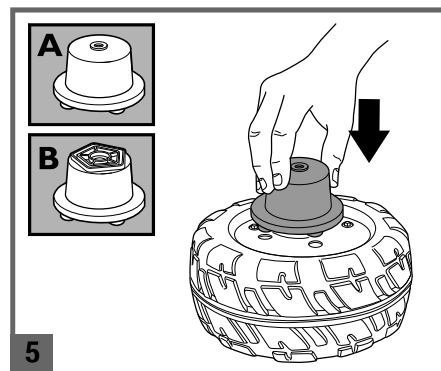
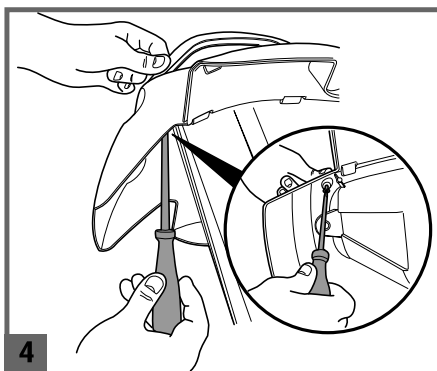
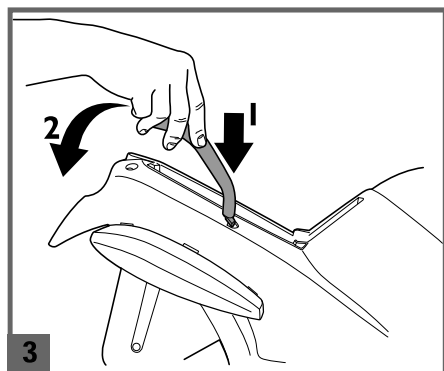
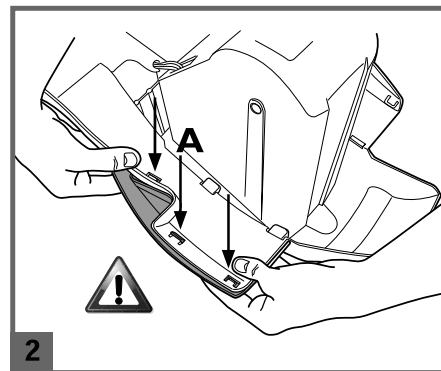
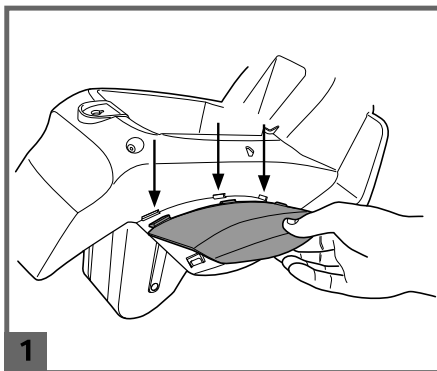

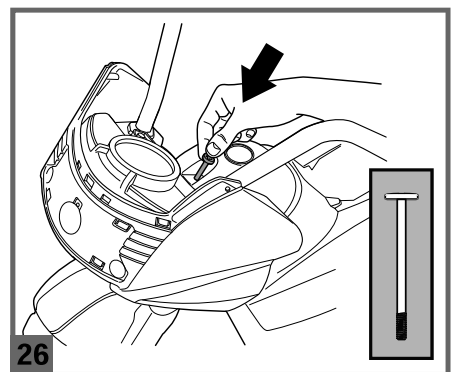
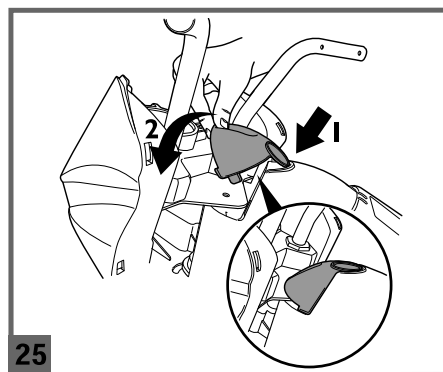
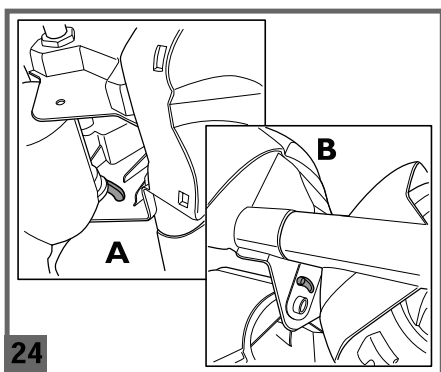
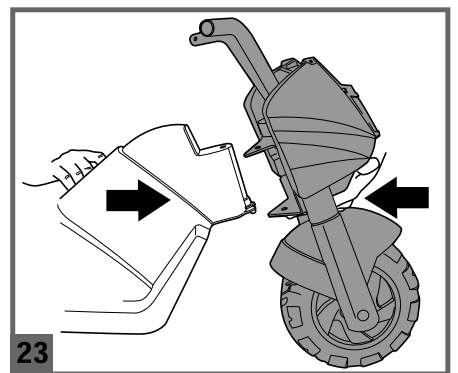
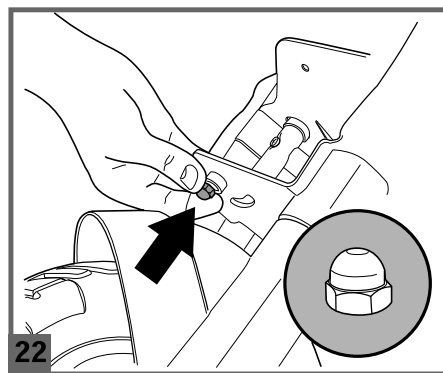
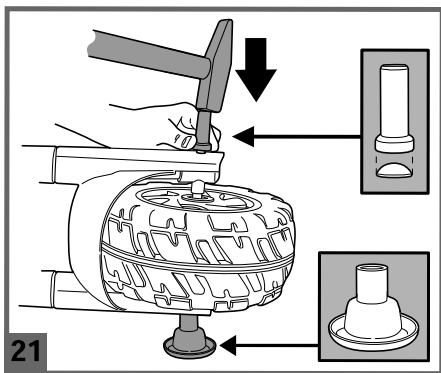
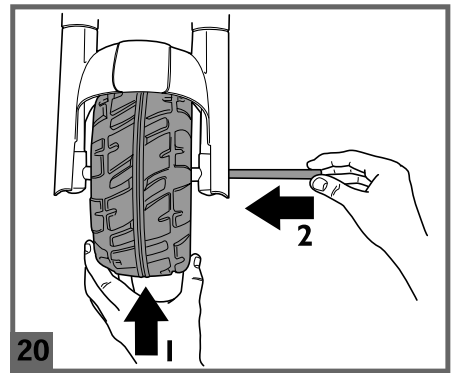
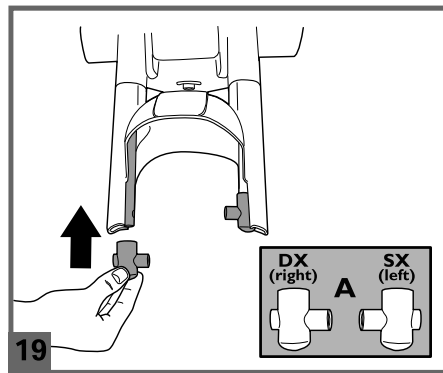
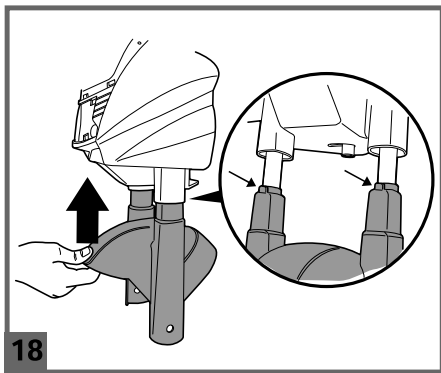
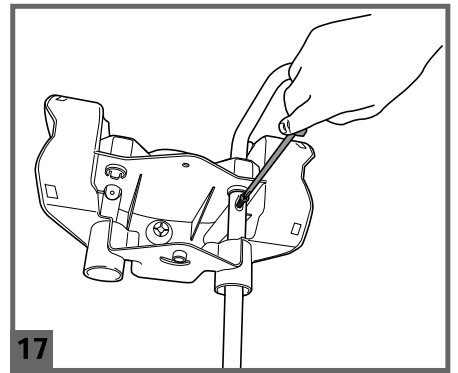
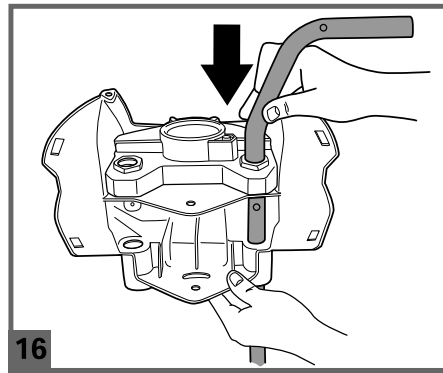
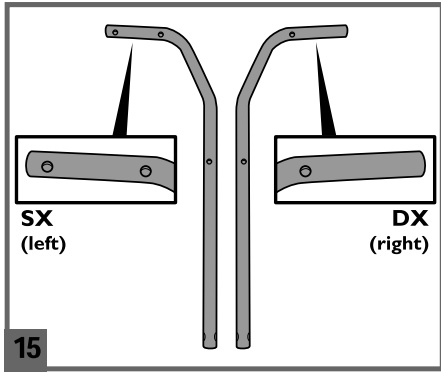
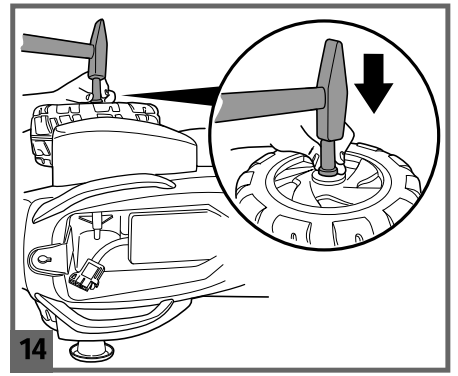
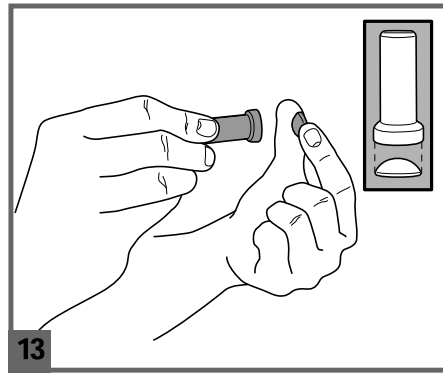
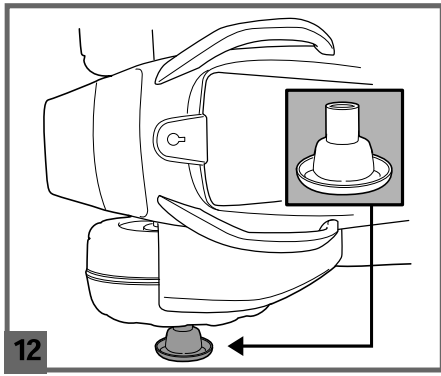

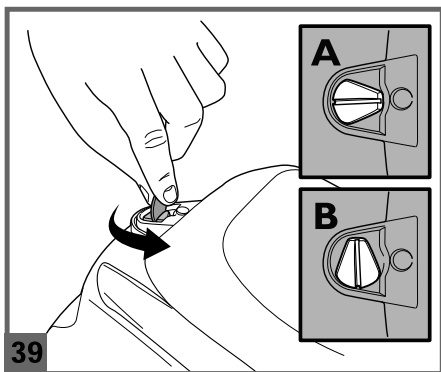
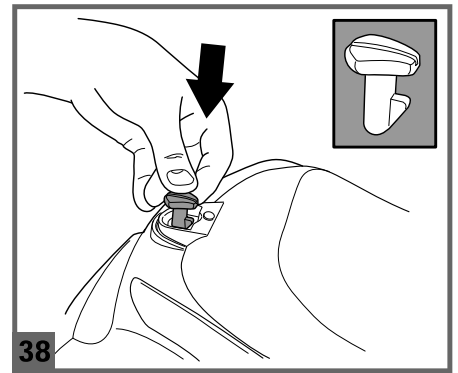
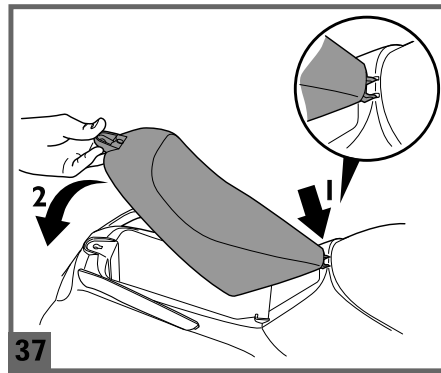
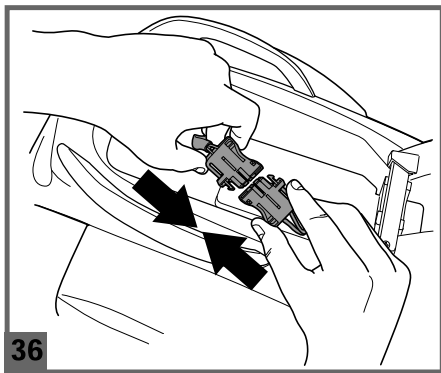
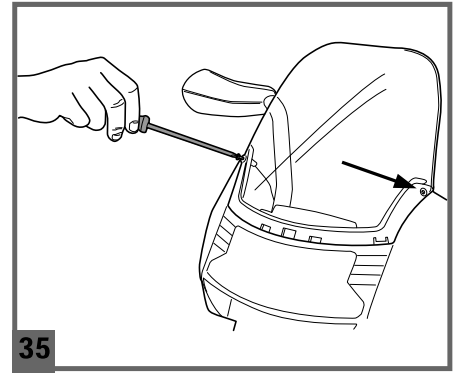
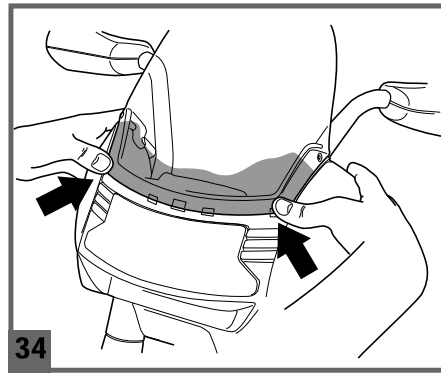
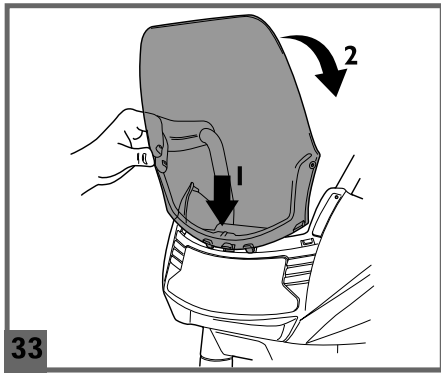
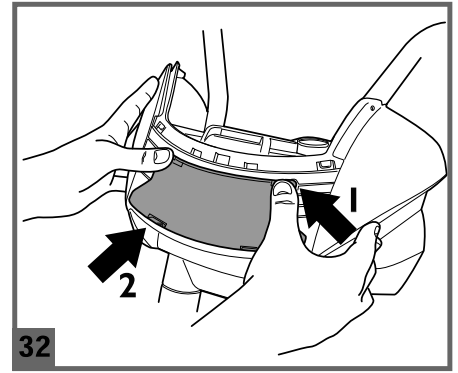
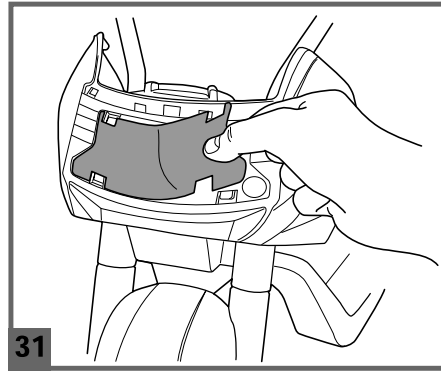
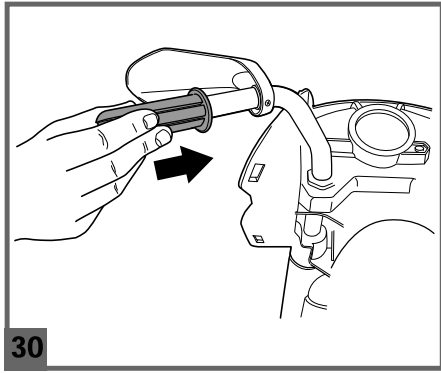
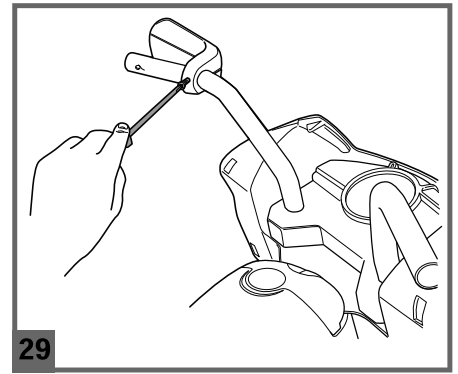
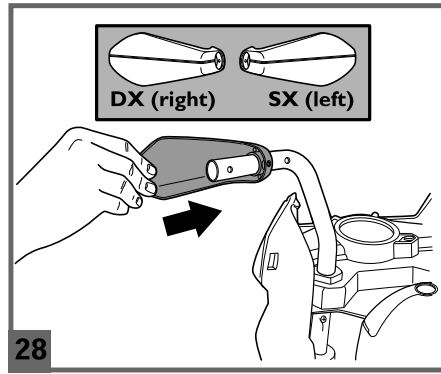
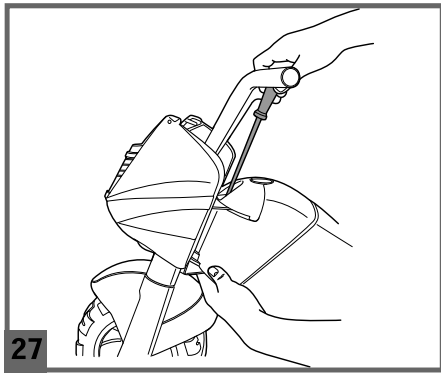

VEHICLE FEATURES AND  
INSTRUCTIONS FOR USE

CARACTERÍSTICAS Y USO DEL  
VEHÍCULO

CARACTERISTIQUES ET  
UTILISATION DU VEHICULE

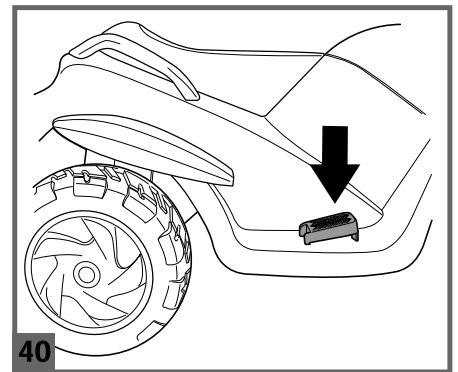

**BATTERY REPLACEMENT**

**CAMBIO DE LA BATERÍA**

**REPLACEMENT DE LA BATTERIE**

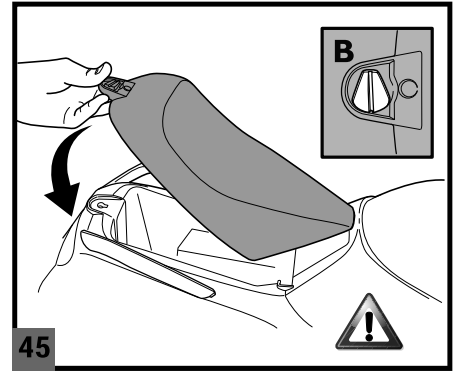
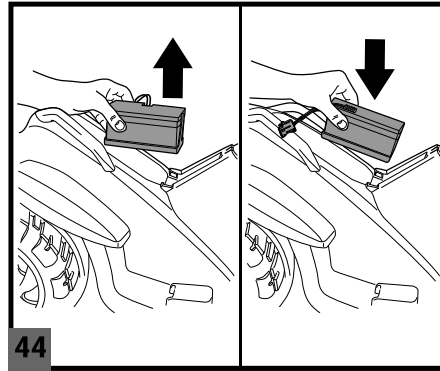
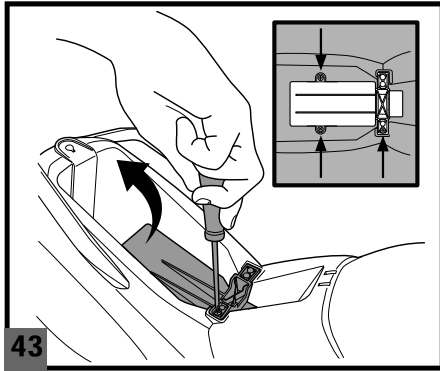
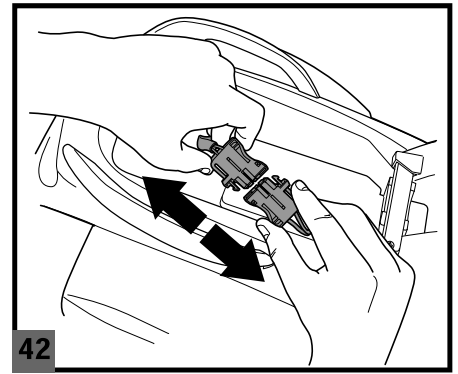
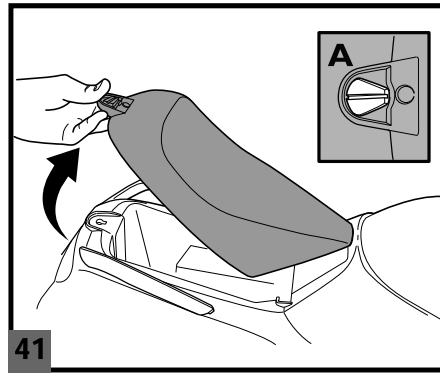

**BATTERY RECHARGE**

**CARGA DE LA BATERÍA**

**CHARGE DE LA BATTERIE**

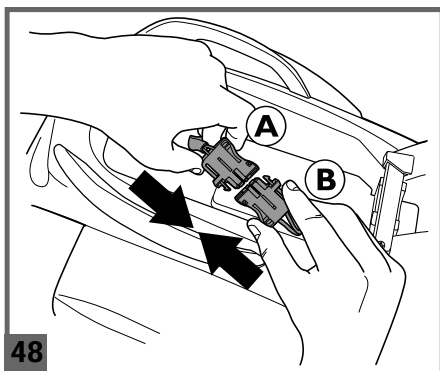
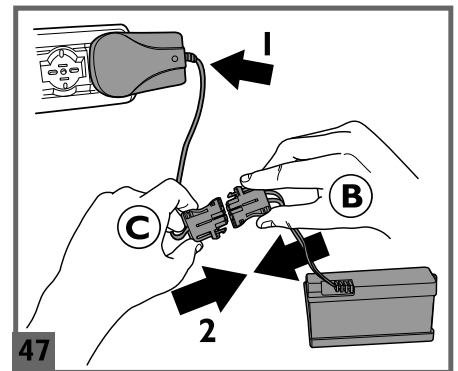
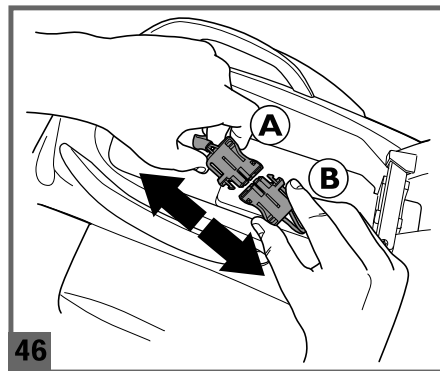

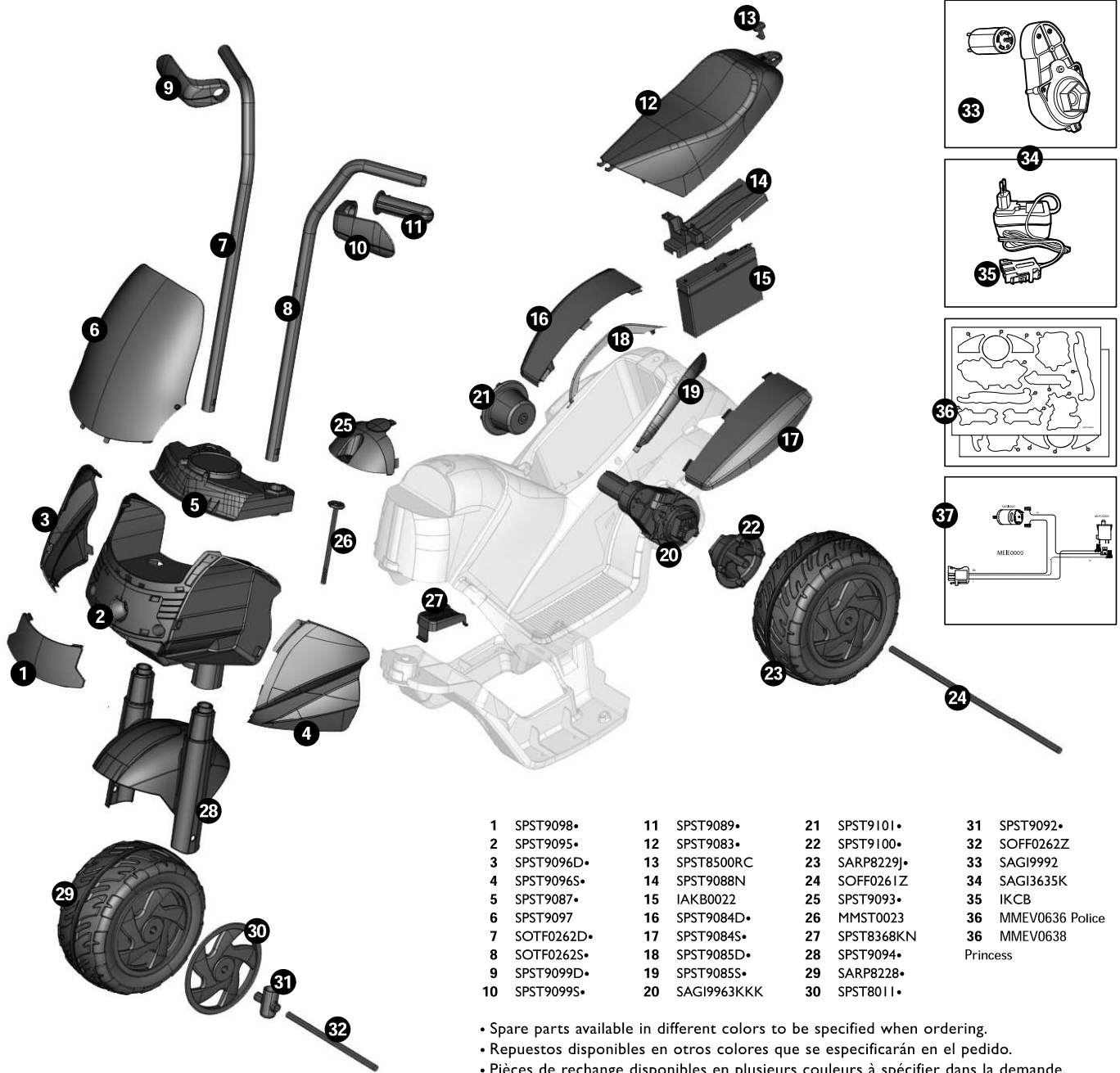

- |               |                |               |                    |
|---------------|----------------|---------------|--------------------|
| 1 SPST9098•   | 11 SPST9089•   | 21 SPST9101•  | 31 SPST9092•       |
| 2 SPST9095•   | 12 SPST9083•   | 22 SPST9100•  | 32 SOFF0262Z       |
| 3 SPST9096D•  | 13 SPST8500RC  | 23 SARP8229J• | 33 SAGI9992        |
| 4 SPST9096S•  | 14 SPST9088N   | 24 SOFF0261Z  | 34 SAGI3635K       |
| 5 SPST9087•   | 15 IAKB0022    | 25 SPST9093•  | 35 IKCB            |
| 6 SPST9097    | 16 SPST9084D•  | 26 MMST0023   | 36 MMEV0636 Police |
| 7 SOTF0262D•  | 17 SPST9084S•  | 27 SPST8368KN | 36 MMEV0638        |
| 8 SOTF0262S•  | 18 SPST9085D•  | 28 SPST9094•  | Princess           |
| 9 SPST9099D•  | 19 SPST9085S•  | 29 SARP8228•  |                    |
| 10 SPST9099S• | 20 SAGI9963KKK | 30 SPST8011•  |                    |

• Spare parts available in different colors to be specified when ordering.  
 • Repuestos disponibles en otros colores que se especificarán en el pedido.  
 • Pièces de rechange disponibles en plusieurs couleurs à spécifier dans la demande.

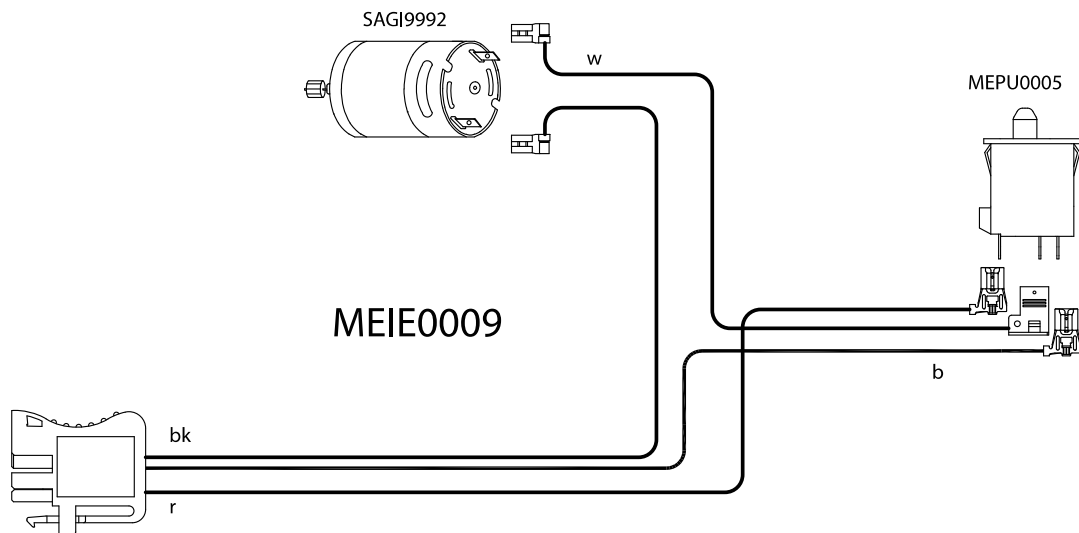

PEG PEREGO® thanks you for choosing this product. For almost 60 years, PEG PEREGO have been taking children for an outing: first with its famous baby carriages and strollers, later with its pedal and battery operated toy vehicles.

Discover our complete range of products, news and other information about the Peg Perego world on our web site [www.pegperego.com](http://www.pegperego.com)

## IMPORTANT INFORMATION

- Read this instruction manual carefully to learn the use of the vehicle and to teach your child safe and enjoyable driving. Please keep this manual (with your original sales receipt) for use as a reference in the future.
- **DO NOT RETURN YOUR VEHICLE TO THE STORE. This product cannot be returned for a refund after it has been used. If you have ANY questions, need replacement parts or need assistance, call us toll-free; U.S.A. , call 1-800-728-2108 / CANADA, call 1-800-661-5050**
- This product meets and/or exceeds all ASTM (American Society for Testing and Materials) TOY SAFETY STANDARDS, including F 963, Consumer Toy Safety Specifications as well as C.R.C, c.931, the Canadian Hazardous Products (Toys) Regulations.
- Tools needed for assembly: small and medium phillips screwdrivers and a hammer.
- Your new vehicle is partially pre-assembled. It will require adult assembly. Please set aside at 45 minutes for assembly.
- Before the vehicle is used for the first time, charge the battery for 18 hours to initiate them. Failure to do this can result in permanent battery damage.
- Use only with the included Peg Perego 6 Volt lead-acid, rechargeable battery and a Peg Perego 6 Volt Charger (both included).

### • Year 2+

### • Weight capacity 44 lbs

- Do not exceed the maximum total weight capacity of 44 lbs (20Kg).

#### Contents:

- 1 Raider Police or 1 Rider Princess riding vehicle -- partially assembled
- 1 Rechargeable 6V 3,3Ah sealed lead-acid battery
- 1 Charger 6V
- one 60 W motor -- pre installed
- assembly hardware
- parts to be assembled
- decals

- Speed: 2.6 mph

- On vehicles that have forward & reverse; please teach your child to stop the vehicle before switching directions to prevent damage to the drive mechanism.
- Peg Perego reserves the right to modify or change its products. Price, literature, manufacturing processes or locations or any combination of the above mentioned entities may change at any time for any reason without notice with impunity.

## ⚠ CAUTION:

ELECTRIC VEHICLE NOT RECOMMENDED FOR CHILDREN UNDER 2 YEARS OF AGE. AS WITH ALL ELECTRIC PRODUCTS, PRECAUTIONS SHOULD BE OBSERVED DURING HANDLING AND USE TO PREVENT ELECTRIC SHOCK. RECHARGER INCLUDED. 120 VOLTS, 60Hz, 15W INPUT, 6 VOLTS (DC) OUTPUT.

## **⚠ CAUTION:**

Only adults should recharge batteries never children.

Never allow children to handle batteries.

Only use the batteries specified by the manufacturer. Only use the charger specified by the manufacturer.

Do not mix old and new batteries.

Do not mix alkaline, standard (carbon-zinc), or rechargeable (nickel-cadmium) batteries.

### CHARGING THE BATTERY

- Charge the batteries no longer than 24 hours, following the instructions enclosed with the battery charger.
- Charge the battery, as the vehicle shows low power, in this way you will avoid damage to the battery.
- If you don't use your vehicle for a long period of time unplug the battery from the main wire harness of the vehicle. Remember to charge the battery at least every three months.
- Never charge the battery upside down.
- Do not forget batteries during charging! Check them periodically.
- Never use a replacement recharger or batteries unless they are approved by PEG PEREGO.
- Batteries are sealed and maintenance free.
- Battery polarity must be observed when connecting battery to wiring.

## **⚠ WARNING:**

- BATTERIES CONTAIN TOXIC AND CORROSIVE SUBSTANCES. DO NOT TAMPER WITH THEM.
- Batteries contain an acid-based electrolyte.
- Do not make direct contact between battery terminals, as this can cause an explosion or fire.
- Charging produces explosive gases. Charge batteries in a well ventilated area away from sources of heat and flammable materials.
- Exhausted batteries are to be removed from the vehicle.
- Do not place the batteries near clothing to avoid damage.

### IF A LEAK DEVELOPS

Shield your eyes. Avoid direct contact with the electrolyte, protect your hands.

Place battery in a plastic bag and follow directions listed below.

### IF ELECTROLYTE COMES IN CONTACT WITH SKIN OR CLOTHING

Flush with cool water for at least 15 minutes.

See a physician at once.

### IF ELECTROLYTE IS INJECTED

Give tap water, milk of magnesia or egg whites at once.

Do not induce vomiting.

See a physician at once.

### DISPOSAL OF BATTERIES

Help protect the environment!

Do not throw used batteries in your regular, household trash.

Dispose of the old batteries in an approved dumping station; contact your local environmental protection agency office for further information.





## INITIAL BATTERY CHARGE

!• Remove battery and charger from packaging. Connect battery charger to a 120vac wall recepticle. Connect battery charger to battery.

## ASSEMBLY INSTRUCTIONS

### CAUTION:

ADULT ASSEMBLY REQUIRED.

USE CARE WHEN UNPACKING AS COMPONENTS TO BE ASSEMBLED MAY POSE A SMALL PARTS/SHARP EDGE HAZARD.

BATTERY ALREADY INSTALLED IN VEHICLE.

- 1 • Clip the rear fender into place by inserting the 3 tabs in the slots in the body shown by the arrows.
- 2 • Turn the body upside down and attach the fender to it by pressing it, making sure the centre tab is inserted first (A).
  - Repeat steps 1 and 2 on the other side.
- 3 • Insert the handle in the hole in the body (1) and turn it downwards (2). PLEASE NOTE: The two handles are different. Position them with the flat side facing the saddle.
- 4 • Turn the body over to access the underside and attach the handle with the screw provided.
  - Repeat steps 3 and 4 with the other handle.
- 5 • Place bushing A into one of the 2 rear wheels (hubcap on 1 side only); align the 4 pins with the holes.
- 6 • Insert the long metal axle into the wheel.
- 7 • Slide a washer onto the axle.
- 8 • Insert the axle with the wheel and washer in the hole on the right hand side of the body, as shown in the figure.
- 9 • Place the remaining bushing (B) on the other wheel with only one hubcap.
- 10 • Insert the wheel on the axle on the other rear wheel hand side of the body, making sure the wheel bushing is properly fitted into the pentagon on the trike.
- 11 • Place the red tool on one of the two ends of the axle.
- 12 • Turn over the body, keeping the red tool underneath.
- 13 • Insert a retainer in the black tool.
- 14 • Put it on the other end of the axle as shown in the figure and use a hammer to secure the wheel with the retainer.
  - Turn the trike over and repeat the procedure to secure the other wheel.
- 15 • Look closely at the handlebar tubes to ensure they are fitted properly. The left hand tube (marked SX/Left) has two holes in the upper section, unlike the right hand one (marked DX/Right).
- 16 • Insert the right tube in the right hand side of the front section, as shown in the figure.
- 17 • Secure it with the screw provided.
  - Repeat steps 16 and 17 with the left tube.
- 18 • Insert the front fender onto the handlebar tubes, positioning it as shown in the figure. PLEASE NOTE: The fender is fitted with two tabs that prevent it from being fully attached if it is inserted incorrectly.
- 19 • Insert the caps in the handlebar tubes, positioning them as shown in figure A.
- 20 • Insert the wheel between the tubes and line up all the holes. Insert the short metal axle.
- 21 • Put the red tool in place and turn over the entire handlebar unit, keeping the red tool underneath.
  - Insert a retainer in the black tool and secure the wheel as shown in the figure.
  - Turn the handlebar unit onto the other side and repeat the procedure to secure the wheel there too.
- 22 • Attach the nut provided under the front section.
- 23 • Attach the handlebar unit to the body, ensuring that the clip locks into place in the part below the front section (see the details in the following picture).
- 24 • The clip has to lock into the curved slot, as shown in detail in the figure (A: view from above - B: view from below).
- 25 • Attach the tank cover by clipping into place the 3 tabs in the body, as shown in the figure.
- 26 • Insert the threaded pin.
- 27 • Fasten the threaded pin to attach the handlebar unit to the body, holding the nut under the front section still with the other hand.
- 28 • Insert the hand guard marked DX (right) on the right handlebar tube and the hand guard marked SX (left) on the left handlebar tube. The picture shows how to fit the hand guard marked SX (left).
- 29 • Secure the hand guards with the screws provided.
- 30 • Wet the inside of the rubber grip to make it easier to slide onto the handlebar tube. The rubber grips are identical and can go on the right or left side.
- 31 • Attach the silver sticker included in the packet.
- 32 • Clip the headlight into place, pressing first on the upper part and then on the lower part.
- 33 • Insert the windshield into the upper part of the front section.
- 34 • Press the windshield against the front section in the points shown in the figure.
- 35 • Attach the windshield with the two screws provided.
- 36 • Connect the electrical system plug to the battery.
- 37 • Insert the front part of the saddle in the body (1), then pull it down (2).
- 38 • Push the locking clip all the way down in the hole at the rear of the saddle.
- 39 • Turn the locking clip to position B to secure the saddle.

## VEHICLE FEATURES AND INSTRUCTIONS FOR USE

- 40 • The vehicle is ready for use. With both hands on the handlebar, press the accelerator pedal with your foot.

## BATTERY REPLACEMENT

### WARNING:

WARNING: BATTERY CHARGING AND ANY OTHER OPERATION ON THE ELECTRICAL SYSTEM MUST BE CARRIED OUT BY ADULTS ONLY.

THE BATTERY CAN ALSO BE CHARGED WITHOUT REMOVING IT FROM THE VEHICLE.

- 41 • Turn the locking clip to position A to release the saddle. Remove the saddle.
- 42 • Disconnect the vehicle's electrical system connector from the battery.
- 43 • Unfasten the 3 screws on the battery holder. Remove the battery holder.
- 44 • Replace the flat battery with another battery that has been charged for at least 14 hours. PLEASE NOTE: Replacement batteries are only sold with electrical power of 6V/8Ah. This does not affect the operation of the vehicle.
- 45 • Replace the battery holder and secure it with the 3 screws. Reconnect the plugs. Replace the saddle and turn the locking clip to position B.
  - WARNING: After working inside the battery compartment, always remember to secure the components with the screw and clip.

## BATTERY RECHARGER

- 46 • Disconnect plug A of the electrical system from the battery plug B by pressing the sides.
- 47 • Plug the battery charger into a domestic power supply, following the instructions provided with it. Connect plug B to the battery charger plug C.
  - When charging is complete, unplug the battery charger from the domestic socket and then disconnect plug C from plug B.
- 48 • Push plug B into plug A until it clicks into place. After completing the procedure, always remember to replace and secure the saddle.

## RULES FOR SAFETY DRIVING

**DON'T STOP THE FUN:** always have freshly charged, back-up batteries on hand.

For your child's safety: please read and follow all instructions below before operating.

• **ATTENTION:**

Check the fastening retainers to be sure they are tight.

• **FORWARD SPEED:**

With both hands on the handlebars, press down on the accelerator pedal; the vehicle goes forward at 2,5 mph.

• **BRAKE:**

The electric braking system stops the vehicle automatically when your child lifts his foot off the pedal.

Teach your child the proper use of this vehicle for a safe and fun play time.

- Before starting be sure that the way is free from people and objects.
- Drive with both hands on the handlebar and keep your eyes on the road at all times.
- Please teach your child to stop in time to avoid running into objects or people and to immediately release the accelerator pedal if they do run into an object or person.

## ⚠ **CAUTION:**

- **If the vehicle is overloaded, as can happen on soft sand, mud, or very uneven ground, the overload switch will immediately disconnect the power. The power supply will be restored after a few seconds.**

## VEHICLE MAINTENANCE AND SAFETY

This product meets and/or exceeds all ASTM (American Society for Testing and Materials) TOY SAFETY STANDARDS, including F 963, Consumer Toy Safety Specification.

This vehicle is not intended for use on streets, around traffic or parked cars.

### **MAINTENANCE AND CARE**

- Regularly check the conditions of the vehicle, particularly the electrical system, the plug connections, the covering caps and the charger. In case of fault, do not try to use the vehicle and the charger. For repair use only original PEG PEREGO's spare parts.
- PEG PEREGO assumes no liability if the electrical system is tampered with.
- Do not leave vehicle or batteries near sources of heat such as radiators, stoves, fireplaces, etc.
- Protect vehicle from water, rain, snow, etc.
- When operating in overload conditions, such as soft deep sand, mud or rough uneven terrain, the overload circuit breaker will automatically disconnect the power. After 10 or more seconds, the circuit breaker will automatically reset, however you must eliminate overload conditions to resume normal driving.
- Periodically lubricate (with a light weight oil) moving parts, such as wheel bearings, steering linkages, where they rotate or touch one another.
- The vehicle's surface can be cleaned with a dampcloth. Do not use abrasive cleaners. The cleaning must be carried out by adults only.
- Never disassemble the vehicle mechanisms or motor unless authorized by PEG PEREGO.

### **SAFETY**

## ⚠ **WARNING:**

- To reduce the risk of injury, adult supervision is required. Never use in roadways, near motor vehicles, on or near steep inclines or steps, swimming pools or other bodies of water; always wear shoes, and never allow more than one rider.
- Surface that are appropriate for use: asphalt, cement, tiles and slopers up to 5%.
- A child must be 2 years of age or older for the necessary coordination and maturation to operate this motorized vehicle safely.
- Never use the vehicle on steep slopes or near steps or stairs. This vehicle is not suitable for use on public highways.
- Children should always wear shoes when riding in or driving a riding vehicle.
- The use of a certified bicycle helmet is strongly recommended.
- Do not allow children to place their hands, feet or any part of their body, clothing or other articles near the moving parts while vehicle is in operation.
- Do not allow the electrical components, motors, wiring, switches of your motorized vehicle to become wet and never wash it with a hose.
- Never use gasoline or other flammable substances near the vehicle.
- The vehicle is designed just for one child: never allow more than one rider

## PROBLEMS?

### IF THE VEHICLE DOES NOT OPERATE?

- **When operating in overload conditions, such as running the vehicle against a fixed object, through soft deep sand or mud, or over rough or uneven terrain, the overload circuit breaker will automatically disconnect the power. After 10 or more seconds, the circuit breaker will automatically reset, however-you must eliminate overload conditions to resume normal driving.**
- Check that all plugs are properly connected.
- Check electrical switches. Replace if necessary.
- Check that the battery is connected to the electrical system.

### IF THERE IS NO POWER?

- Fully recharge the battery. If the problem persists, check with an Authorized PEG PEREGO Service Center.

## CUSTOMER SERVICE

For your convenience, PEG PEREGO offers after-sales service, directly or through a network of authorized service centers for repairs or replacement parts.

If you have any questions about your Peg Perego vehicle, please call our toll-free service lines at;

**U.S.A , call 1-800-728-2108**

**CANADA, call 1-800-661-5050**

Trained customer service representatives are available to take your call in English or Spanish.

This document was created with Win2PDF available at <http://www.win2pdf.com>.  
The unregistered version of Win2PDF is for evaluation or non-commercial use only.  
This page will not be added after purchasing Win2PDF.