

**6  
VOLT**

# ROCKY

Model Number IGED0092US

**Peg-Pérego**

made in italy

USE AND CARE **EN**

EMPLOY Y MANUTENCION **ES**

UTILISATION ET ENTRETIEN **FR**

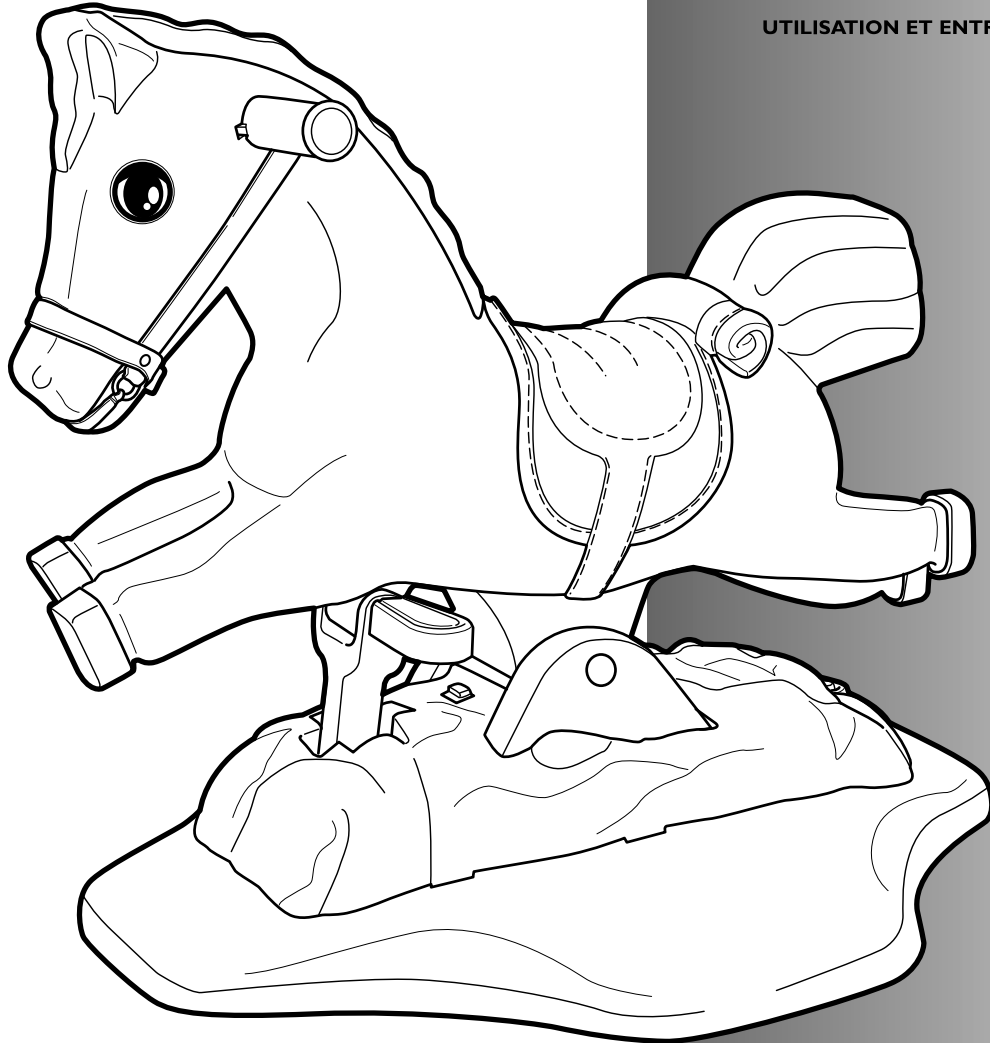

See separate insert  
sheet for more  
information

Vea la hoja separada del  
separador de millares  
para más información

Voir la feuille séparée  
d'insertion pour plus  
d'information



**2 YEARS\***

\*CONSUMER PARTICIPATION  
REQUIRED

FIUS100IG143



SEE VERBAL INSTRUCTIONS  
AFTER THE PICTURES

VER LAS INSTRUCCIONES  
DESPUÉS DE LOS DISEÑOS

VOIR LES INSTRUCTIONS  
APRÈS LES DESSINS

INITIAL BATTERY CHARGE

PRIMERA CARGA DE LA  
BATERÍA

PREMIÈRE CHARGE DE  
BATTERIE

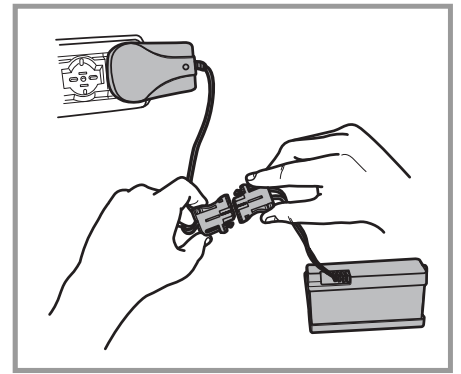

ASSEMBLY

MONTAJE

MONTAGE

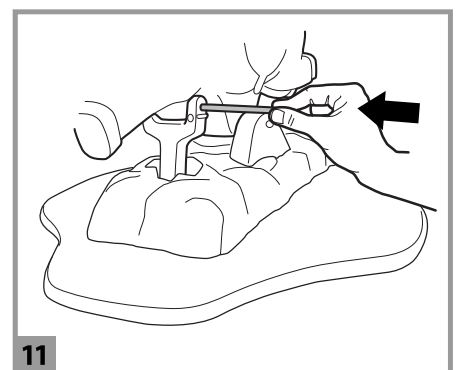
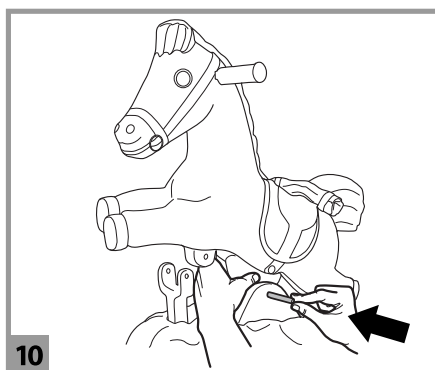
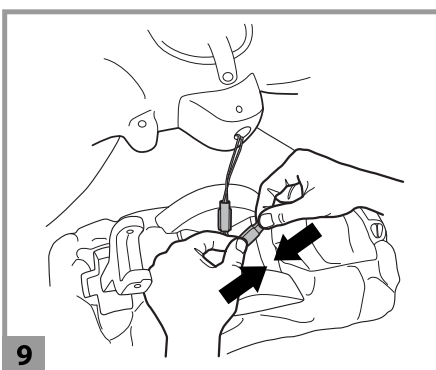
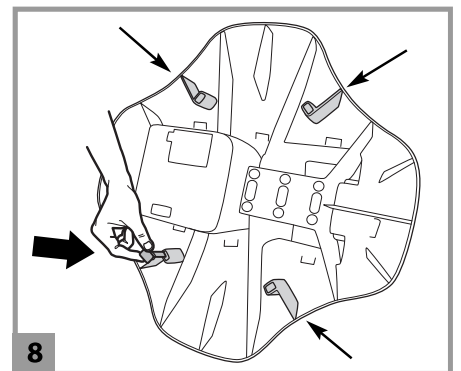
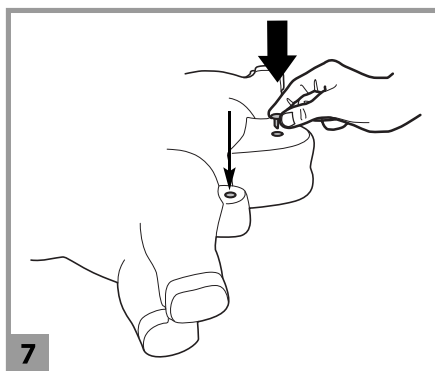
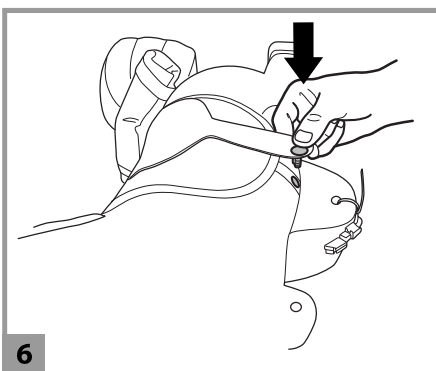
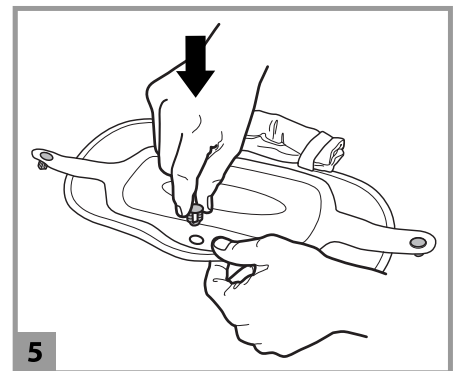
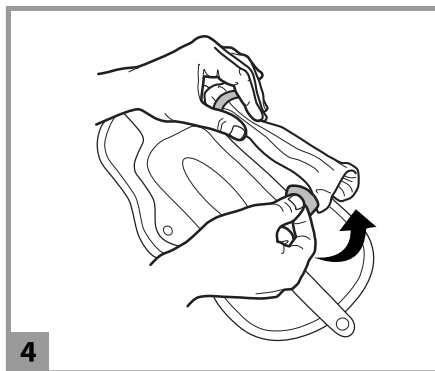
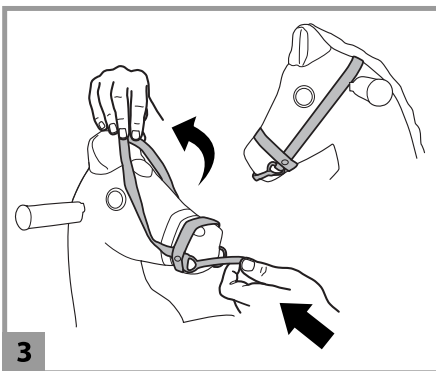
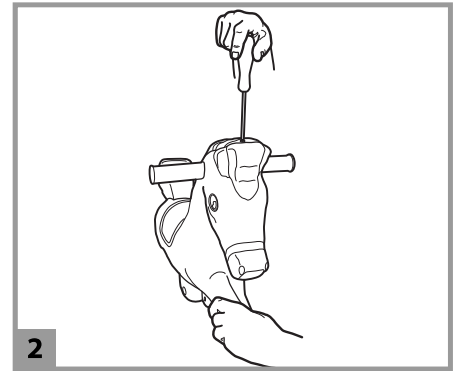
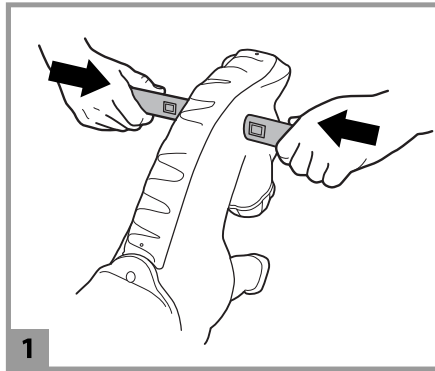

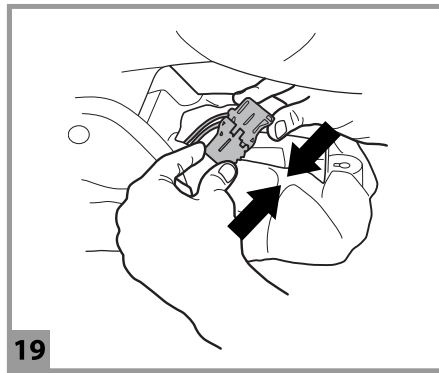
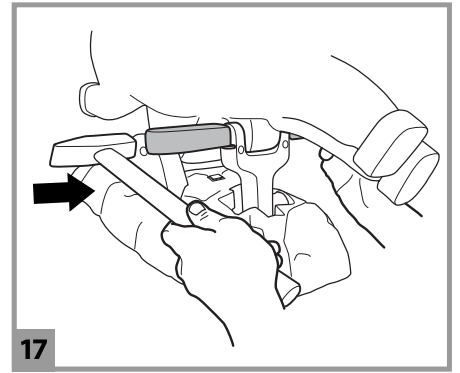
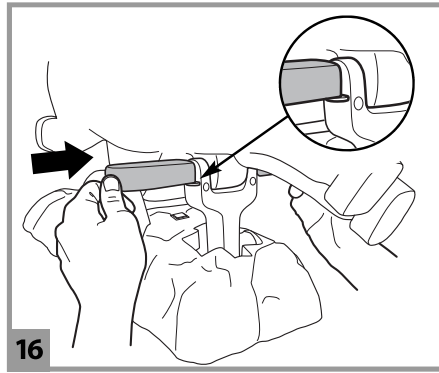
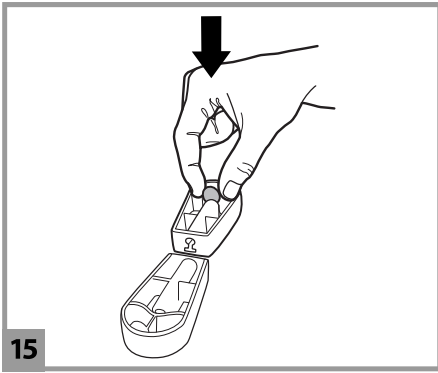
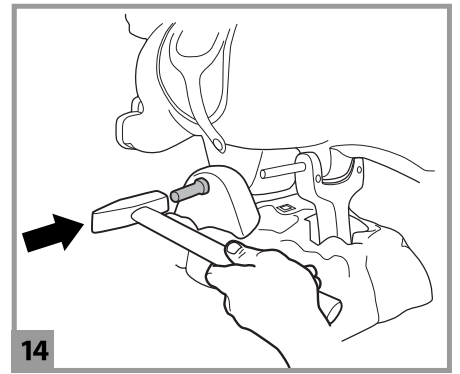
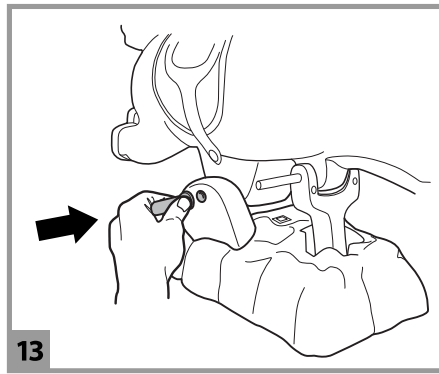
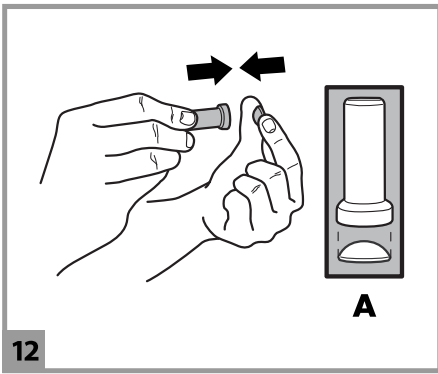

**VEHICLE FEATURES AND  
INSTRUCTIONS FOR USE**  
**CARACTERÍSTICAS Y USO DEL  
VEHÍCULO**  
**CARACTÉRISTIQUES ET  
UTILISATION DU VEHICULE**

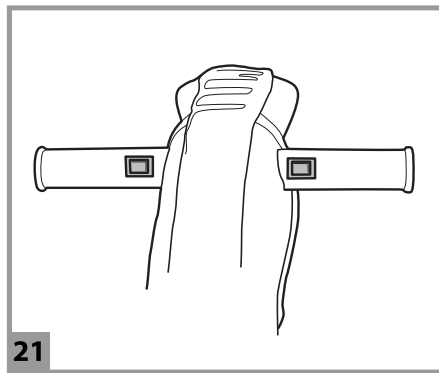
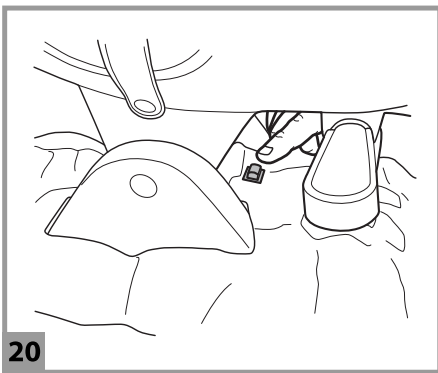

**BATTERY REPLACEMENT**  
**CAMBIO DE LA BATERÍA**  
**REPLACEMENT DE LA BATTERIE**

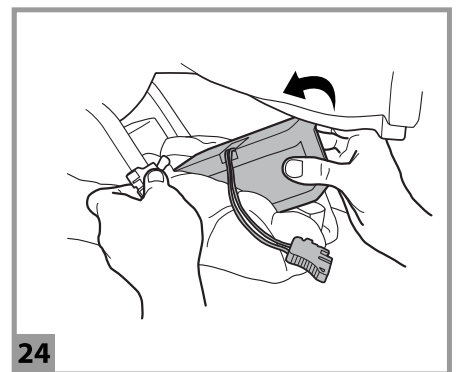
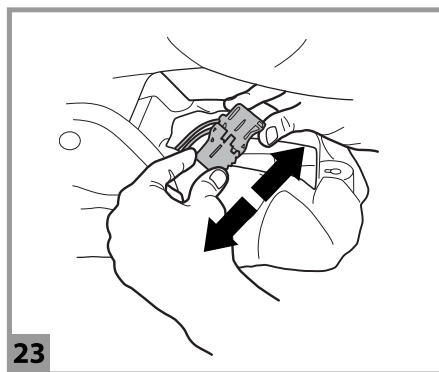
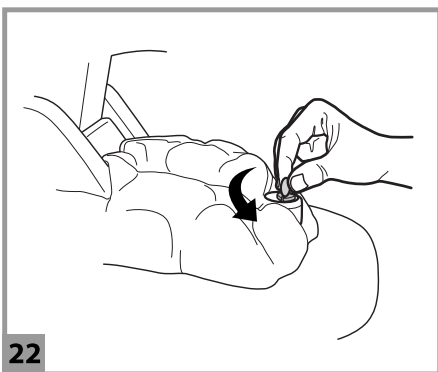

**BATTERY RECHARGE**  
**CARGA DE LA BATERÍA**  
**CHARGE DE LA BATTERIE**

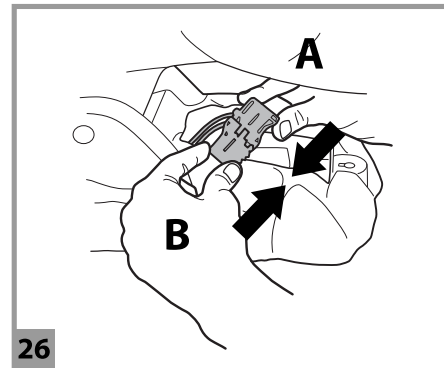
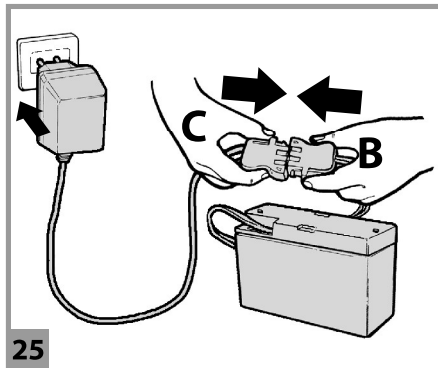



PEG PEREGO® thanks you for choosing this product. For almost 60 years, PEG PEREGO have been taking children for an outing: first with its famous baby carriages and strollers, later with its pedal and battery operated toy vehicles.

Discover our complete range of products, news and other information about the Peg Perego world on our web site [www.pegperego.com](http://www.pegperego.com)

## IMPORTANT INFORMATION

- Read this instruction manual carefully to learn the use of the toy and to teach your child safe and enjoyable driving. Please keep this manual (with your original sales receipt) for use as a reference in the future.
- **DO NOT RETURN YOUR TOY TO THE STORE. This product cannot be returned for a refund after it has been used. If you have ANY questions, need replacement parts or need assistance, call us toll-free; U.S.A. , call 1-800-728-2108 / CANADA, call 1-800-661-5050**
- This product meets and/or exceeds all ASTM (American Society for Testing and Materials) TOY SAFETY STANDARDS, including F 963, Consumer Toy Safety Specifications as well as C.R.C, c.931, the Canadian Hazardous Products (Toys) Regulations.
- Tools needed for assembly: small and medium phillips screwdrivers and a hammer.
- Your new toy is partially pre-assembled. It will require adult assembly. Please set aside at 15-20 minutes for assembly.
- Before the toy is used for the first time, charge the battery for 18 hours to initiate them. Failure to do this can result in permanent battery damage.
- Use only with the included Peg Perego 6 Volt lead-acid, rechargeable battery and a Peg Perego 6 Volt Charger (both included).

- **Year 1+**
- **Weight capacity 40 lbs**

- Do not exceed the maximum total weight capacity of 40 lbs (18,1Kg).

### Contents:

- 1 Battery powered rocking horse -- partially assembled
- 1 Rechargeable 6V 3,3Ah sealed lead-acid battery
- 1 Charger 6V
- one 40 W motor -- pre installed
- assembly hardware
- parts to be assembled
- decals

- Speed: 40 cycles per minute

- Peg Perego reserves the right to modify or change its products. Price, literature, manufacturing processes or locations or any combination of the above mentioned entities may change at any time for any reason without notice with impunity.

## CAUTION:

ELECTRIC TOY NOT RECOMMENDED FOR CHILDREN UNDER 1 YEAR OF AGE. AS WITH ALL ELECTRIC PRODUCTS, PRECAUTIONS SHOULD BE OBSERVED DURING HANDLING AND USE TO PREVENT ELECTRIC SHOCK. RECHARGER INCLUDED. 120 VOLTS, 60Hz, 15W INPUT, 6 VOLTS (DC) OUTPUT.

## ⚠️ CAUTION:

Only adults should recharge batteries never children.

Never allow children to handle batteries.

Only use the batteries specified by the manufacturer. Only use the charger specified by the manufacturer.

Do not mix old and new batteries.

Do not mix alkaline, standard (carbon-zinc), or rechargeable (nickel-cadmium) batteries.

### CHARGING THE BATTERY

- Charge the batteries no longer than 24 hours, following the instructions enclosed with the battery charger.
- Charge the battery, as the toy shows low power; in this way you will avoid damage to the battery.
- If you don't use your toy for a long period of time unplug the battery from the main wire harness of the toy. Remember to charge the battery at least every three months.
- Never charge the battery upside down.
- Do not forget batteries during charging! Check them periodically.
- Never use a replacement recharger or batteries unless they are approved by PEG PEREGO.
- Batteries are sealed and maintenance free.
- Battery polarity must be observed when connecting battery to wiring.

## ⚠️ WARNING:

- BATTERIES CONTAIN TOXIC AND CORROSIVE SUBSTANCES. DO NOT TAMPER WITH THEM.
- Batteries contain an acid-based electrolyte.
- Do not make direct contact between battery terminals, as this can cause an explosion or fire.
- Charging produces explosive gases. Charge batteries in a well ventilated area away from sources of heat and flammable materials.
- Exhausted batteries are to be removed from the toy.
- Do not place the batteries near clothing to avoid damage.

### IF A LEAK DEVELOPS

Shield your eyes. Avoid direct contact with the electrolyte, protect your hands.

Place battery in a plastic bag and follow directions listed below.

### IF ELECTROLYTE COMES IN CONTACT WITH SKIN OR CLOTHING

Flush with cool water for at least 15 minutes.

See a physician at once.

### IF ELECTROLYTE IS INJECTED

Give tap water, milk of magnesia or egg whites at once.

Do not induce vomiting.

See a physician at once.

### DISPOSAL OF BATTERIES

Help protect the environment!

Do not throw used batteries in your regular, household trash.

Dispose of the old batteries in an approved dumping station; contact your local environmental protection agency office for further information.



## INITIAL BATTERY CHARGE

- !• Remove battery and charger from packaging. Connect battery charger to a 120vac wall recepticle. Connect battery charger to battery.

## ASSEMBLY INSTRUCTIONS

### CAUTION:

ADULT ASSEMBLY REQUIRED. USE CARE WHEN UNPACKING AS COMPONENTS TO BE ASSEMBLED MAY POSE A SMALL PARTS/SHARP EDGE HAZARD.

- 1 • Remove the elastic holding strap from the handles. Insert them into the 2 slots, ensuring that the connection teeth are correctly attached to the central pin and that the 2 buttons are positioned as shown in the figure.
- 2 • Unfasten the 2 screws on the mane.
- 3 • Put the bridle on the horse's nose and over the head as far as the handles, as shown in the figure. Put the mane back in place and fasten the 2 screws.
- 4 • Roll up the upper end of the blanket and insert the 2 ends in the matching loops, as shown in the figure.
- 5 • Push the 3 plastic clips all the way down into their holes in the saddle.
- 6 • Attach the saddle to the horse by pushing the 3 clips into the slots.
- 7 • Remove the holding band from the connectors in the lower part of the horse. Insert 2 white bushes into the matching holes on each side of the horse.
- 8 • Push the 4 rubber feet into place underneath the base.
- 9 • Hook up the connectors on the horse with those on the base. **WARNING:** Match together the connectors of the same colour.
- 10 • Take the shorter metal pin from the parts bag. Slot it through the central area of the base and the horse. **WARNING:** Ensure that the cables connected in the previous step are protected inside the horse and that the horse is facing the right direction.
- 11 • Take the other pin from the parts bag and push it through at the front, as shown in the figure.
- 12 • Put 2 self-locking washers in the 2 special tools provided. Important: the tabs on the self-locking washers must be pointing towards the inside of the tools (see detail A).
- 13 • Put the 2 tools on the sides of the central pin and push the 2 washers onto it.
- 14 • Use a hammer to ensure that they are securely attached. Remove the tools.
- 15 • Put 2 more self-locking washers in the lower part of the footrests, as shown in the figure. **WARNING:** When turning over the footrests to fit them, ensure that the washers do not fall out.
- 16 • Push the footrests on, ensuring that they are facing the right way and that they go over the ribs, as shown in the figure.
- 17 • Use a hammer to fix the footrests in place on both sides, keeping the opposite side steady.
- 18 • Use a tool to turn the safety catch of the battery compartment by 90° and remove the cover.
- 19 • Connect the electrical system plug to the battery plug and put the cables back inside the compartment. Close the battery compartment again and secure it with the catch. The item is ready for use.

## FEATURES AND INSTRUCTIONS FOR USE

- 20 • **ON-OFF BUTTON:** It deactivates (OFF – button raised) and activates (ON – button pressed down) the movement function.
- 21 • **HANDLE CONTROLS:** When the ON-OFF button is ON, the black button on the right starts the movement and a galloping sound, while the red one on the left produces a neighing sound.  
When the ON-OFF button is OFF, the button on the right produces the galloping sound, while the one on the left produces the neighing sound.  
In both the ON and the OFF mode, pressing the red button on the left on its own produces 2 tunes.
- **STOPPING:** If the movement button on the right handle is released, the item will stop automatically.

## BATTERY REPLACEMENT

### WARNING:

**WARNING: BATTERY CHARGING AND ANY OTHER OPERATION ON THE ELECTRICAL SYSTEM MUST BE CARRIED OUT BY ADULTS ONLY.**

**THE BATTERY CAN ALSO BE CHARGED WITHOUT REMOVING IT FROM THE TOY.**

- 22 • Put the rear legs in the highest position and turn the catch to open the battery compartment.
- 23 • Disconnect the plugs by pressing them on the sides.
- 24 • Remove and replace the battery. Reconnect the plugs. Close the battery compartment again and secure it with the catch.

## BATTERY RECHARGER

- Disconnect plug A of the electrical system from the battery plug B by pressing the sides.
- 25 • Insert the battery charger plug in a domestic power socket in accordance with the instructions enclosed with it. Connect plug B to the battery charger plug C.
  - When charging is complete, detach the battery charger from the domestic supply and then disconnect plug C from plug B.
  - 26 • Fully insert plug B into plug A, pushing until it clicks. After completing the procedure, always remember to close and secure the battery compartment cover with the catch.



## RULES FOR SAFETY DRIVING

DON'T STOP THE FUN: always have freshly charged, back-up batteries on hand.

For your child's safety: please read and follow all instructions below before operating.

• **ATTENTION:**

Check the fastening retainers to be sure they are tight.

Teach your child the proper use of this toy for a safe and fun play time.

### **⚠ CAUTION:**

• **If the toy is overloaded, the overload switch will immediately disconnect the power. The power supply will be restored after a few seconds.**

## MAINTENANCE AND SAFETY

This product meets and/or exceeds all ASTM (American Society for Testing and Materials) TOY SAFETY STANDARDS, including F 963, Consumer Toy Safety Specification.

### **MAINTENANCE AND CARE**

- Regularly check the conditions of the toy, particularly the electrical system, the plug connections, the covering caps and the charger. In case of fault, do not try to use the toy and the charger. For repair use only original PEG PEREGO's spare parts.
- PEG PEREGO assumes no liability if the electrical system is tampered with.
- Do not leave toy or batteries near sources of heat such as radiators, stoves, fireplaces, etc.
- Protect toy from water, rain, snow, etc.
- When operating in overload conditions, the overload circuit breaker will automatically disconnect the power. After 10 or more seconds, the circuit breaker will automatically reset, however you must eliminate overload conditions to resume normal driving.
- Periodically lubricate (with a light weight oil) moving parts, such as wheel bearings, steering linkages, where they rotate or touch one another.
- The toy's surface can be cleaned with a dampcloth. Do not use abrasive cleaners. The cleaning must be carried out by adults only.
- Never disassemble the toy mechanisms or motor unless authorized by PEG PEREGO.

### **SAFETY**

### **⚠ WARNING:**

- To reduce the risk of injury, adult supervision is required. Never use in roadways, near motor vehicles, on or near steep inclines or steps, swimming pools or other bodies of water; always wear shoes, and never allow more than one rider.
- Surface that are appropriate for use: asphalt, cement, tiles and smooth surfaces.
- A child must be 1 year of age or older for the necessary coordination and maturation to operate this motorized toy safely.
- Never use the toy on steep slopes or near steps or stairs. This toy is not suitable for use on public roadways.
- Children should always wear shoes when riding in or driving a riding toy.
- Do not allow children to place their hands, feet or any part of their body, clothing or other articles near the moving parts while toy is in operation.
- Do not allow the electrical components, motors, wiring, switches of your motorized toy to become wet and never wash it with a hose.
- Never use gasoline or other flammable substances near the toy.
- The toy is designed just for one child: never allow more than one rider.

## PROBLEMS?

IF THE TOY DOES NOT OPERATE?

- **When operating in overload conditions, the circuit breaker will automatically disconnect the power. After 10 or more seconds, the circuit breaker will automatically reset, however-you must eliminate overload conditions to resume normal operating.**
- Check that all plugs are properly connected.
- Check electrical switches. Replace if necessary.
- Check that the battery is connected to the electrical system.

IF THERE IS NO POWER?

- Fully recharge the battery. If the problem persist, check with an Authorised PEG PEREGO Service Center.

## CUSTOMER SERVICE

For your convenience, PEG PEREGO offers after-sales service, directly or through a network of authorized service centers for repairs or replacement parts.

If you have any questions about your Peg Perego vehicle, please call our toll-free service lines at;

**U.S.A , call 1-800-728-2108**

**CANADA, call 1-800-661-5050**

Trained customer service representatives are available to take your call in English or Spanish.

This document was created with Win2PDF available at <http://www.win2pdf.com>.  
The unregistered version of Win2PDF is for evaluation or non-commercial use only.  
This page will not be added after purchasing Win2PDF.