

This Owner's Manual is provided and hosted by [Appliance Factory Parts](#).



# Peg-Perego IGOR0039 Owner's Manual

[Shop genuine replacement parts for Peg-Perego  
IGOR0039](#)



[Find Your Peg-Perego Ride On Parts - Select From 224 Models](#)

----- Manual continues below -----



FIUS0901G137



**JOHN DEERE**

**EN**

**USE AND CARE**

**ES**

**EMPLEO Y MANUTENCION**

**FR**

**UTILISATION ET ENTRETIEN**

**NOTE:** Included rechargeable 12 volt battery located under hood.

**NOTA:** Batería recargable incluida de 12 voltios situada debajo de la capó.

**NOTE:** Batterie rechargeable incluse de 12 volts située sous le capot.

Requires 2 AA batteries (not included)  
Requerir 2 AAbatería (no inclusa)  
Exige 2 batteries de AA (ne pas inclus)



**JOHN DEERE**  
LICENSED PRODUCT

**12V**



# John Deere GROUND FORCE TRACTOR & TRAILER

Model Number IGOR0039

SEE VERBAL INSTRUCTIONS  
AFTER THE PICTURES

VER LAS INSTRUCCIONES  
DESPUÉS DE LOS DISEÑOS

VOIR LES INSTRUCTIONS  
APRÈS LES DESSINS

ASSEMBLY

MONTAJE

MONTAGE

1

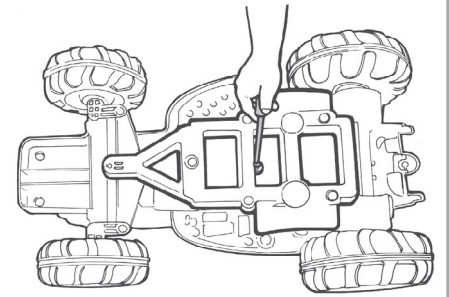

2

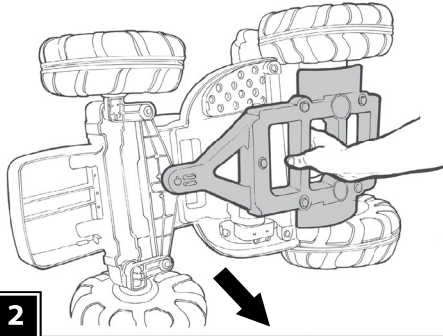

3

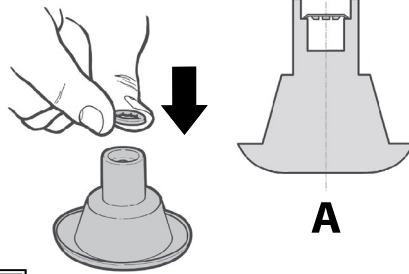

4

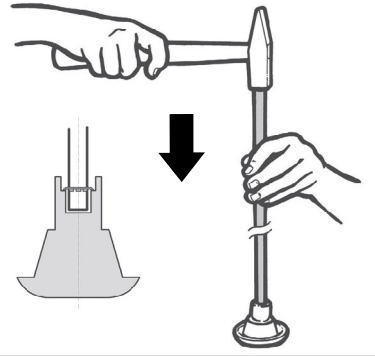

5

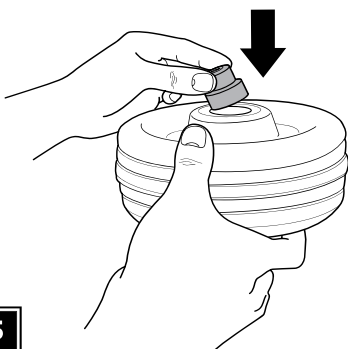

6

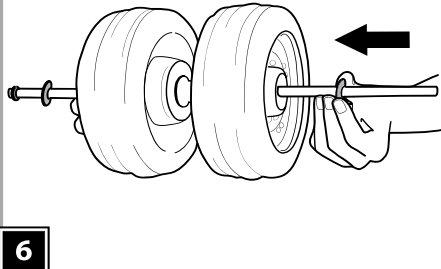

7

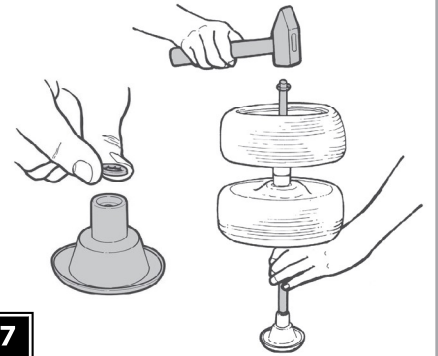

8

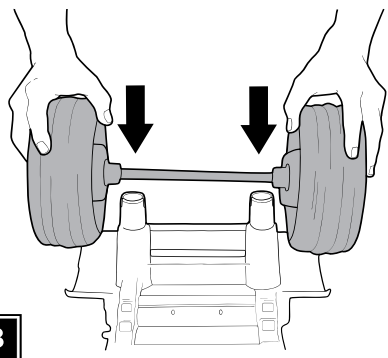

9

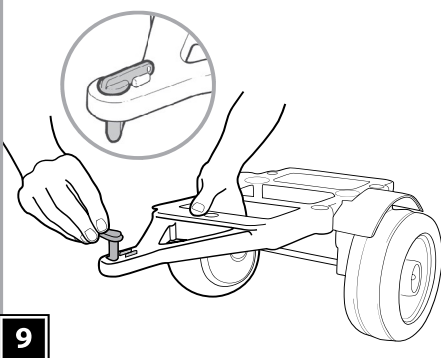

10

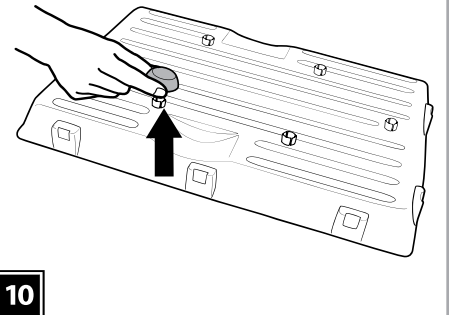

11

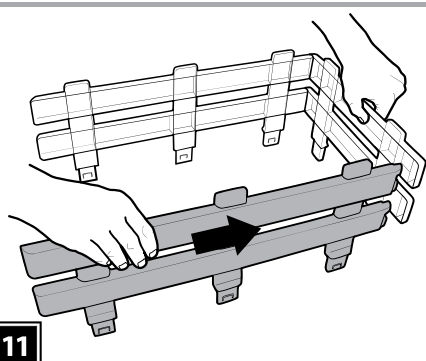

12

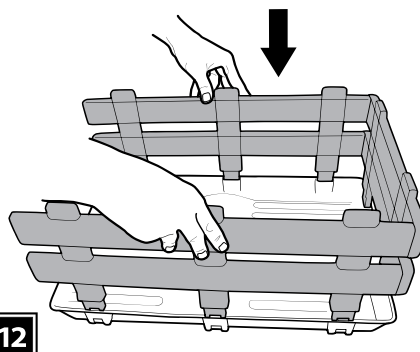

13

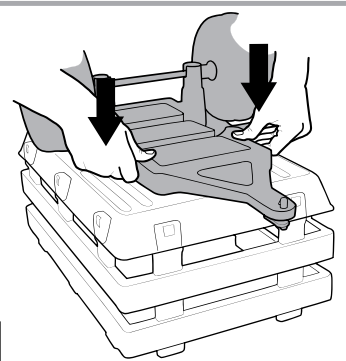

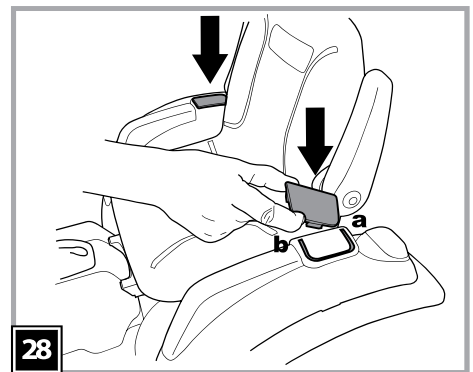
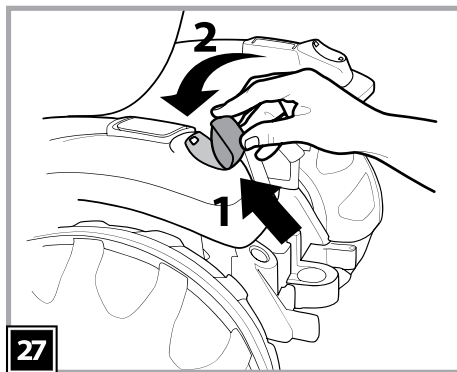
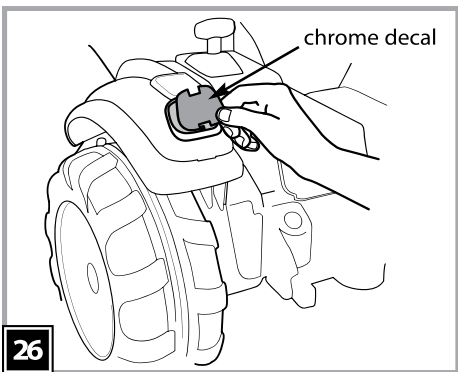
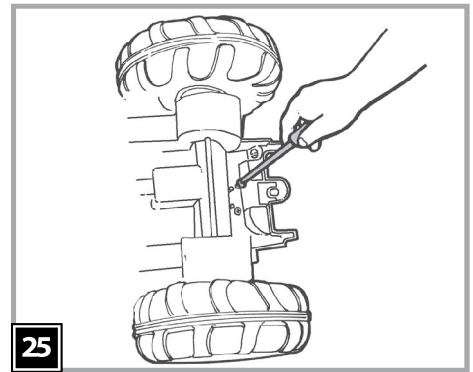
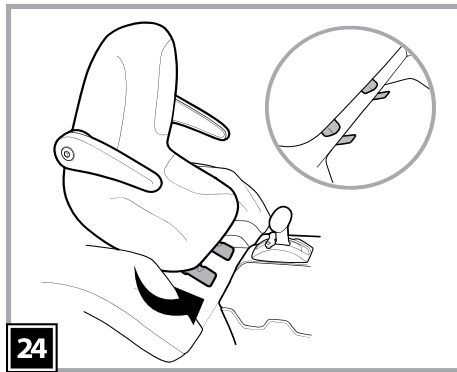
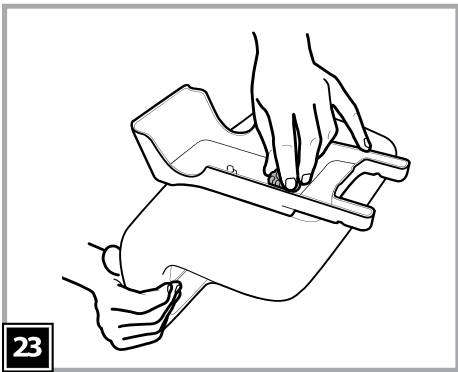
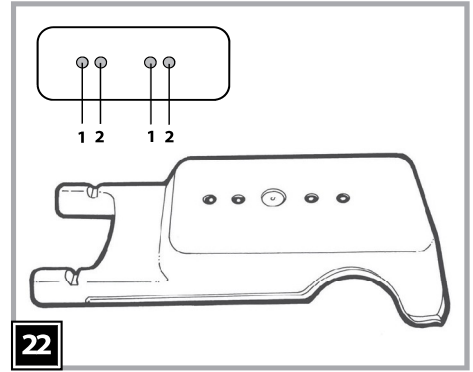
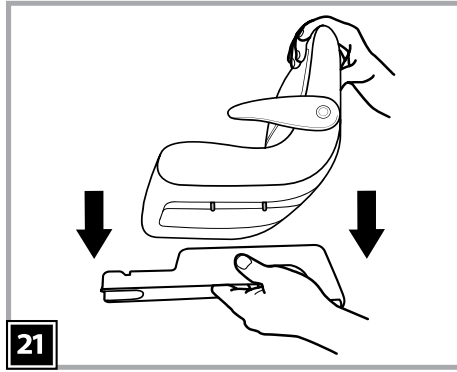
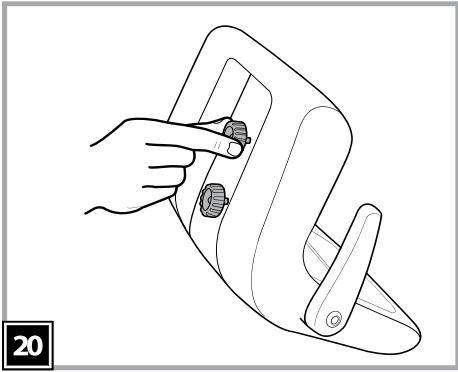
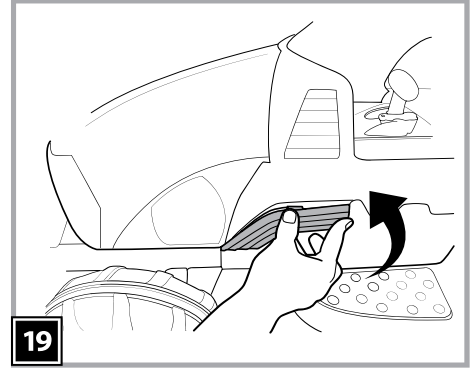
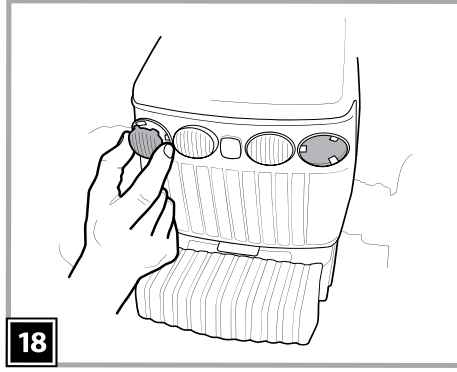
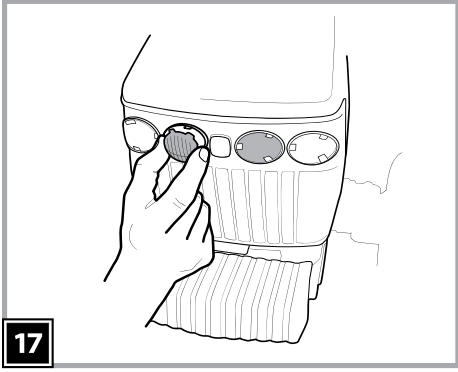
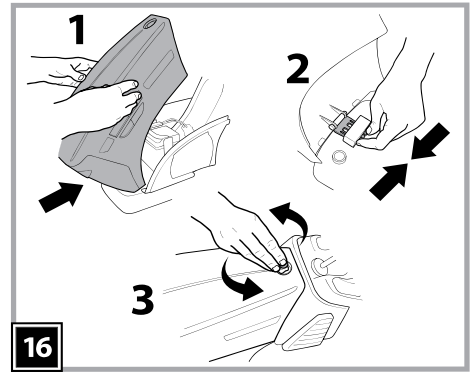
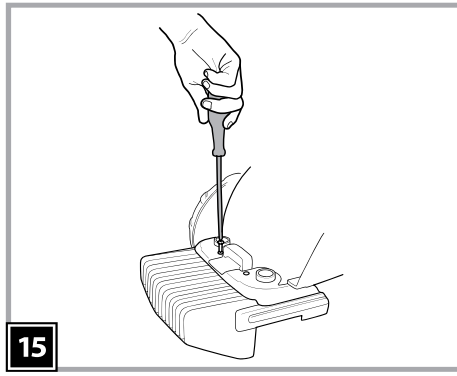
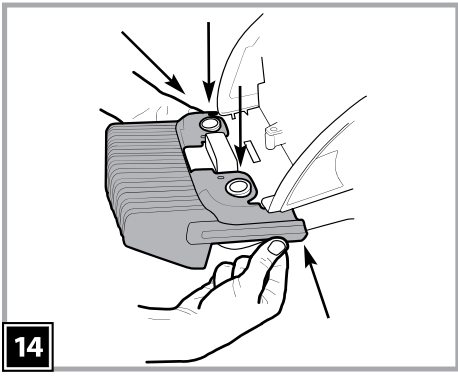

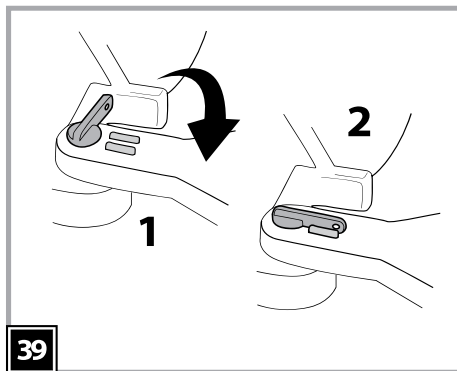
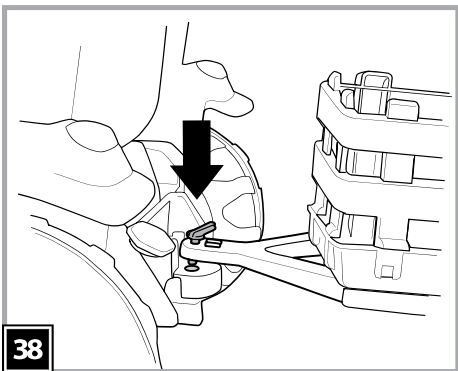
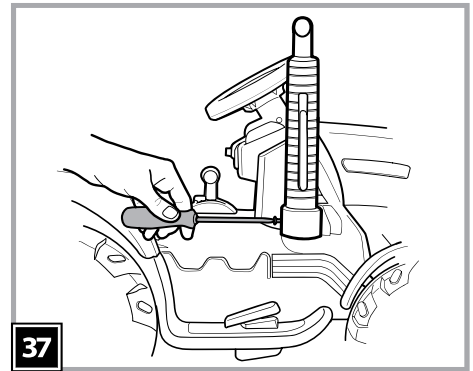
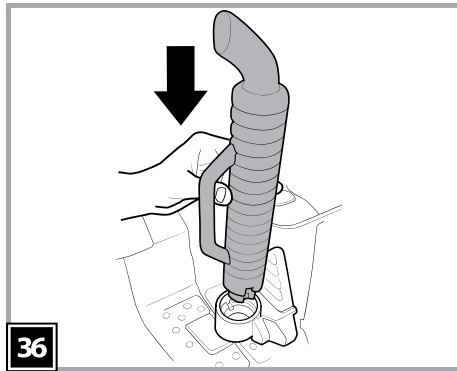
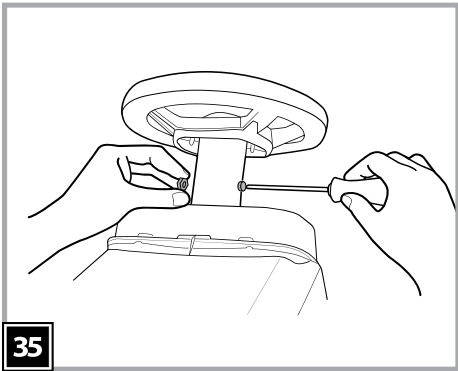
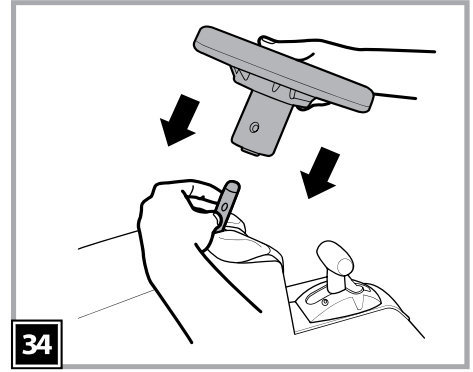
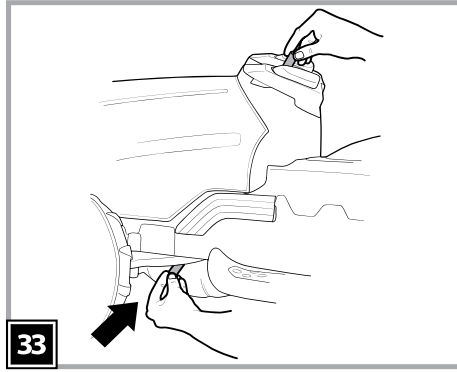
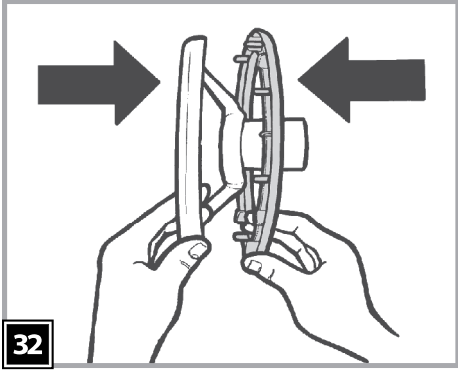
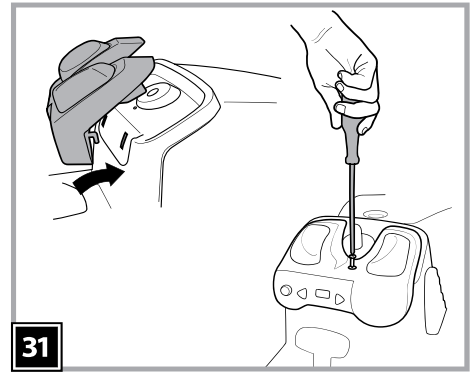
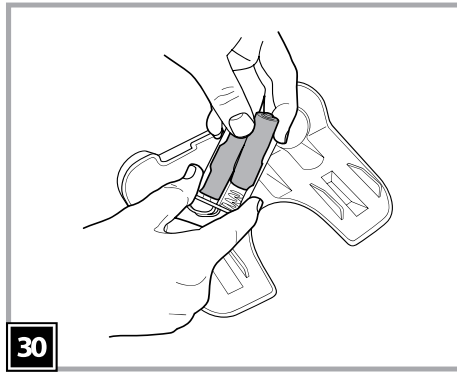
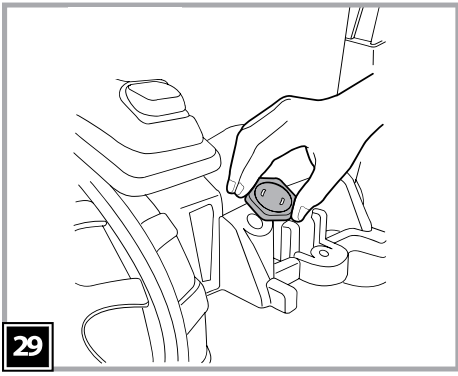

**VEHICLE FEATURES AND INSTRUCTIONS FOR USE**

**CARACTERÍSTICAS Y USO DEL VEHÍCULO**

**CARACTÉRISTIQUES ET UTILISATION DU VEHICULE**

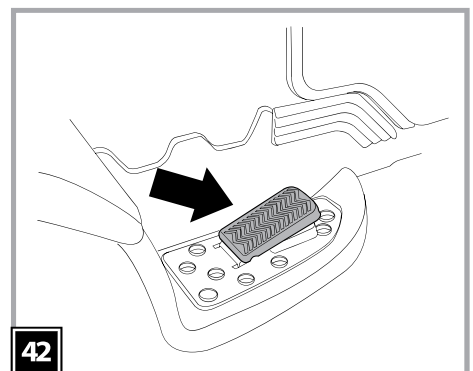
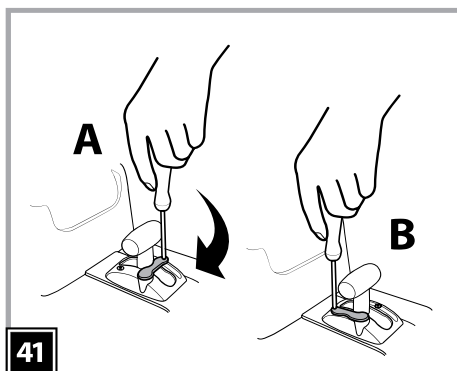
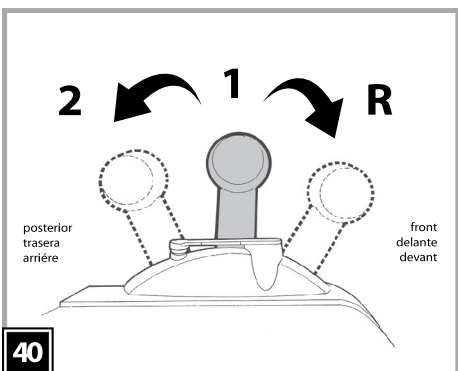

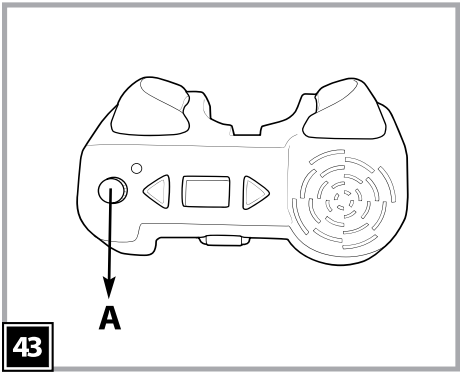

**BATTERY CHARGING**  
**CARGA DE LA BATERÍA**  
**CHARGE DE LA BATTERIE**

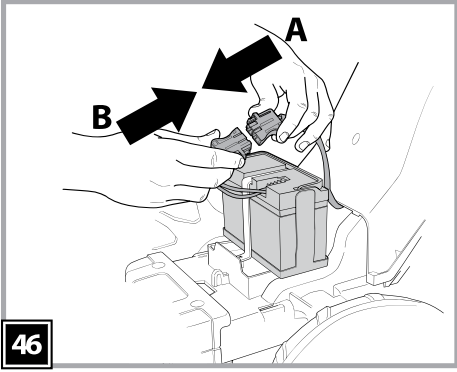
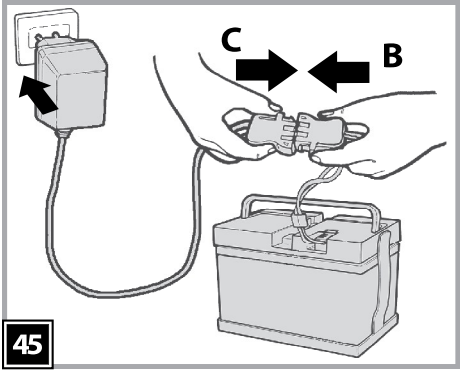
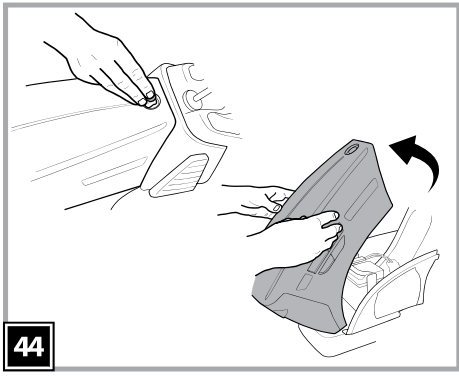

**REMOVING THE BATTERY**  
**CAMBIO DE LA BATERÍA**  
**REPLACEMENT DE LA BATTERIE**

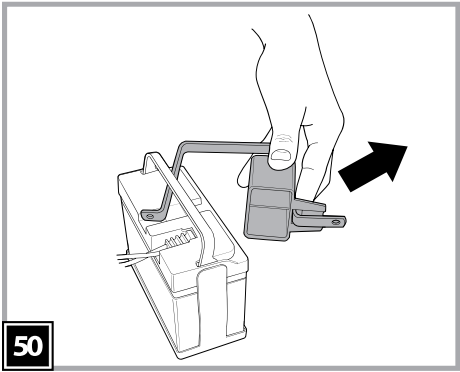
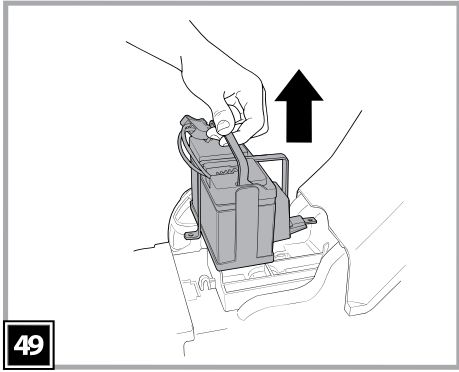
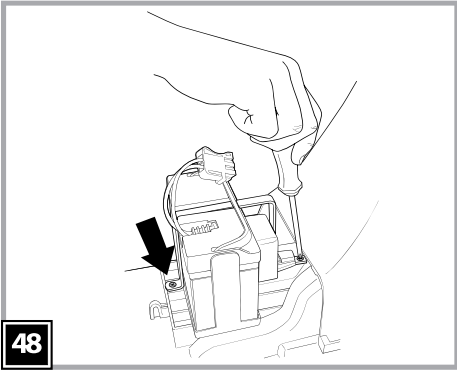
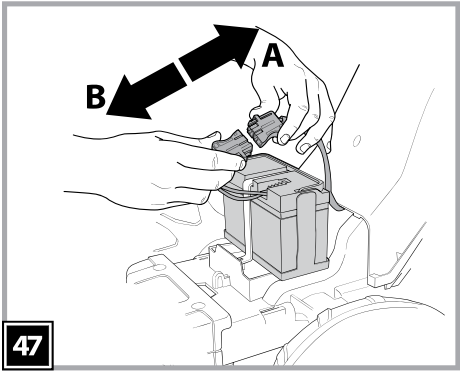

**INSTALLING BATTERY**  
**INSTALACIÓN DE LA BATERÍA**  
**INSTALLATION DE LA BATTERIE**

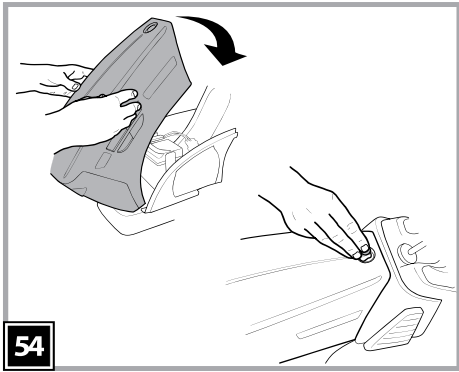
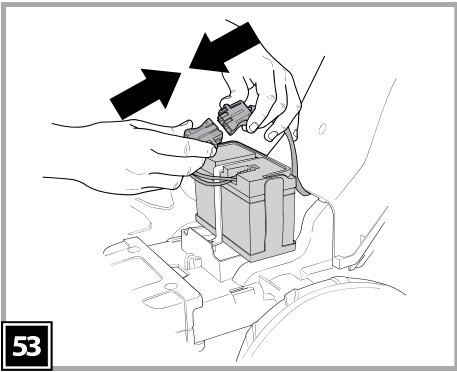
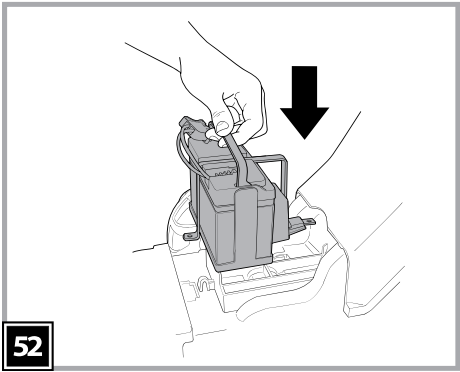
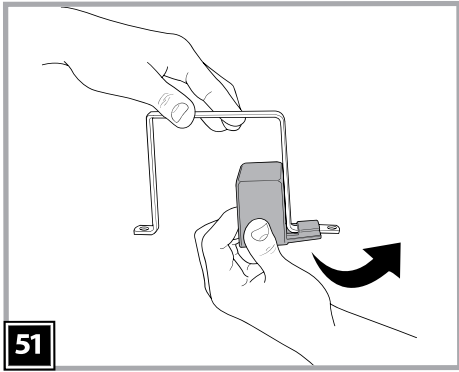

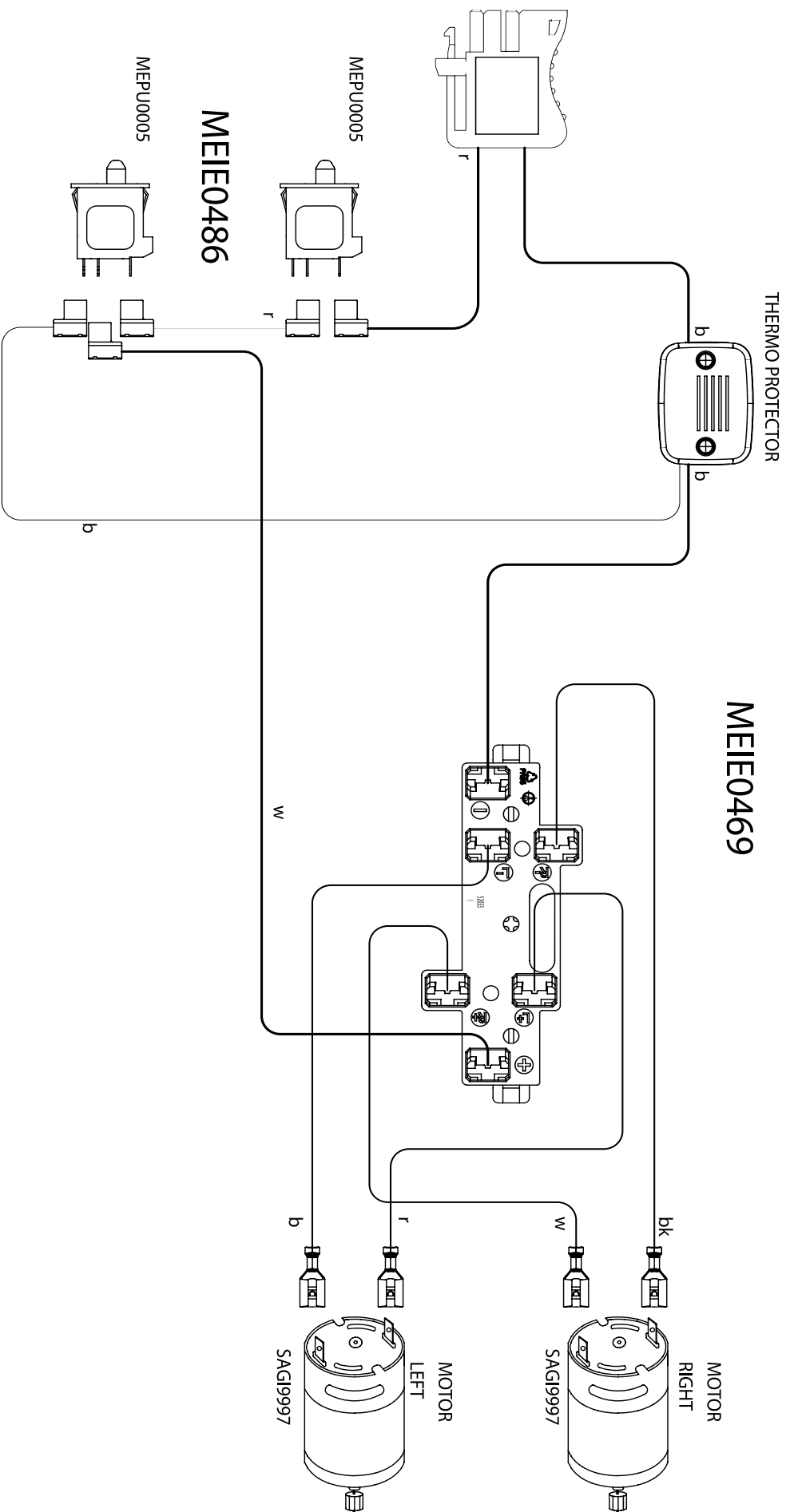

- |                   |                   |                  |
|-------------------|-------------------|------------------|
| <b>b</b> = blue   | <b>b</b> = azul   | <b>b</b> = bleu  |
| <b>bk</b> = black | <b>bk</b> = negro | <b>bk</b> = noir |
| <b>r</b> = red    | <b>r</b> = rojo   | <b>r</b> = rouge |
| <b>w</b> = white  | <b>w</b> = blanco | <b>w</b> = blanc |

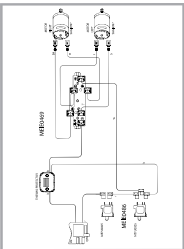

**DECALS  
CALCOMANIAS  
DÉCALQUES**

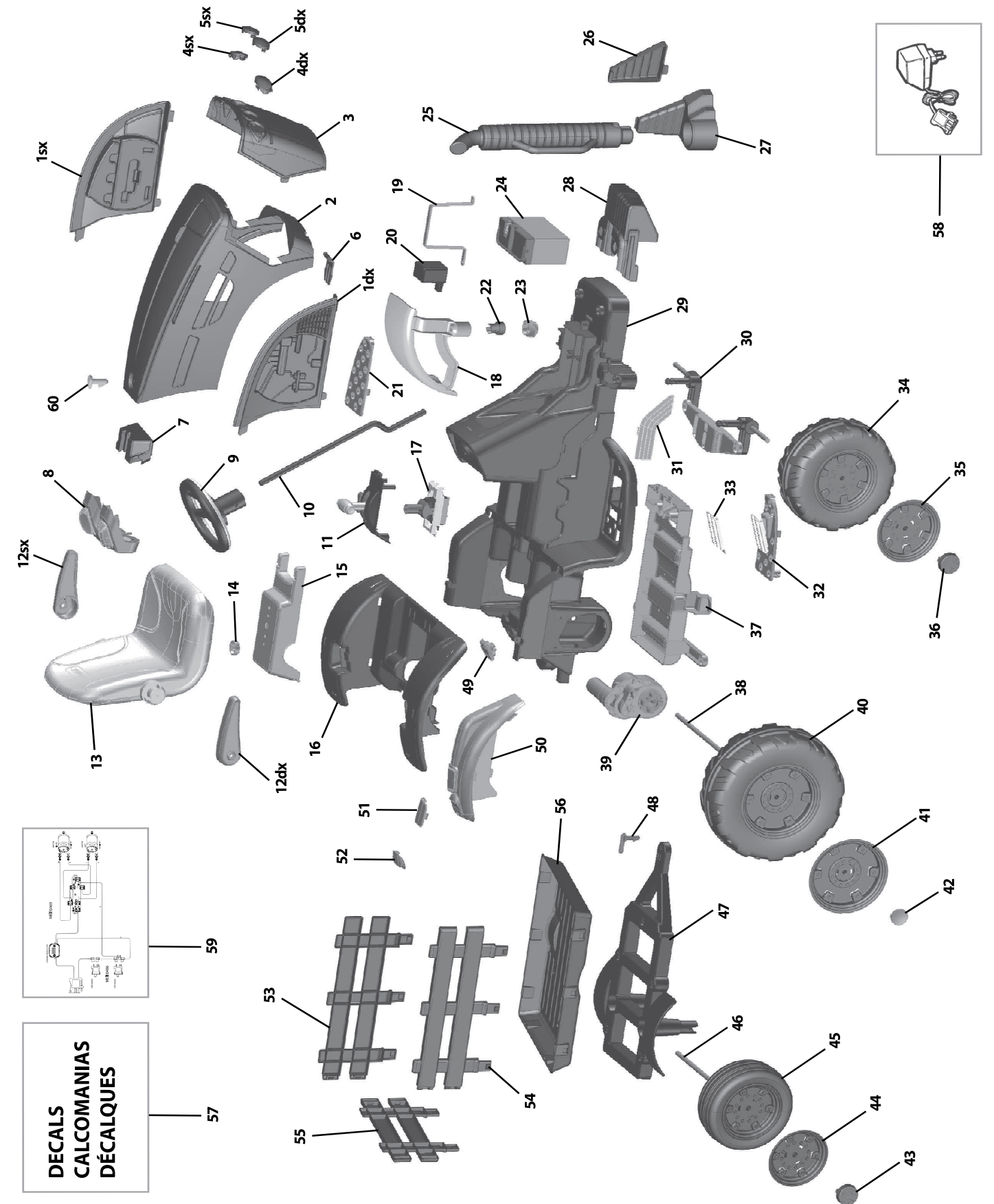

- 1 DX • SPST9117DVB
- 1 SX • SPST9117SVB
- 2 • SPST9115VB
- 3 • SPST9116N
- 4 DX • SPST9120D
- 4 SX • SPST9120S
- 5 DX • SPST9119D
- 5 SX • SPST9119S
- 6 • SPST8825N
- 7 • SPST9121N
- 8 • SAGI8830JN
- 9 • ASGI0134NY
- 10 • SOTF0128L30
- 11 • ASGI0140NY
- 12 DX\* ASGI8827DN
- 12 SX\* ASGI8827SN
- 13 • SARP8826Y
- 14 • SPST8207R
- 15 • SPST8296VB
- 16 • SPST8294N
- 17 • SAGI8782
- 18 DX\* SPST8281DN
- 18 SX\* SPST8281SN
- 19 • SOPF0047L30
- 20 • SPST8508N
- 21 • SPST8300GR
- 22 • SPST9136N
- 23 • SPST8308N
- 24 • IAKB0501
- 25 • SPMV9122N
- 26 • SPST9124N
- 27 • SPST9123N
- 28 • SPST9118VB
- 29 • SPST8279XN
- 30 • SAGI8280N
- 31 DX\* SPST8306DVB
- 31 SX\* SPST8306SVB
- 32 • ASGI0213GRGL
- 33 • SPST8863GL
- 34 DX\* SARP9129DNY
- 34 SX\* SARP9129SNY
- 35 • SPST9131Y
- 36 • SPST9133Y
- 37 • SPST8317KN
- 38 • SOFF0165Z
- 39 • SAGI9951KWN
- 40 DX\* SARP9130DNY
- 40 SX\* SARP9130SNY
- 41 • SPST9132Y
- 42 • SPST8517Y
- 43 • SPST9133Y
- 44 • SPST9134Y
- 45 • SARP8311JNY
- 46 • SOFF0164Z
- 47 • SPST8313N
- 48 • SPST0397R
- 49 • SPST8299R
- 50 DX\* SPST8295DVB
- 50 SX\* SPST8295SVB
- 51 • SPST8833N
- 52 • SPST8307A
- 53 • SPST9064SY
- 54 • SPST9064DY
- 55 • SPST9063Y
- 56 • SPST9062VB
- 57 • MMEV0641
- 58 • MECB0034
- 59 • Call
- 60 • SPST8500RC

## ENGLISH

• PEG PEREGO® thanks you for choosing this product. For over 50 years, PEG PEREGO has been taking children for an outing: first with its famous baby carriages and strollers, later with its pedal and battery operated toy vehicles.

• Read this instruction manual carefully to learn the use of this vehicle and to teach your child safe and enjoyable driving. Please keep this manual for use as a reference in the future.

• Our toys conform with the safety requirements provided by the Council of the EEC; of the I.I.S.G. Istituto Italiano Sicurezza Giocattoli, and the U.S. Consumer Toy Safety Specification F963.



**Peg Perego S.p.A. is an ISO 9001 certified company.**

The fact that we are certified provides a guarantee of our honesty for our customers, and fosters trust in the company's way of working.

• Peg Perego reserves the right to modify or change their product. Price, literature, manufacturing processes or locations or any combination of these above mentioned entities may change at any time for any reason without notice with impunity.

## Years 2-7 Weight capacity 85 lbs

### ⚠ CAUTION:

ELECTRIC VEHICLE NOT RECOMMENDED FOR CHILDREN UNDER 3 YEARS OF AGE. AS WITH ALL ELECTRIC PRODUCTS, PRECAUTIONS SHOULD BE OBSERVED DURING HANDLING AND USE TO PREVENT ELECTRIC SHOCK. RECHARGER INCLUDED. 120 VOLTS, 60Hz, 30W INPUT, 12 VOLTS (DC) OUTPUT.

#### CUSTOMER SERVICE

PEG PEREGO offers after-sales services, directly or through a network of authorized service centers for repairs or replacement parts. See the back cover of this instruction manual for contact information.

#### ASSEMBLY INSTRUCTIONS

### ⚠ CAUTION:

ADULT ASSEMBLY REQUIRED. USE CARE WHEN UNPACKING AS COMPONENTS TO BE ASSEMBLED MAY POSE A SMALL PARTS/SHARP EDGE HAZARD. BATTERY ALREADY INSTALLED IN VEHICLE.

#### ASSEMBLY

- 1-2 • Turn tractor upside down, remove the trailer chassis from underside of the tractor chassis by removing the screw.
- 3 • Insert washer shaped retainer into retainer installation tool with the finished side facing up. ATTENTION: the tabs on the self-locking washer must be turned towards the interior of the tool (see detail A).
- 4 • Place one end of trailer axle into retainer installation tool and pound axle into tool (and retainer) until fully seated.
- 5 • Insert white bushing into the inside of each trailer wheel as shown.
- 6 • Install the following components onto axle; 1) washer 2) wheel (hubcap facing down) 3) 2nd

- wheel (hubcap facing up) 4) washer.  
ATTENTION: Check to make sure that the wheels have been inserted correctly on the axle. The hubcaps must be facing away from the toy.
- 7 • Place retainer into installation tool, place tool onto upper end of axle and pound until seated. Remove tool.
  - 8 • Place wheel & axle assembly onto trailer chassis with washers outside of posts and press down until axle is firmly seated into chassis.
  - 9 • Insert red pin into trailer chassis tongue.
  - 10 • Remove the 5 protective caps from the bottom of the trailer.
  - 11 • Assemble yellow trailer sides together with finished sides facing out.
  - 12 • Place trailer sides firmly into stake pockets in trailer bed.
  - 13 • Turn trailer bed upside down, place trailer chassis onto bed, align the 5 pegs in the green bed with the 5 holes in the black chassis and very firmly press or pound pegs into the holes with hammer until firmly seated.
  - 14 • Place green counterweight on the black chassis; chassis pegs will pass through holes in counterweight. Press lower sides of counterweight into chassis to latch.
  - 15 • Secure with 2 screws.
  - 16 • Install hood by inserting lower black hinged tongue into slot on chassis. Rotate hood closed and turn black latch with coin to secure.
  - 17 • Press the 2 identical central headlights into place paying attention to the 3 respective slots.
  - 18 • Proceed to mount the remaining 2 side headlights. Caution! The 2 headlights are not identical: check the direction of insertion into the slots.

- 19 • Press the side inserts into place on the body.
- 20 • Unscrew the knobs on the bottom of the seat.
- 21 • Place seat bolts into green seat support holes.
- 22 • The seat can be adjusted to 2 positions to suit the height of the child (see figure).
- 23 • After adjusting the seat, tighten the 2 knobs that hold it in place.
- 24 • Insert front green seat support fingers into chassis.
- 25 • Rotate support (and seat) down onto chassis at the rear. Turn tractor chassis upside down and secure support to chassis with 2 screws.
- 26 • Apply the chrome decals to the taillight positions as shown in the figure.
- 27 • Attach the taillight lenses by pressing from the bottom upwards.
- 28 • Install left & right black plastic covers into "C" slots on each rear fender.
- 29 • Press the gas tank cap into place on the back of the tractor.
- 30 • Install 2 AA batteries in FM radio (through door on back side)
- 31 • Attach radio to tractor; insert 2 fingers on radio into the slots in the chassis beneath the steering column. Secure with a screw.
- 32 • Press the trim piece into place under the steering wheel.
- 33 • Install steering wheel; reach under tractor to find metal steering column tube. Push it upward as far as possible and hold it.
- 34 • Place steering wheel onto tube, align bolt holes.
- 35 • Install bolt and nut. Tighten.
- 36/7 • Place exhaust stack into bracket and secure with long screw.
- 38 • Attach the trailer to the tractor as follows: insert the trailer coupling into the opening on the back of the tractor, and rotate it (see fig. 39).
- 39 • Position 1: the trailer can be removed.  
Position 2: the trailer is locked into place.  
WARNING: The trailer will hold a load weighing up to 10 kg/22 lbs.

#### VEHICLE FEATURES AND INSTRUCTIONS FOR USE

- 40 • GEAR SHIFT LEVER. This vehicle has 2 speeds + reverse, with PARENTAL CONTROL: When produced, IT IS RESTRICTED TO SLOW SPEED and REVERSE ONLY (For safety, shifter must be held in reverse to back up).
- 41 • TO ACCESS HIGH SPEED (see red bar beneath shift lever) remove screw, rotate red bar 90 degrees counterclockwise and replace screw.
- 42 • 3 position SmartPedal accelerator; 1) up = off/brake 2) ½ down = coast. 3) run
- 43 • FM RADIO. To switch on, switch off and adjust volume, turn the A button. To select the frequency, press the 2 triangle buttons.

#### CHARGE BATTERY BEFORE USING BATTERY CHARGING

### ⚠ WARNING:

**WARNING: BATTERY CHARGING AND ANY OTHER OPERATION ON THE ELECTRICAL SYSTEM MUST BE CARRIED OUT BY ADULTS ONLY. THE BATTERY CAN ALSO BE CHARGED WITHOUT REMOVING IT FROM THE VEHICLE.**

- 44 • **Install Battery:** Open hood by turning black latch with 90 degrees with a coin. Rotate hood forward to open.
- 45 • Insert the battery charger plug into an electrical outlet. Connect point B to point C on the battery charger. When the battery has been completely recharged, disconnect the battery charger from the electrical outlet, and disconnect point C from point B.
- 46 • Insert point B into point A, pressing until it clicks into place. Replace the battery brace. Always remember to close and fasten the hood on the battery compartment when you have finished working on the battery.

#### REMOVING THE BATTERY

- 47 • Open the hood, as described above. Disconnect the battery from the electrical system by squeezing the sides of the plugs.
- 48 • Loosen the 2 screws on the battery brace, as shown in the figure.
- 49 • Remove the battery.
- 50 • Remove the battery clamp from the dead battery.

#### INSTALLING BATTERY

CHARGE BATTERY BEFORE USING.

- 51 • If you have bought or own a Peg Perego 12V/12Ah battery, you will have to remove the plastic filler (A) by slipping it off the battery clamp.
- 52 • Reposition the new battery with the battery clamp in its housing. Fasten the clamp with the two screws.
- 53 • Connect the battery plug to the electrical system.
- 54 • Close again the cab by repositioning the hook, as done above.

#### BATTERY MAINTENANCE AND SAFETY

Before riding, charge your battery for 18 hours to initiate them. Failure to do this will result in permanent battery damage.

### ⚠ CAUTION:

Only adults should recharge batteries, never children. Never allow children to handle batteries.

Only use the batteries specified by the manufacturer. Only use the charger specified by the manufacturer. Do not mix old and new batteries. Do not mix alkaline, standard (carbon-zinc), or rechargeable (nickel-cadmium) batteries.

#### CHARGING THE BATTERY

- Charge the batteries no longer than 24 hours, following the instructions enclosed with the battery charger.
- Charge the battery, as the vehicle shows low power, in this way you will avoid damage to the battery.
- If you don't use your vehicle for a long period of time unplug the battery from the main wire harness of the vehicle. Remember

to charge the battery at least every three months.

- Never charge the battery upside down.
- Do not forget batteries during charging! Check them periodically.
- Never use a replacement recharger or batteries unless they are approved by PEG PEREGO.
- Batteries are sealed and maintenance free.
- Battery polarity must be observed when connecting battery to wiring.

## ⚠ WARNING:

- BATTERIES CONTAIN TOXIC AND CORROSIVE SUBSTANCES. DO NOT TAMPER WITH THEM.
- Batteries contain an acid-based electrolyte.
- Do not make direct contact between battery terminals, as this can cause an explosion or fire.
- Charging produces explosive gases. Charge batteries in a well ventilated area away from sources of heat and flammable materials.
- Exhausted batteries are to be removed from the vehicle.
- Do not place the batteries near clothing to avoid damage.

### IF A LEAK DEVELOPS

Shield your eyes. Avoid direct contact with the electrolyte, protect your hands.  
Place battery in a plastic bag and follow directions listed below.

IF ELECTROLYTE COMES IN CONTACT WITH SKIN OR CLOTHING  
Flush with cool water for at least 15 minutes.

See a physician at once.

### IF ELECTROLYTE IS INGESTED

Give tap water, milk of magnesia or egg whites at once.  
Do not induce vomiting.  
See a physician at once.

### DISPOSAL OF BATTERIES

Help protect the environment!  
Do not throw used batteries in your regular, household trash.  
Dispose of the old batteries in an approved dumping station; contact your local environmental protection agency office for further information.



## ⚠ CAUTION AA BATTERIES

The insertion of batteries must only be carried out or supervised by

adults. Do not let children play with the batteries.

- The batteries should be replaced by an adult.
- Use only the type of battery specified by the manufacturer.
- Respect the polarity +/-
- Do not allow the batteries to be in contact with metal parts (risk of fire or explosion).
- Always remove the batteries if the toy is not in use for a long period.
- Do not throw batteries on the fire.
- Never attempt to charge batteries that are not rechargeable.
- Remove dead batteries from the toy.
- Dispose of dead batteries into containers provided for the recycling of dead batteries.



## VEHICLE MAINTENANCE AND SAFETY

This product conforms to EN 71 and conforms to EN 50088 safety standard for electric toys.

This vehicle is not intended for use on streets, around traffic or parked cars.

This product meets and/or exceeds all ASTM TOY SAFETY STANDARDS, including F 963, Consumer Toy Safety Specifications.

### MAINTENANCE AND CARE

- Regularly check the conditions of the vehicle, particularly the electrical system, the plug connections, the covering caps and the charger. In case of fault, do not try to use the vehicle and the charger. For repair use only original PEG PEREGO's spare parts.
- PEG PEREGO assumes no liability if the electrical system is tampered with.
- Do not leave vehicle or batteries near sources of heat such as radiators, stoves, fireplaces, etc.
- Protect vehicle from water, rain, snow, etc.
- It can operate on grass, dirt or hard surfaces.
- When operating in overload conditions, such as soft deep sand, mud or rough uneven terrain, the overload circuit breaker will automatically disconnect the power. After 10 or more seconds, the circuit breaker will automatically reset, however you must eliminate overload conditions to resume normal driving.
- Periodically lubricate (with a light weight oil) moving parts, such as wheel bearings, steering linkages,

where they rotate or touch one another.

- The vehicle's surface can be cleaned with a dampcloth. Do not use abrasive cleaners. The cleaning must be carried out by adults only.
- Never disassemble the vehicle mechanisms or motor unless authorized by PEG PEREGO.

Conforms a EN 50088

Rechargeable battery 12V 8Ah sealed lead-acid battery.

Two 140W motors

### SAFETY

## ⚠ WARNING:

- To reduce the risk of injury, adult supervision is required. Never use in roadways, near motor vehicles, on or near steep inclines or steps, swimming pools or other bodies of water; always wear shoes, and never allow more than one rider.
- Surfaces that are appropriate for safe use: grass, gravel, hard surfaces, inclines up to 10%.
- Not suitable for children under the age of 36 months. The small pieces could be swallowed or inhaled.
- The trailer is not designed to support a child's weight. Do not place loads over 10 Kg/22 lbs. on the trailer.
- Never use the vehicle on steep slopes or near steps or stairs. This vehicle is not suitable for use on public highways.
- Do not allow children to place their hands, feet or any part of their body, clothing or other articles near the moving parts while vehicle is in operation.
- Do not allow the electrical components, motors, wiring, switches of your motorized vehicle to become wet and never wash it with a hose.
- Never use gasoline or other flammable substances near the vehicle.
- The vehicle is designed just for one child: never allow more than one rider.

## RULES FOR SAFE DRIVING

DON'T STOP THE FUN: always have freshly charged, back-up batteries on hand.

For your child's safety: please read and follow all instructions below before operating.

### 2nd SPEED

Initially we suggest using only the 1st speed and the reverse gear. Before moving into 2nd speed be sure that the child has become familiar with operating the vehicle.

- 1ST SPEED slow speed (beginner drivers):  
With both hands on the steeringwheel, press down on the accelerator pedal; the vehicle goes forward at 2.25 mph.
- 2ND SPEED fast speed (experienced drivers):  
With both hands on the steeringwheel, press down on the accelerator pedal; the vehicle goes forward at 4.5 mph.
- REVERSE:  
Place the left hand on the steeringwheel. With the right hand holding the gearshift in reverse, press your foot down on the accelerator; the vehicle reverses at 2.25mph. (Reverse is spring-loaded for safety).
- BRAKE:  
The electric braking system stops the vehicle automatically when your child lifts his foot off the pedal.

Teach your child the proper use of this vehicle for a safe and fun play time.

- Before starting be sure that the way is free from people and objects.
- Drive with both hands on the steeringwheel and keep your eyes on the road at all times.
- Stop in time to avoid accidents.
- Use the 2nd speed only after your child has the maturity and the reflexes to operate the vehicle safely.

## ⚠ CAUTION:

- **In first gear, the vehicle has a differential effect like real cars; on smooth terrain and with one child, the two wheels may turn at different speeds, resulting in possible sliding/deceleration.**
- **When operating in overload conditions, such as soft deep sand, mud or rough uneven terrain, the overload circuit breaker will automatically disconnect the power. After 10 or more seconds, the circuit breaker will automatically reset, however you must eliminate overload conditions to resume normal driving.**

## PROBLEMS?

IF THE VEHICLE DOES NOT OPERATE?

- Check that all the plugs are properly connected.
- Check to make sure that no wires

are disconnected from the reduction gears.

- Check the accelerator switch, if vehicle runs replace switch.
- Check that the battery is connected to the electrical system.

IF THERE IS NO POWER?

- Fully recharge the batteries. If the problem persists, check with an Authorized PEG PEREGO Service Center.

## ESPAÑOL

• PEG PEREGO® le agradece que haya elegido este producto.  
Hace más de 50 años que PEG PEREGO lleva a pasear a los niños: al nacer, con sus famosos coches-cuna y coches de paseo, después con los fantásticos vehículos de juguete a pedal y con batería.

• Lea atentamente este manual de instrucciones para familiarizarse con el uso del modelo y enseñar a su niño un modo de conducir correcto, seguro y divertido. Conserve después el manual para cualquier consulta futura.

• Nuestros juguetes respetan los requisitos de seguridad previstos por el Consejo de la EEC, por el "U.S. Consumer Toy Safety Specification" y están aprobados por el I.I.S.G. Istituto Italiano Sicurezza Giocattoli.



**Peg Perego S.p.A. cuenta con la certificación ISO 9001.**

Dicha certificación ofrece tanto a los clientes como a los consumidores la garantía de una transparencia y confianza por lo que concierne al modo de trabajar de la empresa.

• Peg Perego podrá modificar los modelos descritos en este prospecto, por razones técnicas o comerciales.

## Años 2-7 Peso transportable 85 lbs/38,6 kg

### ⚠ PRECAUTION:

LOS VEHICULOS ELECTRICOS NO SON RECOMENDABLE PARA NIÑOS MENORES DE 3 AÑOS. COMO TODOS LOS PRODUCTOS ELECTRICOS, CUANDO SE ESTA MANEJANDO OBSERVE LAS MEDIDAS DE PRECAUCION PARA PREVENIR UN CHOQUE ELECTRICO. EL CARGADOR ESTA INCLUIDO. 120 VOLTS, 60Hz, 30W DE ENTRADA, 12 VOLTS (DC) DE SALIDA.

### SERVICIO DE ASISTENCIA

PEG PEREGO ofrece un servicio de asistencia post-venta, directamente o a través de una red de centros de asistencia técnica autorizados, para eventuales reparaciones o sustituciones y venta de recambios originales. Para contactar con los centros de asistencia véase la parte de atrás de la cubierta de este manual de instrucciones.

### INSTRUCCIONES DE MONTAJE

### ⚠ PRECAUTION:

REQUIERE MONTAJE DE UN ADULTO. ALGUNOS COMPONENTES AL SER ENSAMBLADOS PODRÍAN TENER PARTES PEQUEÑAS/RIESGO POR BORDES CONTANTES.

#### MONTAJE

- 1-2 • Girar el tractor, quitar el chasis del remolque desde la parte inferior del chasis del tractor quitando todos los tornillos.
- 3 • Introducir un retén en forma de arandela en la herramienta de instalación con el lado acabado hacia arriba. ATENCIÓN: las lengüetas de la arandela autobloqueante tienen que estar hacia el interior de la herramienta (véase el detalle A).
- 4 • Situar un extremo del eje del remolque en la herramienta de instalación del retén y golpear

This document was created with Win2PDF available at <http://www.win2pdf.com>.  
The unregistered version of Win2PDF is for evaluation or non-commercial use only.  
This page will not be added after purchasing Win2PDF.